



SoundCore Infini Soundbar A3371 User Manual

[Home](#) » [Support](#) » SoundCore Infini Soundbar A3371 User Manual 

Contents

- [1 SoundCore Infini Soundbar A3371](#)
- [2 What's Included](#)
- [3 Safety Instructions](#)
- [4 At a Glance](#)
- [5 Placement
 - \[5.1 Table Placement\]\(#\)
 - \[5.2 Wall mount Installation\]\(#\)](#)
- [6 Remote Control
 - \[6.1 1. Battery installation\]\(#\)
 - \[6.2 2. Remote control buttons\]\(#\)](#)
- [7 Using Your Soundbar
 - \[7.1 1. Turn On / Off\]\(#\)](#)
- [8 Declaration of Conformity](#)
- [9 Specifications](#)
- [10 A3371 FAQ](#)
- [11 DOWNLOAD](#)
- [12 Related Posts](#)

SoundCore Infini Soundbar A3371



USER MANUAL

Model No.: A3371
51005001129 V01

What's Included

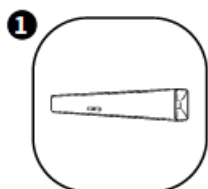

Soundcore Infini

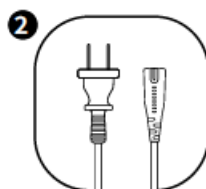

Power cord

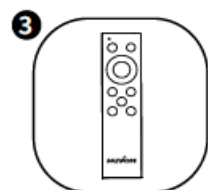

Remote control

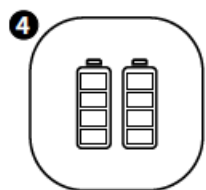

AAA batteries

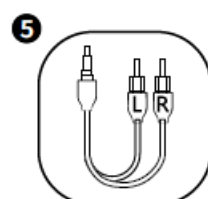

3.5mm to RCA
audio cable

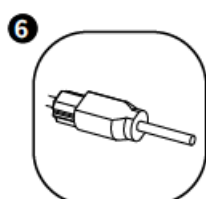

Optical cable

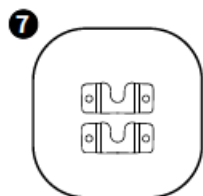

Wall mounting
brackets

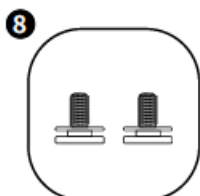

Wall mounting
bolts

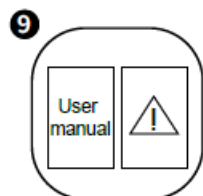

User manual

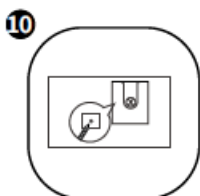

Wall mounting
template

Safety Instructions

- Avoid dropping.
- Do not disassemble.
- Do not submerge in water.
- Avoid extreme temperatures.
- Do not use the device outdoors during thunderstorms.
- Use original or certified cables.
- Do not use any corrosive cleaner / oil to clean.
- The product should not be exposed to dripping or splashing water.

At a Glance

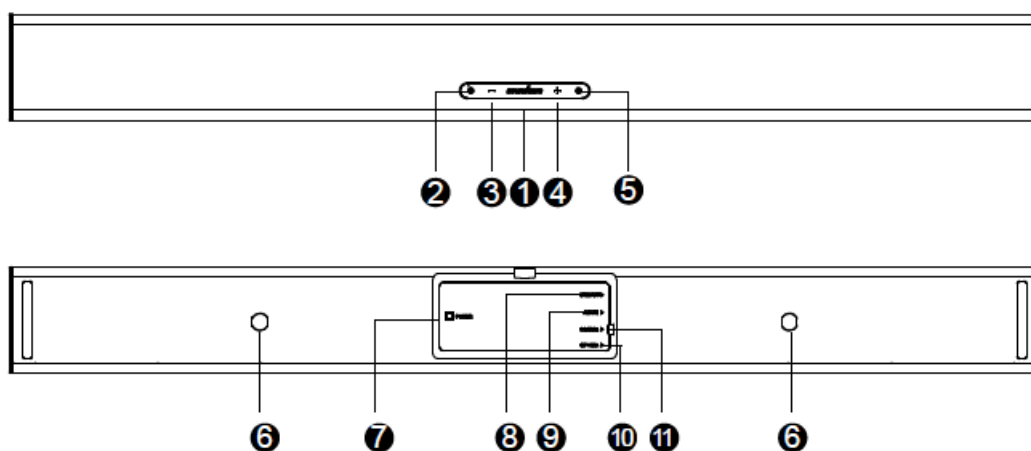

1. Status indicator

Status	Status indicator light
Standby	Solid red
Optical	Solid green (stays on for 10 seconds)
Coaxial	Solid orange (stays on for 10 seconds)
Aux in	Solid cyan (stays on for 10 seconds)
Bluetooth pairing mode	Flashing blue
Bluetooth device connected	Solid blue (stays on for 10 seconds)
Volume up and down	Flashing white

Status	Status indicator light
Maximum volume	Solid white (stays on for 10 seconds)
Minimum volume	Solid white (stays on for 10 seconds)
Music equalizer mode	Flashing white (once)
Movie equalizer mode	Flashing white (2 times)
Dialogue mode	Solid white (stays on for 5 seconds)
Mute	Solid yellow

2. Power button
3. Volume-down control
4. Volume-up control
5. Source input button
6. Wall mounting screw holes
7. Power input
8. Service port
9. Aux input
10. Optical input
11. Coaxial

Note: Press source input button and hold for 3 seconds to activate Bluetooth pairing mode.

Placement

Table Placement

1. Place the soundbar on a solid surface.

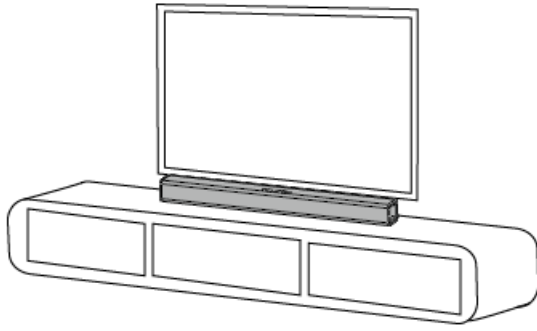

Wall mount Installation

Step 1: Insert two wall mounting screws into the wall mounting screw holes, then fasten the screws.

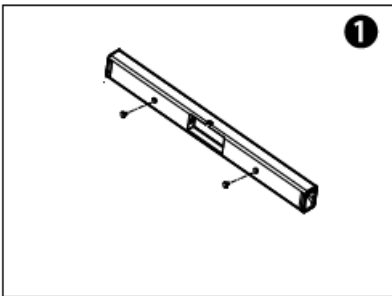

Step 2: Place the wall mounting template against the wall, under your TV. Mark the 4 bracket holes on the wall with a pencil.

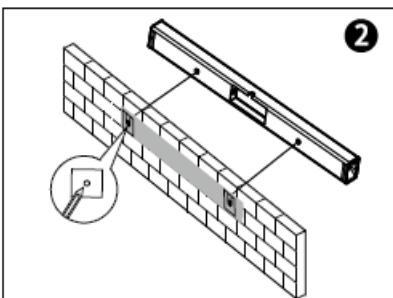

Step 3: Fix the two mounting brackets on the wall according to the center points. Use bolts (not included) to secure the brackets.

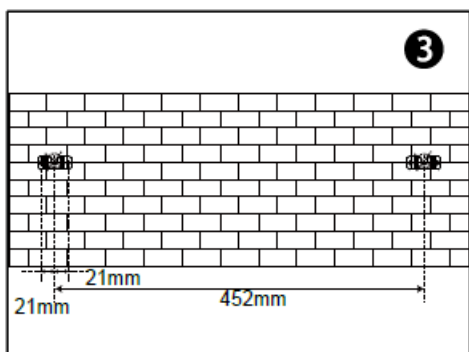

Step 4: Hang the soundbar on the brackets.

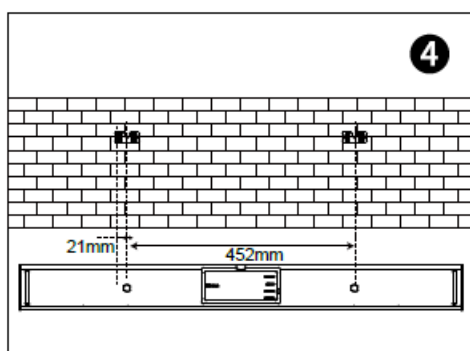

Remote Control

1. Battery installation

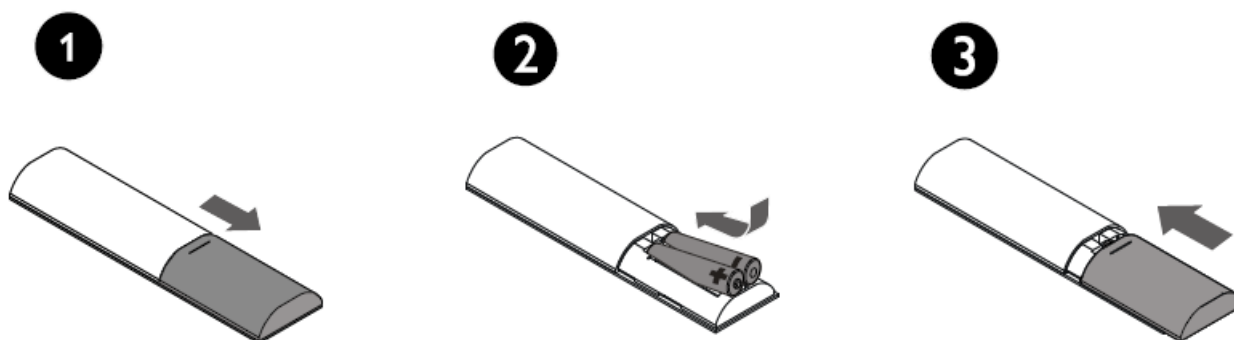

2. Remote control buttons

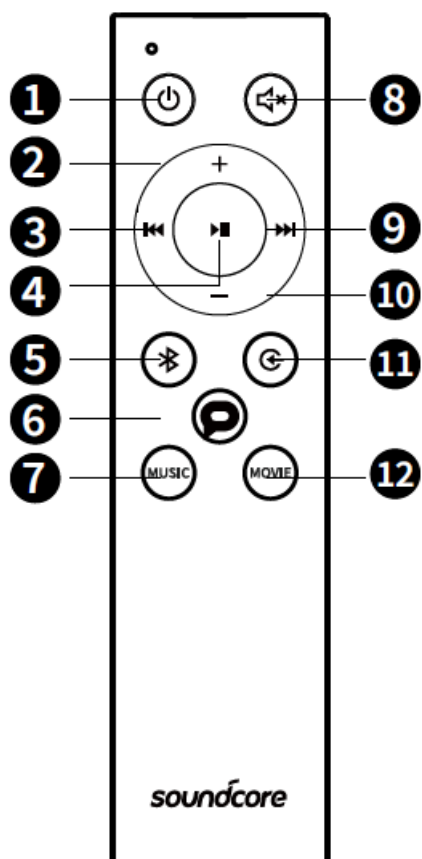

Button	Button functions
❶ Power button	Press to switch on / off the soundbar.
❷ Volume-up control	To increase the volume.
❸ Previous	Return to previous track.
❹ Play / Pause	To pause / resume playback.

Button	Button functions
5 Bluetooth button	To activate Bluetooth mode. 1. Press to activate Bluetooth mode. 2. Press and hold for 3 seconds to reconnect.
6 Dialogue mode button	To activate the dialogue mode.
7 Music equalizer button	To activate the music equalizer mode.
8 Mute button	To temporarily turn off the sound. Press the button again to turn the sound back on.
9 Next	Move to next track.
10 Volume-down control	To decrease the volume.
11 Source input button	To change source input. Press this button for 3 seconds to activate Bluetooth pairing mode.
12 Movie equalizer button	To activate the movie equalizer mode.

Warning: The status indicator light will stay on for approximately 10 seconds when the soundbar is in Bluetooth mode / Aux in mode / Optical mode / Coaxial mode.

Using Your Soundbar

1. Turn On / Off

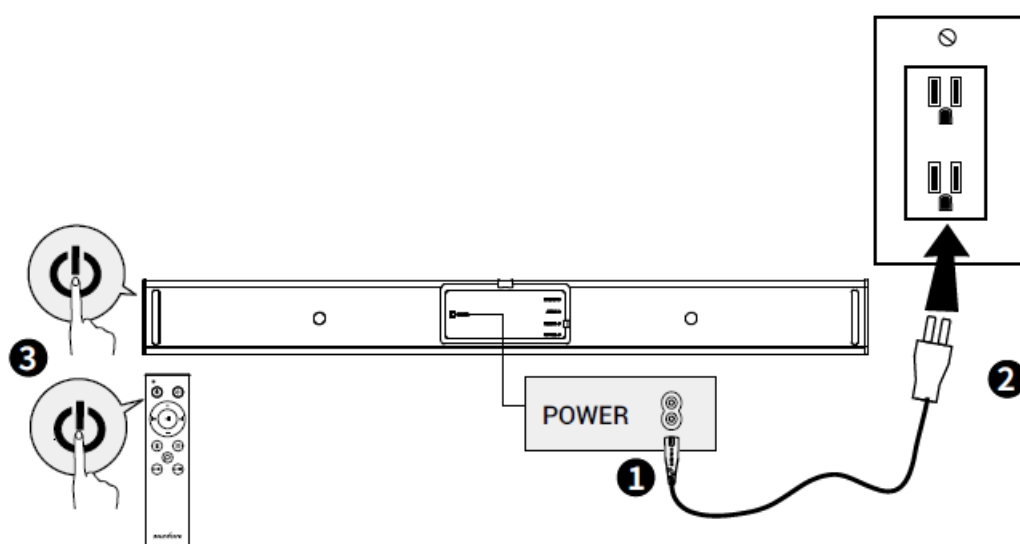

Warning: The soundbar will automatically switch to standby mode when no audio input is received for over 30 minutes. The soundbar will wake up from standby mode when any button is pressed or source input is received.

a. Connect to your TV

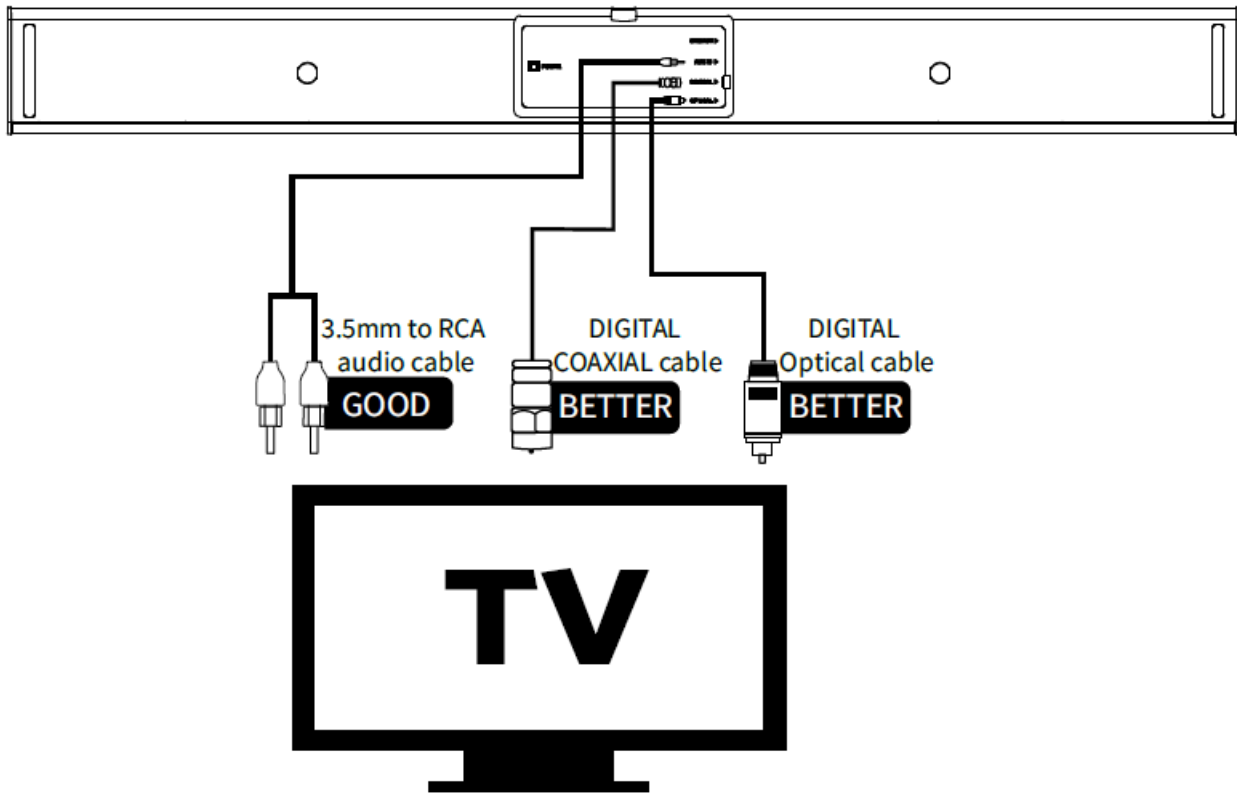

1. You can use optical cable, coaxial cable or 3.5mm to RCA audio cable to connect to the respective output port of your TV.
2. Press the source input button on the soundbar or remote control to activate the corresponding mode. The status indicator will be solid green in optical mode, orange in coaxial mode and cyan in Aux mode.

Note: The status indicator light will stay on for 10 seconds.

Note: Not all TVs have the audio outputs shown as above, please check your TV's specifications before setup.

Note: Try set the TV output to PCM if there is no audio sound when using either of the optical or coaxial inputs.

Note: Coaxial cable is not included.

b. Connect to other devices

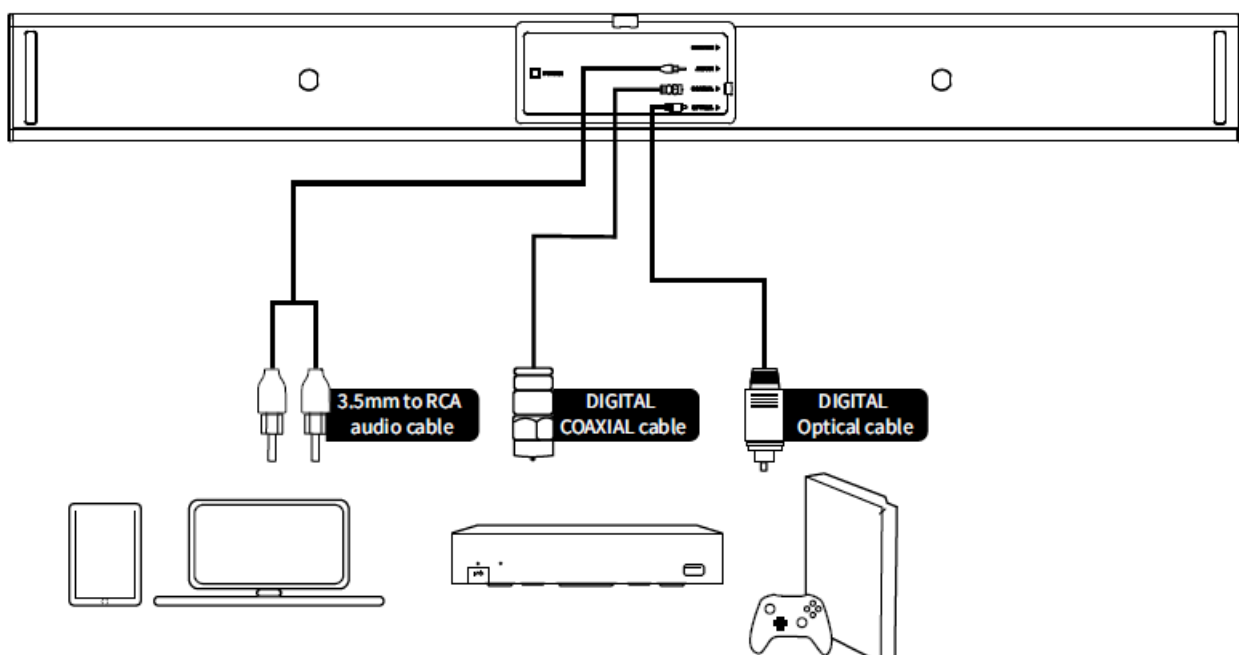

1. You can use optical cable / coaxial cable or 3.5mm to RCA audio cable, or 3.5mm to 3.5mm cable (not included) to connect to the respective output port of other devices (such as Blu-ray player, game console, tablet, MP3 Player / laptop etc).
2. Press the source input button on the soundbar or remote control to activate optical, coaxial or Aux mode. The status indicator will be solid green in optical mode, orange in coaxial mode and cyan in Aux mode.

Note: The status indicator light will stay on for 10 seconds.

Note: Follow your device's user manual if you want to connect the soundbar to your other devices (such as Blu-ray player, game console, tablet, MP3 Player / laptop...etc)..

Note: 3.5mm to 3.5mm cable is not included.

c. Bluetooth mode

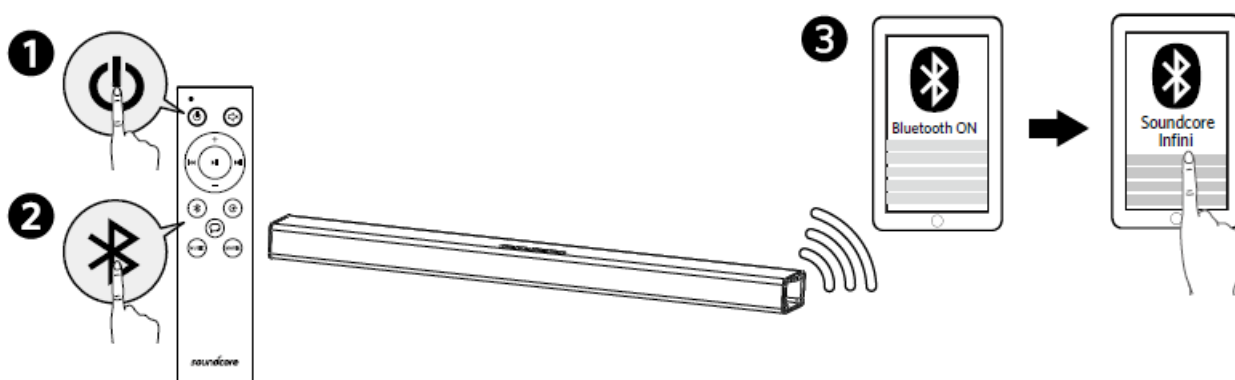

1. Press power button on the remote control to switch on the soundbar.
2. Press the Bluetooth button on the remote control to activate Bluetooth pairing mode.
3. Turn on the Bluetooth of your device, search for Soundcore Infini on your Bluetooth list then select connect.

Flashing blue	Bluetooth mode is activated
Solid blue	Connected to device Note: The status indicator light will stay on for 10 seconds.

Warning:

- When turned on, Soundcore Infini Soundbar will automatically connect to the last connected device if available. If not, press and hold the Bluetooth button (or source input button) for 3 seconds on the remote control or press the source input button on the soundbar for 3 seconds to activate Bluetooth mode.
- Having connection problems? Remove Soundcore Infini from your device's Bluetooth history and ensure it's less than 10 meters away. Then try pairing again. To get the best sound quality, make sure there is a clear line of sight between the connected device and your soundbar.

Warning:

When not in use, store your soundbar in a cool place.

Declaration of Conformity

Hereby, Anker Innovations Limited declares that the radio equipment type A3371

is in compliance with Directive 2014/53/EU. The full text of the EU declaration of conformity is available at the following internet address:

<https://www.anker.com/products>

Maximum output power: 0dBm

Frequency band: 2.4G band (2.4000GHz-2.4835GHz)

Anker Innovations Limited / Room 1318-19, Hollywood Plaza, 610 Nathan Road, Mongkok, Kowloon, Hong Kong

Specifications

Specifications are subject to change without notice.

- Input: 100-240V~ 50/60Hz 0.5A
 - Audio output: 100 W
 - Size: 880 x 56 x 90 mm / 34.6 x 2.2 x 3.5 in
 - Weight (without packaging): 2.9 kg / 104 oz
 - Bluetooth version: V4.2
 - Range: 10 m / 33 ft
-

A3371 FAQ

1. Can Soundcore Infini be connected to a TV wirelessly via Bluetooth?

The soundbar can be connected to a TV with the Bluetooth feature.

2. Can all three inputs be used (three different devices connected) at the same time?

You can plug in three inputs and switch between them, but only one will play at a time.

3. Will Soundcore Infini work with an iPod that has bluetooth?

Yes.

4. Does Soundcore Infini have an audio output?

It does not. It only has Bluetooth, Optical, Coaxial, and 3.5mm audio input.

5. Can I connect additional wired speakers to Soundcore Infini?

No.

6. How do I connect to the TV using Bluetooth?

See article.

7. Can Soundcore Infini be mounted on the TV?

Yes, you can do it with 2 wall mount screws, 2 wall mount brackets, and the wall mount template.

8. How many watts does Soundcore Infini have?

The output is 100W.

9. Does an optical cable come with the package?

Yes, it comes with a 4.9 ft optical cable.

10. Is Soundcore Infini able to decode Dolby Digital 5.1?

No, it can't.

11. Is there an external compatible subwoofer?

It comes with two built-in subwoofer speakers and cannot be added to an external subwoofer.

12. Will Soundcore Infini automatically turn off?

The soundbar will automatically switch to standby mode when no audio input is received for over 30 minutes, and will wake up from standby mode when any button is pressed or source input is received.

DOWNLOAD

SoundCore Infini Soundbar A3371 User Manual – [[Download PDF](#)]
