

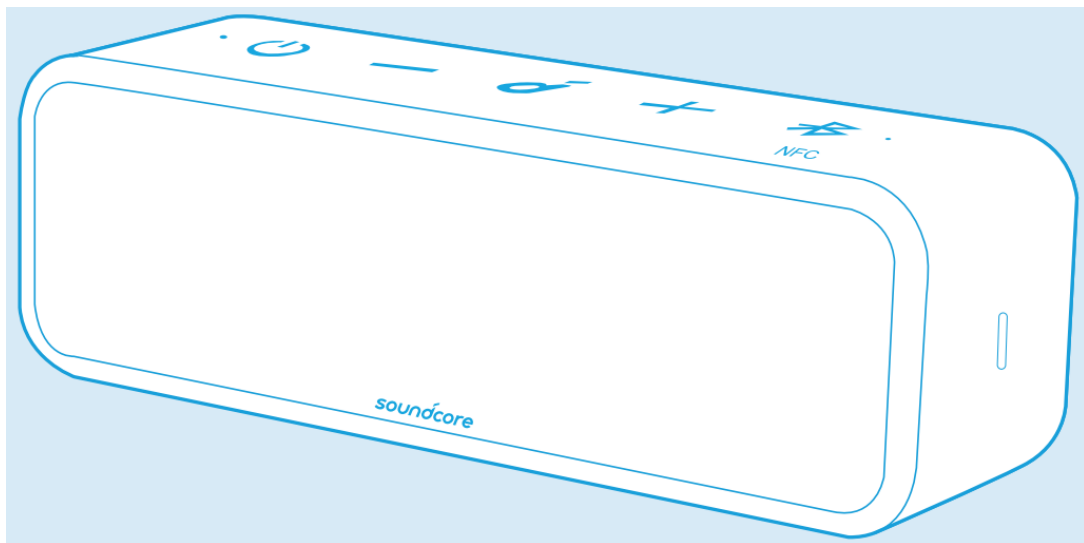

Soundcore A3125 Select 2 Portable Bluetooth Speaker User Manual

[Home](#) » [Soundcore](#) » Soundcore A3125 Select 2 Portable Bluetooth Speaker User Manual 

soundcore



Soundcore Select 2
USER MANUAL

Contents

- 1 At a Glance
- 2 Charging
- 3 Powering On/Off
- 4 Using your Soundcore Select
- 2
- 5 Soundcore App
- 6 Specifications
- 7 Documents / Resources
- 8 Related Posts

At a Glance

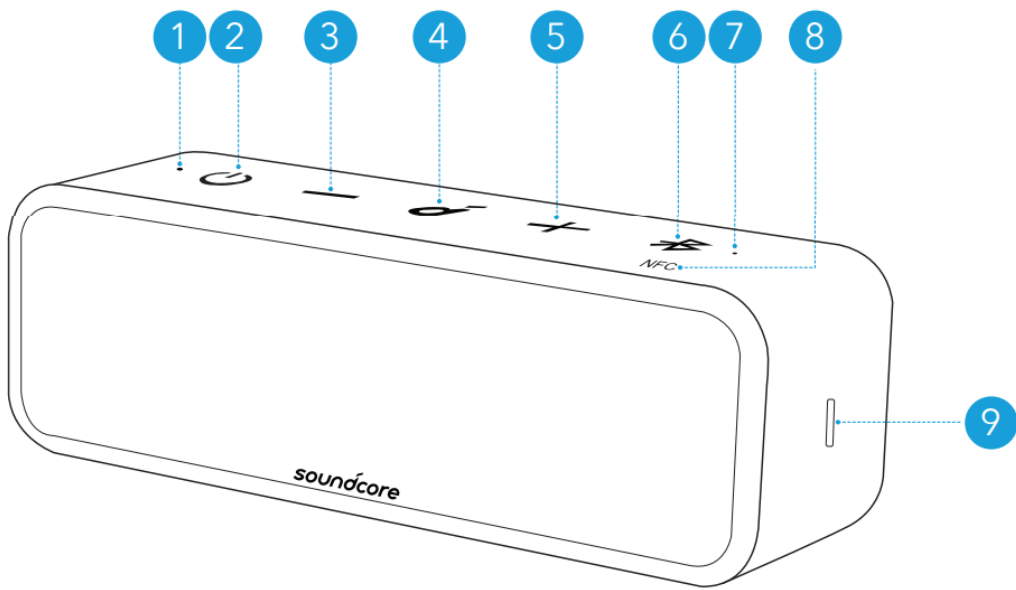

1. Power LED 2. Power button 3. Volume down button 4. Multi-function button 5. Volume up button	6. Bluetooth/PartyCast button 7. Bluetooth LED 8. NFC tag 9. USB-C charging port
-------------------------------------------------------------------------------------------------------------	-------------------------------------------------------------------------------------------

Charging



- Use the provided USB-C cable to prevent any damage.
- Fully charge this speaker before the first use to prolong the lifespan of the built-in battery.
- Disconnect this speaker from the charger when fully charged. Do not charge for extended periods.

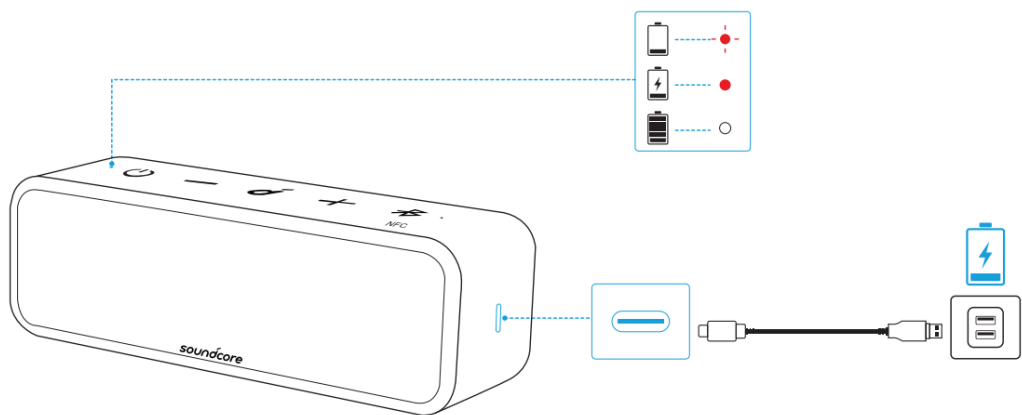

	Flashing red	Low battery
	Steady red	Being charged
	Steady white	Fully charged

Powering On/Off

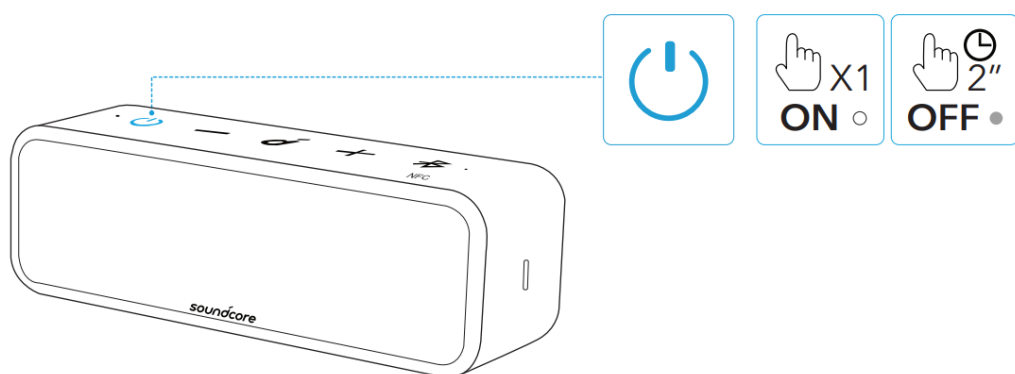

Power on		Press
Power off		Press and hold 2 seconds





- This speaker will power off automatically 30 minutes after no audio input or button inactivity.

Using your Soundcore Select 2

Bluetooth Mode

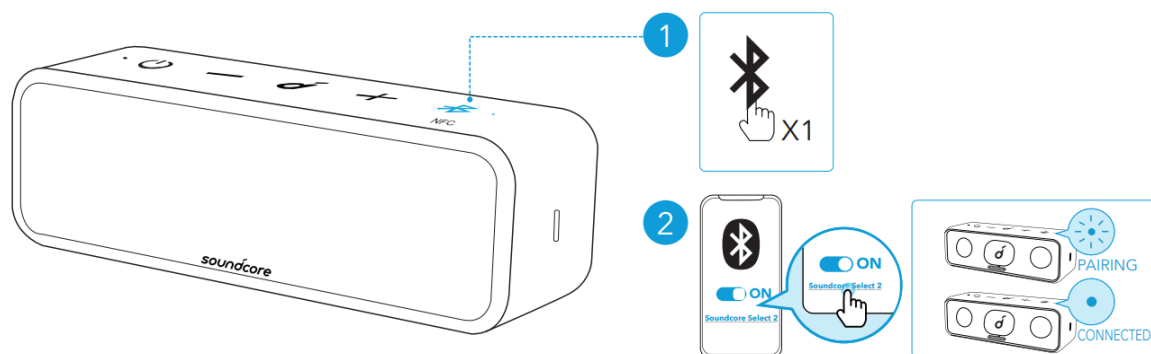
With this speaker, you can enjoy music through your Bluetooth-enabled devices.



	Press	Enter Bluetooth pairing mode
	Flashing blue	Bluetooth pairing
	Steady blue	Bluetooth connected



- **Dual Bluetooth Connection:** This speaker can pair up to 2 mobile devices via Bluetooth. To pair with another device, press the Bluetooth button to re-enter Bluetooth pairing mode.
- This speaker can only play music on one mobile device at a time. To play from another connected device, pause the currently active device first.
- Each time you power on your Soundcore speaker, it will automatically connect to your last connected device is available within the Bluetooth range. If not, press the Bluetooth button to enter Bluetooth pairing mode.

NFC Mode

If your Bluetooth device supports NFC, you can connect it with this speaker easily.

1. Enable the NFC feature on your Bluetooth device.
2. Touch the NFC tag on the speaker with the back of your Bluetooth device.
3. On your Bluetooth device, accept the pairing request with "Soundcore Select 2".

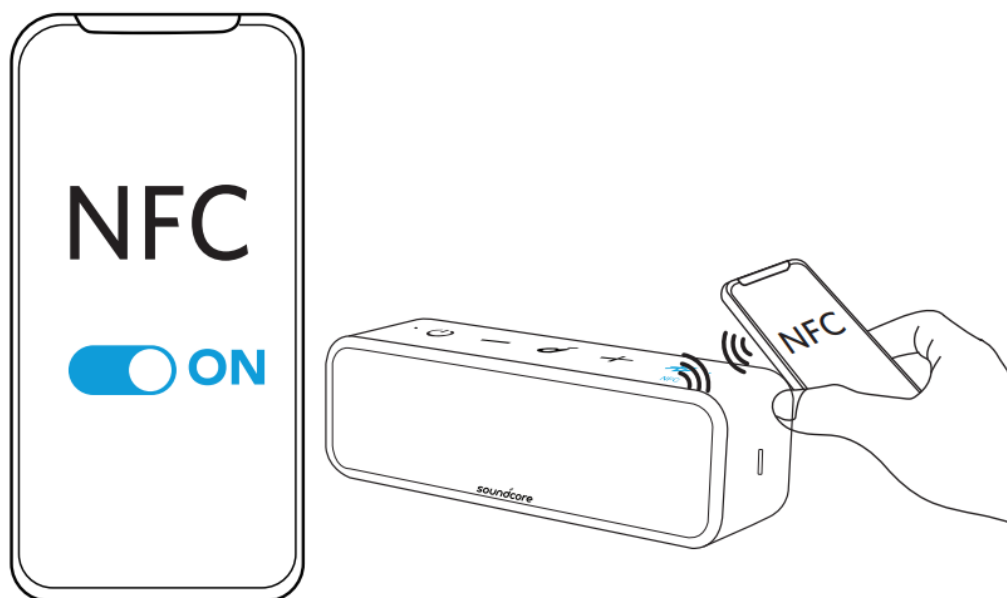

PartyCast Mode

You can wirelessly connect up to 100 identical Soundcore Select 2 speakers together.

1. Connect one Soundcore Select 2 speaker with your smartphone or tablet as the primary speaker.
2. Press and hold the Bluetooth button on the primary speaker and all desired speakers to enter pairing mode.
>>> When successfully connected, the Bluetooth LED on the primary speaker will continue flashing white, while on the secondary speakers will turn white.

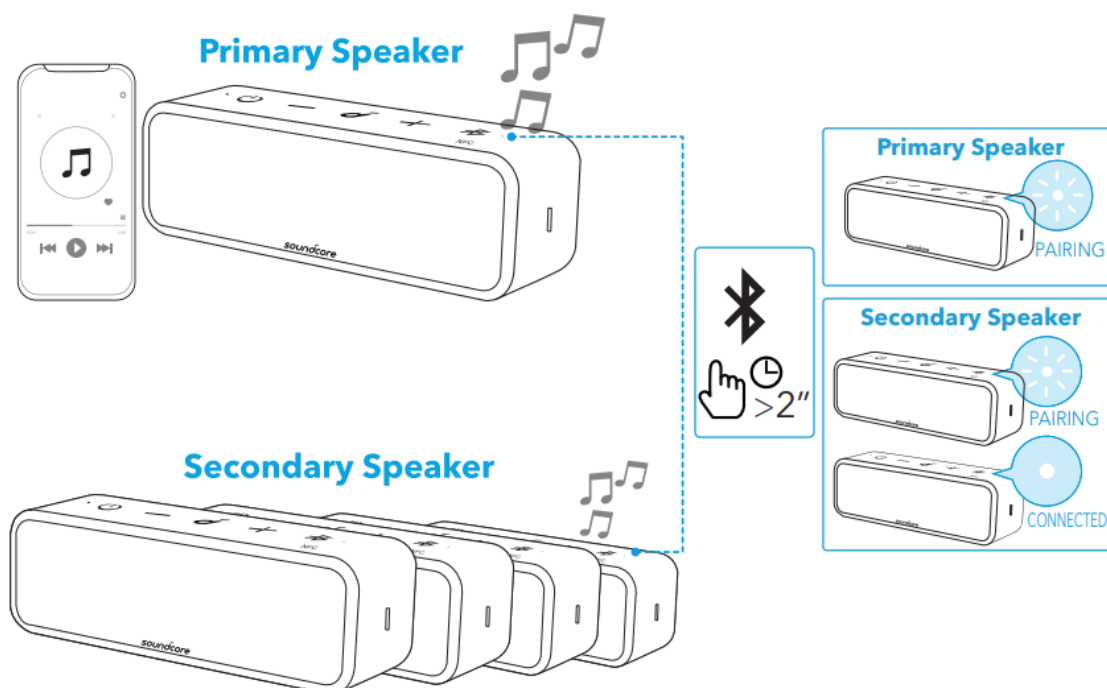

When PartyCast mode is successfully entered:





- Any secondary speaker can be switched to become the primary speaker by pressing the Bluetooth button twice and connecting to your smartphone. Any primary speaker can be switched to become the secondary speaker by pressing the Bluetooth button twice and searching for an available primary speaker.
- To exit the PartyCast mode, press and hold the Bluetooth button on any speaker for 2 seconds.

Button Controls



	Press
	Press twice
	Press thrice
-/+	



	Press	
	Press	
	Press and hold for 2 seconds	
	Press and hold for 2 seconds	



	Press and hold for 2 seconds
-------------------------------------------------------------------------------------	------------------------------

Soundcore App

Download the Soundcore App for an enhanced product experience.

- Update firmware
- Indicate battery status
- Remotely control the volume and play/pause
- Customize EQ settings
- Set Auto-power off time



Soundcore



Google Play and the Google Play logo are trademarks of Google Inc.



Apple and the Apple logo are trademarks of Apple Inc.

Specifications



Specifications are subject to change without notice

DC power input

Battery capacity

Audio output power

Charging time

Playtime (varies by volume level and music content)

Waterproof level

Bluetooth version

Bluetooth range

Documents / Resources

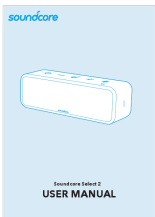

[Soundcore A3125 Select 2 Portable Bluetooth Speaker](#) [pdf] User Manual
A3125, Select 2, Portable Bluetooth Speaker