

## Contents [ [hide](#) ]

- [1 BL10 Sound Machine Wake Up Light](#)
- [2 Product Information](#)
- [3 Product Usage Instructions](#)
- [4 Product Overview](#)
- [5 Setup and Maintenance](#)
- [6 Time Setting](#)
- [7 Alarm Setting](#)
- [8 Frequently Asked Questions](#)
- [9 Documents / Resources](#)
  - [9.1 References](#)

# Sound Machine

## BL10 Sound Machine Wake Up Light



## Product Information

### Specifications:

- **Model:** BL10
- **Power Input:** DC 5V
- **Power Source:** AC Adapter (100V-240V)
- **Battery:** CR2032 cell battery (pre-installed)
- **Display:** Time and Date
- **Alarm:** Dual alarms with customizable settings
- **Sound Options:** 30 sleep sounds, 7 alarm ringtones
- **Lighting:** RGB light with sunrise simulation

## Product Usage Instructions

### Setup and Maintenance:

- **Initial Power-on:** Connect the USB C cable to the DC 5V power port and plug the AC adapter into a 100V-240V outlet.
- **Battery Backup:** Remove the insulating spacer for first use. Change the CR2032 battery when needed.
- **Product Preservation:** Keep the product on a level surface away from direct sunlight, heat, or moisture.

### Time Setting:

1. Power on the device and press the designated button to enter time setting mode.
2. Choose between 12-hour or 24-hour format using the rotary knob.
3. Set the hour and minute using the knob, then select the correct day of the week.
4. Confirm and exit time setup to save the settings.

### Alarm Setting:

1. To set Alarm 1, hold the specified button to enter hour setup, then set minutes and choose a ringtone.
2. Select alarm volume and sunrise simulation time duration.
3. Choose a schedule pattern for the alarm and confirm to finish setup.

### When Alarm Goes Off:

1. To snooze, press the designated button for an additional 9 minutes of sleep.
2. To turn off the alarm, press any button except Snooze.

### Sleep Sounds:

1. To activate sleep aid, press the specified button. Select from 30 available sleep sounds.

### CUSTOMER SERVICE

Our customer service team is standing by to assist you if you have any questions or concerns.

[SUPPOrt@apuzom.com](mailto:SUPPOrt@apuzom.com)

### Product Overview

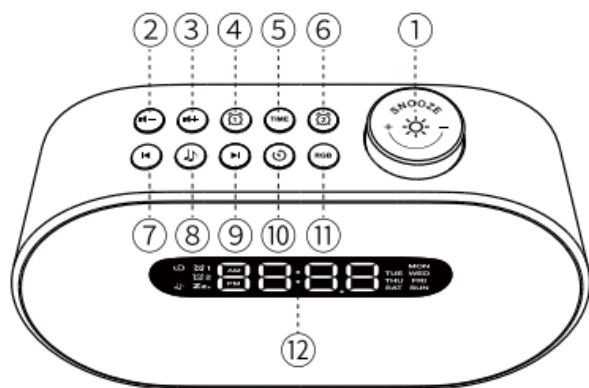

Product front

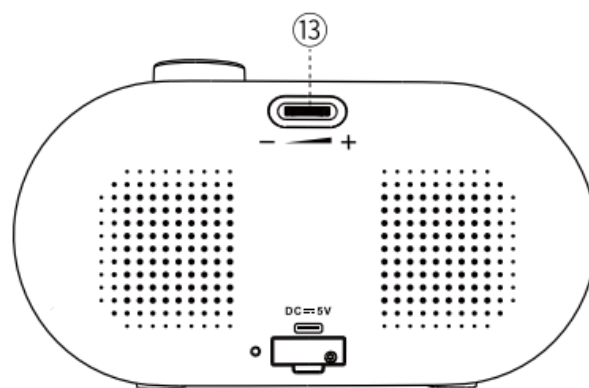

Product back

1. Snooze / Setup + and- / Nightlight / Light dimmer		
2. Volume down	3. Volume up	4. Alarm 1
5. Time	6. Alarm 2	7. Last track
8. Sleep sounds	9. Next track	10. Timer
11. RGB light	12. Time display	13. Display dimmer

### Setup and Maintenance

#### Initial Power-on

Connect the USB C cable to the DC 5V power port of the Sound machine and plug the AC adapter into a 100V-240V household outlet.

### **Battery backup**

The Sound machine alarm clock is pre-installed with a CR2032 cell battery to remain your time settings in the event of a power failure.

For first use, please remove the insulating spacer from the battery compartment.

### **Battery change**

Unscrew the battery box with a screwdriver, install a new battery with the positive side facing up, and tighten the battery box.

### **Product preservation**

Place the item on a level surface away from sources of direct sunlight or excessive heat or moisture.

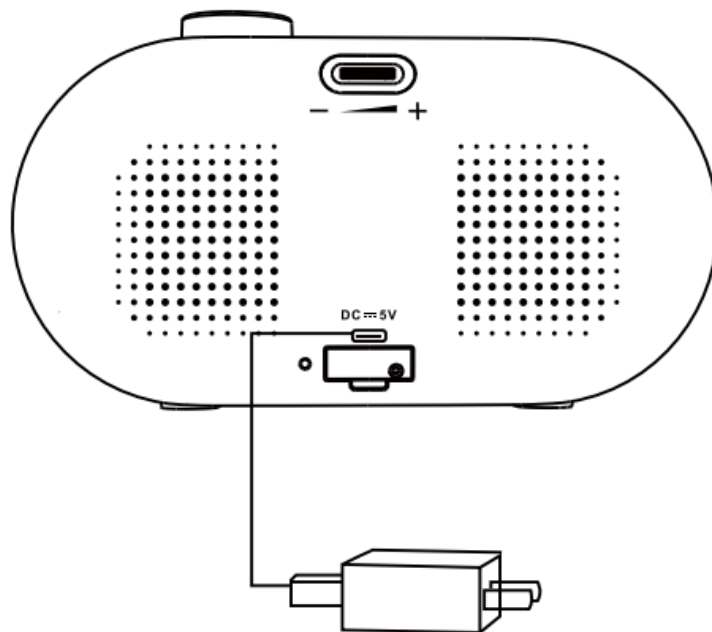

### **Time Setting**

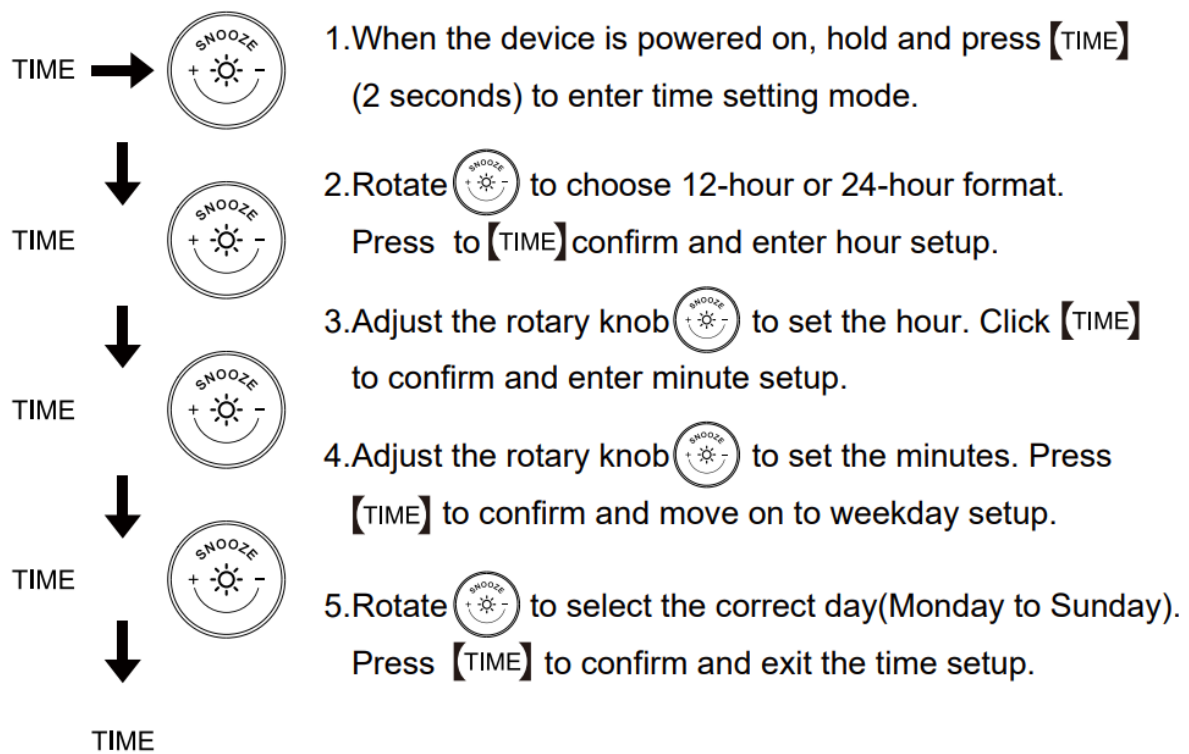

## Alarm Setting

### (Alarm 1 as example)

This Sound machine alarm clock features 2 separate alarms, so you can set up 2 different alarm times. For example, you can use Alarm 1 for weekdays and Alarm 2 for weekends.

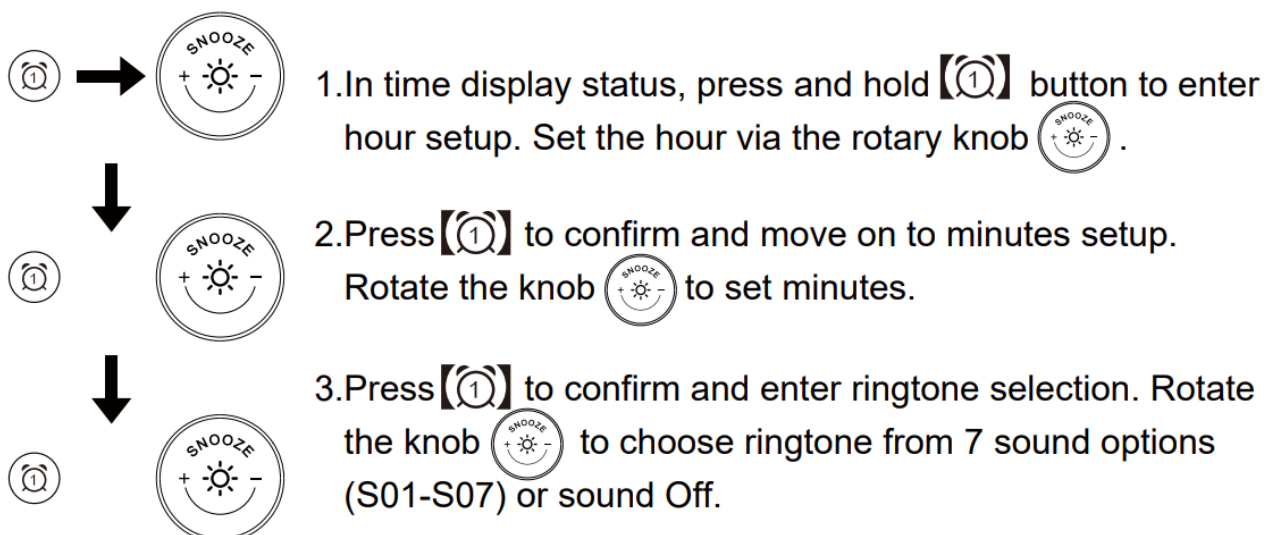

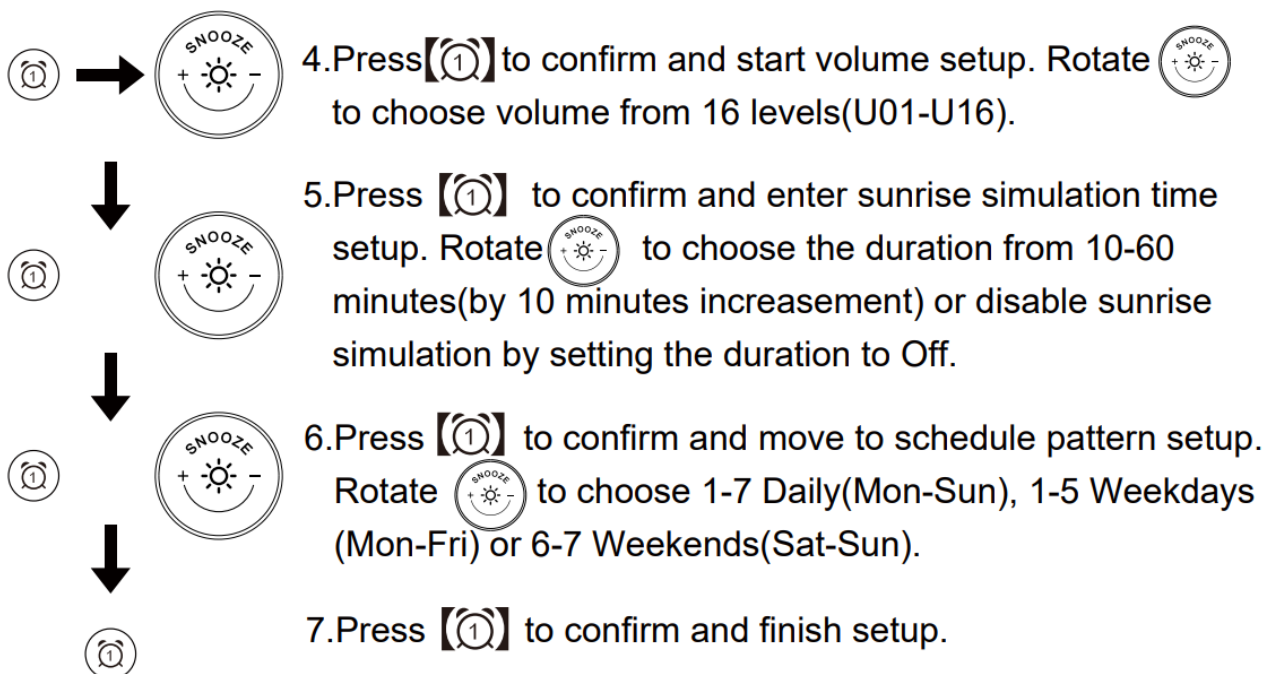

If you enable the light alarm, the wake-up light will illuminate at the preset time and simulate a natural sunrise via gradually getting brighter over 10-60 minutes and reaching the maximum brightness at the scheduled alarm time.

When alarm goes off, you can:

#### 1. Snooze alarm

Press to snooze the alarm to get another 9 minutes sleep.

\*You can snooze the alarm unlimited times.

#### 2. Turn off alarm

Press the any button except /Snooze to turn off the alarm for the day.

**Note:** The alarm will stop automatically after 9 minutes without any operation.

### Sleep Sounds

1. In time display mode, press to turn on/off sleep aid.
2. Press to select sleep sounds among 30 sound options(S01~S30).
3. Press to set sound volume(16 levels: U01~U16).





### Display Brightness

In time display mode, rotate at the back of the sound machine to adjust display

brightness from 0-100%.

## Night Light

1. Turn on/off night light
2. Switch lights

- When powered on, press  to turn on/off the night light.
- Rotate  to set light brightness(20 brightness levels: L01-L20).  
When powered on, press RGB to turn on the RGB light and cycle through one warm white light and 13 color-changing lights(C01-C14).
- Rotate  to adjust light brightness(20 brightness levels: L01-L20).
- Press and hold RGB to turn off the RGB light.
- Press  to turn on/off the RGB light(it goes to the last light selection).

## Sleep Timer

1. In time display mode, press  to turn timer on and select timer duration from 15/30/60/90/120/180 minutes settings. The screen returns time display after 5 seconds without any operation.

\*When timer is enabled, click  to check remaining time on the screen.

2. Press and hold  to turn timer off.

\*Timer remembers your last sound and volume selection when turned on again.

## WARNING

- **INGESTION HAZARD:** This product contains a button cell or coin battery.
- **DEATH** or serious injury can occur if ingested.
- A swallowed button cell or coin battery can cause Internal Chemical Burns in as little as 2 hours.
- **KEEP** new and used batteries **OUT OF REACH** of **CHILDREN**
- Seek immediate medical attention if a battery is suspected to be swallowed or

inserted inside any part of the body.

- The product contains replaceable button batteries.
- Remove and immediately recycle or dispose of used batteries in accordance with local regulations and keep out of reach of children. Do not discard batteries in household garbage or incinerate.
- Even used batteries can cause serious injury or death.
- Call your local poison control center for treatment information.
- Battery type CR2032
- Rated battery voltage: 3V
- Non-rechargeable batteries shall not be charged.
- Do not force discharge, charge, disassemble, heat above (manufacturer-specified rated temperature), or incinerate, Otherwise, injury may occur due to venting, leakage, or explosion, resulting in chemical burns.
- Batteries are installed correctly according to polarity.
- Do not mix new and old batteries, or batteries of different brands or types, such as alkaline, carbon-zinc, or rechargeable batteries.
- Remove and recycle or dispose of batteries from devices that will not be used for an extended period in accordance with local regulations.
- Always keep the battery compartment secure. If the battery compartment is not securely closed, stop using the product, remove the batteries, and keep them out of reach of children.



Made in China

## Frequently Asked Questions

### **Q: How do I change the battery in the Sound Machine Wake-Up Light?**

**A:** Unscrew the battery box, replace the CR2032 battery with the positive side up, and tighten the box securely.

### **Q: Can I disable the sunrise simulation feature?**

**A:** Yes, you can disable the sunrise simulation by setting the duration to Off during alarm setup.



# Documents / Resources

	<a href="#">Sound Machine BL10 Sound Machine Wake Up Light [pdf]</a> Instructions BL10 Sound Machine Wake Up Light, BL10, Sound Machine Wake Up Light, Machine Wake Up Light, Wake Up Light, Up Light
---	--

## References

- [User Manual](#)

Sound

Machine

BL10, BL10 Sound Machine Wake Up Light, Machine Wake Up Light, Sound Machine, Sound Machine Wake Up Light, Up Light, Wake Up Light

## Leave a comment

Your email address will not be published. Required fields are marked \*

Comment \*

Name

Email

Website

☐ Save my name, email, and website in this browser for the next time I comment.

[Post Comment](#)

## Search:

[Search](#)

[Manuals+](#) | [Upload](#) | [Deep Search](#) | [Privacy Policy](#) | [@manuals.plus](#) | [YouTube](#)

This website is an independent publication and is neither affiliated with nor endorsed by any of the trademark owners. The "Bluetooth®" word mark and logos are registered trademarks owned by Bluetooth SIG, Inc. The "Wi-Fi®" word mark and logos are registered trademarks owned by the Wi-Fi Alliance. Any use of these marks on this website does not imply any affiliation with or endorsement.