

**Contents** [[hide](#)]

- [1 SOULION R30 Plus Bluetooth Computer Speakers](#)
- [2 Specifications](#)
- [3 Usage](#)
- [4 FAQs](#)
- [5 Documents / Resources](#)
 - [5.1 References](#)

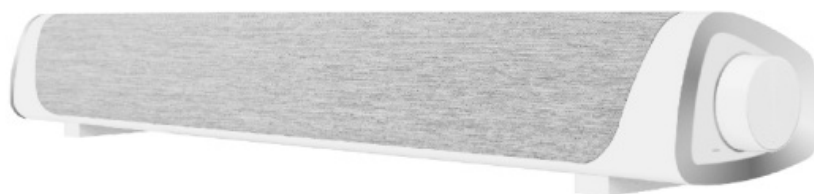

SOULION R30 Plus Bluetooth Computer Speakers



Introduction

The SOULION R30 Plus Bluetooth Computer Speakers offer a high-quality audio experience for your PC, laptop, tablet, or smartphone. These sleek, modern speakers combine vibrant sound with stylish design, making them perfect for both work and entertainment. The R30 Plus delivers clear highs, rich mids, and powerful bass, ensuring immersive sound quality for music, gaming, and movies. Equipped with Bluetooth 5.0, wired AUX connection, and USB power, the SOULION R30 Plus speakers provide flexibility and convenience for any setup.

Specifications

Speaker Unit	2INCHx 2
Power Output (RMS)	5Wx 2
Frequency Range	60Hz-20KHz
Input Sensitivity:	500mV
Separation:	ie65dB
Bluetooth Compliant	VS.3
Power Supply	USB 5V/1A
Function	USB Sound Card / Bluetooth
Product Size	W415xD78xH68mm

Usage

- **Bluetooth Connection:** Pair the speakers wirelessly with your Bluetooth-enabled devices such as smartphones, laptops, and tablets.
- **Wired Connection:** Use the provided AUX cable for a reliable wired connection with computers or audio devices without Bluetooth.
- **USB Powered:** Connect the USB cable to your computer or a USB adapter for power, making it perfect for portable setups.
- **Sound Adjustment:** Use the built-in controls to adjust volume, bass, and treble for an optimized listening experience.
- **Multimedia:** Enjoy movies, music, and games with dynamic sound quality, enhancing your entertainment experience.

Safety Tips

1. **Avoid Water Exposure:** Keep the speakers dry and avoid contact with liquids to

prevent damage.

2. **Proper Ventilation:** Do not block speaker vents. Ensure they have adequate space for airflow to avoid overheating.
3. **Avoid Overloading:** Do not exceed the recommended power output (5W per speaker). Avoid playing audio at excessively high volumes for extended periods to protect the speakers from damage.
4. **Use Proper Charging:** Always use the supplied USB cable for power to ensure safe charging and avoid potential electrical issues.
5. **Disconnect When Not in Use:** Disconnect the speakers when not in use for prolonged periods to avoid unnecessary wear on components.

Package Content

Speaker+ User Manual

Button Command:

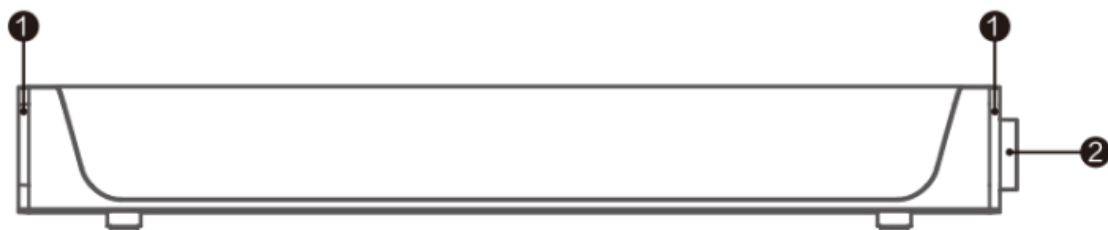

1. LED lighting effect
2. Multi-functional Button:
 - Long Press for 3 Seconds: Power ON/OFF
 - Double Click: Switch to Bluetooth/USB Sound Card Mode
 - One Click: Change RGB Lighting Colors
 - Rotary Knob: Volume+/-
3. Audio Cable (USS-Powered Cable)

How To Setup:

PC, Laptops, Macbook Pro/Air

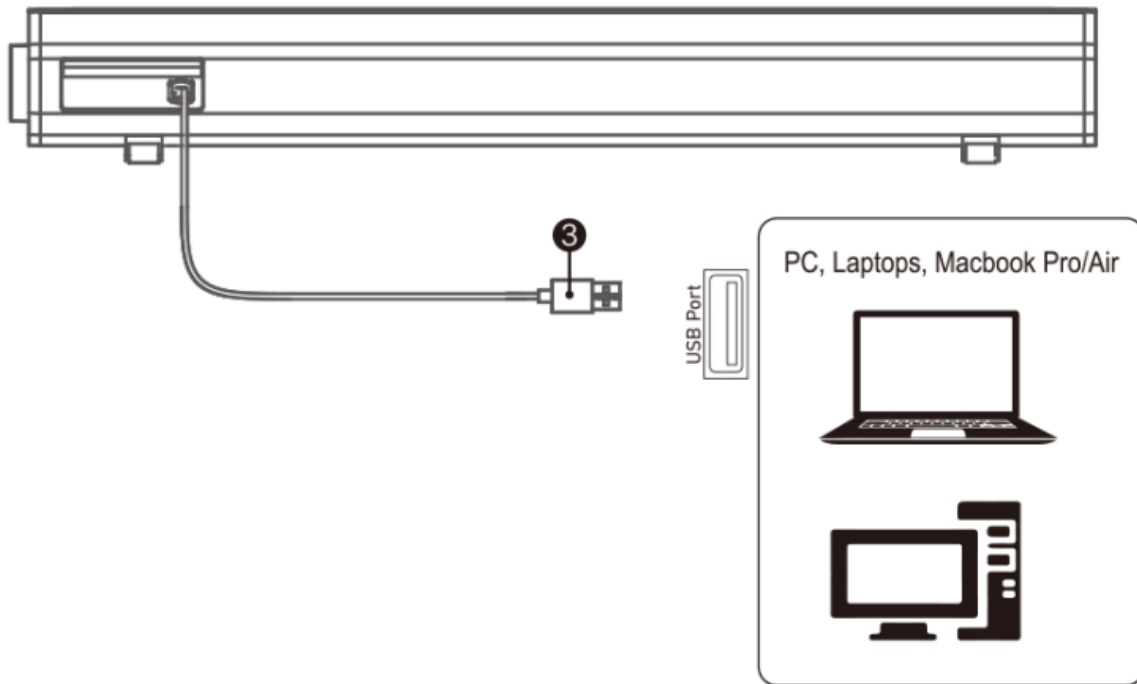

1. Plug the USB connector into USB side ports on the computers.
2. Fix the settings: control panel/system preference – sound settings- choose R30 Plus as audio output – save changes.

How To Setup

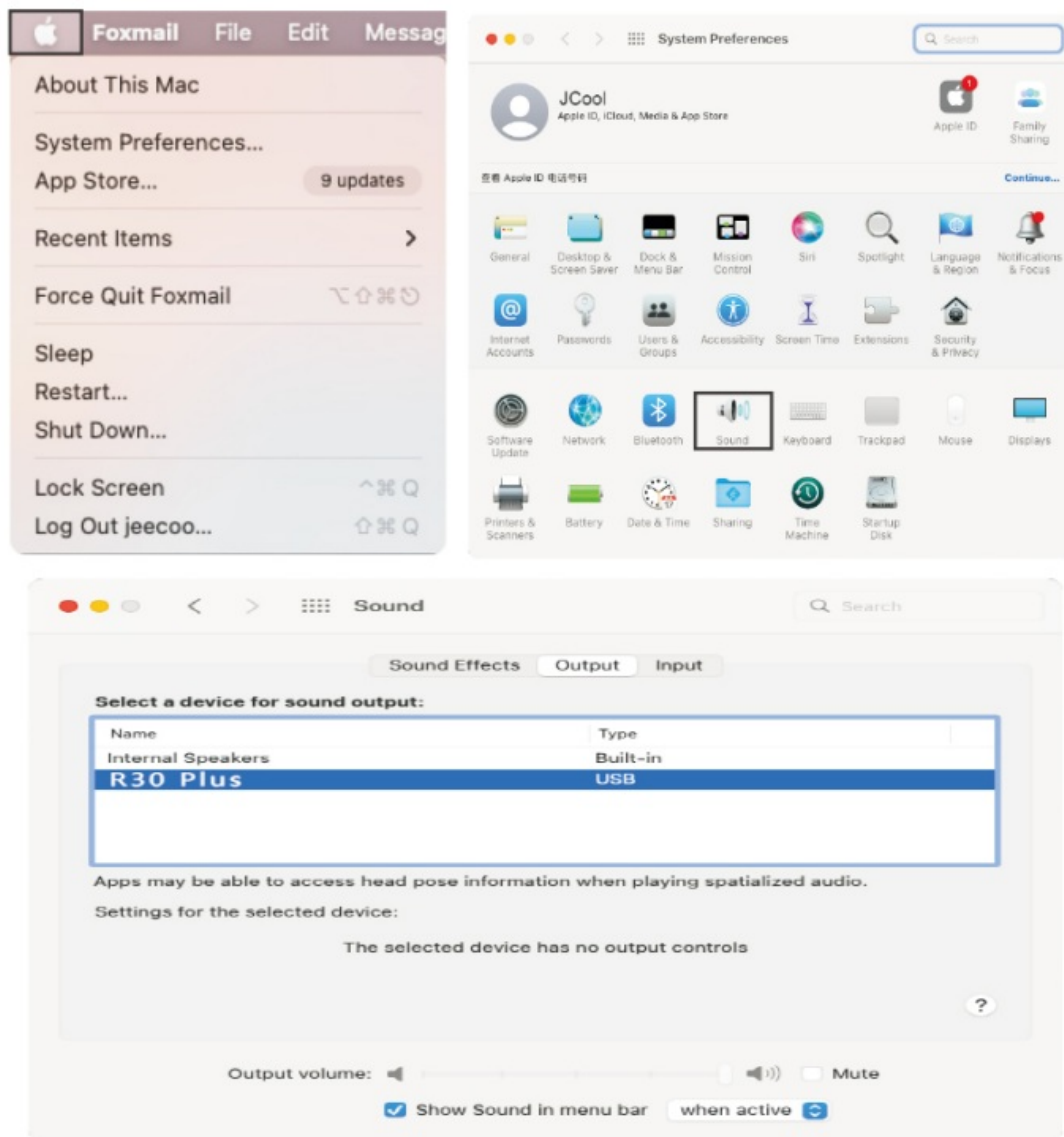

Cellphone, iPad, and Mobile Devices (Bluetooth Mode)

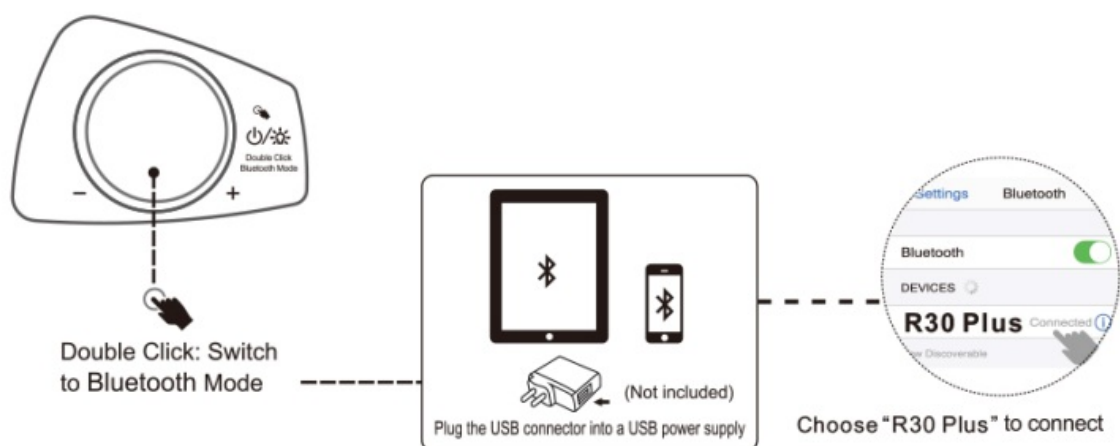

1. Plug the USB connector into a USB power supply.
2. Double click the button to switch Bluetooth mode.
3. Turn On Bluetooth on your cellphones, search and select device name "R30 Plus", connect it and pair.



Note: This speaker adopts USB decoding. If the speaker is connected to your computer and there is no sound when playing music (not in silent mode), please go to the “Manage Audio Devices” of the computer control panel to find the audio device and switch it.



MANUFACTURER

- NINGBO NINHUASCM CO., LTD
- Add: 21 JIANGXIA ST., NINGBO 315000 P.R. of CHINA
- Web: www.soulion.net
- Email: support@soulion.net
- www.facebook.com/Soulion.fans
-  @SOULION_ OFFICIAL

FAQs

Q1: Can I use the SOULION R30 Plus speakers with my TV?

A1: Yes, you can connect the speakers to your TV using a 3.5mm AUX cable if your TV has an AUX output. Bluetooth connection may also be supported depending on your TV model.

Q2: Are the SOULION R30 Plus speakers compatible with Mac?

A2: Yes, the R30 Plus Bluetooth speakers are compatible with both Windows and Mac computers. Simply connect them via Bluetooth or AUX cable.

Q3: Do the speakers have a microphone?

A3: No, the SOULION R30 Plus speakers do not come with an integrated microphone. They are designed for audio output only.

Documents / Resources

	SOULION R30 Plus Bluetooth Computer Speakers [pdf] User Manual R30 Plus, R30 Plus Bluetooth Computer Speakers, R30 Plus, Bluetooth Computer Speakers, Computer Speakers, Speakers
---	---

References

- [User Manual](#)

SOULION

Bluetooth Computer Speakers, Computer Speakers, R30 Plus, R30 Plus Bluetooth Computer Speakers, SOULION, Speakers

Leave a comment

Your email address will not be published. Required fields are marked *

Comment *

Name

Email

Website

☐ Save my name, email, and website in this browser for the next time I comment.

Post Comment

Search:

e.g. whirlpool wrf535swhz

Search

[Manuals+](#) | [Upload](#) | [Deep Search](#) | [Privacy Policy](#) | [@manuals.plus](#) | [YouTube](#)

This website is an independent publication and is neither affiliated with nor endorsed by any of the trademark owners. The "Bluetooth®" word mark and logos are registered trademarks owned by Bluetooth SIG, Inc. The "Wi-Fi®" word mark and logos are registered trademarks owned by the Wi-Fi Alliance. Any use of these marks on this website does not imply any affiliation with or endorsement.