

Soothielec KH156M Noise Canceling Bluetooth Headset



# Soothielec KH156M Noise Canceling Bluetooth Headset User Manual

[Home](#) » [Soothielec](#) » Soothielec KH156M Noise Canceling Bluetooth Headset User Manual 

## Contents

- 1 Soothielec KH156M Noise Canceling Bluetooth Headset
- 2 Product Specifications
- 3 FAQ
- 4 Product Overview
- 5 Packing List
- 6 Basic Operation
- 7 Troubleshooting
- 8 How to Restore Factory Settings
- 9 Fix Microphone Issue
- 10 Charging
- 11 LED Indicator
- 12 Product Specification
- 13 FCC STATEMENT
- 14 Documents / Resources
  - 14.1 References

# Soothielec

Soothielec KH156M Noise Canceling Bluetooth Headset



## Product Specifications

- **Model:** KH156M
- Noise Canceling Bluetooth Headset
- Mute Button
- Multi-Function Button (MFB)
- Volume Adjust Knob
- LED Indicator
- ON/OFF Button
- USB-C Charging Port

## Product Overview

The Noise Canceling Bluetooth Headset model KH156M comes with a charging base and a Bluetooth dongle. The headset features a Mute Button, Multi-Function Button, Volume Adjust Knob, LED Indicator, and ON/OFF Button for convenient operation.

## Basic Operation

The basic operations of the KH156M headset include powering on/off, adjusting volume, controlling music playback, answering/rejecting calls, redialing calls, switching audio, activating voice assistant, and muting/unmuting.

### Power On/Off

To power on, long press the ON/OFF button for 3 seconds. To power off, long press the ON/OFF button for 5 seconds.

### Volume Adjustment

Rotate the volume and adjust the knob clockwise to increase volume and counterclockwise to decrease volume.

## Bluetooth Pairing and Connection

### With Cell Phone

1. In off status, long press the ON/OFF button for 3 seconds to power on and enter pairing mode.
2. Search and select KH156M on your phone's Bluetooth list to pair and connect.

### With PC

1. In off status, long press the ON/OFF button for 3 seconds to power on and enter pairing mode.
2. In your PC's settings, add the Bluetooth device KH156M to establish a connection.

## FAQ

- **Q:** How do I delete pairing records?

In power-on status, simultaneously long press both the MFB and ON/OFF buttons for about 5 seconds to delete pairing records.

- **Q:** What should I do if my computer asks for a Bluetooth driver?

If your computer asks for a Bluetooth driver during pairing with the headset, please contact your computer manufacturer for assistance.

## Product Overview

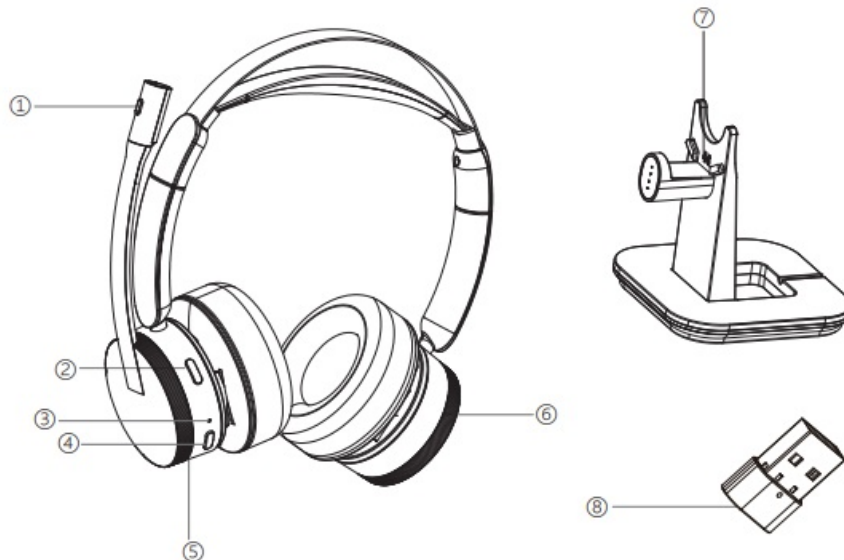

1. Mute Button
2. Multi-Function Button (MFB)
3. LED Indicator
4. ON/OFF Button
5. USB-C Charging Port
6. Volume Adjust Knob

7. Charging Base
8. Bluetooth Dongle

## Packing List

- A. Bluetooth Headset KH156M x 1
- B. Charging Base x 1
- C. Bluetooth Dongle x 1
- D. USB-C Charging Cable x 1
- E. User Manual x 1



## Basic Operation

| Button             | Function      | Operation Instruction   |
|--------------------|---------------|---|
| ON/OFF             | Power On      | In off status, long press for 3 seconds with prompt "Power ON". KH156 M will enter paring mode automatically. |
|                    | Power Off     | In on status, long press for 5 seconds with prompt " Power Off".  |
|                    | Next Song     | Double click ON/OFF button, while playing music.  |
|                    | Previous Song | Three click ON/OFF button, while playing music.   |
| Volume Adjust Knob | Volume Up     | Rotate the knob clockwise when talking or playing music. ( up to maximum, it will prompt " Di")               |
|                    |               |   |

|                |                        |  |
|----------------|------------------------|--|
|                | Volume Down            | Rotate the knob counterclockwise when talking or playing music. ( up to minimum, it will prompt “ Di”) |
| MFB            | Play/Pause             | Short press when play music.   |
|                | Answer a Call          | When a call comes, short press to answer.  |
|                | Reject a Call          | When a call comes, long press for 1 second to reject a call.   |
|                | Hang up a Call         | During a call, short press to hang up.   |
|                | Redial a Call          | In connected/standby/playing music status, double press MFB to dial the last call                      |
|                | Audio Switch           | During a call, long press for 1-2 seconds to switch between Bluetooth headset and cell phone           |
|                | Voice Assistant        | Long press MFB for 1-2 seconds then release.   |
| Mute Button    | Mute/Unmute            | During a call, short press to mute, and press again to cancel mute.                                    |
| MFB and ON/OFF | Delete Pairing Records | In power-on status, long press about 5 seconds at the same time to delete records.                     |

### Bluetooth Pairing and Connect with Cell Phone

- In off status, Long press the ON/OFF button for 3 seconds to power on, KH156M will enter pairing mode automatically( the LED indicator will flash red and blue), the headset will prompt “Power ON”, and then prompt

“Paring”.

- Search and click the “KH156M” on the Bluetooth list of your phone, the headset will prompt “Paired” and then prompt “Your headset is connected” (the LED indicator will disappear and show blue every 10 seconds). Now, you can listen to music through the headset



## Bluetooth Pairing and Connect with PC

### Pair with a Computer Via Bluetooth

1. In off status, long press the ON/OFF button for 3 seconds to power on, KH156M will enter pairing mode automatically( the LED indicator will flash red and blue), the headset will prompt “Power ON”, and then prompt “Paring
2. On your PC, select Start > Settings > Bluetooth & other devices > Add Bluetooth or other devices> Bluetooth > Click on the model number [KH156M] of your device. A window will pop up indicating the Bluetooth connection is complete. You will hear “Your headset is connected” at the same time. If your computer asks for a Bluetooth driver, contact your computer manufacturer

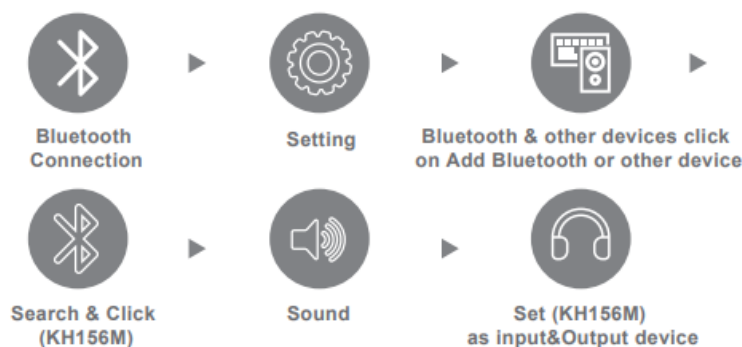

### KH156M & Computer Adapter Pairing

1. Initial pairing KH156M with Dongle, please disable the Bluetooth function on your phone/ computer previously connected with KH156M
2. Plug the USB Dongle into the USB port of our computer and wait for your computer to recognize it. The LED indicator on the USB Dongle flashes blue.

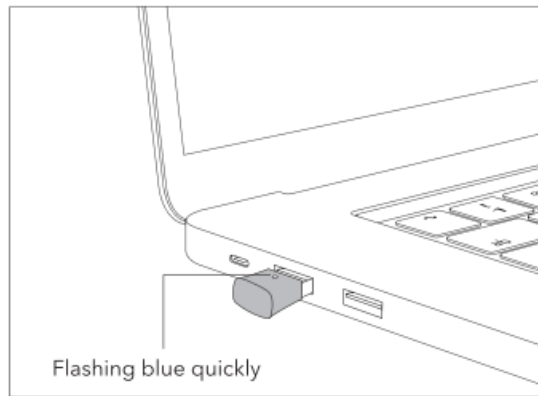

3. In off status, long press ON/OFF button for 3 seconds to power on, KH156M will enter pairing mode automatically( the LED indicator will flash red and blue), the headset will prompt “ Power ON”, and then prompt “ Paring”.
4. Pairing is successful when you hear” your headset is connected” and the LED indicator on the USB Dongle is solid blue. This pairing process can take up to 10 seconds

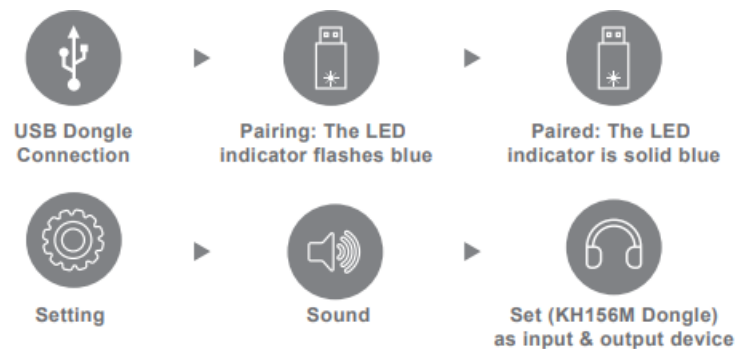

## Zoom & Other Meeting Apps Settings

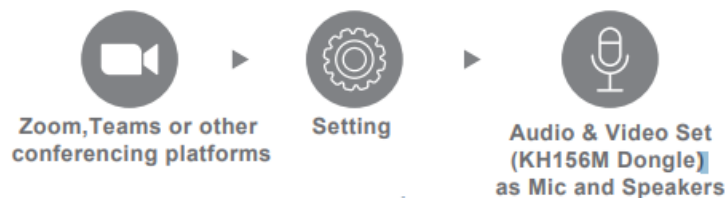

## Note

1. KH156M can remember the dongle paired previously. After being paired successfully for the first time, make sure the Bluetooth Dongle is plugged in the computer first and turn on KH156M.
2. Your KH156M headset can be used with a dongle and your phone together. Make sure the dongle is plugged into your computer and the Bluetooth function on your phone is enabled before turning on KH156M. Music only will be played via the computer. You phone or computer can answer calls.

## Troubleshooting

- Q: The Bluetooth Dongle won't turn on after plugging into the USB port.
- A: Try another USB port. After being plugged in, the Dongle will power on automatically and the indicator flashes blue quickly.
- Q: The Bluetooth Dongle doesn't pair with KH156M.

- A: Please make sure the Bluetooth Dongle is in pairing mode and KH156M is in auto re-pairing mode, and wait for them to pair automatically.
- Q: The Bluetooth Dongle won't auto-reconnect with KH156M.
- A: When the headset is charged ( via cable directly or via charging stand). It will lose connection, it is designed to protect the headset. So after charging, the headset is in off status and won't reconnect with Bluetooth Dongle. You need to turn off the headset and turn it on again.
- Q: Unable to play music after connecting with KH156M.
- A: Check if your headset is used with Dongle and your phone/computer at the same time. If yes, music can be played via the Dongle only.

## Connection with Two Devices

- Two devices that connected to KH156M are divided into two sets: Device A and Device B.
- In off status, long press the ON/OFF button for 3 seconds to power on, and KH156M will enter pairing mode automatically( the LED indicator will flash red and blue), the headset will prompt "Power ON", and then prompt "Paring".
- Turn on the Bluetooth of device A and search for "KH156M", then click to connect. Be sure device A is connected successfully, turn off the Bluetooth of device A and KH156M will enter pairing mode again.
- Use device B to connect with KH156M (the same steps as connecting device A). Be sure device B is connected successfully, turn on the Bluetooth of device A and click KH156M to connect. (Some devices may have the automatic connection function).



## Please note

- Music only can be played through one phone while connecting with two phones. If you want to play music from another phone, you need to pause or close the music of phone you are using. The same operation during talking status.

## How to Restore Factory Settings

1. Disconnect from the device.
2. Delete the Bluetooth device information of the headset from your device.
3. Press and hold the MFB button and the "ON/OFF" button simultaneously for at least 5 seconds.
4. The initialization is complete when the light indicator (purple) flashes once.
5. Pair the headset with your computer again.

## Note:



After initialization, the headset will return to the factory settings and all Bluetooth pairing information will be deleted.

## **Fix Microphone Issue**

If the KH156M headset microphone has no sound after paired KH156M to a computer via USB Dongle, please follow the steps below:

1. Make sure the KH156M headset and dongle are paired successfully(the dongle display light is solid blue) If pairing is not successful, please try the steps below:
  1. Reset the headset (please refer to the reset section ).
  2. Unplug the dongle and plug it into another USB port
2. After the KH156M headset and dongle are paired successfully, please follow the steps below:
  1. Right-click the Speakers icon at the bottom right, then click "Open Sound settings".
  2. Make sure that [KH156M dongle] has been selected as both the output and input device. Then close Settings

**If there is still no sound, the microphone of the headset may be disabled or [KH156M dongle] is not set as the default device on your computer.**

1. Right-click the Speakers icon at the bottom right, then click "Sound "
2. Click "Recording" and "Playback", then set [KH156M dongle] as the default device and make sure it is enabled.

## **Make sure apps have access to the microphone**

If your microphone isn't detected, you may need to give your app permission to use it. (Take Windows 10 as an example).

1. To let apps access the microphone, select Start, then select Settings> Privacy> Microphone. Select Change, then turn on Allow apps to access your microphone.
2. After allowing access to the microphone, you can choose which Microsoft Store apps can access these features under Choose which Microsoft Store apps can access your microphone, and give access to non-Microsoft-Store desktop apps by ensuring that the switch beneath Allow desktop apps to access your microphone is set to On.

**Make sure the [KH156M Dongle] is set as a microphone and speaker device. (Take Skype as an example)**

1. Open Skype and choose settings.
2. In Audio & Video, set [KH156M dongle] as Microphone and Speakers. If you connect the computer and the headset via Bluetooth instead of the dongle, please follow above instructions also. And if there are any issues, please contact: [support@soothielec.com](mailto:support@soothielec.com)

## **Charging**

- Please charge the KH156M when the Red LED flashes.
- Charging time is about 2 hours. When it is charged, the LED keeps solid red.
- When it is fully charged, the Solid Red LED turns off and the Blue Led turns on.

## Two ways of Charging

1. Charge KH156M through the charging base( the base without battery and needs to be plugged with the USB-C cable )

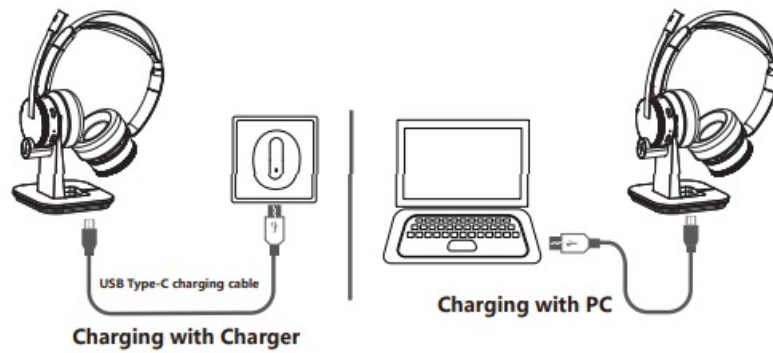

2. Charges KH156M directly through the USB-C charging cable

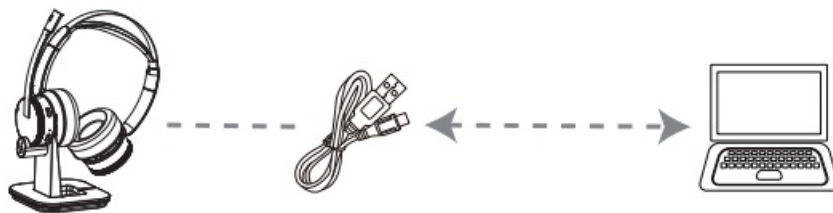

### Please note:

If you don't use the headset for long time, please keep charging it every 2 months at least

## LED Indicator

| <b>Mode</b>                   | <b>LED Indicator</b>                   |
|-------------------------------|--|
| <b>Power on</b>               | Blue LED flashes 2 times               |
| <b>Power off</b>              | Red LED flashes 2 times                |
| <b>Pairing mode</b>           | Red & Blue LED flash alternately       |
| <b>Connected standby mode</b> | Blue LED flashes once every 10 seconds |
| <b>Playing Music</b>          | Blue LED flashes once every 10 seconds |
| <b>Talking</b>                | Blue LED flashes once every 10 seconds |
| <b>Delete pairing record</b>  | Red & Blue LED are on for 1 time       |
| <b>Charging</b>               | Solid Red LED                          |
| <b>Full charged</b>           | Solid Blue LED                         |
| <b>Low battery</b>            | Red LED flashes                        |

## Voice Prompt

|                            |                               |
|----------------------------|-------------------------------|
| <b>Power on</b>            | Power on                      |
| <b>Enter paring mode</b>   | Pairing                       |
| <b>Pair successfully</b>   | Paired                        |
| <b>Connected</b>           | Your headset is connected     |
| <b>Disconnect</b>          | Your headset is disconnected  |
| <b>Power off</b>           | Power off                     |
| <b>Microphone mute on</b>  | mute on                       |
| <b>Microphone mute off</b> | mute off                      |
| <b>Low battery</b>         | Battery Low (every 3 minutes) |

## Product Specification

|                     |                                   |
|---------------------|-----------------------------------|
| Bluetooth Version   | Bluetooth V5.2                    |
| Frequency Range     | 2.402-2.480GHz                    |
| Bluetooth Protocols | HSP HFP A2DP AVRCP                |
| CODEC               | AAC SBC aptX aptX-HD aptX Adaptiv |

|                    |   |
|--------------------|---|
| Bluetooth Chipset  | QCC3040                                   |
| ENC                | >25db 200-4000Hz                          |
| Operation Range    | 10 meters                                 |
| Music Time         | About 30 hours ( 70% Volume )             |
| Talk Rime          | About 25 hours ( 70% Volume )             |
| Battery Type       | 3.7V, 450mAh, Lithium ion polymer battery |
| Charging Time      | About 2 hours                             |
| Work Temperature   | -10—55℃                                   |
| Headset Dimension  | 187*176*68mm                              |
| Base Dimension     | 105.5*100*104.5mm                         |
| Headset Net Weight | About 190.5g                              |
| Base Net Weight    | About 176g                                |

## Attention and Q & A

- How to reconnect and operate when failed to reconnect

When“KH156M” connects with your mobile phone successfully at the first time, it will search and reconnect the paired device automatically when powered on, If failed, please clear the pairing records, then connect your phone again.

- How to delete paired records?

In power-on status, long press the MFB and ON/Off Button for 5 seconds to clear the pairing record. After deleting, the headset will not connect devices automatically.

- What's the password for pairing?

Some connection devices require a password for pairing, please try 0000 8888 1111 or 1234. If all can't work, please contact us: [support@soothielec.com](mailto:support@soothielec.com)

- What devices could charge for the headphones?

Any car charger, power bank, PC etc. which meets DC 5V, charging current of more than 500mA could be charged for KH156M.

- What to do if can not power or are dead?

You can try charging reset by pressing the multi-function button when charging to reset. Or you can try to delete paired records, long press the MFB and ON/Off Button for 5 seconds to clear the pairing record. If all can't work, please contact us: [support@soothielec.com](mailto:support@soothielec.com)

- Why the headphones power off automatically?

KH156M will power off under standby mode for over 10 minutes, or if the battery voltage is less than 3.1V.

## FCC STATEMENT

### FCC Warning

This device complies with part 15 of the FCC Rules. Operation is subject to the following two conditions:

1. This device may not cause harmful interference, and
2. this device must accept any interference received, including interference that may cause undesired operation.

Any Changes or modifications not expressly approved by the party responsible for compliance could void the user's authority to operate the equipment.

Note: This equipment has been tested and found to comply with the limits for a Class B digital device, pursuant to part 15 of the FCC Rules. These limits are designed to provide reasonable protection against harmful interference in a residential installation. This equipment generates uses and can radiate radio frequency energy and, if not installed and used in accordance with the instructions, may cause harmful interference to radio communications. However, there is no guarantee that interference will not occur in a particular installation. If this equipment does cause harmful interference to radio or television reception, which can be determined by turning the equipment off and on, the user is encouraged to try to correct the interference by one or more of the following measures:

- Reorient or relocate the receiving antenna.
- Increase the separation between the equipment and the receiver.
- Connect the equipment to an outlet on a circuit different from that to which the receiver is connected.
- Consult the dealer or an experienced radio/TV technician for help

The device has been evaluated to meet general RF exposure requirements. The device can be used in portable exposure conditions without restriction

### We'd love to help!

If you have any problems setting up or using our KH156M Bluetooth headset, please contact us by email at: [support@soothielec.com](mailto:support@soothielec.com) Please read this manual carefully before using the product and keep it properly. Alternatively, solutions to common problems can be found in the Attentions and Q&A section.

## Documents / Resources

|   |  |
|---|--|
|  | <p><a href="#">Soothielec KH156M Noise Canceling Bluetooth Headset</a> [pdf] User Manual</p> <p>KH156M, KH156M Noise Canceling Bluetooth Headset, Noise Canceling Bluetooth Headset, C<br/> anceling Bluetooth Headset, Bluetooth Headset, Headset</p> |
|---|--|

## References

- [User Manual](#)

### [Manuals+.](#) [Privacy Policy](#)

This website is an independent publication and is neither affiliated with nor endorsed by any of the trademark owners. The "Bluetooth®" word mark and logos are registered trademarks owned by Bluetooth SIG, Inc. The "Wi-Fi®" word mark and logos are registered trademarks owned by the Wi-Fi Alliance. Any use of these marks on this website does not imply any affiliation with or endorsement.