



SONY XS-XB1621C 2-Way Component Speaker System Instructions

[Home](#) » [Sony](#) » SONY XS-XB1621C 2-Way Component Speaker System Instructions 

SONY®

2-Way Component
Speaker System
XS-162ES
User Manual

Contents

- [1 Dimensions](#)
- [2 Precautions](#)
- [3 Specifications](#)
- [4 Mounting](#)
- [5 Woofer](#)
- [6 Passive crossover network](#)
- [7 Connections](#)
- [8 Documents / Resources](#)
 - [8.1 References](#)
- [9 Related Posts](#)

Dimensions

Tweeter

Unit: mm (in)

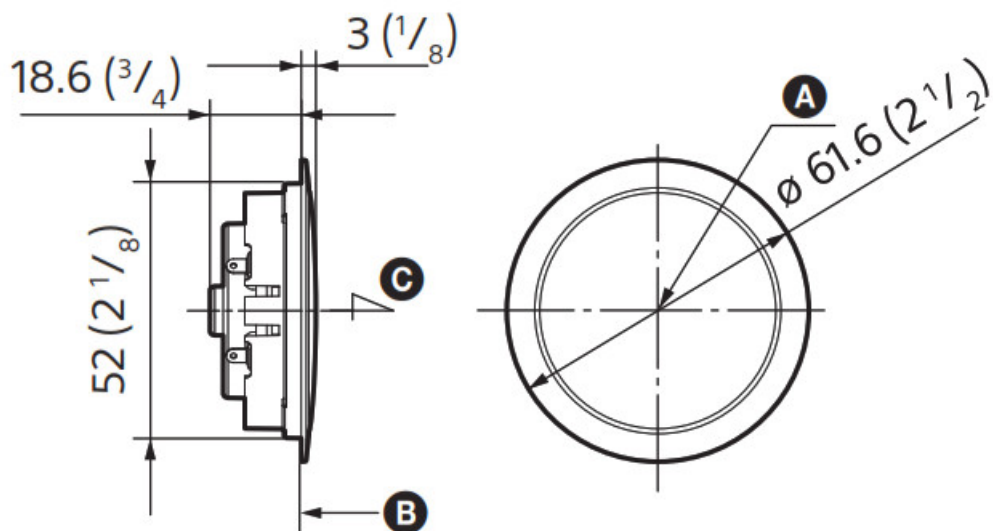

- A. Reference Point
- B. Reference Plane
- C. Reference Axis

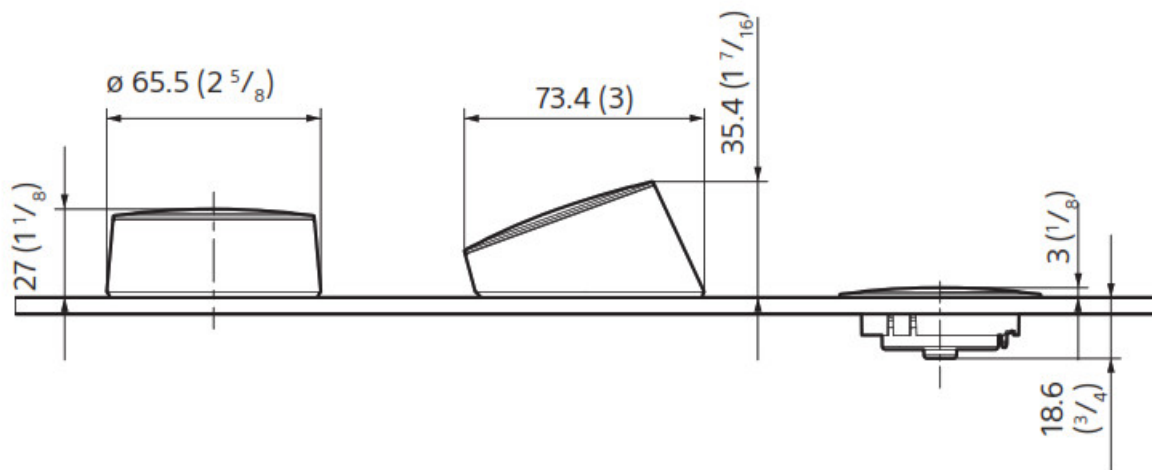

* Depending on the attachment location, the dimension value may differ.

Woofer

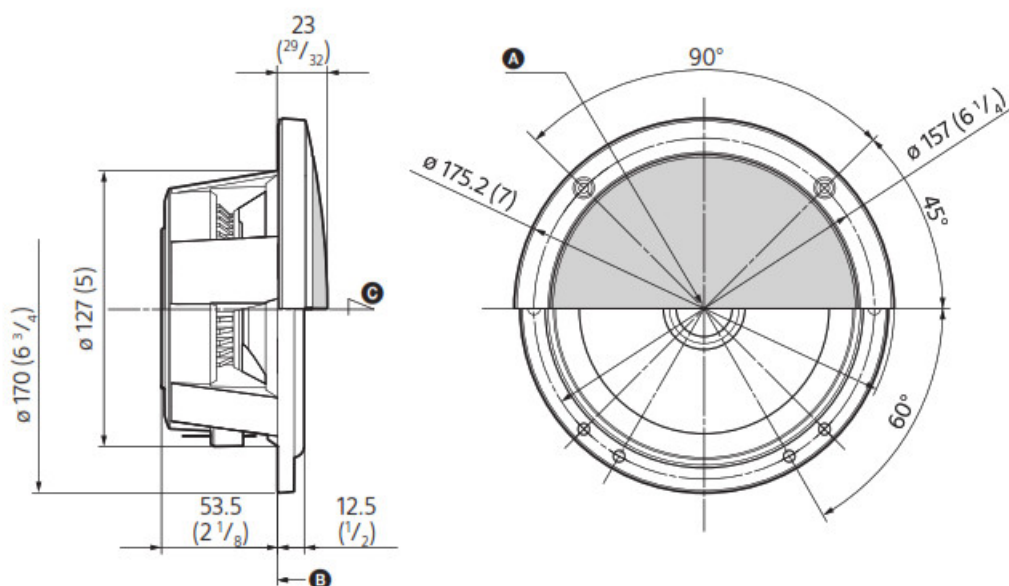

- A. Reference Point
- B. Reference Plane
- C. Reference Axis

Passive crossover network

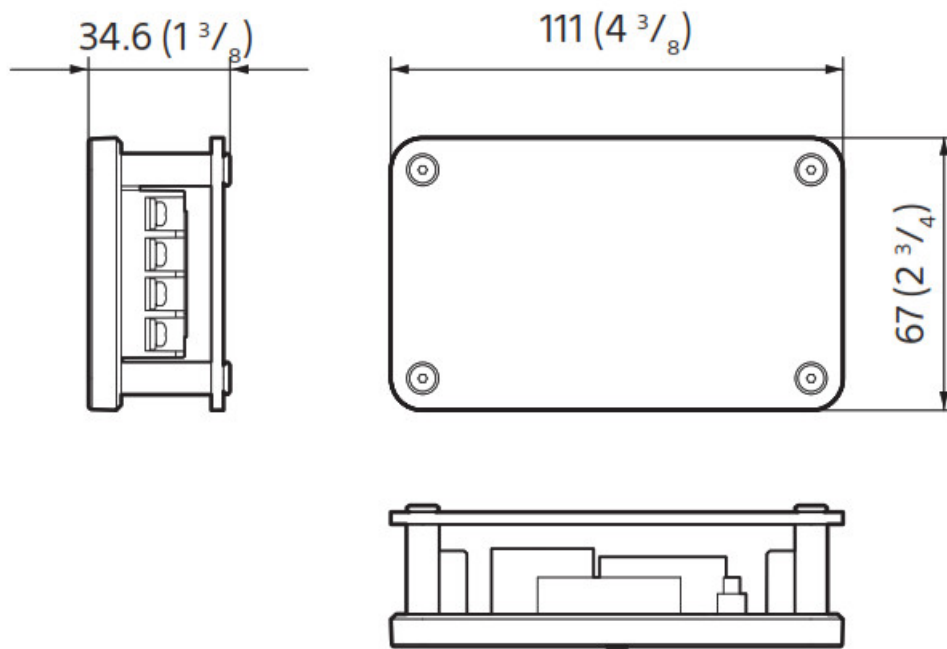

Notice for customers: the following information is only applicable to equipment sold in countries applying EU directives.

This product has been manufactured by or on behalf of Sony Corporation.

EU Importer: Sony Europe B.V.

Inquiries to the EU Importer or related to product compliance in Europe should be sent to the manufacturer's authorized representative, Sony Belgium, bijkantoor van Sony Europe B.V., Da Vincilaan 7-D1, 1930 Zaventem, Belgium.



Disposal of old electrical & electronic equipment (applicable in the European Union and other countries with separate collection systems)

This symbol on the product or on its packaging indicates that this product shall not be treated as household waste. Instead it shall be handed over to the appropriate collection point for the recycling of electrical and electronic equipment. By ensuring that this product is disposed of correctly, you will help to prevent potential negative consequences for the environment and human health, which could be caused by inappropriate waste handling of this product. The recycling of materials will help to conserve natural resources. For more detailed information about recycling of this product, please contact your local Civic Office, your household waste disposal service or the shop where you purchased the product.

Precautions

- Do not continuously use the speaker system beyond the peak power handling capacity.
- Keep recorded tapes, watches, and personal credit cards using magnetic coding away from the speaker system to protect them from damage caused by the magnets in the speakers.
- Please note the following when installing the units; otherwise, malfunction and/or deterioration in sound quality may result.
 - Do not touch the diaphragms and/or speaker cones by hand or with tools.
 - Do not put your fingers through the holes of the frame.
 - Do not drop foreign objects in the units.
- Do not place this product close to medical devices.
 - This product (including accessories) has a magnet(s) which may interfere with pacemakers, programmable shunt valves for hydrocephalus treatment, or other medical devices. Do not place this product close to persons who use such medical devices. Consult your doctor before using this product if you use any such medical device.

Caution

When using the speakers with an amplifier or power booster employing the BTL (balanced transformerless) system, be sure to connect the speaker system cords directly to the amplifier speaker cords. If the connection is made through already existing speaker cords that have a common lead for both the right and left channels, it is possible that no sound will be heard, and that the amplifier will be damaged. If you cannot find an appropriate mounting location, consult your car dealer or your nearest Sony dealer before mounting.

Specifications

Speaker	Separate type, 2 way: Woofer 16.5 cm (6 1/2in) cone type Tweeter 2.5 cm (1 in) dome type
Short-term maximum power*1	270 W*2
Rated power	60 W*2
CTA 2031 RMS Power	90 W
Rated impedance	4 Ω
Output sound pressure level	89 \pm 2 dB (1 W, 1 m)*2
Effective frequency range	40 – 40,000 Hz*2
Crossover frequency	5,000 Hz
Mass	Woofer: Approx. 950 g (2 lb 2 oz) per speaker Tweeter: Approx. 60 g (2 oz) per speaker Passive crossover network: Approx. 160 g (6 oz) per speaker
Supplied accessories	Parts for installation

Design and specifications are subject to change without notice.

*1“Short-term maximum power” may also be referred to as “Peak Power”.

*2Testing Condition: IEC 60268-5 (2003-05)

Mounting

Before mounting

A depth of at least 53.5 mm (21/8in) is required to mount the woofer. Measure the depth of the area where you are to mount the speaker and ensure that the speaker is not obstructing any other components of the car. Keep the following in mind when choosing a mounting location:

- Make sure that nothing is obstructing around the mounting location of the door (front or rear) where you are to mount the speaker.
- A hole for mounting may already be cut out of the inner panel of the door (front or rear). In this case, you need to modify the board only.
- If you are to mount this speaker system in the door (front or rear), make sure that the speaker terminals, frame

or magnet do not interfere with any inner parts, such as the window mechanism in the door (when you open or close the window), etc. Also make sure that the speaker grille does not touch any inner fittings, such as the window cranks, door handles, armrests, door pockets, lamps or seats etc.

- The suitable mounting location for the tweeters varies depending on the type of car. Choose a location that suits your car.

Parts list

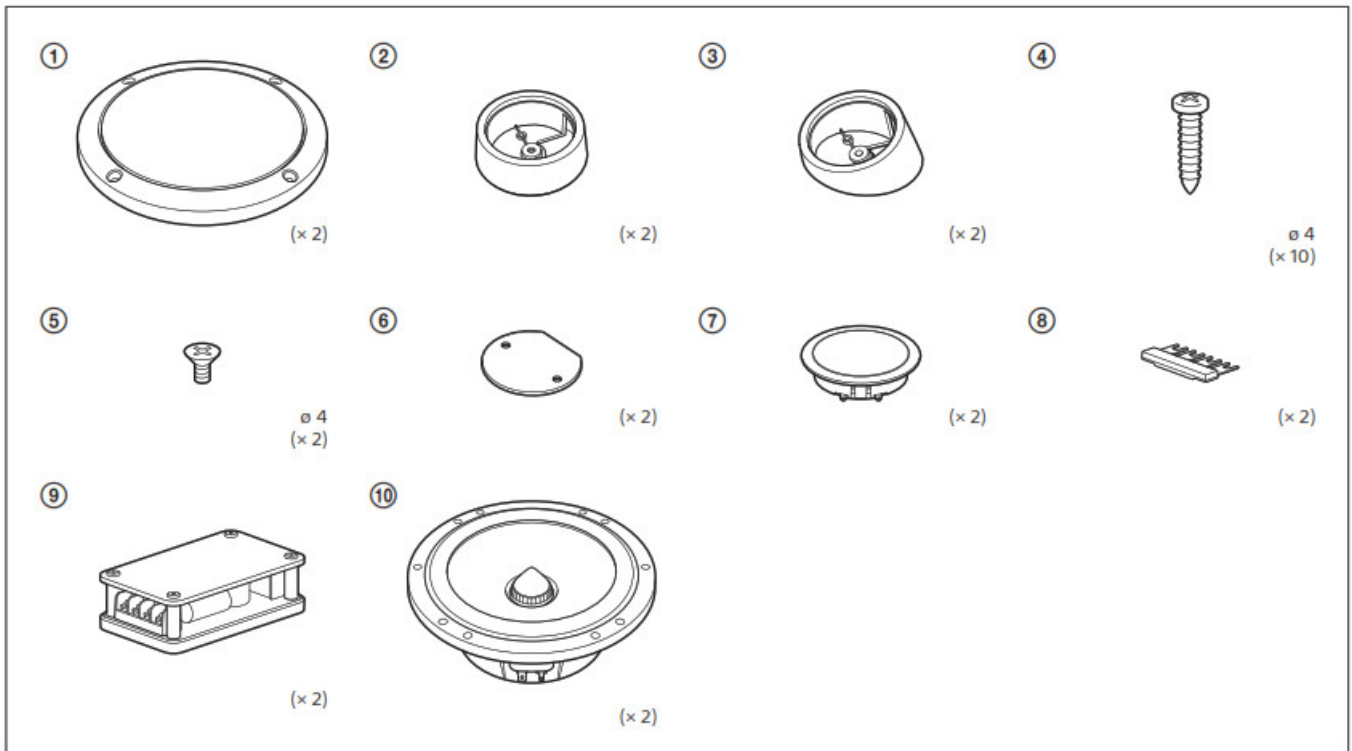

Tweeter Example

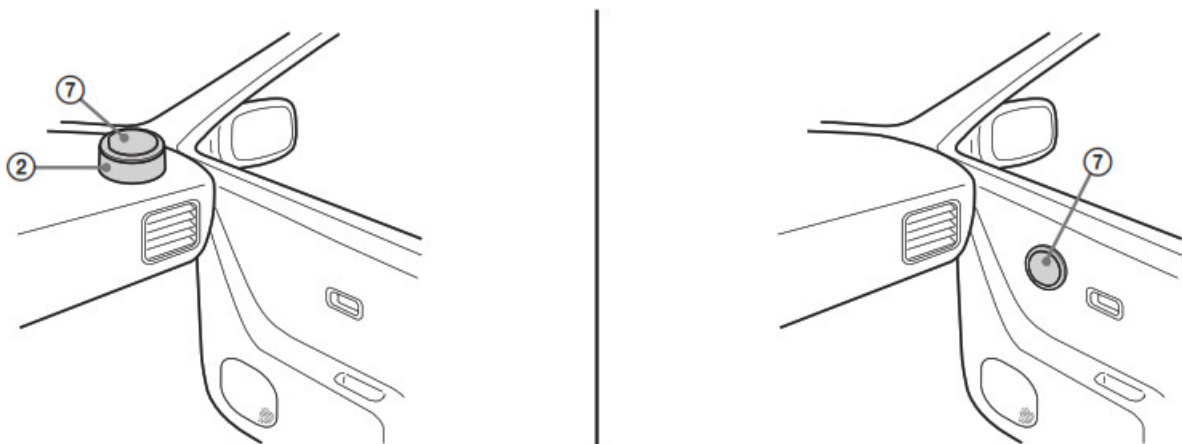

1. Remove the inside door panel.

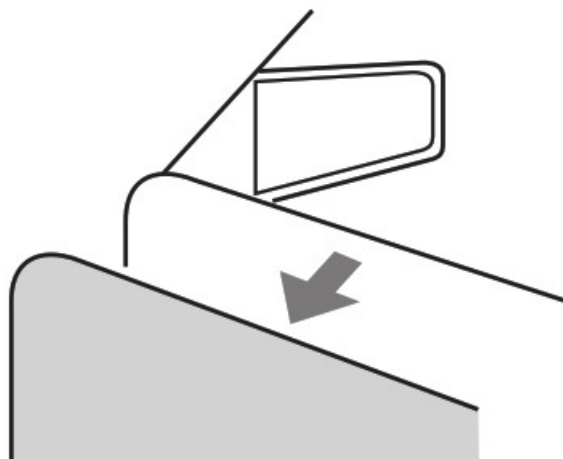

2. Unit: mm (in)

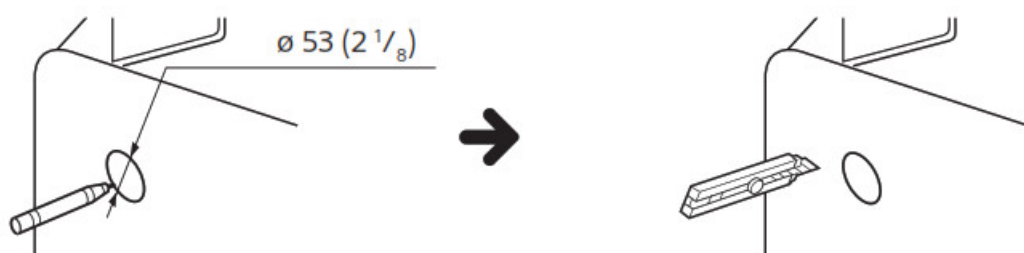

Decide the method to mount the unit depending on the type of the car and the installation location.

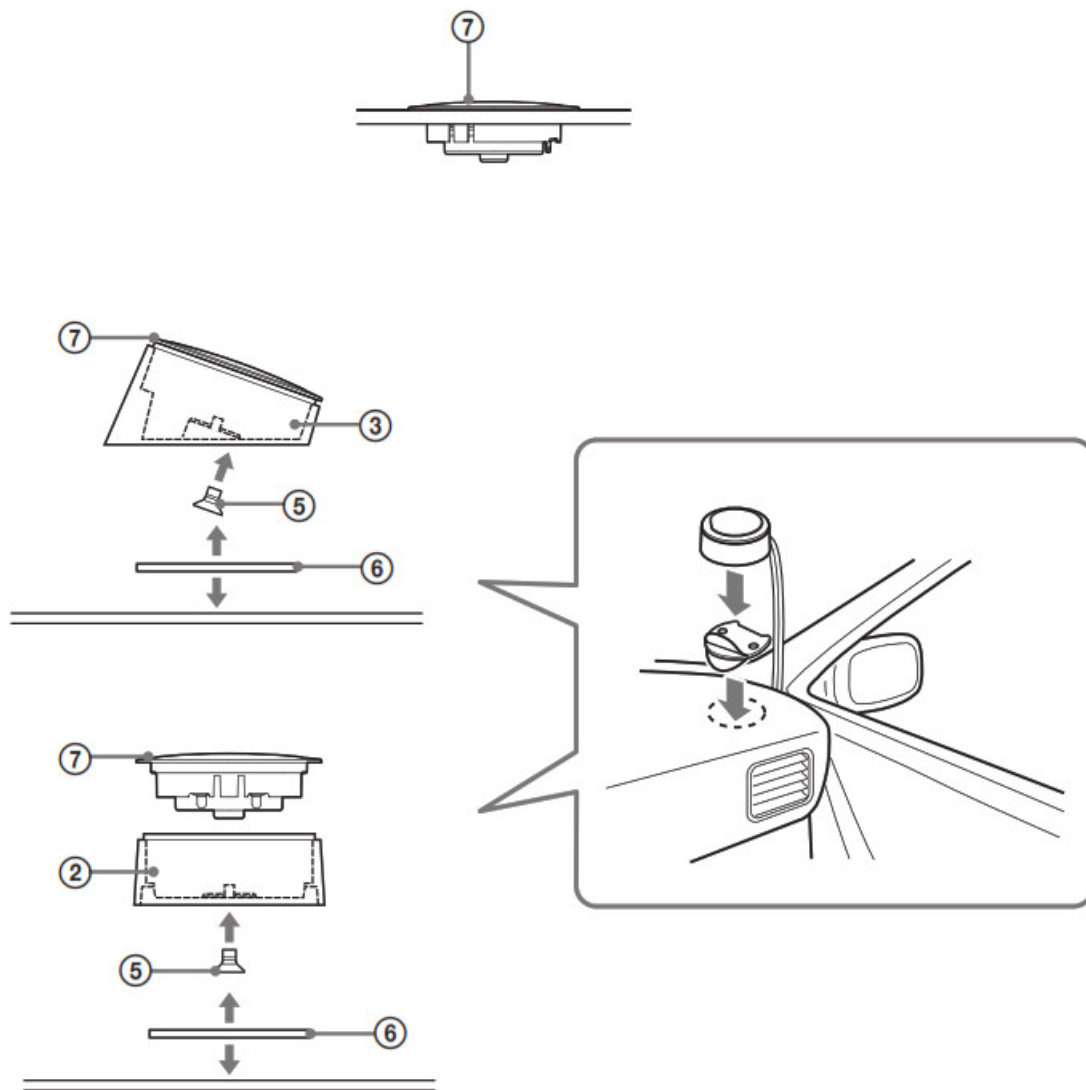

Woofer

1. Mark the 4 bolt holes and make them 3.2 mm (1/8 in) in diameter.

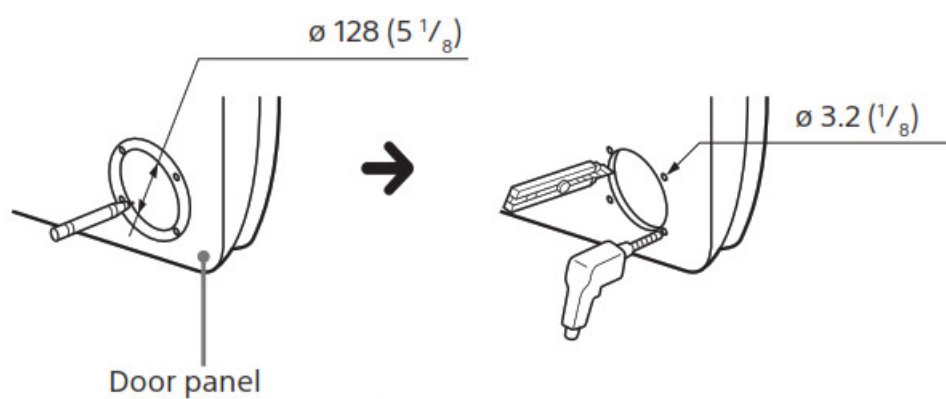

Unit: mm (in)

2. Speaker cord (not supplied)

2

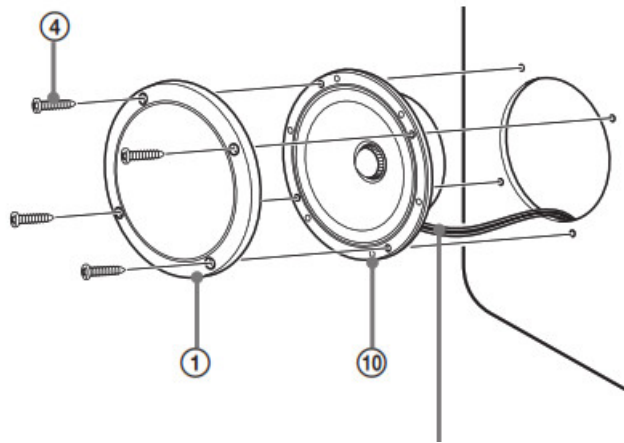

Passive crossover network

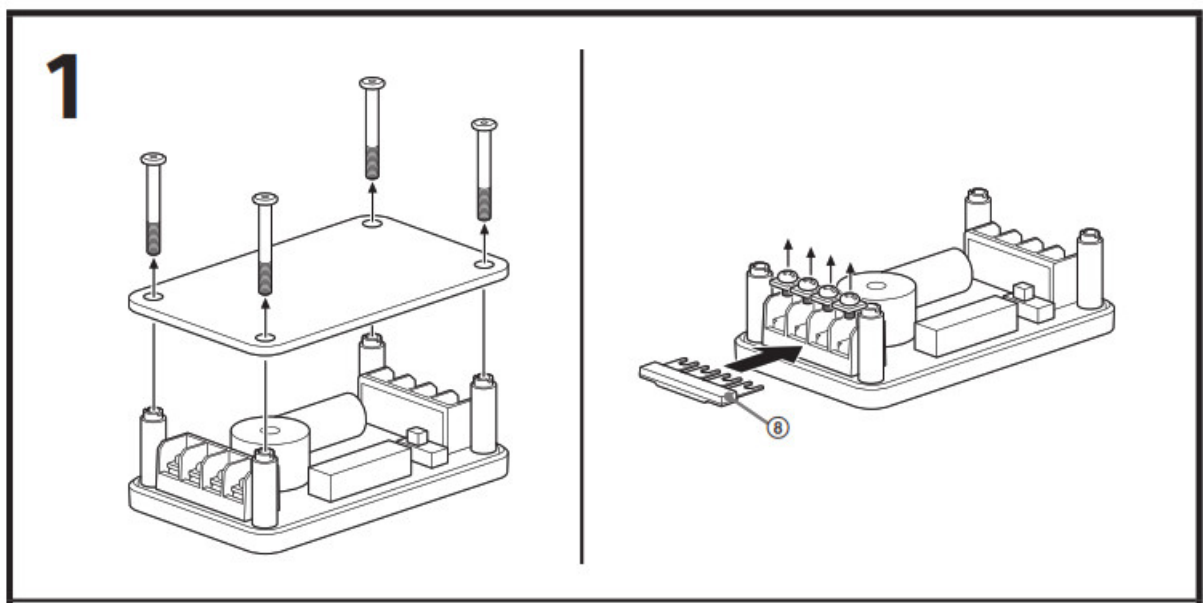

2. Adjusting the sound pressure of the tweeter
You can switch the sound pressure to 0 dB or +3 dB.

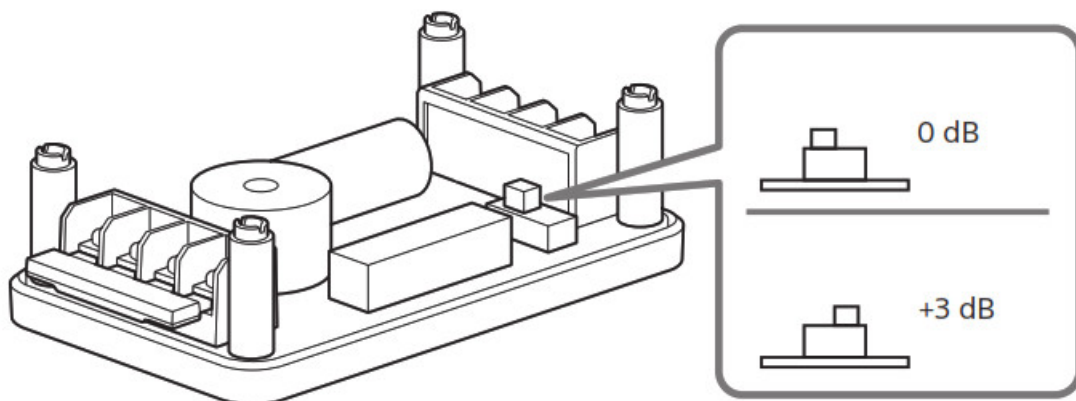

Connections

A. Basic connection

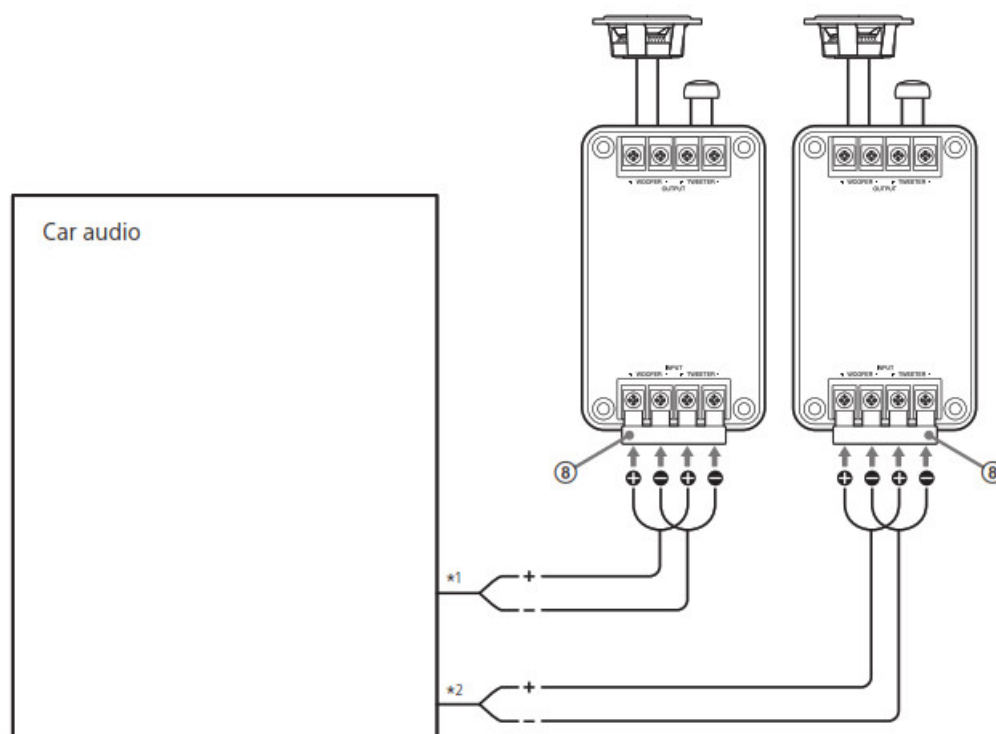

B. Standard connection

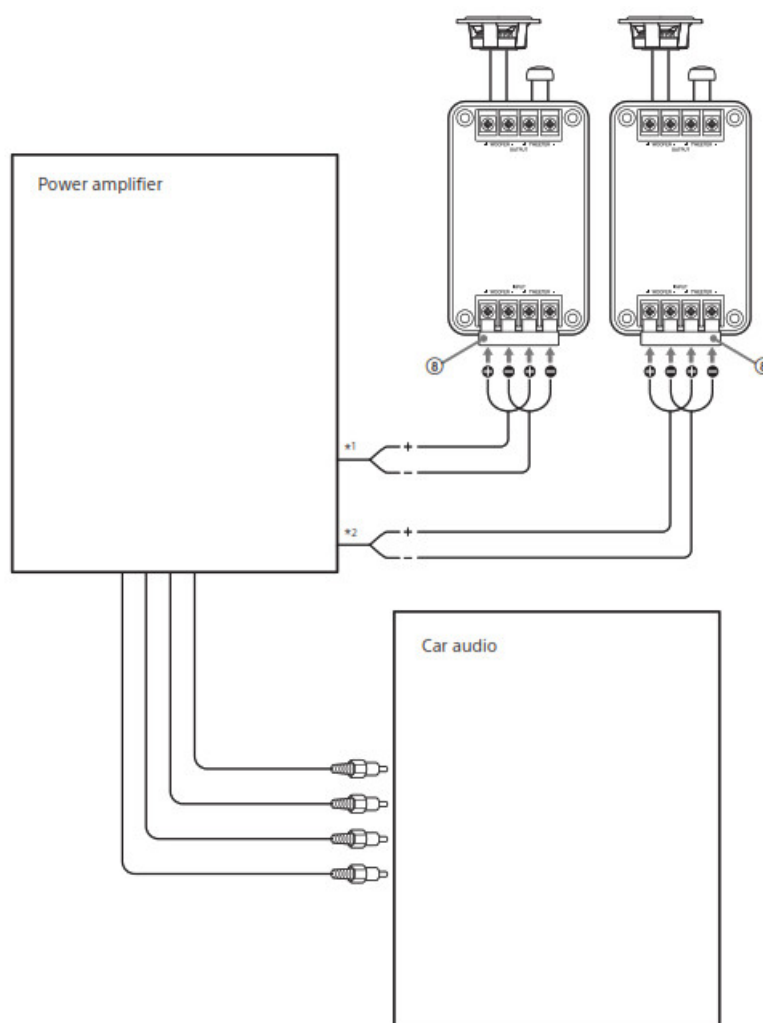

*1 Left speaker

*2 Right speaker

C. Standard connection

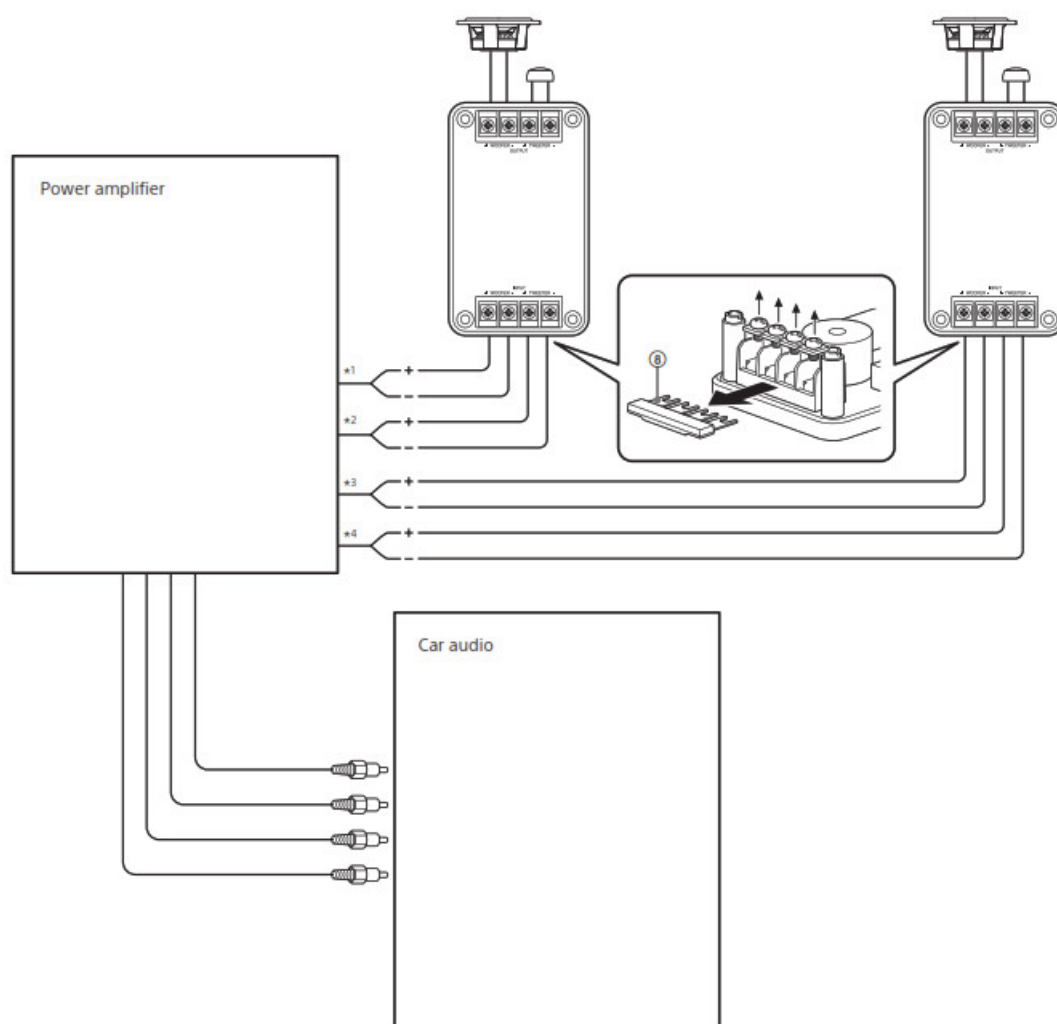

- *1 Rear right speaker
- *2 Front right speaker
- *3 Rear left speaker
- *4 Front left speaker

Documents / Resources

	<p>SONY XS-XB1621C 2-Way Component Speaker System [pdf] Instructions XS-XB1621C 2-Way Component Speaker System, XS-XB1621C, 2-Way Component Speaker System</p>
--	---

References

- [Sony Corporation - Home](#)