

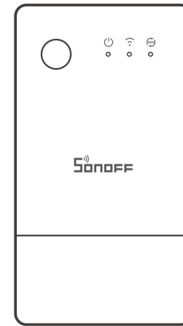

SONOFF THOrigin  
Smart  
Temperature and  
Humidity  
Monitor Switch



# SONOFF THOrigin Smart Temperature and Humidity Monitor Switch User Manual

[Home](#) » [SonOFF](#) » SONOFF THOrigin Smart Temperature and Humidity Monitor Switch User Manual 

## Contents

- [1 SONOFF THOrigin Smart Temperature and Humidity Monitor Switch](#)
- [2 Product Introduction](#)
- [3 Buttons instructions](#)
- [4 Features](#)
- [5 Device Installation](#)
- [6 Alexa voice control instructions](#)
- [7 Specifications](#)
- [8 Documents / Resources](#)
  - [8.1 References](#)
- [9 Related Posts](#)



**SONOFF THOrigin Smart Temperature and Humidity Monitor Switch**

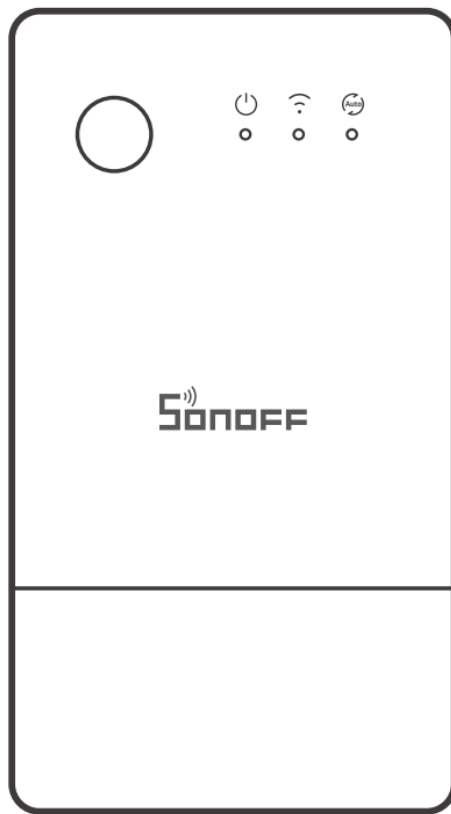

## Product Introduction

### TH Origin

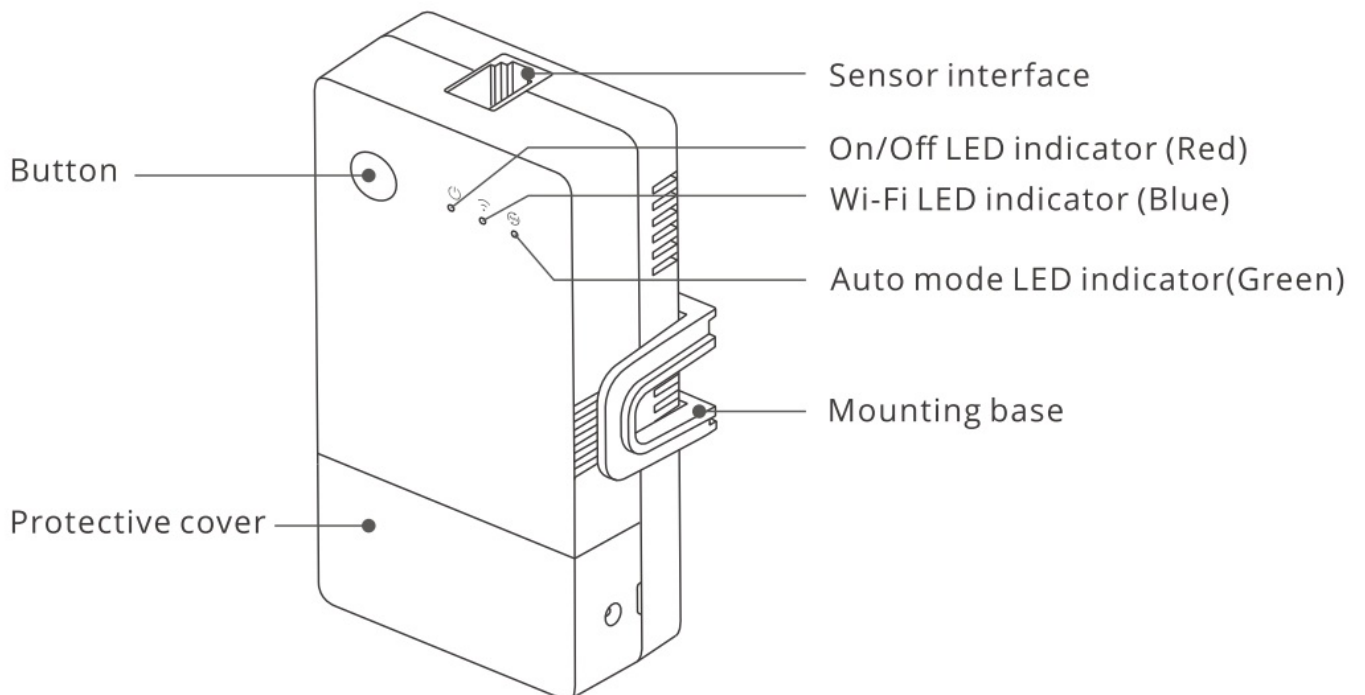

### TH Elite

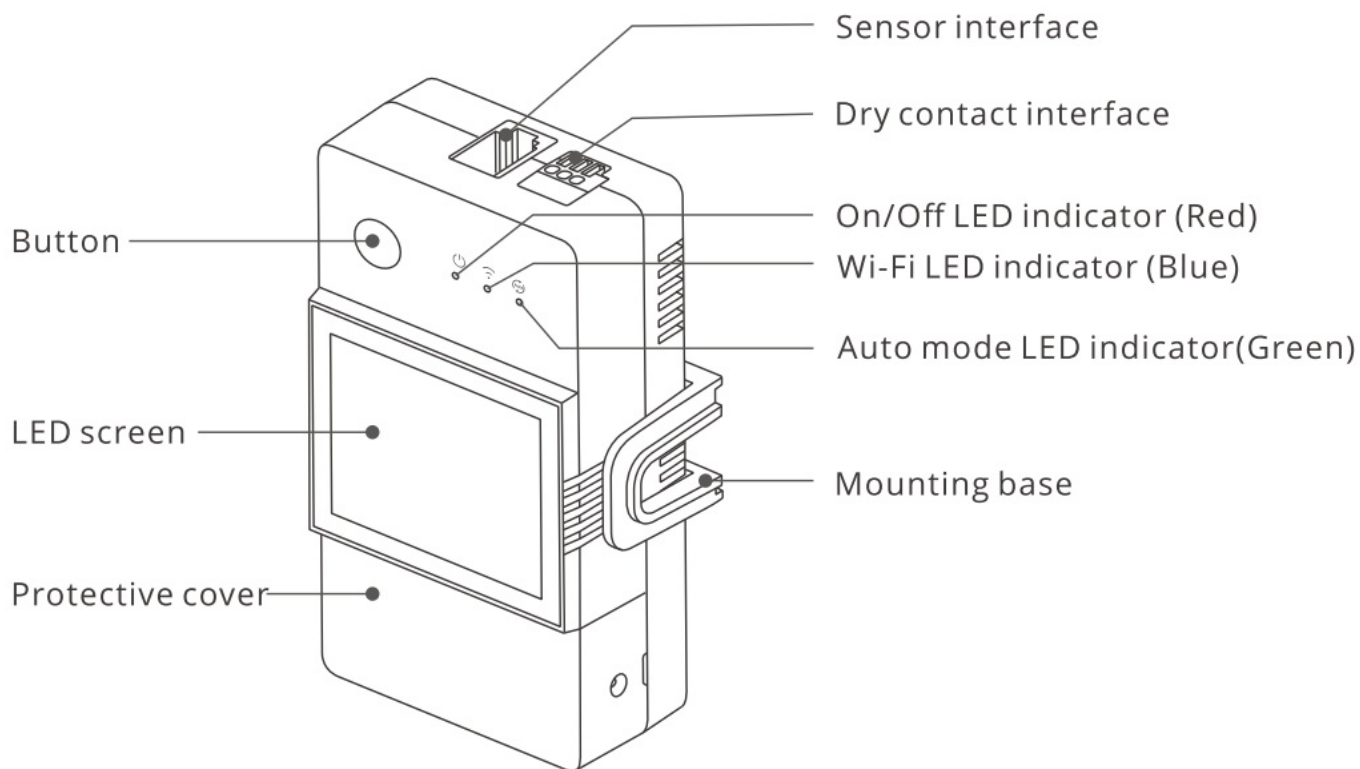

The device weight is less than 1 kg.  
 The installation height of less than 2m is recommended.

### Buttons instructions

Actions	Results
Single-click	Device on/off
Double-click	Auto-mode enable/disable
Long press for 5s	Enter the Pairing mode

### LED indicator status instruction

LED indicator status	Status instruction
Blue LED indicator flashes(one long and two short)	Pairing mode
Blue LED indicator keeps on	Device is online
Blue LED indicator quick flashes once	Fail to connect to router
Blue LED indicator quick flashes twice	Connected to router but fail to connect to server
Blue LED indicator quick flashes three times	Firmware updating
Green LED indicator keeps on	Auto-mode is on

### Features

TH Origin/Elite is a DIV smart switch with temperature and humidity monitoring, and required to use with the temperature and humidity sensors correspondingly. Automatically control the channel switch by setting the temperature or humidity threshold on the App.



Sensing Control



Temp & Humi  
History Data Graph



Automatic Mode



Share Control



Inching Mode



Voice Control



Timer Schedule



LAN Control



Wet & Dry Contact  
(TH Elite)



Screen Display  
(TH Elite)

## Device Installation

### Power off

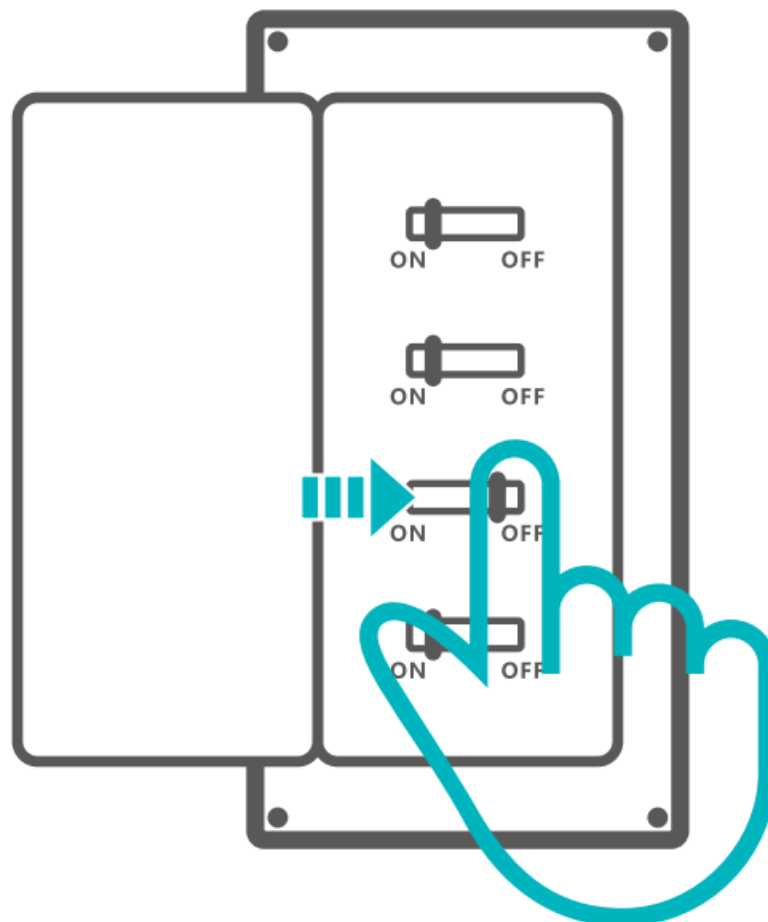

### WARNING

Please install and maintain the device by a professional electrician. To avoid electric shock hazard, do not operate any connection or contact the terminal connector while the device is powered on!

### Wiring instruction

1. Remove protective cover

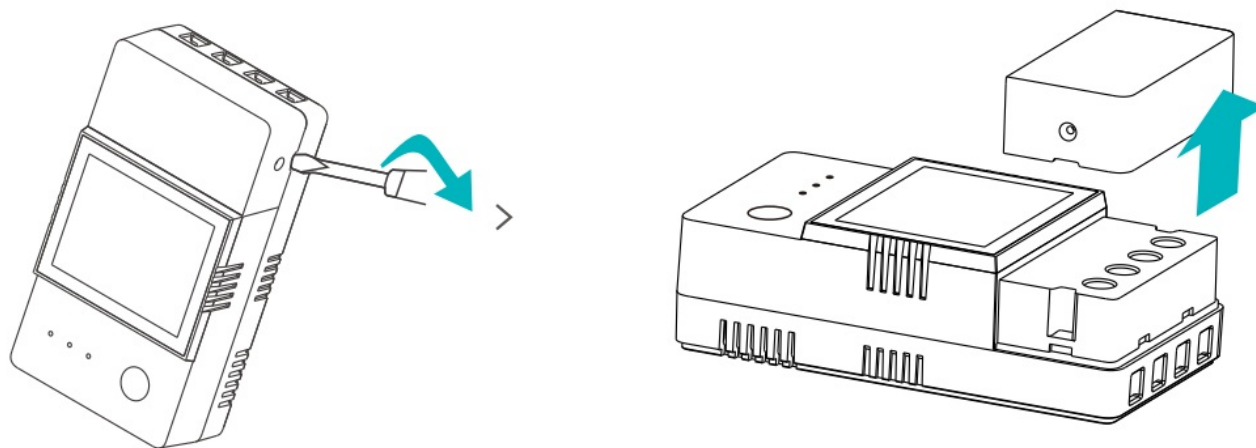

2.

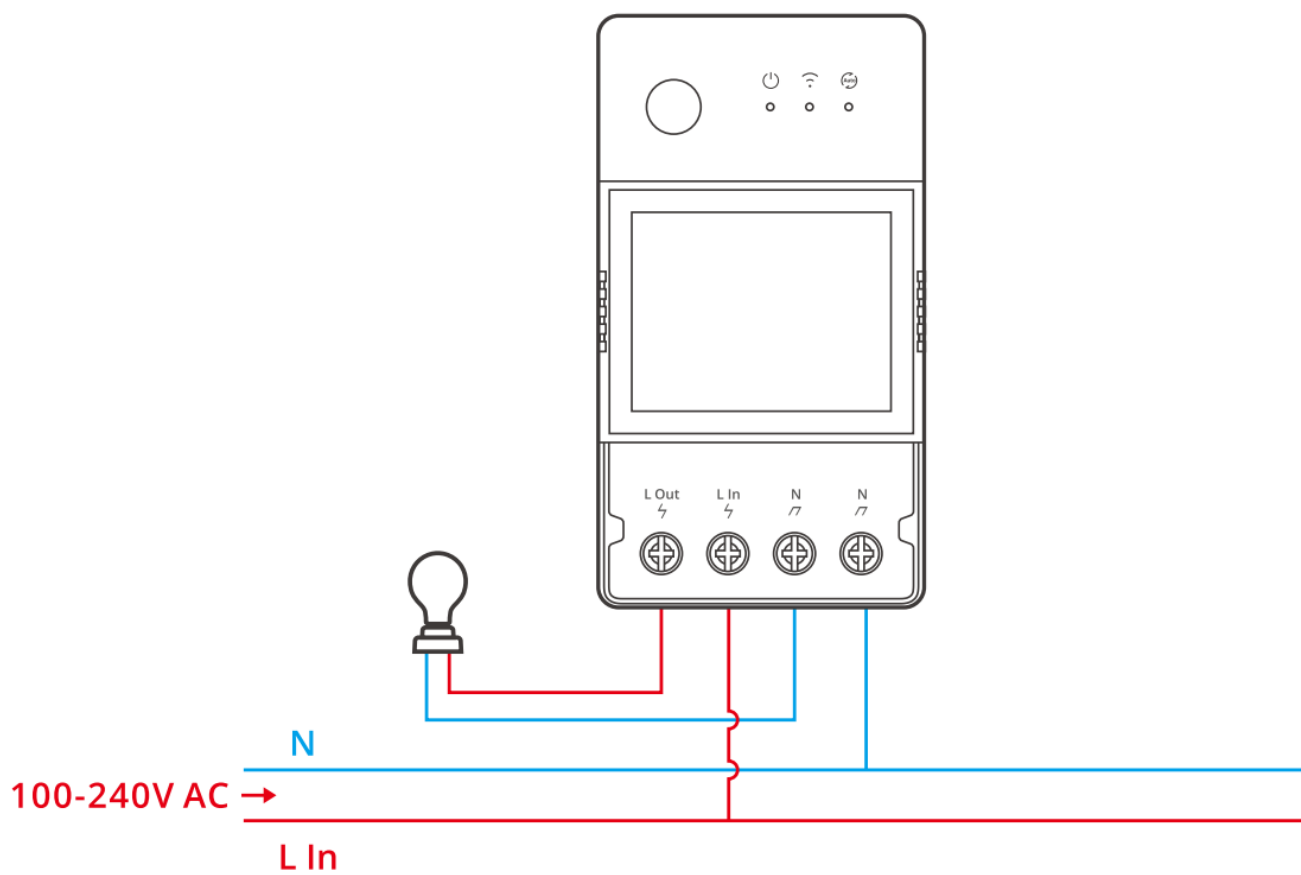

3. Wiring method of dry contact

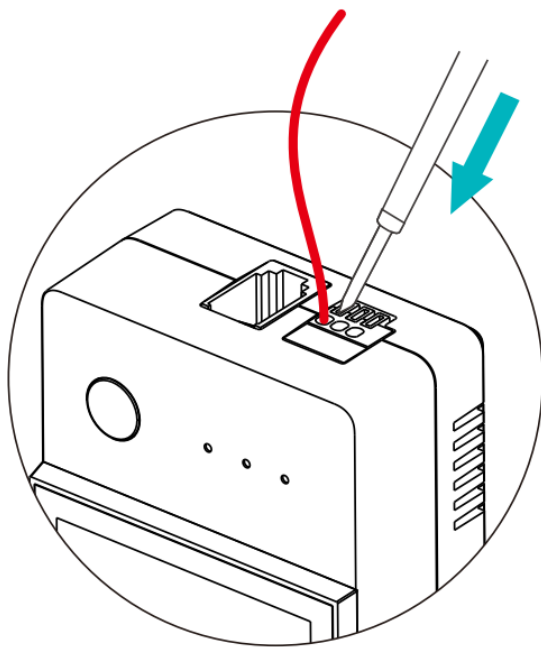

9-10mm



## TH Elite

Press the white button on the top of the wire connecting hole to insert the wire corresponding, then release.

- Dry contact wire conductor size: 0.13-0.5mm', wire stripping length: 9-10mm.
- Make sure all wires are connected correctly.

### 2-435mm rail installation

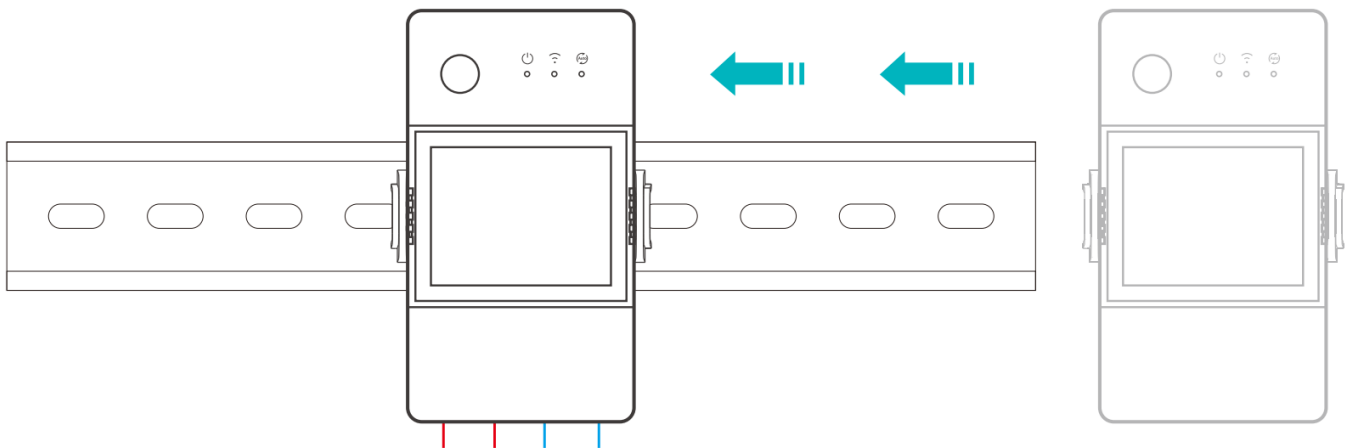

First fix the guide rail at the position where the equipment needs to be installed, and then slide the device base buckle against the side of the guide rail.

### Insert the sensor

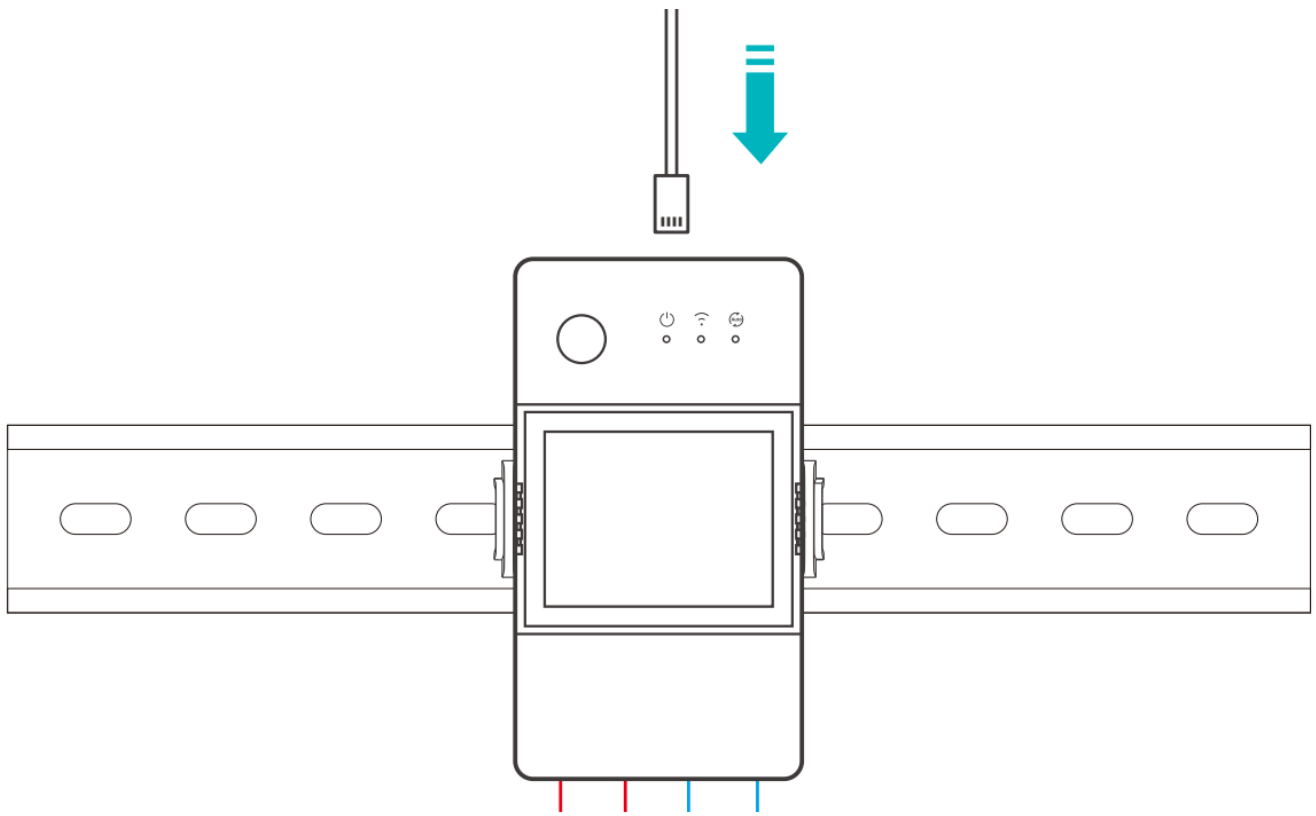

Compatible SONOFF sensors: WTS01, MS01, THS01, AM2301, Si7021. Compatible sensor extension cables: RL560.

- Some old version sensors need to be used with the accompanying adapter.

### Device pairing

1. Download the eWeLinkApp



Android™ & iOS

2. Power on

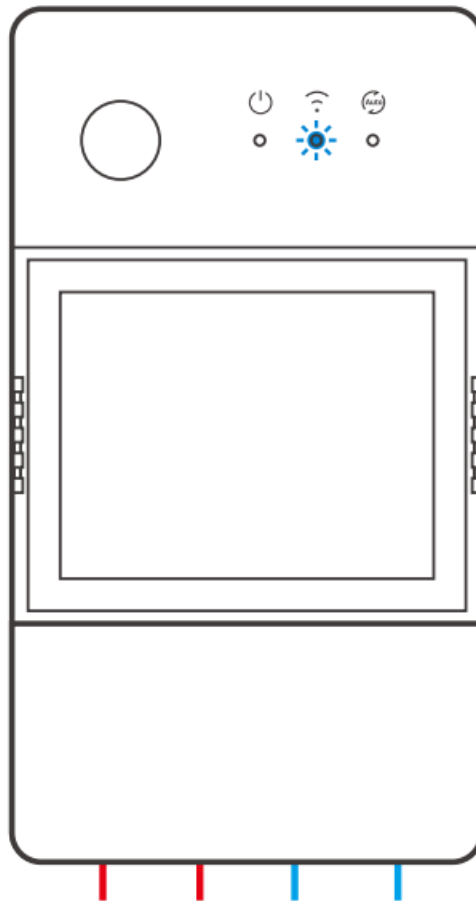

After powering on, the device will enter the Bluetooth Pairing Mode during the first use. The Wi-Fi LED indicator changes in a cycle of two short and one long flash and release.

- The device will exit the Bluetooth Pairing Mode if not paired within 3mins. If you want to enter this mode, please long press button for about 5s until the Wi-Fi LED indicator changes in a cycle of two short and one long flash and release.

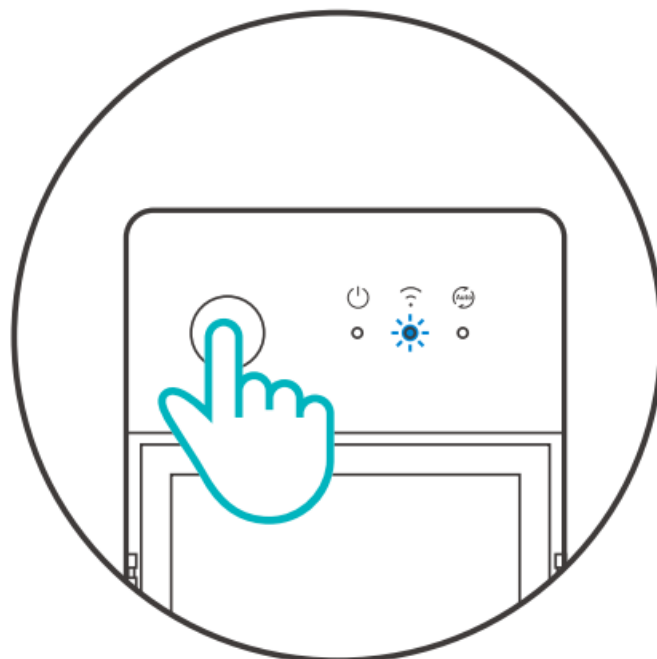

### 3. Add device

#### Method 1: Bluetooth Pairing



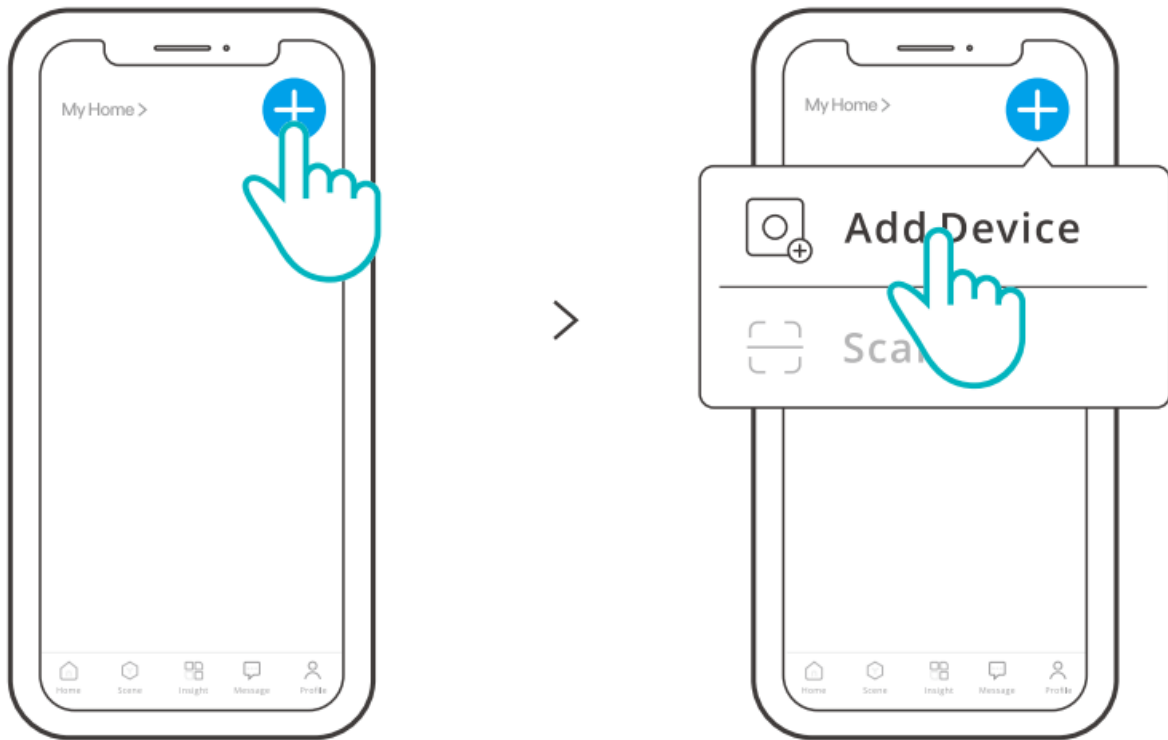

**Tap “+” and select “Add device”, then operate following the prompt on the App. Method 2: Scan QR code**

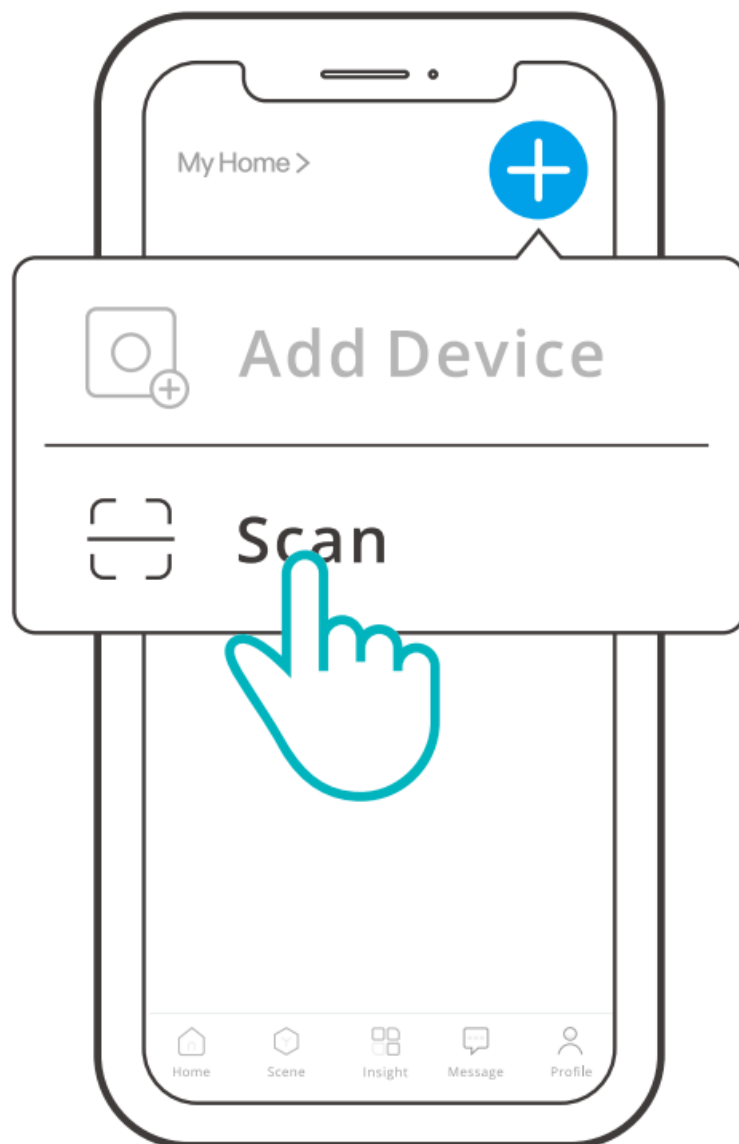

In the Pairing mode, tap “Scan” to add the device by scanning the QR code on its back.

## Alexa voice control instructions

1. Download the Amazon Alexa App and sign up an account.



Amazon Alexa

2. Add Amazon Echo Speaker on the Alexa App.
3. Account Linking (Link Alexa account on the eWelink App)

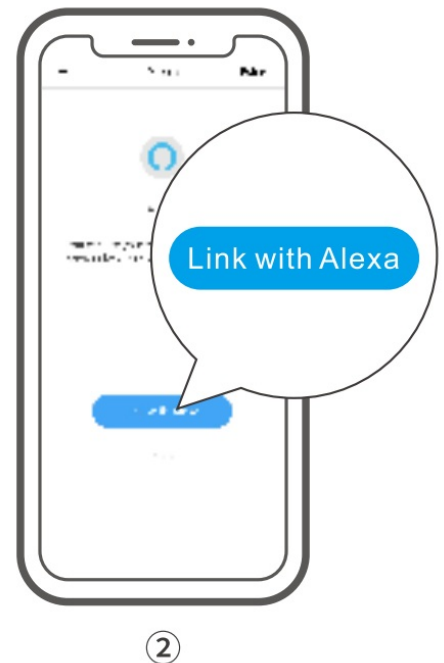
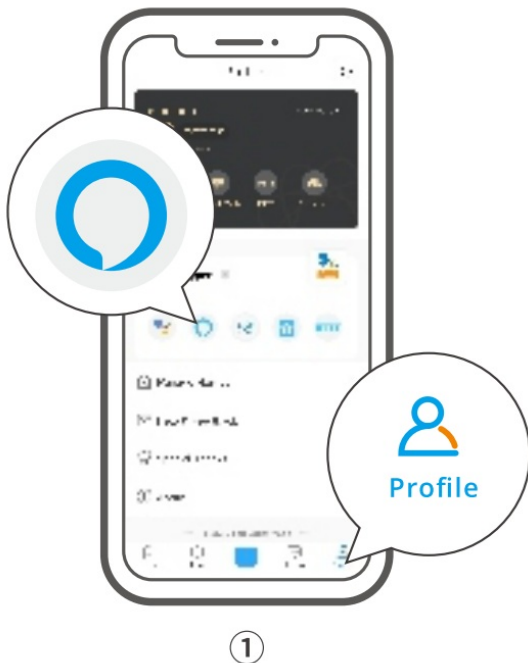

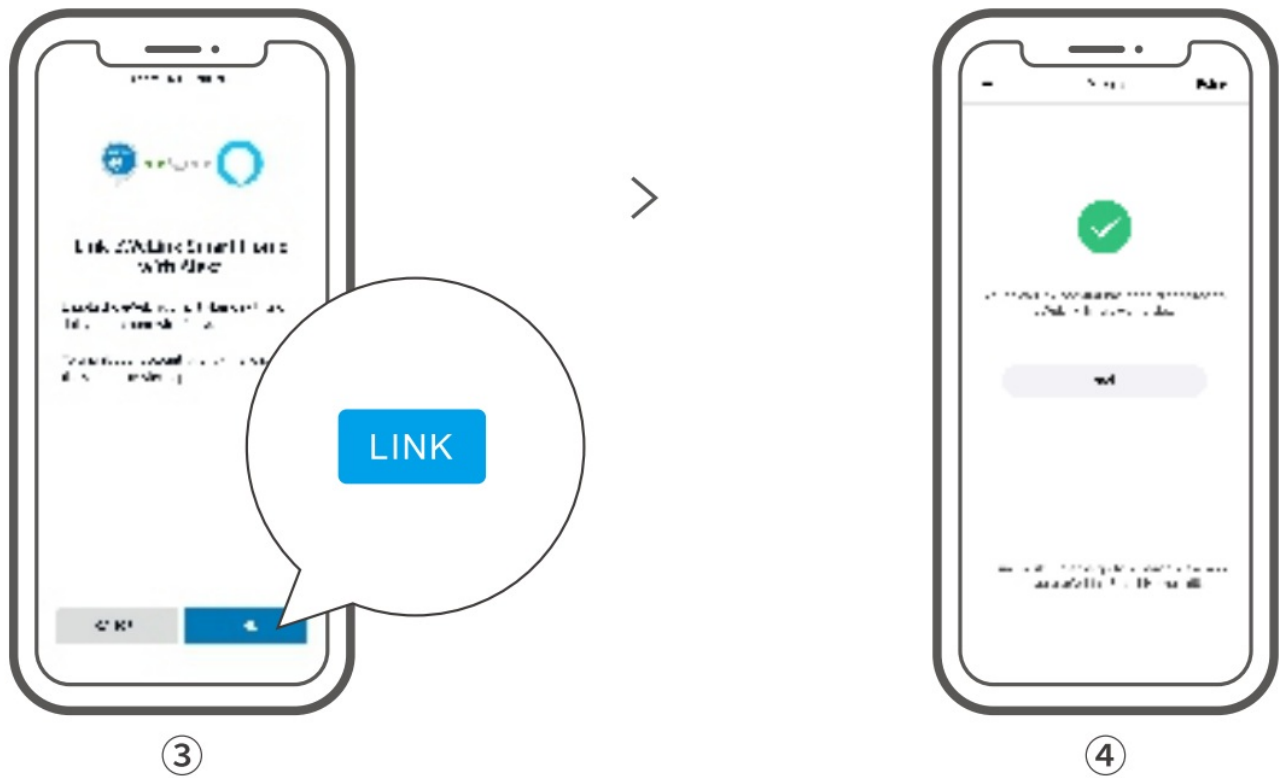

4. After linking the accounts, you can discover devices to connect on the Alexa App according the prompt.

Account linking method of Google Assistant, Xiaodu, Tmall Genie, Mate Xiaoai and etc is similar., the guides on the App shall prevail.

## Specifications

Model	THR316, THR320, THR316D, THR320D
Input	THR316, THR316D: 100-240V- 50/60Hz 16A Max THR320, THR320D: 100-240V – 50/60Hz 20A Max
Output	THR316, THR316D: 100-240V- 50/60Hz 16A Max THR320, THR320D: 100-240V – 50/60Hz 20A Max
Dry contact output	5-30V, 1A Max
Wi-Fi	IEEE 802.11 b/g/n 2.4GHz
<b>LED screen size</b>	THR316D, THR320D, 43x33mm
App supported systems	Android & iOS
Operating temps	10T40 (-10°C-40°C)
Working humidity	5%-95% RH, non-condensing
Shell material	PCV0
<b>Dimension</b>	THR316, THR320, 98x54x27.5mm THR316D, THR320D, 98x54x31 mm
High voltage <b>connector wire</b>	THR316, THR316D: 1.0 mm <sup>2</sup> to 4.0mm <sup>2</sup> THR320, THR320D: 1.5mm <sup>2</sup> to 6.0mm <sup>2</sup>
<b>Rated impulse voltage</b>	2500V
<b>Remark</b>	<b>External preliminary protection with Max. C 20 A circuit breaker in the supply line required under all circumstances.</b>

### LAN control

A communication method to control the devices directly without going through the Cloud, which requires your smartphone and device connect to the same WIFI.

Operation notifications, operation records, firmware upgrades, smart scenes, devices sharing and devices delete are not supported when there is no external network connection.

### Control modes

- **Manual** mode: Turn on/off the device through the App and device itself whenever you want.
- **Auto** mode: Turn on/off the device automatically through presetting the threshold of temperature and humidity.
- **Auto** mode setting: Set the threshold of temperature & humidity and effective time period, you can set up 8

automatic control programs in different time periods

### **Auto mode enable/disable**

Enable/disable the auto mode by double click the button on the device or enable/disable it on the App directly.

Manual control and Auto mode can work at the same time. In the auto mode, you can turn on/off the device manually. After a while, auto mode will resume execution if it detects changes in temperature and humidity.

### **Factory Reset**

Deleting the device on the eWelink app indicates you restore it to factory setting.

### **Common Problems**

Fail to pair Wi-Fi devices to eWelinkAPP

1. Make sure the device is in pairing mode. After three minutes of unsuccessful pairing, the device will automatically exit pairing mode.
2. Please turn on location services and allow location permission. Before choosing the Wi-Fi network, location services should be turned on and location permission should be allowed. Location information permission is used to obtain Wi-Fi list information. If you click Disable, you will not be able to add devices.
3. Make sure your Wi-Fi network runs on the 2.4GHz band.
4. Make sure you entered a correct Wi-Fi SSID and password, no special characters contained. Wrong password is a very common reason for pairing failure.
5. The device shall get close to the router for a good transmission signal condition while pairing.

### **Wi-Fi devices “Offline” issue, Please check the following problems by the Wi-Fi LED indicator status:**

The LED indicator blinks once every 2s means you fail to connect to the router.

1. Maybe you entered the wrong Wi-Fi SSID and password.
2. Make sure that your Wi-Fi SSID and password don't contain special characters, for example, the Hebrew, Arabic characters, our system can't recognize these characters and then fail to connect to the Wi-Fi.
3. Maybe your router has a lower carrying capacity.
4. Maybe the Wi-Fi strength is weak. Your router is too far away from your device, or there may be some obstacle between the router and device which blocks the signal transmission.

The LED indicator flashes twice on repeated means you fail to connect to the server.

1. Make sure the Internet connection is working. You can use your phone or PC to connect to the Internet, and if it fails to access, please check the availability of the Internet connection.
2. Maybe your router has a low carrying capacity. The number of devices connected to the router exceeds its maximum value. Please confirm the maximum number of devices that your router can carry. If it exceeds, please delete some devices or get a larger router and try again.

If none of the above methods solved this problem, please submit your request via help&feedback on the eWelink App.

**Shenzhen SonoffTechnologies Co., Ltd.**

3F & 6F, Bldg A, No. 663, Bu long Rd, Shenzhen, Guangdong, China

ZIP code: 518000 Website: [sonaff.tech](http://sonaff.tech)  
Service email: [support@itead.cc](mailto:support@itead.cc)

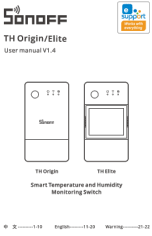

Documents / Resources

	<p><a href="#">SONOFF THOrigin Smart Temperature and Humidity Monitor Switch</a> [pdf] User Manual THOrigin Smart Temperature and Humidity Monitor Switch, THOrigin, Smart Temperature and Humidity Monitor Switch, Humidity Monitor Switch, Monitor Switch</p>
---	---

References

- [User Manual](#)

[Manuals+](#), [Privacy Policy](#)

This website is an independent publication and is neither affiliated with nor endorsed by any of the trademark owners. The "Bluetooth®" word mark and logos are registered trademarks owned by Bluetooth SIG, Inc. The "Wi-Fi®" word mark and logos are registered trademarks owned by the Wi-Fi Alliance. Any use of these marks on this website does not imply any affiliation with or endorsement.