



SONOFF The Origin/Elite Smart Temperature and Humidity Monitoring Switch User Manual

[Home](#) » [SonOFF](#) » SONOFF The Origin/Elite Smart Temperature and Humidity Monitoring Switch User Manual



SONOFF The Origin/Elite Smart Temperature and Humidity Monitoring Switch User Manual



Dear customer,

Thank you for purchasing our product. Please read the following instructions carefully before first use and keep this user manual for future reference. Pay particular attention to the safety instructions. If you have any questions or comments about the device, please contact the customer line.

✉ www.alza.co.uk/kontakt

☎ +44 (0)203 514 4411

Importer Alza.cz a.s., Jankovcova 1522/53, Holešovice, 170 00 Praha 7, www.alza.cz

Contents

- 1 Product Introduction
- 2 Button instructions
- 3 Features
- 4 Device Installation
- 5 Device pairing
- 6 Alexa voice control instructions
- 7 Specifications
- 8 Common Problems
- 9 Warranty Conditions
- 10 EU Declaration of Conformity
- 11 WEEE
- 12 Documents / Resources
 - 12.1 References
- 13 Related Posts

Product Introduction

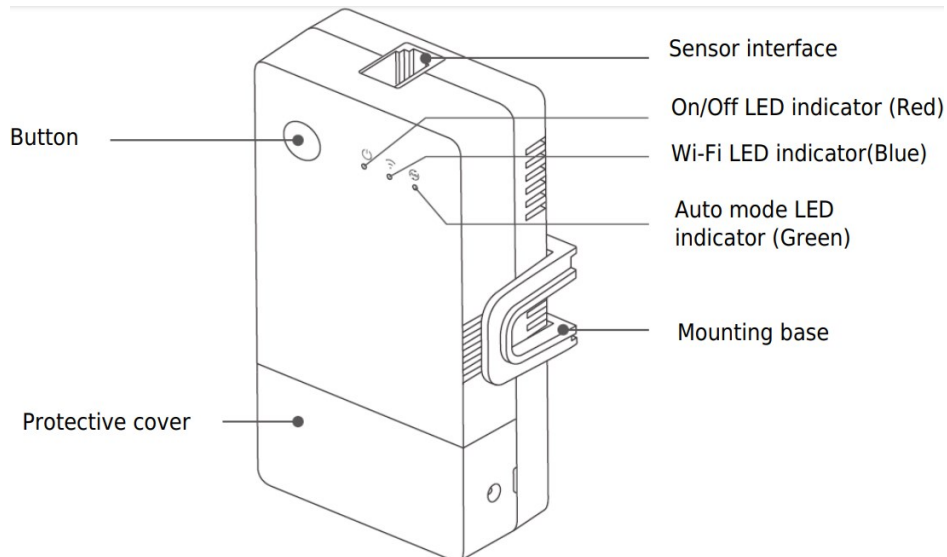

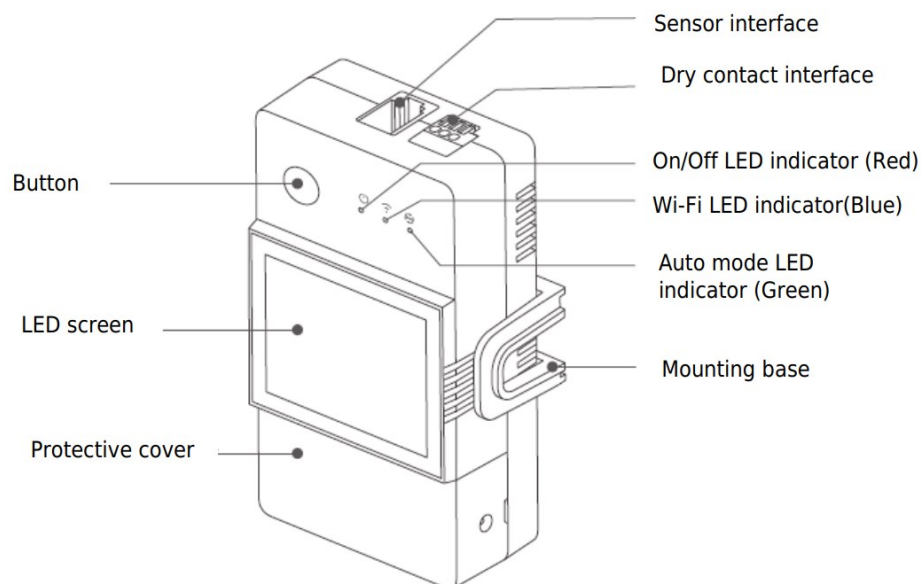

The device weight is less than 1kg. The installation height of less than 2m is recommended.

Button instructions

Actions	Results
Single-click	Device on/off
Double-click	Auto-mode enable/disable
Long press for 5s	Enter the Pairing mode

LED indicator status instruction

LED indicator status	Status instruction
Blue LED indicator flashes (one long and two short)	Pairing mode
Blue LED indicator keeps on	Device is online
Blue LED indicator quick flashes once	Fail to connect to router
Blue LED indicator quick flashes twice	Connected to router but fail to connect
Blue LED indicator quick flashes threetimes	Firmware updating
Green LED indicator keeps on	Auto-models on

Features

TH Origin/Elite is a DIY smart switch with temperature and humidity monitoring, and required to use with the temperature and humidity sensors correspondingly.

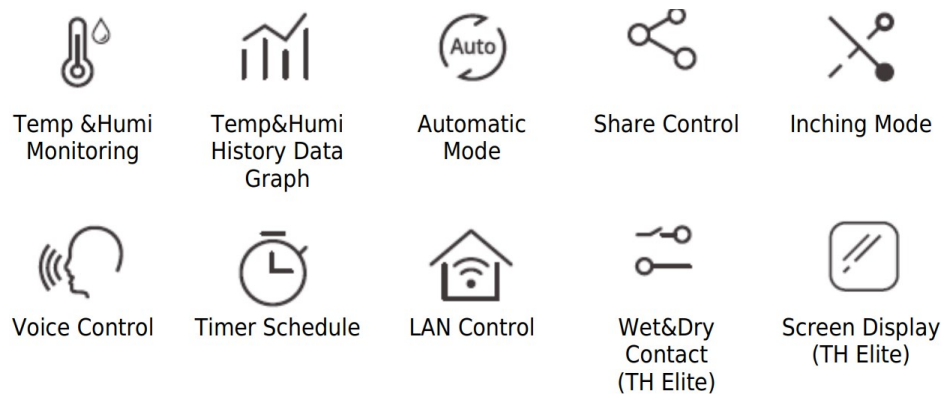

Device Installation

Power off

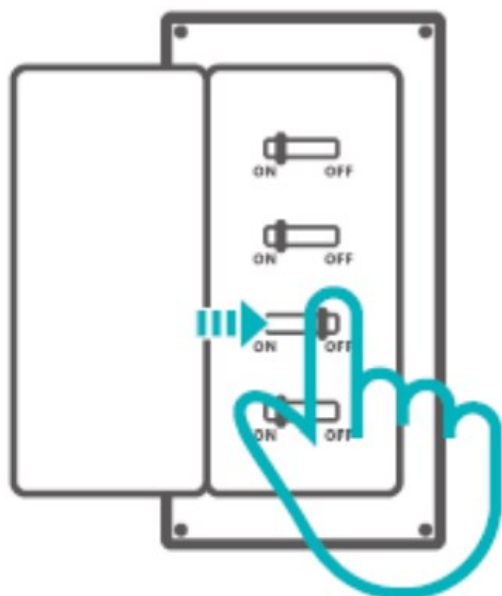

Please install and maintain the device by a professional electrician. To avoid electric shock hazard, do not operate any connection or contact the terminal connector while the device is powered on!

Wiring instruction Remove protective cover

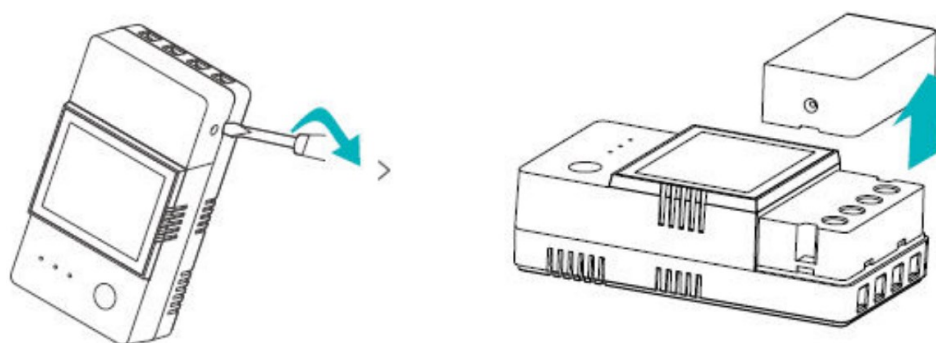

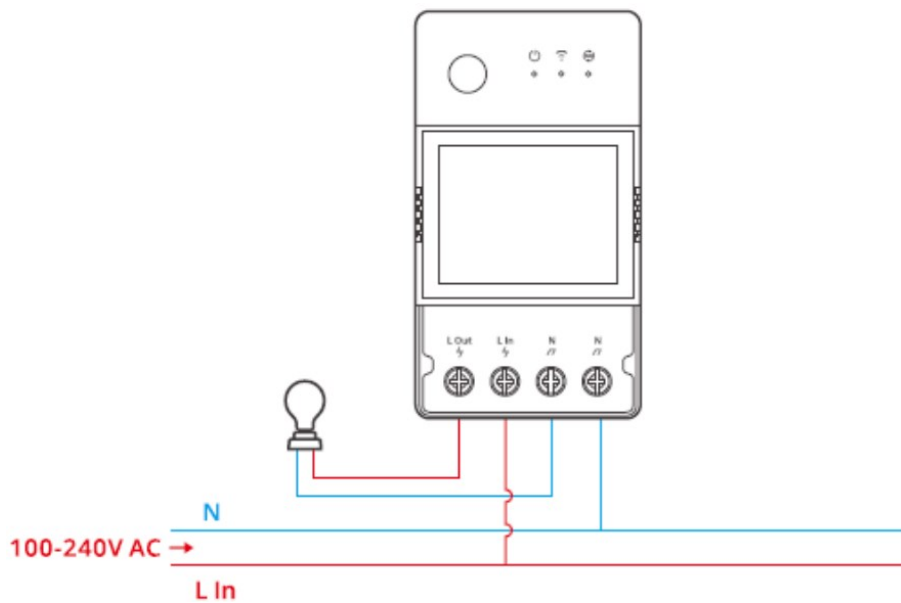

Wiring method of dry contact

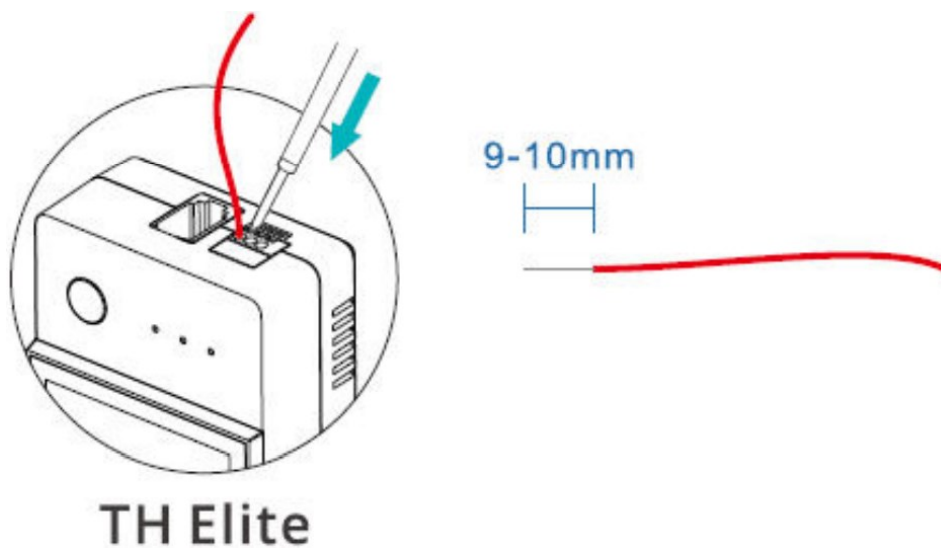

Press the white button on the top of the wire connecting hole to insert the wire corresponding, then release.
Dry contact wire conductor size: 0.13-0.5mm², wire stripping length: 9-10mm. Make sure all wires are connected correctly.

Insert the sensor

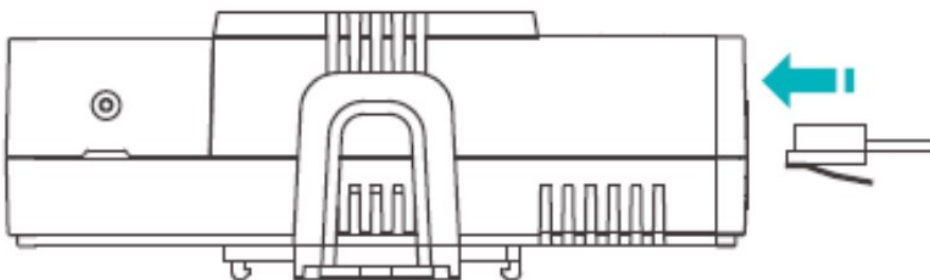

Compatible SONOFF sensors: DS18B20, MS01, THS01, AM2301, Si7021. Compatible sensor extension cables: RL560. Some old version sensors need to be used with the accompanying adapter.

Device pairing

Download the eWeLink App

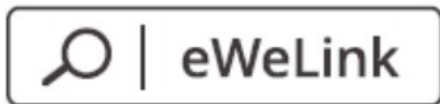

Power on

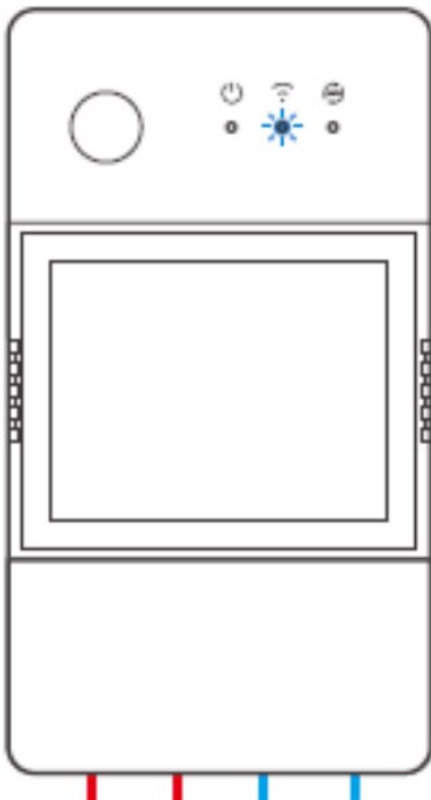

After powering on, the device will enter the Bluetooth Pairing Mode during the first use. The Wi-Fi LED indicator

changes in a cycle of two short and one long flash and release. The device will exit the Bluetooth Pairing Mode if not paired within 3mins. If you want to enter this mode, please long press button for about 5s until the Wi-Fi LED indicator changes in a cycle of two short and one long flash and release



Add device

Method 1: Bluetooth Pairing

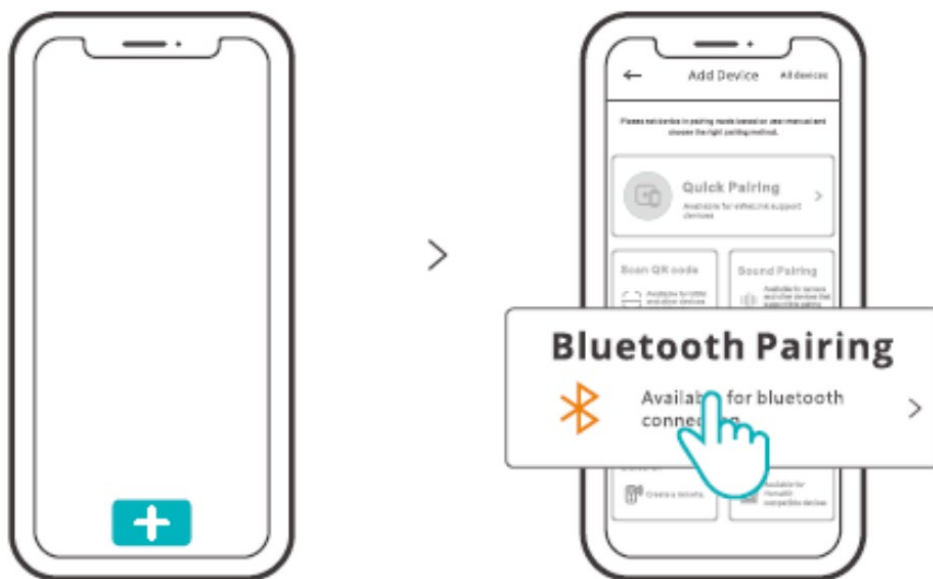

Tap "+" and select "Bluetooth Pairing", then operate following the prompt on the App. Method 2: Scan QR code

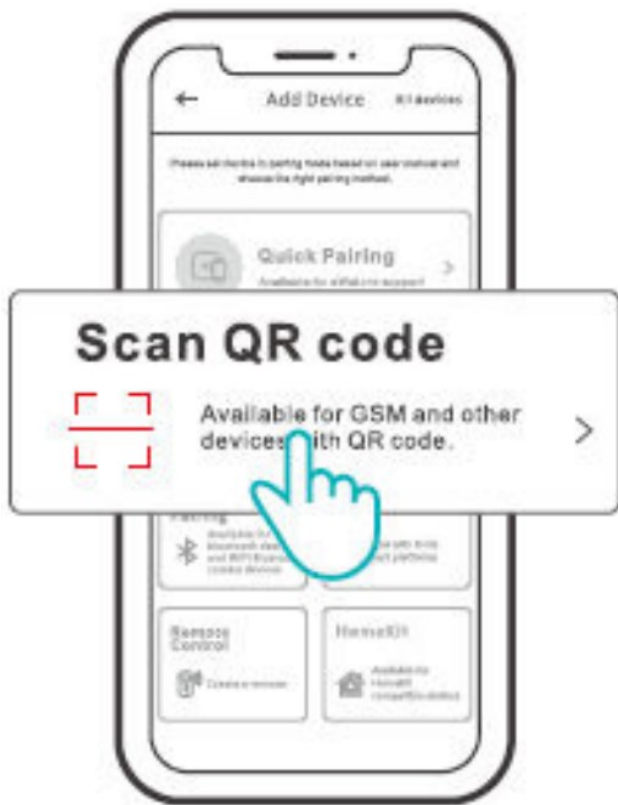

In the Pairing mode, tap “Scan QR code” to add the device by scanning the QR code on its back.

Alexa voice control instructions

1. Download the Amazon Alexa App and sign up an account.



2. Add Amazon Echo Speaker on the Alexa App.
3. Account Linking (Link Alexa account on the eWeLink App)

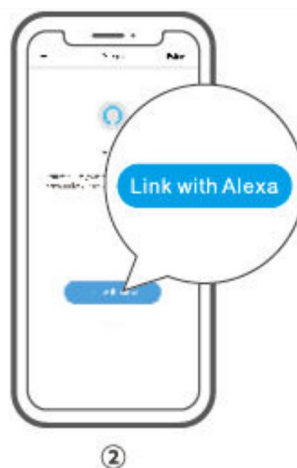

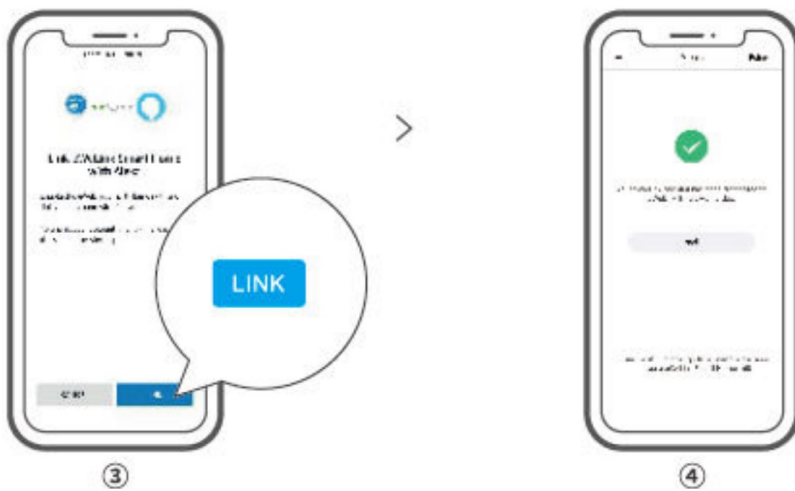

4. After linking the accounts, you can discover devices to connect on the Alexa App according the prompt.

Account linking method of Google Assistant, Xiaodu, Tmall Genie, Mate Xiaoai and etc is similar., the guides on the App shall prevail.

Specifications

Model THR316,THR320,THR316D,THR320D

Input THR316,THR316D: 100-240V~50/60Hz 16A Max THR320,THR320D: 100-240V~50/60H 20A Max

Output THR316,THR316D: 100-240V ~ 50/60Hz 16A Max THR320, THR320D: 110-240V ~ 50/60HZ 20A Max

Dry contact output 5—30V, 1A Max

Wi-Fi IEEE 802.11 b/g/n 2.4GHz

LED screen size TH R316D, TH R320D: 43X33mm

App supported systems Android 8LiOS

Working temperature -10°C~40°C

Working humidity 5%-95% RH, non-condensing

Shell material PC V0

Dimension THR316,THR320: 98x54x27.5mm THR316D,THR320D: 98X54X31mm

LAN control

A communication method to control the devices directly without going through the Cloud, which requires your smartphone and device connect to the same WIFI. Operation notifications, operation records, firmware upgrades, smart scenes, devices sharing and devices delete are not supported when there is no external network connection.

Control modes

Manual mode: Turn on/off the device through the App and device itself whenever you want.

Auto mode: Turn on/off the device automatically through pre-setting the threshold of temperature and humidity.

Auto mode setting: Set the threshold of temperature & humidity and effective time period, you can set up 8 automatic control programs in different time periods

Auto mode enable/disable

Enable/disable the auto mode by double click the button on the device or enable/disable it on the App directly.

Manual control and Auto mode can work at the same time. In the auto mode, you can turn on/off the device manually. After a while, auto mode will resume execution if it detects changes in temperature and humidity.

Factory Reset

Deleting the device on the eWeLink app indicates you restore it to factory setting.

Common Problems

Fail to pair Wi-Fi devices to eWeLink APP

1. Make sure the device is in pairing mode. After three minutes of unsuccessful pairing, the device will automatically exit pairing mode.
2. Please turn on location services and allow location permission. Before choosing the Wi-Fi network, location services should be turned on and location permission should be allowed. Location information permission is used to obtain Wi-Fi list information. If you click Disable, you will not be able to add devices.
3. Make sure your Wi-Fi network runs on the 2.4GHz band.
4. Make sure you entered a correct Wi-Fi SSID and password, no special character contained. Wrong password is a very common reason for pairing failure.
5. The device shall get close to the router for a good transmission signal condition while pairing.

Wi-Fi devices “Offline” issue, Please check the following problems by the Wi-Fi LED indicator status:

The LED indicator blinks once every 2s means you fail to connect to the router.

1. Maybe you entered the wrong Wi-Fi SSID and password.
2. Make sure that your Wi-Fi SSID and password don't contain special characters, for example, the Hebrew, Arabic characters, our system can't recognize these characters and then fail to connect to the Wi-Fi.
3. Maybe your router has a lower carrying capacity.
4. Maybe the Wi-Fi strength is weak. Your router is too far away from your device, or there may be some obstacle between the router and device which blocks the signal transmission.
5. Be sure that the MAC of the device is not on the blacklist of your MAC management.

The LED indicator flashes twice on repeated means you fail to connect to the server.

1. Make sure the Internet connection is working. You can use your phone or PC to connect to the Internet, and if it fails to access, please check the availability of the Internet connection.
2. Maybe your router has a low carrying capacity. The number of devices connected to the router exceeds its maximum value. Please confirm the maximum number of devices that your router can carry. If it exceeds, please delete some devices or get a larger router and try again.
3. Please contact your ISP and confirm our server address is not shielded: cndisp.coolkit.cc (China Mainland) as-disp.coolkit.cc (in Asia except China) eu-disp.coolkit.cc (in EU) us-disp.coolkit.cc (in US)

If none of the above methods solved this problem, please submit your request via Help & feedback on the eWeLink App.

Warranty Conditions

A new product purchased in the Alza.cz sales network is guaranteed for 2 years. If you need repair or other services during the warranty period, contact the product seller directly, you must provide the original proof of purchase with the date of purchase.

The following are considered to be a conflict with the warranty conditions, for which the claimed claim may not be

recognized:

- Using the product for any purpose other than that for which the product is intended or failing to follow the instructions for maintenance, operation, and service of the product.
- Damage to the product by a natural disaster, the intervention of an unauthorized person or mechanically through the fault of the buyer (e.g., during transport, cleaning by inappropriate means, etc.).
- Natural wear and aging of consumables or components during use (such as batteries, etc.).
- Exposure to adverse external influences, such as sunlight and other radiation or electromagnetic fields, fluid intrusion, object intrusion, mains overvoltage, electrostatic discharge voltage (including lightning), faulty supply or input voltage and inappropriate polarity of this voltage, chemical processes such as used power supplies, etc.
- If anyone has made modifications, modifications, alterations to the design or adaptation to change or extend the functions of the product compared to the purchased design or use of non-original components.

EU Declaration of Conformity

Identification data of the manufacturer's / importer's authorized representative:

Importer: Alza.cz a.s. Registered office: Jankovcova 1522/53, Holešovice, 170 00 Prague 7 CIN: 27082440

Subject of the declaration:

Title: Smart temperature and Humidity Monitoring Switch

Model / Type: TH Origin/Elite

The above product has been tested in accordance with the standard(s) used to demonstrate compliance with the essential requirements laid down in the Directive(s):

Directive No. 2014/53/EU

Directive No. 2011/65/EU as amended 2015/863/EU



WEEE

This product must not be disposed of as normal household waste in accordance with the EU Directive on Waste Electrical and Electronic Equipment (WEEE – 2012/19 / EU). Instead, it shall be returned to the place of purchase or handed over to a public collection point for the recyclable waste. By ensuring this product is disposed of correctly, you will help prevent potential negative consequences for the environment and human health, which could otherwise be caused by inappropriate waste handling of this product. Contact your local authority or the nearest collection point for further details. Improper disposal of this type of waste may result in fines in accordance with national regulations.



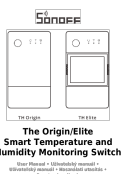





Documents / Resources



[SONOFF The Origin/Elite Smart Temperature and Humidity Monitoring Switch](#) [pdf] User Manual

The Origin Elite Smart Temperature and Humidity Monitoring Switch, The Origin, Elite Smart Temperature and Humidity Monitoring Switch, Humidity Monitoring Switch

References

-  [Welcome to OpenResty!](#)
-  [Welcome to OpenResty!](#)
-  [kit.cc](#)
-  [alza.at](#)
-  [alza.co.uk](#)
-  [alza.de](#)
-  [alza.hu](#)
-  [alza.sk](#)

Manuals+.