



# SONOFF TH Origin Smart Temperature and Humidity Monitoring Switch User Guide

[Home](#) » [SonOFF](#) » SONOFF TH Origin Smart Temperature and Humidity Monitoring Switch User Guide 

## Contents

- [1 SONOFF TH Origin Smart Temperature and Humidity Monitoring Switch](#)
- [2 Device Installation](#)
- [3 Guide to eWeLink and Alexa Accounts Linking](#)
- [4 FCC Warning](#)
- [5 Documents / Resources](#)
- [6 Related Posts](#)



**SONOFF TH Origin Smart Temperature and Humidity Monitoring Switch**



## Device Installation

### Power off

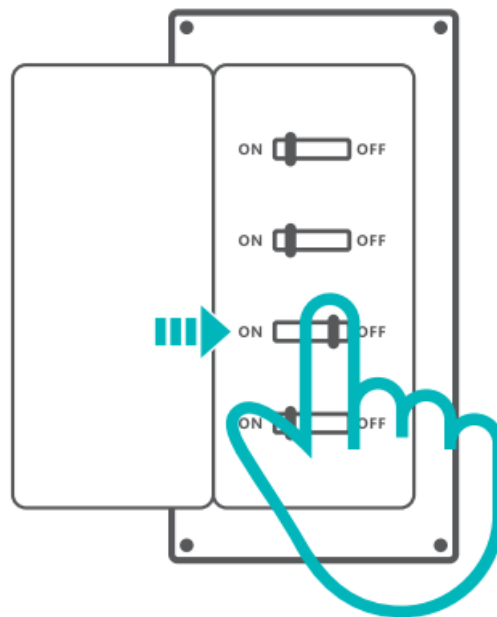

Please install and maintain the device by a professional electrician. To avoid electric shock hazard, do not operate any connection or contact the terminal connector while the device is powered on!

### Wiring instruction

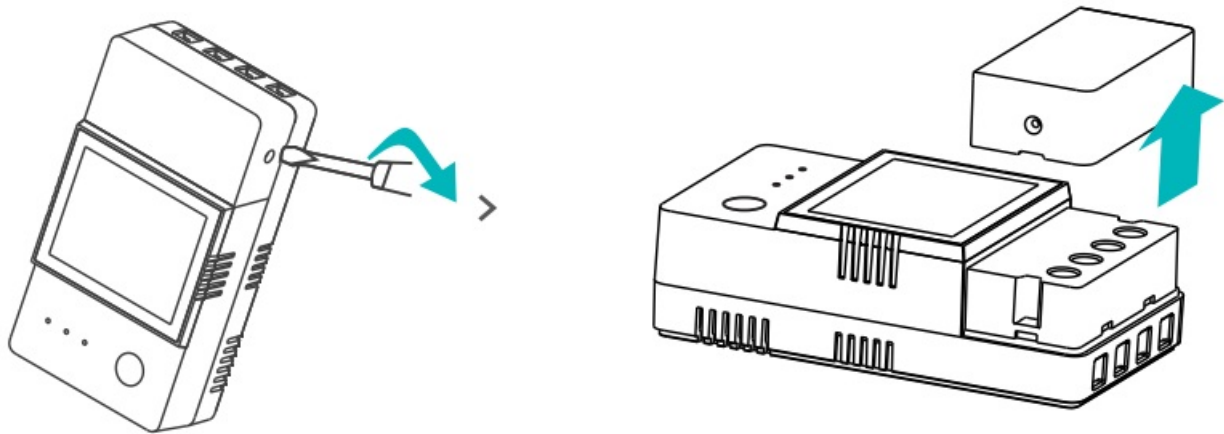

Remove protective cover

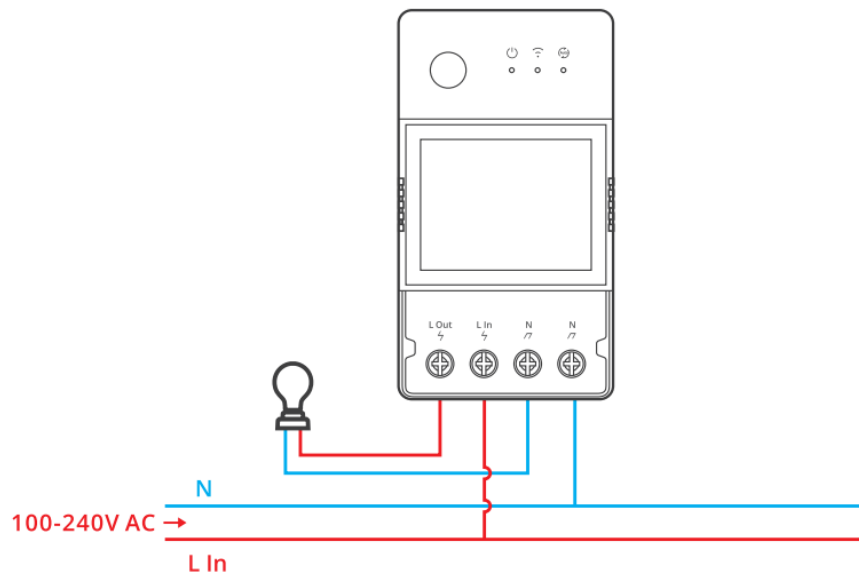

Wiring method of dry contact

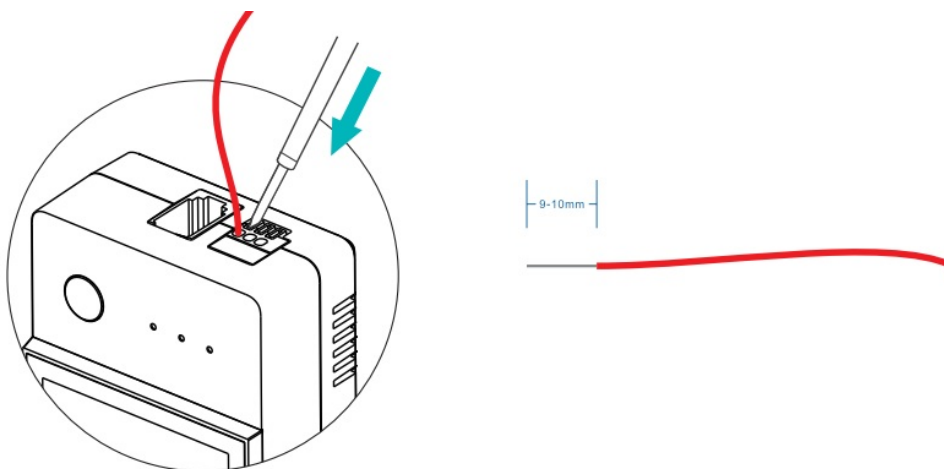

**TH Elite**

Press the white button on the top of the wire connecting hole to insert the wire corresponding, then release.

Dry contact wire conductor size: 0.13-0.5mm<sup>2</sup>, wire stripping length: 9-10mm. Make sure all wires are connected

correctly.

### Insert the sensor

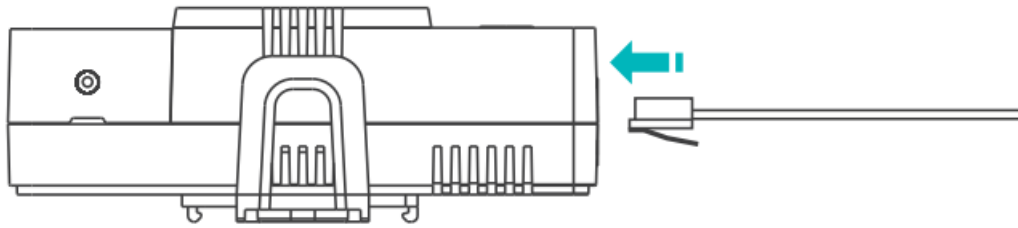

Compatible SONOFF sensors: DS18B20, MS001, THSO1, AM2301, Si7021. Compatible sensor extension cables: RL560.

Some old version sensors need to be used with the accompanying adapter.

### Device pairing

1. Download the eWeLink App



Android™ & iOS

### Power on

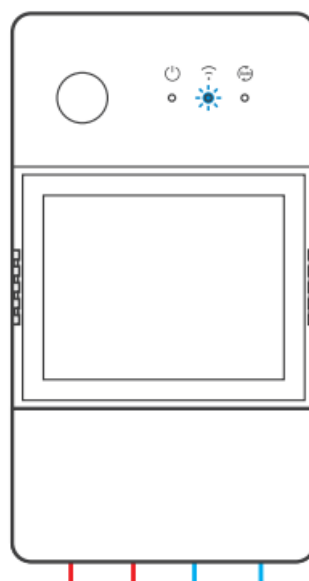

After powering on, the device will enter the Bluetooth Pairing Mode during the first use. The Wi-Fi LED indicator

changes in a cycle of two short and one long flash and release.

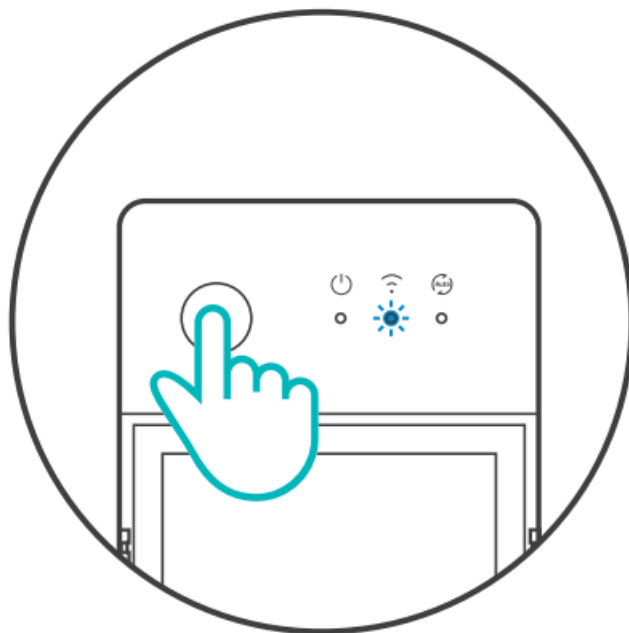

The device will exit the Bluetooth Pairing Mode if not paired within 3mins. If you want to enter this mode, please long press button for about 5s until the Wi-Fi LED indicator changes in a cycle of two short and one long flash and release.

#### Add device

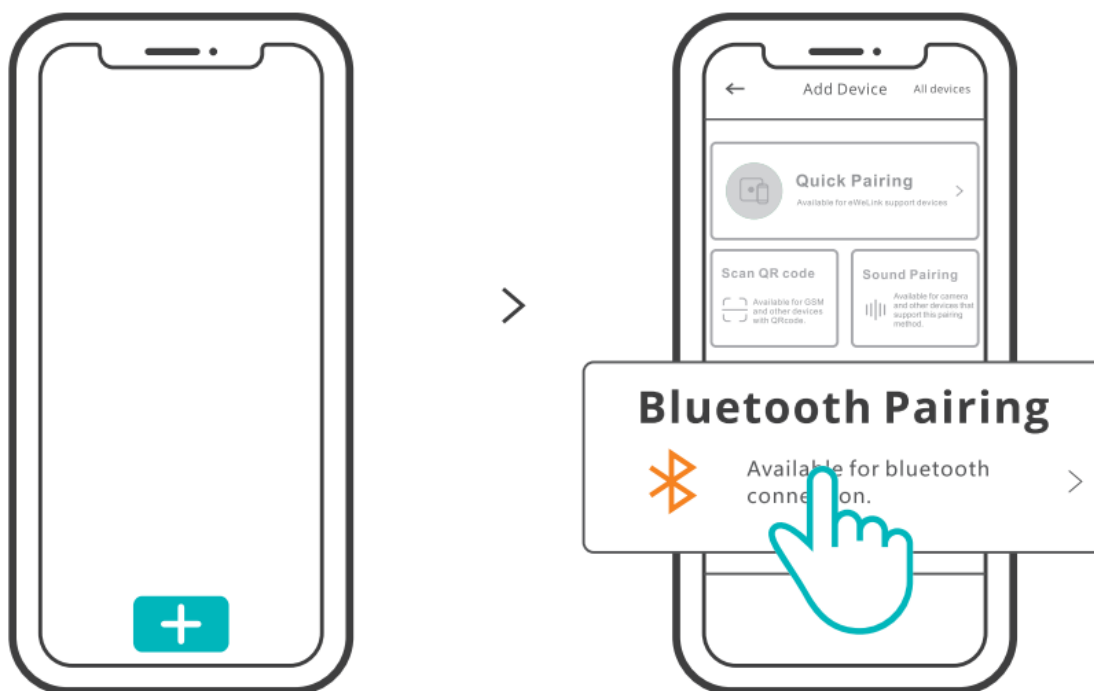

Tap “+” and select “Bluetooth Pairing”, then operate following the prompt on the App.

You can also select “Scan QR code” in the App to pair through scanning the code on the device.

#### Guide to eWeLink and Alexa Accounts Linking



Amazon Alexa

Download the Amazon Alexa App and sign up an account.

Add Amazon Echo Speaker on the Alexa App.

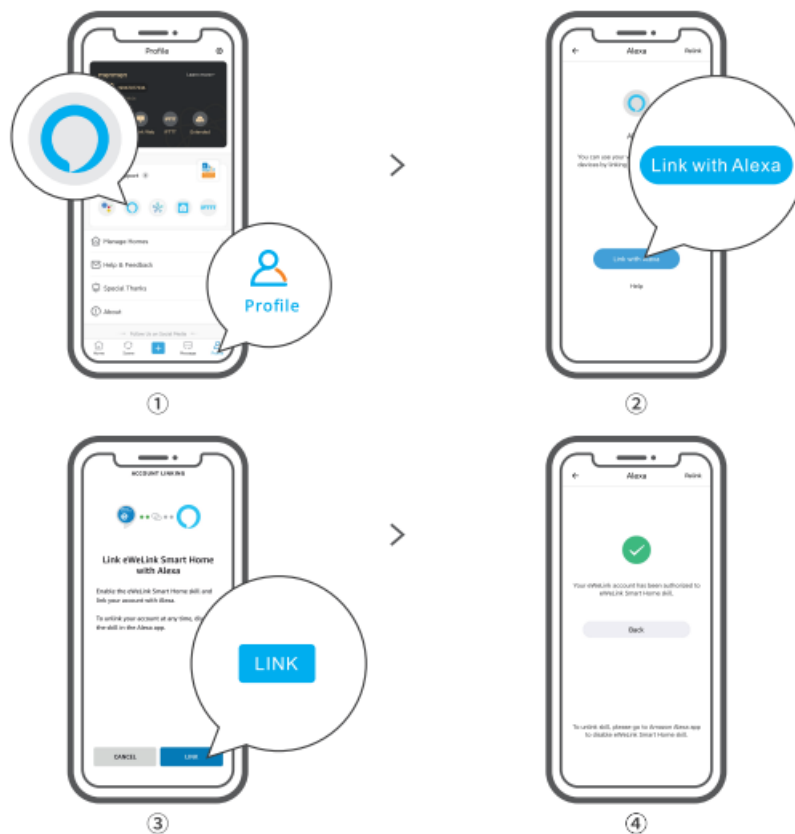

Account Linking (Link Alexa account on the eWeLink App)

After linking the accounts, you can discover devices to connect on the Alexa App according the prompt.

## User Manual



<https://sonoff.tech/usermanuals>

Scan the QR code or visit the website to learn about the detailed user manual and help.

## **FCC Warning**

Changes or modifications not expressly approved by the party responsible for compliance could void the user's authority to operate the equipment. This device complies with part 15 of the FCC Rules. Operation is subject to the following two conditions:

1. This device may not cause harmful interference, and
2. This device must accept any interference received, including interference that may cause undesired operation.

## **FCC Radiation Exposure Statement:**

This equipment complies with FCC radiation exposure limits set forth for an uncontrolled environment. This equipment should be installed and operated with minimum distance 20cm between the radiator & your body. This transmitter must not be co-located or operating in conjunction with any other antenna or transmitter.

## **Note:**

This equipment has been tested and found to comply with the limits for a Class B digital device, pursuant to part 15 of the FCC Rules. These limits are designed to provide reasonable protection against harmful interference in a residential installation. This equipment generates, uses and can radiate radio frequency energy and, if not installed and used in accordance with the instructions, may cause harmful interference to radio communications. However, there is no guarantee that interference will not occur in a particular installation. If this equipment does cause harmful interference to radio or television reception, which can be determined by turning the equipment off and on, the user is encouraged to try to correct the interference by one or more of the following measures:

- Reorient or relocate the receiving antenna.
- Increase the separation between the equipment and receiver.
- Connect the equipment into an outlet on a circuit different from that to which the receiver is connected.
- Consult the dealer or an experienced radio/TV technician for help.

Hereby, Shenzhen Sonoff Technologies Co., Ltd. declares that the radio equipment type THR316, THR316D, THR320, THR320D are in compliance with Directive 2014/53/EU. The full text of the EU declaration of conformity is available at the following internet address: <https://sonoff.tech/usermanuals>

## **Operation frequency Range:**

2402-2480MHz(BLE) 2412-2472MHz(Wi-Fi)

## **RF Output Power:**

8.36dBm(BLE) 18.56dBm(802.11b), 17.93dBm(802.11g), 19.23dBm(802.11n20), 19.44dBm(802.11n 40)(Wi-Fi)

**Shenzhen Sonoff Technologies Co., Ltd.**  
3F&6F, Bldg A, No. 663, Bulong Rd, Shenzhen, Guangdong, China ZIP code: 518000 **Website:** [sonoff.tech](http://sonoff.tech)  
MADE IN CHINA

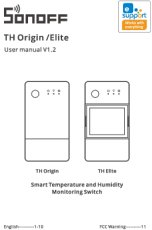

**Documents / Resources**

	<a href="#">SONOFF TH Origin Smart Temperature and Humidity Monitoring Switch</a> [pdf] User Guide TH Origin Smart Temperature and Humidity Monitoring Switch, TH Origin, Smart Temperature and Humidity Monitoring Switch, Temperature and Humidity Monitoring Switch, Humidity Monitoring Switch, Monitoring Switch, Switch, Smart Temperature, Temperature
	<a href="#">SONOFF TH Origin Smart Temperature and Humidity Monitoring Switch</a> [pdf] User Manual TH Elite, THR320D, 2APN5THR320D, THR320D 2APN5THR320D, TH Origin Smart Temperature and Humidity Monitoring Switch, Smart Temperature and Humidity Monitoring Switch, Humidity Monitoring Switch, Monitoring Switch

[Manuals+](#)