



## SONOFF T5 Series Smart Touch Wall Switch User Manual

[Home](#) » [SonOFF](#) » SONOFF T5 Series Smart Touch Wall Switch User Manual 

### SONOFF T5 Series Smart Touch Wall Switch User Manual



## Contents

- 1 Product introduction
- 2 LED Indicator status and instructions
- 3 Operation instruction
- 4 Features
- 5 Installation
- 6 Pairing Method
- 7 Add eWeLink-Remote Sub-devices
- 8 Specifications
- 9 FCC Compliance Statement
- 10 ISED Notice
- 11 WEEE Warning
- 12 EU Declaration of Conformity
- 13 Documents / Resources
  - 13.1 References
- 14 Related Posts

## Product introduction

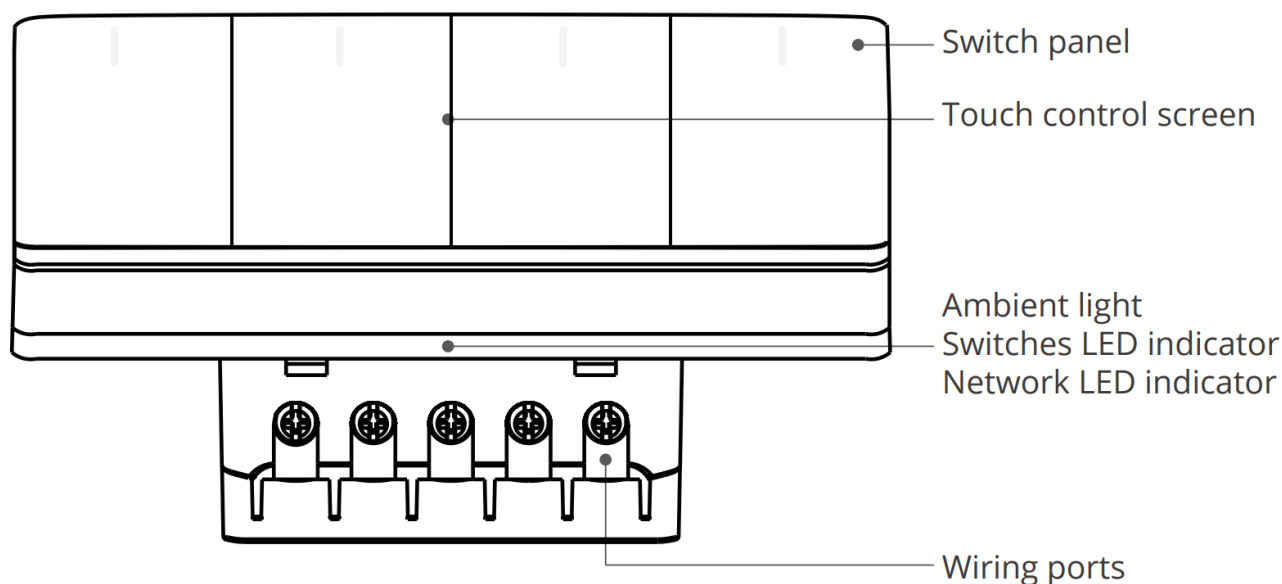

The device weight is less than 1kg, and the recommended installation height is less than 2m.

## LED Indicator status and instructions

LED indicators	LED indicator status	Instructions
Pairing LED indicator	In the "Cycle mode"	Device is in pairing mode
Network LED indicator	Flashes blue quickly once	Device is not connected to router
	Flashes blue quickly twice	Device is connected to the router but not to the cloud

## Operation instruction

- Quick click

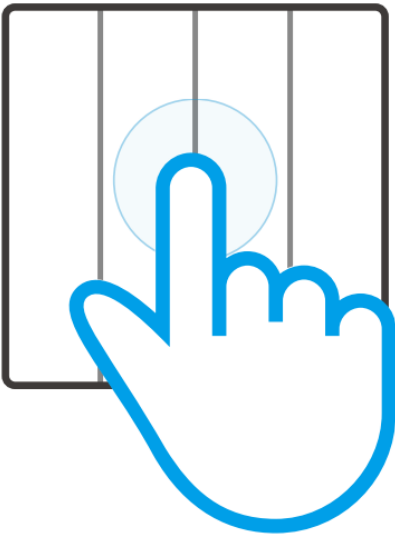

- Long press

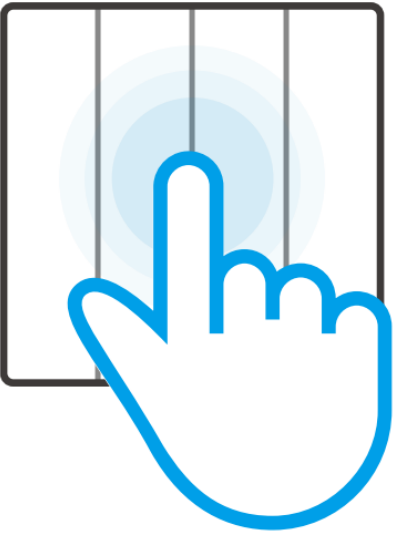

- Swipe

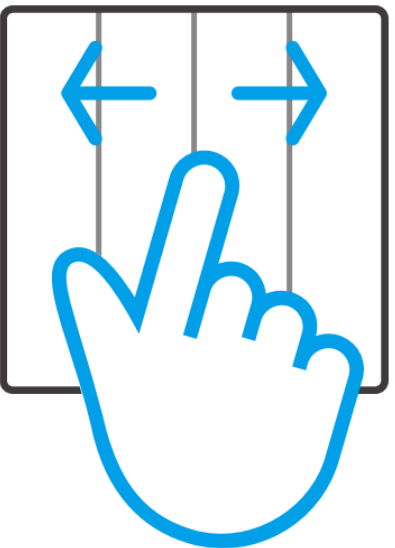

- Multi-point click

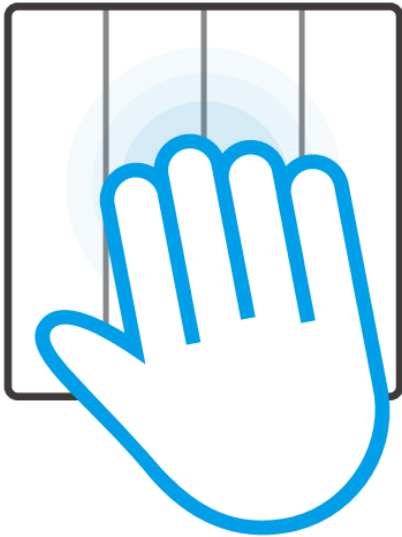

Operations	Instructions	Functions
Quick click	Click the switch panel quickly	Turn on/off the switches and triggered smart scenes
Long press	Long press the switch panel for 5s	Make the device enter the pairing mode
Swipe	Swipe on the switch panel and ensure the swipe distance exceeds 50% of it• T5-86 s upports left/right swipe	Trigger the smart scene
Multi-point click	Multiple fingers click the switch panel	Turn on/off the ambient light manually

## Features

SONOFF TX Ultimate is a smart touch wall switch with LED lights which will produce sound, light and vibration effects when it is turned on/off. After adding in the eWe Link App, you can remote control on/off, switch the ambient lighting modes, set timer and smart scene on the phone.

- Remote Control



- Voice Control



- Smart Scene



- Ambient Lighting Mode



- Touch Vibration



- Light Effects



## Installation

### Power of

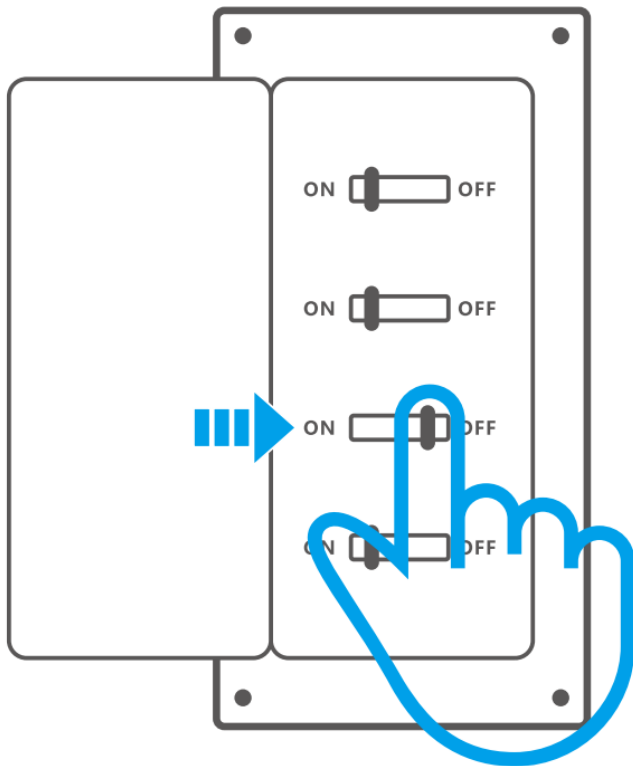

Please install and maintain the device by a professional electrician. To avoid electric shock hazard, do not operate any connection or contact the terminal connector while the device is powered on!

### Wiring instruction

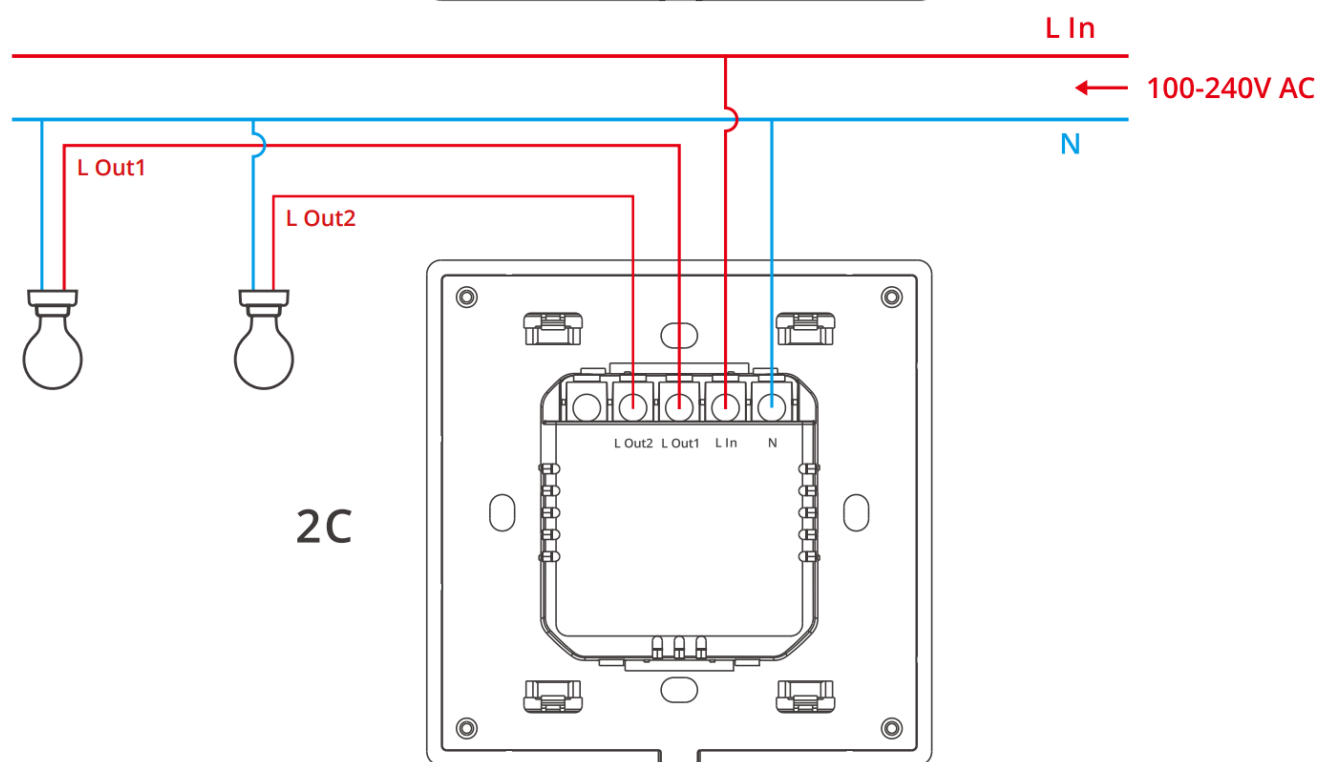
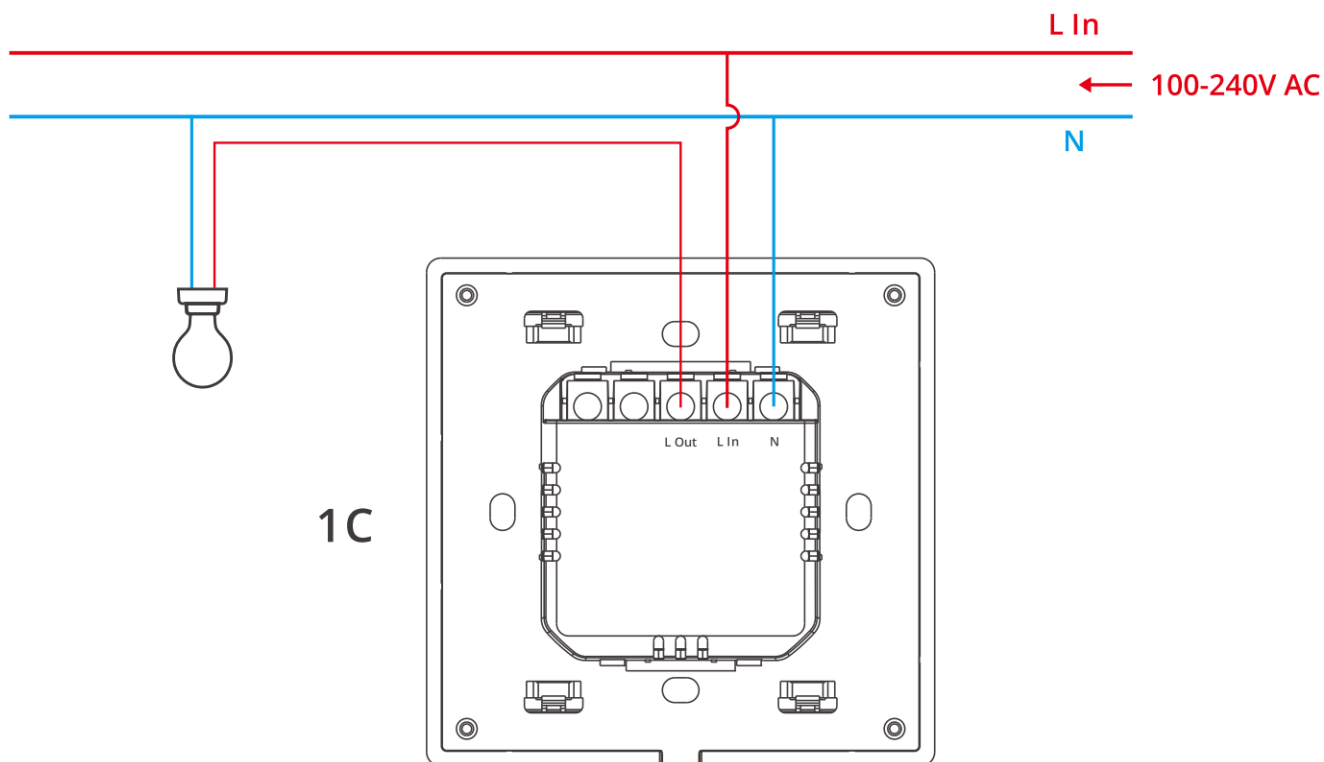

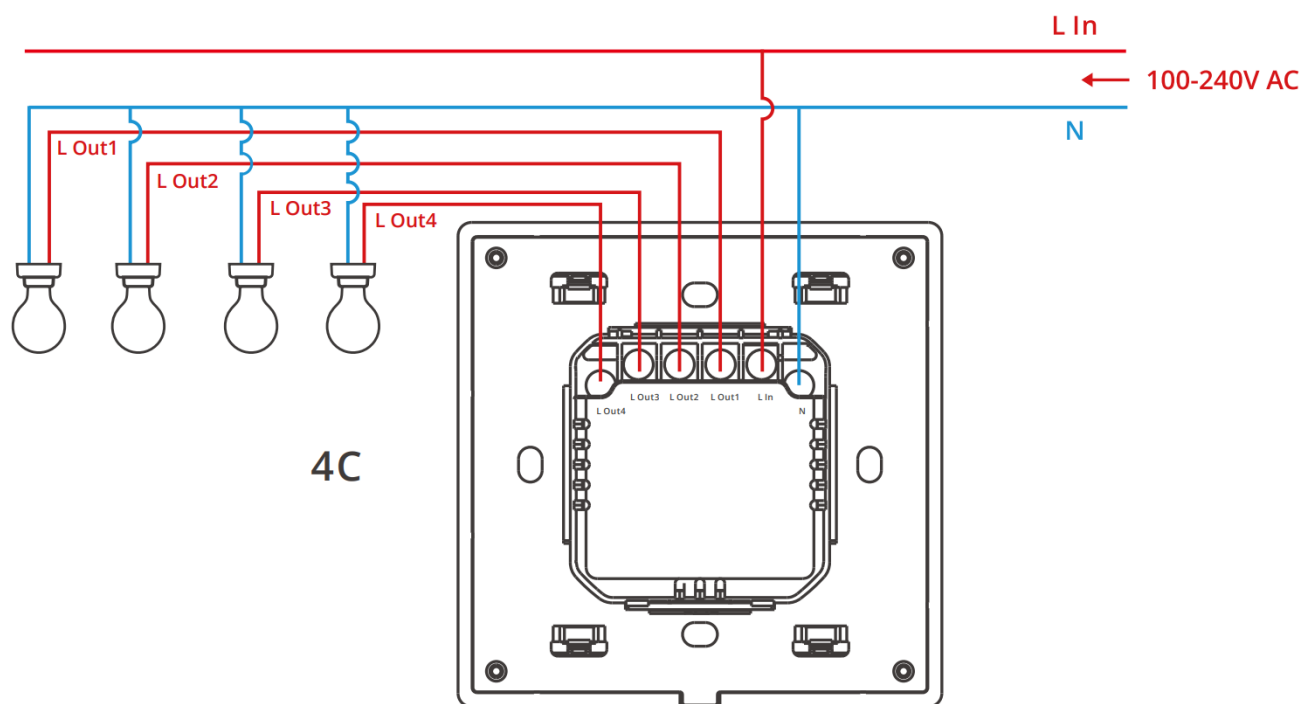
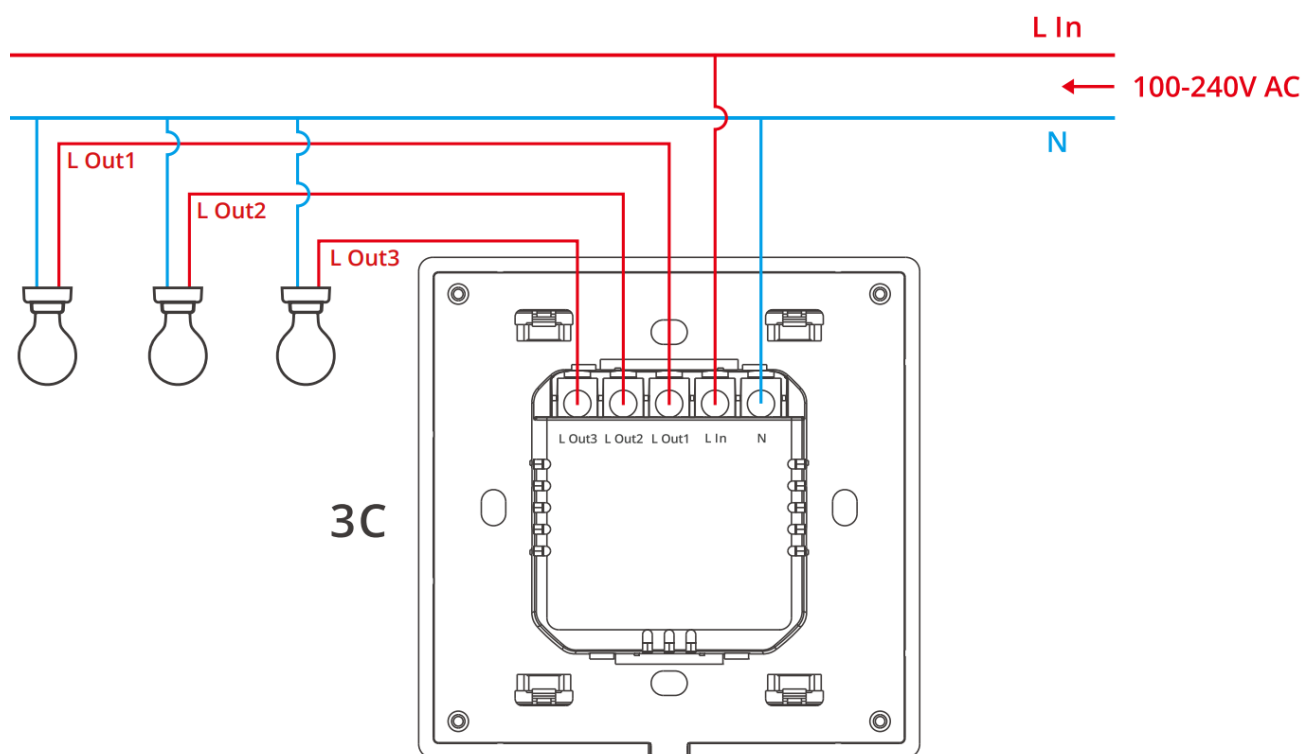

1.  To ensure the safety of your electrical installation, it's essential either a Miniature Circuit Breaker (MCB) or a Residual Current Operated Circuit Breaker (RCBO) with an electrical rating of 10A (T5-1C-86, T5-2C-86), 16A (T5-3C-86, T5-4C-86) has been installed before the TX Ultimate.
2. Make sure all wires are connected correctly.

## Pairing Method

### eWeLink App Pairing

1. Download the eWeLink App



Please download the “eWeLink” App from Google Play Store or Apple App Store.

2. **Power on**

After powering on, the device will enter the Bluetooth pairing mode by default during the first use and the LED frame light will light in the “Cycle mode”.

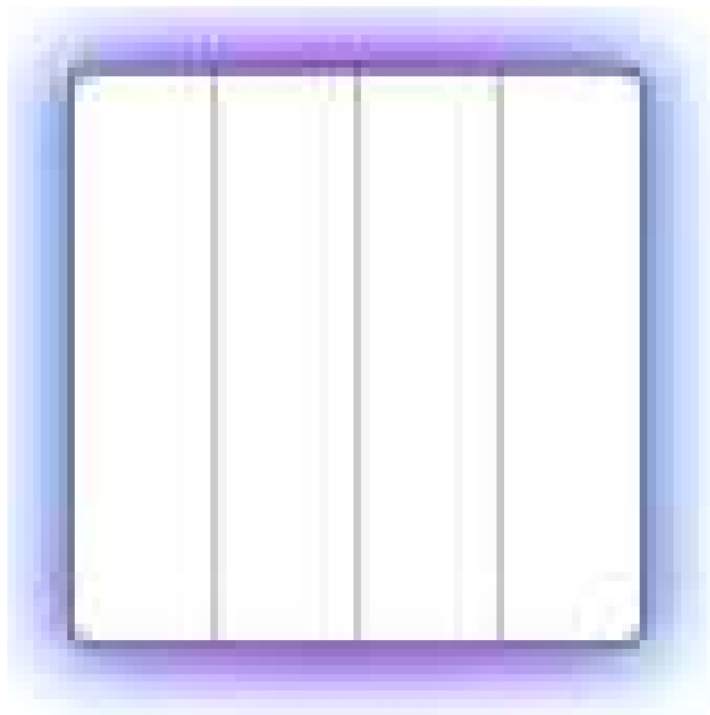

The device will exit the Bluetooth pairing mode when it doesn't be paired successfully within 30mins. If you want to access the pairing mode again, touch the wall switch panel for 5s until the LED frame light lights in the “Cycle mode”.

3. **Add device**

Tap “+” and select “Add Device”, then operate following the prompt on the App.



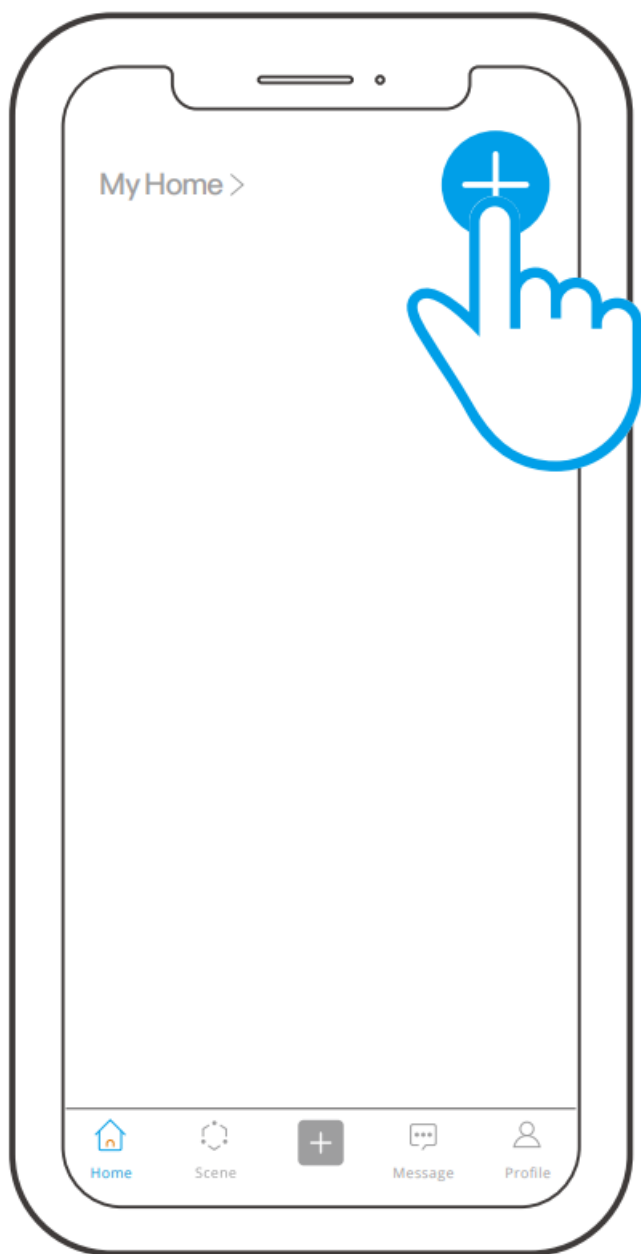

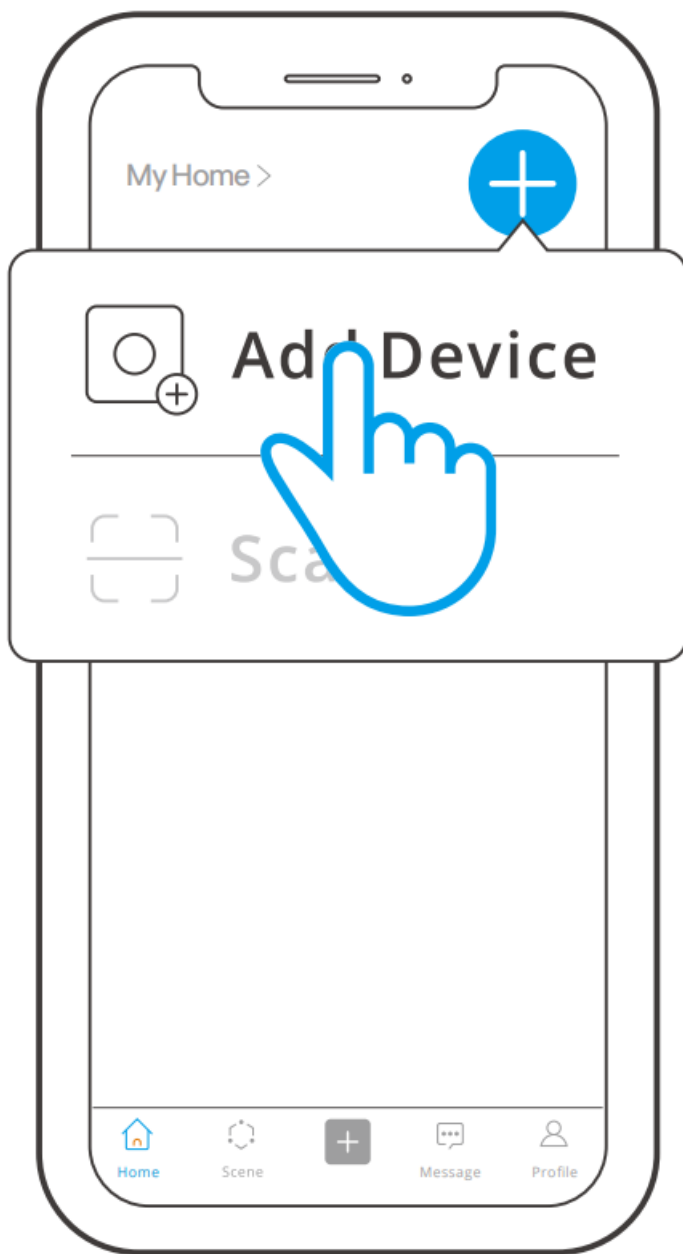

## Add eWeLink-Remote Sub-devices

Enter the Device Settings page on the eWeLink App, select “eWeLink-Remote sub-devices” and tap “Add”, then trigger the sub-device to add it successfully.

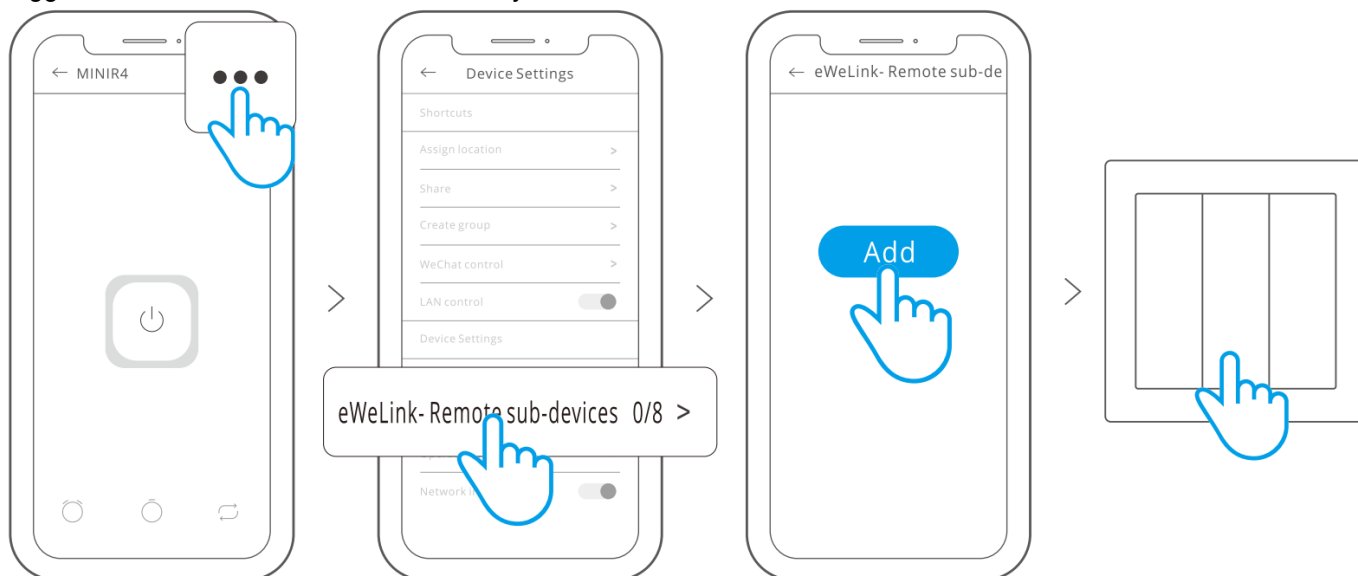

## Specifications

Model	T5-1C-86/T5-2C-86/T5-3C-86/T5-4C-86
Input	1C:100-240V ~ 50/60Hz Max 5A 2C:100-240V ~ 50/60Hz Max 10A 3C:100-240V ~ 50/60Hz Max 15A 4C:100-240V ~ 50/60Hz Max 16A
Output	1C:100-240V ~ 50/60Hz Max 5A 2C:100-240V ~ 50/60Hz Max 5A/Gang 10A/Total 3C:100-240V ~ 50/60Hz Max 5A/Gang 15A/Total 4C:100-240V ~ 50/60Hz Max 4A/Gang 16A/Total
LED load	1C: 150W Max@240V, 75W Max@100V 2C: 150W Max@240V/Gang, 75W Max@100V/Gang 3C: 150W Max@240V/Gang, 75W Max@100V/Gang 4C: 150W Max@240V/Gang, 75W Max@100V/Gang
Wi-Fi	IEEE 802.11b/g/n 2.4GHz
Working temperature	-10°C ~ 40°C
Working humidity	5% ~ 95%RH,non-condensing
Color	White
Casing material	PC +CRS
Dimension	86x86x39mm

## FCC Compliance Statement

This device complies with part 15 of the FCC Rules. Operation is subject to the following two conditions:

1. This device may not cause harmful interference, and
2. This device must accept any interference received, including interference that may cause undesired operation.
3. Changes or modifications not expressly approved by the party responsible for compliance could void the user's authority to operate the equipment.

**Note:** This equipment has been tested and found to comply with the limits for a Class B digital device, pursuant to part 15 of the FCC Rules. These limits are designed to provide reasonable protection against harmful interference in a residential installation. This equipment generates, uses and can radiate radio frequency energy and, if not installed and used in accordance with the instructions, may cause harmful interference to radio communications. However, there is no guarantee that interference will not occur in a particular installation. If this equipment does cause harmful interference to radio or television reception, which can be determined by turning the equipment off and on, the user is encouraged to try to correct the interference by one or more of the following measures:

- Reorient or relocate the receiving antenna.
- Increase the separation between the equipment and receiver.
- Connect the equipment into an outlet on a circuit different from that to which the receiver is connected.
- Consult the dealer or an experienced radio/TV technician for help.

## FCC Radiation Exposure statement:

This equipment complies with FCC radiation exposure limits set forth for an uncontrolled environment. This

equipment should be installed and operated with minimum distance of 20 cm between the radiator and your body. This transmitter must not be co-located or operating in conjunction with any other antenna or transmitter.

## ISED Notice

This device contains licence-exempt transmitter(s)/receiver(s) that comply with Innovation, Science and Economic Development Canada's licence-exempt RSS(s).

Operation is subject to the following two conditions:

1. This device may not cause interference.
2. This device must accept any interference, including interference that may cause undesired operation of the device.

This Class B digital apparatus complies with Canadian ICES-003.

This device complies with RSS-247 of Industry Canada.

Operation is subject to the condition that this device does not cause harmful interference.

## WEEE Warning



**WEEE Disposal and Recycling Information** All products bearing this symbol are waste electrical and electronic equipment (WEEE as in directive 2012/19/EU) which should not be mixed with unsorted household waste. Instead, you should protect human health and the environment by handing over your waste equipment to a designated collection point for the recycling of waste electrical and electronic equipment, appointed by the government or local authorities. Correct disposal and recycling will help prevent potential negative consequences to the environment and human health. Please contact the installer or local authorities for more information about the location as well as terms and conditions of such collection points.

Scatola	Scatola	Manuale	Neto
PAP 20	PAP 21	PAP 22	EVA 7
Carta	Carta	Carta	Plastica
RACCOLTA DIFFERENZIATA			
Verifica le disposizioni del tuo Comune. Separate le componenti e conferiscile in modo corretto.			

## EU Declaration of Conformity

Hereby, Shenzhen Sonoff Technologies Co., Ltd. declares that the radio equipment type T5-1C-86, T5-2C-86, T5-3C-86, T5-4C-86 are in compliance with Directive 2014/53/EU. The full text of the EU declaration of conformity is available at the following internet address:

<https://sonoff.tech/usermanuals>

## For CE Frequency:

Operation frequency Range:

2402-2480MHz(BLE)

802.11 b/g/n20: 2412-2472MHz

802.11 n40 2422-2462MHz

## RF Output Power:

2dBm(BLE)

15dBm(802.11b), 14dBm(802.11g), 15dBm(802.11n20),

16dBm(802.11n40)(Wi-Fi)

**Shenzhen Sonoff Technologies Co., Ltd.**

3F & 6F, Bldg A, No. 663, Bulong Rd, Shenzhen, Guangdong, China

**ZIP code:** 518000

**Website:** sonoff.tech

MADE IN CHINA



Points de collecte sur [www.quefairedemesdechets.fr](http://www.quefairedemesdechets.fr) Privilégiez la réparation ou le don de votre appareil !

# SONOFF

## Documents / Resources

	<p><b>SONOFF T5 Series Smart Touch Wall Switch</b> [pdf] User Manual T5-1C-86, T5-2C-86, T5-3C-86, T5-4C-86, T5 Series Smart Touch Wall Switch, Smart Touch Wall Switch, Touch Wall Switch, Wall Switch</p>
-------------------------------------------------------------------------------------	-----------------------------------------------------------------------------------------------------------------------------------------------------------------------------------------------------------------

## References

- [User Manual](#)

Manuals+.