

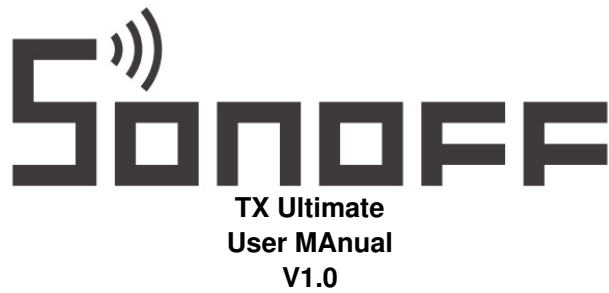

SonoFF T5-1C-86 TX Ultimate Smart Touch Wall Switch User Manual

[Home](#) » [SonOFF](#) » SonoFF T5-1C-86 TX Ultimate Smart Touch Wall Switch User Manual 

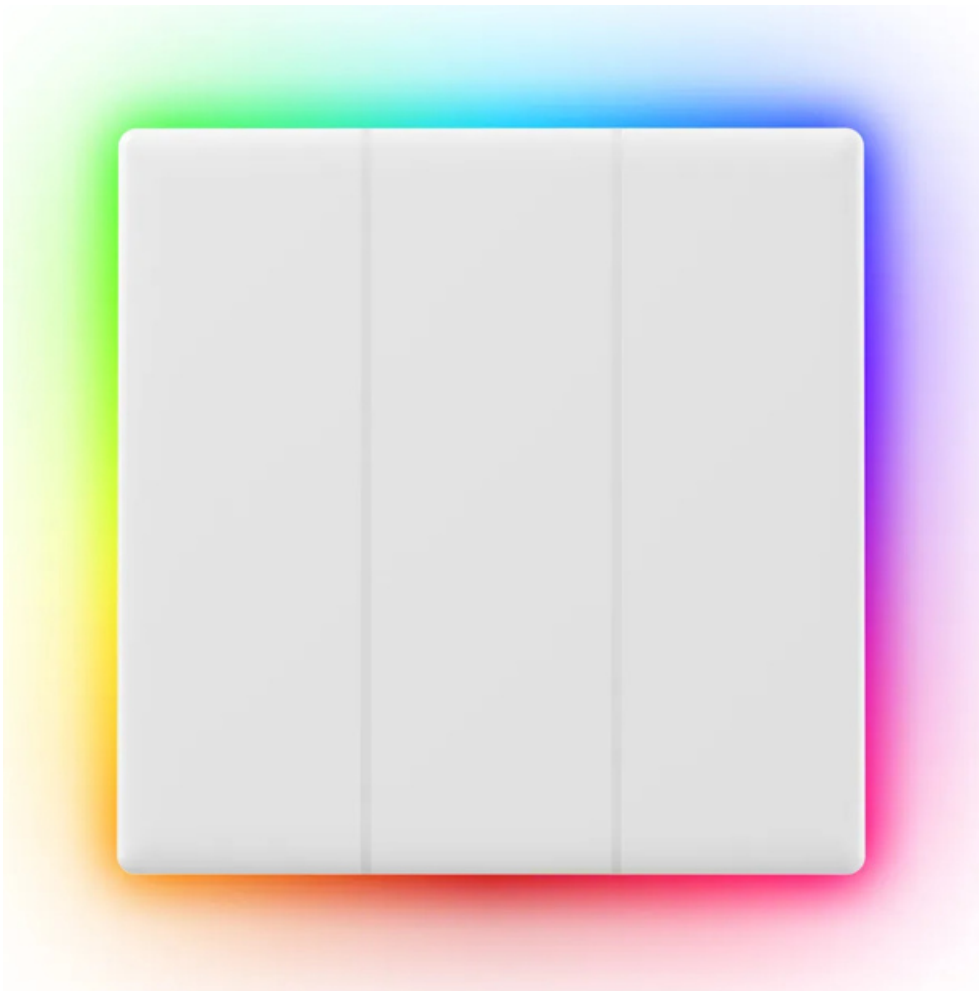



Smart Touch Wall Switch



Contents

- [1 Product introduction](#)
- [2 LED Indicator status and instruction](#)
- [3 Operation instruction](#)
- [4 Features](#)
- [5 Installation](#)
- [6 Pairing Method](#)
- [7 Amazon Frustration-Free Setup \(FFS\)](#)
- [8 Add eWeLink-Remote Sub-devices](#)
- [9 Specifications](#)
- [10 Documents / Resources](#)
 - [10.1 References](#)
- [11 Related Posts](#)

Product introduction

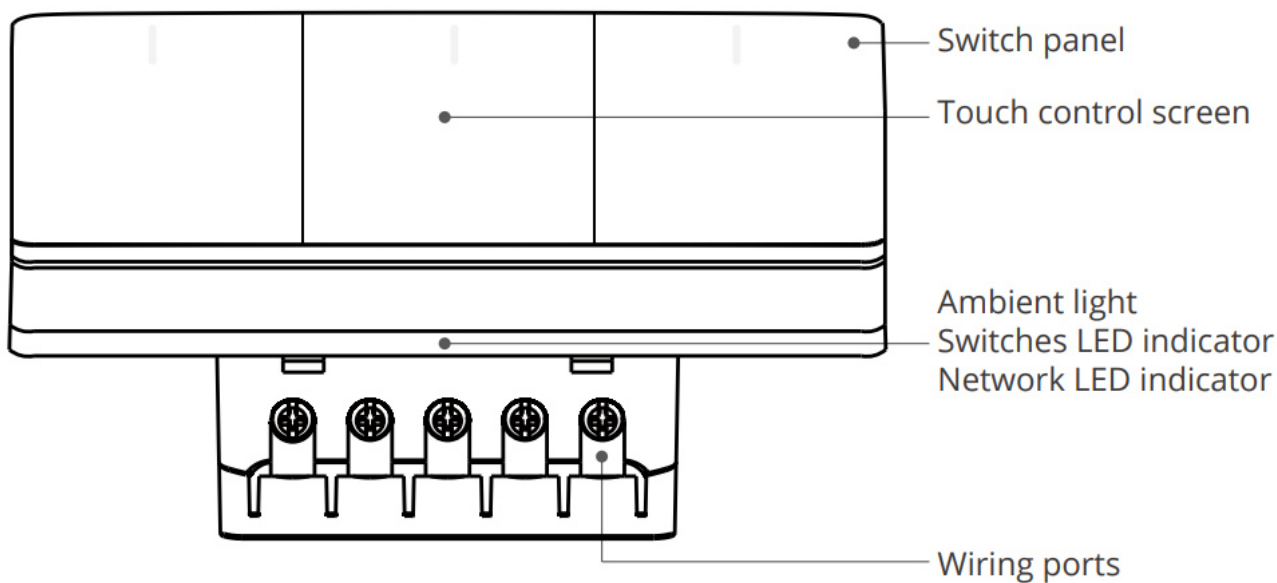

⚠ The device weight is less than 1kg, and the recommended installation height is less than 2m.

LED Indicator status and instruction

LED indicators	LED indicator status	Instructions
Pairing LED indicator	In the "Cycle mode"	Device is in pairing mode
Network LED indicator	Flashes blue quickly once	Device is not connected to router
	Flashes blue quickly twice	Device is connected to the router but not to the cloud

Operation instruction

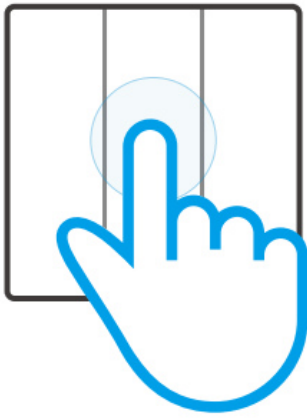

Quick click

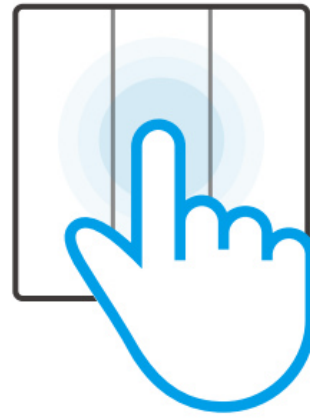

Long press

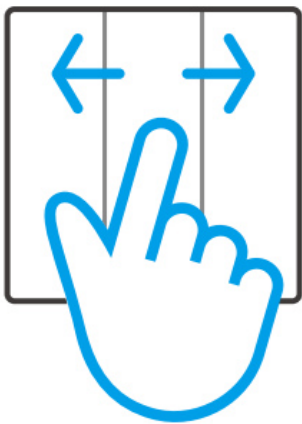

Swipe

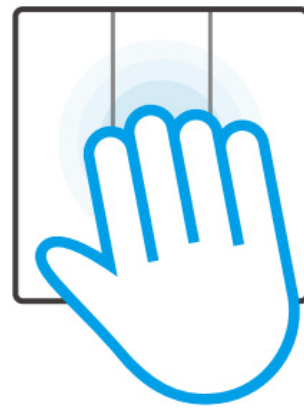

Multi-point click

Operations	Instructions	Functions
Quick click	Click the switch panel quickly	Turn on/off the switches and trigger the smart scenes
Long press	Long press the switch panel for 5s	Make the device enter the pairing mode
Swipe	Swipe on the switch panel and ensure the swipe distance exceeds 50% of it • T5-86 supports left/right swipe	Trigger the smart scene
Multi-point click	Multiple fingers click the switch panel	Turn on/off the ambient light manually

Features

SONOFF TX Ultimate is a smart touch wall switch with LED lights which will produce sound, light and vibration effects when it is turned on/off. After adding in the eWeLink App, you can remote control on/off, switch the ambient lighting modes, set timer and smart scene on the phone.



Remote Control



Voice Control



Smart Scene



Ambient Lighting Mode



Touch Vibration



Light Effects

Installation

1. Power off

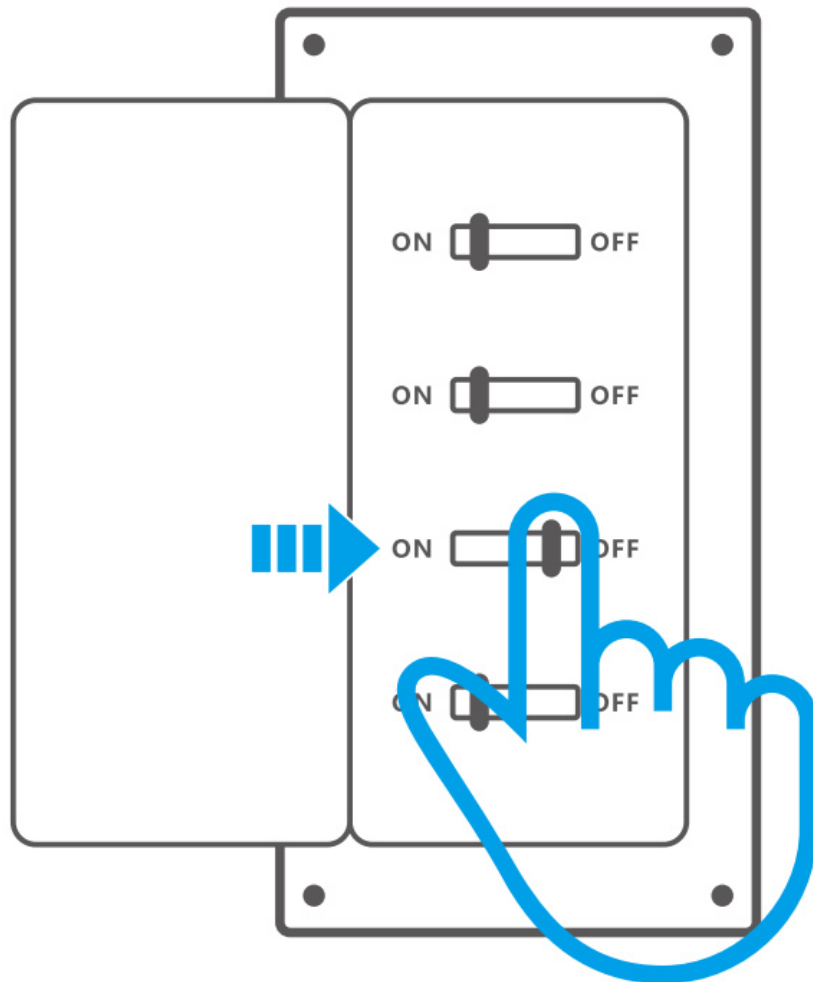

Please install and maintain the device by a professional electrician. To avoid electric shock hazard, do not operate any connection or contact the terminal connector while the device is powered on!

2. Wiring instruction

Before installing the device, please install an air switch as the protective device (Air switch 16A/250V).

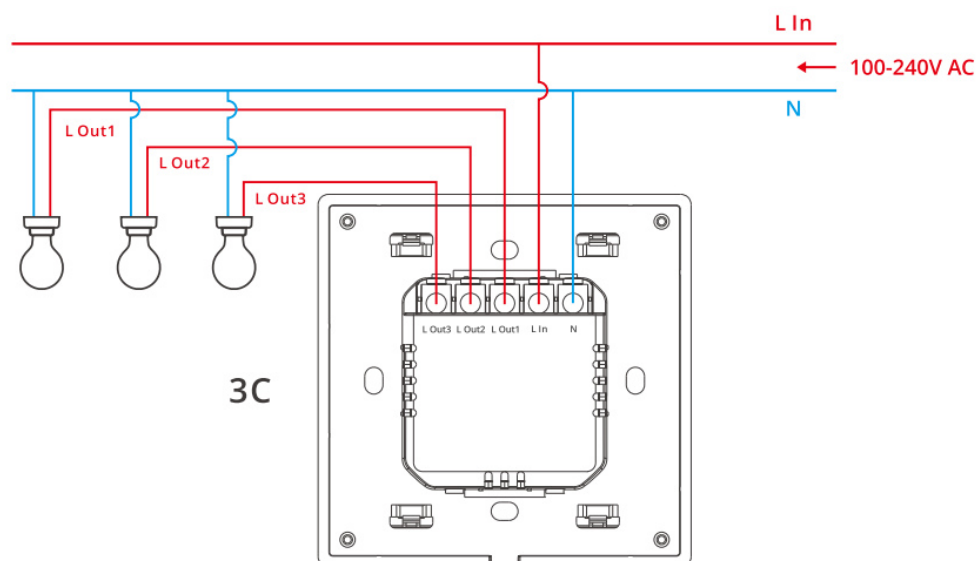
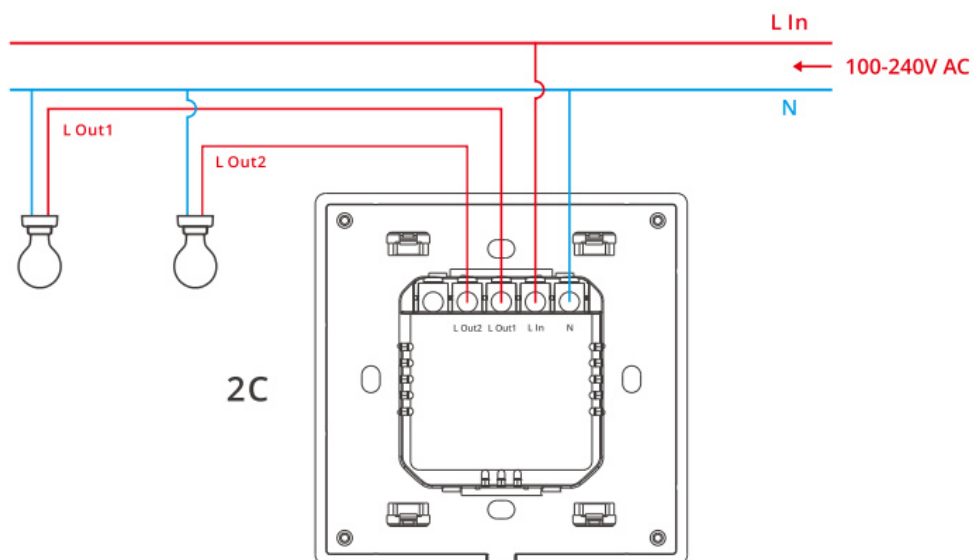
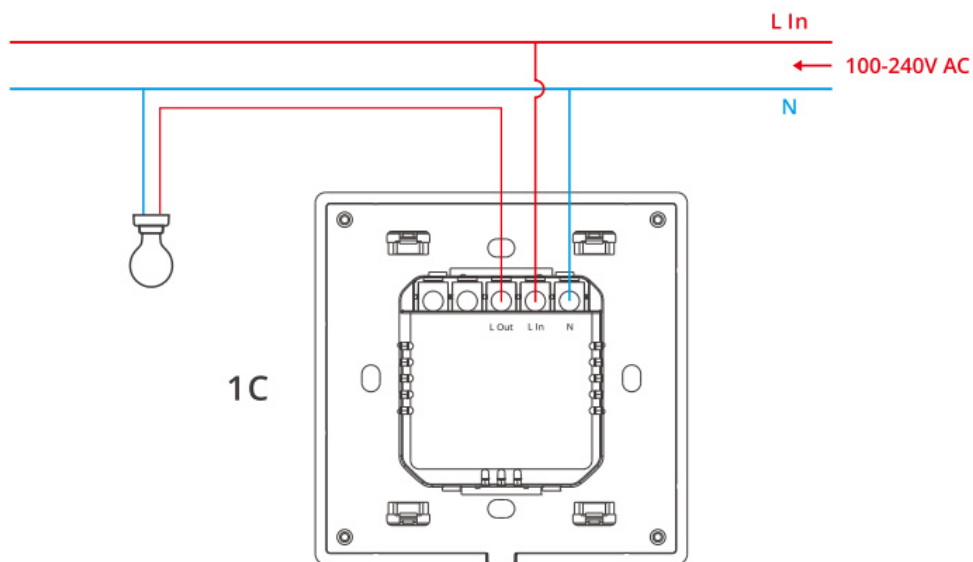

⚠ Make sure all wires are connected correctly.

Pairing Method

1. eWeLink App Pairing

1-1 Download the eWeLink App

Please download the “eWeLink” App from Google Play Store or Apple App Store.



1-2 Power on

After powering on, the device will enter the Bluetooth pairing mode by default during the first use and the LED frame light will light in the “Cycle mode”.

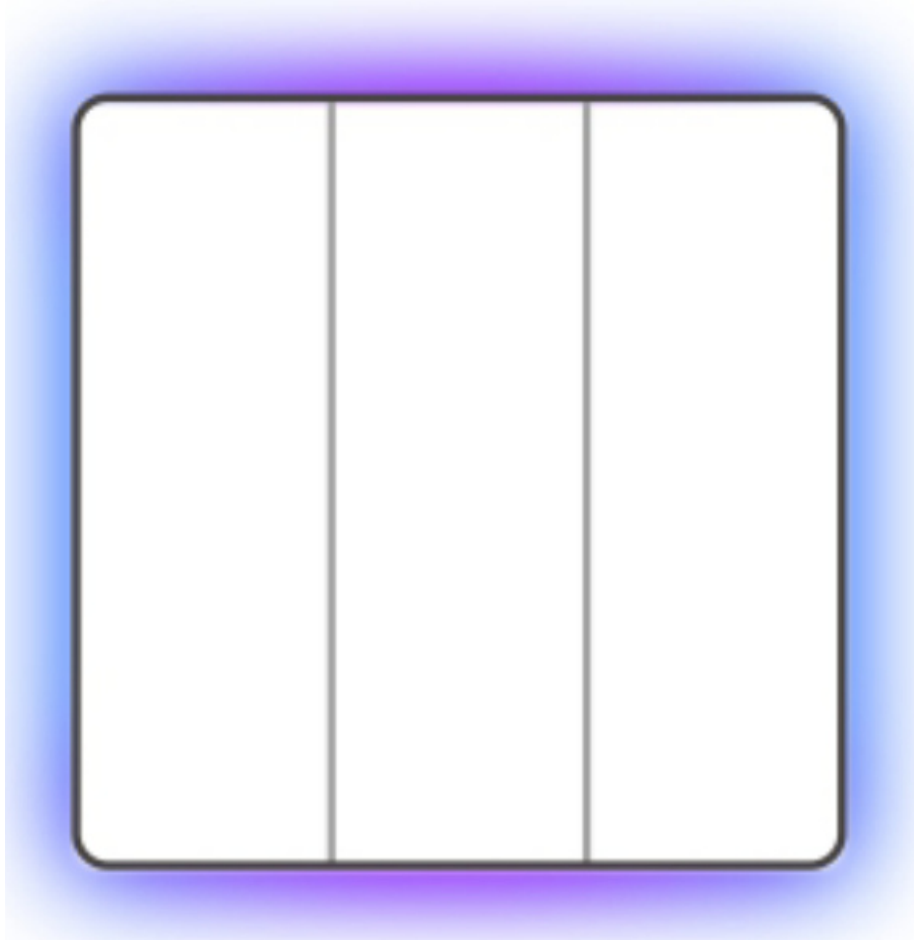

The device will exit the Bluetooth pairing mode when it doesn't be paired successfully within 10mins. If you want to access the pairing mode again, touch the wall switch panel for 5s until the LED frame light lights in the “Cycle mode”.

1-3 Add device

Tap “+” and select “Bluetooth Pairing”, then operate following the prompt on the App.

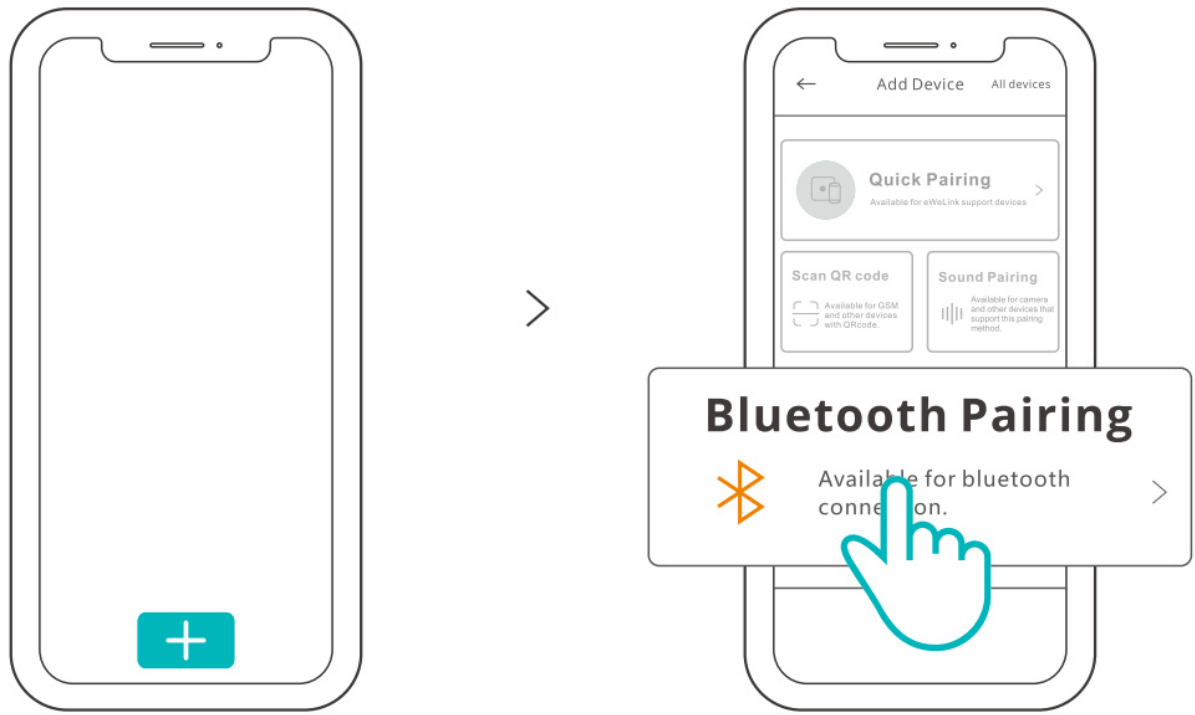

Amazon Frustration-Free Setup (FFS)

Applicable situation: The account you use to purchase this device on Amazon.com is the same as the Alexa account you sign in the smart speaker (with Certified for Humans badge).

2-1

After power on the device, it will enter the FFS pairing mode by default (LED indicator flashes in "Cycle mode").

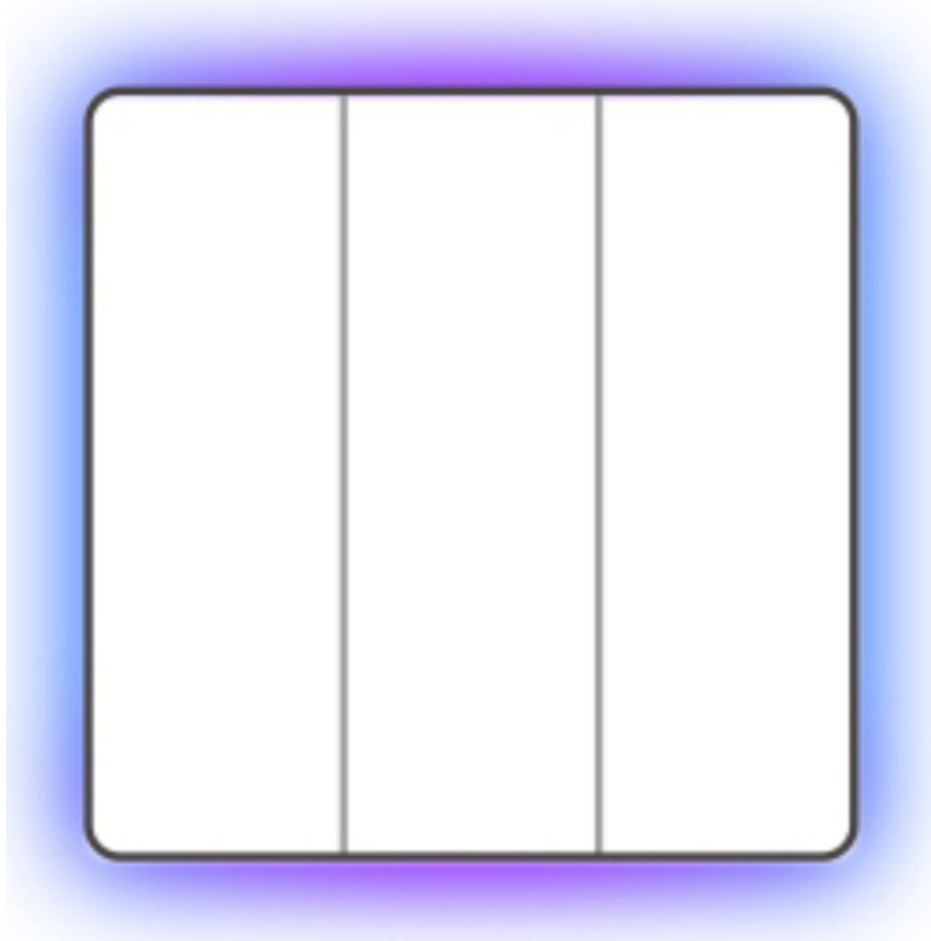

When you hear “New switch found” after powering on for about 1-2 mins, refresh the device list in the Alexa App and you will see the device is added successfully.



<https://sonoff.tech/product-review/tutorial/works-with-alexa-instruction-guide/>

1. The device will exit FFS pairing mode if it had not been paired within 30mins. If you want to enter the pairing mode again, please long press the switch panel for 5s until the LED indicator flashes in “cycle mode”.
2. If the device cannot be paired through FFS pairing mode for a long time, please pair the device by method (1) eWeLink App pairing.
3. The method of FFS pairing can only be used to add devices to Alexa App.
4. If you want to synchronize this device between eWeLink App and Alexa App, please connect the accounts of eWeLink and Alexa through Account Linking, scan the QR code or enter the URL to check the guideline of Account Linking.

Add eWeLink-Remote Sub-devices

Enter the Device Settings page on the eWeLink App, select “eWeLink-Remote sub-devices” and tap “Add”, then trigger the sub-device to add it successfully.

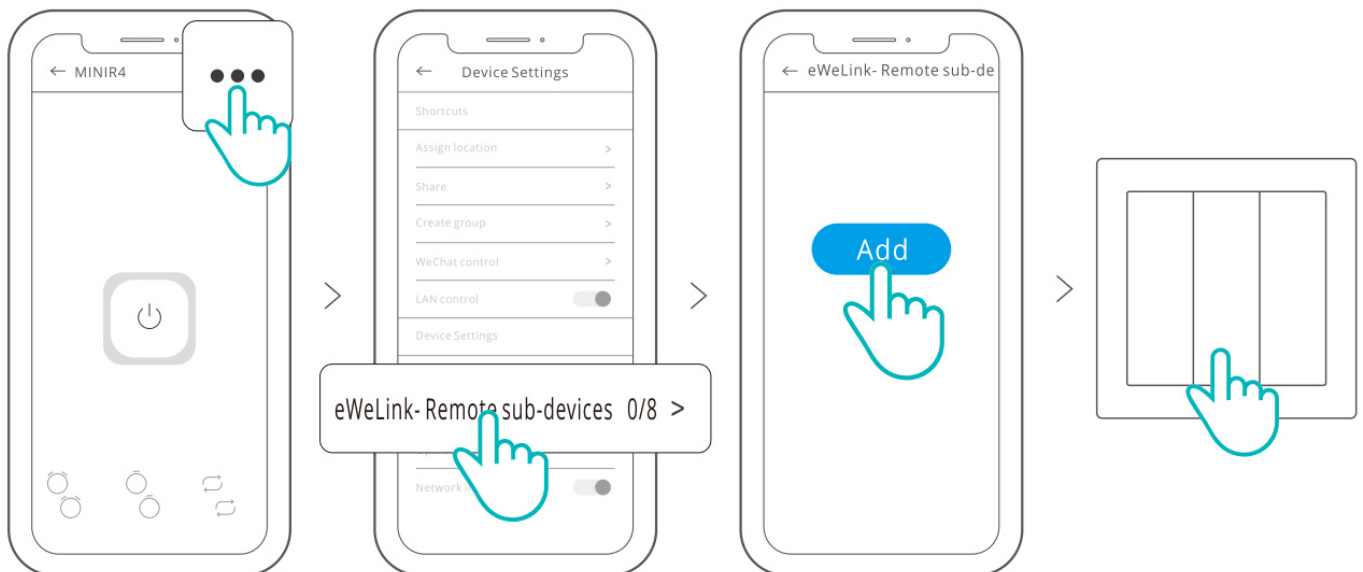

Specifications

Model	T5-1C-86/T5-2C-86/T5-3C-86
Input	1C:100-240V ~ 50/60Hz Max 5A 2C:100-240V ~ 50/60Hz Max 10A 3C:100-240V ~ 50/60Hz Max 15A
Wi-Fi	1C:100-240V ~ 50/60Hz Max 5A 2C:100-240V ~ 50/60Hz Max 5A/Gang 10A/Total 3C:100-240V ~ 50/60Hz Max 5A/Gang 15A/Total
Working temperature	IEEE 802.11b/g/n 2.4GHz
Working humidity	-10°C ~ 40°C
Casing material	5% ~ 95% RH, non-condensing
Dimension	White
Output	PC
Color	86x86x39mm



Documents / Resources

	<p>SonomFF T5-1C-86 TX Ultimate Smart Touch Wall Switch [pdf] User Manual T5-86 V1.0, T5-1C-86 TX Ultimate Smart Touch Wall Switch, T5-1C-86, TX Ultimate Smart Touch Wall Switch, Smart Touch Wall Switch, Touch Wall Switch, Wall Switch, Switch</p>
---	--

References

- [Amazon.com](#)
- [Works with Alexa Instruction Guide - SONOFF Official](#)
- [User Manual](#)