

SONOFF SWITCH-WF WiFi Smart Switch Instruction Manual

[Home](#) » [SonOFF](#) » SONOFF SWITCH-WF WiFi Smart Switch Instruction Manual 

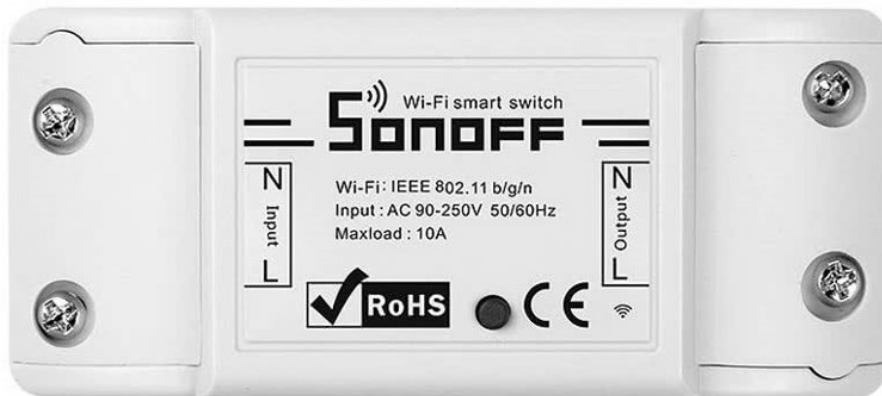

SWITCH-WF WiFi



SWITCH-WF WiFi Smart

Contents

- [1 Operating Instruction](#)
- [2 Compatible Pairing Mode](#)
- [3 Specifications](#)
- [4 Product Introduction](#)
- [5 Wi-Fi led indicator status instruction](#)
- [6 Features](#)
- [7 Switch Network](#)
- [8 Factory Reset](#)
- [9 Common Problems](#)
- [10 FCC Warning](#)
- [11 Documents / Resources](#)
- [12 Related Posts](#)

Operating Instruction

1. Power off

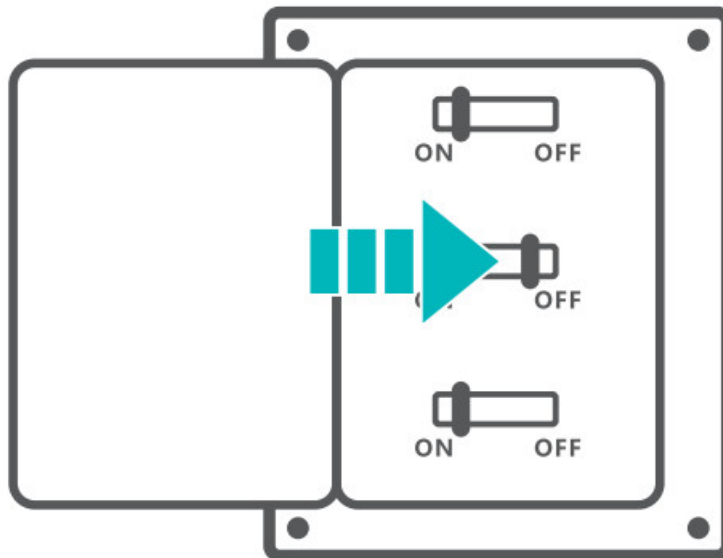

To avoid electric shocks, please consult the dealer or a qualified professional for help when installing and repairing!

2. Wiring instruction

One live wire wiring instruction:

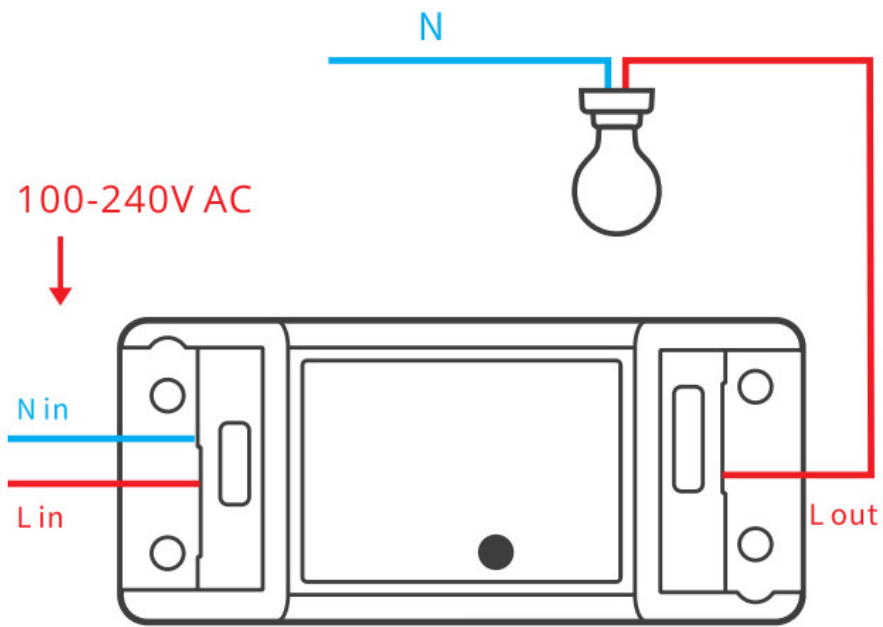

Ceiling lamp wiring instruction:

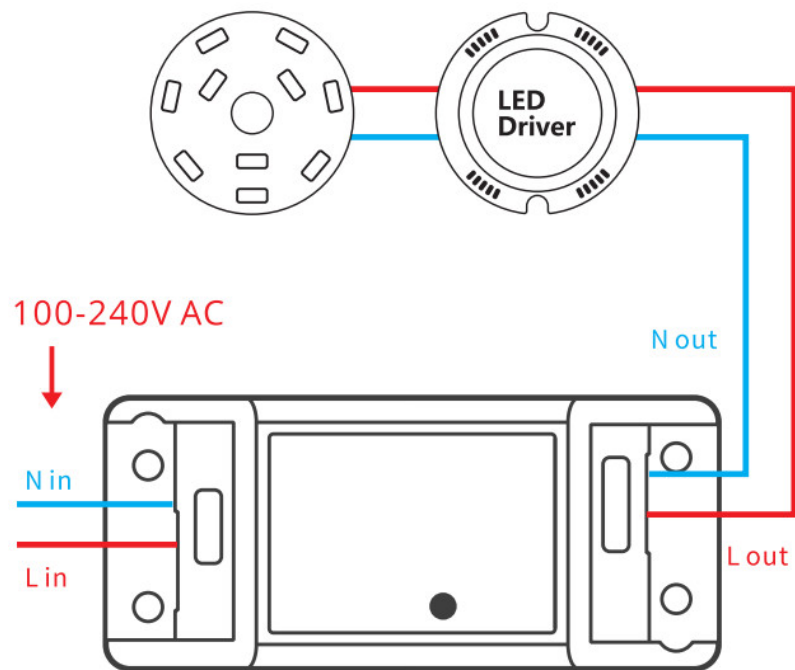

Make sure the neutral wire and live wire connection is correct.

3. Download “eWeLink” APP

<div><div> eWeLink</div><div> Download on the App Store</div><div> GET IT ON Google Play</div></div>	
http://app.coolkit.cc/dl.html	

4. Power on

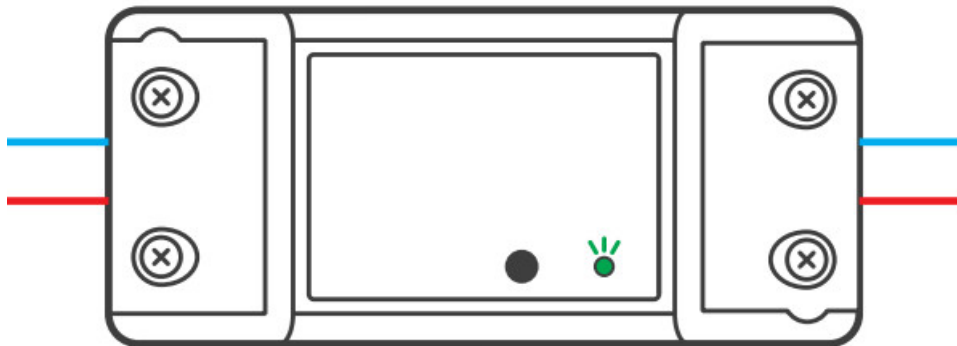

After powering on, the device will enter the quick pairing mode (Touch) during the first use. The Wi-Fi LED indicator changes in a cycle of two short and one long flash and release.



The device will exit the quick pairing mode (Touch) if not paired within 3mins. If you want to enter this mode, please long press the Pairing button for about 5s until the Wi-Fi LED indicator changes in a cycle of two short and one long flash and release.

5. Add the device

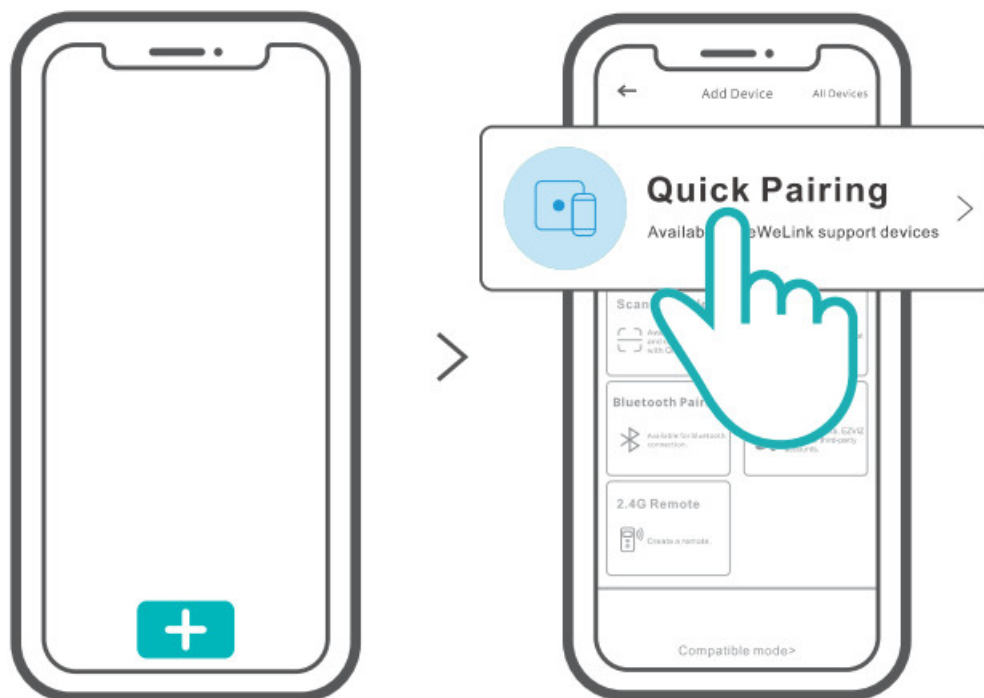

Tap “+” and select “Quick Pairing”, then operate following the prompt on the APP.

Compatible Pairing Mode

If you fail to enter Quick Pairing Mode (Touch), please try “Compatible Pairing Mode” to pair.

1. Long press Pairing button for 5s until the Wi-Fi LED indicator changes in a cycle of two short flashes and one long flash and release. Long press the Pairing button for 5s again until the Wi-Fi LED indicator flashes quickly. Then, the device enters Compatible Pairing Mode. 2. Tap “+” and select “Compatible Pairing Mode” on APP.

For Android system: Enter Wi-Fi password and tap “Next”. Be patient until pairing completes.

For iOS system: Enter Wi-Fi password, tap “Next” and then “Connect”. Select Wi-Fi SSID with ITEAD-***** and enter the password 12345678, and then go back to the eWeLink app and tap “Next”. Be patient until pairing completes.

Specifications

Model	SWITCH-WF
Input	100-240V AC 50/60Hz
Output	100-240VAC 50/60Hz
Max. Load	2200W/10A
Operating Systems	(Android 4.1 & iOS 9.0) or higher
Wi-Fi	IEEE 802.11 b/g/n 2.4GHz
Material	ABS
Dimension	88x39x24mm

Product Introduction

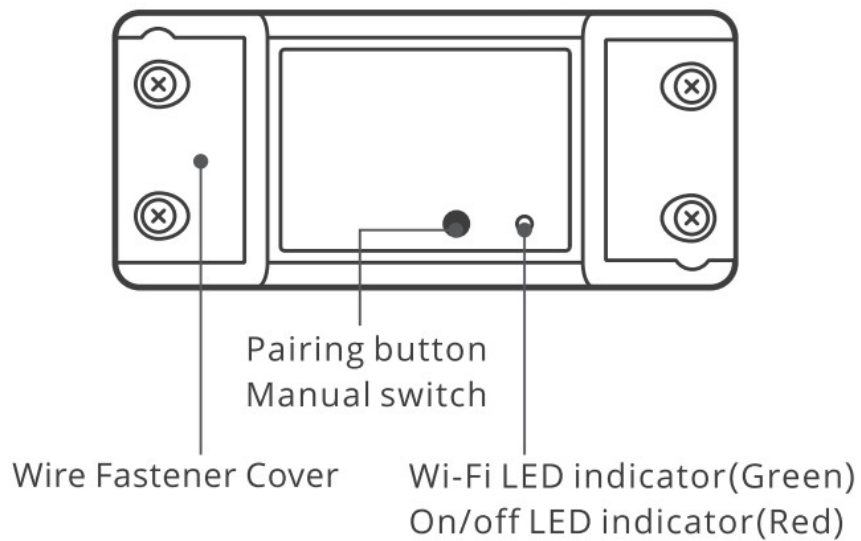

Wi-Fi led indicator status instruction

LED indicator status	Status instruction
Flashes (one long and two short)	Quick Pairing Mode
Flashes quickly	Compatible Pairing Mode
Keeps on	The device is connected successfully
Flashes quickly once	Unable to discover the router
Flashes quickly twice	Connect to the router but fail to connect to Wi-Fi
Flashes quickly three times	Upgrading

Features

Turn on/off the device from anywhere, schedule power on/off, and share the APP with your family to control.

Remote Control	Single/ Countdown Timing	Share Control	Voice Control
Smart Sync	Scene Status	Power-on State	LAN Control

Switch Network

If you need to change the network, long-press the pairing button for 5s until the Wi-Fi LED indicator changes in a cycle of two short and one long flash and release, then the device enters quick pairing mode and you can pair

again.

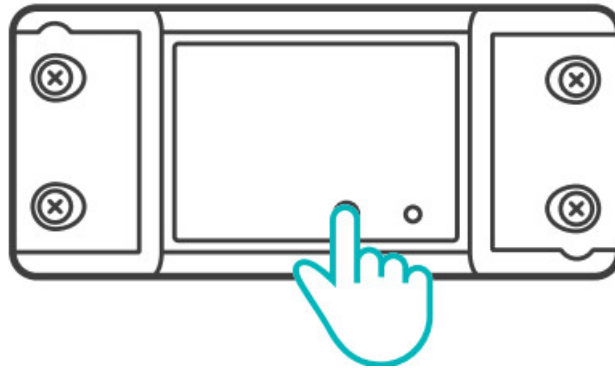

Factory Reset

Deleting the device on the eWeLink app indicates you restore it to factory setting.

Common Problems

Q: Why does my device stay “Offline”?

A: The newly added device needs 1 – 2mins to connect to Wi-Fi and network. If it stays offline for a long time, please judge these problems by the green Wi-Fi indicator status:

1 The green Wi-Fi indicator quickly flashes once per second, which means that the switch failed to connect your Wi-Fi:

(1) Maybe you have entered the wrong Wi-Fi password.

(2) Maybe there's too much distance between the switch your router or the environment causes interference, consider getting close to the router. If failed, please add it again.

(3) The 5G Wi-Fi network is not supported and only supports the 2.4GHz wireless network.

(4) Maybe the MAC address filtering is open. Please turn it off.

If none of the above methods solved the problem, you can open the mobile data network on your phone to create a Wi-Fi hotspot, then add the device again.

2. Green indicator quickly flashes twice per second, which means your device has connected to Wi-Fi but failed to connect to the server. Ensure a steady enough network. If double flash occurs frequently, which means you access an unsteady network, not a product problem. If the network is normal, try to turn off the power to restart the switch.

eWeLink has integrated with mainstream AI platforms. To ensure users can know quickly which platforms/smart speakers are compatible with products, manufacturers can print the poster version with “Works with AI” of the eWeLink logo and attach it in the package with the user manual.

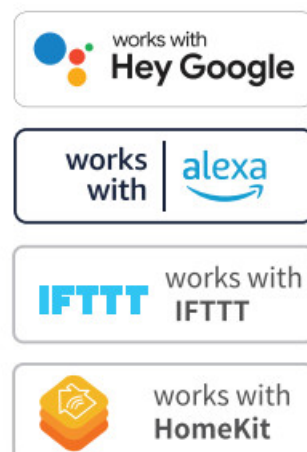



Smart products supporting the eWeLink APP need to get the certification of the corresponding platform before using the logo of AI voice platforms. Please refer to the product certification to make a deletion if manufacturers use the version on the package.

FCC Warning

Changes or modifications not expressly approved by the party responsible for compliance could avoid the user’s authority to operate the equipment. This device complies with part 15 of the FCC Rules. Operation is subject to the following two conditions: (1) This device may not cause harmful interference, and (2) this device must accept any interference received, including interference that may cause undesired operation.

FCC Radiation Exposure Statement:

This equipment complies with FCC radiation exposure limits set forth for an uncontrolled environment. This equipment should be installed and operated with a minimum distance of 20cm between the radiator & your body. This transmitter must not be co-located or operating in conjunction with any other antenna or transmitter.

Note:

This equipment has been tested and found to comply with the limits for a Class B digital device, pursuant to part 15 of the FCC Rules. These limits are designed to provide reasonable protection against harmful interference in a residential installation. This equipment generates, uses, and can radiate radio frequency energy and, if not installed and used in accordance with the instructions, may cause harmful interference to radio communications. However, there is no guarantee that interference will not occur in a particular installation. If this equipment does cause harmful interference to radio or television reception, which can be determined by turning the equipment off and on, the user is encouraged to try to correct the interference by one or more of the following measures:

- Reorient or relocate the receiving antenna.
- Increase the separation between the equipment and receiver.
- Connect the equipment into an outlet on a circuit different from that to which the receiver is connected.
- Consult the dealer or an experienced radio/TV technician for help.

Documents / Resources

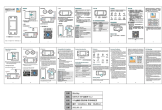
	<p>SONOFF SWITCH-WF WiFi Smart Switch [pdf] Instruction Manual WIFI, 2AZJLWIFI, SWITCH-WF WiFi Smart Switch, WiFi Smart Switch, Smart Switch</p>
---	--