



SONOFF-MICRO Wifi Smart USB Adapter Instruction Manual

[Home](#) » [SonOFF](#) » SONOFF-MICRO Wifi Smart USB Adapter Instruction Manual 

Contents

- [1 SONOFF-MICRO Wifi Smart USB Adapter](#)
- [2 Operation instruction](#)
- [3 Specifications](#)
- [4 Product Introduction](#)
- [5 Wi-Fi LED indicator status instruction](#)
- [6 Features](#)
- [7 Switch Network](#)
- [8 Factory Reset](#)
- [9 Common Problems](#)
- [10 Documents / Resources](#)



SONOFF-MICRO Wifi Smart USB Adapter



Product Information

Sonoff Micro is a portable mini USB smart adaptor that allows you to make your USB devices smart. It enables remote control of connected devices, scheduling of on/off operations, sharing control with family members, and various other features.

Specifications

- Model: Micro
- Input: 5V
- Output: 5V, 2.5A
- Operating Systems: Android & iOS
- Wi-Fi: IEEE 802.11 b/g/n, 2.4GHz
- Working Temperature: -10°C to 40°C
- Material: PC V0
- Dimension: 31×26.5×33mm

Features

- Remote Control
- Single/Countdown Timing
- Voice Control
- Share Control
- Sync Status
- Camera Linking
- Power-on State
- Smart Scene
- Switch Network

Wi-Fi LED Indicator Status Instruction

- Blue light flashes quickly: Pairing mode
- Blue light is always on: Device is connected successfully
- Blue light flashes quickly once: Unable to find the router
- Blue light flashes quickly twice: Successfully connect to the router but Wi-Fi is not connected
- Blue light flashes quickly three times: Upgrading

Product Usage Instructions

Download eWeLink App

Download the eWeLink app from your app store.

Power On

When powering on the device for the first time, it will enter the quick pairing mode (Touch). The Wi-Fi indicator will flash quickly.

- If the device is not paired within 3 minutes, it will exit the pairing mode (Touch).
- To enter the pairing mode again, long press the configuration button for 5 seconds until the Wi-Fi indicator flashes quickly and release.

Add the Device

Method 1: Scan the Code to Add (recommended)

Make sure the device is in pairing mode.

- Tap “+” in the app and select “Scan QR code”.
- Scan the QR code on the card in the package to add the device.

Method 2: Manual to Add

Please enter all the numbers beside the QR code as the device ID.

- Set the device to pairing mode and find the Wi-Fi SSID with ITEAD-***** on your mobile phone.
- Save the last 10 digital codes (the unique ID of the device).
- Go back to eWeLink App, tap “+”, select “Scan QR code”, then tap “Scanning failed. Please enter device ID manually” on the bottom.
- Save the device ID, tap “Next” and wait until the adding is successful.

Switch Network

If you need to change the network, long press the pairing button for 5 seconds until the Wi-Fi indicator flashes quickly and release. The device will enter pairing mode and you can pair it again.

Factory Reset

To perform a factory reset, please refer to the user manual or contact customer support for assistance.

Operation instruction

1. Download eWeLink APP



Android™ & iOS

2. Power on

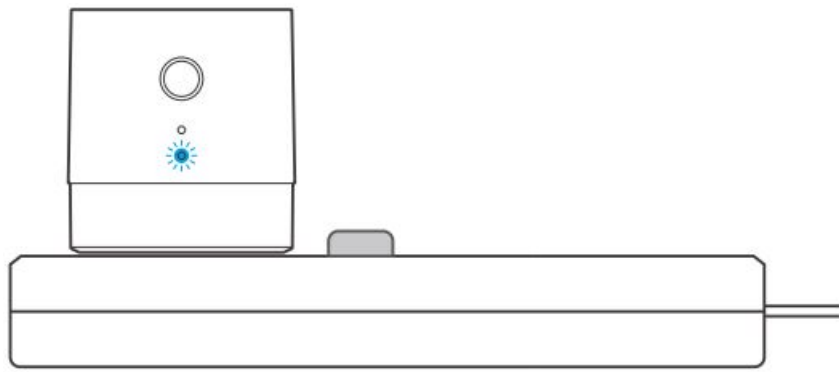

Powering on, the device will enter the quick pairing mode (Touch) during the first use. The Wi-Fi indicator flashes quickly.

It will exit the pairing mode (Touch) if the device is not paired within 3mins. If you want to enter this mode again, long press the configuration button for 5s until the Wi-Fi indicator flashes quickly and release.

3. Add the device

Method 1: Scan the code to add (recommended)



Tap “+” and select “Scan QR code”, then scan the QR code on the card in the package to add the device.

Method 2: manual to add

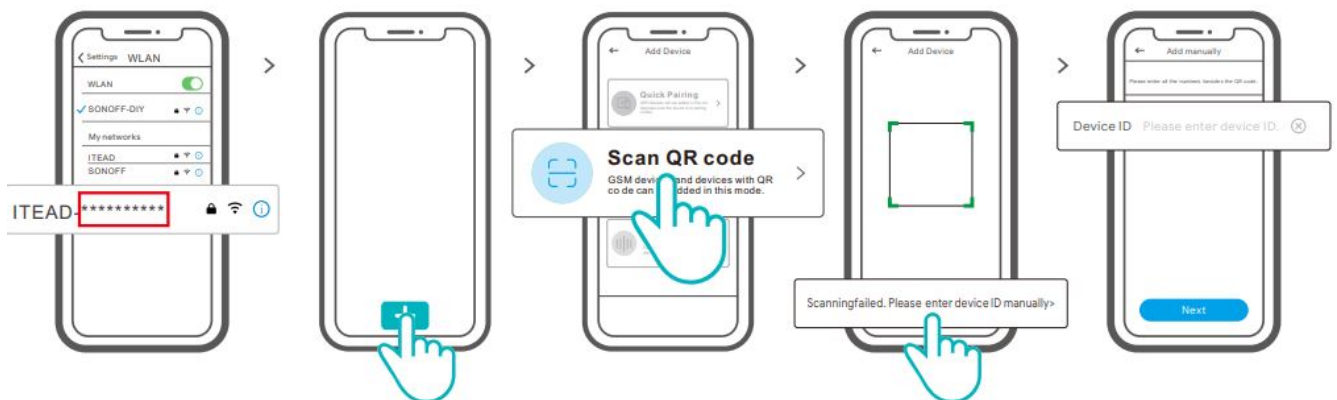

1. Set the device to the pairing mode, and find the Wi-Fi SSID with ITEAD-***** on your mobile phone, and save last 10 digital codes (The digital code is the unique ID of the device)
2. Go back to “eWeLink” App, tap “+”, select “Scan QR code”, then tap the word “Scanning failed. Please enter device ID manually” on the bottom and save the device ID, tap “Next” and wait until the adding is successful.

Specifications

Model	Micro
Input	5V
Output	5V 2.5A
Operating systems	Android & iOS
Wi-Fi	IEEE 802.11 b/g/n 2.4GHz
Working temperature	-10°C~40°C
Material	PC V0
Dimension	31×26.5×33mm

Product Introduction

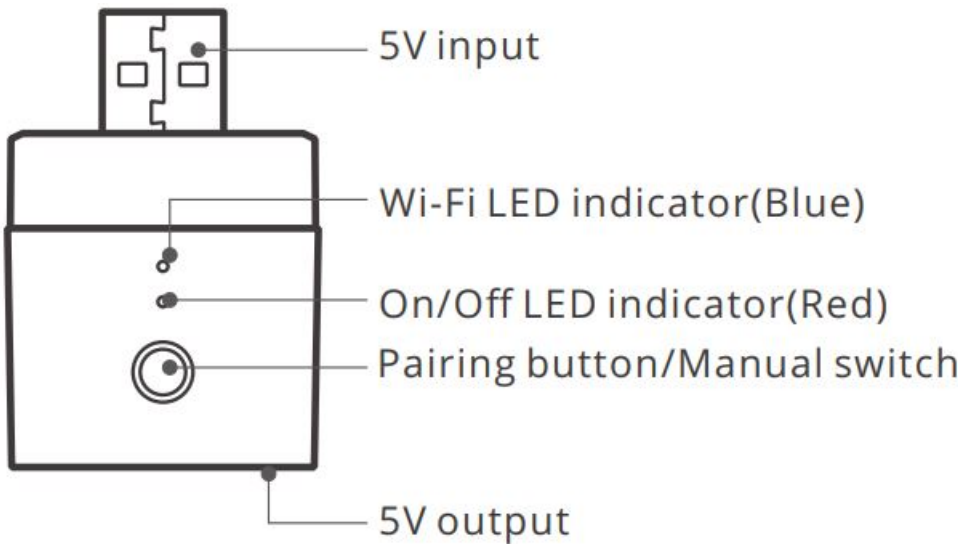

Wi-Fi LED indicator status instruction

LED indicator status	Status instruction
Blue light flashes quickly	Pairing mode
Blue light is always on	Device is connected successfully
Blue light flashes quickly once	Unable to find the router
Blue light flashes quickly twice	Successfully connect to the router but Wi-Fi is not connected
Blue light flashes quickly three times	Upgrading

Features

Micro is a portable mini USB smart adaptor that makes your USB devices smart. You can remotely turn on/off the connected devices of your home anywhere, schedule it on/off and share it with your family to control together.



Remote Control



Single/Countdown Timing



Voice Control



Share Control



Sync Status



Camera Linking



Power-on State



Smart Scene

Switch Network

If you need to change the network, long press the pairing button for 5s until the Wi-Fi indicator flashes quickly and release., then the device enters pairing mode and you can pair again.

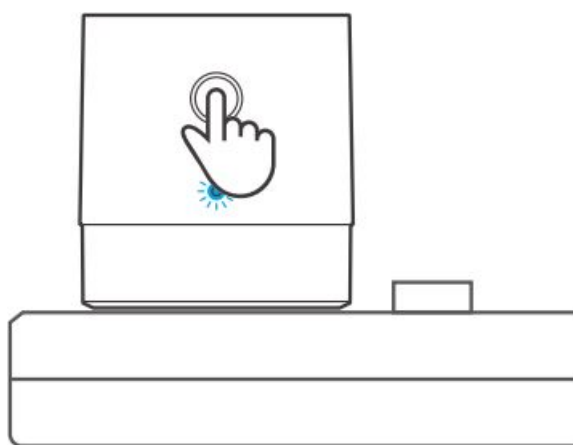

Factory Reset

Deleting the device on the eWeLink app indicates you restore it to the factory setting.

Common Problems

Q: Why my device stays “Offline”?

A: The newly added device needs 1 – 2mins to connect to Wi-Fi and the network. If it stays offline for a long time, please judge these problems by the blue Wi-Fi indicator status:

1. The blue Wi-Fi indicator quickly flashes once per second, which means that the switch failed to connect to your Wi-Fi:
 1. Maybe you have entered the wrong Wi-Fi password.
 2. Maybe there's too much distance between the switch and your router or the environment causes interference, consider getting close to the router. If failed, please add it again.
 3. The 5G Wi-Fi network is not supported and only supports the 2.4GHz wireless network.
 4. Maybe the MAC address filtering is open. Please turn it off.

If none of the above methods solved the problem, you can open the mobile data network on your phone to create a Wi-Fi hotspot, then add the device again.
2. The blue indicator quickly flashes twice per second, which means your device has connected to Wi-Fi but failed to connect to the server.

Ensure a steady enough network. If double flash occurs frequently, which means you access an unsteady network, not a product problem. If the network is normal, try to turn off the power to restart the switch.

Documents / Resources

	<p>SONOFF SONOFF-MICRO Wifi Smart USB Adapter [pdf] Instruction Manual</p> <p>SONOFF-MICRO Wifi Smart USB Adapter, SONOFF-MICRO, Wifi Smart USB Adapter, Smart USB Adapter, USB Adapter, Adapter</p>
---	--