



SONOFF SNZB03P zigbee Motion Sensor User Guide

[Home](#) » [SonOFF](#) » SONOFF SNZB03P zigbee Motion Sensor User Guide 

Contents

- [1 SONOFF SNZB03P zigbee Motion Sensor](#)
- [2 INTRODUCTION](#)
- [3 Power on the device](#)
- [4 Zigbee Bridge](#)
- [5 Distance Verification](#)
- [6 INSTALLATION](#)
- [7 SPECIFICATIONS](#)
- [8 What's in the box](#)
- [9 FCC](#)
- [10 EU Declaration of Conformity](#)
- [11 CONTACT](#)
- [12 Documents / Resources](#)



SONOFF SNZB03P zigbee Motion Sensor



INTRODUCTION

The device can be operated intelligently via working with the The device can work with other gateways supporting Zigbee 3.0 wireless protocol. Detailed information is in accordance with the final product.SONOFF Zigbee gateway to communicate with other devices. Download the eWeLink App & Add SONOFF Zigbee gateway

Power on the device



Take out the battery insulation sheet to power on the device. After powering on the device for the first time, it will enter the pairing mode by default and the LED indicator “flashes slowly”



The device will exit the pairing mode when it doesn't be paired to Zigbee gateway successfully within 3mins. If you want to access the pairing mode again, press and hold the device pairing button for 5s until the LED indicator “flashes slowly” If the device is the No battery version, please install the battery (CR2477) to power on the device.

Zigbee Bridge

Add the device to Zigbee Bridge



On the Zigbee gateway main page of the eWeLink App, click “Add” sub-devices and wait for the addition process to complete. If the device is failed to be added, please move the device closer to the Bridge and add it again

Distance Verification

Effective Communication Distance Verification

Install the device in the desired place, then press the Pairing button on the device. The LED indicator flashes twice means the device and the device under the same Zigbee network (the router device or hub) are in the effective communication distance

INSTALLATION

5-1



5-2

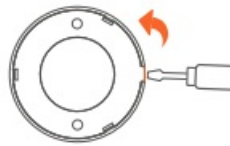

①

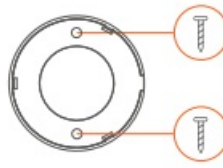

②

The equipment is only suitable for mounting at heights > 2 m.



<https://sonoff.tech/usermanuals>. Scan the QR code or visit the website to learn about the detailed user manual and help.

SPECIFICATIONS

Zigbee Motion Sensor

- **Model:** SNZB-03P
- **Wireless connection:** Zigbee 3.0
- **Dimension:** 44.2×44.2×59mm
- **Working temperature:** -10°C~+60°C
- **Working humidity:** 5~95%RH (non-condensing)
- **Input:** 3.0V =
- **Battery model:** CR2477
- **Casing material:** ABS
- **Color:** White

What's in the box

- Zigbee motion sensor x 1
- 3M adhesive tape x 1
- Screw x 2
- Quick guide x 1
- Magnetic base x 1

FCC

FCC compliance statement

1. This device complies with part 15 of the FCC Rules. Operation is subject to the following two conditions:
 1. This device may not cause harmful interference, and
 2. This device must accept any interference received, including interference that may cause undesired operation.
2. Changes or modifications not expressly approved by the party responsible for compliance could void the user's authority to operate the equipment.

Note: This equipment has been tested and found to comply with the limits for a Class B digital device, pursuant to part 15 of the FCC Rules. These limits are designed to provide reasonable protection against harmful interference in a residential installation. This equipment generates, uses and can radiate radio frequency energy and, if not installed and used in accordance with the instructions, may cause harmful interference to radio communications. However, there is no guarantee that interference will not occur in a particular installation. If this equipment does cause harmful interference to radio or television reception, which can be determined by turning the equipment off and on, the user is encouraged to try to correct the interference by one or more of the following measures:

- Reorient or relocate the receiving antenna.
- Increase the separation between the equipment and receiver.
- Connect the equipment into an outlet on a circuit different from that to which the receiver is connected.
- Consult the dealer or an experienced radio/TV technician for help.

FCC Radiation Exposure statement:

This equipment complies with FCC radiation exposure limits set forth for an uncontrolled environment. This equipment should be installed and operated with minimum distance of 20 cm between the radiator and your body. This transmitter must not be co-located or operating in conjunction with another antenna or transmitter.

EU Declaration of Conformity

Hereby, Shenzhen Sonoff Technologies Co., Ltd. declares that the radio equipment type SNZB-03P is in compliance with Directive 2014/53/EU. The full text of the EU declaration of conformity is available at the following internet address: <https://sonoff.tech/usermanuals>.

- Do not ingest battery, Chemical Burn Hazard.
- This product contains a coin / button cell battery.
- If the coin / button cell battery is swallowed, it can cause severe internal burns in just 2 hours and can lead to death.
- Keep new and used batteries away from children.
- If the battery compartment does not close securely, stop using the product and keep it away from children.

- If you think batteries might have been swallowed or placed inside any part of the body, seek immediate medical attention.
- Replacement of a battery with an incorrect type that can defeat a safeguard (for example, in the case of some lithium battery types).
- Disposal of a battery into fire or a hot oven, or mechanically crushing or cutting of a battery, that can result in an explosion.
- Leaving a battery in an extremely high temperature surrounding environment that can result in an explosion or the leakage of flammable liquid or gas.
- A battery subjected to extremely low air pressure that may result in an explosion or the leakage of flammable liquid or gas.

Scatola	Manuale	Plastics
PAP 21	PAP 22	LDPE 4
Carta	Carta	Plastica
RACCOLTA DIFFERENZIATA		
Verifica le disposizioni del tuo Comune. Separa le componenti e conferiscile in modo corretto.		

CONTACT

- Shenzhen Sonoff Technologies Co., Ltd.
- 3F & 6F, Bldg A, No. 663, Bulong Rd, Shenzhen, Guangdong, China
- ZIP code: 518000
- **Service email:** support@itead.cc.
- **Website:** sonoff.tech
- MADE IN CHINA
- <https://sonoff.tech>.
- **Manufacturer:** Shenzhen Sonoff Technologies Co., Ltd.
- **Address:** 3F & 6F, Bldg A, No. 663, Bulong Rd, Shenzhen, Guangdong, China
- **Website:** sonoff.tech
- **ZIP code:** 518000
- **Service email:** support@itead.cc





[SONOFF SNZB03P zigbee Motion Sensor](#) [pdf] User Guide

SNZB03P zigbee Motion Sensor, SNZB03P, zigbee Motion Sensor, Motion Sensor, Sensor