

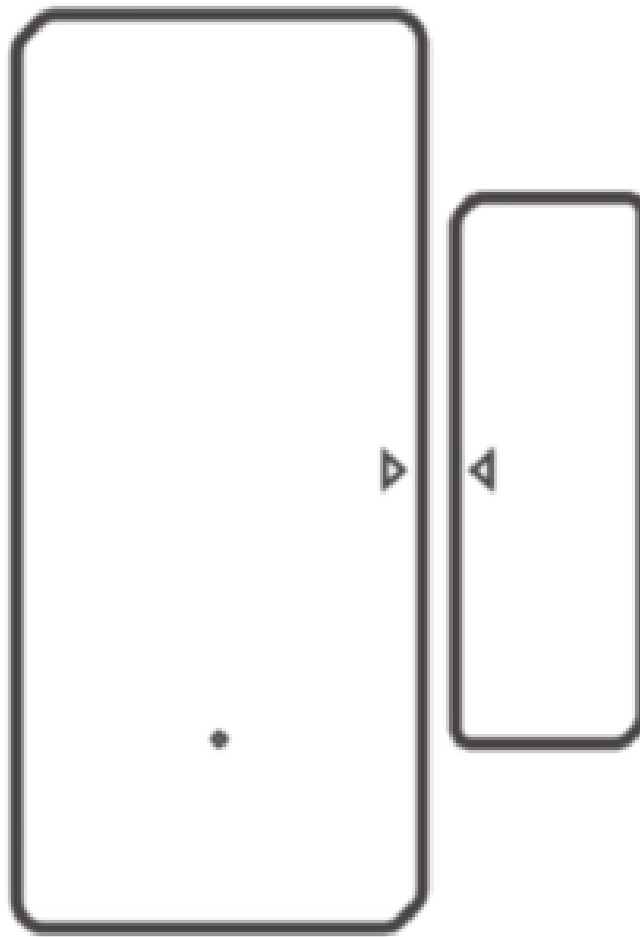

Sonoff SNZB-04 Wireless Door/Window Sensor User Guide

[Home](#) » [SonOFF](#) » Sonoff SNZB-04 Wireless Door/Window Sensor User Guide 





Wireless Door/Window Sensor

The device can be operated intelligently via working with the SONOFF ZigBee Bridge to communicate with other devices.



The device can work with other gateways supporting ZigBee 3.0 wireless protocol. Detailed information is in accordance with the final product.

Contents

- [1 DOWNLOAD APP](#)
- [2 Add sub-devices](#)
- [3 Install the device](#)
- [4 User Manual](#)
- [5 FCC Warning](#)
- [6 Documents / Resources](#)
- [7 Related Posts](#)

DOWNLOAD APP



<http://app.coolkit.cc/dl.html>

1. Pull out the battery insulation sheet

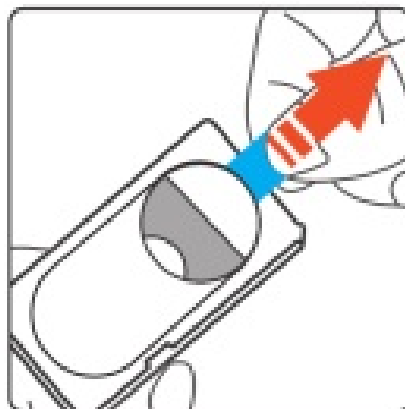
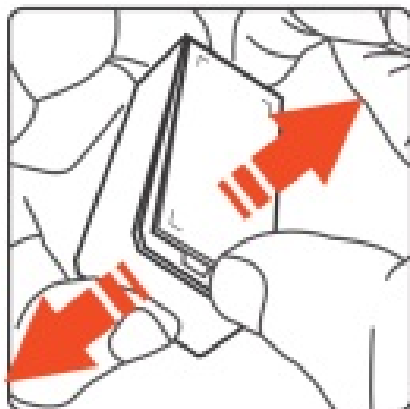

Add sub-devices



Connect the Bridge before adding the sub-device.



>



Access eWeLink APP, select the Bridge that you want to connect, and tap “Add” to add a sub-device. Then long press reset button on the device for 5s until the LED indicator flashes three times, which means the device has entered the pairing mode, and be patient until pairing completes.



If the addition failed, move the sub-device closer to the Bridge and try again.

Install the device

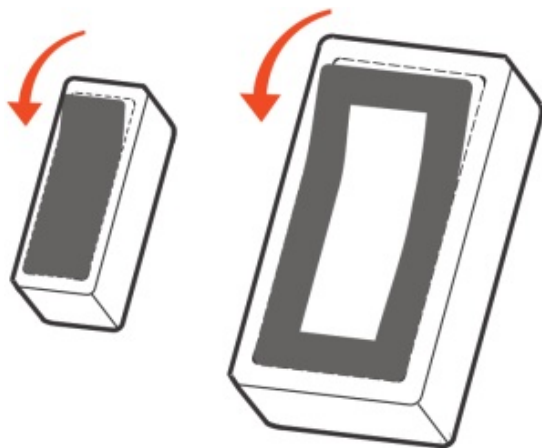

Tear off the protective film of the 3M adhesive.

4-2

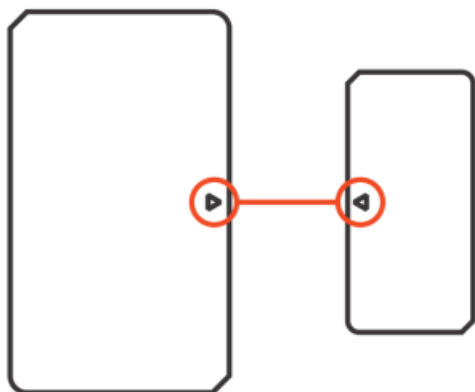

Try to align the mark line on the magnet with that on the transmitter during installation.

4-3

Install them in the opening and closing area separately.

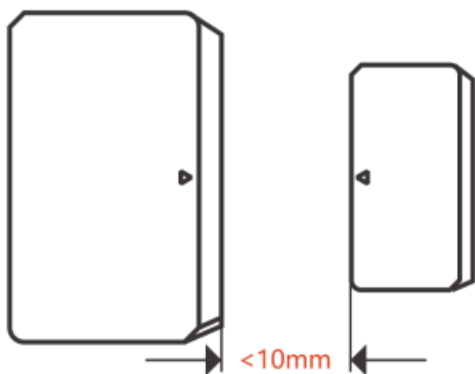

Make sure the installation gap is less than 10mm when the door or the window is closed.

User Manual



<https://www.sonoff.tech/usermanuas>

Scan the QR code or visit the website to learn about the detailed user manual and help.

FCC Warning

Changes or modifications not expressly approved by the party responsible for compliance could avoid the user's authority to operate the equipment.

This device complies with part 15 of the FCC Rules. Operation is subject to the following two conditions: (1) This device may not cause harmful interference, and (2) this device must accept any interference received, including interference that may cause undesired operation.

FCC Radiation Exposure Statement:

This equipment complies with FCC radiation exposure limits set forth for an uncontrolled environment. This equipment should be installed and operated with minimum distance 20cm between the radiator & your body. This transmitter must not be co-located or operating in conjunction with any other antenna or transmitter.

Note:

This equipment has been tested and found to comply with the limits for a Class B digital device, pursuant to part 15 of the FCC Rules. These limits are designed to provide reasonable protection against harmful interference in a residential installation. This equipment generates, uses and can radiate radio frequency energy and, if not installed and used in accordance with the instructions, may cause harmful interference to radio communications. However, there is no guarantee that interference will not occur in a particular installation. If this equipment does cause harmful interference to radio or television reception, which can be determined by turning the equipment off and on, the user is encouraged to try to correct the interference by one or more of the following measures:

- Reorient or relocate the receiving antenna.
- Increase the separation between the equipment and receiver.
- Connect the equipment into an outlet on a circuit different from that to which the receiver is connected.
- Consult the dealer or an experienced radio/TV technician for help.

Hereby, Shenzhen Sonoff Technologies Co., Ltd. declares that the radio equipment type SNZB-04 is in compliance with Directive 2014/53/EU. The full text of the EU declaration of conformity is available at the following internet address:

<https://www.sonoff.tech/usermanuals>



Shenzhen Sonoff Technologies Co., Ltd.

1001, BLDG8, Lianhua Industrial Park, shenzhen, GD, China

ZIP code: 518000

Website: sonoff.tech

MADE IN CHINA



HAVE A PROBLEM?

We are so sorry for the inconvenience caused by the product.
Please contact us for help via the email address below.



support@itead.cc

We will get back to you as soon as possible.



LIKE IT!

Glad to know you are satisfied with SONOFF products.

It would mean a lot to us if you can take a minute to share your buying experience.



Share it on Amazon



Share it on your social media



Share it with your friends and family

Get the latest news by following us:

New arrival Promotion How-to videos

Documents / Resources



[Sonoff SNZB-04 Wireless Door/Window Sensor](#) [pdf] User Guide
SNZB-04, Wireless Door Window Sensor