



SONOFF S26R2ZB ZigBee Smart Plug User Manual

[Home](#) » [SonOFF](#) » SONOFF S26R2ZB ZigBee Smart Plug User Manual 



S26R2ZB
User manual V1.0





TPG(UK)

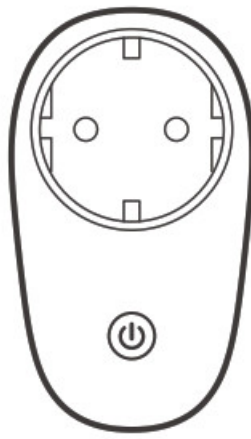

TPF(DE)



TPE(FR)

Contents

- [1 Operating Instruction](#)
- [2 More APP application platforms and gateway recommendations](#)
- [3 Specifications](#)
- [4 Product Introduction](#)
- [5 Features](#)
- [6 Switch Network](#)
- [7 Factory Reset](#)
- [8 Documents / Resources](#)
- [9 Related Posts](#)

Operating Instruction

1. Download APP

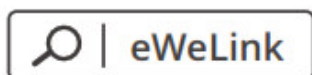

Android™ & iOS

<http://app.coolkit.cc/dl.html>

2. Power on

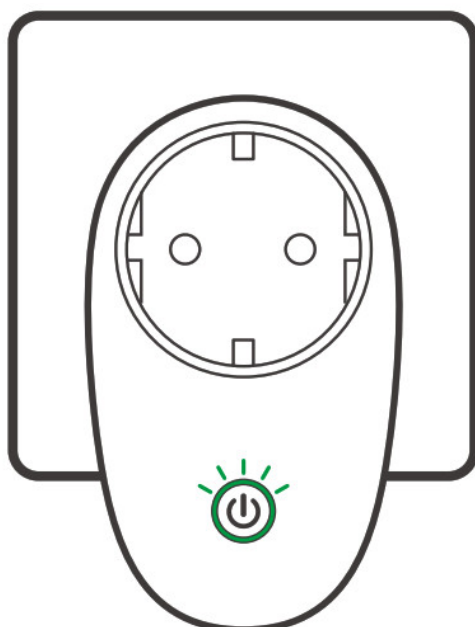

After powering on, the device will enter the pairing mode during the first use and the Zigbee LED signal indicator flashes.

3. Add sub-devices



Connect the SONOFF ZigBee Bridge before adding the sub-device.

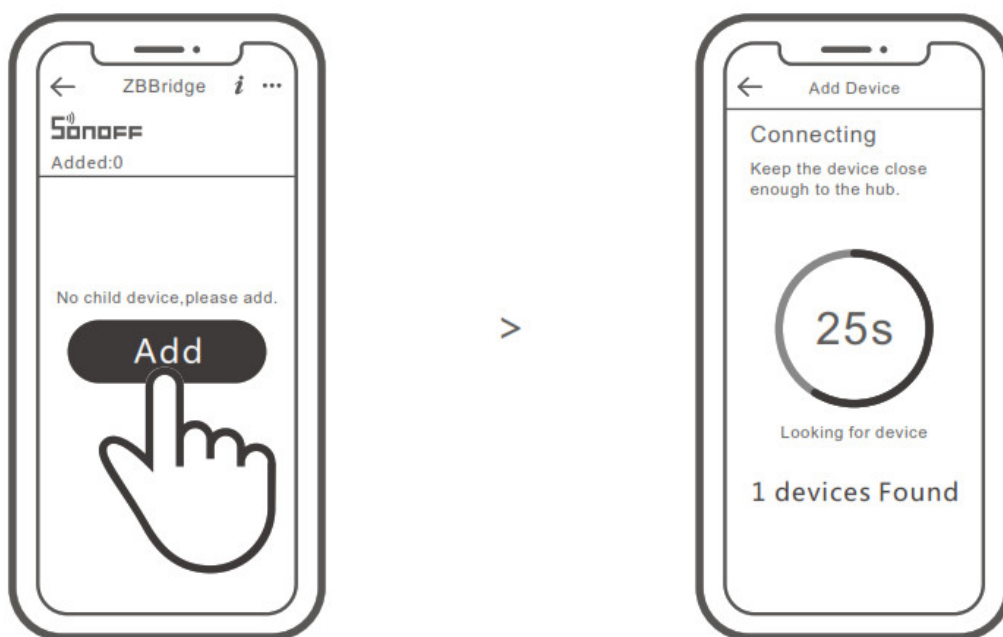

Access the eWeLink APP, select the Bridge that you want to connect, tap “Add” to add a sub-device, and be patient until the pairing completes.



If the addition failed, move the sub-device closer to the Bridge and try again.

SONOFF ZigBee Bridge supports connecting multiple sub-devices at the same time.

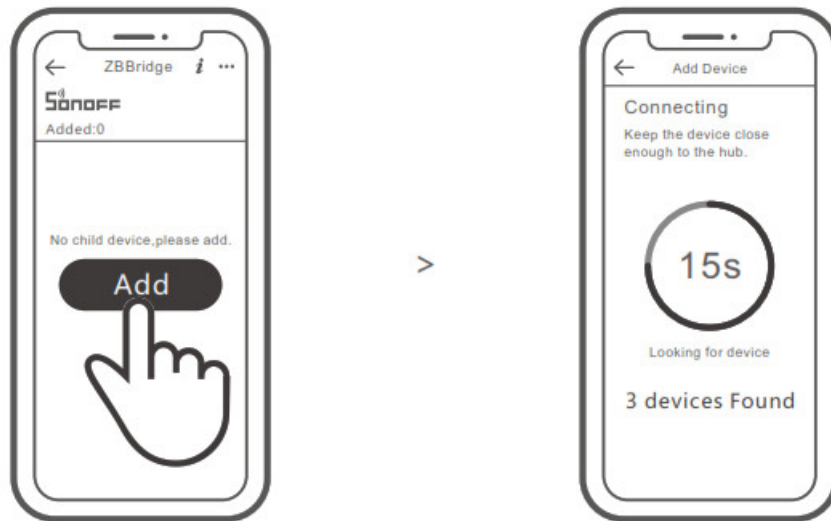

Power the Bridge on, set the sub-device to the pairing mode. Then access the Bridge page in the eWeLink APP to tap “Add”, and be patient until the pairing completes.

More APP application platforms and gateway recommendations



SmartThings



Amazon Alexa



Hue

This device supports the following gateways besides SONOFF ZigBee:

Echo Studio
Echo (4th Gen)
Echo Plus (model: ZE39KL)
2nd Gen Echo Show (model: DW84JL)
2nd Gen Echo Plus (model: L9D29R)
Samsung SmartThings hub
Philips Hue Smart Hub

Gateway adding instruction:

1. Refer to the gateway user manual to download the matched APP and get it paired.
2. Set ZBMINI to the pairing mode.
3. Add ZBMINI according to the prompt of APP. Please select eWeLink or SONOFF when adding.



If the addition failed, move the sub-device closer to the Bridge and try again.

Specifications

Model	S26R2ZBTPF, S26R2ZBTPE, S26R2ZBTPG
Input	250V~, 50/60Hz
Max. load	S26R2ZBTPF: 4000W/16A S26R2ZBTPE: 3680W (230V)/16A S26R2ZBTPG: 3250W/13A
ZigBee	IEEE 802.15.4
Operating systems	Android & iOS
Working temperature	-10°C~40°C
Material	PC V0
Dimension	97.5x56x35mm

Product Introduction

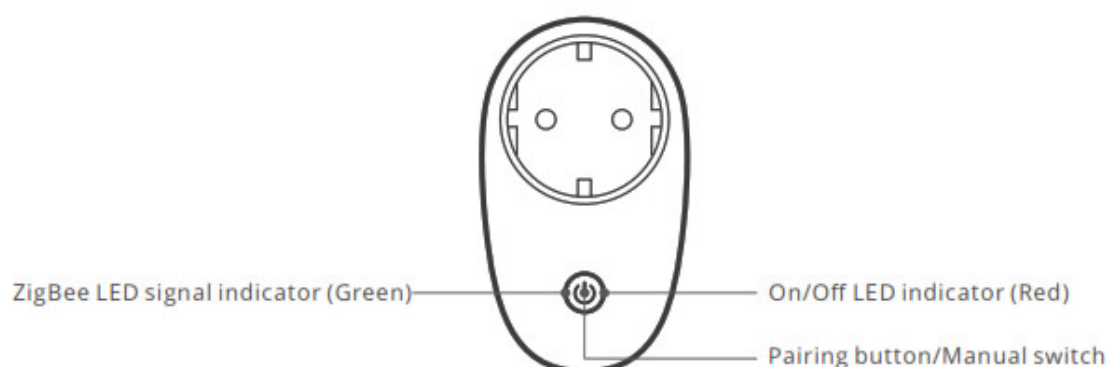

Features

The is a smart device with ZigBee wireless communication protocol that allows you to remotely turn on, schedule on/off, and set smart scenes to trigger other devices, etc.



Remote Control



Single/Countdown Timing



Voice Control



Share Control



Smart Scene



Camera Binding



The above functions are determined by the connected ZigBee Hub.

Switch Network

If you need to change the network, long-press the pairing button for 5s until the ZigBee LED signal indicator flashes and releases, then the device enters pairing mode and you can pair again.

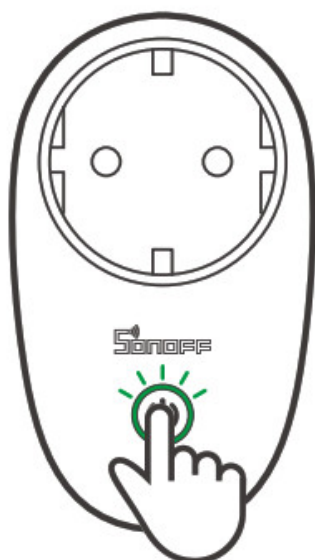

Factory Reset

Deleting the device on the eWeLink app indicates you restore it to the factory setting.

Hereby, Shenzhen Sonoff Technologies Co., Ltd. declares that the radio equipment type S26R2ZBTPF, S26R2ZBTPE, S26R2ZBTPG is in compliance with Directive 2014/53/EU. The full text of the EU declaration of conformity is available at the following internet address: <https://sonoff.tech/usermanuals>





Shenzhen Sonoff Technologies Co., Ltd.
1001, BLDG8, Lianhua Industrial Park, Shenzhen, GD, China
ZIP code: 518000 Website: sonoff.tech
MADE IN CHINA



Documents / Resources

S26R2ZB
User manual V1.0





TIG001 TIG002 TIG003

ZigBee Smart Plug

EN	1-4	English	1-4
Deutsch	5-12	English	13-20
Français	13-20	English	21-28
Português	29-35	Português	36-43

SONOFF S26R2ZB ZigBee Smart Plug [pdf] User Manual

S26R2ZB, ZigBee Smart Plug

S26R2ZB
User manual V1.0



TIG001 TIG002 TIG003

ZigBee Smart Plug

EN	1-4	English	1-4
Deutsch	5-12	English	13-20
Français	13-20	English	21-28
Português	29-35	Português	36-43

SONOFF S26R2ZB ZigBee Smart Plug [pdf] User Manual

S26R2ZB, ZigBee Smart Plug