



SONOFF LBS L2 WiFi Smart LED Light Strip User Manual

[Home](#) » [SonOFF](#) » SONOFF LBS L2 WiFi Smart LED Light Strip User Manual 

Contents

- [1 SONOFF LBS L2 WiFi Smart LED Light Strip](#)
- [2 Features of the Smart LED Light Strip](#)
- [3 Operation instruction](#)
- [4 Specifications](#)
- [5 Wi-Fi control setting](#)
- [6 Safety Warning](#)
- [7 FCC STATEMENT Warning](#)
- [8 Documents / Resources](#)
- [9 Related Posts](#)



SONOFF LBS L2 WiFi Smart LED Light Strip



Features of the Smart LED Light Strip

- SMD5050 LED Beads; FPCB Circuit Board; Every 3 LED lights in one segment.
- Main Colors of the Light: Red/Blue/Green.



App Control



Voice Control



Single/Countdown
Timing



Share Control



Dimming



Music Reactive
Mode



16M Colors



Remote Control



Bluetooth Control



Scene Mode

Operation instruction

1. Clean the surface

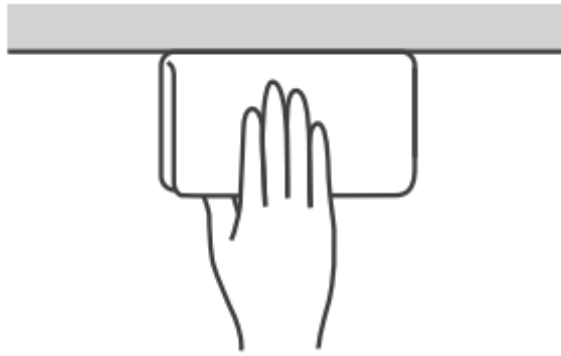

2. Tear the backing tape

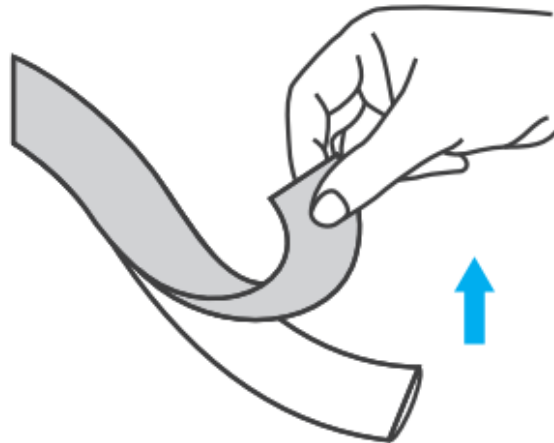

3. Adhere it to the surface

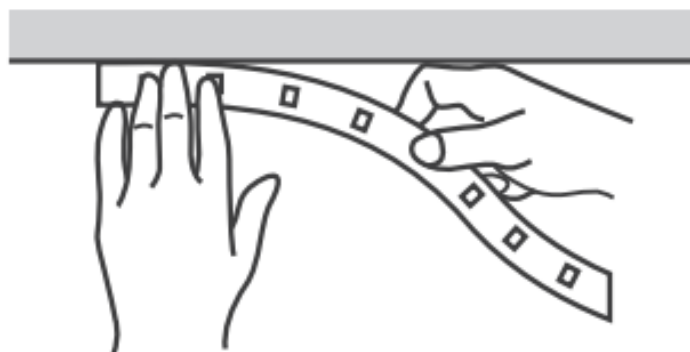

4. Download the eWeLinkApp



Android™ & iOS

5. Power on

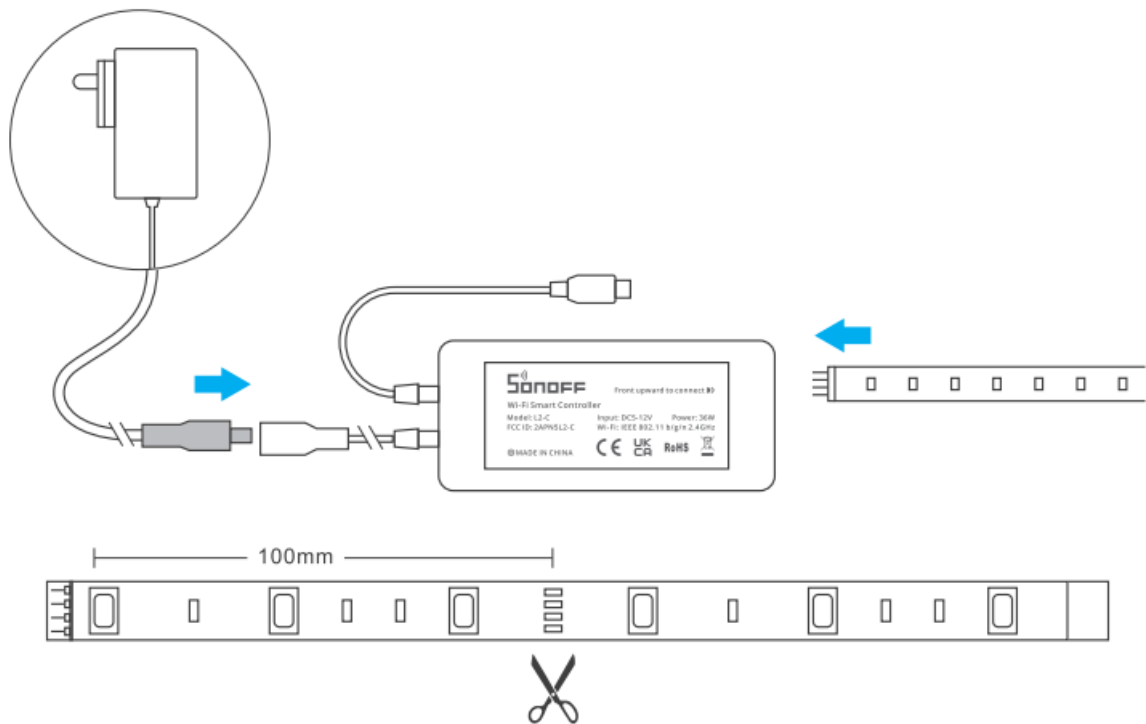

6. Pull out the insulation sheet. then long press “on” button for 5s until the light strip “flashes”, which means it enters the Bluetooth Pairing mode.

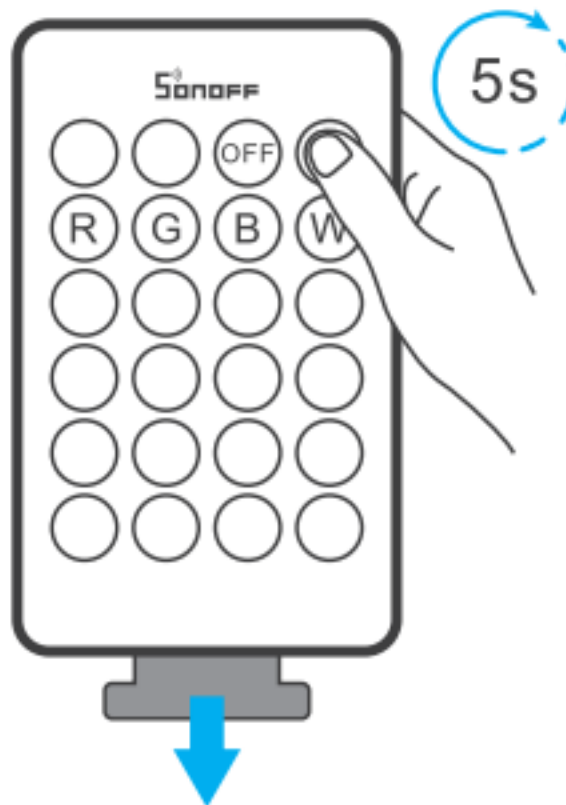

The device will exit the Bluetooth Pairing mode if not paired within 1 min. If you want to enter this mode again, long press the “on” button on the remote controller for 5s until the light strip “flashes” and release.

7. **Add the device**

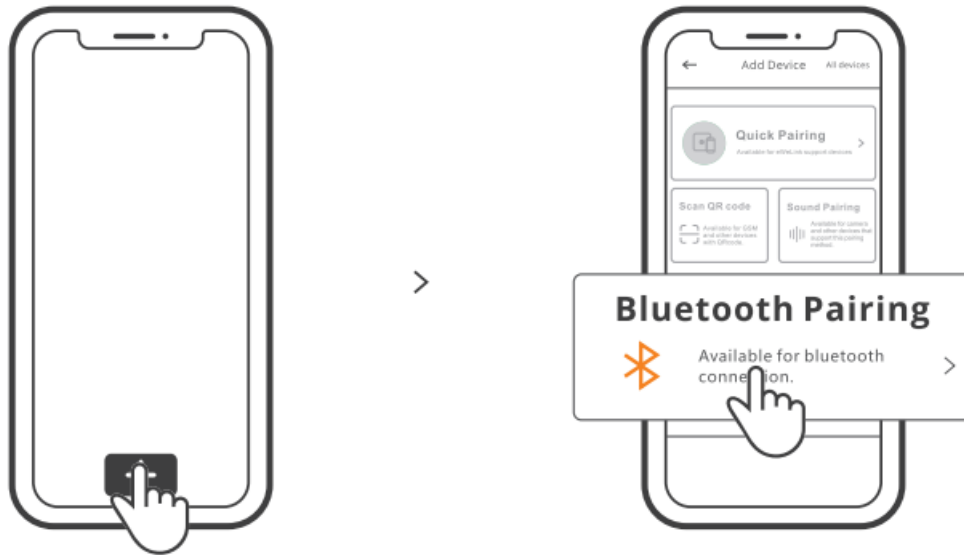

Tap “+” and select “Bluetooth Pairing”, then operate following the prompt on the App.

Specifications

Model: L 1-2M, L 1-SM, L 1 Lite-SM-EU, L 1 Lite-SM-US

Light Strips

Input Voltage	DC 12V	LED QTY	30LEDs/m
Luminous Flux	◆3001umens/m	Life Expectancy	> 25000 hours
Beam Angle	L1: 140" L 1 Lite: 120"	Operating Temperature	-15°C – 50°C
Working Humidity	◆95%	Protect Range	L1: IP65
Materiel	FPCB		L1 Lite: IP20
Light Decay	Less than 3% after 1000 hours constant work		

Power Adapter

- **Input** 100-240V AC 50/60Hz 0.6A Max
- **Output** DC 12V 2000mA
- **Protection** Anti-overvoltage, Anti-overload, Anti-temperature

Wi-Fi Controller

Input	DC S-12V	Power.max	36W
Remote Control	24 Keys IR Remote Controller	Wi-Fi	IEEE802.11 b2.4GHz
Remote controller battery	3V(CR2025)	Bluetooth	5.0 BLE
App operating systems	Android & iOS		

Wi-Fi control setting

Select the “Wi-Fi Settings” on the “Device Settings” interface in the eWeLink App to add or change the network.

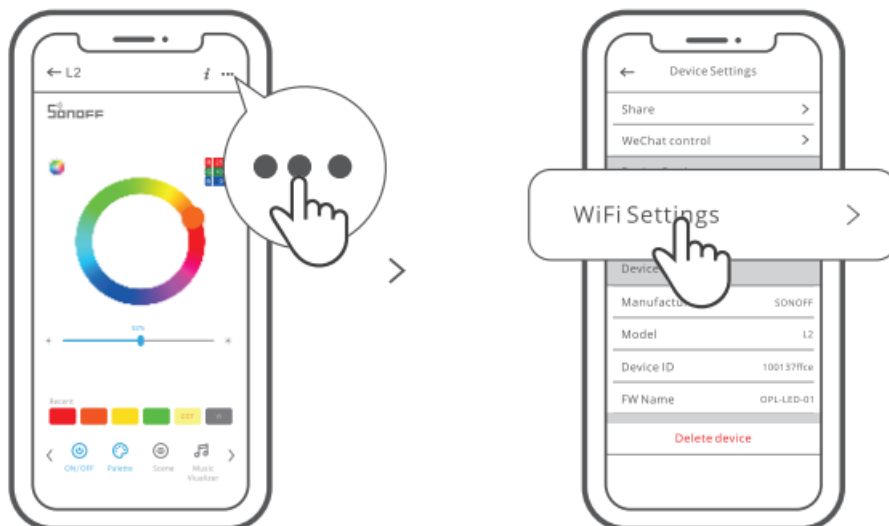

When Wi-Fi is not available, the device will automatically switch to Bluetooth control (Ensure Bluetooth is enable on your mobile phone).

Re-establish Pairing

Long press “on” button for 5s until the light strip “flashes”, which means it enters the Bluetooth Pairing mode and you can pair again.

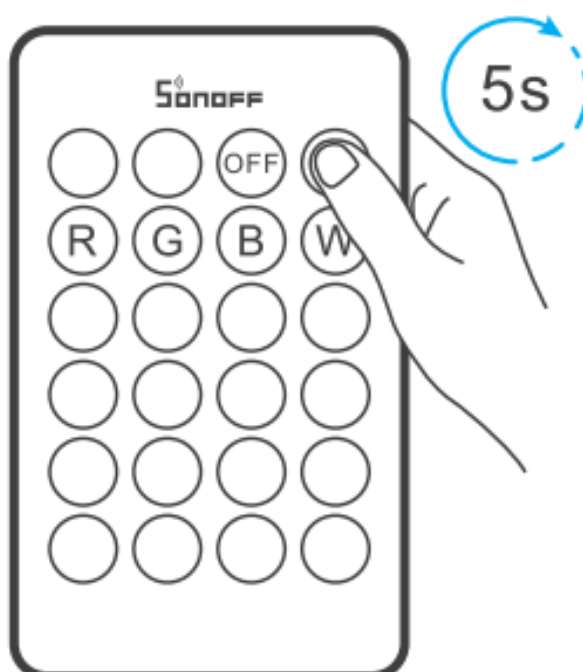

Factory Reset

Deleting the device on the eWelink app indicates you restore it to the factory setting.

Safety Warning

1. Before using this product, please make sure that your voltage is appropriate for this product's working voltage. Using this product with a voltage other than the one specified may damage the product and cause safety hazards.
2. LED Light Sources are unchangeable, please don't dismantle them.
3. While the Light Strip is working, it will generate heat so please keep it in a crossventilation environment for heat dissipation.

FCC STATEMENT Warning

Changes or modifications not expressly approved by the party responsible for compliance could avoid the user's authority to operate the equipment. This device complies with part 15 of the FCC Rules. Operation is subject to the following two conditions: (1) This device may not cause harmful interference, and (2) this device must accept any interference received, including interference that may cause undesired operation.

FCC Radiation Exposure Statement:

This equipment complies with FCC radiation exposure limits set forth for an uncontrolled environment. This equipment should be installed and operated with a minimum distance of 20cm between the radiator & your body. This transmitter must not be co-located or operating in conjunction with any other antenna or transmitter.

Note:

This equipment has been tested and found to comply with the limits for a Class B digital device, pursuant to part 15 of the FCC Rules. These limits are designed to provide reasonable protection against harmful interference in a residential installation. This equipment generates, uses, and can radiate radio frequency energy and, if not installed and used in accordance with the instructions, may cause harmful interference to radio communications. However, there is no guarantee that interference will not occur in a particular installation. If this equipment does cause harmful interference to radio or television reception, which can be determined by turning the equipment off and on, the user is encouraged to try to correct the interference by one or more of the following measures:

- Reorient or relocate the receiving antenna.
- Increase the separation between the equipment and receiver.
- Connect the equipment into an outlet on a circuit different from that to which the receiver is connected.
- Consult the dealer or an experienced radio/TV technician for help.

Hereby, Shenzhen SonoffTechnologies Co., Ltd. declares that the radio equipment type L 1-2M/L 1-SM/L 1 Lite-SM-US/L 1 Lite-SM-EU is in compliance with Directive 2014/53/EU. The full text of the EU declaration of conformity is available at the following internet address: <https://sonoff.tech/usermanuals>.

Documents / Resources

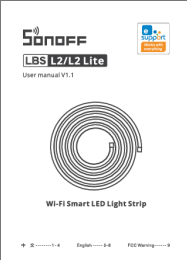
	<p>SONOFF LBS L2 WiFi Smart LED Light Strip [pdf] User Manual LBS L2, LBS L2 Lite, LBS L2 WiFi Smart LED Light Strip, WiFi Smart LED Light Strip</p>
---	--

