



SONOFF DW2RF RF-Wireless Door/Window Sensor User Manual

[Home](#) » [SonOFF](#) » SONOFF DW2RF RF-Wireless Door/Window Sensor User Manual 

Contents

- 1 [SONOFF DW2RF RF-Wireless Door/Window Sensor](#)
- 2 [Operation instruction](#)
 - 2.1 [Download APP](#)
- 3 [Install batteries](#)
 - 3.1 [Remove the back cover of the transmitter.](#)
- 4 [Add sub-devices](#)
- 5 [Install the device](#)
- 6 [Specifications](#)
- 7 [Product Introduction](#)
- 8 [Features](#)
- 9 [Application](#)
- 10 [Replace batteries](#)
- 11 [FCC Warning](#)
- 12 [Documents / Resources](#)
- 13 [Related Posts](#)



SONOFF DW2RF RF-Wireless Door/Window Sensor



The device can be operated intelligently via working with the SON OFF 433MHz RF Bridge to communicate with other devices. The device can work with other gateways supporting 433MHz wireless protocol. Detailed information is in accordance with the final product.

Operation instruction

Download APP



Android™ & iOS

Install batteries

Remove the back cover of the transmitter.

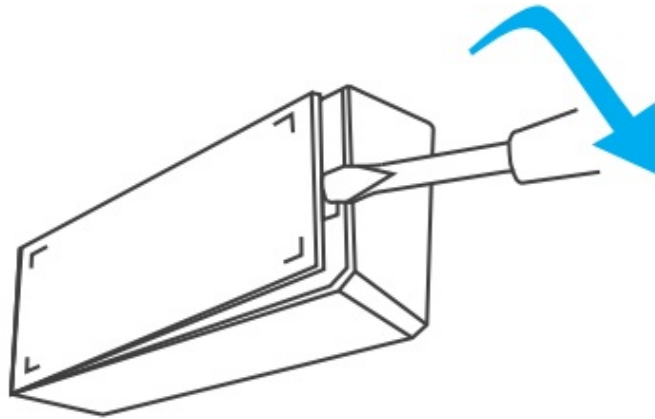

Insert batteries into the battery compartment based on identifiers of positive and negative poles.

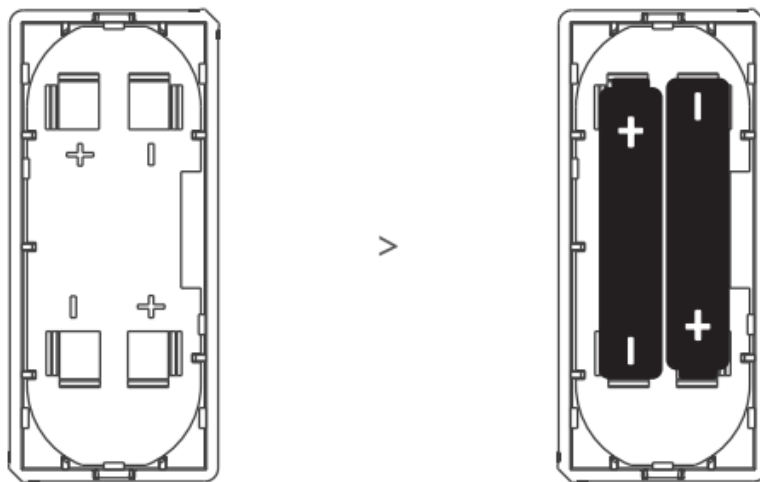

Close the back cover.

The battery is not included, please purchase it separately.

Add sub-devices

Connect the Bridge before adding the sub-device.

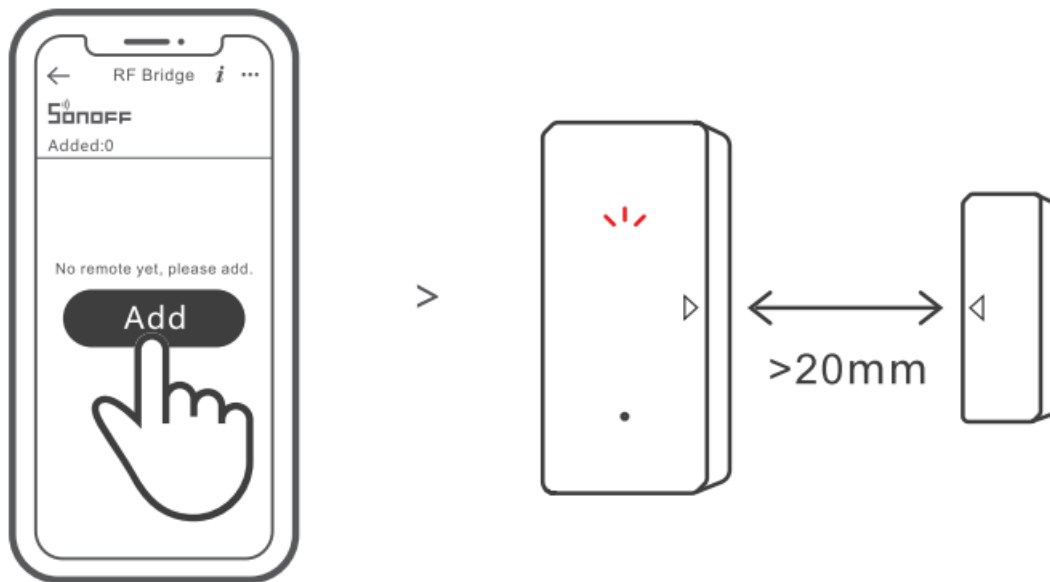

Access the eWeLinkAPP and select the Bridge, tap “Add” to select the alarm, and a “Beep” means the Bridge enters the pairing mode. Then separate the magnet for more than 20 mm from the transmitter until the LED indicator stays on for 1 to 2s, and the pairing is complete when you hear “Beep Beep”.

If the addition failed, move the sub-device closer to the Bridge and try again.

Install the device

Tear off the protective film of the 3M adhesive.

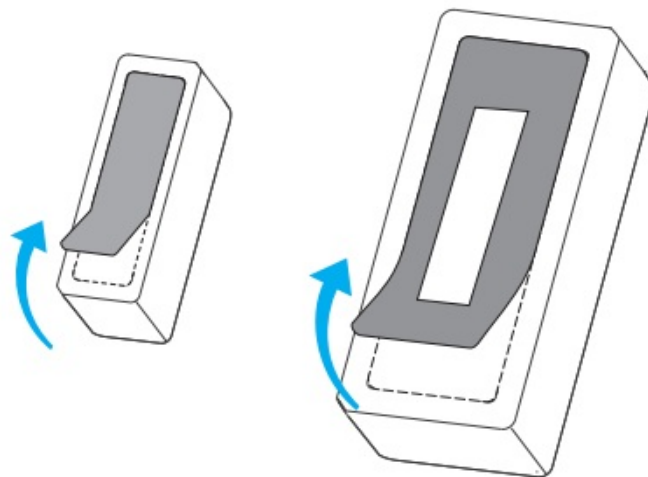

Try to align the mark line on the magnet with that on the transmitter during installation.

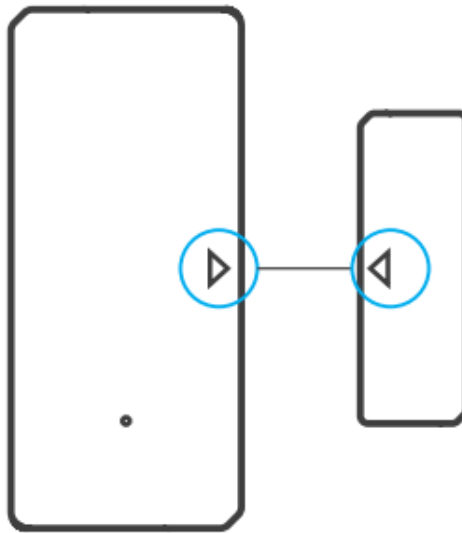

Install them in the opening and closing area separately.

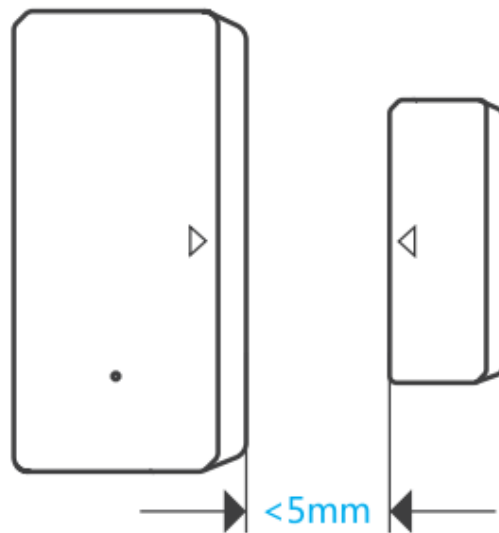

Make sure the installation gap is less than 5mm when the door or the window is closed.

Specifications

Model	DW2-RF
RF	433MHz

Working voltage	DC3V (2 x 1.5V battery)
Battery model	AAA 1.5V
Quiescent current	:S.6uA
Emission current	:S.10mA
Wireless transmission distance	Max. 50m
Installation gap	<5mm
Working temperature	-10°C~40°C
Material	PC
Dimension	Transmitter: 70x31x19mm Magnet: 42x14x16mm

Product Introduction

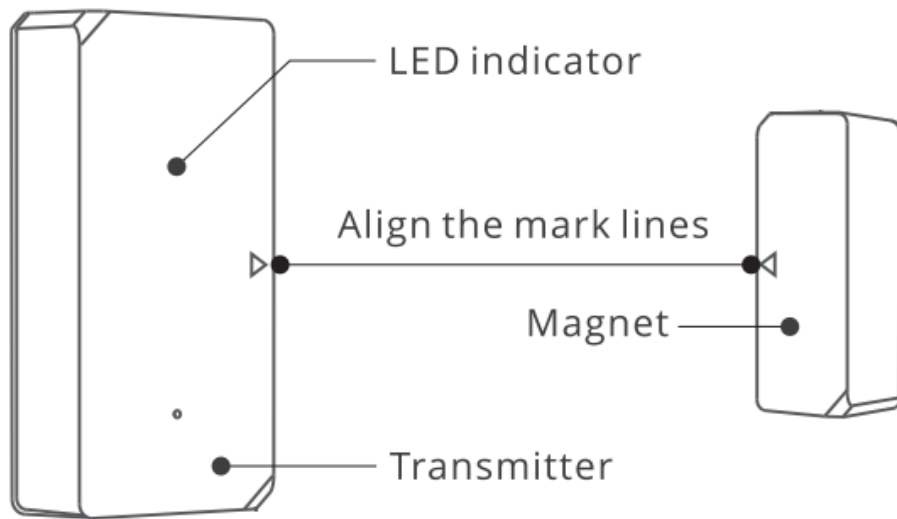

The device's weight is less than 1 kg. An installation height of fewer than 2 is recommended.

Features

DW2-RF is a low-energy wireless door/window sensor that makes you know the opening/closing status of door and window by separating the magnet from the transmitter. Connect it with the Bridge and you can create a smart scene to trigger other devices.



Low-energy



Alarm recordings check



Smart scene

Application

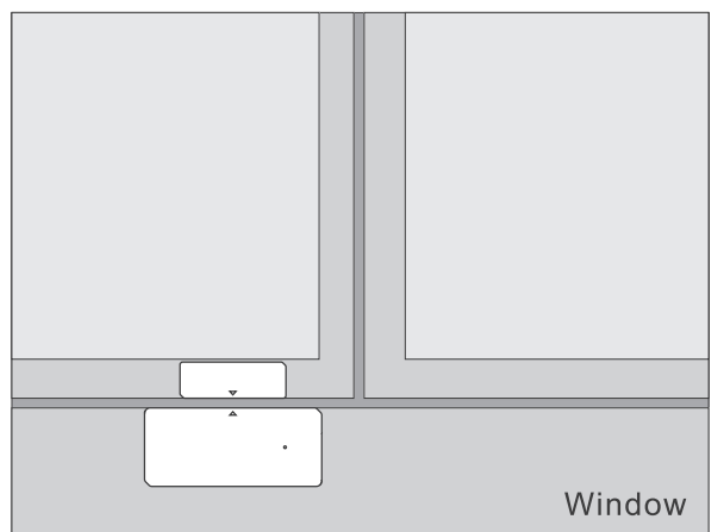
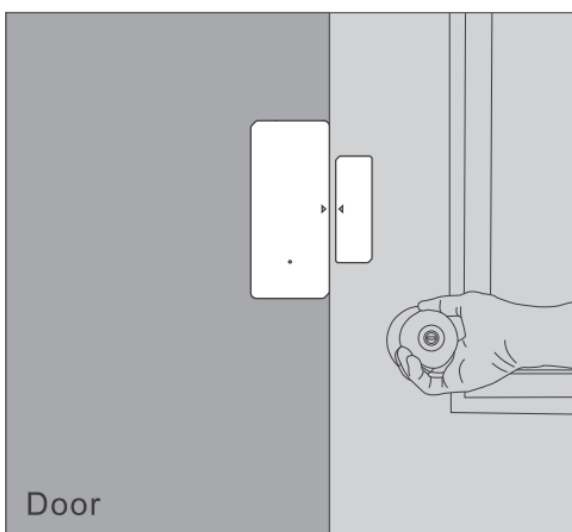

Note:

- Do not install outside the door/window.
- Do not install in an unstable position or in a place exposed to rain or moisture.
- Do not install near wiring or magnetic object.

Replace batteries

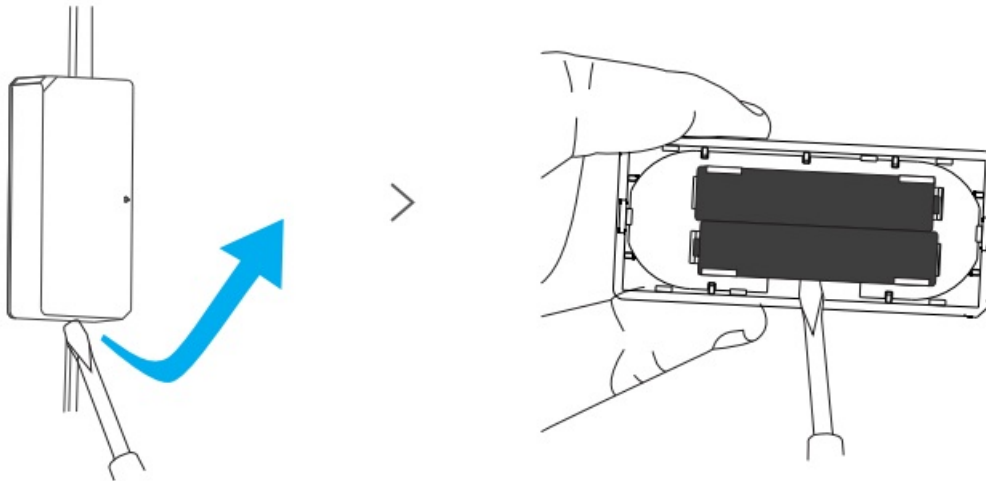

FCC Warning

Changes or modifications not expressly approved by the party responsible for compliance could avoid the user's authority to operate the equipment.

This device complies with part 15 of the FCC Rules. Operation is subject to the following two conditions: (1) This device may not cause harmful interference, and (2) this device must accept any interference received, including interference that may cause undesired operation.

FCC Radiation Exposure Statement:

This equipment complies with FCC radiation exposure limits set forth for an uncontrolled environment. This transmitter must not be co-located or operating in conjunction with any other antenna or transmitter.

Note:

This equipment has been tested and found to comply with the limits for a Class B digital device, pursuant to part 15 of the FCC Rules. These limits are designed to provide reasonable protection against harmful interference in a residential installation. This equipment generates, uses and can radiate radio frequency energy and, if not installed and used in accordance with the instructions, may cause harmful interference to radio communications. However, there is no guarantee that interference will not occur in a particular installation. If this equipment does cause harmful interference to radio or television reception, which can be determined by turning the equipment off and on, the user is encouraged to try to correct the interference by one or more of the following measures:

- Reorient or relocate the receiving antenna.
- Increase the separation between the equipment and receiver.
- Connect the equipment into an outlet on a circuit different from that to which the receiver is connected.
- Consult the dealer or an experienced radio/TV technician for help.

Hereby, Shenzhen Son off Technologies Co., Ltd. declares that the radio equipment type DW2-RF is in compliance with Directive 2014/53/EU. The full text of the EU declaration of conformity is available at the following internet address:

<https://sonoff.tech/usermanuals>

TX Frequency: SRD:433MHz

RF Output Power:-8.50dBm EIRP

 The image shows the cover of the SONOFF DW2-RF User Manual V2.0. It features the SONOFF logo at the top left, followed by 'DW2-RF' and 'User Manual V2.0'. Below this is a diagram of the sensor unit, which is a small rectangular device with a circular indicator light. The text 'RF Wireless Door/Window Sensor' is printed below the diagram. At the bottom, there is a small navigation bar with icons for different sections: 1-4, English, 5-8, and FCC Warning.	<p>SONOFF DW2RF RF-Wireless Door/Window Sensor [pdf] User Manual DW2RF, 2APN5DW2RF, DW2RF RF-Wireless Door, Window x, RF-Wireless Door Sensor</p>
---	---