



SONOFF DW2-RF RF Wireless Door/Window Sensor User Manual

[Home](#) » [SonOFF](#) » SONOFF DW2-RF RF Wireless Door/Window Sensor User Manual 



Contents

- [1 DW2-RF](#)
- [2 RF Wireless Door/Window Sensor](#)
- [3 Operation instruction](#)
 - [3.1 1. Download APP](#)
 - [3.2 2. Install batteries](#)
 - [3.3 3. Add sub-devices](#)
 - [3.4 Install the device](#)
 - [3.5 Specifications](#)
 - [3.6 Product Introduction](#)
 - [3.7 Features](#)
 - [3.8 Application](#)
 - [3.9 Replace batteries](#)
 - [3.10 FCC Warning](#)
- [4 Documents / Resources](#)

DW2-RF

User manual V1.0

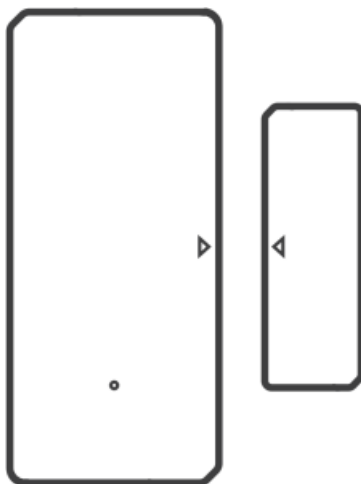

RF Wireless Door/Window Sensor

The device can be operated intelligently via working with the SONOFF 433MHz RF Bridge to communicate with other devices.



The device can work with other gateways supporting 433MHz wireless protocol. Detailed information is in accordance with the final product.

Operation instruction

1. Download APP

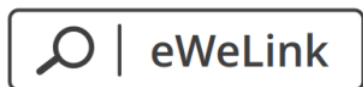

Android™ & iOS

2. Install batteries

2-1. Remove the back cover of the transmitter.

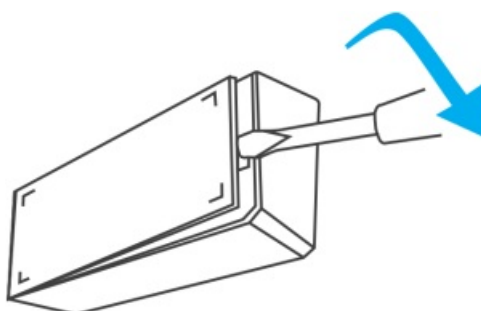

2-2. Insert batteries into the battery compartment based on identifiers of positive and negative poles.

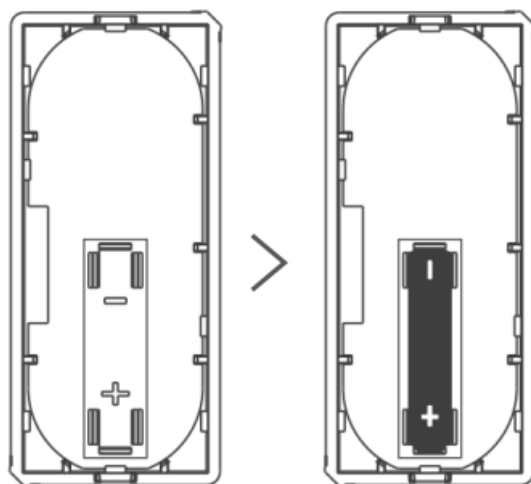

2-3. Close the back cover.

⚠ The battery is not included, please purchase it separately.

3. Add sub-devices

Connect the Bridge before adding the sub-device.

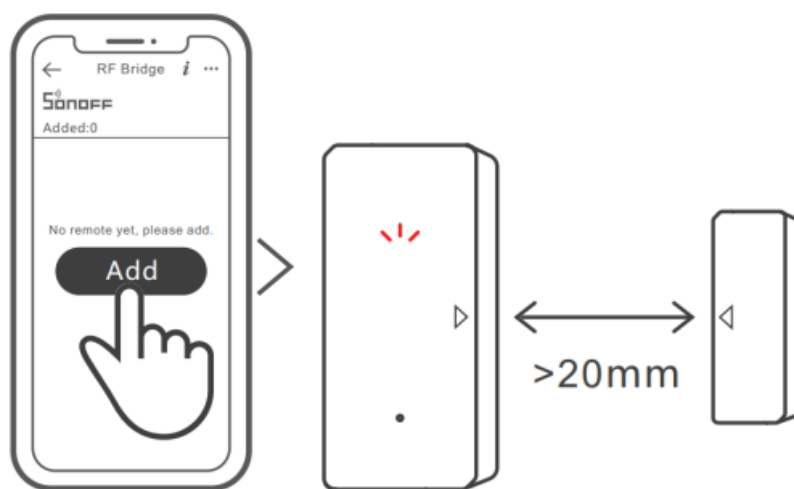

Access the eWeLink APP and select the Bridge, tap “Add” to select the alarm, and a “Beep” means the Bridge enters the pairing mode. Then separate the magnet for more than 20 mm from the transmitter until the LED indicator stays on for 1 to 2s, and the pairing is complete when you hear “Beep Beep”.

⚠ If the addition failed, move the sub-device closer to the Bridge and try again.

Install the device

1. Tear off the protective film of the 3M adhesive.

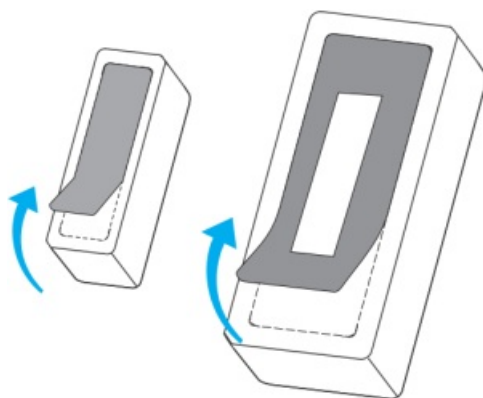

2. Try to align the mark line on the magnet with that on the transmitter during installation.

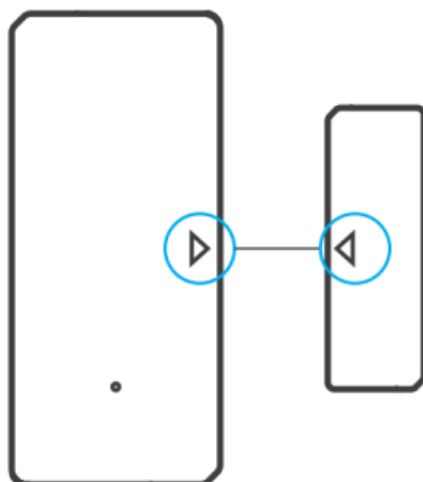

3. Install them in the opening and closing area separately.

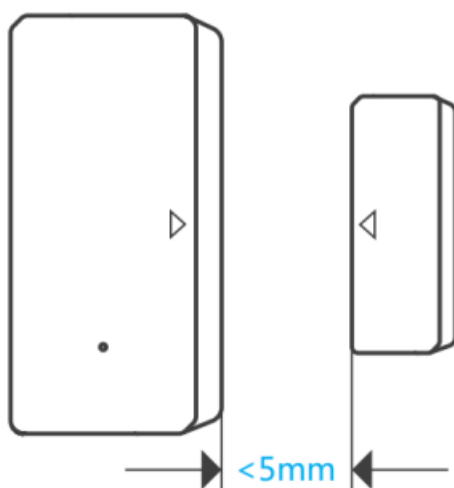

Make sure the installation gap is less than 5mm when the door or the window is closed.

Specifications

Model	DW2-RF
RF	433.92MHz
Quiescent current	$\leq 1.5\mu\text{A}$
Emission current	$\leq 20\text{mA}$
Working voltage	DC12V(Model: 27A 12V)
Wireless transmission distance	Max. 50m
Installation gap	<5mm
Working temperature	-10°C~40°C
Material	PC
Dimension	Transmitter: 70x31x19mm Magnet: 42x14x16mm

Product Introduction

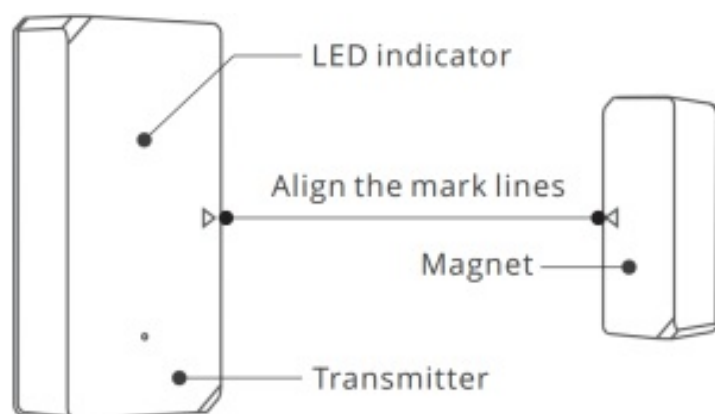

⚠ The device weight is less than 1 kg.
The installation height of less than 2 m is recommended.

Features

DW2-RF is a low-energy wireless door/window sensor that makes you know the opening/closing status of door and window by separating the magnet from the transmitter. Connect it with the Bridge and you can create a smart scene to trigger other devices.



Low-energy Alarm recordings check Smart scene

Application

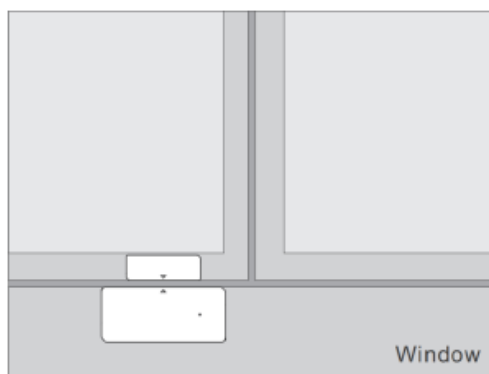
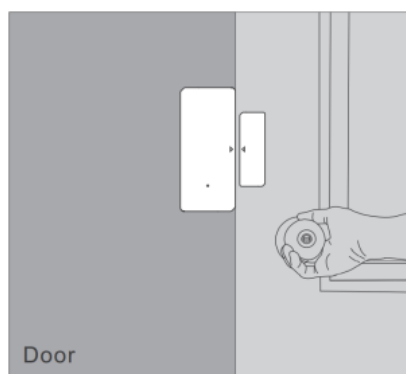

Note:

- Do not install outside the door/window.
- Do not install in the unstable position or in the place exposed to rain or moisture.
- Do not install near wiring or magnetic object.

Replace batteries

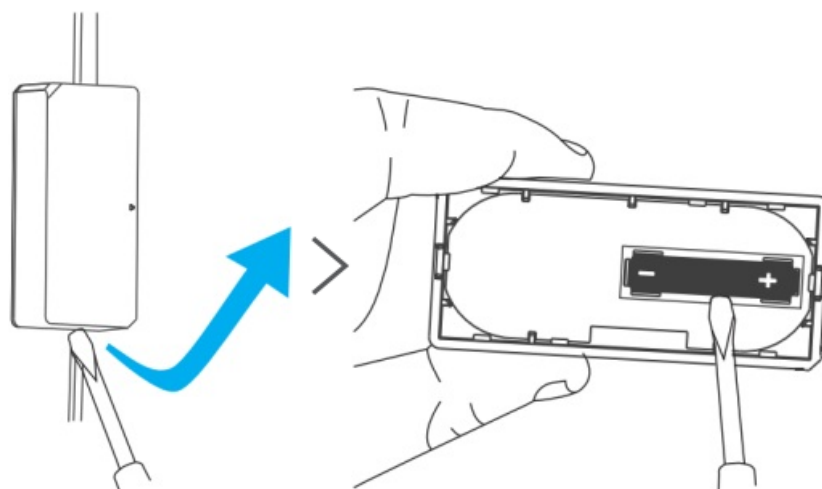

FCC Warning

Changes or modifications not expressly approved by the party responsible for compliance could avoid the user's authority to operate the equipment.

This device complies with part 15 of the FCC Rules. Operation is subject to the following two conditions: (1) This device may not cause harmful interference, and (2) this device must accept any interference received, including interference that may cause undesired operation.

FCC Radiation Exposure Statement:

This equipment complies with FCC radiation exposure limits set forth for an uncontrolled environment. This equipment should be installed and operated with minimum distance 20cm between the radiator & your body. This transmitter must not be co-located or operating in conjunction with any other antenna or transmitter.

Note:

This equipment has been tested and found to comply with the limits for a Class B digital device, pursuant to part 15 of the FCC Rules. These limits are designed to provide reasonable protection against harmful interference in a residential installation. This equipment generates, uses and can radiate radio frequency energy and, if not installed and used in accordance with the instructions, may cause harmful interference to radio communications. However, there is no guarantee that interference will not occur in a particular installation. If this equipment does cause harmful interference to radio or television reception, which can be determined by turning the equipment off and on, the user is encouraged to try to correct the interference by one or more of the following measures:

- Reorient or relocate the receiving antenna.
- Increase the separation between the equipment and receiver.
- Connect the equipment into an outlet on a circuit different from that to which the receiver is connected.
- Consult the dealer or an experienced radio/TV technician for help.

Hereby, Shenzhen Sonoff Technologies Co., Ltd. declares that the radio equipment type DW2-RF is in compliance with Directive 2014/53/EU. The full text of the EU declaration of conformity is available at the following internet address:

<https://sonoff.tech/usermanuals>

TX Frequency: SRD:433.92MHz
RF Output Power: -28.16dBm ERP



Shenzhen Sonoff Technologies Co., Ltd.

1001, BLDG8, Lianhua Industrial Park, shenzhen, GD, China
ZIP code: 518000 Website: sonoff.tech



Documents / Resources

	<p>SONOFF DW2-RF RF Wireless Door/Window Sensor [pdf] User Manual DW2-RF, RF Wireless Door, Window Sensor</p>
	<p>SONOFF DW2-RF RF Wireless Door/Window Sensor [pdf] User Manual DW2-RF, RF Wireless Door Sensor, RF Wireless Window Sensor</p>

