



Sonoff DW2-RF 433MHz Wireless Door-Window Sensor User Manual

[Home](#) » [SonOFF](#) » Sonoff DW2-RF 433MHz Wireless Door-Window Sensor User Manual

Contents [[hide](#)]

- [1 Sonoff DW2-RF 433MHz Wireless Door-Window Sensor](#)
- [2 Product Features](#)
- [3 How to Use](#)
- [4 Operation Instruction](#)
- [5 Specifications](#)
- [6 Operation Instruction](#)
- [7 Install the device](#)
- [8 Specifications](#)
- [9 Product Introduction](#)
- [10 Replace batteries](#)
- [11 Warranty Conditions](#)
- [12 EU Declaration of Conformity](#)
- [13 Documents / Resources](#)
 - [13.1 References](#)
- [14 Related Posts](#)



Sonoff DW2-RF 433MHz Wireless Door-Window Sensor

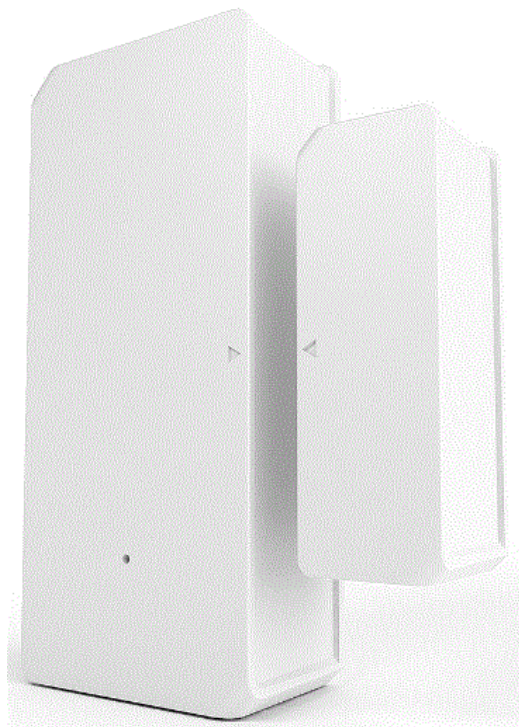

Sonoff DW2-RF

Product Features

- Can be operated intelligently via working with the SONOFF 433MHz RF Bridge to communicate with other devices
- Can work with other gateways supporting 433MHz wireless protocol
- Max. wireless transmission distance of 50m
- Installation gap should be less than 5mm when the door or the window is closed

How to Use

Read the user manual carefully to get the best experience and avoid unnecessary damage. Keep this manual for future reference.

Operation Instruction

1. Download the eWeLink APP on your device.
2. **Install batteries in the transmitter:**
 - Remove the back cover of the transmitter.
 - Insert batteries into the battery compartment based on identifiers of positive and negative poles.
 - Close the back cover. The battery is not included, please purchase it separately.
3. **Add sub-devices:**
 - Connect the Bridge before adding the sub-device.
 - Access the eWeLink APP and select the Bridge, tap Add to select the alarm, and a Beep means the Bridge enters the pairing mode.
 - Then separate the magnet for more than 20 mm from the transmitter until the LED indicator stays on for 1 to 2s, and the pairing is complete when you hear Beep Beep. If the addition failed, move the sub-device

closer to the Bridge and try again.

4. Install the device:

- Tear off the protective film of the 3M adhesive.
- Try to align the mark line on the magnet with that on the transmitter during installation.
- Install them in the opening and closing area separately.

Specifications

Model	RF	Quiescent current	Emission current	Working voltage	Wireless transmission distance	Installation gap	Working temperature	Material	Dimension
DW2-RF	433.92MHz	1.5uA	20mA	DC12V(Model: 27A 12V)	Max. 50m	Less than 5mm when door/window is closed	N/A	N/A	N/A

The product user guide contains product features, how to use, and the operating procedure. Read the user manual carefully to get the best experience and avoid unnecessary damage. Keep this manual for future reference. If you have any questions or comments about the device, please contact the customer line.

www.alza.co.uk/kontakt

+44 (0)203 514 4411

Importer: Alza.cz a.s., Jankovcova 1522/53, Holešovice, 170 00 Praha 7, www.alza.cz

The device can be operated intelligently via working with the SONOFF 433MHz RF Bridge to communicate with other devices.

The device can work with other gateways supporting 433MHz wireless protocol. Detailed information is in accordance with the final product.

Operation Instruction

Download APP

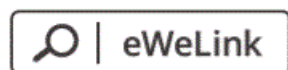

Android™ & iOS

Install batteries

Remove the back cover of the transmitter.

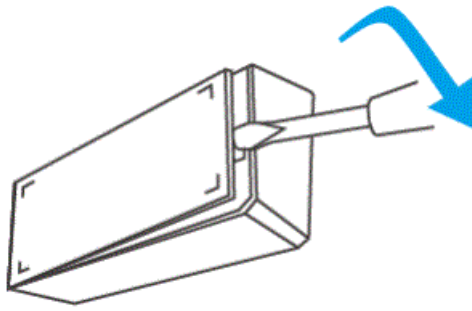

Insert batteries into the battery compartment based on identifiers of positive and negative poles.

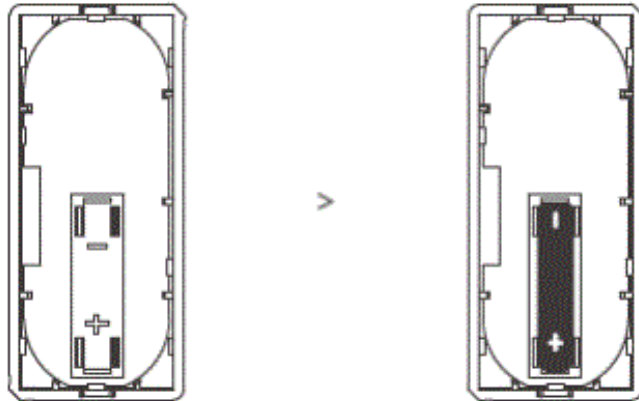

Close the back cover.

The battery is not included, please purchase it separately.

add sub-devices

Connect the Bridge before adding the sub-device.

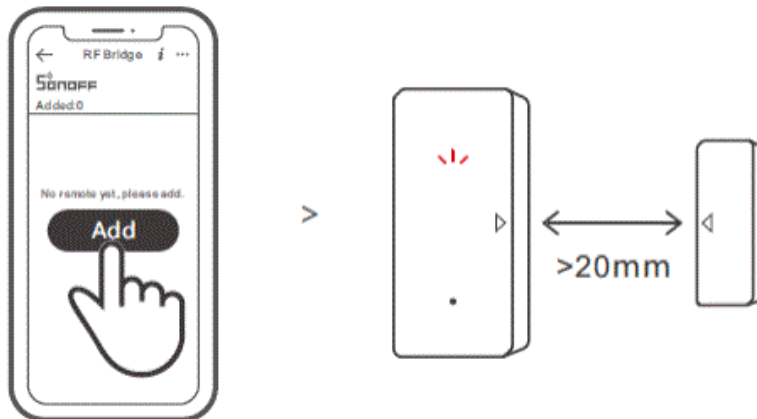

Access the eWeLink APP and select the Bridge, tap “Add” to select the alarm, and a “Beep” means the Bridge enters the pairing mode. Then separate the magnet for more than 20 mm from the transmitter until the LED indicator stays on for 1 to 2s, and the pairing is complete when you hear “Beep Beep”. If the addition failed, move the sub-device closer to the Bridge and try again.

Install the device

1. Tear off the protective film of the 3M adhesive.

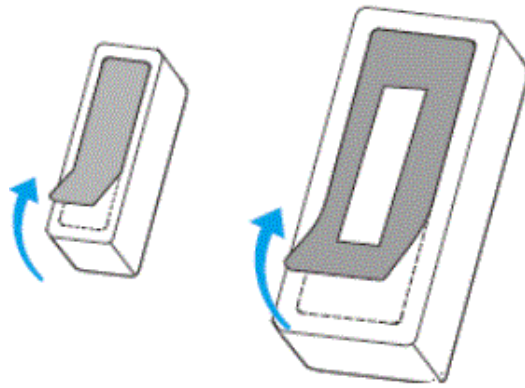

2. Try to align the mark line on the magnet with that on the transmitter during installation.

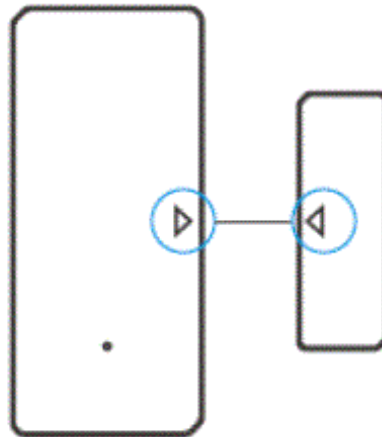

3. Install them in the opening and closing area separately.

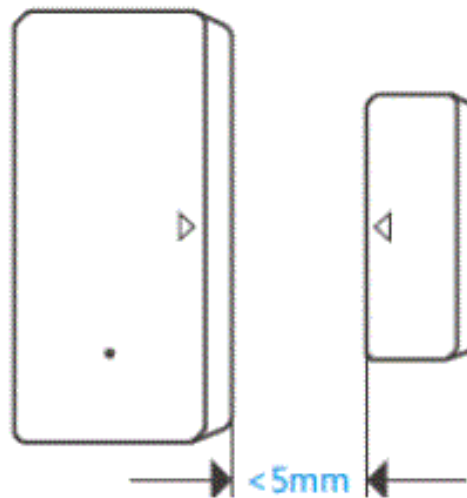

Make sure the installation gap is less than 5mm when the door or the window is closed.

Specifications

Model	DW2-RF
RF	433.92MHz
Quiescent current	≤1.5uA
Emission current	≤20mA
Working voltage	DC12V(Model: 27A 12V)
Wireless transmission distance	Max. 50m
Installation gap	<5mm
Working temperature	-10°C~40°C
Material	PC
Dimension	Transmitter: 70x31x19mm Magnet: 42x14x16mm

Product Introduction

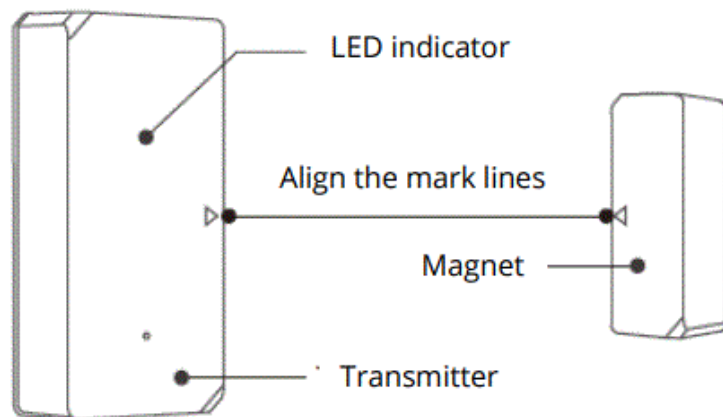

The device weight is less than 1 kg. The installation height of less than 2 m is recommended.

Features

DW2-RF is a low-energy wireless door/window sensor that makes you know the opening/closing status of door and window by separating the magnet from the transmitter. Connect it with the Bridge and you can create a smart scene to trigger other devices.



Application

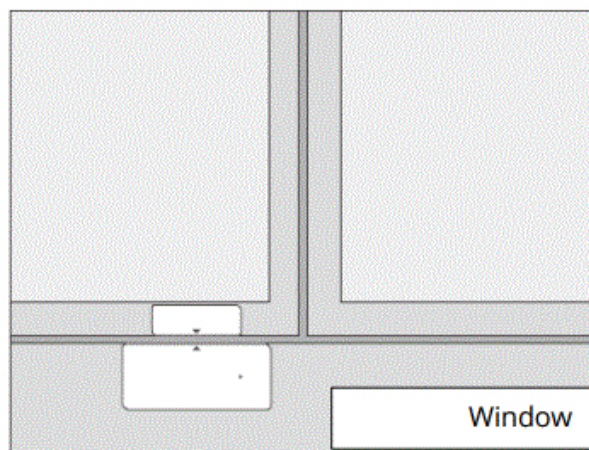
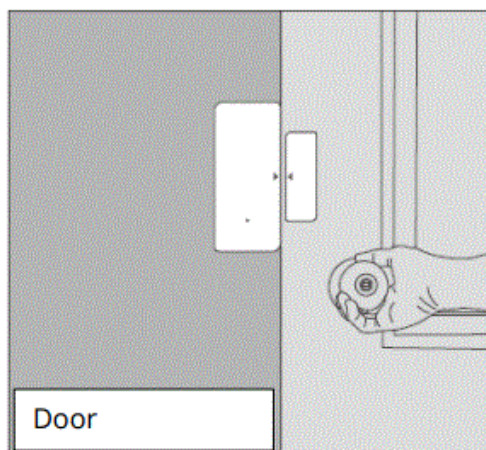

Note:

- Do not install outside the door/window.
- Do not install in the unstable position or In the place exposed to rain or moisture.
- Do not install near wiring or magnetic object.

Replace batteries

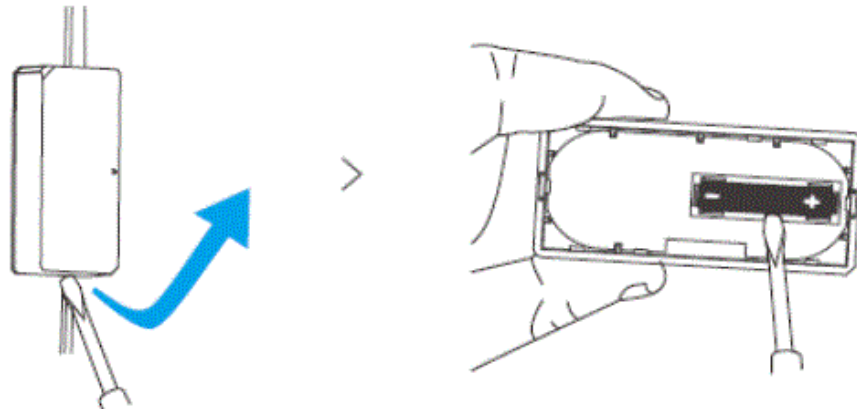

Warranty Conditions

A new product purchased in the Alza.cz sales network is guaranteed for 2 years. If you need repair or other services during the warranty period, contact the product seller directly, you must provide the original proof of purchase with the date of purchase.

The following are considered to be a conflict with the warranty conditions, for which the claimed claim may not be recognized:

- Using the product for any purpose other than that for which the product is intended or failing to follow the instructions for maintenance, operation and service of the product.
- Damage to the product by a natural disaster, the intervention of an unauthorized person or mechanically through the fault of the buyer (e.g. during transport, cleaning by inappropriate means, etc.).
- Natural wear and aging of consumables or components during use (such as batteries, etc.).
- Exposure to adverse external influences, such as sunlight and other radiation or electromagnetic fields, fluid intrusion, object intrusion, mains overvoltage, electrostatic discharge voltage (including lightning), faulty supply or input voltage and inappropriate polarity of this voltage, chemical processes such as used power supplies, etc.
- If anyone has made modifications, modifications, alterations to the design or adaptation to change or extend the functions of the product compared to the purchased design or use of non-original components.

EU Declaration of Conformity

Identification data of the manufacturer's / importer's authorized representative : Importer: Alza.cz a.s.

Registered office: Jankovcova 1522/53, Holešovice, 170 00 Prague 7

CIN: 27082440

Subject of the declaration:

Title: Windows and doors sensor

Model / Type: DW2 RF

The above product has been tested in accordance with the standard(s) used to demonstrate compliance with the essential requirements laid down in the Directive(s):

Directive No. (EU) 2014/53/EU

Directive No. (EU) 2011/65/EU as amended 2015/863/EU

Prague



WEEE





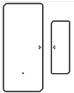

This product must not be disposed of as normal household waste in accordance with the EU Directive on Waste Electrical and Electronic Equipment (WEEE – 2012/19 / EU). Instead, it shall be returned to the place of purchase or handed over to a public collection point for the recyclable waste. By ensuring this product is disposed of correctly, you will help prevent potential negative consequences for the environment and human health, which could otherwise be caused by inappropriate waste handling of this product. Contact your local authority or the nearest collection point for further details. Improper disposal of this type of waste may result in fines in accordance with national regulations.



Documents / Resources

 <p>Sonoff DW2-RF User Manual - 433MHz Wireless Door-Window Sensor Výhradný prevádzkovateľ: Alza.sk s.r.o.</p>	<p>Sonoff DW2-RF 433MHz Wireless Door-Window Sensor [pdf] User Manual DW2-RF 433MHz Wireless Door-Window Sensor, DW2-RF, 433MHz Wireless Door-Window Sensor, Wireless Door-Window Sensor, Door-Window Sensor, Window Sensor, Sensor</p>
---	---

References

-  [Alza.hu – Kényelmes és biztonságos vásárlás | alza.hu](#)
-  [alza.at](#)
-  [alza.co.uk](#)
-  [alza.de](#)
-  [alza.hu](#)
-  [alza.sk](#)