



# SONOFF CC2652P Zigbee 3.0 USB Dongle Plus User Manual

[Home](#) » [SonOFF](#) » SONOFF CC2652P Zigbee 3.0 USB Dongle Plus User Manual

## Contents [ [hide](#) ]

- [1 SONOFF CC2652P Zigbee 3.0 USB Dongle Plus](#)
- [2 Antenna Installation](#)
- [3 FCC Warning](#)
- [4 Documents / Resources](#)
- [5 Related Posts](#)



## SONOFF CC2652P Zigbee 3.0 USB Dongle Plus



SONOFF Zigbee 3.0 uses Dongle Plus Is designed to hoo directly into your computer or Raspberry Pi and can be used as a coord Jnator our outer for your Zigbee network through ZHA or Zigbee2MQTT In open-source automation platforms like Home Assistant. It is based on the TI Cc2652P+CP2102N and pre-flashed with the Z-Stack3.x.Ocoordinatorfirmware.

## Antenna Installation

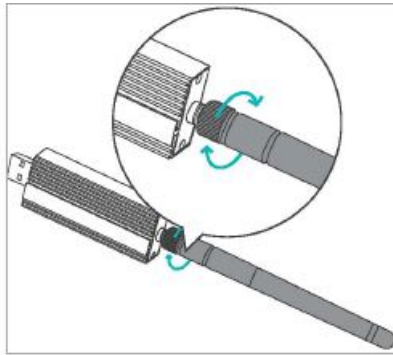

## Supported Device Types

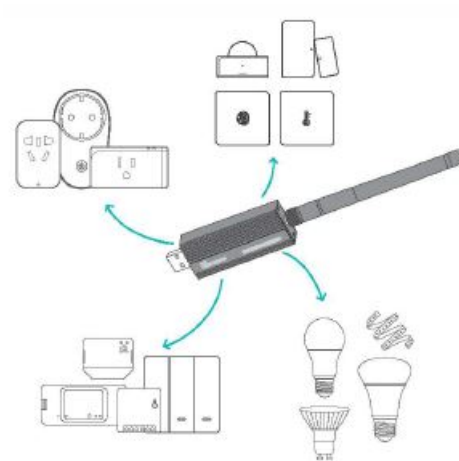

## More Detailed Tutorials



<https://sonoff.tech/uncategorized/zigbee-3-0-usb-dongle-plus/>

Scan the QR code or enter the URL to view the detailed tutorial.

## FCC Warning

Changes or modifications not expressly approved by the party responsible for compliance could void the user's authority to operate the equipment.

This device complies with part 15 of the FCC Rules. Operation is subject to the following two conditions: (1) This device may not cause harmful interference, and (2) this device must accept any interference received, including interference that may cause undesired operation.

## FCC Radiation Exposure Statement:

This equipment complies with FCC radiation exposure limits set forth for an uncontrolled environment. This equipment should be installed and operated with a minimum distance of 20cm between the radiator & your body. This transmitter must not be co-located or operating in conjunction with any other antenna or transmitter

**Note:**

- This equipment has been tested and found to comply with the limits for a Class B digital device, pursuant to part 15 of the FCC Rules. These limits are designed to provide reasonable protection against harmful interference in residential installation. This equipment generates, uses, and can radiate radio frequency energy and, if not installed and used in accordance with the instructions, may cause harmful interference to radio communications. However, there is no guarantee that interference will not occur in a particular installation. If this equipment does cause harmful interference to radio or television reception, which can be determined by turning the equipment on and off, the user is encouraged to try to correct the interference by one or more of the following measures:

Reorient or relocate the receiving antenna.

-increase the separation between the equipment and receiver.

– Connect the equipment into an outlet on a circuit different from that to which the receiver is connected.

– Consult the dealer or an experienced radio/TV technician for help.

Hereby, Shenzhen Sonoff Technologies Co., Ltd. declares that the radio equipment type ZBDongle-P is in compliance with Directive 2014/53/EU. The full text of the EU declaration of conformity is available at the following Internet address:

Shenzhen Sonoff Technologies Co., Ltd. 1001, BLDGB, Lianhua Industrial Park. Shenzhen, GD, China  
ZIP code: 518000 Website: [sonoff.tech](http://sonoff.tech)

## Documents / Resources

	<p><a href="#">SONOFF CC2652P Zigbee 3.0 USB Dongle Plus</a> [pdf] User Manual CC2652P Zigbee 3.0 USB Dongle Plus, CC2652P, Zigbee 3.0 USB Dongle Plus</p>
---	--