

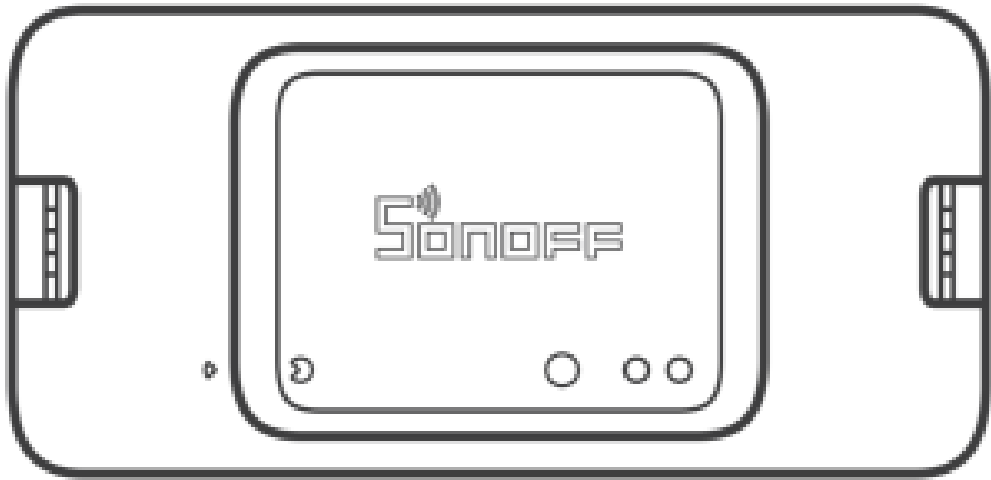

SONOFF BASICZBR3 ZigBee DIY Smart Switch User Manual

[Home](#) » [SonOFF](#) » SONOFF BASICZBR3 ZigBee DIY Smart Switch User Manual 

SONOFF BASICZBR3 ZigBee DIY Smart Switch



The device can be operated intelligently via working with the SONOFF ZigBee Bridge.

 The device can work with other gateways supporting ZigBee 3.0 wireless protocol. Detailed information is in accordance with the final product.

Contents

- 1 Operating Instruction
 - 1.1 Power of
 - 1.2 Wiring instruction
 - 1.3 Download APP
 - 1.4 Power on
 - 1.5 Add sub-devices
- 2 Specifications
- 3 Product Introduction
- 4 Features
- 5 Switch Network
- 6 Factory Reset
- 7 Documents / Resources
- 8 Related Posts

Operating Instruction

Power of

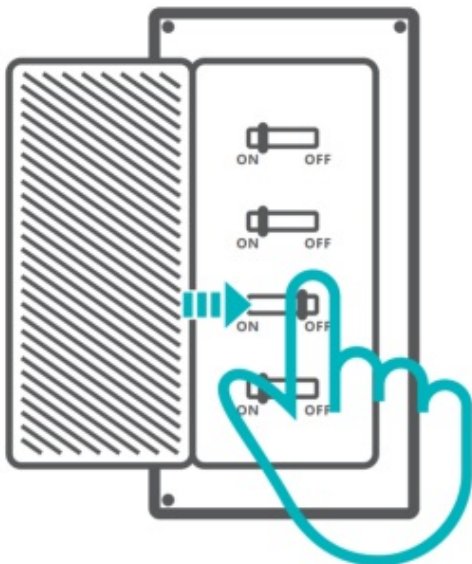

To avoid electric shocks, please consult the dealer or a qualified professional for help when installing and repairing! Please do not touch the switch during use.

Wiring instruction

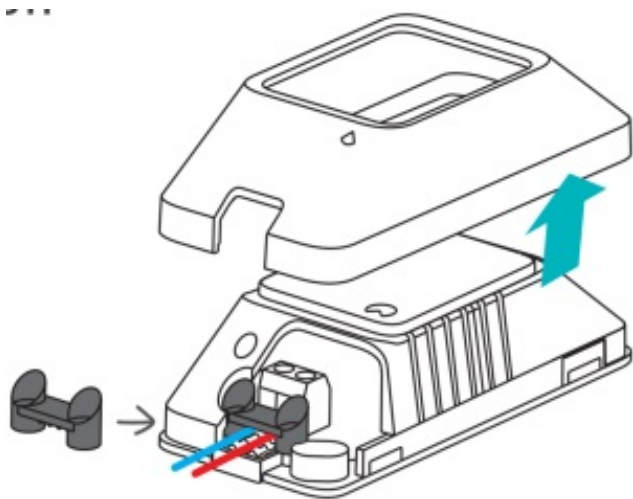

Remove the Protective cover, then connect wires before fixing the wire fastener.

⚠ To make sure a full installation, please align “” with “” when securing the protective cover.

Ceiling lamp wiring instruction

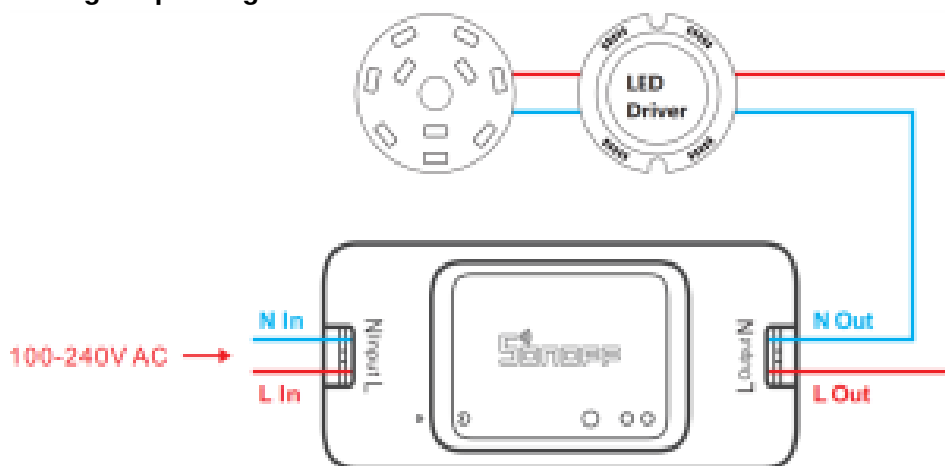

One live wire wiring instruction:

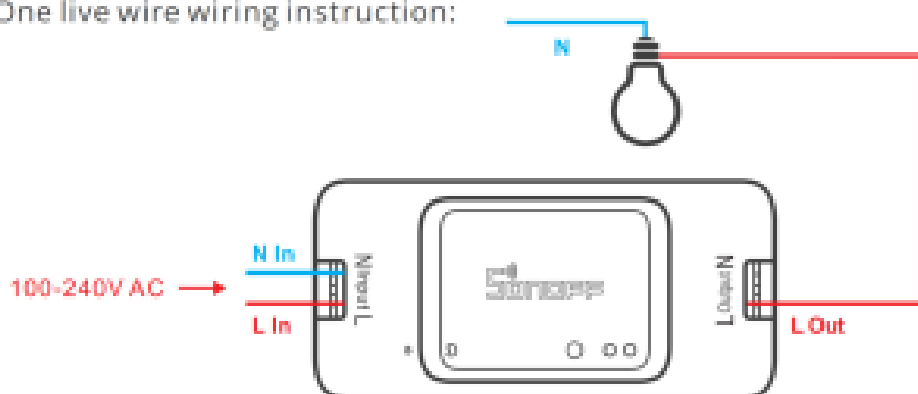

⚠ Make sure the neutral wire and live wire connection is correct.

Download APP

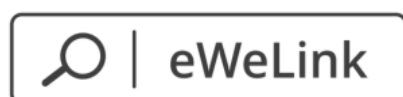



Android™ & iOS

Power on



After powering on, the device will enter the pairing mode during the first use and the ZigBee LED signal indicator flashes.

⚠ The device will exit the pairing mode if no next operation for a long time. If enter again, please long press the pairing button for 5s until the ZigBee LED signal indicator flashes and release.

Add sub-devices

⚠ Connect the SONOFF ZBBridge before adding the sub-device.



Access eWeLink APP, select the Bridge that you want to connect, and tap “Add” to add a sub-device, and be

patient until pairing completes.

⚠ If the addition failed, move the sub-device closer to the Bridge and try again.

SONOFF ZigBee Bridge supports connecting multiple sub-devices at the same time.

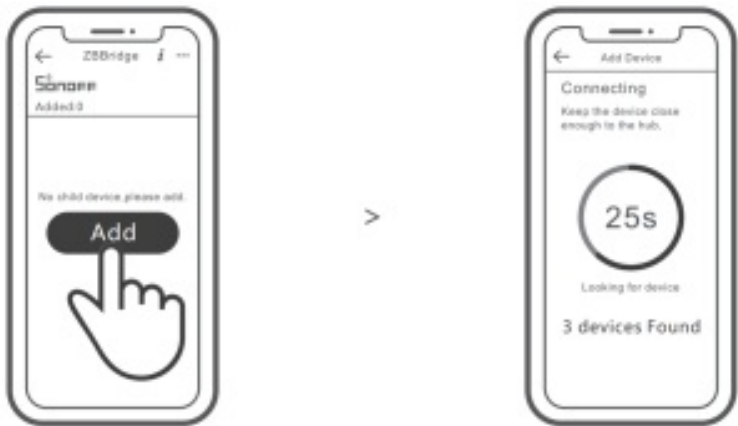

Power the Bridge on, set the sub-device to the pairing mode. Then access the Bridge page in the eWeLink APP to tap “Add”, and be patient until the pairing completes.

More APP application platforms and gateway recommendations

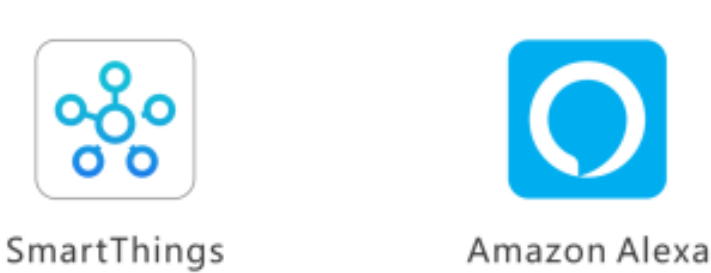

This device supports the following gateways besides SONOFF ZigBee

Echo Studio
Echo Plus (model: ZE39KL)
2nd Gen Echo Show (model: DW84JL)
2nd Gen Echo Plus (model: L9D29R)
Samsung SmartThings hub

Gateway adding instruction:

1. Refer to the gateway user manual to download the matched APP and get it paired.
2. Set ZBMINI to the pairing mode.
3. Add ZBMINI according to the prompt of APP. You should select WeLink or SONOFF when adding.

⚠ If the addition failed, move the sub-device closer to the Bridge and try again.

Specifications

Model	BASICZBR3
Input	100-240V AC 50/60Hz 10A Max
Output	100-240V AC 50/60Hz 10A Max
ZigBee	IEEE 802.15.4
Operating systems	Android & iOS
Working temperature	-10°C~40°C
Material	PC V0
Dimension	91x43x25mm

Product Introduction

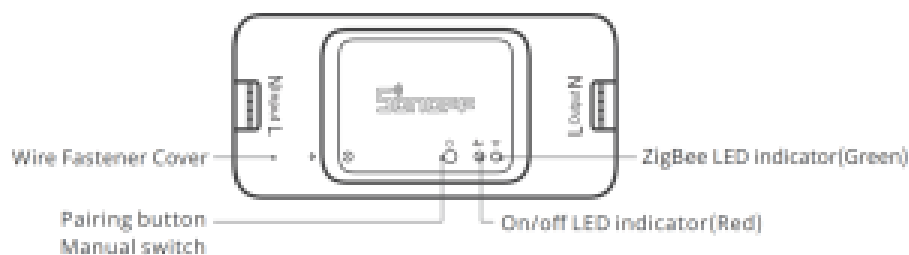

⚠ The device weight is less than 1 kg. The installation height of less than 2 m is recommended.

Features

SONOFF ZigBee smart devices based on ZigBee wireless communication protocol allow you to remotely turn on/off, schedule on/off connected devices, and set smartscenes, etc.



⚠ Above functions are determined by ZigBee Hub.

Switch Network

If you need to change the network, long press the pairing button for 5s until the ZigBee LED signal indicator flashes and release. then the device enters quick pairing mode and you can pair again.

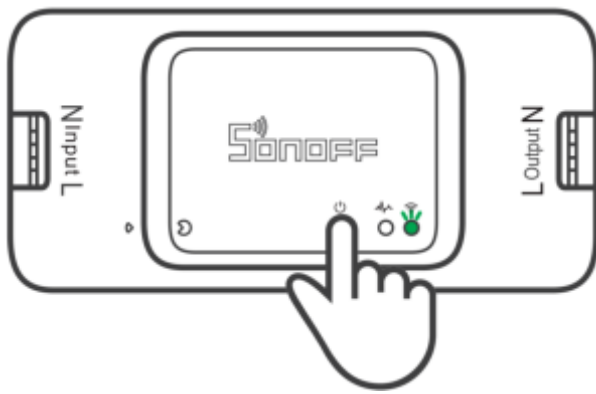

Factory Reset

Deleting the device on the eWeLink app indicates you restore it to factory setting.

Shenzhen Sonoff Technologies Co., Ltd.
 1001, BLDG8, Lianhua Industrial Park, shenzhen, GD, China
 ZIP code: 518000 **Website:** sonoff.tech
 MADE IN CHINA



Documents / Resources

	<p>SONOFF BASICZBR3 ZigBee DIY Smart Switch [pdf] User Manual BASICZBR3, ZigBee DIY Smart Switch</p>
	<p>SONOFF BASICZBR3 ZigBee DIY Smart Switch [pdf] Installation Guide BASICZBR3, ZigBee DIY Smart Switch</p>
	<p>SONOFF BASICZBR3 ZigBee DIY Smart Switch [pdf] Installation Guide BASICZBR3, ZigBee DIY Smart Switch</p>