

# SONOFF 4CHR3 4-Gang Wi-Fi Smart Switch Installation Guide

[Home](#) » [SonOFF](#) » SONOFF 4CHR3 4-Gang Wi-Fi Smart Switch Installation Guide 



Contents

1 SONOFF 4CHR3 4-Gang Wi-Fi Smart Switch Installation Guide

2 1. Power off

3 2. Wiring Instructions

4 3. Download App

5 4. Power ON

6 5. Add the device

7 FCC Warning

8 FCC Radiation Exposure Statement:

9 Documents / Resources

10 Related Posts

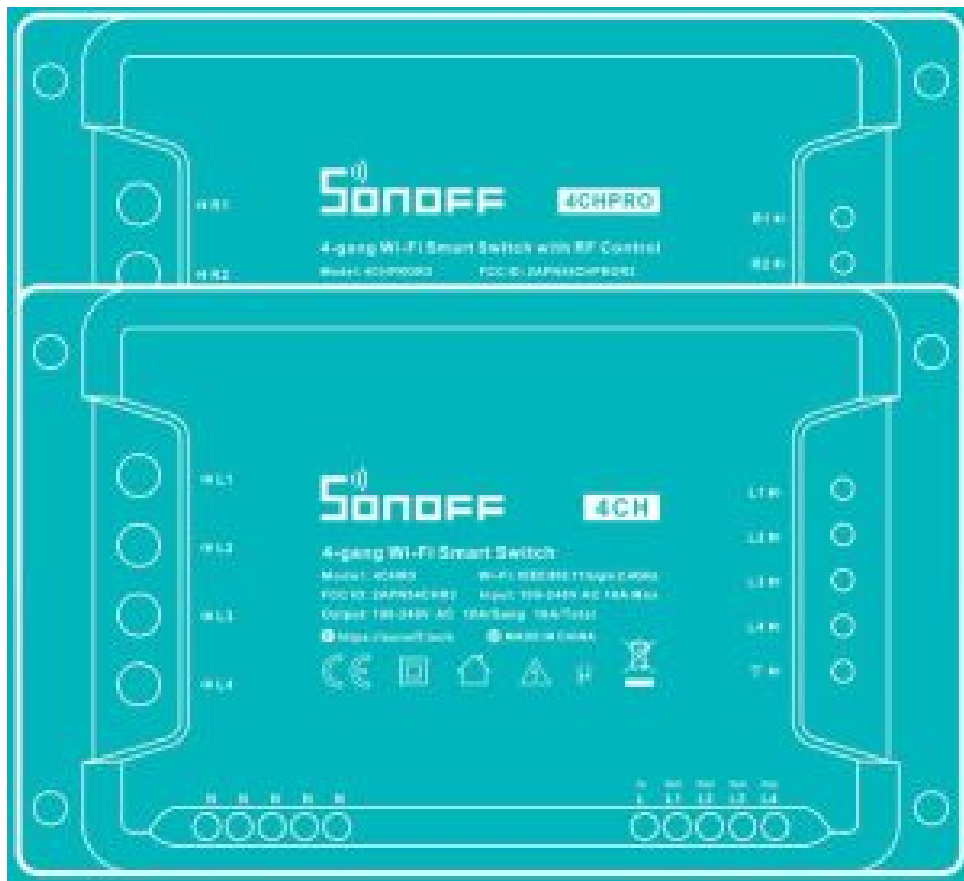

## 1. Power off

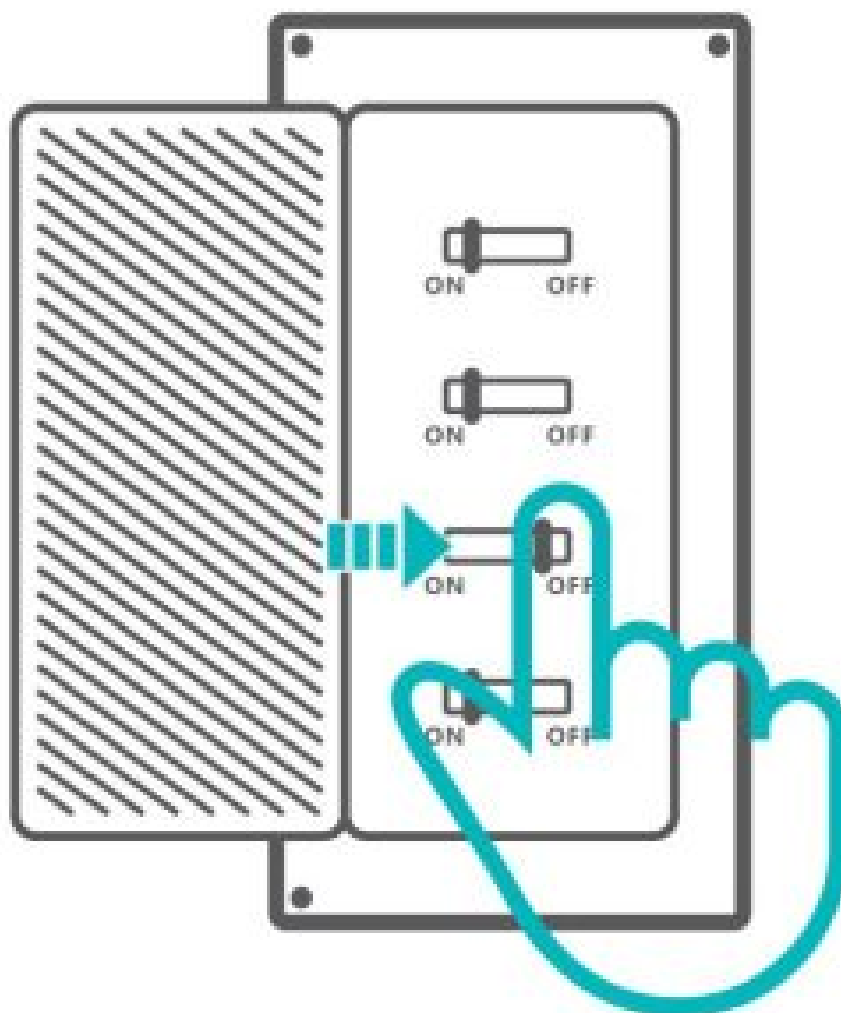

To avoid electric shocks, please consult the dealer or a qualified professional for help when installing and repairing.

## 2. Wiring Instructions

### Light fixture wiring instructions

## 4CHR3

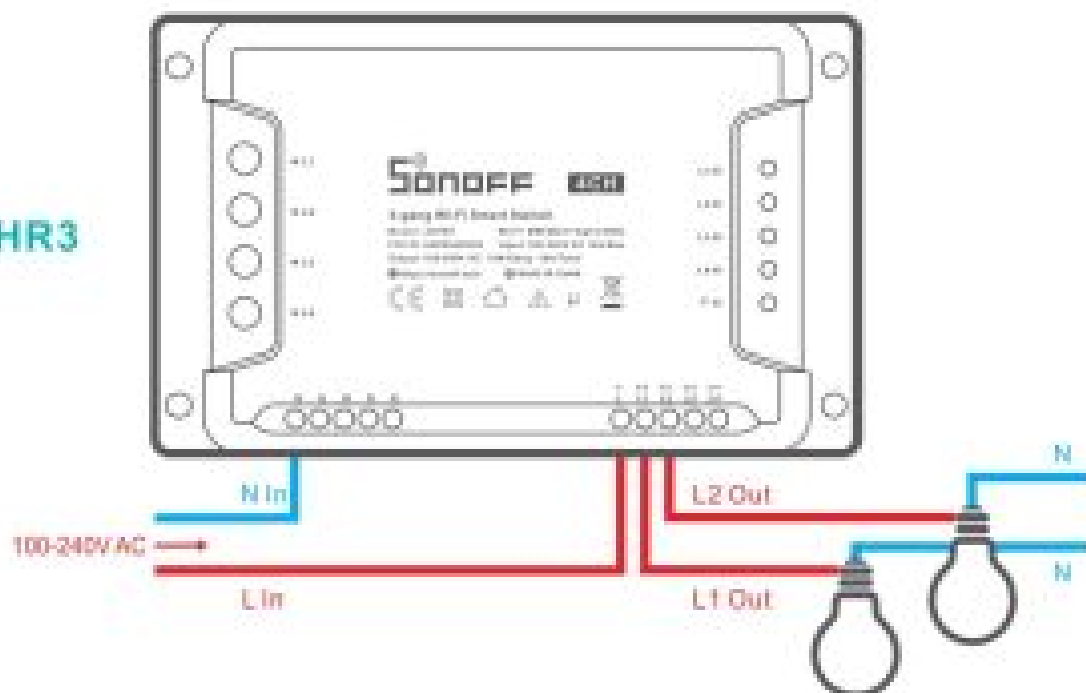

## 4CHPROR3 (DC Input)

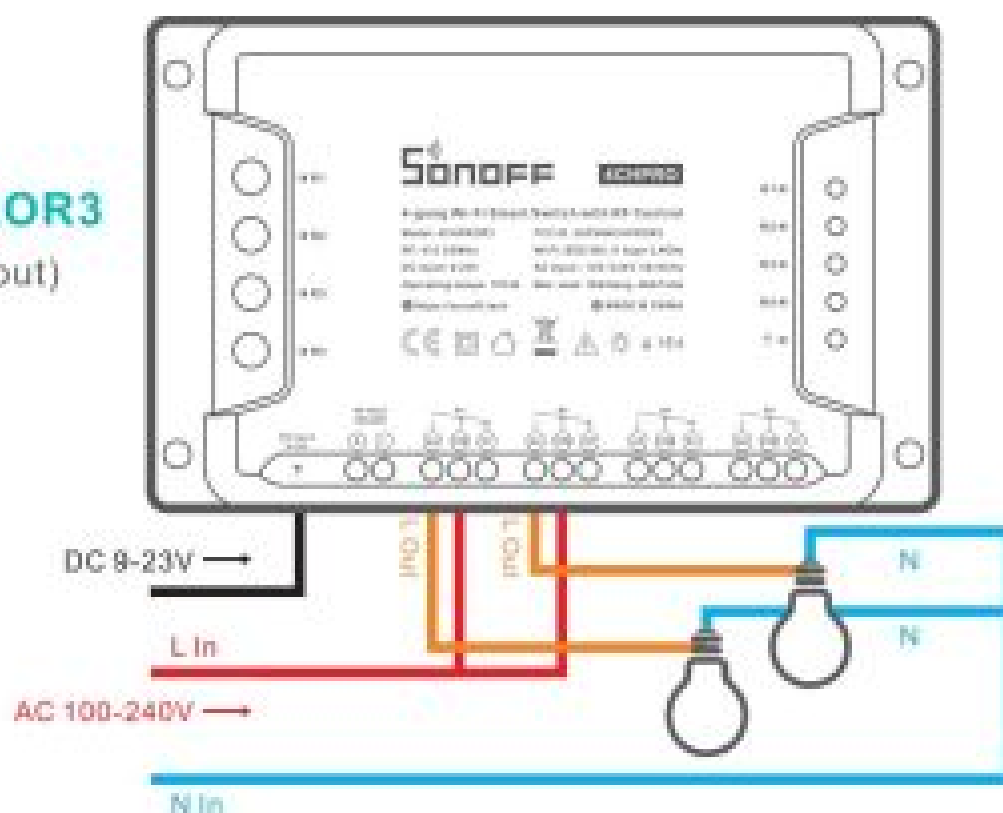

## 4CHPROR3 (AC Input)

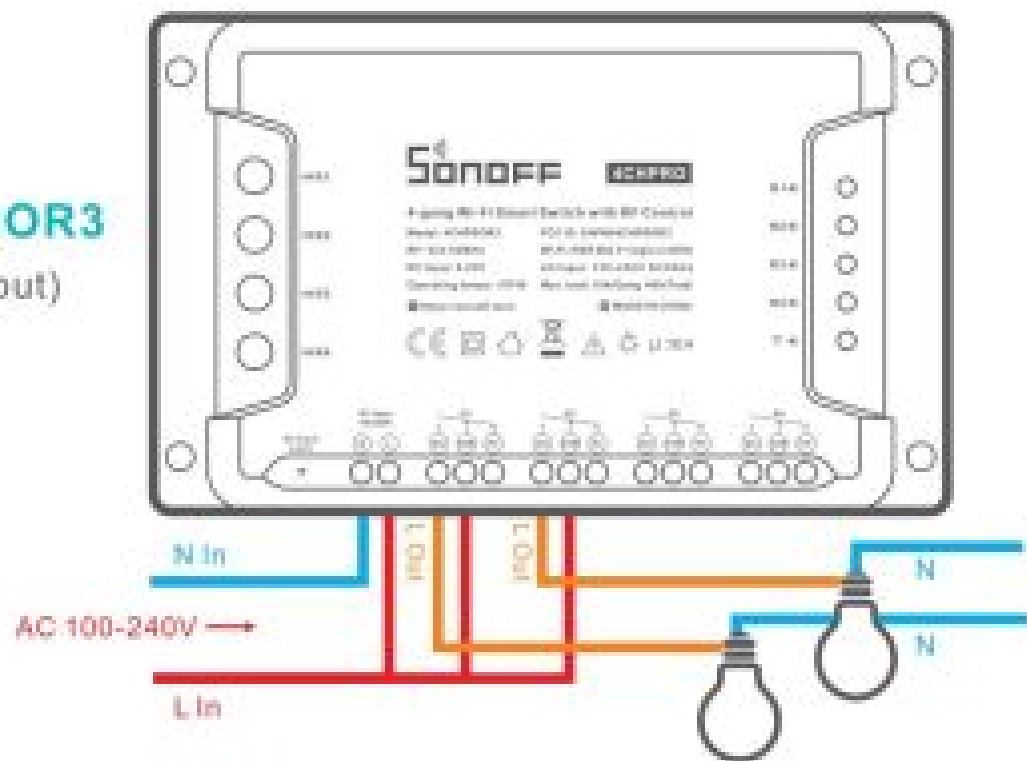

Socket wiring instruction (Don't need to connect if no ground wire)

## 4CHR3

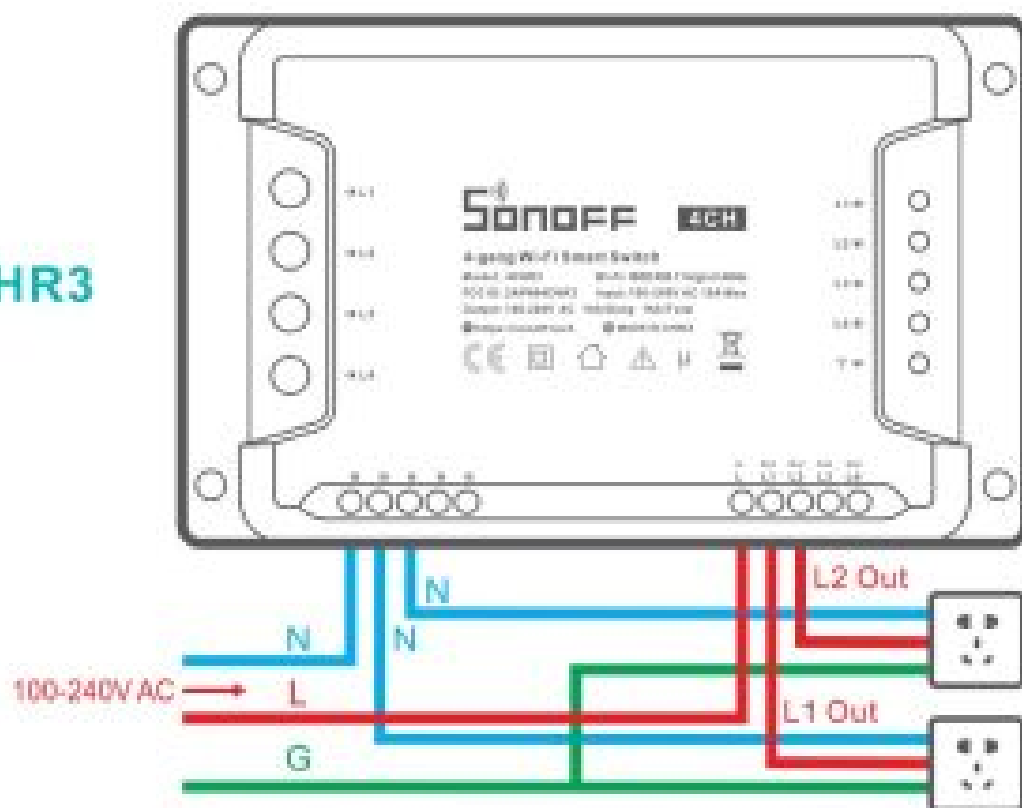

## 4CHPROR3 (DC Input)

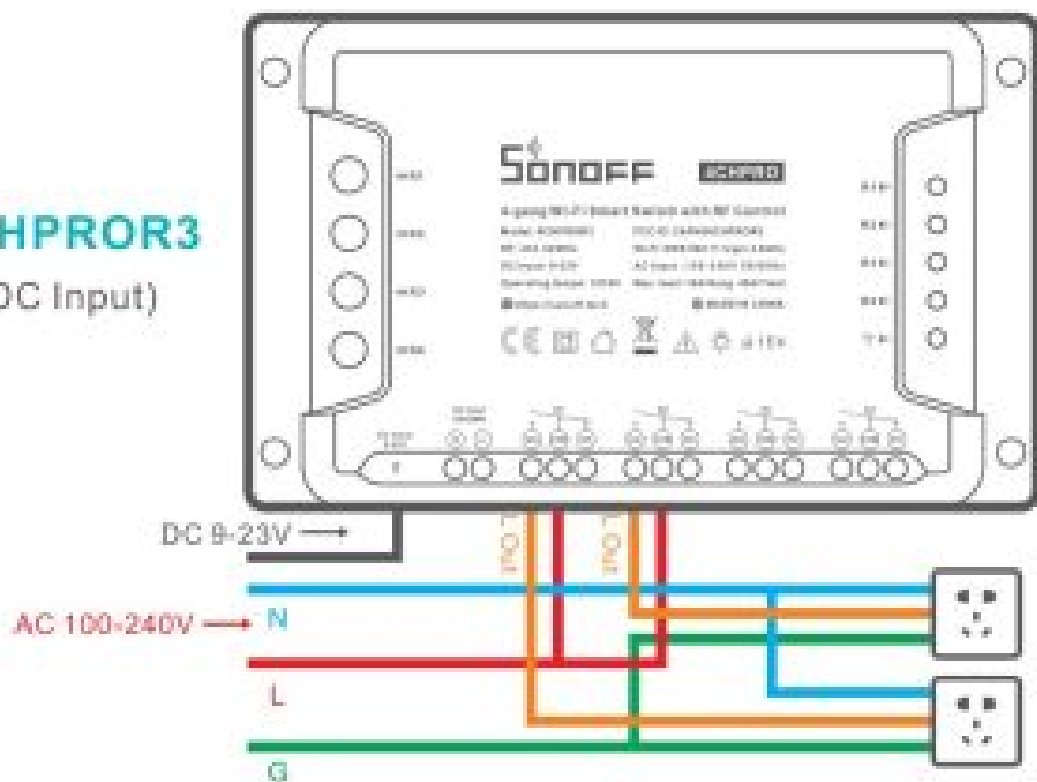

Make sure all wires are connected correctly.

### LIKE IT!

Glad to know you are satisfied with SONOFF products. It would mean a lot to us if you can take a minute to share your buying experience.

# LIKE IT!

Glad to know you are satisfied with SONOFF products.  
It would mean a lot to us if you can take a minute to share your  
buying experience.



Share it on Amazon



Share it on your social media



Share it with your friends and family

Get the latest news by following us:

**New arrival**  
**Promotion**  
**How-to videos**

## HAVE A PROBLEM?

We are so sorry for the inconvenience caused by the product.  
Please contact us for help via the email address below.



[support@itead.cc](mailto:support@itead.cc)

We will get back to you as soon as possible.



### 3. Download App



### 4. Power ON

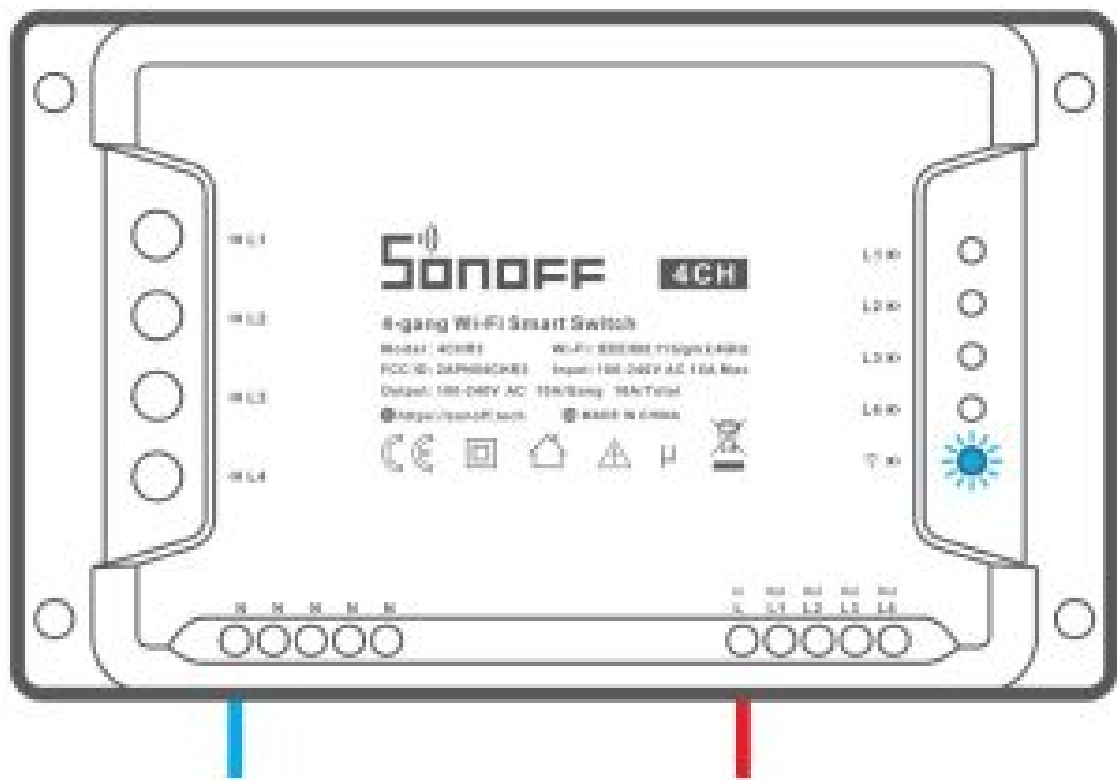

After powering on, the device will enter the quick pairing mode (Touch) during the first use. The Wi-Fi LED indicator changes in a cycle of two short and one long flash and release.

**i** The device will exit the quick pairing mode (Touch) if not paired within 3mins. If you want to enter this mode, please long press any configuration button for about 5s until the Wi-Fi LED indicator changes in a cycle of two short and one long flash and release.

## 5. Add the device

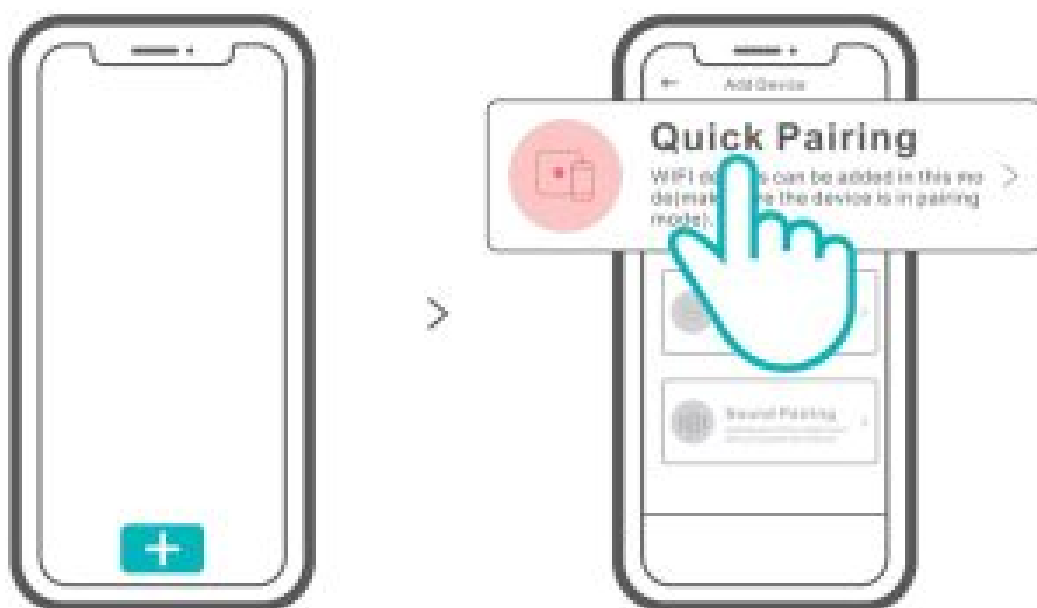

Tap " + " and select "Quick Pairing", then operate following the prompt on the app.



Scan the QR code or visit the website to learn about the detailed user manual and help.

Scan the QR code to read the voice control instruction for Amazon Echo and Google Home.

## **FCC Warning**

Changes or modifications not expressly approved by the party responsible for compliance could avoid the user's authority to operate the equipment. This device complies with part 15 of the FCC Rules. Operation is subject to the following two conditions: (1) This device may not cause harmful interference, and (2) this device must accept any interference received, including interference that may cause undesired operation

## **FCC Radiation Exposure Statement:**

This equipment complies with FCC radiation exposure limits set forth for an uncontrolled environment. This equipment should be installed and operated with minimum distance 20cm between the radiator & your body.

This transmitter must not be co-located or operating in conjunction with any other antenna or transmitter. Note: This equipment has been tested and found to comply with the limits for a Class B digital device, pursuant to part 15 of the FCC Rules.

These limits are designed to provide reasonable protection against harmful interference in a residential installation. This equipment generates, uses and can radiate radio frequency energy and, if not installed and used in accordance with the instructions, may cause harmful interference to radio communications.

However, there is no guarantee that interference will not occur in a particular installation. If this equipment does cause harmful interference to radio or television reception, which can be determined by turning the equipment off and on, the user is encouraged to try to correct the interference by one or more of the following measures:

- Reorient or relocate the receiving antenna.
- Increase the separation between the equipment and receiver.
- Connect the equipment into an outlet on a circuit different from that to which the receiver is connected.
- Consult the dealer or an experienced radio/TV technician for help.

Hereby, Shenzhen Sonoff Technologies Co., Ltd. declares that the radio equipment type 4CHR3/4CHPROR3 is in compliance with Directive 2014/53/EU. The full text of the EU declaration of conformity is available at the following internet address:

<https://www.sonoff.tech/usermanuals>

---

**TX Frequency:**

WIFI: 2412-2472MHz

**RX Frequency:**

WIFI: 2412-2472MHz

SRD: 433.92MHz

**Output Power:**

15.55dBm

16.3dBm(802.11b), 17.16dBm(802.11g), 17.38dBm(802.11n20)

---

**Shenzhen Sonoff Technologies Co., Ltd.**

1001, BLDG8, Lianhua Industrial Park, shenzhen, GD, China ZIP code: 518000

**Made in China**

Website: [sonoff.tech](http://sonoff.tech)

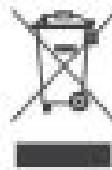

**Read More About This Manual & Download PDF:**

**Documents / Resources**



[SONOFF 4CHR3 4-Gang Wi-Fi Smart Switch](#) [pdf] Installation Guide  
4CHR3, 4CHPROR3, 4-Gang Wi-Fi Smart Switch