

Sonoff 4CHPRO-R3 4-gang Wi-Fi Smart Switch with RF Control User Manual

[Home](#) » [SonOFF](#) » Sonoff 4CHPRO-R3 4-gang Wi-Fi Smart Switch with RF Control User Manual

Sonoff 4CHPRO-R3 4-gang Wi-Fi Smart Switch with RF Control User Manual



Contents [[hide](#)]

- [1 Product Introduction](#)
- [2 Features](#)
- [3 RF Remote Controller Pairing](#)
- [4 Factory Reset](#)
- [5 Common Problems](#)
- [6 LED indicator status instruction](#)
- [7 Specifications](#)
- [8 Documents / Resources](#)
- [9 Related Posts](#)

Product Introduction

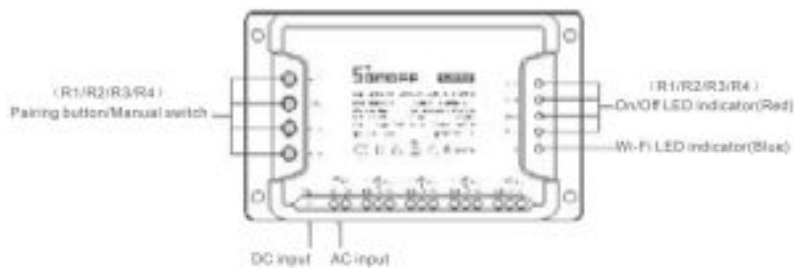

Features

4CHPROR3 is a 4-gang Wi-Fi smart switch with self-locking, interlock and inching that allow you to remotely turn on/off connected devices via your smartphone, schedule on or off, share to your family to control together.

- Remote Control



- Single/Countdown Timing



- Voice Control



- I Share Control

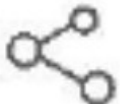

- Smart Scene



- Power-on State



- Camera Feature



- Self-locking



- Interlock



- Interlock



- LAN Control



RF Remote Controller Pairing

Pairing Method:

Long press the channel switch that you want to pair for 3s until the LED “flashes quickly once” and release, then short press the remote controller button that your want to pair. The red channel switch button LED “flashes quickly once” indicates that the pairing is successful. Other remote controller buttons can be paired according to this method.

Clearing Method:

Long press the channel switch that you want to clear for 5s until the LED “flashes quickly twice” and release, then short press the remote controller button that your want to clear. The red channel switch button LED “flashes quickly once” indicates that the clearing is successful. Other remote controller buttons can be cleared according to this method.

Factory Reset

Long press the pairing button for about 5s until the Wi-Fi LED indicator changes in a cycle of two short and one long flash and release, then the reset is successful. The device enters quick pairing mode (Touch).

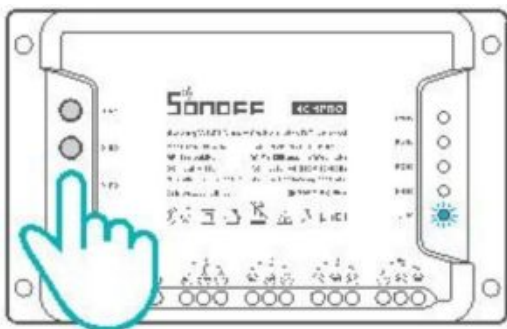

Please reset the switch to factory defaults if you want to change Wi-Fi the network, then reconnect the new network.

Common Problems



Tap “ ” on eWeLink APP and select “FAQ” to check.

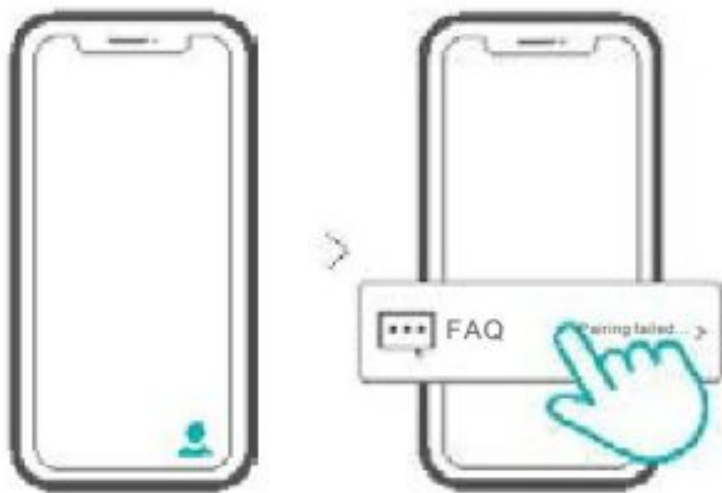

LED indicator status instruction

LED indicator status	Status instruction
Blue LED flashes (one long and two short)	Quick pairing mode
Blue LED keeps on	Device is connected successfully
Blue LED flashes quickly once	Unable to discover the router
Blue LED flashes quickly twice	Connect to the router but fail to connect to Wi-Fi
Blue LED flashes quickly three times	Upgrading
Red LED is on/off	Device is on/off

Specifications

Model	4CHPROR3
DC Input	9-23V
AC Input	100-240V 50/60Hz
Max. Load	10A/gang 40A/Total
Wi-Fi	IEEE 802.11 b/g/n 2.4GHz
Operating systems	(Android 4.1 & iOS 9.0)or higher
Material	PC
Dimension	145x90x34mm

Documents / Resources

	<p>Sonoff 4CHPRO-R3 4-gang Wi-Fi Smart Switch with RF Control [pdf] User Manual 4CHPRO-R3, 4CHPRO-R3, 4-Gang Wi-Fi Smart Switch with RF Control</p>
---	---