



SOMOGYI ELEKTRONICS NVS 3 RF SMART RF Socket with Master Function Instruction Manual

[Home](#) » [SOMOGYI ELEKTRONICS](#) » **SOMOGYI ELEKTRONICS NVS 3 RF SMART RF Socket with Master Function Instruction Manual** 

Contents

- [1 SOMOGYI ELEKTRONICS NVS 3 RF SMART RF Socket with Master Function](#)
- [2 Countdown timer](#)
- [3 Schedule timer](#)
- [4 TO KNOW BEFORE USING THE WIFI SOCKET](#)
- [5 SPECIFICATIONS](#)
- [6 DISPOSAL](#)
- [7 Documents / Resources](#)
 - [7.1 References](#)
- [8 Related Posts](#)



SOMOGYI ELEKTRONIC®

SOMOGYI ELEKTRONICS NVS 3 RF SMART RF Socket with Master Function



1. Install KT Smart WiFi application from App Store or Google Play store.

3:32 PM

< Register

E-mail

Please input E-mail

Password

Please input password

Repeat Password

Please input password

Password length of 8 to 16 and must contain the English letters and numbers

Register

2. Create a user account with username and an appropriate e-mail address.

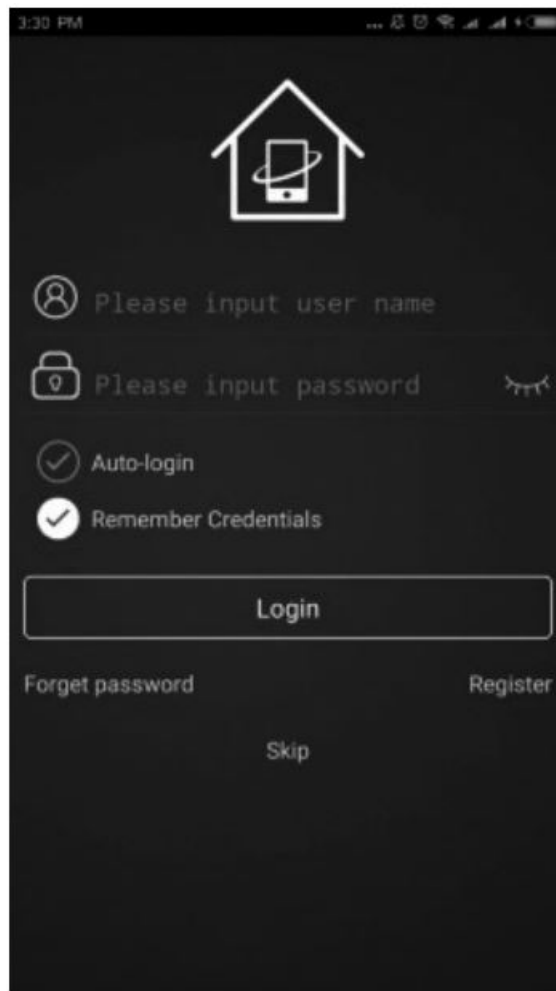

3. Log in to your account with a registered username and password, with WiFi connection.

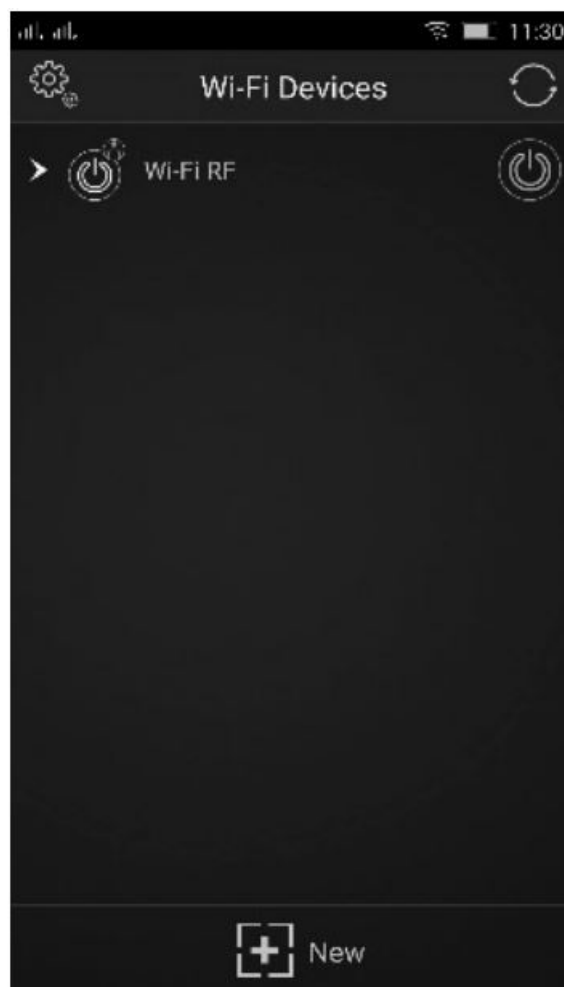

4. Connect your phone to WiFi network and start KT Smart WiFi application. In the menu, tap “New”(Add device)

option.

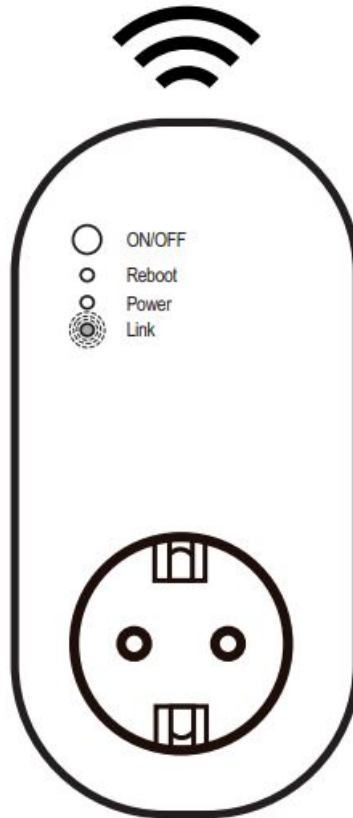

5. Press and hold the ON / OFF button for more than 3 seconds until the WiFi indicator (Link) starts flashing. The WiFi socket is ready to sync.



6. Make sure that your smartphone and WiFi socket are in the same WiFi network. The connection process requires approx. 40 seconds, depending on the network status



7. Once the connection has been made, the WiFi socket will be visible in the application. You can switch it ON / OFF or by sliding left you can edit, delete the device with the appearing icons.

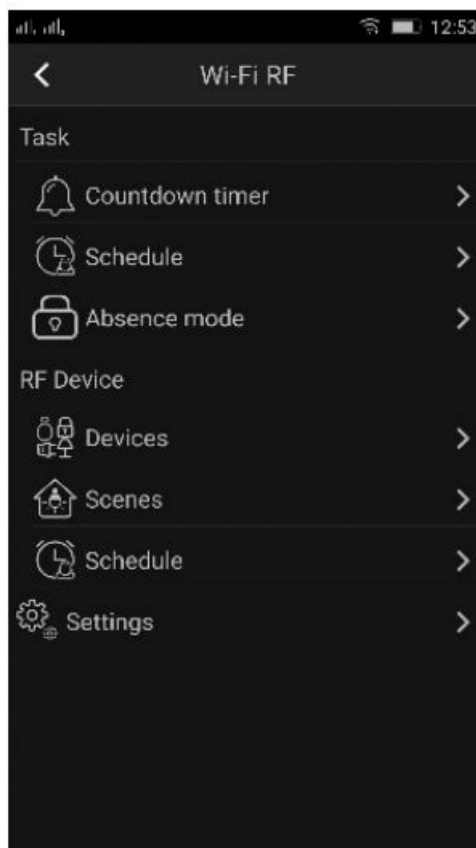

8. Click on the name of the WiFi RF socket to set countdown, scheduled operation, and absence mode. Here, you can add and teach 433.92 MHz RF sockets (THO 1, THO 2, THO 111, THO 113) to the WiFi RF socket. You need to buy them separately.

Countdown timer

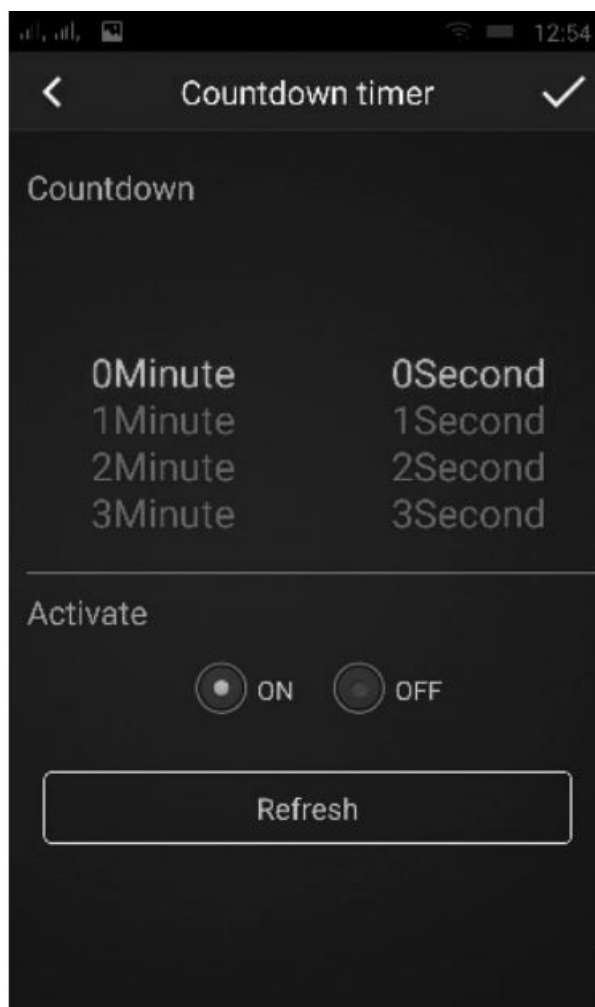

Countdown timer – Turn on/off device plugged into the WiFi socket by the time assigned.



By pressing the + button, you can add a new 433,92 MHz RF socket. Enter the name of the socket (e.g. THO 1),

and the type of it (Switch).

Schedule timer

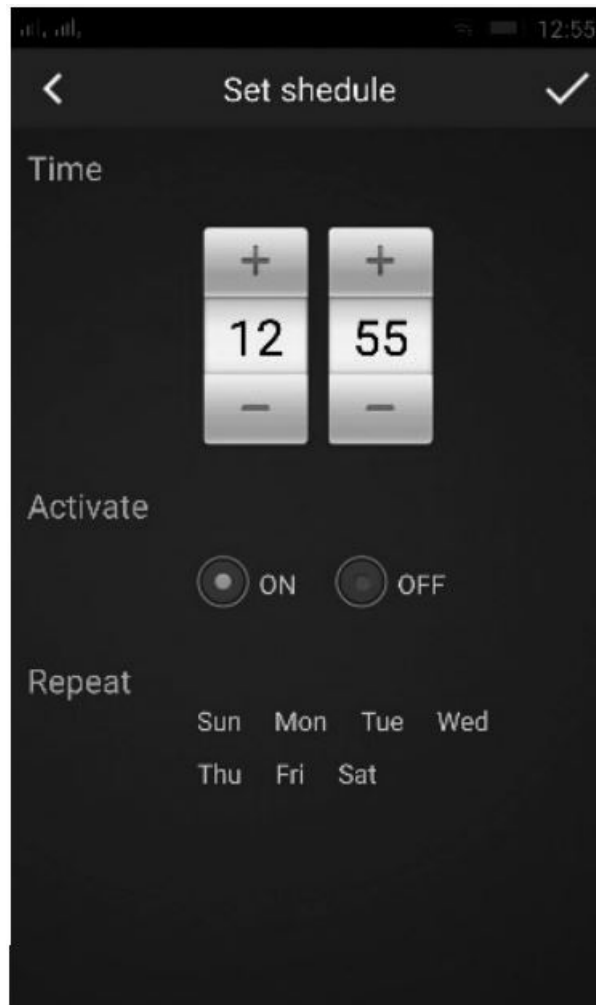

Schedule Timer – Perform the same routine operation at the same time in a week for your home appliances.

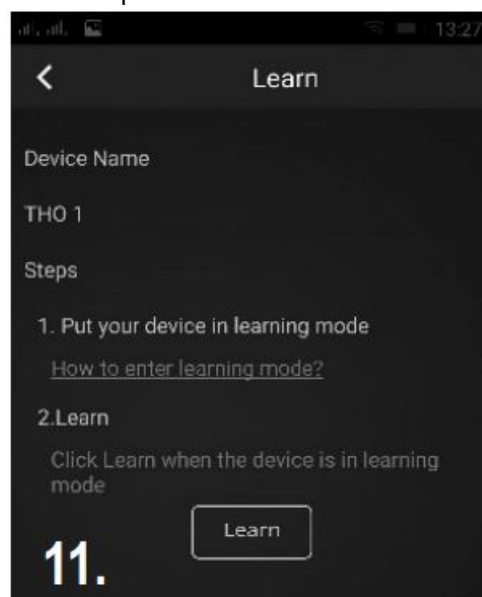

After saving the device's name, you can pair the 433.92 MHz RF socket in the next window. To do this, hold pressed the RF socket (e.g. THO 1) button for 3-6 seconds and release. The RF socket flashes. Then press the Learn button in the application. If the teaching is successful, the program can now turn ON/OFF the RF socket. **IMPORTANT!** The 433,92 MHz RF socket is only an end point, there is no feedback to the application, that the ON/OFF switch has been done indeed! We recommend you, to be present when switching the RF sockets, or do not switch a device that has an on/off state that poses a safety risk!

12:55

< Absence mode ✓

Interval

Please input interval Minute

Start time >

End time >

1 2 3 -

4 5 6 √

7 8 9 X

, 0 . ✓

Absence Mode – Protect your home by switching on or off the lights connected to the WiFi socket. Select the start and end times and the length of switch-on times.

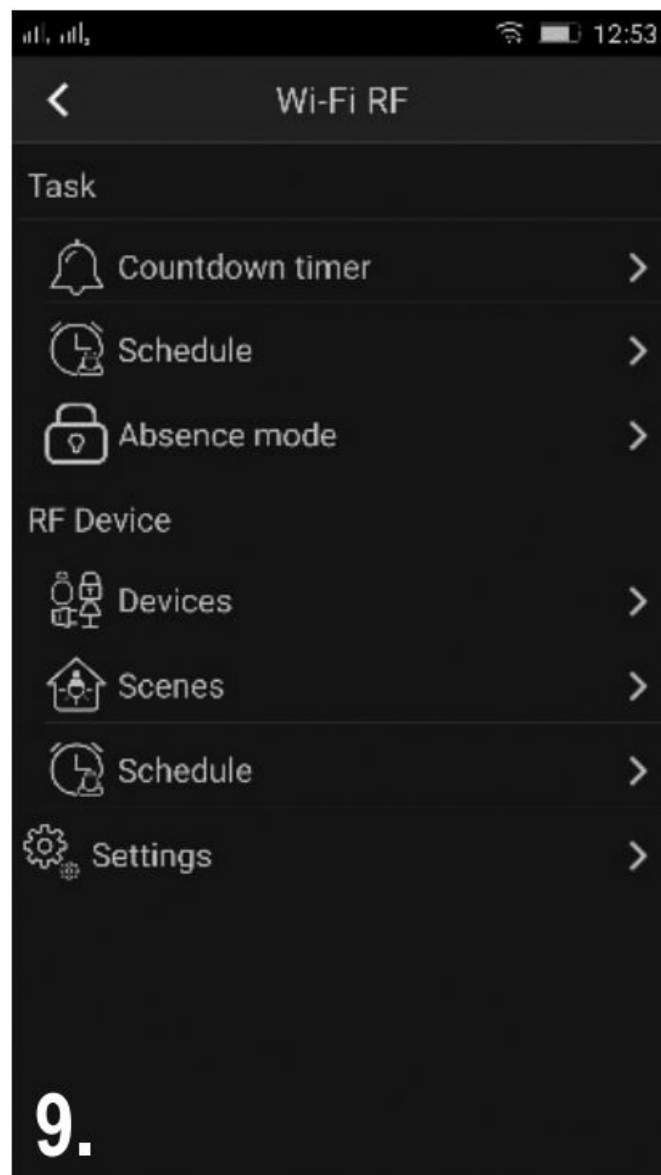

To pair the 433,92 MHz RF sockets, press the RF Device / Devices menu.

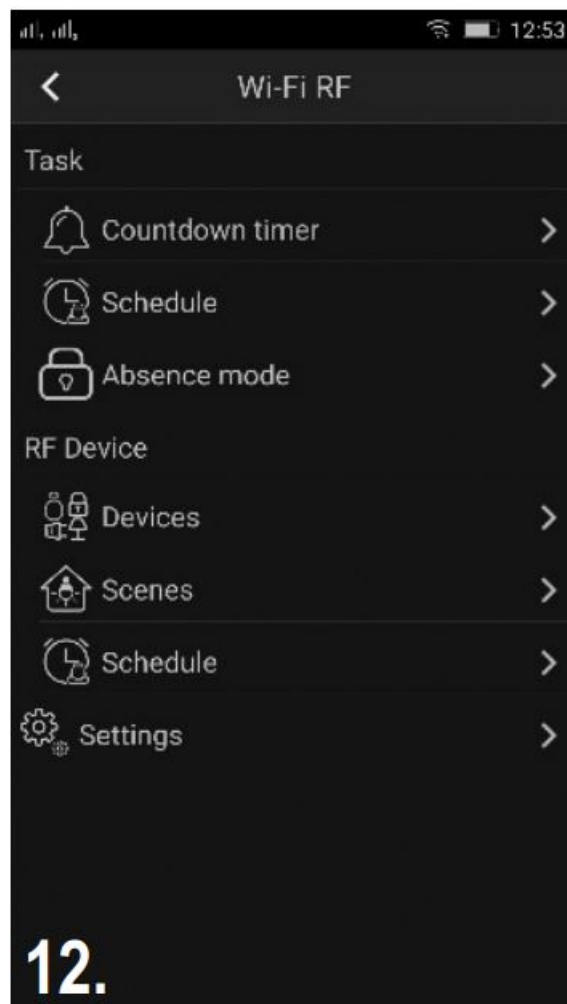

From the RF Device menu, you can access the connected sockets, schedule them (Schedule) or assign them to locations (Scenes).

TO KNOW BEFORE USING THE WIFI SOCKET

- The device is only voltage free if the plug is pulled out of the power source.
- Make sure that your router has 2.4 G system and your smartphone is connected to this 2.4 G network.
- Make sure that the iOS / Android KT Smart WiFi application connects to the device that is plugged into the WiFi socket.
- Make sure if you have a strong WiFi sign on the WiFi socket.
- Make sure there are not many devices connected to your router at the same time. You can temporarily disconnect some other devices from the router and then switch them back on again until the pairing is done.
- Make sure the "AP isolation" function is not activated on the router.
- Make sure you do not need extra logins in your browser after connecting the device to WiFi.
- Synchronization and all functions of the WiFi socket can only be accessed via WiFi network connected to the Internet.
- The WiFi socket must be paired again if the SSID or password has changed.
- You do not need to pair the WiFi socket again, if you have turned it off or disconnected it from one of the mains sockets and plugged it into another within the WiFi router range.
- Restart: Press and hold the ON / OFF button for 10 seconds and release. The Link feedback light flashes rapidly and then goes off. The WiFi socket has been reset now.

SPECIFICATIONS

- nominal datas: 230 V~ / 50 Hz / max. 16 A / max. 3680 W
- WiFi: 2,4 GHz 802.11 b/g/n; 1 mW
- Use only under dry, indoor conditions!
- environmental temperature: 0 – 40 °C
- environmental relative humidity: ≤ 80% RH
- System requirements:
- WiFi router
- iPhone, iPad (iOS 7.0)
- Android 4.0

DISPOSAL

Waste equipment must be collected and disposed separately from household waste because it may contain components hazardous to the environment or health. Used or waste equipment may be dropped off free of charge at the point of sale, or at any distributor which sells equipment of identical nature and function. Dispose of product at a facility specializing in the collection of electronic waste. By doing so, you will protect the environment as well as the health of others and yourself. If you have any questions, contact the local waste management organization. We shall undertake the tasks pertinent to the manufacturer as prescribed in the relevant regulations and shall bear any associated costs arising.

www.somogyi.hu

Distributor: S.C. SOMOGYI ELEKTRONIC S.R.L.

J12/2014/13.06.2006 C.U.I.: RO 18761195

Cluj-Napoca, județul Cluj, România, Str. Prof. Dr. Gheorghe Marinescu, nr. 2, Cod poștal: 400337

Tel.: +40 264 406 488, Fax: +40 264 406 489 • www.somogyi.ro • Producător: Somogyi Elektronik Kft

Documents / Resources

	<p>SOMOGYI ELEKTRONICS NVS 3 RF SMART RF Socket with Master Function [pdf] Instructi on Manual</p> <p>NVS 3 RF SMART RF Socket with Master Function, NVS 3 RF, SMART RF Socket with Master Function, RF Socket with Master Function, Socket with Master Function, Master Function, Funct ion</p>
---	--

References

-  [Digitalis d.o.o.](#)
-  [Elementa d.o.o.](#)
-  [Somogyi Elektronik Kft.](#)
-  [Somogyi Elektronik S.R.L.](#)
-  [Zed d.o.o.](#)