

**Contents** [ [hide](#) ]

[1 SOMMER SOMloq2 SOMcom 2.1 Radio Receiver](#)

[2 Product Usage Instructions:](#)

[3 FAQs](#)

[4 Documents / Resources](#)

[4.1 References](#)

# SOMMER

## SOMMER SOMloq2 SOMcom 2.1 Radio Receiver



### Specifications:

- Product Name: SOMcom 2.1
- Model Number: S13611 S14089-00002

- Power Supply: 24V AC/DC
- Compatibility: Compatible with drives or control units

## **Product Usage Instructions:**

### **Connecting SOMcom 2.1 to Drives or Control Units:**

1. Ensure the power supply is 24V AC/DC.
2. Connect the SOMcom 2.1 radio receiver to the drives or control units.
3. If drives are not directly connected to SOMweb, use SOMweb for control.

### **Setting Up DIP Switches:**

To set up DIP switches:

- For DIP switches 4 and 6: Set them to ON position.
- For DIP switch 5: Set it to ON position.

### **Configuring TorMinal Memory Locations:**

To configure TorMinal memory locations:

- For memory location 39: Set it to value 5.
- For memory location 35: Set it to value 31.

### **Menu Settings for GIGAcontrol A:**

In the menu, navigate to menu item 1640 and make the following setting:

- Setting: Relay energizes permanently when the lower end position is reached.
- Select a free relay for operation.

### **SOMcom2.1 – Sensor – SOMweb connection**

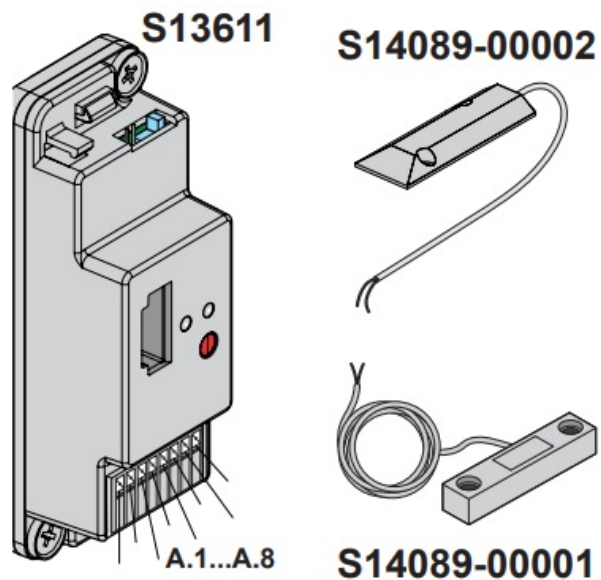

SOMMER Antriebs- und Funktechnik GmbH

- Hans-Böckler-Straße 27
- D-73230 Kirchheim unter Teck
- +49 (0) 7021 8001 333
- [info@sommer.eu](mailto:info@sommer.eu)
- [www.sommer.eu](http://www.sommer.eu)



### Original quick start guide

- These instructions describe how to connect the SOMcom 2.1 radio receiver to drives or control units in order to control them with a SOMweb (for drives that are not directly connected to the SOMweb)

SOMcom2.1

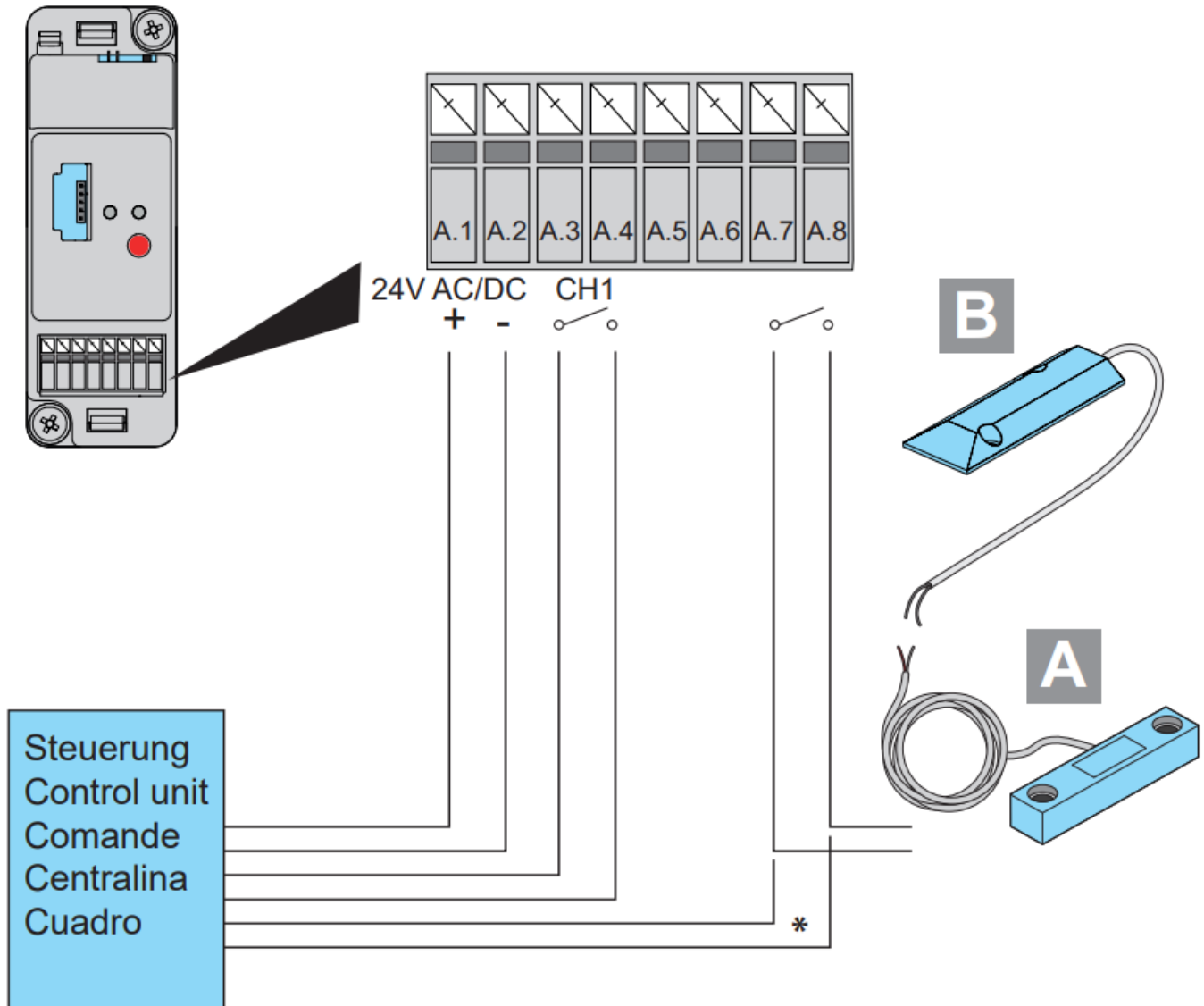

- For operator controls with an output for querying the door status, this can be connected to terminals A.7 and A.8. Alternatively, or if no 'TorMinal' is available, one of the illustrated external sensors A / B can be used.
- If the operator control unit does not have an output for querying the door status, one of the external sensors A / B must be used.

**twist 200 E / EL / M / ML (+)**

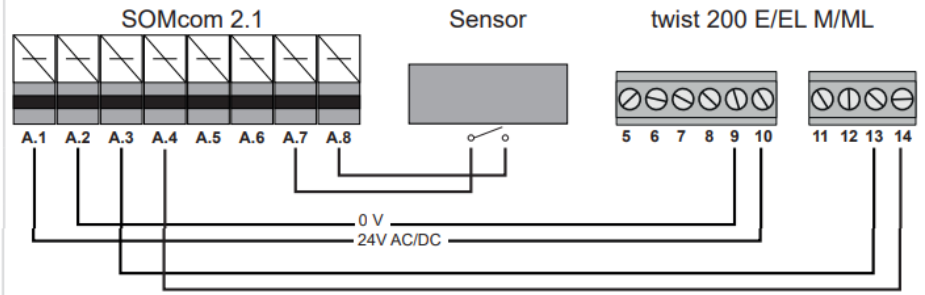
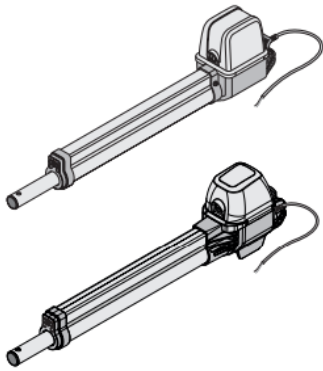

SOMcom2.1	twist 200 / M
A1	10
A2	9
A3	13
A4	14
A7	Sensor
A8	Sensor

## twist XL / 350 (+)

### twist XL / 350 (+)

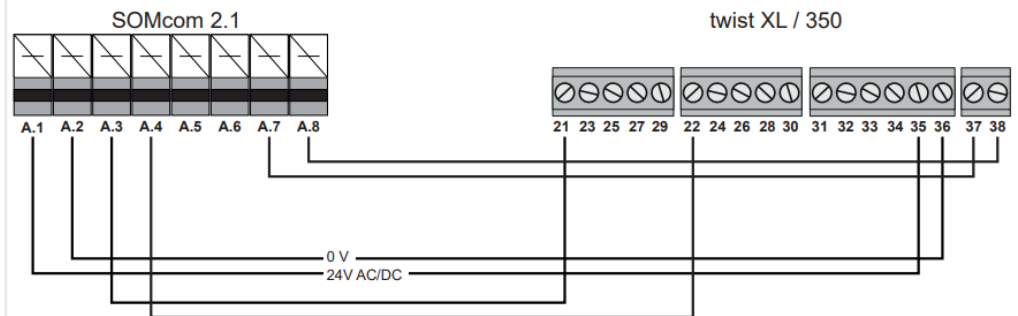
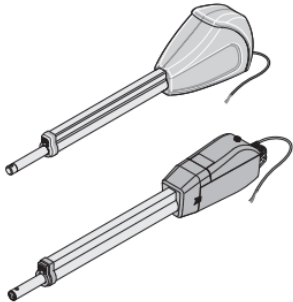

SOMcom2.1	twist XL / 350
A1	35
A2	36
A3	21
A4	22
A7	37
A8	38

Set DIP switches 4 and 6 to ON

## RUNner / SP900 / S900

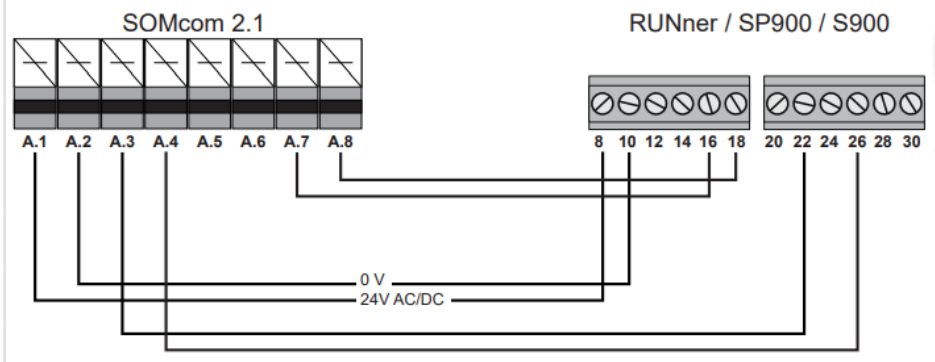
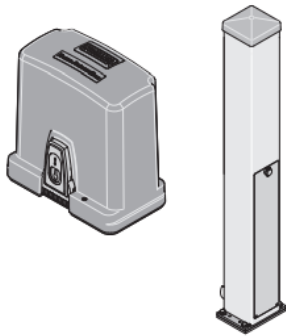

SOMcom2.1	SP 900 / S900
A1	8
A2	10
A3	22
A4	26
A7	16
A8	18

- Set DIP switch 5 to ON
- Set TorMinal memory location 39 to value 5

## STArter

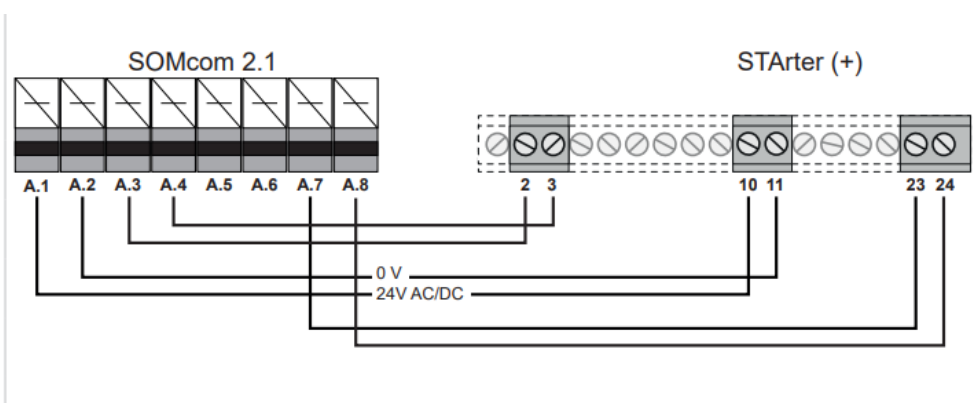

SOMcom2.1	STArter
A1	10
A2	11
A3	2
A4	3
A7	23
A8	24

- Set TorMinal memory location 35 to value 31

## duo vision

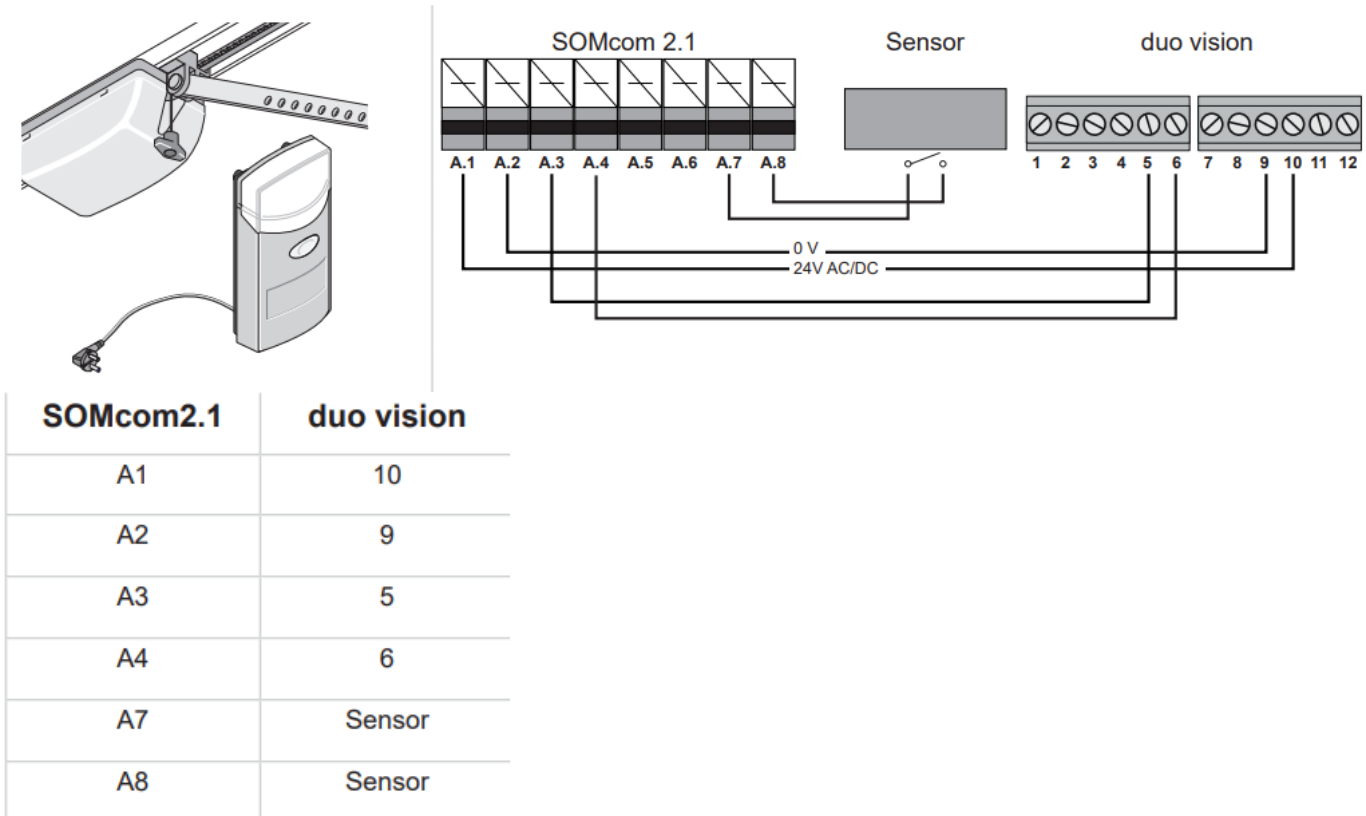

## marathon SL

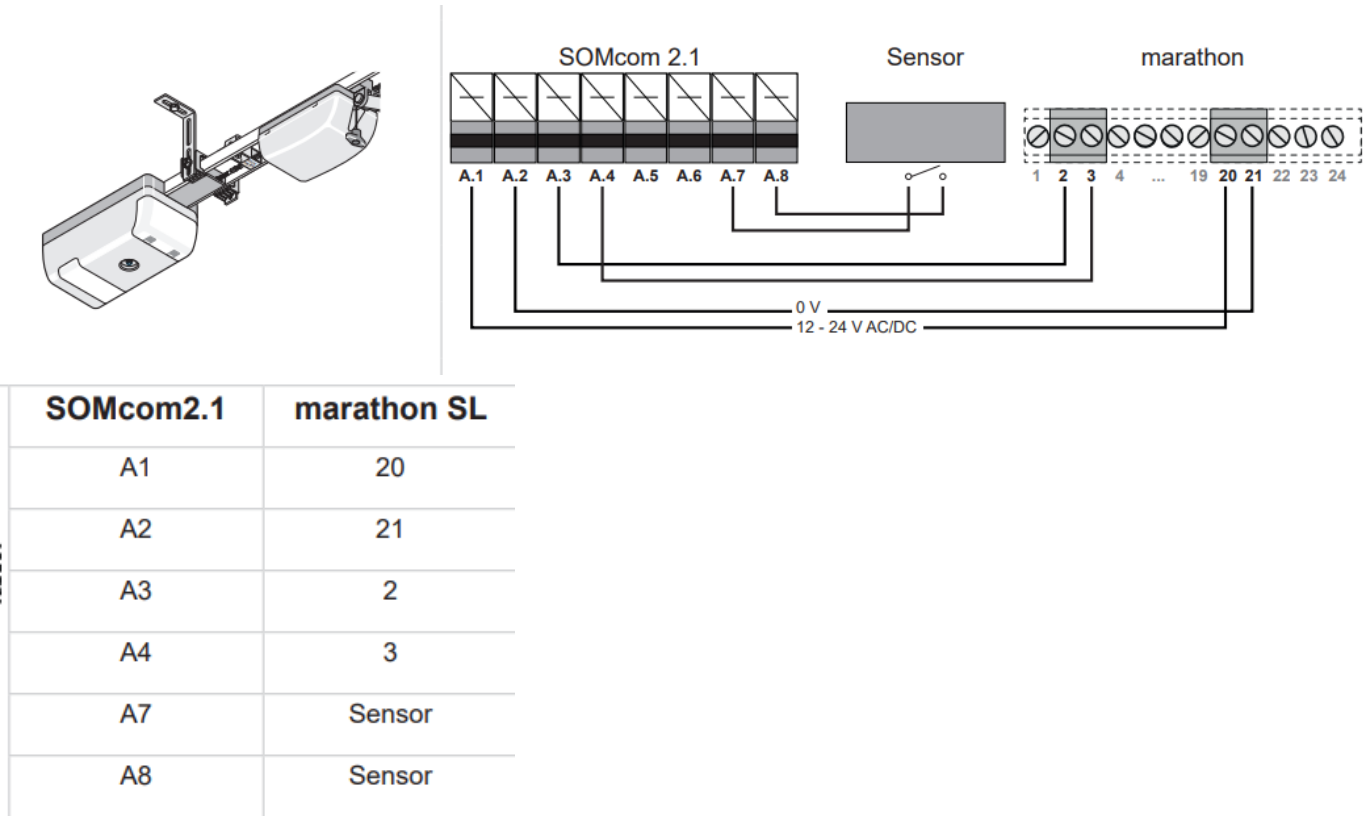

# GIGAcontrol A

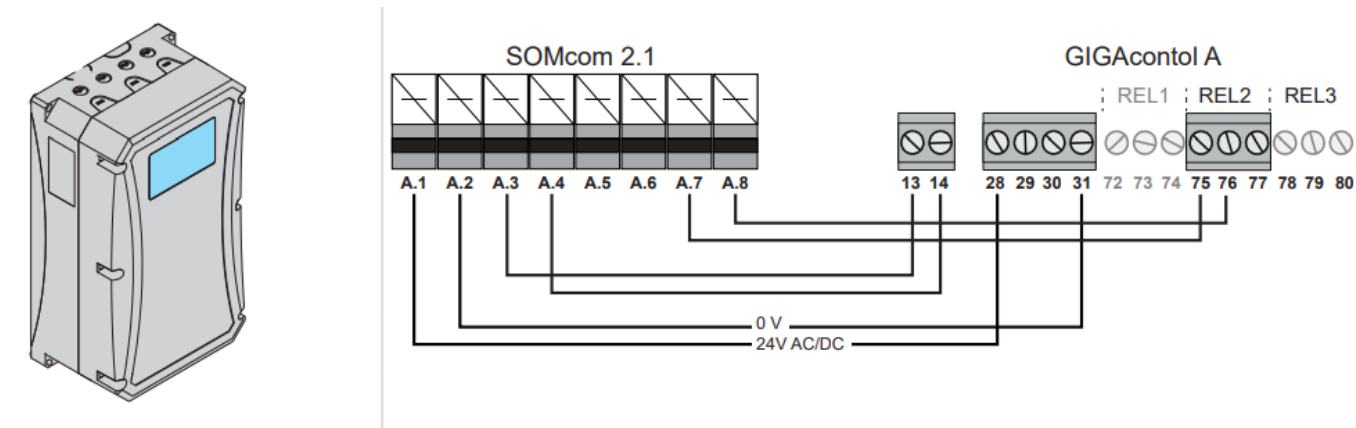

SOMcom2.1	GIGAcontrol A
A1	28
A2	31
A3	13
A4	14
A7	75 / 78*
A8	76 / 79*

## Select free relay

- Settings required in the menu from menu item 1640.
- Setting: Relay energises permanently when the lower end position is reached

## FAQS

**Q: What should I do if the SOMcom 2.1 does not respond to commands?**

A: Check the power supply and ensure proper connection to the drives/control units. Verify the DIP switch settings and consult the manual for troubleshooting steps.

**Q: How can I reset the SOMcom 2.1 to factory settings?**

A: Refer to the user manual for specific instructions on resetting the SOMcom 2.1 to factory settings. Typically, this involves pressing a reset button or following a sequence of steps.

## Documents / Resources



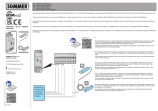

## [SOMMER SOMloq2 SOMcom 2.1 Radio Receiver \[pdf\]](#) User Guide

SOMloq2, SOMloq2 SOMcom 2.1 Radio Receiver, SOMcom 2.1 Radio Receiver, 2.1 Radio Receiver, Receiver

## References

- [Garage door openers, radio technology and Smart Home | SOMMER](#)
- [User Manual](#)

■ SOMMER

🔍 2.1 Radio Receiver, Receiver, SOMcom 2.1 Radio Receiver, SOMloq2, SOMloq2 SOMcom 2.1 Radio Receiver, SOMMER

—Previous Post

**[SOMMER S 9060 Pro+ Garage Door Opener Owner's Manual](#)**

---

## Leave a comment

Your email address will not be published. Required fields are marked \*

Comment \*

Name

Email

Website

☐ Save my name, email, and website in this browser for the next time I comment.

[Post Comment](#)

## Search:

[Search](#)

[Manuals+](#) | [Upload](#) | [Deep Search](#) | [Privacy Policy](#) | [@manuals.plus](#) | [YouTube](#)

This website is an independent publication and is neither affiliated with nor endorsed by any of the trademark owners. The "Bluetooth®" word mark and logos are registered trademarks owned by Bluetooth SIG, Inc. The "Wi-Fi®" word mark and logos are registered trademarks owned by the Wi-Fi Alliance. Any use of these marks on this website does not imply any affiliation with or endorsement.