



[Home](#) » [somfy](#) » **somfy SUNTEIS IO Temperature Sensor Installation Guide** 

Contents [[hide](#)]

- [1 somfy SUNTEIS IO Temperature Sensor](#)
- [2 Unpacking the product](#)
- [3 Installation](#)
- [4 Technical data](#)
- [5 Documents / Resources](#)
 - [5.1 References](#)



somfy SUNTEIS IO Temperature Sensor



Complete instruction guide (tips and advice, advanced settings: Reset, Demo mode, Automatism mode) available online on www.somfy.info. Please read this guide carefully before installing or using this product. Please also comply with the instructions set out in the enclosed Safety Instructions document.

SUNTEIS IO is an autonomous outdoor light and temperature sensor.

In detail (Figure [A])

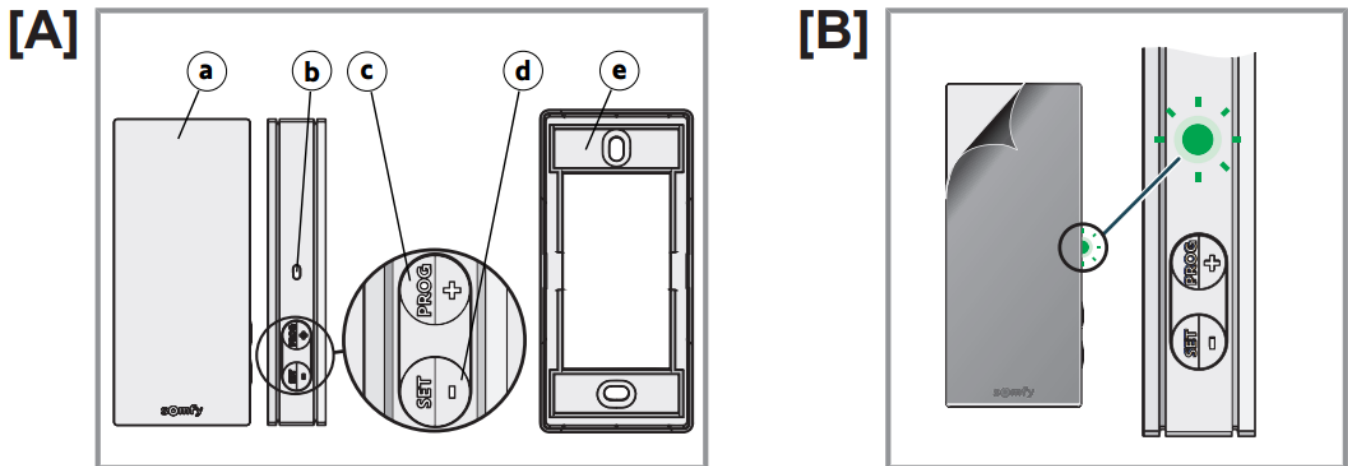

- a) Front cover
- b) Feedback LED
- c) PROG button
- d) SET button
- e) Wall bracket

Unpacking the product

Wake up the product (Figure [B])

When unpacking the product for the first time, remove the black cover and leave the sensor exposed to ambient sunlight. → The LED lights green.

Check sensor charge status (Figure C)

To check the charging status of the sensor, briefly press the SET button.

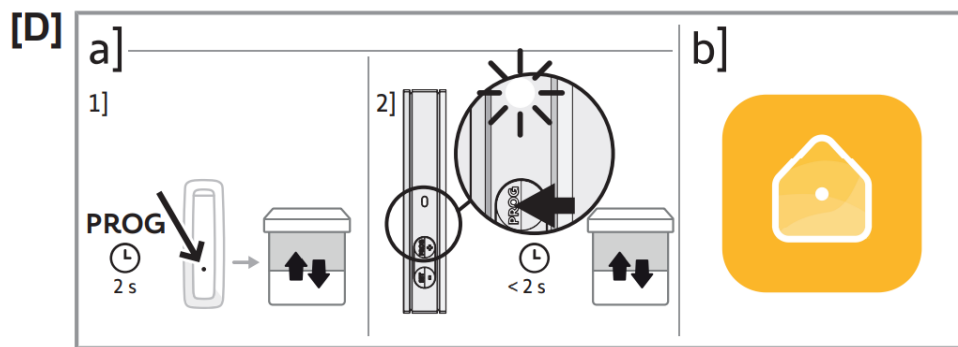
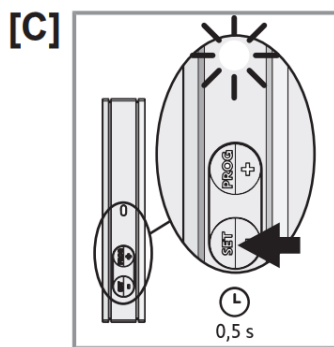

- The LED blinks green: Sensor is charged.
- The LED blinks orange: The battery is low, place the sensor under sunlight to charge it.
- The LED does not blink: The sensor is discharged, place the sensor under sunlight to charge it.

Installation

Pairing (Figur [D])

- Without the TaHoma application, in local mode.

NOTICE

To pair smart drives, see the complete instruction guide or the “Help me by Somfy” application.

- With TaHoma, follow the instructions on the TaHoma application.

Setting the Threshold

To enter or exit setting mode, press the SET button for between 2 seconds and 7 seconds; the LED lights up orange.

CAUTION

- Do not exceed 7 seconds SET, the sensor goes into demo mode.
- Do not exceed 7 seconds PROG, the sensor will return to factory mode.
- Press the SET and PROG buttons simultaneously to see the current threshold.
- To increase the value, short-press the PROG (+) button; the LED flashes green.

- To decrease the value, short-press the SET (-) button; the LED flashes green.
- Depending on the LED blinking, see the table below for the 8 corresponding brightness levels thresholds.

Threshold	Britghtness	Feedback (number of green LED blinks)
1	10 kLux	1
2	16 kLux	2
3	24kLux	3
4 (by default)	32 kLux	4
5	40 kLux	5
6	50 kLux	6
7	65 kLux	7
8	80 kLux	8

See full instructions for more information.

Wall mounting (Figure [E])

Fix the wall bracket to a clean, flat vertical surface using a screwdriver and the screws provided with the product.

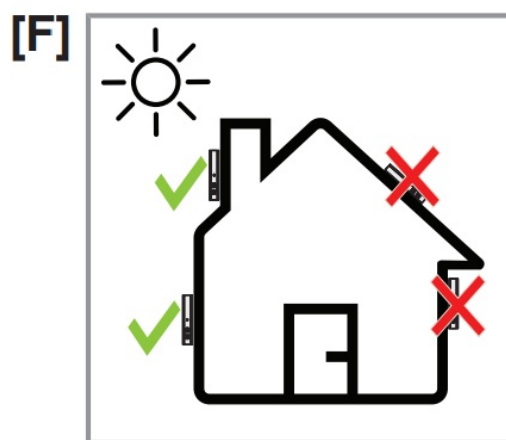
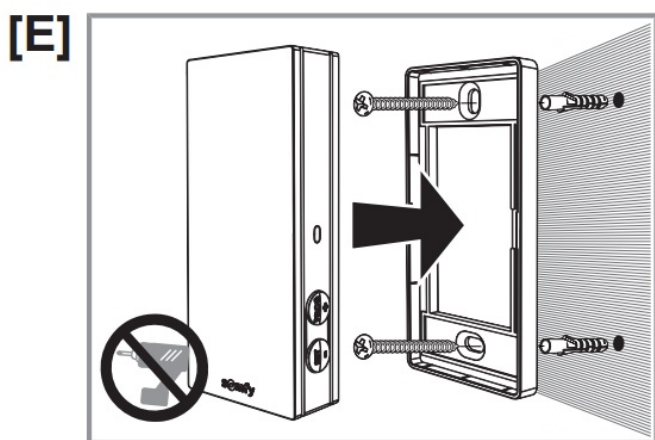

CAUTION

Do not use an electric screwdriver.

Recommendations for wall mounting (Figure [F])

Install the sensor in a vertical position close to motorised products, where there is constant sunlight. The buttons should be positioned at the bottom right. Avoid northern exposure (operation will be degraded), avoid shadows. avAvoidetallic parts.

Technical data

Frequency range and maximum power used: 868.700 MHz – 869.200 MHz e.r.p. <25 mw. The environment in which the product is used might reduce the radio range. The use of the same facade as the controlled products is recommended. Radio range in free field: 150 m.

- Operating temperature: -20 °C to +60 °C.
- Power supply: Solar panel A
- CR1225 coin cell (non-removable) for storage and transport is needed
- Index protecting rate: IP44
- Maximum number of associated drives: Unlimited for standard drives and 10 for smart drives.

CE SOMFY ACTIVITES SA, 74300 CLUSES FRANCE hereby declares that the radio equipment covered by these instructions complies with the requirements of Radio Directive 2014/53/ EU and the other essential requirements of the applicable European Directives. The full text of the EU Declaration of Conformity is available at www.somfy.com/ce.

**UK
CA** Somfy Limited, Yeadon LS19 7za UK, hereby declares that the radio equipment covered by these instructions complies with the requirements of UK legislation: the Radio Equipment Regulations S.I. 2017 N°1206. The full text of the UKCA declaration of conformity is available at www.somfy.co.uk.

Copyright ©2024. All rights reserved. SOMFY ACTIVITÉS SA, Société Anonyme, capital 35.000.000 Euros, RCS Annecy 303.970.230.

Images non contractually binding.09/2

From the Application “Help me by Somfy”s can the QR code.



Help me with Somfy



Here are the complete setting instructions.

Documents / Resources

	somfy SUNTEIS IO Temperature Sensor [pdf] Installation Guide 5178777A000, SUNTEIS IO Temperature Sensor, SUNTEIS IO, Temperat ure Sensor, Sensor
---	--

References

- [Somfy | Motors, Automatisms, Controls & Smart Home Solutions](#)
- [Declarations of conformity](#)
- [Somfy Info](#)
- [User Manual](#)

📎 5178777A000, Sensor, somfy, SUNTEIS IO, SUNTEIS IO Temperature Sensor, Temperature

📁 somfy Sensor

—Previous Post

[somfy Amy 1 io Control With Frame Instructions](#)



Leave a comment

Your email address will not be published. Required fields are marked *

Comment *

Name

Email

Website

☐ Save my name, email, and website in this browser for the next time I comment.

Post Comment

Search:

e.g. whirlpool wrf535swhz

Search

[Manuals+](#) | [Upload](#) | [Deep Search](#) | [Privacy Policy](#) | [@manuals.plus](#) | [YouTube](#)

This website is an independent publication and is neither affiliated with nor endorsed by any of the trademark owners. The "Bluetooth®" word mark and logos are registered trademarks owned by Bluetooth SIG, Inc. The "Wi-Fi®" word mark and logos are registered trademarks owned by the Wi-Fi Alliance. Any use of these marks on this website does not imply any affiliation with or endorsement.