



# Somfy Connexoon Window RTS Direct Compatibility with Amazon Alexa User Guide

[Home](#) » [somfy](#) » Somfy Connexoon Window RTS Direct Compatibility with Amazon Alexa User Guide 

## Contents

- [1 Somfy Connexoon Window RTS Direct Compatibility with Amazon Alexa](#)
- [2 Product Usage Instructions](#)
- [3 Connexoon Window RTS](#)
- [4 INSTRUCTION](#)
- [5 Personalised Routine](#)
- [6 Troubleshooting:](#)
- [7 Documents / Resources](#)
  - [7.1 References](#)



## Somfy Connexoon Window RTS Direct Compatibility with Amazon Alexa



### Specifications:

- Product Name: Connexoon Window RTS

- Compatibility: Amazon Alexa
- Manufacturer: Somfy

## Product Usage Instructions

### Connect to your Amazon Alexa:

Follow the steps provided in the quick start guide to link your Connexoon Window RTS with Amazon Alexa for voice control.

### Change the Name of Your Window Coverings/Lights:

1. Open the Amazon Alexa app and go to Device Settings.
2. Select the specific device you want to rename.
3. Choose Edit Name and enter the new name.
4. Tap the back arrow to save the changes.

### Group Your Window Coverings/Lights Within A Room:

1. In the Amazon Alexa app, navigate to Device Settings.
2. Tap the + icon and select Add Group.
3. Choose Create a room or device group.
4. Select the room you want to set up.
5. Customize the room if needed and add devices to it.
6. Save your changes and confirm the setup.

### FAQ:

**Q:** How do I troubleshoot issues with my Connexoon Window RTS and Amazon Alexa connection?

**A:** Please refer to the Troubleshooting section in the user manual for detailed steps to resolve any connectivity issues between your devices.

Direct Connection for Connexoon Window RTS with Amazon Alexa  
Quick Start Guide

## Connexoon Window RTS

Direct Compatibility with Amazon Alexa  
QUICK START GUIDE

Pre-start checklist prior to Amazon Alexa use

- Ensure set-up of your Amazon Alexa is complete and connected to Wi-Fi.
- Ensure set-up of Connexoon Window RTS app is complete and paired with the window coverings you wish to control via your Amazon Alexa.

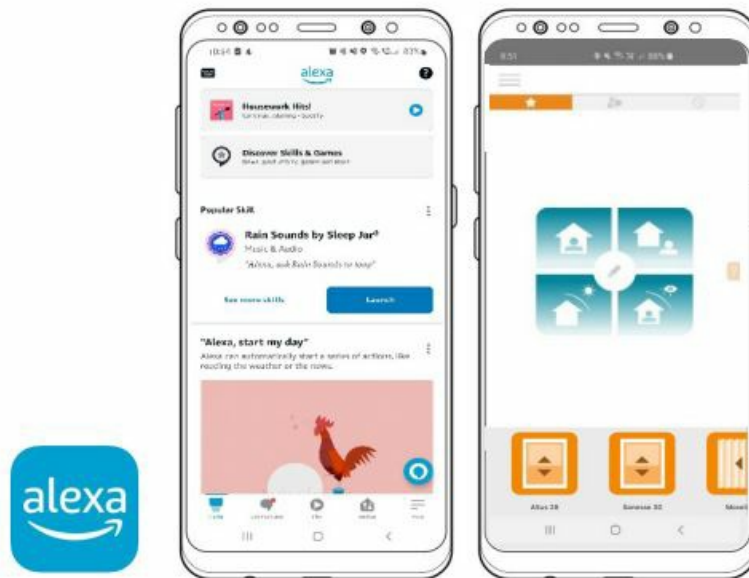

## Compatibility between Connexoon Window RTS and Amazon Alexa

- Pre-set Connexoon Window RTS scenarios (scenes and ambiances) will not automatically transfer to Amazon Alexa during the linking process. To control your Connexoon Window RTS scenarios via voice control, you will need to recreate the 'routine' within the Amazon Alexa app. Refer to page 5 of this quick start guide for instructions. Amazon Alexa allows up to 99 unique routines to be controlled via voice control.
- Amazon Alexa has the capability of triggering open/close or on/off commands through voice control. Triggering your pre-set 'my' position on your Somfy powered solution can be achieved through your Connexoon Window App or your Somfy RTS control only.

## INSTRUCTION

1. Open Amazon Alexa app.
2. Select More located in the bottom right-hand corner.
3. Select Skills & Games.
4. Using the search bar, look up "TaHoma by Somfy".
5. Select "TaHoma By Somfy".

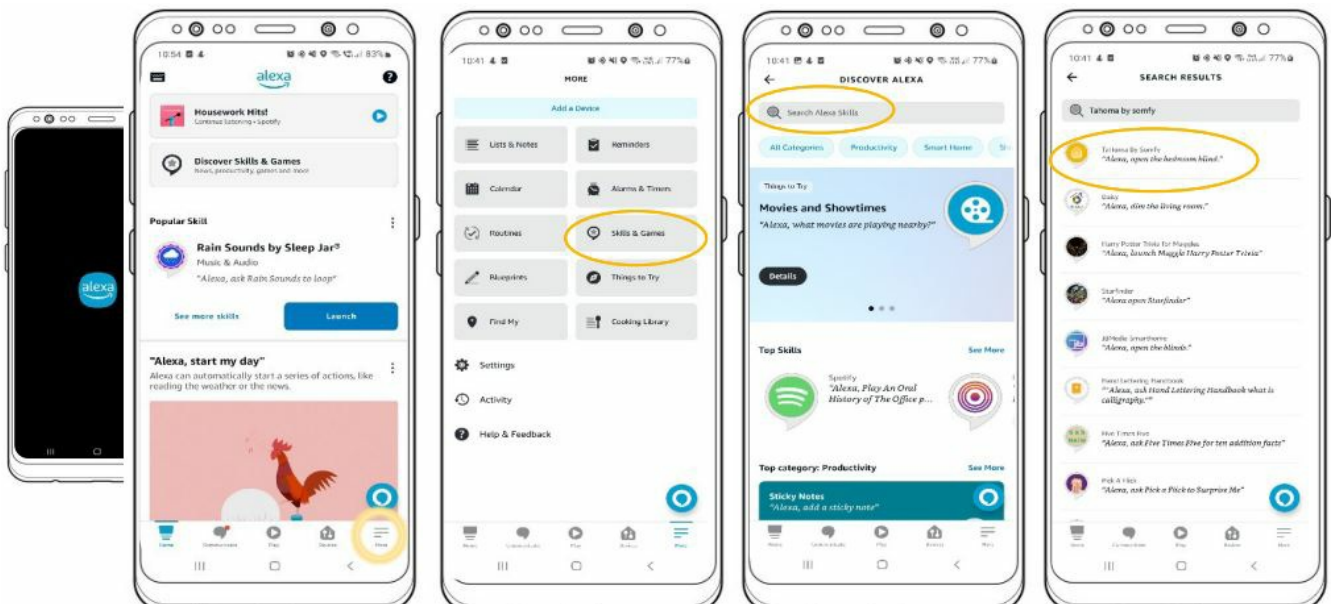

6. Tap ENABLE TO USE.
7. Enter your Connexoon Window RTS username & password.  
Check the Memorize my login details tick box, then tap LOG IN.
8. Select YES.
9. A notification will appear to confirm your Amazon Alexa account and your Connexoon Window RTS account have successfully linked.  
Select Next.

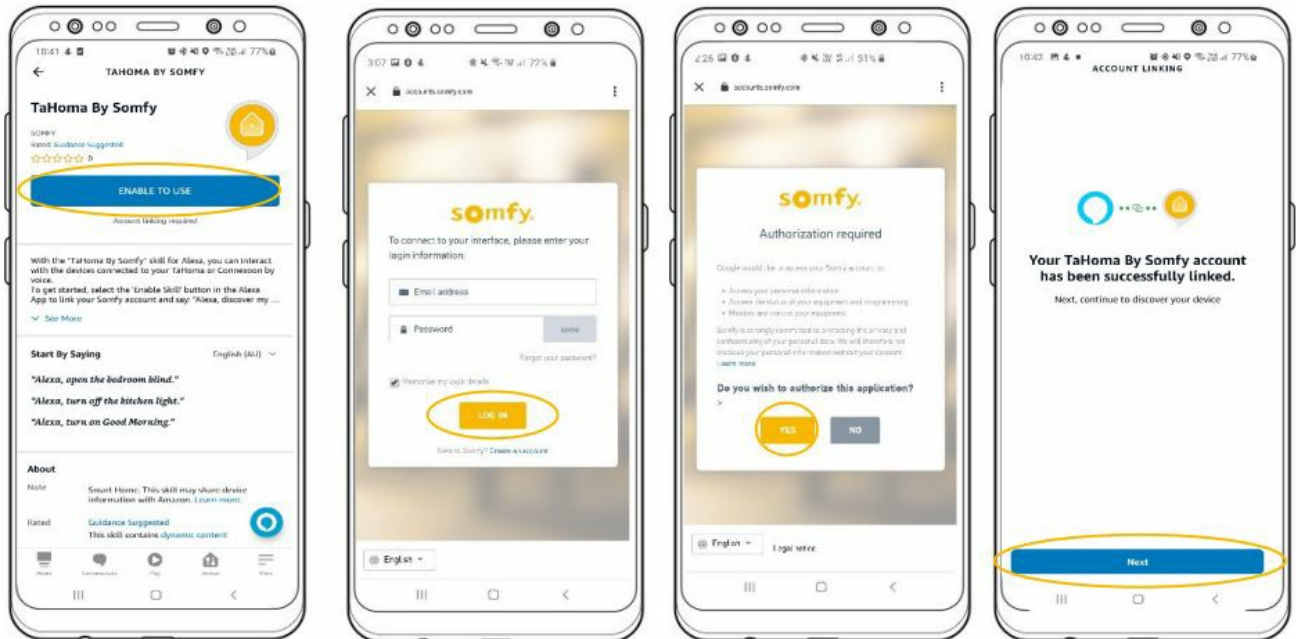

10. The Alexa app will begin to scan your Connexoon Window RTS app to find all the paired devices. Once the scan is complete, the Amazon Alexa app will confirm the number of devices found.  
Tap Next to set up each device individually.
11. Select the device you wish to set up first.
12. Select Set Up Device.
13. Select Continue.
14. Repeat steps 11 – 13 until all your Somfy powered devices are connected to your Alexa app.

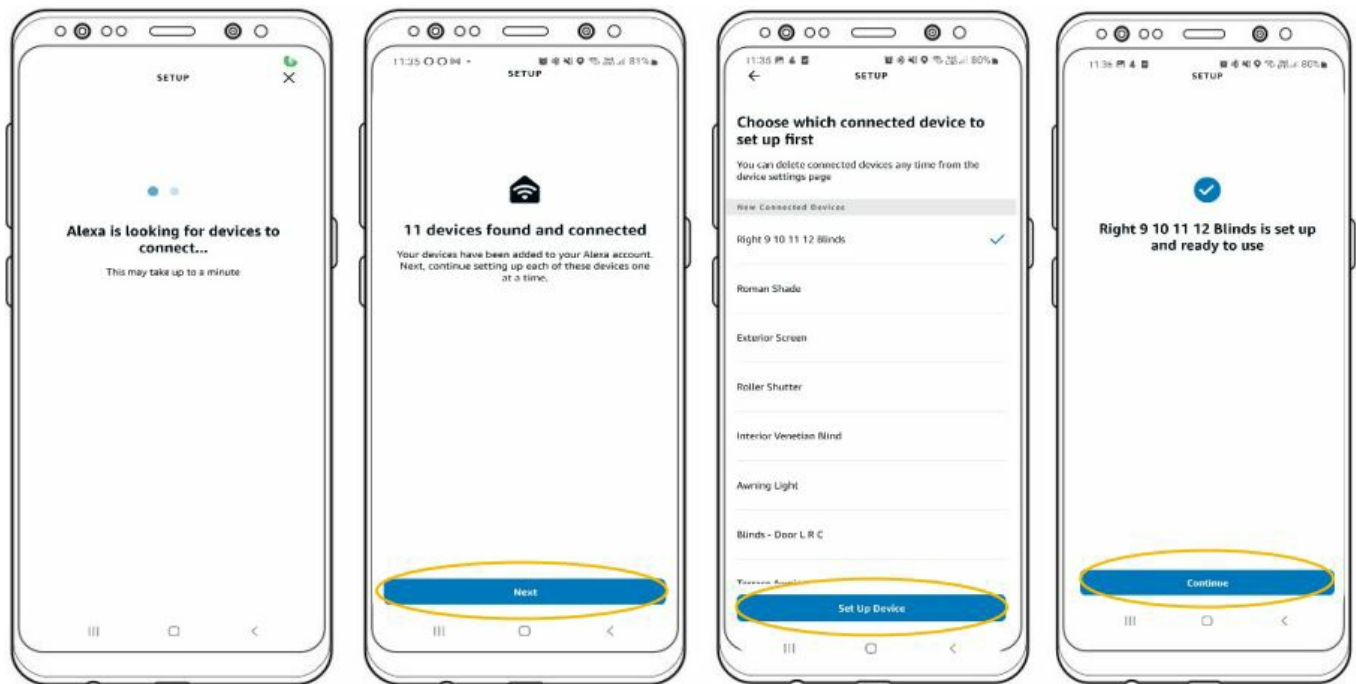

### Change the Name of Your Window Coverings/Lights (optional set-up):

Enables you to effectively operate your devices via voice control

1. From the Amazon Alexa home screen, select Device Settings.
2. Select the device you wish change.
3. Select Edit Name.

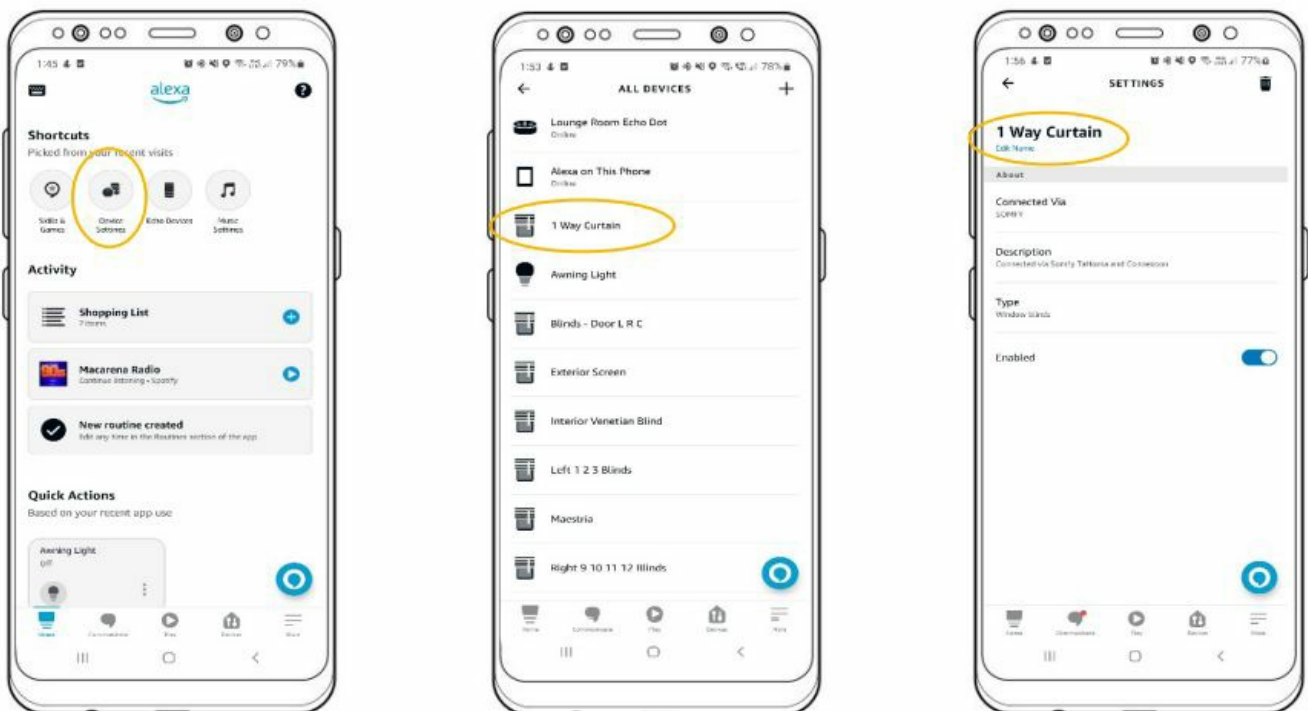

4. Enter your new preferred name.  
Tap the back arrow to return to the previous screen..

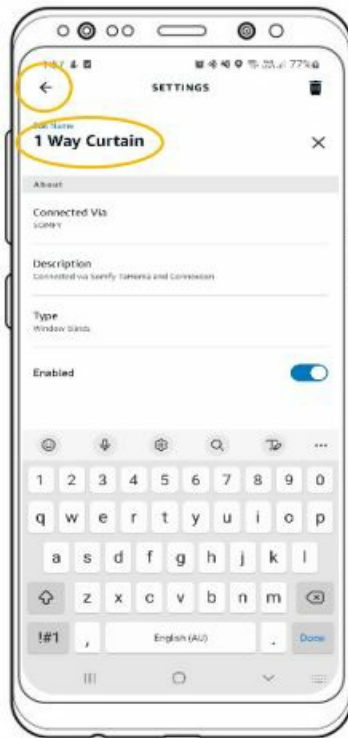

### Group Your Window Coverings/Lights Within A Room (optional set-up):

Enables you to operate all devices assigned to a room simultaneously via voice control

1. From the Amazon Alexa home screen, select Device Settings.
2. Tap the + in the top right-hand corner.
3. Select Add Group.

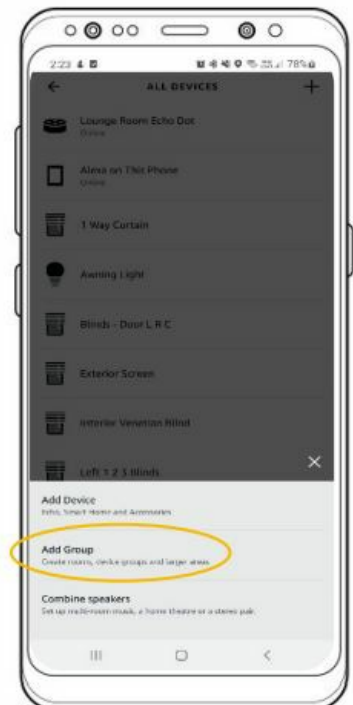
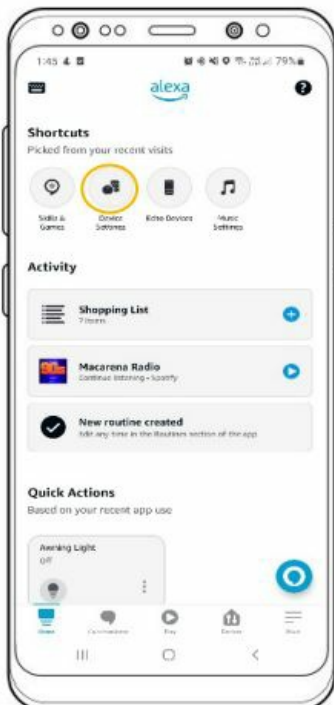

4. Select Create a room or device group.
5. Tap Next.
6. Select the room you wish to set up. Tap Next.

To customise a room, scroll to the bottom and select Customise room. Enter your preferred room name. Tap Next.





7. Select one or multiple devices you wish to add to your room.  
Tap Next.
8. Your room is now set up. Tap Done.
9. To edit or delete a room or group select Devices on the bottom ribbon.
10. Select the room or group you wish to edit.

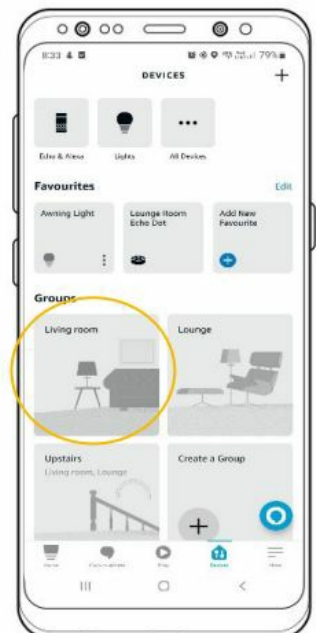
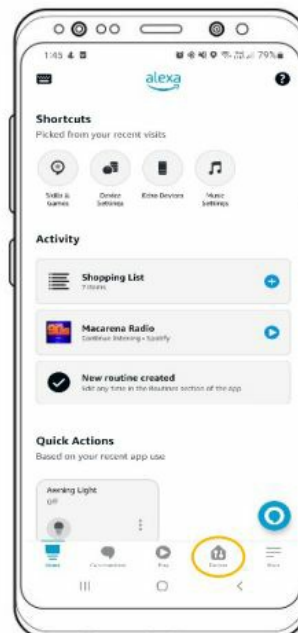
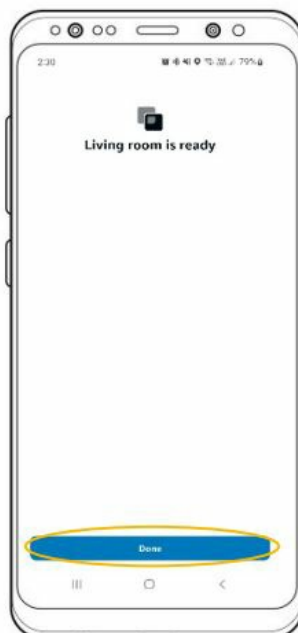
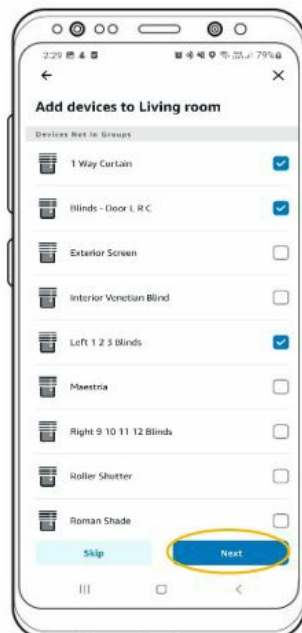

11. Tap Edit in the top right-hand corner. From here you can:
  1. Update the room or group name
  2. Add or remove devices from the room
  3. Add another Alexa speaker, or
  4. Delete the room

Once you have made all your preferred changes, tap Save.  
A confirmation of your changes will be shown. Tap Done.

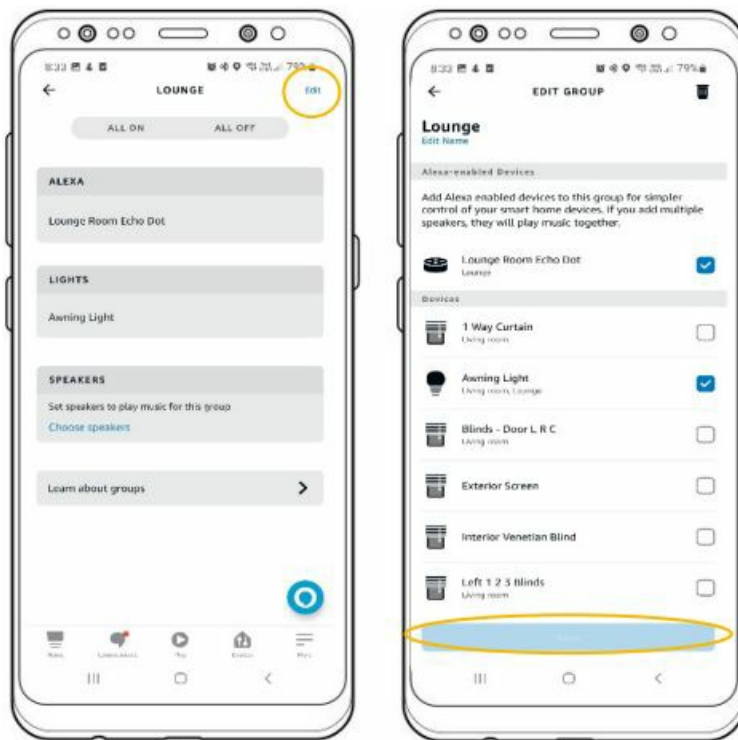

### Combine Your Pre-Set Rooms or Groups Within a House or Zone (optional set-up):

Enables you to operate all rooms within a house simultaneously via voice control

1. From the Amazon Alexa home screen, select Device Settings.
2. Tap the + in the top right-hand corner.
3. Select Add Group.
4. Select Combine rooms or groups.

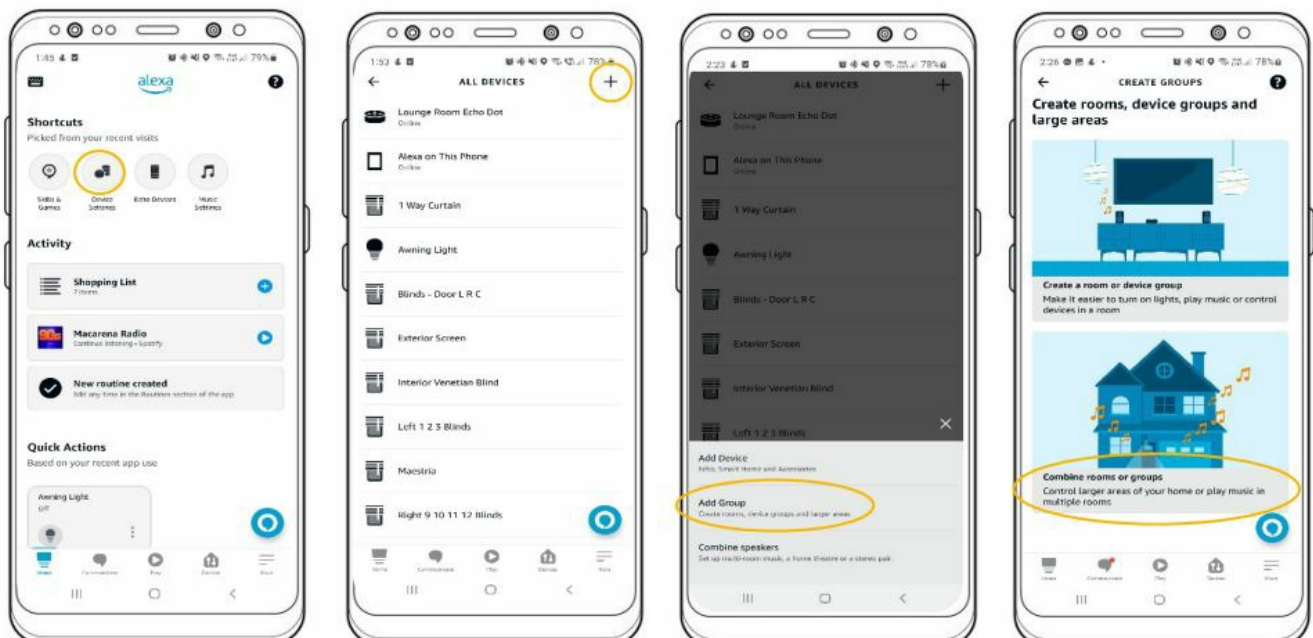

5. Tap Next.
6. Name the area you wish to group.

You can select a name from the list provided in the app or customise the name by tapping the + icon at the bottom of the screen, then typing your customised name into the open field.

Tap Next.

7. Select the pre-set rooms you wish to group into the combined area.



Tap Next.

8. Tap Done.

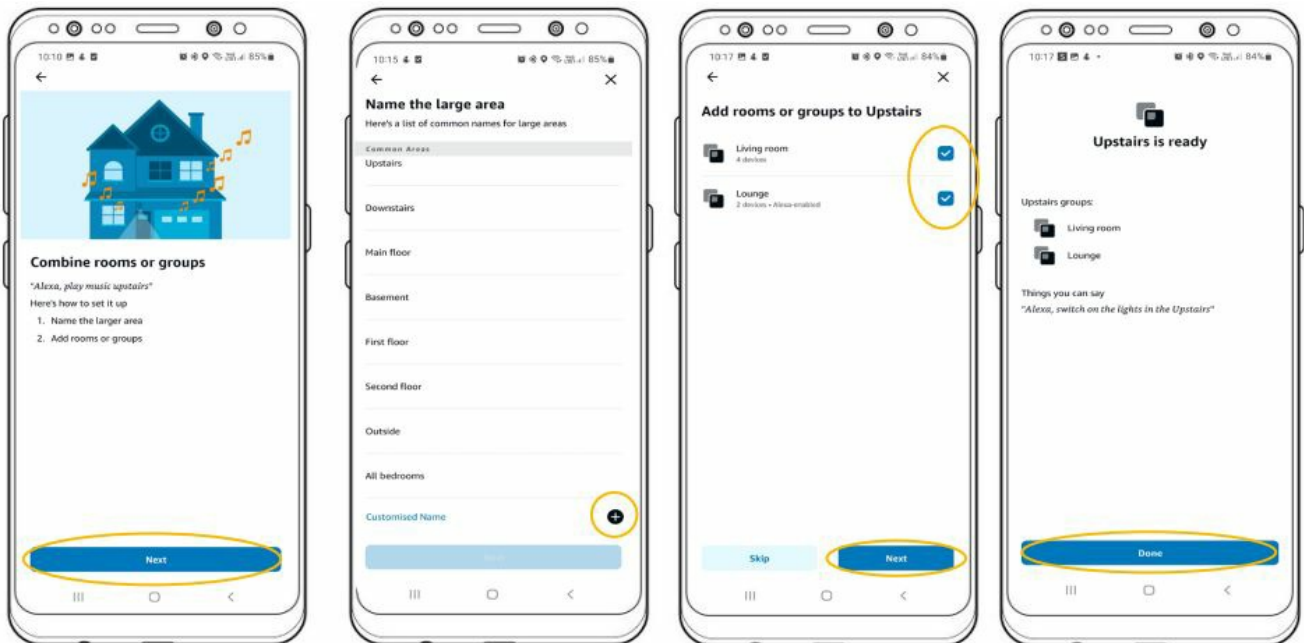

### Create A Personalised Routine to Simplify Your Daily Life

Enables you to activate a personalised routine via voice control

1. Select More located in the bottom right-hand corner.
2. Select Routines.
3. Tap the + in the top right-hand corner.
4. Enter the routine name by selecting +.

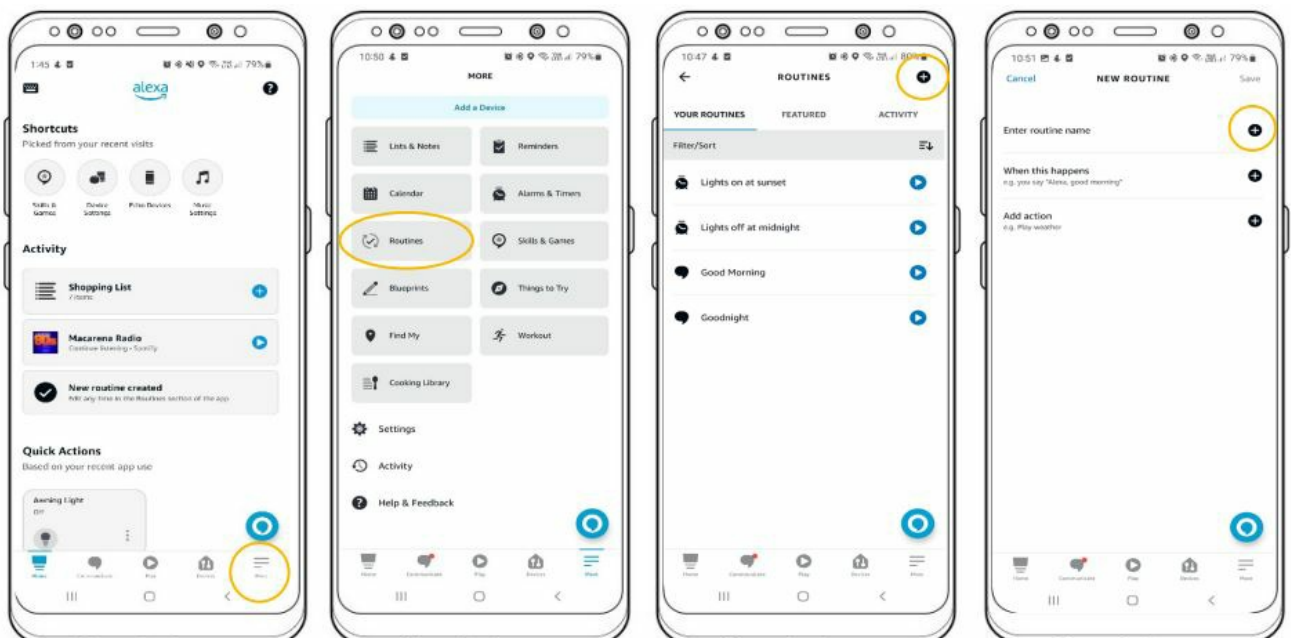

5. Type the routine name into the free text field [max. 50 characters].

Tap Next.

6. Select Voice.

7. Type the phrase you wish to use to activate your new personalised routine i.e.

"Alexa, start my day". [Max. 100 characters].

Tap Next in the top right-hand corner.

8. To add your Somfy-powered

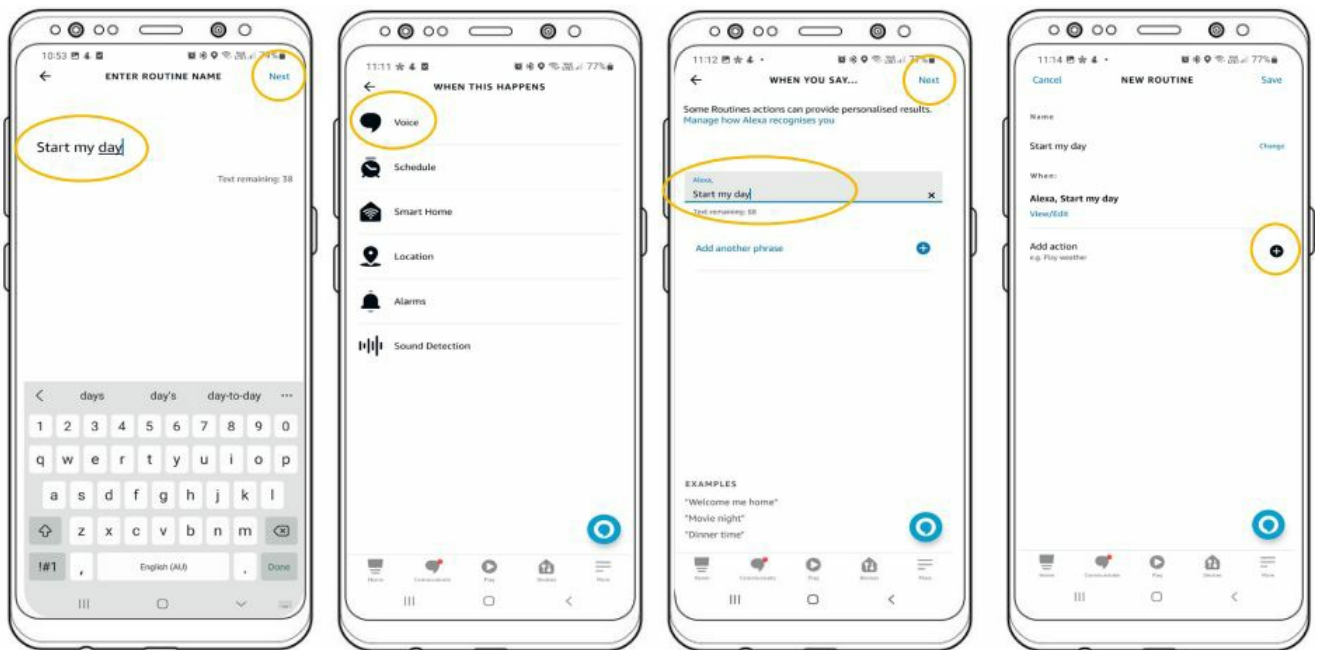

9. Select Smart Home.
10. Select the first device you wish to add to the routine.
11. Set the action:  
Open/Close or On/Off.
12. Tap Done.
13. Tap Next.
14. Repeat Steps 8 – 13, until all your devices (and your preferred commands) are added to the routine.
15. Tap Save in the top right-hand corner.

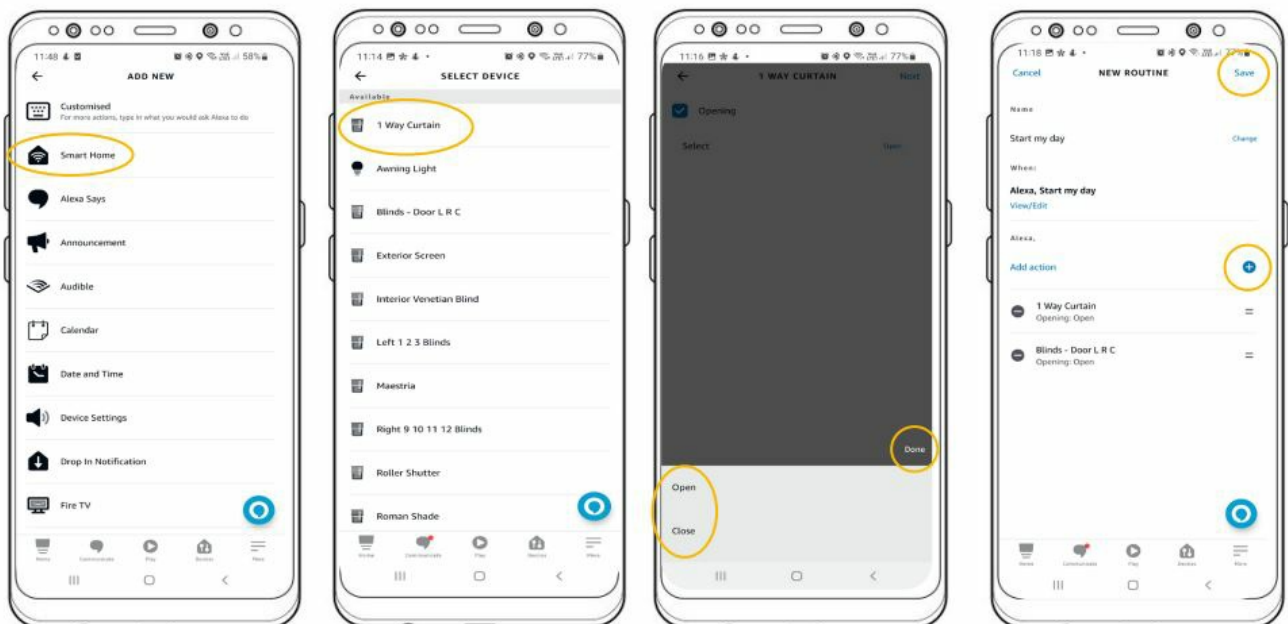

## Personalised Routine

To update or delete a personalised routine in the Amazon Alexa app

1. Select More located in the bottom right-hand corner.
2. Select Routines.
3. Select the routine you wish to update.
4. From here you can:

1. Update the name of your routine
2. Update the phrase you wish to use to activate the routine through voice control
3. Add or remove devices from the routine
4. Delete the routine

Once you have made all your updates, tap the back arrow in the top left-hand corner.

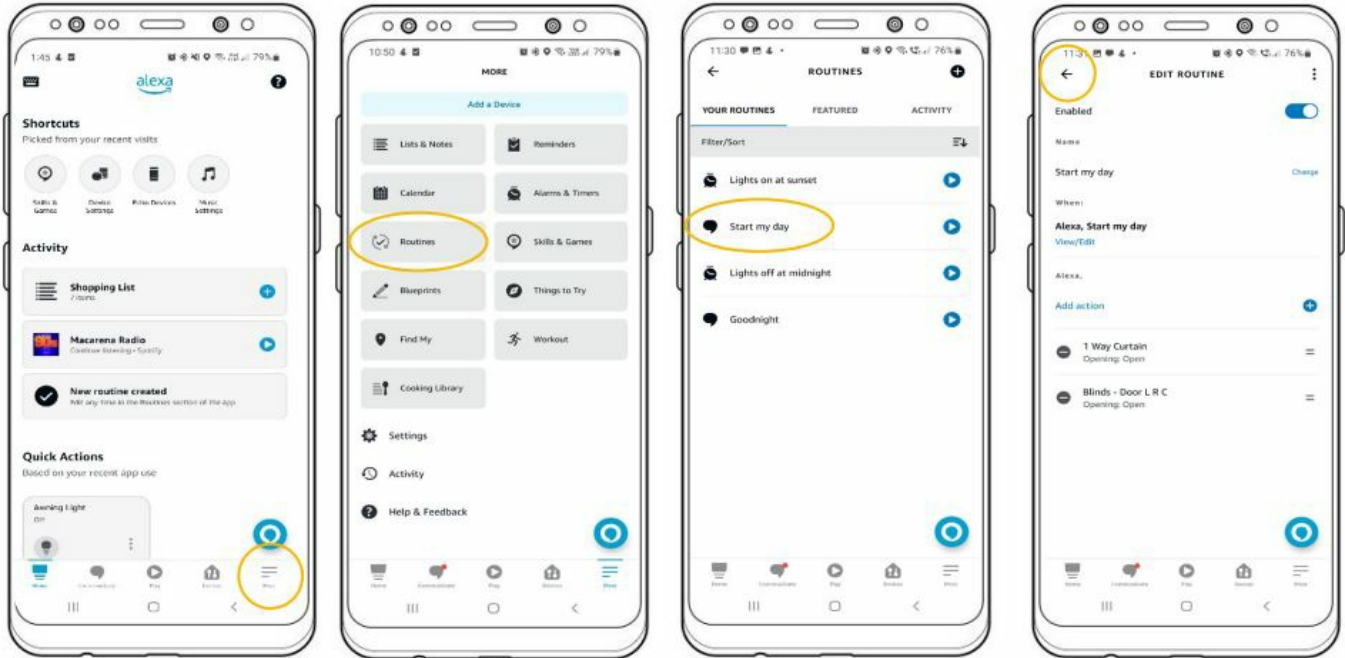

### Control Your Window Coverings/Lights Through Voice Control:

Enables you to complete control of your devices through a simple voice command

1. Ensure steps to connect Connexoon Window RTS and your Amazon Alexa are complete.
2. Familiarise yourself with the names set in the Amazon Alexa app for your:
  - [Devices] Individual Window Coverings/Lights
  - Rooms
  - Groups
  - Routines

**Note:** If you have changed the name of linked device in your Amazon Alexa app, it will not automatically transfer back to your Connexoon Window RTS app (and vice versa).

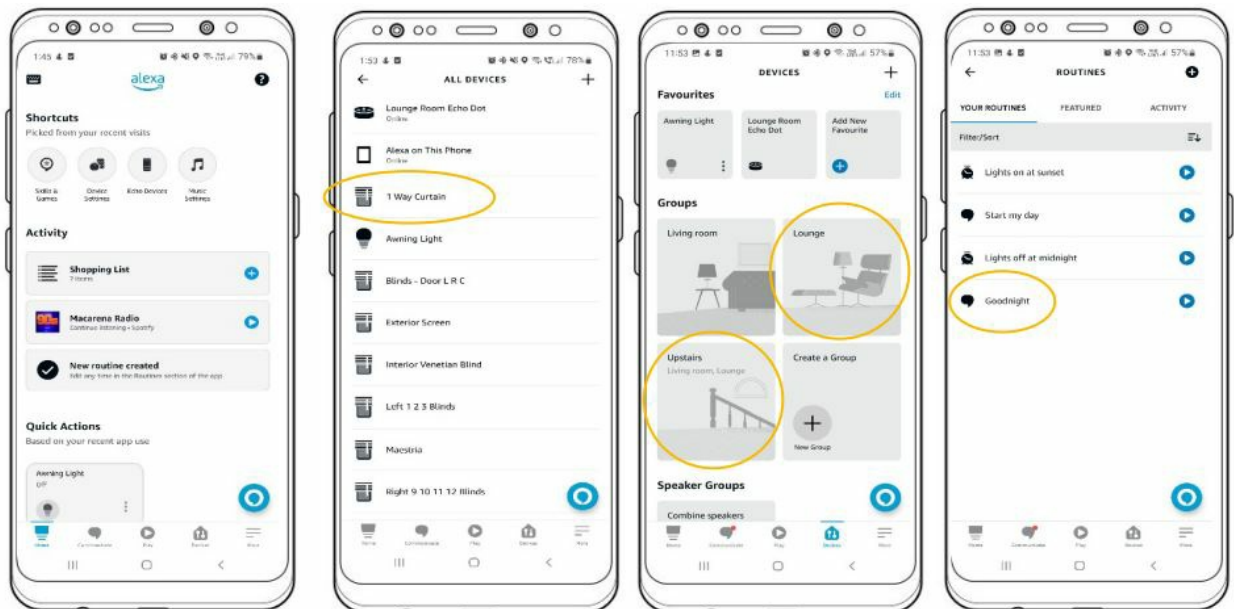

3. To give your Amazon Alexa device a command, you first need to activate it by saying:

“Alexa...”

4. Followed by:

By Individual Window Covering/Light (Device):

- Close <blind name>
- Open <blind name>
- Turn on <light name>
- Turn off <light name>

**By Awning:**

- Close <awning name> (retracts awning)
- Open <awning name> (extends awning)

**By Room/Group:**

- Open <room/group name>
- Close <room /group name>

**By Routine:**

- <Routine name>

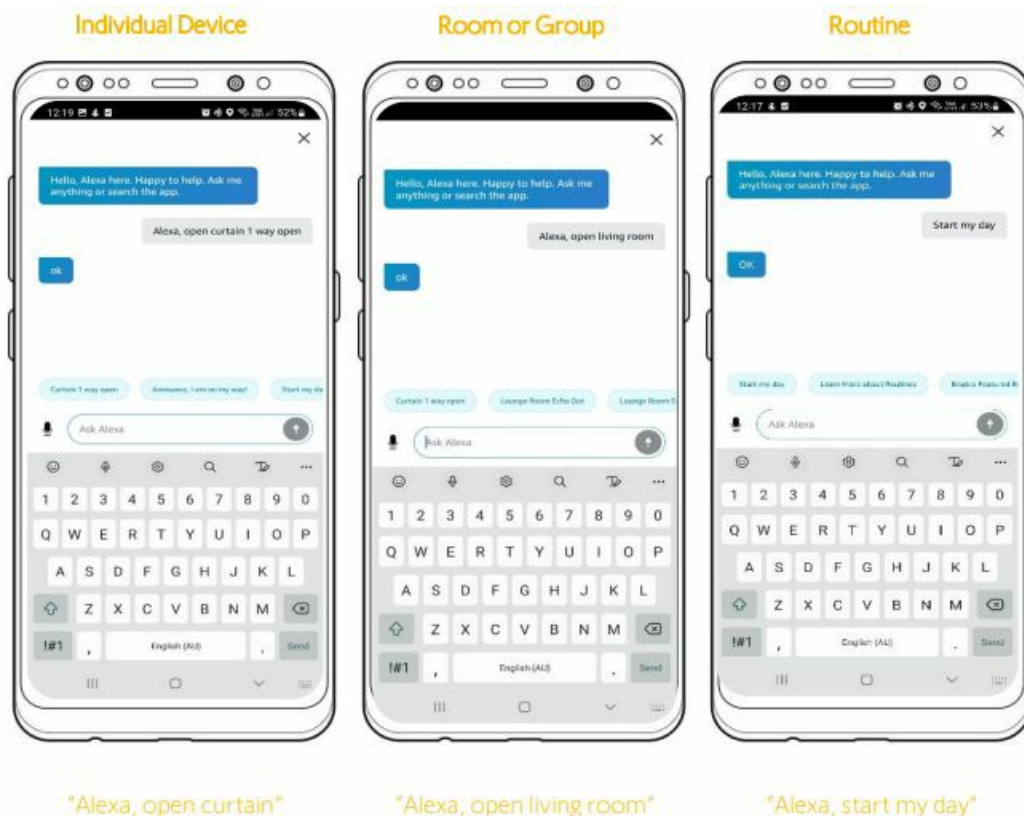

## Troubleshooting:

<p>I cannot find 'Tahoma by Somfy' in the list of Amazon Skills within the Amazon Alexa app.</p>	<p>The 'Tahoma by Somfy' Amazon skill is only available in selected countries and regions. Check that your Amazon profile is set to one of the supported regions.</p>
<p>I have successfully enabled the 'Tahoma by Somfy' Amazon skill; but Alexa cannot find any of my Somfy powered devices.</p>	<ol style="list-style-type: none"> <li>1.) Ensure that your Somfy-powered solutions are paired to your Connexoon Window RTS first.</li> <li>2.) Disable and then re-enable the 'Tahoma by Somfy' Amazon skill in your Amazon Alexa app.</li> <li>3.) Contact your local Somfy tech support team on: Phone: 1800 076 639 Email: <a href="mailto:techsupport@somfy.com">techsupport@somfy.com</a></li> </ol>

## About Somfy

Somfy's leading smart solutions for homes and buildings have been improving people's daily lives for over 50 years. Developed with comfort, ease of use, security and sustainability in mind, our innovations automate and connect interior and exterior window coverings, awnings and pergolas. We are committed to creating useful solutions that are accessible to all, designed for today and beyond.

Somfy Pty Limited Australia

Toll Free 1800 076 639 t: 02 8845 7200

e: [somfy.au@somfy.com](mailto:somfy.au@somfy.com)

New Zealand



Toll Free 0800 276 639 e: [somfy.nz@somfy.com](mailto:somfy.nz@somfy.com)

[somfy.com.au](https://www.somfy.com.au)

[somfy.co.nz](https://www.somfy.co.nz)

Find us on Facebook Follow us on Instagram Subscribe to us on YouTube Follow us on Pinterest

## Documents / Resources

 <p>Connexoon Window RTS Direct Compatibility with Amazon Alexa User Guide quadrant</p> 	<p><a href="#">Somfy Connexoon Window RTS Direct Compatibility with Amazon Alexa</a> [pdf] User Guide Connexoon Window RTS Direct Compatibility with Amazon Alexa, Connexoon Window RTS, Direct Compatibility with Amazon Alexa, Compatibility with Amazon Alexa</p>
--	--

## References

- [Somfy: motors, automation, controls and smart home solutions](#)
- [Somfy: motors, automation, controls and smart home solutions](#)
- [User Manual](#)

### Manuals+, Privacy Policy

This website is an independent publication and is neither affiliated with nor endorsed by any of the trademark owners. The "Bluetooth®" word mark and logos are registered trademarks owned by Bluetooth SIG, Inc. The "Wi-Fi®" word mark and logos are registered trademarks owned by the Wi-Fi Alliance. Any use of these marks on this website does not imply any affiliation with or endorsement.