



## solo Sideloading An APP Instructions

[Home](#) » [Solo](#) » solo Sideloading An APP Instructions 



### Contents

- [1 Sideloading An APP](#)
- [2 Documents / Resources](#)
- [3 Related Posts](#)

### Sideloading An APP

Download the APK file for the app you are wanting to install onto your PC.

\*Note: in most cases you can download the APK directly from the software provider's site. There are also several APK download sites that make these APKs available. For example, [www.apkmirror.com](http://www.apkmirror.com) and [www.apkpure.com](http://www.apkpure.com).

Place the Scepter or Solo in the charging cradle (connected via USB to PC) and enable File transfer mode:

- Swipe downward from top of screen.
- Tap USB for charging... then File transfers.

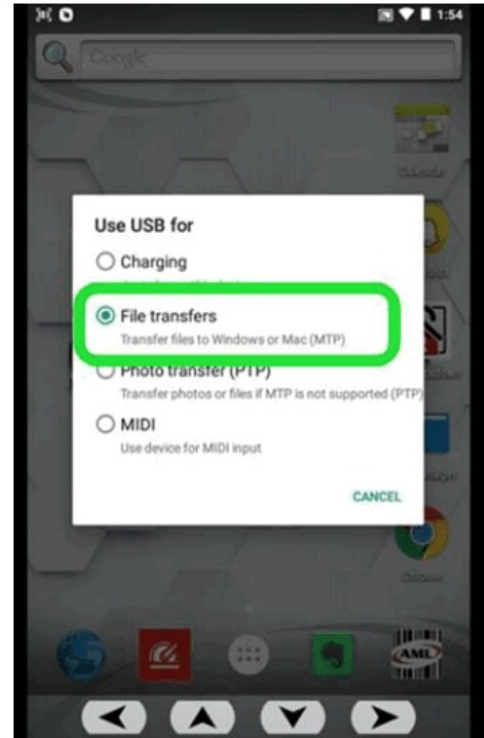

Open Windows File Explorer on the PC.

(\*note: this can also be performed using a thumb drive inserted into the charging cradle)

Copy your apk file(s) to: Scepter > Internal storage > Download.

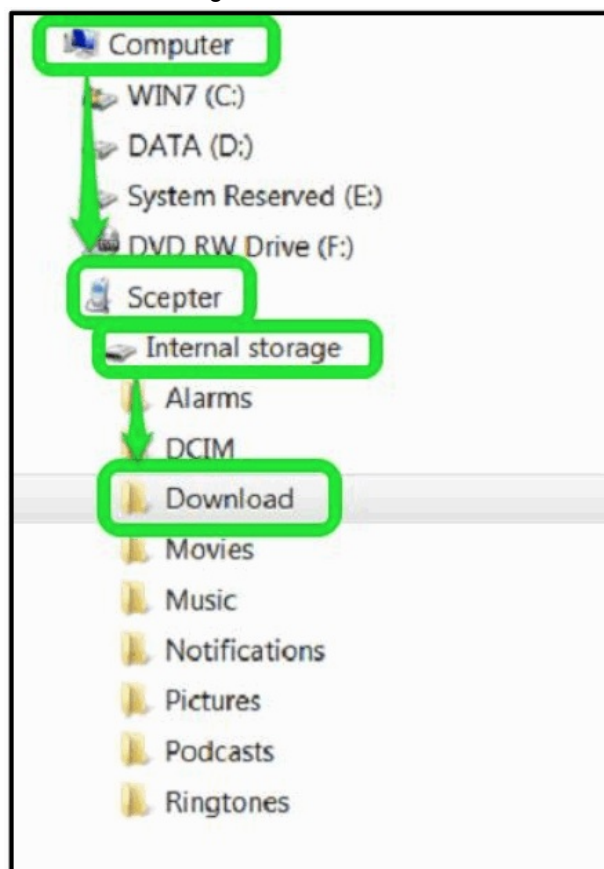

Install the APK on the Scepter or Solo using the File Manager app:

- Tap the File Manager app to open

- Navigate to the Download folder

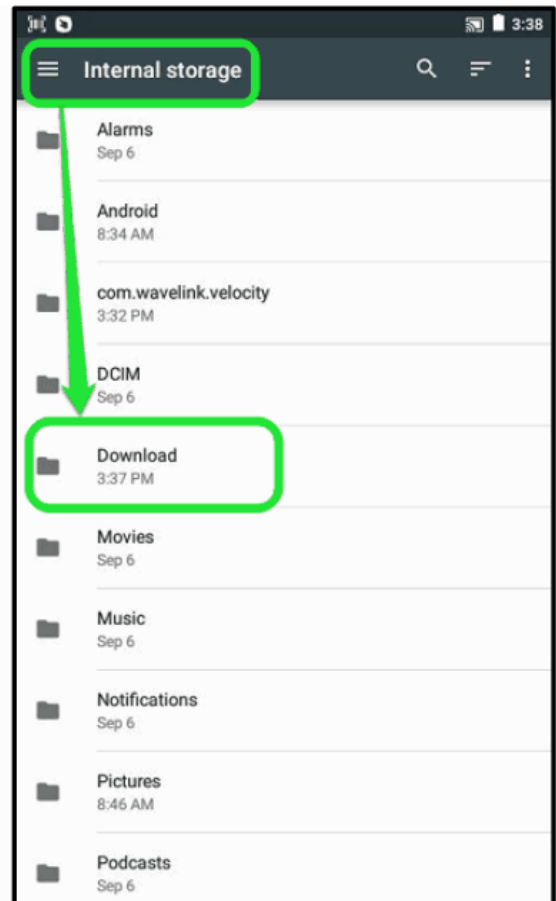
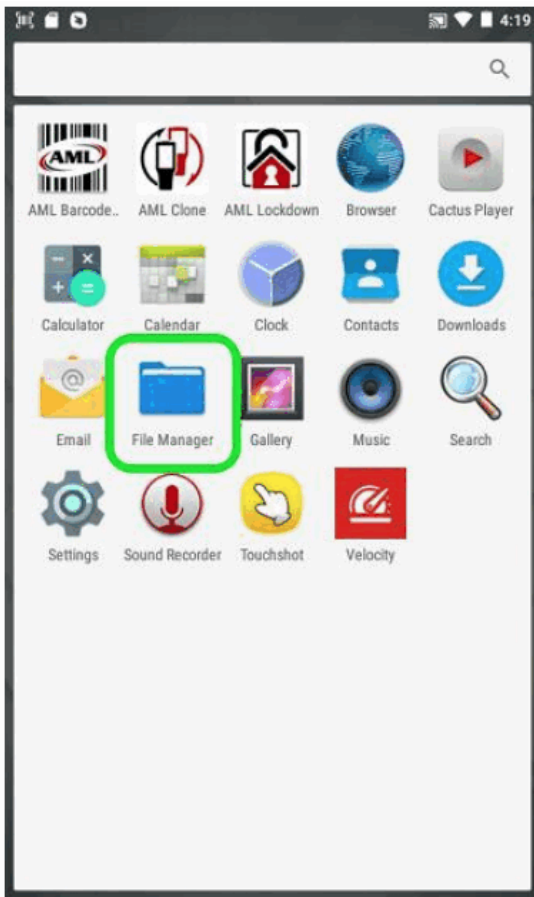

Tap on the APK file and choose Install.

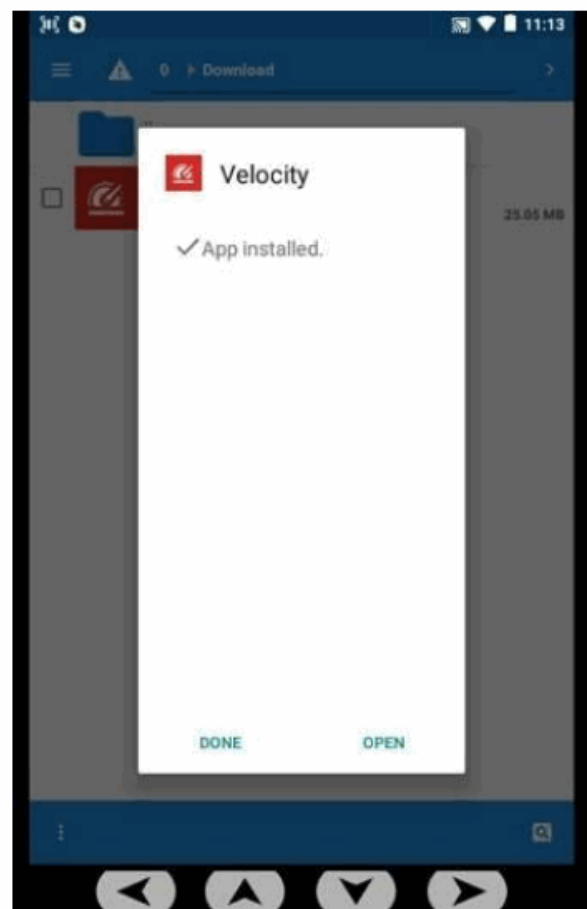
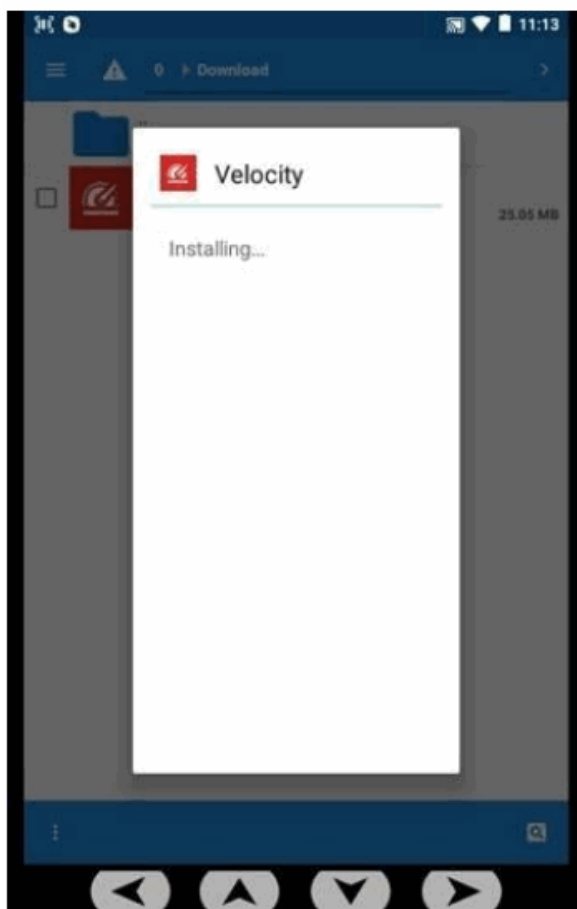
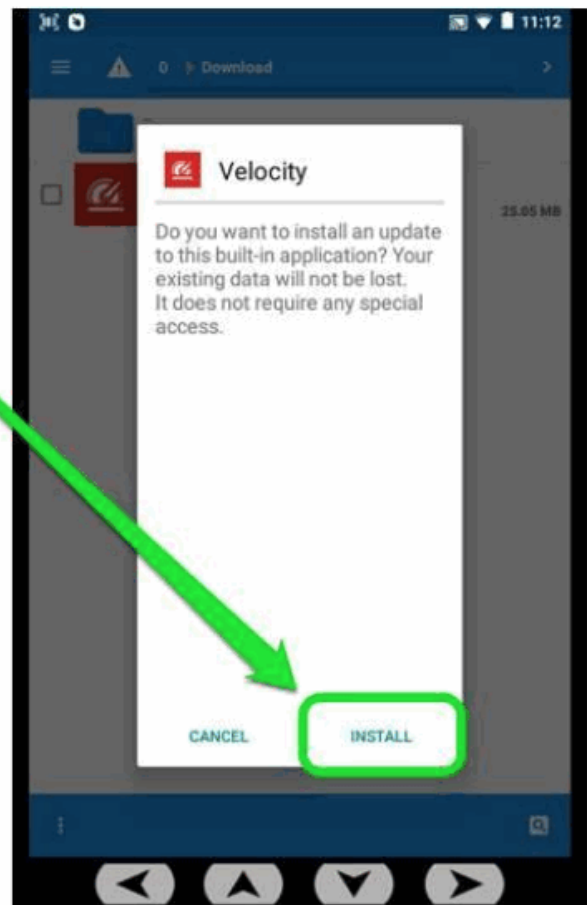

\*Note: Once you have a unit configured the way you want it, the AML Clone app will allow you to make a clone file for your device (which will copy/clone all settings, applications, files. etc.) to be deployed onto your other devices.

The AML Clone app is not just a backup and restore function, but a true cloning utility. The encrypted clone file can then be used to quickly image other devices with all the same applications, settings and credentials. See \*AML Cloning App\* document.



Documents / Resources

	<a href="#">solo Sideload An APP [pdf] Instructions</a> Sideload An APP, An APP, APP
---	---

Manuals+.