

SOLIGHT DT01 Mechanical Timer



Contents [[hide](#)]

[1 Operating Instructions](#)

[2 Customer Support](#)

[3 Documents / Resources](#)

[3.1 References](#)

Operating Instructions

- Set the correct time by turning the entire dial in the direction of the arrow.
- Push the black plastic parts (latches) as needed (1 section = 15 minutes).
- Insert the switch into the socket and plug in your appliance.
- You can turn off the timer function with the switch on the right side.

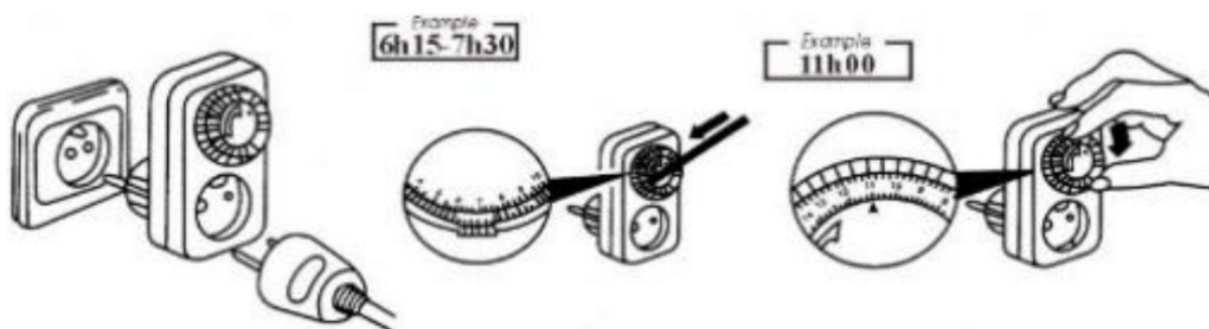

Input: 230 V/50 Hz; **Output:** max. 16A, 230V, 3680W; **Minimum time:** 15 min., **Range:** 24h.

Customer Support

The product is issued with a CE declaration of conformity in accordance with applicable regulations.

On request from the manufacturer: info@solight.cz, or downloadable at <https://www.solight.cz>. Manufacturer: So light Holding, s.r.o., Na Bren 1972, Hradec Krylova 500 06, Czech Republic.



Documents / Resources

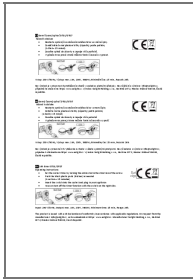

[SOLIGHT DT01 Mechanical Timer \[pdf\]](#) Instruction Manual
DT01, DT07, DT01 Mechanical Timer, Mechanical Timer, Timer

References

- [User Manual](#)

DT01, DT01 Mechanical Timer, DT07, Mechanical Timer, Solight,
Solight Timer

Leave a comment

Your email address will not be published. Required fields are marked *

Comment *

Name

Email

Website

☐ Save my name, email, and website in this browser for the next time I comment.

[Post Comment](#)

Search:

[Search](#)

[Manuals+](#) | [Upload](#) | [Deep Search](#) | [Privacy Policy](#) | [@manuals.plus](#) | [YouTube](#)

This website is an independent publication and is neither affiliated with nor endorsed by any of the trademark owners. The "Bluetooth®" word mark and logos are registered trademarks owned by Bluetooth SIG, Inc. The "Wi-Fi®" word mark and logos are registered trademarks owned by the Wi-Fi Alliance. Any use of these marks on this website does not imply any affiliation with or endorsement.