

 **SOLEM**
BL-NR Bluetooth
Watering Controller



SOLEM BL-NR Bluetooth Watering Controller User Guide

[Home](#) » [SOLEM](#) » SOLEM BL-NR Bluetooth Watering Controller User Guide 

Contents

- [1 SOLEM BL-NR Bluetooth Watering Controller](#)
- [2 Product Information](#)
- [3 Product Usage Instructions](#)
- [4 FAQ](#)
- [5 App download](#)
- [6 Battery installation](#)
- [7 Configuration](#)
- [8 Documents / Resources](#)
 - [8.1 References](#)



SOLEM BL-NR Bluetooth Watering Controller



Product Information

Specifications

- **Model:** BL-NR
- **Languages:** English (EN), French (FR), Spanish (ES), Italian (IT)

Product Usage Instructions

Battery Installation

1. Remove the green cover and the sealing cap.
2. Place the battery in the compartment respecting the polarity.
3. Replace the sealing plug and the green cap.

Configuration

1. Turn on Bluetooth on your smartphone or tablet.
2. Open the MySOLEM app and install a product for the first time:
 1. Launch the MySOLEM app.
 2. Tap on the number displayed in green (same as on the product).
 3. After a few seconds, your device will be connected.
 4. Change the name of the device if desired.
 5. Add a security key for protection.

To schedule, rename, or issue manual commands, open the MySOLEM app. Select the device by pressing either

the number or its name, and then follow the application's prompts. If pairing has already been established and you're replacing the battery, there is no need to redo the pairing. Simply wait 2 minutes while the product pairs with your phone.

FAQ

- **Q:** Do I need to redo the pairing if I replace the battery?
- **A:** If pairing has already been established and you're replacing the battery, there is no need to redo the pairing. Simply wait 2 minutes while the product pairs with your phone.

App download

- Download the MySOLEM app on your smartphone or tablet from the App Store or Google Play.



Battery installation

1. Remove the green cover and the sealing cap.
2. Place the battery in the compartment respecting the polarity.
3. Replace the sealing plug and the green cap.



Configuration

1. Turn on Bluetooth on your smartphone or tablet.
If the Bluetooth is not turned on, the MySOLEM app will prompt you to activate it and it guide you to your settings in order to do so.

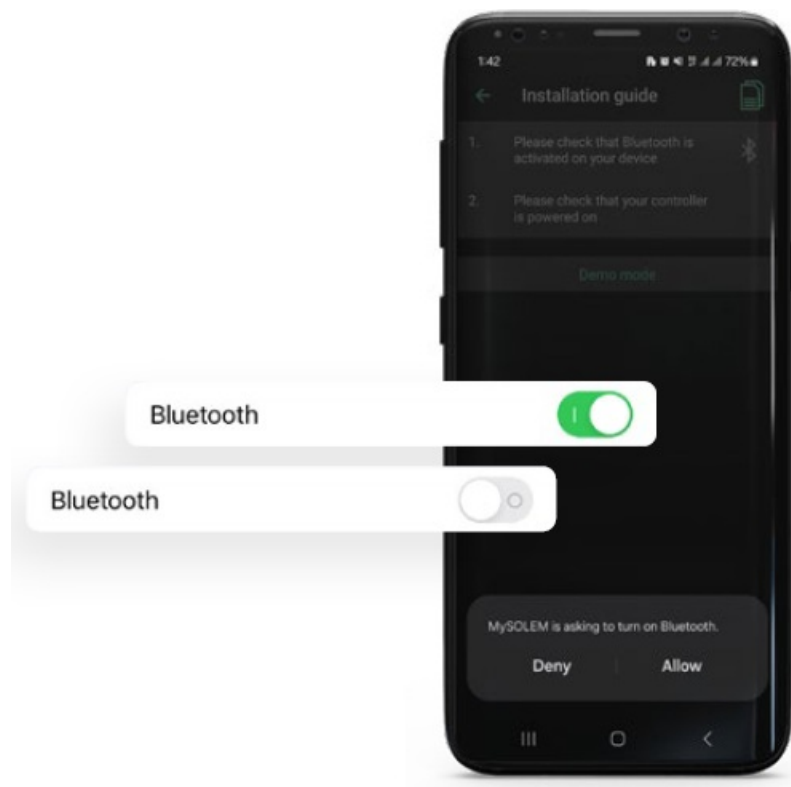

2. Opening the app and installing a product for the first time:



Launch the MySOLEM app



Click on the 3 « + »

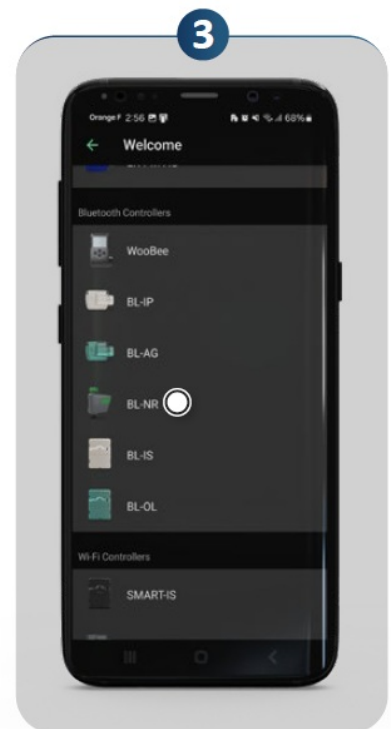

Tap on « BL-NR » from the list

- Tap on the number displayed in green. It is the same number found on the underside of the product.

4

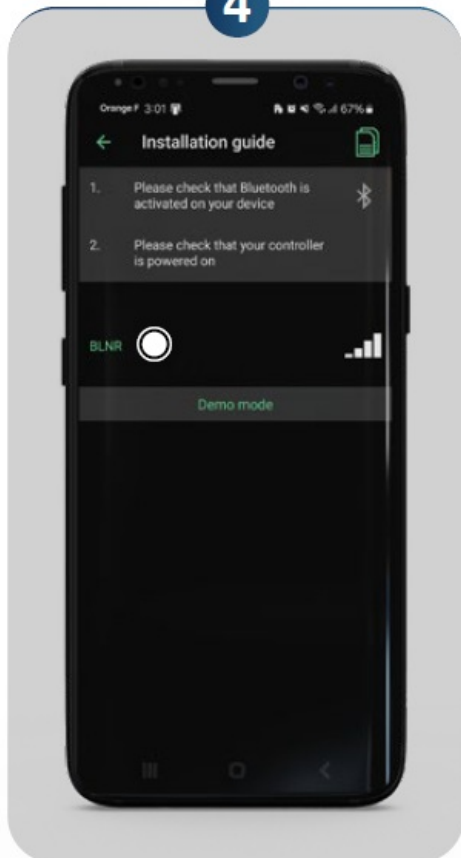

See the label on the underside of the product.

5

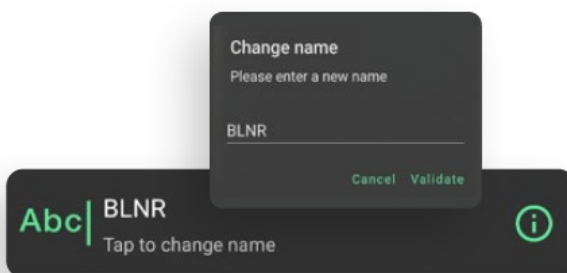
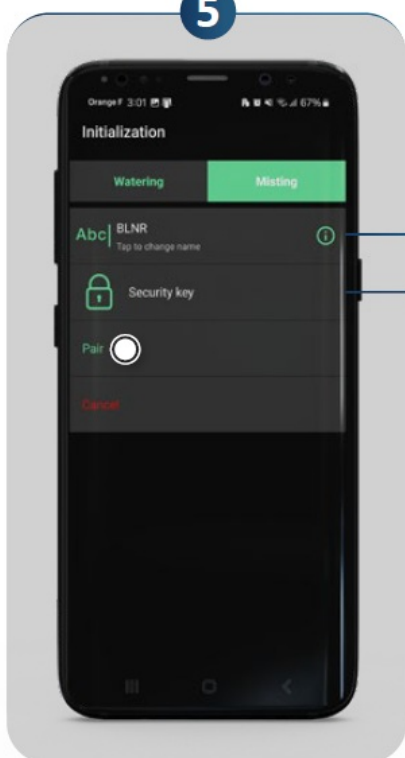

Change the name of the device if desired.

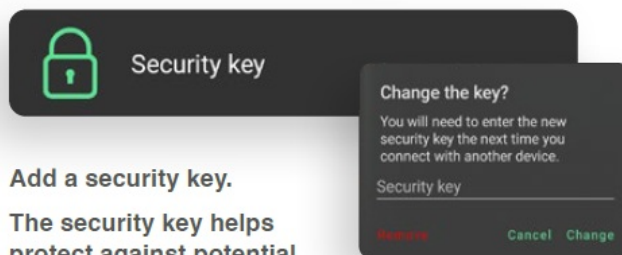

Add a security key.
The security key helps protect against potential threats from unauthorized neighbors.

Tap on « Pair »

- After a few seconds, your device will be connected.



After a few seconds, your device will be connected.

To schedule, rename, or issue manual commands, open the MySOLEM app. Select the device by pressing either the number or its name, and then follow the application's prompts. If pairing has already been established and you're replacing the battery, there is no need to redo the pairing. Simply wait 2 minutes while the product pairs with your phone.

For additional information, please visit our support website at support.mysolem.com.

Documents / Resources

 <p>SOLEM ASSOCIATION GUIDE BL-NR Bluetooth</p>	<p>SOLEM BL-NR Bluetooth Watering Controller [pdf] User Guide BL-NR_MULTI, BL-NR Bluetooth Watering Controller, BL-NR, Bluetooth Watering Controller, Watering Controller, Controller</p>
--	---

References

- [User Manual](#)

[Manuals+](#). [Privacy Policy](#)

This website is an independent publication and is neither affiliated with nor endorsed by any of the trademark owners. The "Bluetooth®" word mark and logos are registered trademarks owned by Bluetooth SIG, Inc. The "Wi-Fi®" word mark and logos are registered trademarks owned by the Wi-Fi Alliance. Any use of these marks on this website does not imply any affiliation with or endorsement.