



SoClean Adapter and Diffuser for Respiration System One and DreamStation Instructions

[Home](#) » [SoClean](#) » SoClean Adapter and Diffuser for Respiration System One and DreamStation Instructions



SoClean Adapter and Diffuser for Respiration System One and DreamStation



Contents

- [1 CONNECTING TO:](#)
- [2 Connecting the Adapter: Dream Station](#)
- [3 Connecting the Adapter: System One](#)
- [4 Connecting the Diffuser: System One](#)
- [5 Documents / Resources](#)
 - [5.1 References](#)
- [6 Related Posts](#)

CONNECTING TO:

Respironics DreamStation and System One System One machine with a standard hose connection.

To begin, we'll need to identify if you need to use the adapter or the **diffuser**.

Start by disconnecting your PAP hose from the reservoir.

Now, take a close look at the port on your reservoir to identify how you should proceed.

- Dream Station machine.

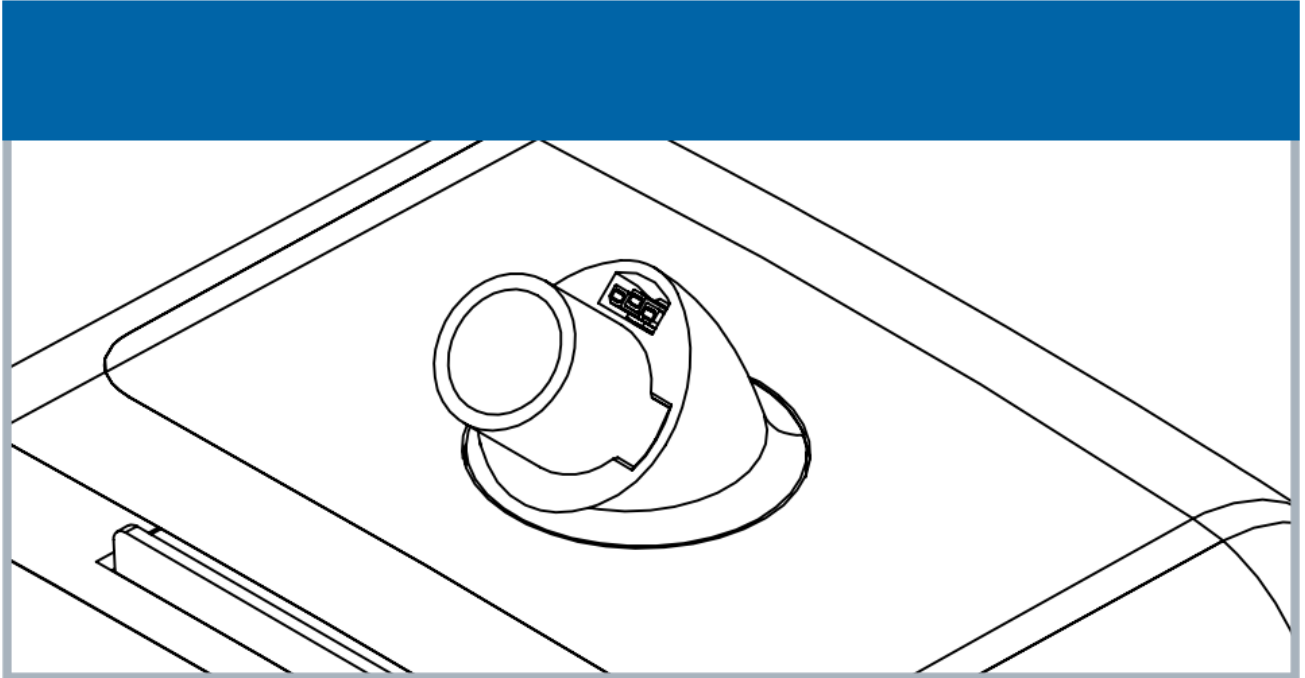

- System One machine with a heated hose connection.



- System One machine with a standard hose connection.

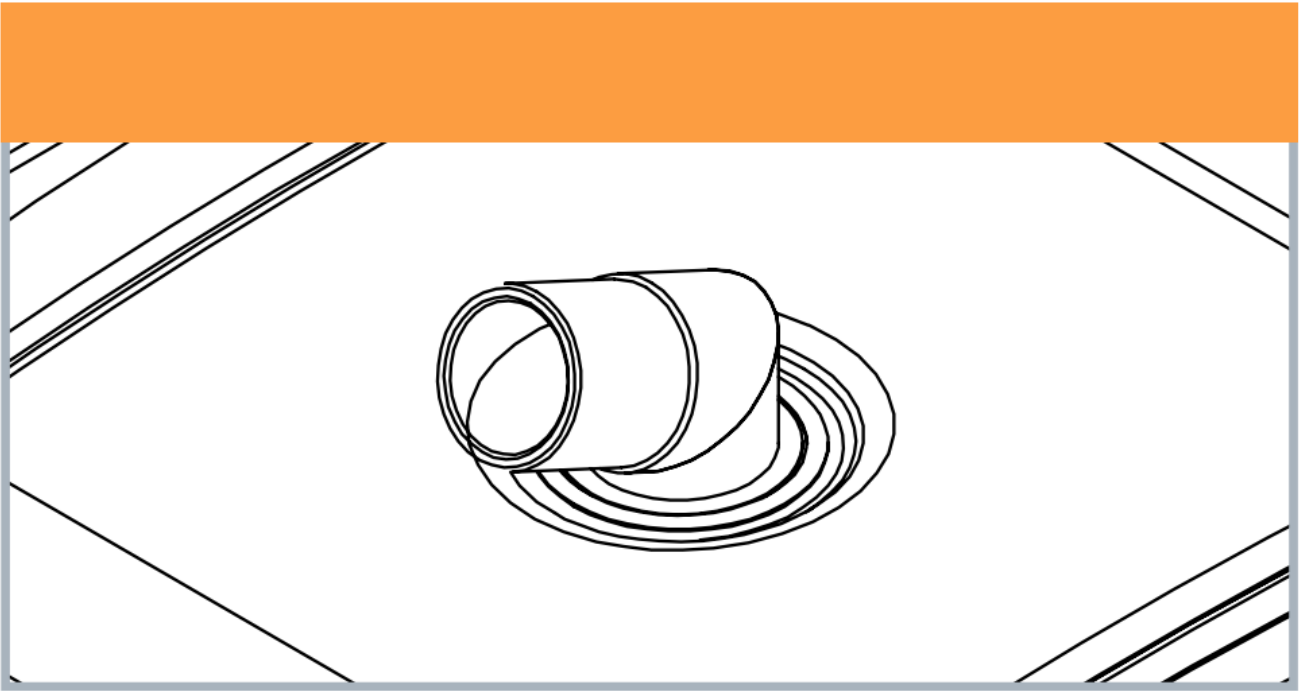

Connecting the Adapter: Dream Station

1. Detach the Injection Fitting from Injection Hose A. Save Injection Fitting in case you need it in the future.

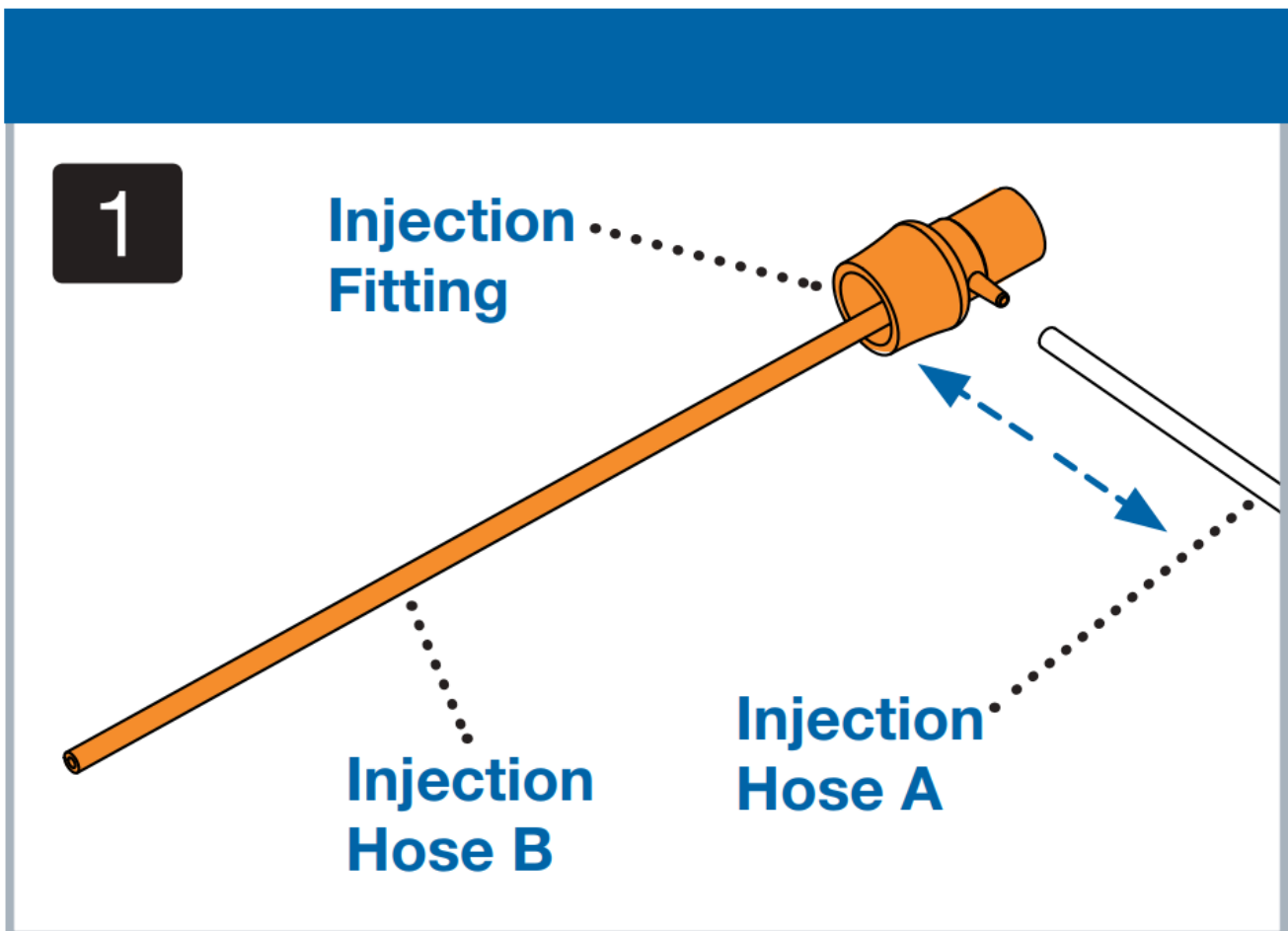

2. Connect Injection Hose A to the stem on the side of the adapter.

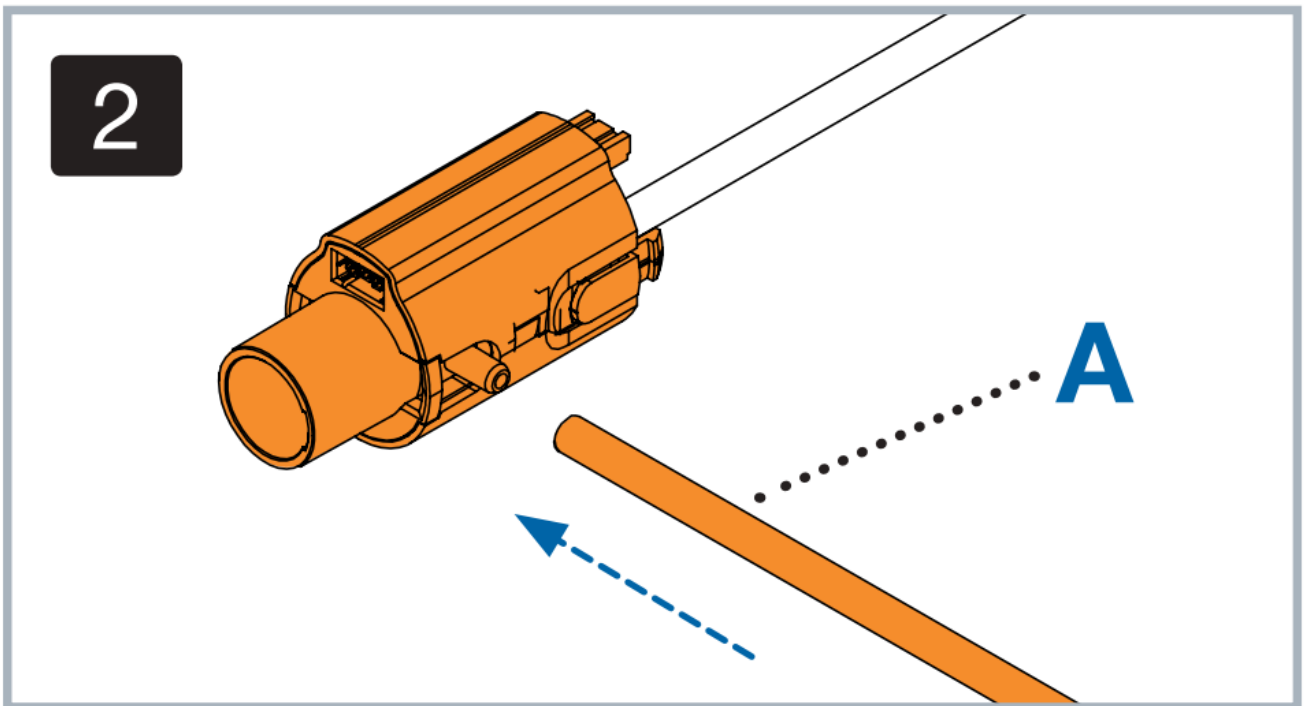

3. Open the reservoir lid.

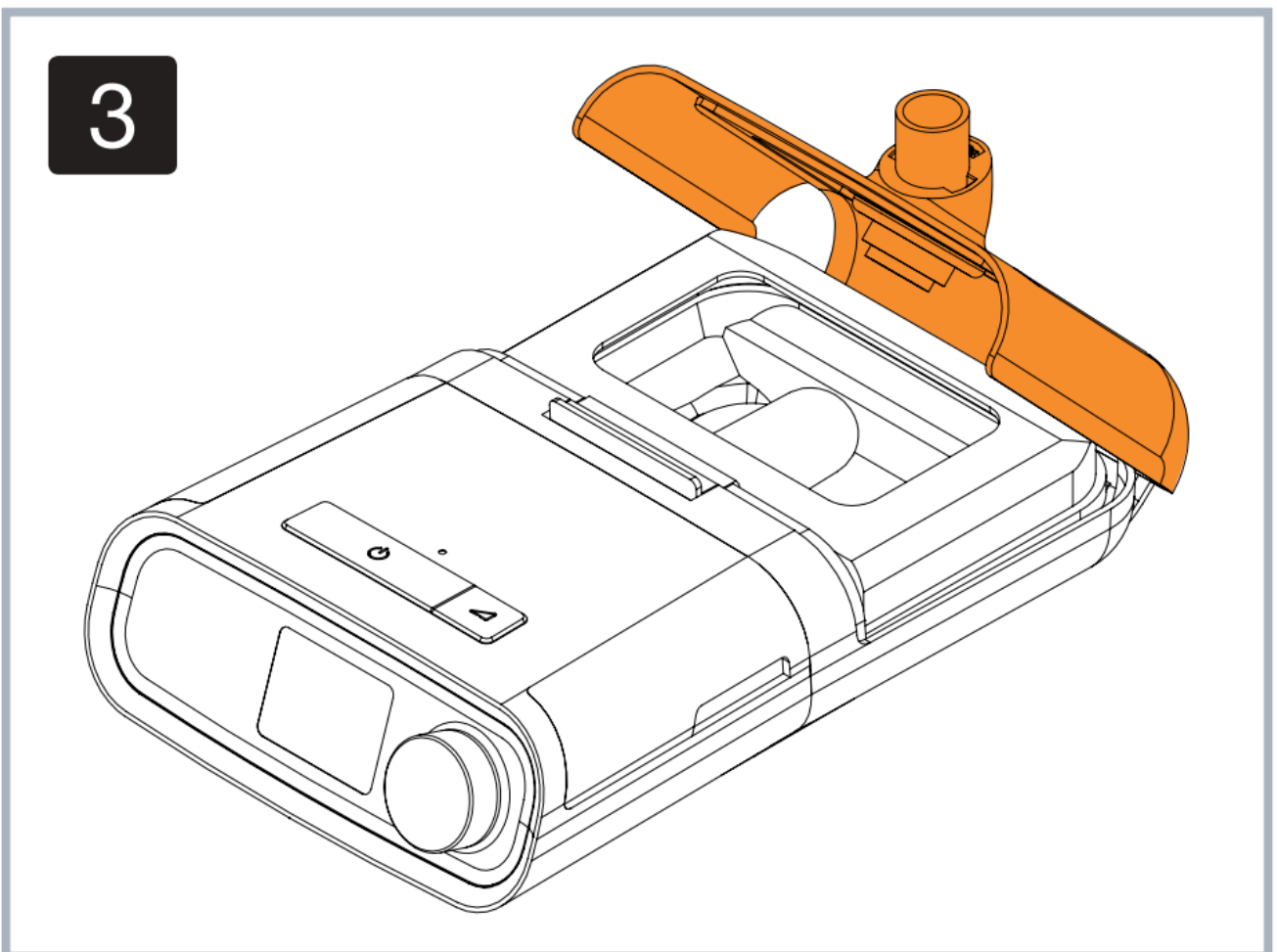

4. Guide the diffuser down into your reservoir through the port making sure that the hose on the underside passes into the reservoir opening and rests near the bottom. Attach the adapter to your reservoir.

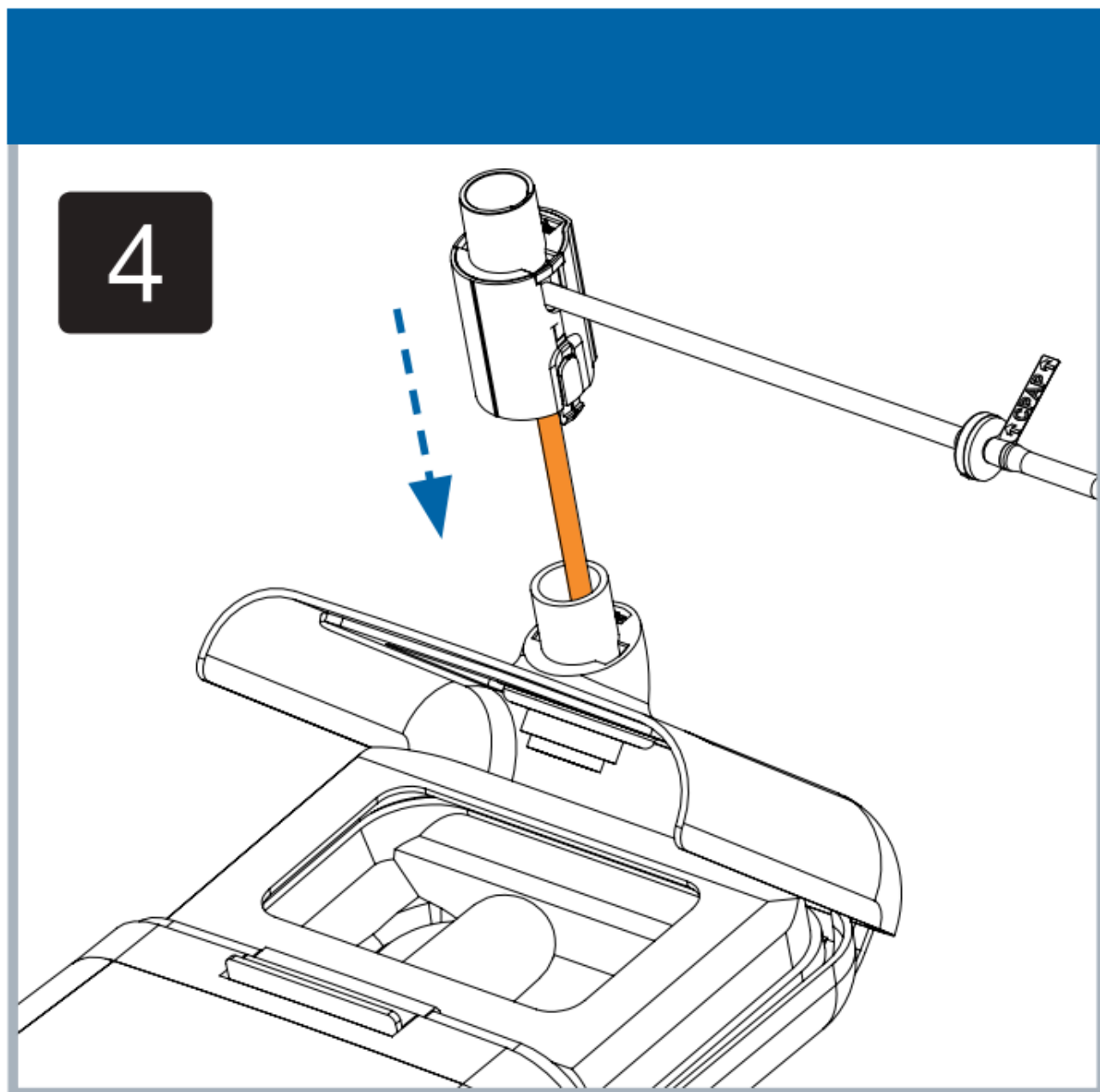

5. Close the reservoir lid and attach the PAP hose to the adapter. You are now ready to use the So Clean.

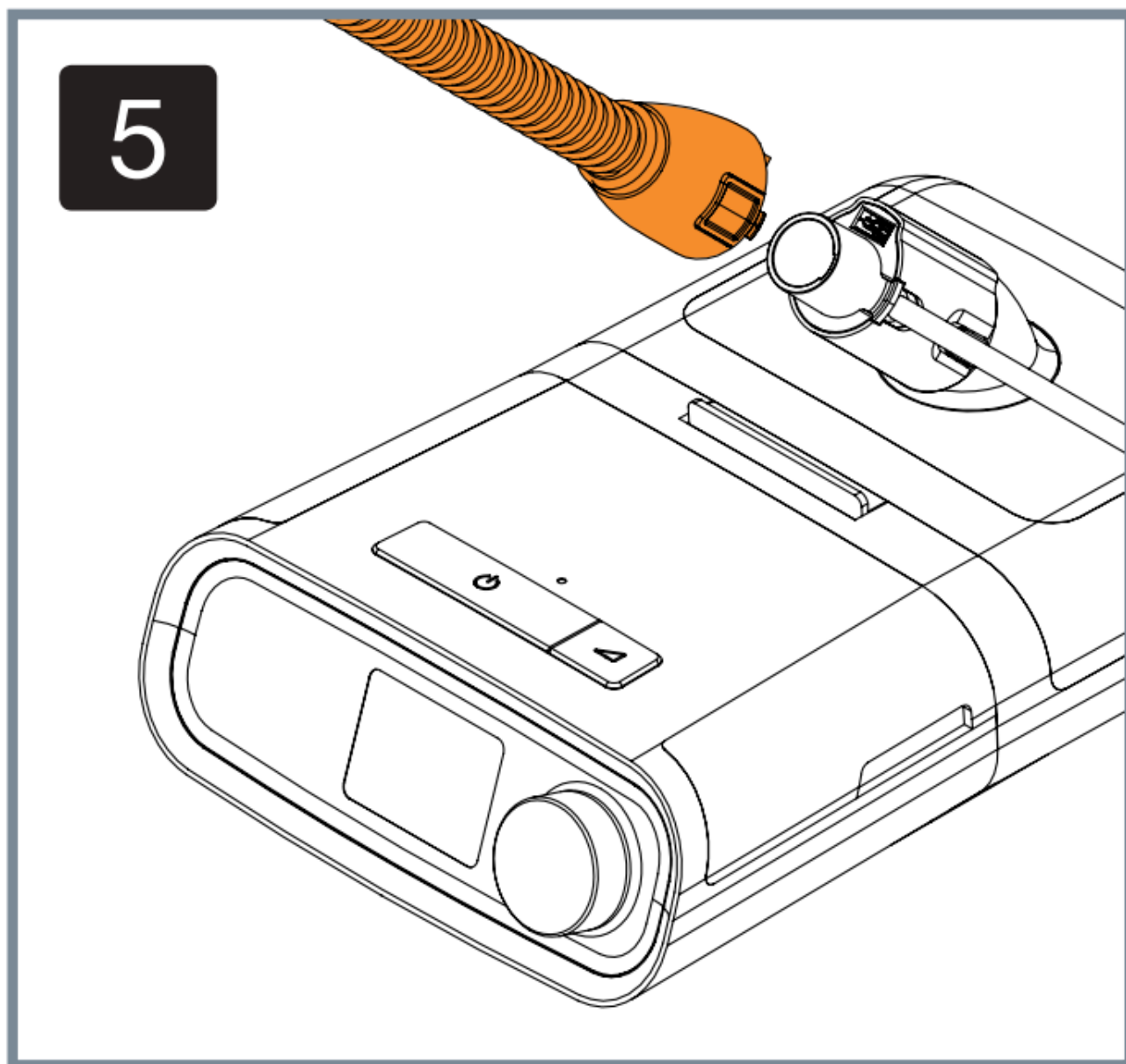

WARNING: Injection Hose A must be attached to the So Clean adapter at all times when operating your PAP or the So Clean.

Connecting the Adapter: System One

with a standard hose connection

1. Detach Injection Fitting from Injection Hose A. Save Injection Fitting in case you need it in the future.

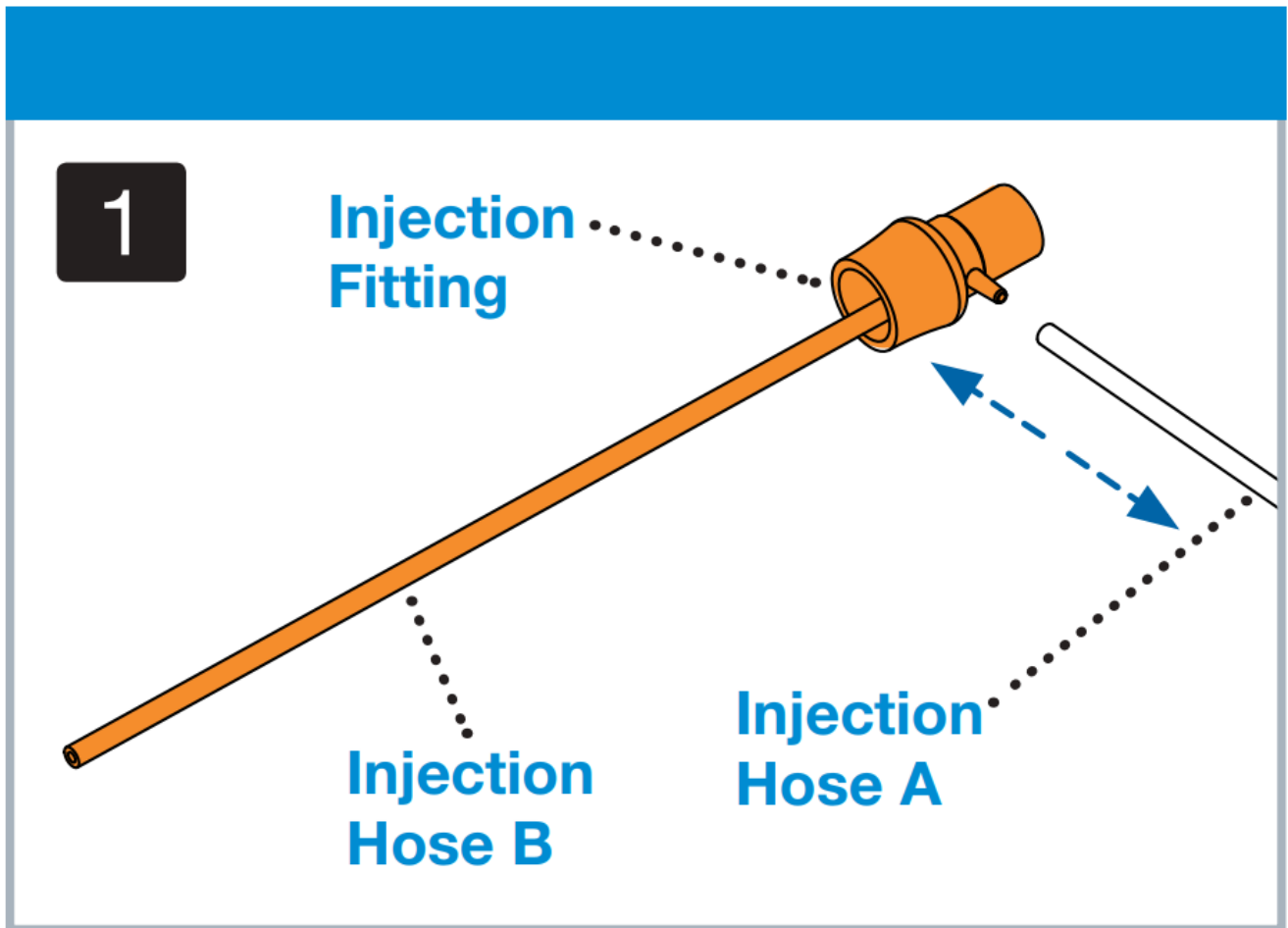

2. Connect Injection Hose A from the So Clean to the stem on the side of the adapter.

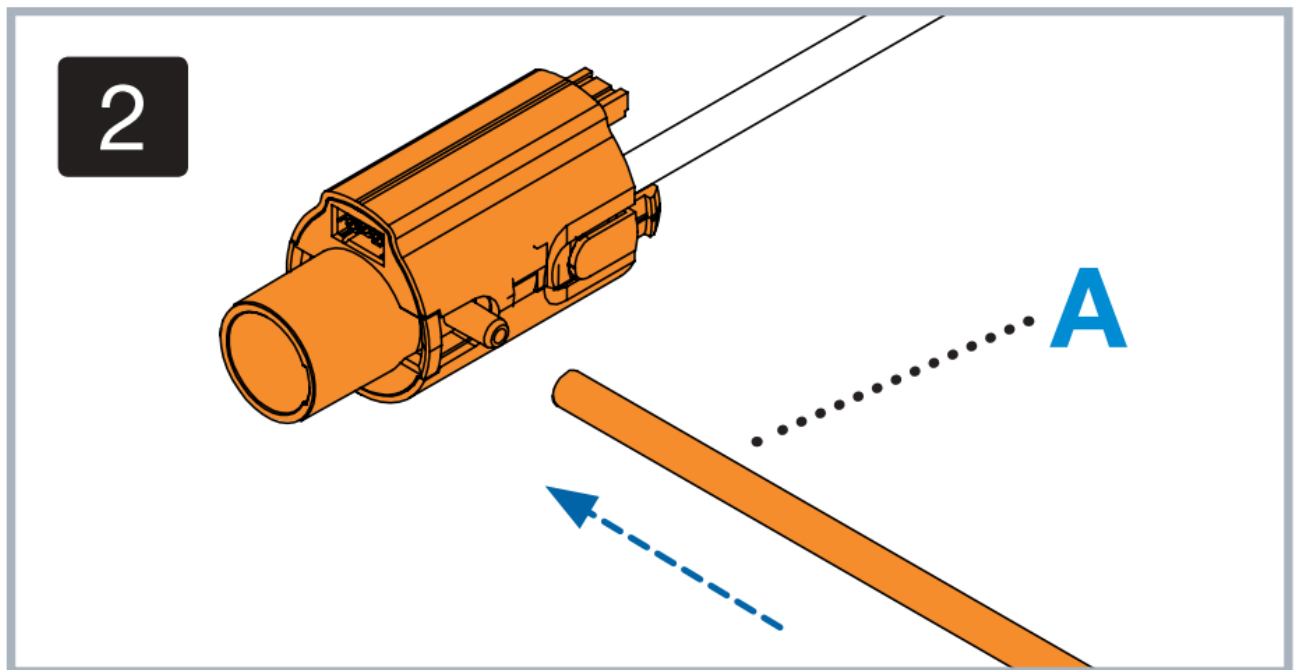

3. Open the reservoir lid.

3

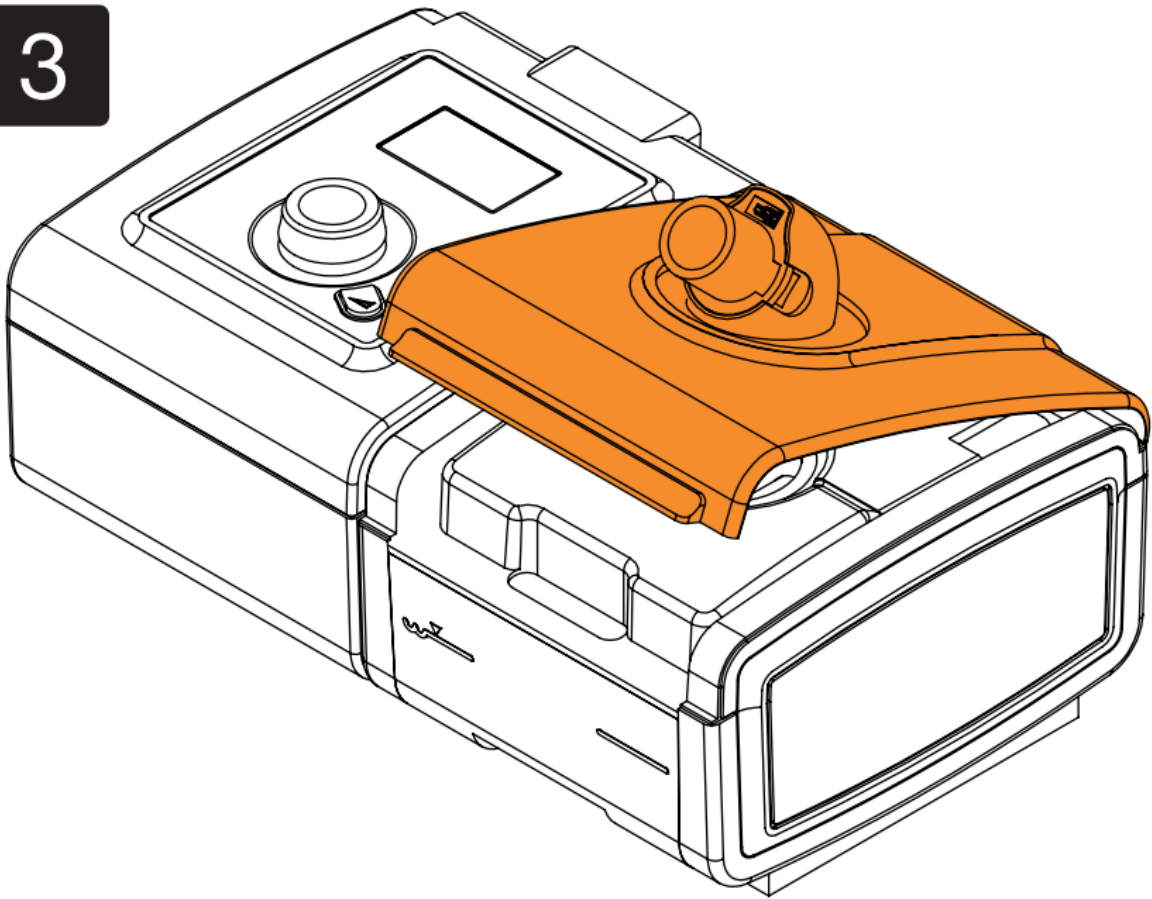

4. Guide the adapter hose down into your reservoir through the port making sure that the hose on the underside passes into the reservoir opening and rests near the bottom. Attach the adapter to your reservoir.

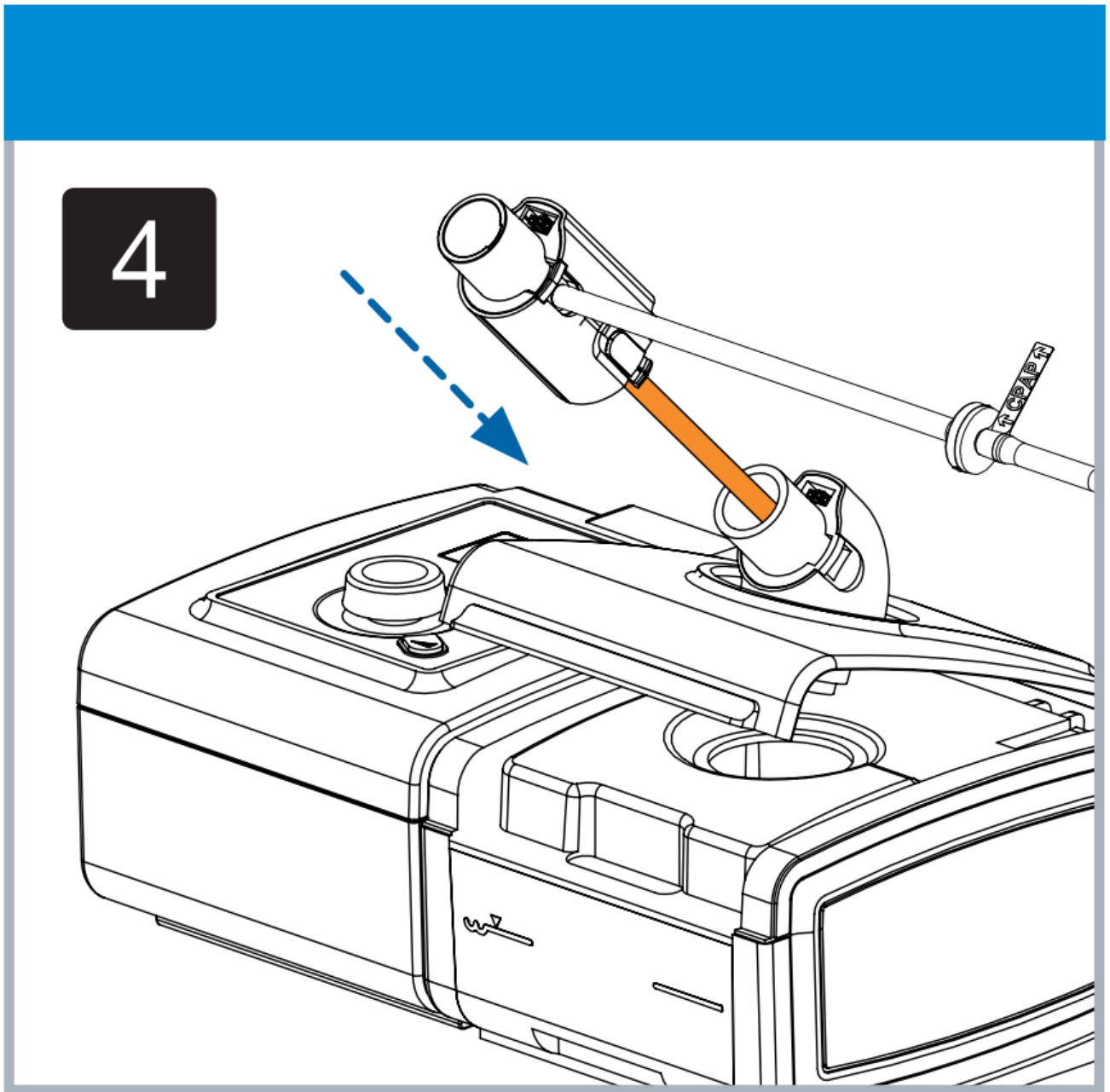

5. Close the reservoir lid and attach the PAP hose to the adapter. You are now ready to use the So Clean.

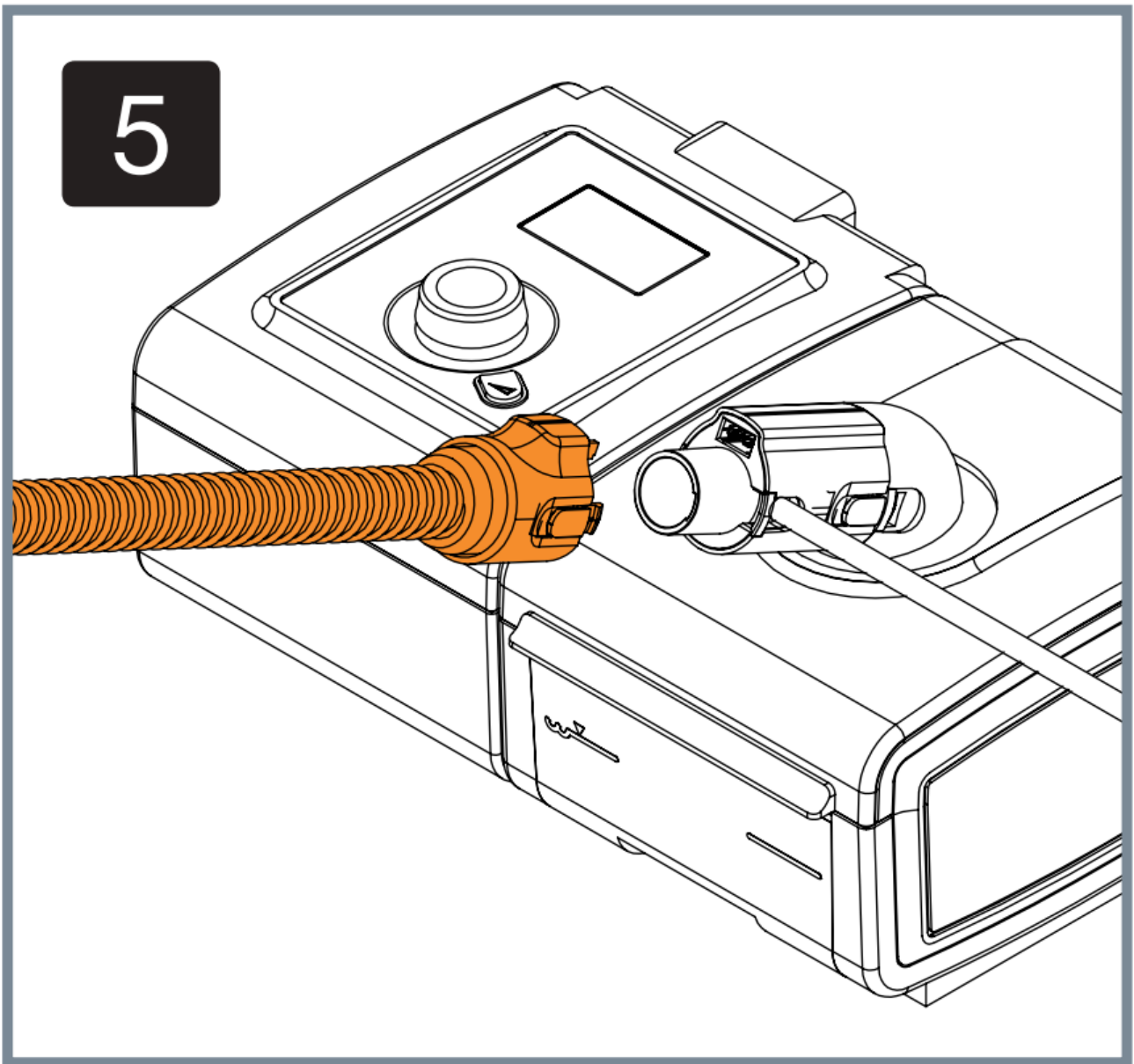

WARNING: Injection Hose A must be attached to the So Clean adapter at all times when operating your PAP or the So Clean.

Connecting the Diffuser: System One

with a standard hose connection

For this scenario, you won't need the adapter. You'll only need the diffuser: the short length of hose with a clear plastic fitting on the end.

1. Detach Injection Hose B from the inner stem of the Injection Fitting.

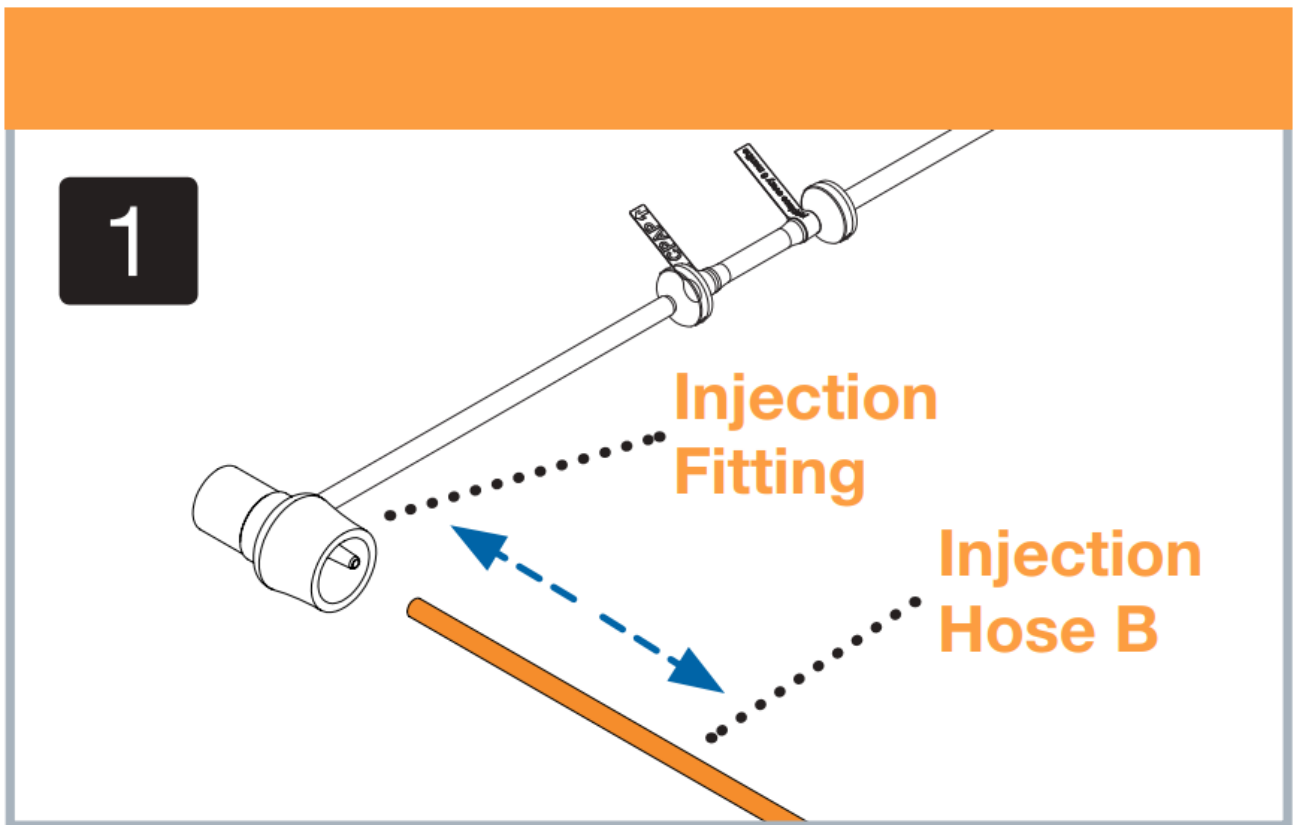

2. Attach the diffuser to the stem on the inside of the Injection Fitting. You may use a little water as a lubricant to make it easier.

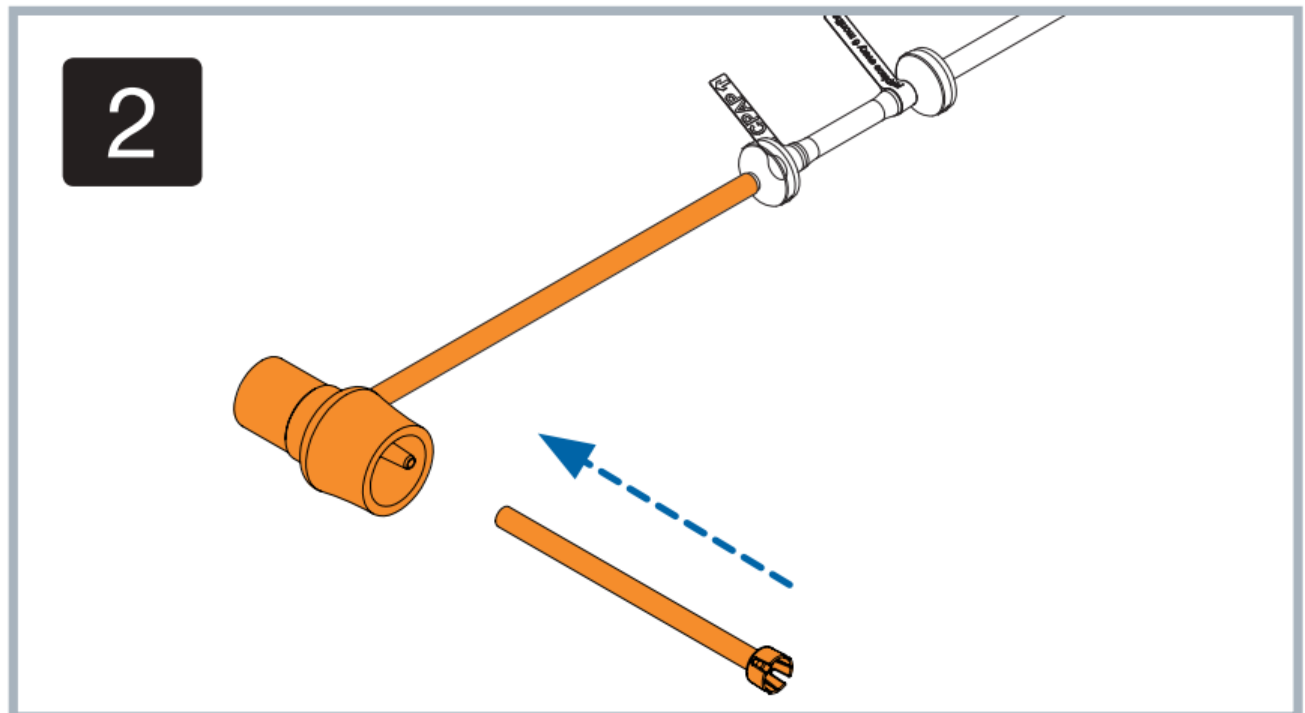

3. Open the reservoir lid.

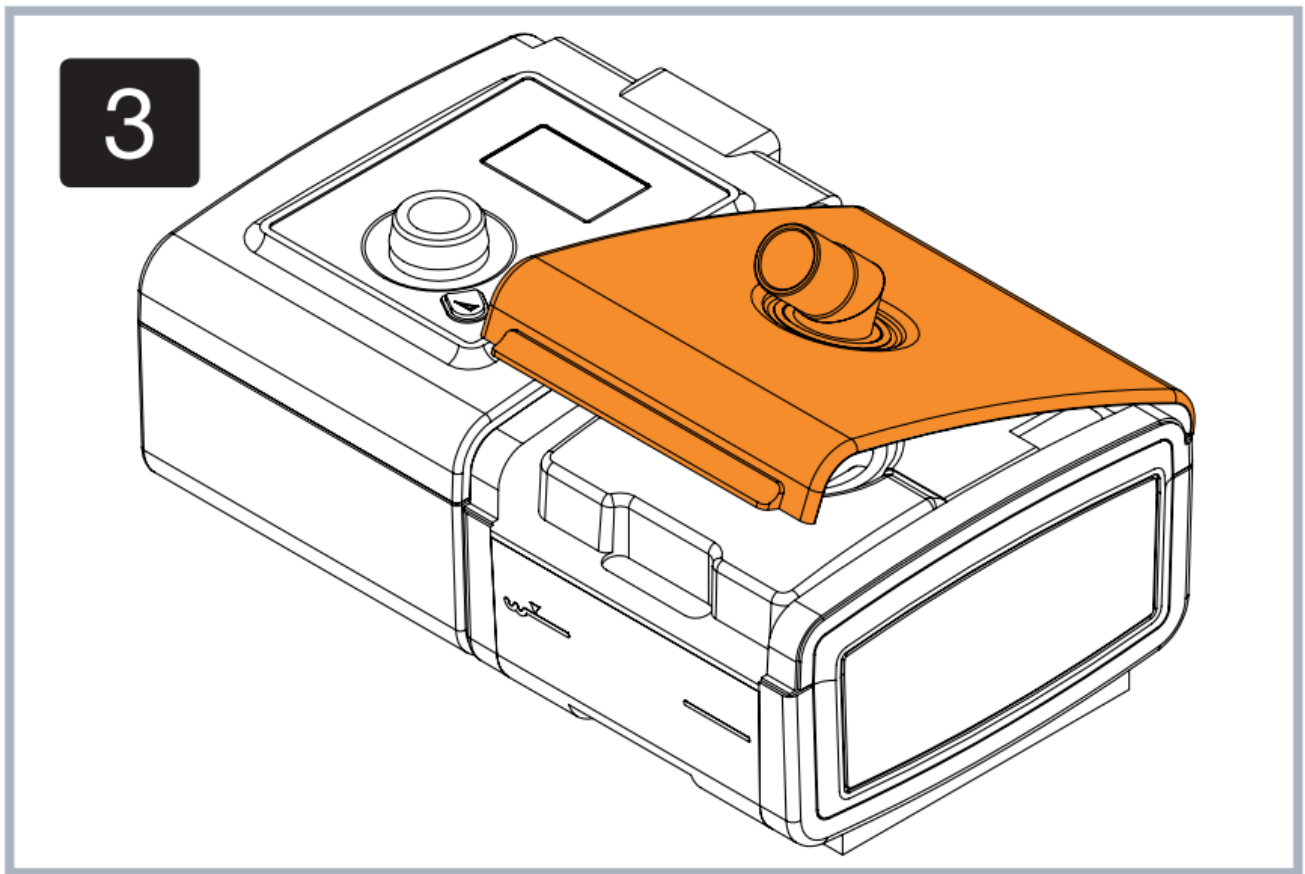

4. Guide the diffuser down into your reservoir through the port, making sure that the hose on the underside passes into the reservoir opening until the clear plastic end rests at the bottom of the reservoir. Attach the Injection Fitting to your reservoir.

4

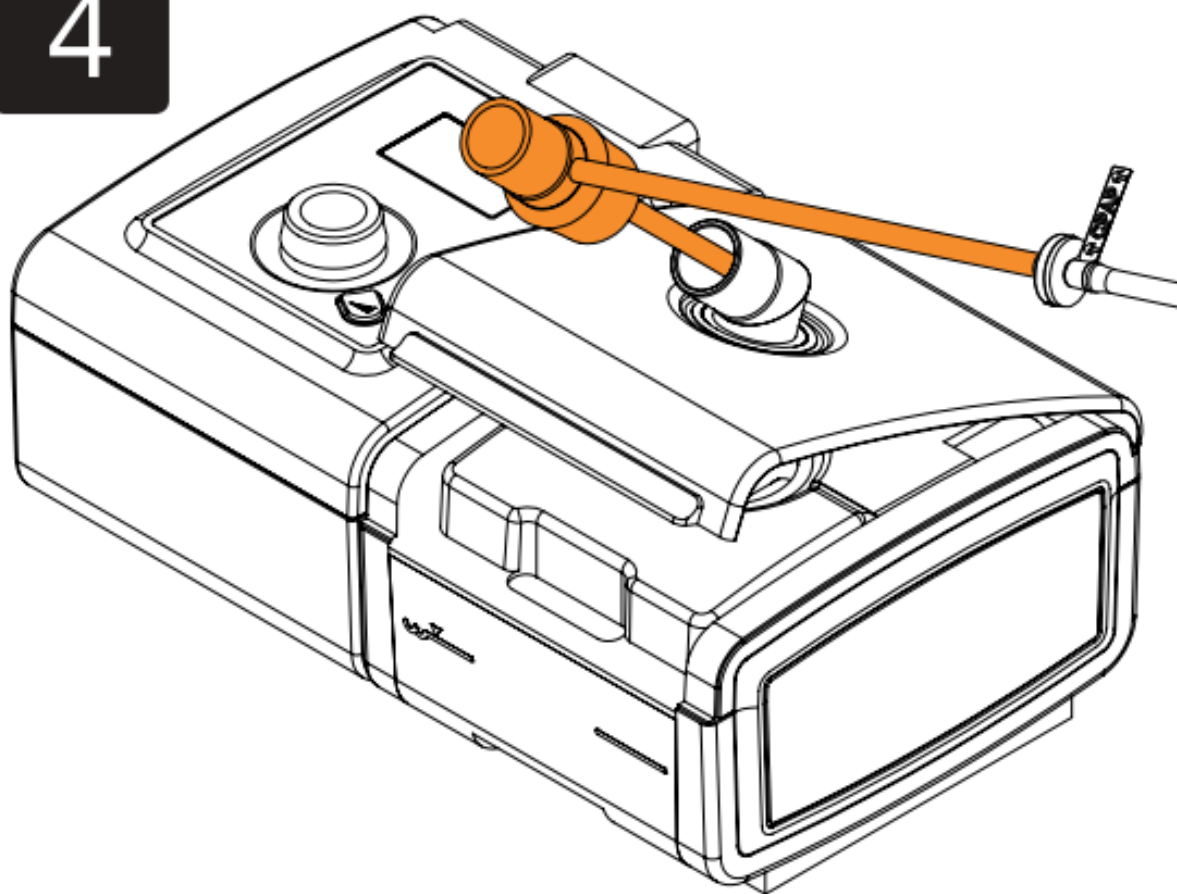

5. Close the reservoir lid and attach the PAP hose to the Injection Fitting. You are now ready to use the So Clean.

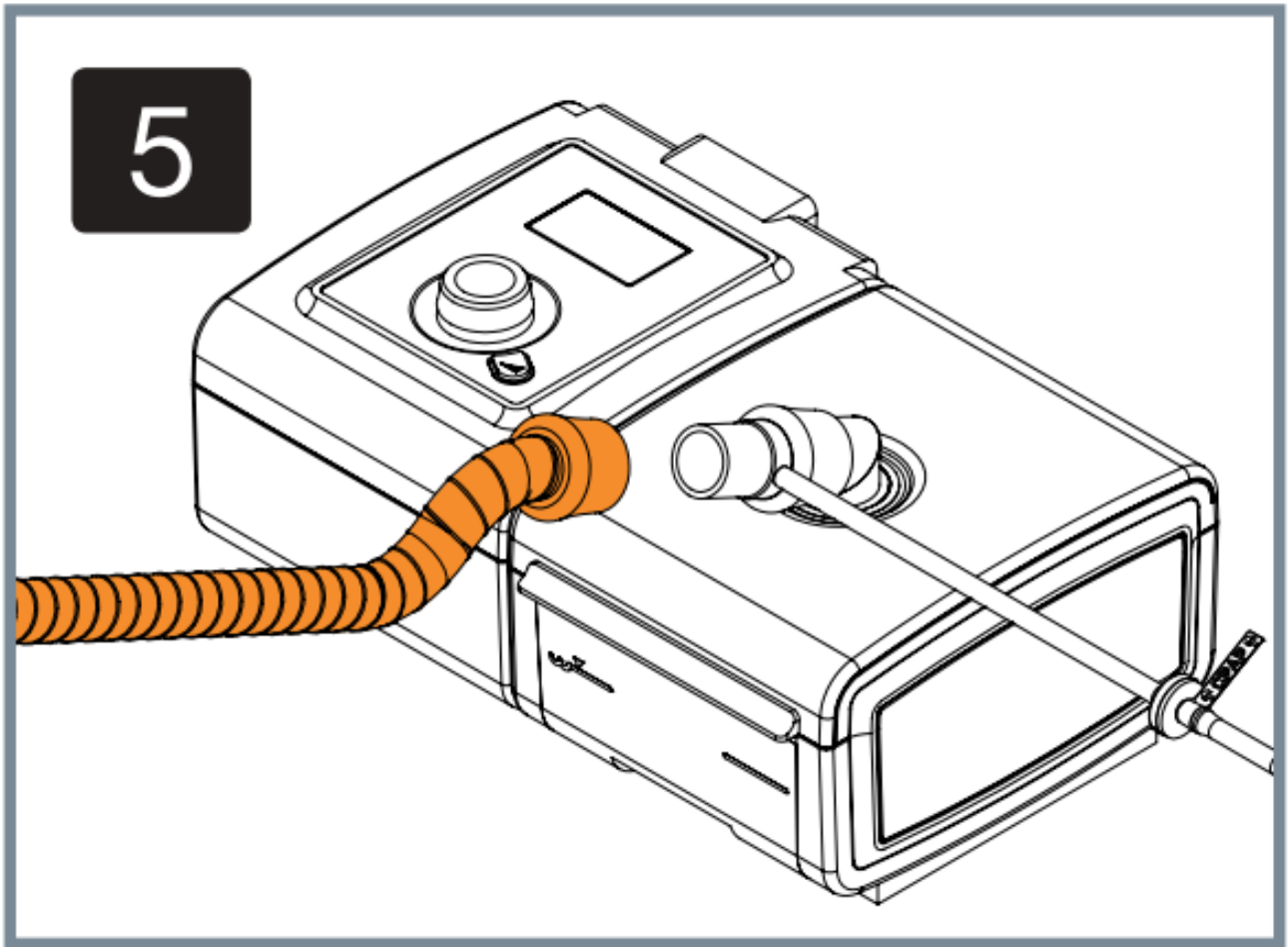

IMPORTANT: If you need to disconnect the So Clean from your adapter, please reinstall the original humidifier lid onto your PAP machine. If you fail to do this, the water in your humidifier will be pushed out through the hose and flooding will result. So Clean is not responsible for damage resulting from equipment mishandling.



WARNING: Injection Hose A must be attached to the So Clean adapter at all times when operating your PAP or the So Clean.

If you need help connecting your adapter or diffuser, contact So Clean.



EU 00800 5558 8811

soclean.com | info@soclean.com

12 Vose Farm Road | Peterborough, New Hampshire 03458 USA



Documents / Resources

	<p>SoClean Adapter and Diffuser for Respironics System One and DreamStation [pdf]</p> <p>Instructions</p> <p>Adapter and Diffuser for Respironics System One and DreamStation, Diffuser for Respironics System One and DreamStation, Respironics System One and DreamStation, One and DreamStation, DreamStation</p>
-----------------------------------------------------------------------------------	--------------------------------------------------------------------------------------------------------------------------------------------------------------------------------------------------------------------------------------------------------------------------------------------------------------------------------------

References

- [SoClean | Bettering Lives Through the Power of A Better Clean](#)