



SoClean 2 Automated PAP Disinfecting System User Manual

[Home](#) » [SoClean](#) » SoClean 2 Automated PAP Disinfecting System User Manual 

Contents

- 1 SoClean 2 Automated PAP Disinfecting System
- 2 Specifications
- 3 YOUR HEALTH AND OZONE SAFETY
- 4 CLASSIFICATION, MANUFACTURER
- 5 FCC Notice
- 6 INCLUDED WITH YOUR SOCLEAN 2
- 7 SOCLEAN 2 CONTROL PANEL
- 8 KEY PAP PARTS
- 9 CONNECTION STEPS
- 10 SUPPORTED PAP MACHINES AND ADAPTERS
- 11 SET CLOCK AND DISINFECTING SCHEDULE
- 12 USING YOUR SOCLEAN 2
- 13 CARE AND MAINTENANCE OF YOUR SOCLEAN 2 DEVICE
- 14 FAQs
- 15 Documents / Resources
 - 15.1 References
- 16 Related Posts



SoClean 2 Automated PAP Disinfecting System



INDICATIONS FOR USE, CONTRAINDICATIONS, SPECIFICATIONS, WARNINGS AND CAUTIONS

Indications for use: The SoClean 2 is a general Positive Airway Pressure (PAP) disinfecting device and is intended to be used in the home. An individual who uses Positive Airway Pressure (PAP) equipment can use the SoClean 2 to destroy 99.9% of germs and bacteria and other pathogens on PAP equipment, or when the user wants the added benefit of thorough PAP system disinfection.*†

The SoClean 2 attaches to a PAP machine and runs daily while the mask is inside the Disinfecting chamber. The SoClean 2 does not need to be disconnected before using your PAP machine.

Contraindications for use: Persons with underlying lung diseases, such as asthma and chronic obstructive pulmonary disease (also known as COPD, which includes emphysema and chronic bronchitis), and those with cardiovascular disease may be sensitive to ozone and should speak to their doctor before using this product.

Read this User Manual before operating the equipment.

Use this product only in the manner described in this User Manual. If the equipment is used in a manner not specified by the manufacturer, the safety protection provided by the equipment may be impaired.

Specifications

Electrical characteristics:

- **AC adapter input:** AC 100~240V, 50/60HZ, 0.5A
- **AC adapter output:** DC 12V, 1.5A max.
- **Power consumption:** 18W max.

- **Environmental characteristics:**

- **Operating:** 10°C to 38°C (50°F to 100°F), 15% to 70% humidity

- **Storage and transport conditions:** -20°C to +55°C (-4°F to 131°F), 15% to 70% humidity

Ozone concentration:

When operated in a 11.6 m² room with 2.4 m-high ceilings, the average ambient ozone concentration in the room over the operating cycle is < 0.05 parts per million (PPM).†

Physical characteristics:

- **Dimensions:** 200 x 184 x 225 mm

- **Weight:** 2.5 kg

- **Cord length:** 142 cm

* DISCLAIMER: SoClean does not represent through the use of the terms disinfect, disinfectant or disinfection herein, or in other documentation, a kill rate of more than 99.9% of germs and bacteria in PAP equipment.

- **WARNING:** Ensure the correct clock time and cycle start time are set on your SoClean 2 before using your PAP machine. Pay particular attention to the AM/PM setting if using the 12-hr mode. Failure to do so may result in the SoClean 2 device operating at an unexpected time.
- **WARNING:** In the event of loss of power to your home or the SoClean 2 device, ensure the correct clock time and cycle start time are set on your SoClean 2 before using your PAP machine. Failure to do so may result in the SoClean 2 device operating at an unexpected time.
- **WARNING:** Do not physically alter the Hose detect switches on your SoClean 2 device. Inspect the Hose detect switches regularly for damage or inability to move up/down. Failure of the Hose detect switches on your SoClean 2 may result in the SoClean operating at an unexpected time.
- **WARNING:** Keep away from water sources including rain, bathtubs, sinks and pools. To clean, wipe with a damp cloth. Do not submerge the SoClean device in liquid or use chemical cleaners.
- **WARNING:** Keep away from children. Do not place any living thing inside the Disinfecting chamber during use.
- **WARNING:** Do not inhale from the Injection hose or the Injection hose outlet on the back of the device.
- **WARNING:** Do not breathe through your PAP mask if the SoClean is operating a disinfecting cycle.
- **WARNING:** Do not use a fragrant oil in the water reservoir or highly fragrant soaps to wash the sleep equipment when using the SoClean 2.
- **WARNING:** Discontinue use if acne or a rash develops along the mask contact line and call SoClean customer care.
- **WARNING:** Do not use in explosive air environments, near gas vapours or other flammables, etc. Do not place any flammable or ignitable items on top of the SoClean 2.
- **WARNING:** Keep the SoClean lid closed until the green status light illuminates (approximately two hours after completion of the disinfecting cycle).
- **WARNING:** Do not remove gasket from the Hose detect switch slot.
- **CAUTION:** The lid gasket is removable. Ensure that the lid gasket is installed properly before operating a disinfecting cycle.
- **WARNING:** Do not dismantle the SoClean 2.
- **CAUTION:** Do not place Neutralising pre-wash in the PAP reservoir. Neutralising pre-wash is for cleaning your PAP equipment only.

- **CAUTION:** Please ensure that the black Injection hose from the back of the SoClean is connected to your PAP before operating your SoClean device.
- **WARNING:** If a strong ozone odour is detected when the SoClean is operating, turn the SoClean 2 off by disconnecting the AC power adapter and inspect the SoClean 2 for visible damage, such as cracks in the enclosure or tubing along with tubing connections.
- **WARNING:** Do not route your PAP hose through both Hose detect slots while or after using your PAP. This may result in the SoClean device running at an unexpected time.

YOUR HEALTH AND OZONE SAFETY

Precautions for beneficial use of the SoClean 2

- Ozone, the triatomic form of oxygen (O₃), is known as activated oxygen.
- Ozone is an effective, invisible disinfectant.
- The SoClean 2 uses ozone to disinfect Positive Airway Pressure (PAP) equipment; ozone contacts the PAP equipment only, not the user.
- The SoClean 2 is designed to produce only enough ozone for effective disinfection of your PAP equipment.
- While breathing large amounts of ozone can irritate breathing passages of humans, following the instructions for use ensures that SoClean 2 users will not breathe in large amounts of ozone.
- Ozone quickly dissipates in the atmosphere. If you accidentally interrupt the disinfecting cycle and release ozone by opening the Disinfecting chamber before the end of the disinfecting cycle, simply step away from the SoClean 2 to avoid unintended exposure.
- The smell of ozone is detectable at low concentrations by some people. The scent of ozone is similar to a sweet chlorine-like smell.
- If you smell ozone and believe the SoClean device is not operating correctly, disconnect the power to the device and contact SoClean.

WARNING: If a strong ozone odour is detected when the SoClean is operating, turn the SoClean 2 off by disconnecting the AC power adapter and inspect the SoClean 2 for visible damage, such as cracks in the enclosure or tubing along with tubing connections.

WARNING: Discontinue use if acne or a rash develops along the mask contact line and call SoClean customer care.

CLASSIFICATION, MANUFACTURER

Classification

EC/EU MDD Class IIa according to 93/42/EEC Annex IX Rule 15 – Device is intended to disinfect medical devices.

Designed by and manufactured for: SoClean, Inc., 12 Vose Farm Road, Peterborough, New Hampshire 03458 USA

FCC Notice

Please note that changes or modifications not expressly approved by the party responsible for compliance could void the user's authority to operate the equipment.

NOTE: This equipment has been tested and found to comply with the limits for a Class B digital device, pursuant

to Part 18 of the FCC Rules. These limits are designed to provide reasonable protection against harmful interference in a residential installation. This equipment generates, uses and can radiate radio frequency energy and, if not installed and used in accordance with the instructions, may cause harmful interference to radio communications. However, there is no guarantee that interference will not occur in a particular installation. If this equipment does cause harmful interference to radio or television reception, which can be determined by turning the equipment off and on, the user is encouraged to try to correct the interference by one or more of the following measures:

- Reorientate or relocate the receiving aerial.
- Increase the separation between the equipment and the receiver.
- Connect equipment into an outlet on a circuit different from that to which the receiver is connected.
- Consult the dealer or an experienced radio/TV technician for help.

INCLUDED WITH YOUR SOCLEAN 2

Number	Part name	SKU	Description
1	Removable hose slot plug	PN1214	This allows you to set up the SoClean 2 device on either the right or left side of your PAP machine. Place this plug in the hose slot that you don't use.
2	Disinfecting chamber	N/A	Place your mask in here when you wake up. Close the lid to ensure that the daily automated disinfecting cycle runs.
3	Lid gasket	PN1215	Ensures a tight seal around the Disinfecting chamber when the SoClean 2 lid is closed. Do not close the lid without this part in place.
4	SoClean lid	N/A	Close the lid after you place your mask in the Disinfecting chamber to ensure that the daily automated disinfecting cycle occurs.
5	Cartridge filter	PN1207UNI	This Cartridge filter converts ozone back into normal oxygen. Remove outer plastic wrapper and blue tape prior to installation. You can repurchase the filter along with the Check valve as part of the Cartridge filter kit.
6	Hose detect switch	N/A	The Hose detect switch detects when the SoClean 2 is configured for operation by detecting the presence of the hose in the hose slot when the lid is closed. If no hose is detected, the SoClean 2 will not run a disinfecting cycle. Hose detect switch operation can be inspected by gently pushing down and releasing the grey plastic switch and hearing an audible click. The switch should move freely down and up when pressed gently.
7	Neutralising pre-wash	PN1101	The Neutralising pre-wash removes any material or odour that could react with ozone. Wash your PAP equipment following the PAP manufacturer's instructions before connecting the SoClean 2 device, or when you receive a new mask, hose or reservoir.

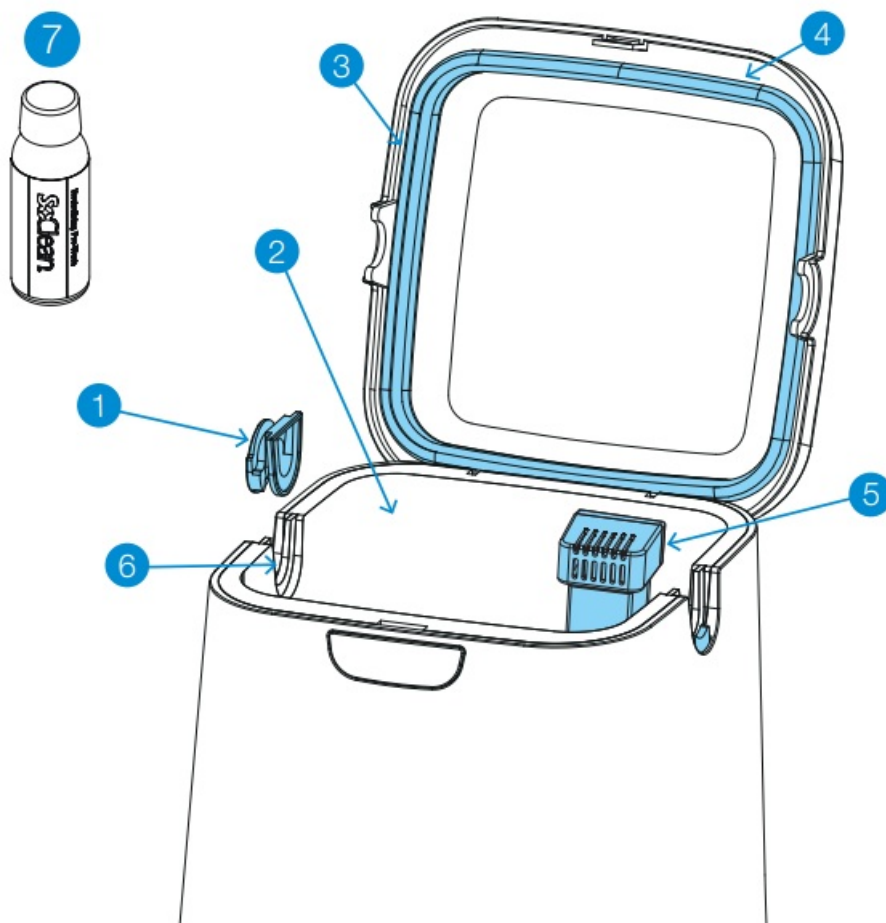

cc	Part name	SKU	Description
8	Control panel	N/A	Buttons, display and cycle light indicator for SoClean functions. See page 10 for details.
9	Injection hose A and B	PN1104.12	The Injection hose A and B carries ozone from the SoClean device to the PAP machine. See page 16.
10	Check valve	PN1102A	This item comes pre-installed into the Injection hose. It is a one-way Check valve that prevents water in your humidifier reservoir from backing up and entering your SoClean device. If you can see water in this clear tube, replace the check valve assembly immediately. You can repurchase it along with the Cartridge filter as part of the Cartridge filter kit.
11	Injection fitting	PN1106 (with humidifier reservoir) PN1116 (without humidifier reservoir – not included)	Connects the Injection hose A and B to your PAP machine. See page 15.
12	AC adapter	PN1222UNI	Supplies power to your SoClean 2. See page 16.

Replacement Parts

You will replace some SoClean parts regularly due to normal wear and usage. A message appears on your SoClean after a certain amount of use (typically around six months) as a reminder to replace the Cartridge filter and Check valve. These two parts are ordered as a set called the Cartridge filter kit (PN1207UNI).

The Neutralising pre-wash (PN1101.8) is also available for purchase if you run out. Follow your PAP manufacturer's instructions for cleaning your PAP equipment.

To reorder supplies, contact your authorised reseller or visit [SoClean.com](https://www.soclean.com) and search for the desired part.

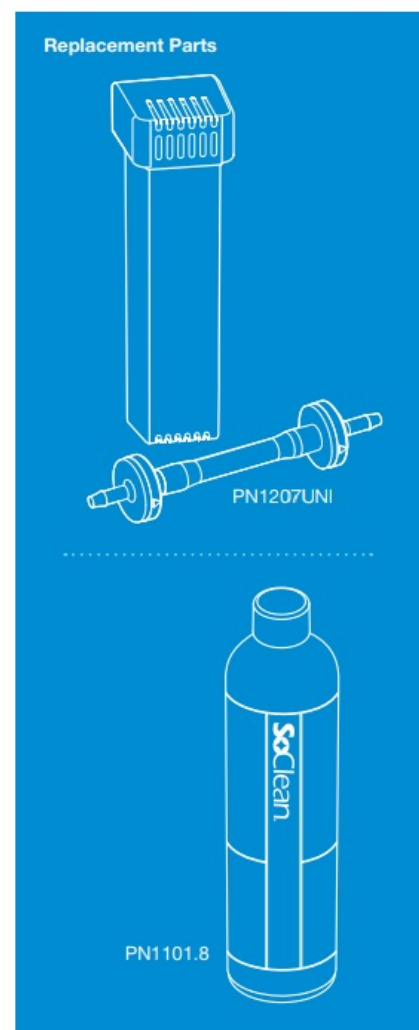
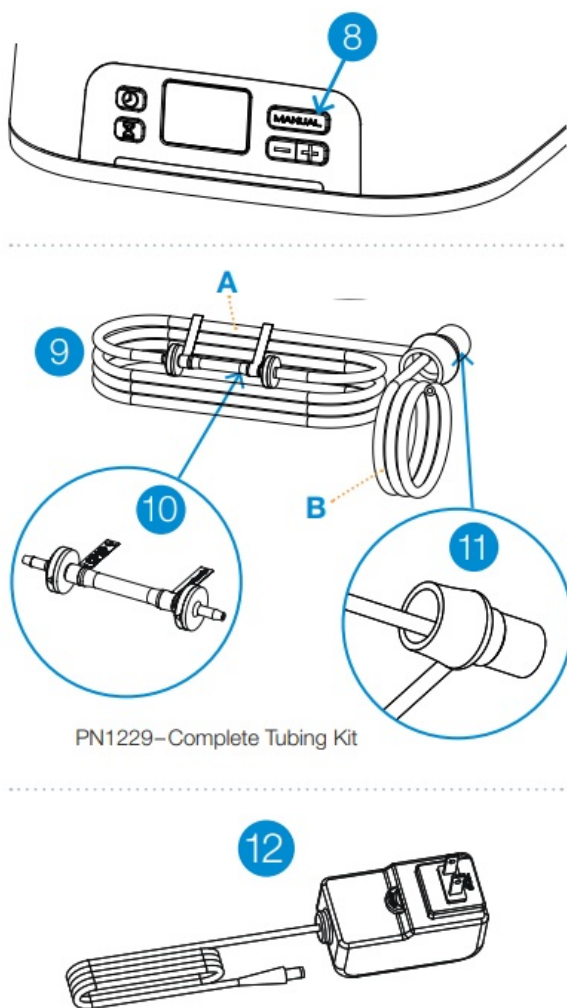

WARNING: Please purchase your Cartridge filter kits from SoClean® only. Authentic Cartridge filter kits can be purchased from SoClean via multiple online marketplaces, such as Amazon® and eBay® in addition to SoClean.com. However, please confirm that the seller of your Cartridge filter kit is SoClean, and not any other seller, to ensure the authenticity of your Cartridge filter kit. SoClean has discovered counterfeit Cartridge filter kits being sold, particularly on Amazon® and eBay®, with check valves and filters that leak and can cause damage to your SoClean machine or to your property due to water leakage from the counterfeit check valves. Please contact SoClean immediately if you have had any issues with your Cartridge filter kit. Amazon® is a registered trademark owned by Amazon Technologies, Inc. eBay® is a registered trademark owned by eBay, Inc. SoClean® is a registered trademark owned by SoClean, Inc.

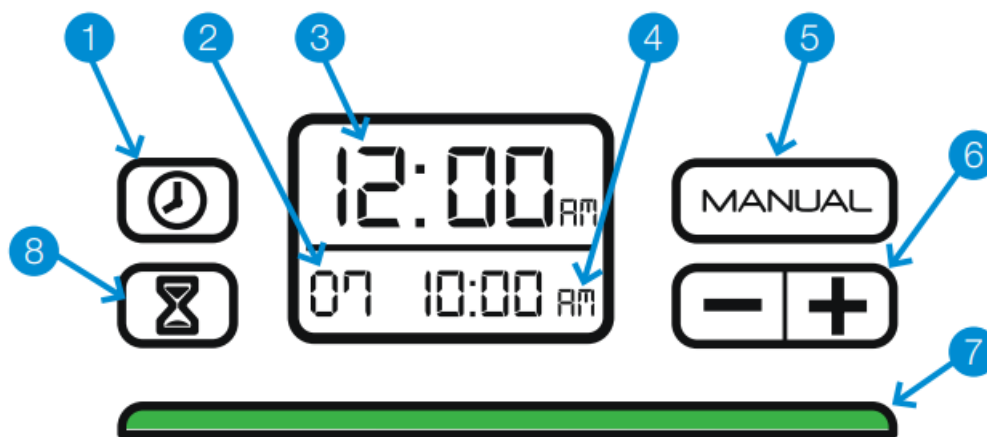

SOCLEAN 2 CONTROL PANEL



WARNING: In the event of loss of power to your home or the SoClean 2, ensure that the correct clock time and cycle start time are set on your SoClean 2 before using your PAP machine. Failure to do so may result in the SoClean 2 operating at an unexpected time.

Number	Button(s)/Display	Description
1		Sets the clock. See page 19.
2	Disinfecting cycle length	The length, in minutes, of the disinfecting cycle. See page 20 to set this. The default disinfecting cycle length is set to 7 minutes.
3	Current time	The current time. See page 19 to set. The default time is set to 12:00 am.
4	Daily disinfecting start time	The time when the daily disinfecting cycle starts. See page 20 to set the schedule. The default disinfecting cycle start time is set to 10:00 am.
5		Starts a disinfecting cycle immediately. The scheduled disinfecting will still occur. See page 21.
6		Decreases (-) or increases (+) time.

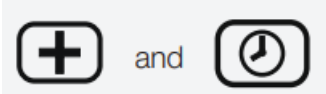
Number	Button(s)/Display	Description
7	Status light	<p>The light below the display indicates the disinfecting cycle status. See pages 19, 20 and 21 for instructions on scheduling and manual operation. A green light indicates that disinfecting is complete, and you can remove your PAP mask from the SoClean Disinfecting chamber and use your PAP machine.</p> <p>RED – The SoClean is operating and generating ozone.</p> <p>YELLOW – The two-hour disinfecting cycle is still active. The ozone is working and dissipating.</p> <p>GREEN – The disinfecting cycle is complete. You can use your PAP machine any time. The light turns off when you open the lid.</p>
8		Sets daily disinfecting start time. See page 20.
		Changes clock between the 24-hour or 12-hour format. See page 19.

Messages

The SoClean display panel shows messages that may require action. This list shows the messages and how to correct them:

Message	What to Do
Hose not present. Cycle will not run.	Ensure that the PAP hose is seated securely in the hose slot. Check that the Removable hose slot plug is seated correctly on the other side. See page 22.
Order filter kit.	Your Cartridge filter has reached the end of its life based on your use. See page 25.
Disinfection in process. Do not open the lid!	Ozone present. The SoClean 2 is performing disinfection. This takes approximately two hours. The green cycle indicator light means that disinfection is complete. You can then open the lid, take out your mask and use your PAP machine.

KEY PAP PARTS

The SoClean device is designed to connect permanently to your PAP machine and enable operation of either product.

The SoClean device connects to most PAP machines using the standard included parts. This section describes key parts of your PAP machine in the connection procedure. The figure on the next page shows a generic representation of these key parts.

Some PAP machines have features that require additional steps or parts. Adapters required for SoClean to

function with your PAP contain appropriate instructions. See page 17 for a list of available adapters for specific PAP machines.

See [SoClean.com](https://www.soclean.com) for additional instructions for specific PAP machines.

These are the typical parts of a PAP machine that are referenced in the SoClean connection procedures. These are only representations: your actual PAP machine can look different from these drawings. Review the documentation that came with your PAP machine for a better idea of what these parts look like.

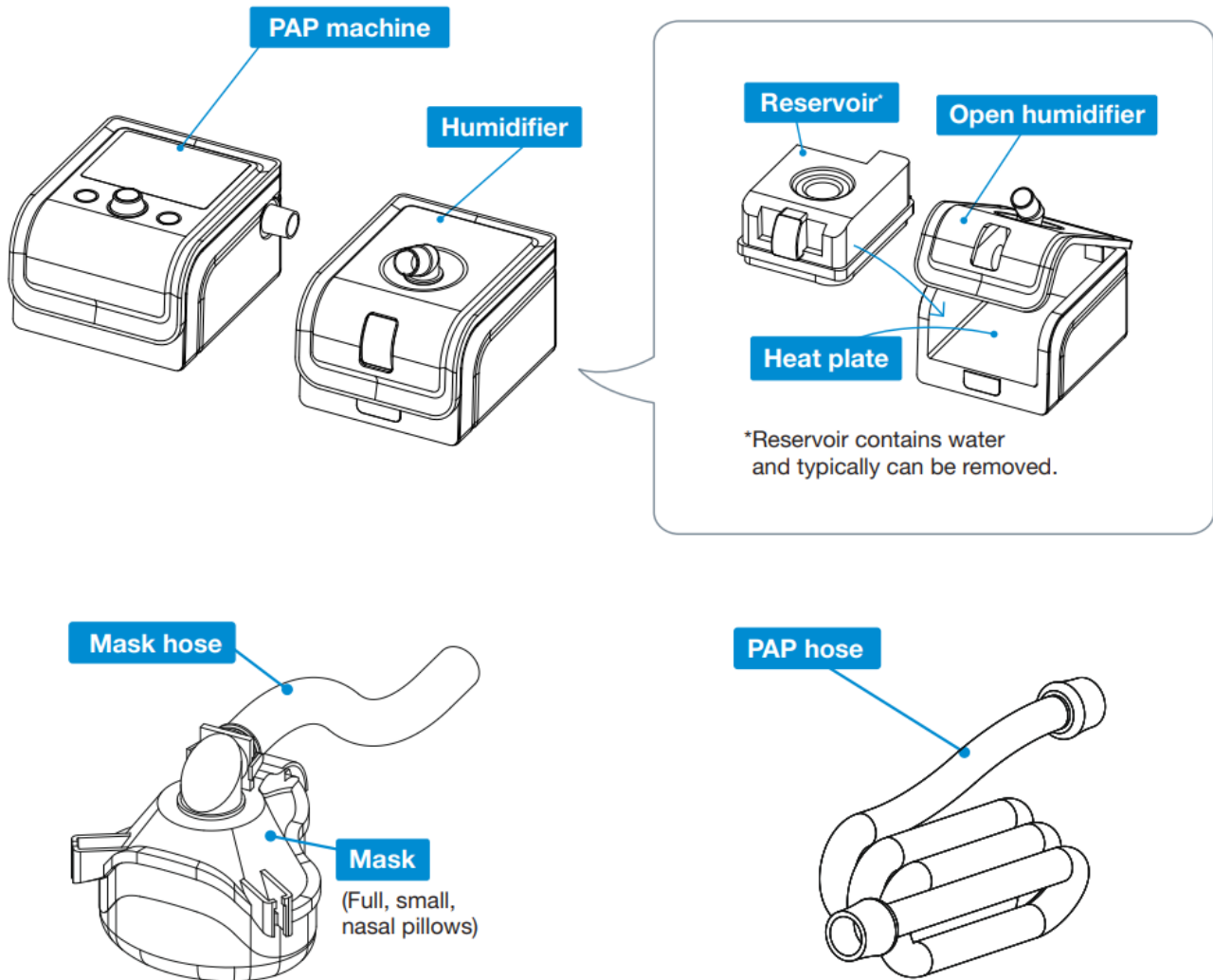

CONNECTION STEPS

After following these steps, your SoClean 2 will disinfect your PAP machine daily without disconnecting. Before you disconnect your PAP machine to wash the parts, look at where the PAP hose is connected. You will reconnect the SoClean Injection fitting to the same location.

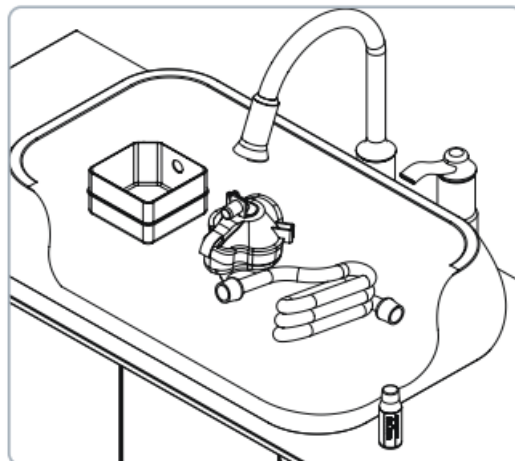

Figure 1. Disassemble and Wash PAP Equipment

Please note, SoClean devices do not replace proper cleaning and maintenance of the PAP device according to the manufacturer's instructions

Pre-wash PAP equipment

Disconnect your PAP mask, hose and reservoir from the PAP machine.

Use two capfuls of the included Neutralising prewash with 4 litres (1 gallon) of water to wash your PAP equipment (mask, hose and reservoir) according to the manufacturer's instructions (Figure 1).

Rinse thoroughly with clean water.

Reinsert the reservoir (if used) into the PAP machine.

Do not reattach the hose or mask yet.

CAUTION: Do not place Neutralising pre-wash in the SoClean 2 Disinfecting chamber or PAP reservoir.

Neutralising pre-wash is for cleaning your PAP equipment only.

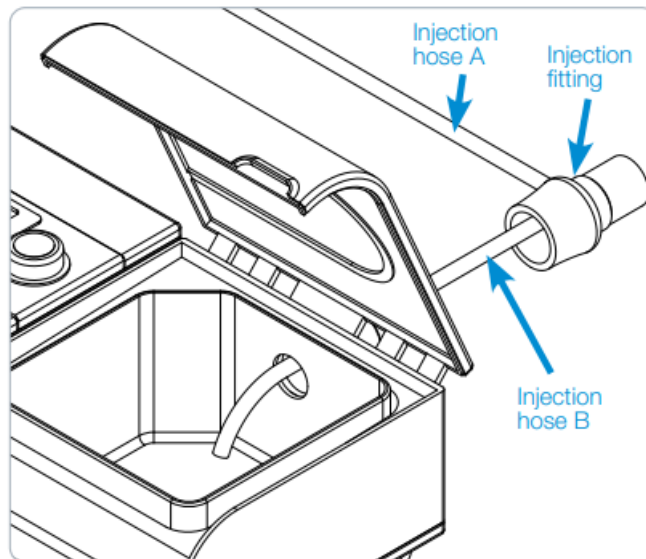

Figure 2. Connect the Injection fitting

Using an adapter

If your PAP machine requires an adapter, see adapter instructions for set-up and proceed to Step 5.

Connect the Injection fitting

The Injection fitting connects the SoClean 2 to your PAP machine. Once installed, you do not need to disconnect the Injection fitting to use your PAP. The SoClean 2 is intended to stay continuously connected to your PAP machine.

Note: Your PAP reservoir model may require additional configuration procedures or an adapter. If you have difficulty with the steps in this guide, visit:

[SoClean.com](https://www.soclean.com) for information on various models.

With humidifier:

1. Position the Injection fitting onto the port of your humidifier (where your PAP hose was connected), allowing the smaller Injection hose B to enter into the reservoir (Figure 2). The end of the tubing should be positioned over the heat plate.
2. If necessary, carefully trim the Injection hose B in increments until it is the correct length, and over the heat plate.

For additional help in connecting to your specific machine, please visit our support pages at: [SoClean.com](https://www.soclean.com)

Without humidifier:

1. Pull off the small Injection hose B from the inside of the Injection fitting.

Note: If you are having difficulty disconnecting Injection hose B, you may cut the tubing as close to the Injection fitting as possible.

2. Attach the Injection fitting directly to your PAP machine.
3. Reconnect your PAP hose to the end of the Injection fitting.

CAUTION: Please ensure that the black Injection hose from the back of the SoClean 2 is connected to your PAP before operating your SoClean 2.

b If you are having difficulty connecting to your PAP, an additional part may be necessary. Contact [SoClean.com](https://www.soclean.com).

Connect the PAP hose

Regardless of your humidifier, you can now connect your PAP hose to the end of the Injection fitting, which is connected to your PAP machine (Figure 3).

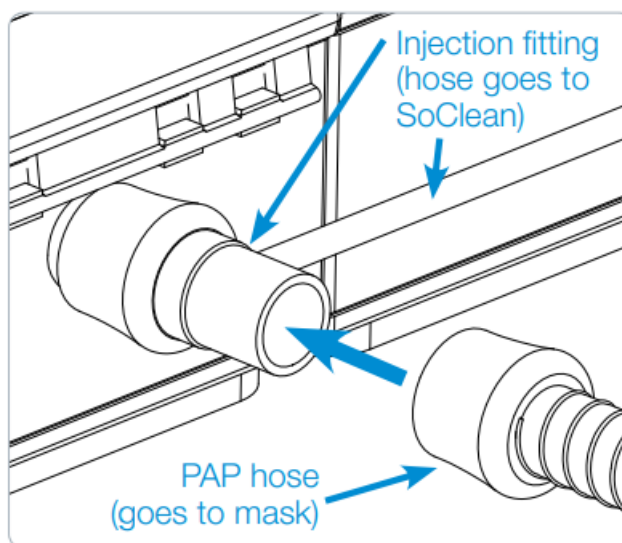

Figure 3. Connect PAP hose to Injection fitting

Connect power

Plug the AC adapter into the connector marked DC 12V, 1.5A on the back of the SoClean 2. The AC adapter should be plugged into a wall outlet that is easy to access and observe (Figure 4).

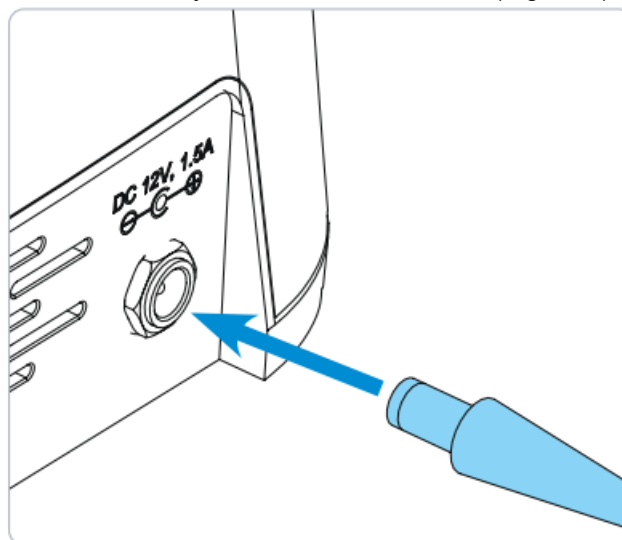

Figure 4. Connect AC power

WARNING: In the event of loss of power to your home or the SoClean 2, ensure that the correct clock time and cycle start time are set on the SoClean 2 before using your PAP machine. Failure to do so may result in the SoClean device operating at an unexpected time.

Reconnect PAP equipment

You can now reattach the mask to the end of the PAP hose.

SUPPORTED PAP MACHINES AND ADAPTERS

The following PAP machines have adapters available from SoClean.

To order, go to: Your authorised reseller or [SoClean.com](https://www.soclean.com).

Manufacturer	Model	PN
Fisher & Paykel	ICON	PNA1100i
	SleepStyle 600 Series	PNA110i-600
	SleepStyle	PNA1411
Löwenstein Medical	prisma	PNA1116
	SOMNObalance	PNA1116
	SOMNOsoft 2	PNA1116
Philips Respironics	DreamStation	PNA1410
	PR System One REMstar 60 Series	PNA1410
	PR Systems One REMstar	PNA1410
	DreamStation Go	PNA1214
ResMed	S9	PNA1109
	AirSense10	PNA1210
	AirMini	PNA1214
Transcend & Z1	Works with all models	PNA1213

***Note:** This list and adapter availability are based on information as of March 2019. If there is any PAP equipment that needs an adapter and it is not listed here please visit [SoClean.com](https://www.soclean.com) or contact your authorised reseller.





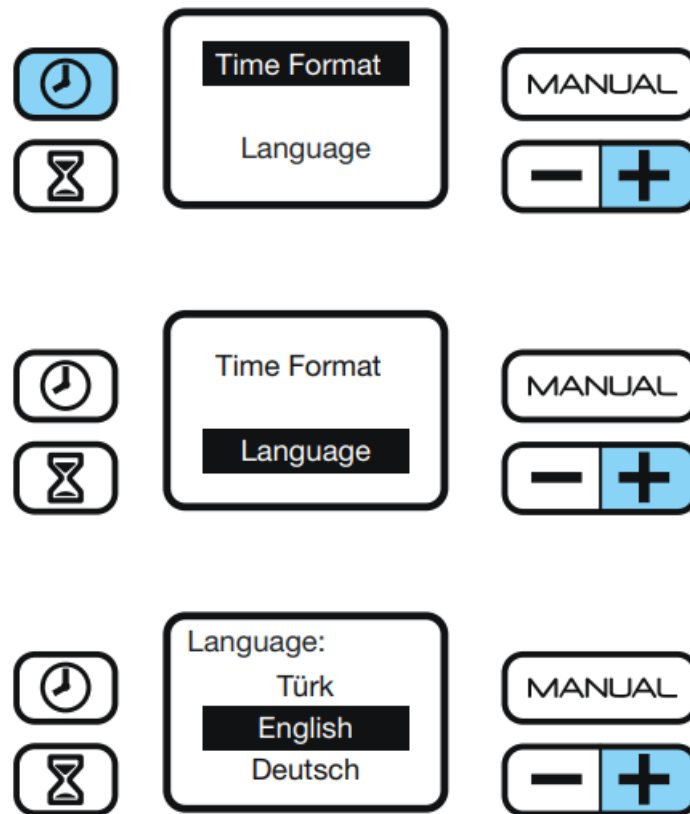

SoClean is an independent company not affiliated with Aeiomed, Apex Medical, Carefusion, Fisher & Paykel, Philips Respironics, PMI Probasic, Puritan Bennett, RESmart, ResMed or Transcend. Names and associated trademarks are solely owned by the respective companies and manufacturers. Depictions of brand logos on our website are for informational and educational purposes only and are used for customer equipment recognition. We are not affiliated or endorsed by any PAP equipment manufacturer.

SET LANGUAGE

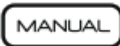

Language

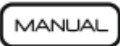
To choose the correct language:

1. Press the  and buttons  simultaneously.
2. Choose 'Language' by using the  button.
3. With 'Language' selected, press the  button
4. Scroll through language options by using the  button.
5. Press the  button to select your language of choice.
6. Press the  button to save.

SET CLOCK AND DISINFECTING SCHEDULE



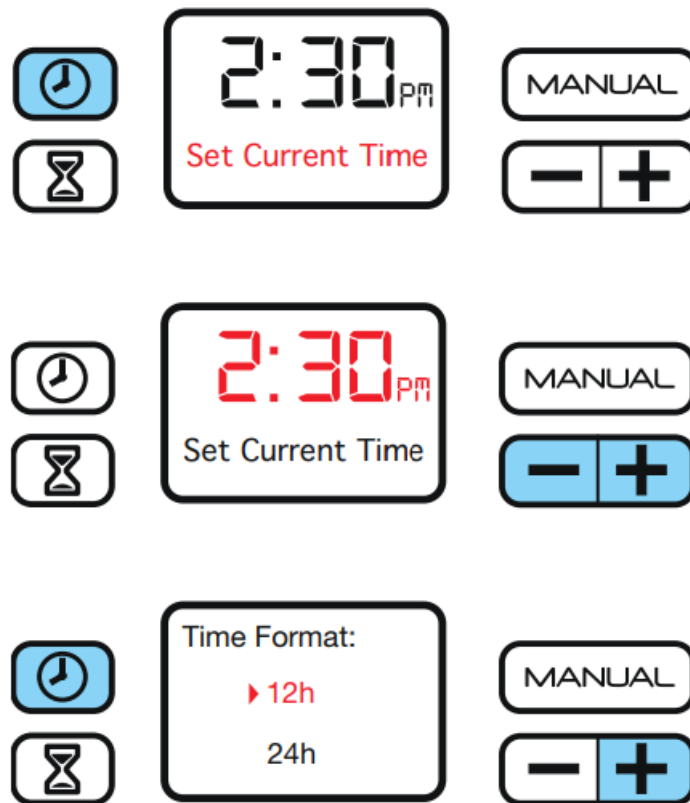

WARNING: Ensure that the correct clock time and cycle start time are set on your SoClean 2 before using your PAP machine. Pay particular attention to the AM/PM setting if using the 12-hr mode. Failure to do so may result in the SoClean device operating at an unexpected time.

WARNING: In the event of loss of power to your home or the SoClean device, ensure the correct clock time and cycle start time are set on your SoClean 2 before using your PAP machine. Failure to do so may result in the SoClean 2 operating at an unexpected time.

If you unplug the SoClean 2 or experience a power loss, you will need to reset the current time only. The disinfecting settings will remain saved. For safe use, operate your SoClean 2 only as instructed in this guide. Your SoClean 2 timer allows you to completely automate your daily disinfecting after connecting to your PAP. The SoClean comes preset to start a 7-minute disinfecting cycle at 10:00 am daily. However, you must set the clock to your current time. The following procedures describe how to set the clock, schedule the daily disinfecting and start a disinfecting cycle immediately.









Set the clock

1. Press the  button.
2. Change the time by pushing either the  or  button until your current time is reached. By holding down the button the time moves faster. Press the button  once more to store your time and return to the home screen.



24-Hour clock

To display in 24-hour format (military time):





1. Press the  and  buttons simultaneously.
2. With 'Time format' selected, press the  button
3. Choose either the 12- or 24-hour format by using the  button.
4. Press the  button to select preferred setting.
5. Press the  button to save.

Set cycle length/Schedule the daily disinfecting

These two processes follow each other in this set-up.

1. Press the  button.
2. Press the  or  button to decrease or increase the number of minutes of your cycle time.

Note: The default run time of 7 minutes should be sufficient to disinfect your PAP equipment.

3. Press the button again to save your cycle length and schedule the cycle start time. To skip the start time set-up, press the button  again when you reach button again when you reach
4. Press the  or  buttons to reach the desired start time. Press the  button again to save and return to the home screen.

Note: Schedule a start time at least two hours before you need to use the PAP machine. The entire disinfecting cycle requires two hours plus the disinfecting time to complete. A green indicator light means that the cycle completed.



Manual mode

Use this mode to disinfect your equipment immediately. The automated daily disinfecting will still occur if your PAP equipment is stored in the Disinfecting chamber.

Ensure that your PAP equipment is in place and the SoClean lid is closed.

1. Press the  button to begin the disinfecting cycle.

The disinfecting cycle starts immediately and runs for the set cycle time.

As with your normal disinfecting procedure, wait for the green light before removing your mask. It's not necessary to remove your mask immediately after observing the green light.

USING YOUR SOCLEAN 2

After set-up, using your SoClean 2 is extremely easy. After following the connection procedure on page 14 your SoClean 2 disinfects your PAP equipment daily.

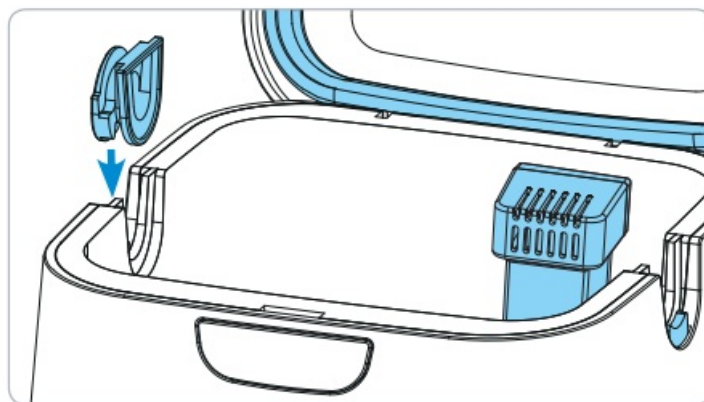

Figure 6. Install Removable hose slot plug

WARNING: Do not physically alter the Hose detect switches on your SoClean 2. Inspect the Hose detect switches regularly for damage or inability to move up/down.

Failure of the Hose detect switch on your SoClean 2 may result in the SoClean operating at an unexpected time.

1. Open the lid.
 2. Install the Removable hose slot plug into one open slot (Figure 6).
Orientate the Removable hose slot plug as shown in Figure 6.
 6. The round face of the Removable hose slot plug is on the outside of the SoClean 2.
- Note:** Your mask and PAP hose can be inserted from either side of the SoClean 2. To change sides, remove the Removable hose slot plug by lifting it straight out, and insert it into the slot on the opposite side
3. Remove outer plastic wrapper and blue tape from the Cartridge filter and fully seat it into the Cartridge filter slot at the back-right corner of the Disinfecting chamber.
 4. Insert your mask into the Disinfecting chamber, allowing its attached PAP hose to rest in the open hose slot, opposite the Removable hose slot plug (Figure 7).
 5. Close the lid with the PAP hose placed in the open slot (Figure 8). The SoClean will now automatically operate according to its preset time and duration.
- Note:** The SoClean won't operate without the mask and hose present in the closed Disinfecting chamber. Additionally, the SoClean will not operate if the Removable hose slot plug is missing or improperly seated.
3. Remove outer plastic wrapper and blue tape from the Cartridge filter and fully seat it into the Cartridge filter slot at the back-right corner of the Disinfecting chamber.
 6. Insert your mask into the Disinfecting chamber, allowing its attached PAP hose to rest in the open hose slot, opposite the Removable hose slot plug (Figure 7).
 7. Close the lid with the PAP hose placed in the open slot (Figure 8). The SoClean will now automatically operate according to its preset time and duration.
- Note:** The SoClean won't operate without the mask and hose present in the closed Disinfecting chamber. Additionally, the SoClean will not operate if the Removable hose slot plug is missing or improperly seated.

WARNING: Keep the SoClean lid closed until the green status light illuminates (approximately two hours after completion of the disinfecting cycle). It is necessary to let the mask remain in the closed Disinfecting chamber for at least two hours to ensure that the ozone performs its disinfection function and dissipates appropriately. After that period, the status light shines green and the mask is ready to be removed from the Disinfecting chamber. Ozone quickly dissipates into the atmosphere. If you accidentally interrupt the disinfecting cycle and release ozone by opening the Disinfecting chamber lid, simply step away from the SoClean 2 for 5 minutes to avoid unintended exposure. Note: Your PAP equipment will not be fully disinfected if you interrupt the disinfecting cycle; therefore, it is recommended that you restart the cycle.

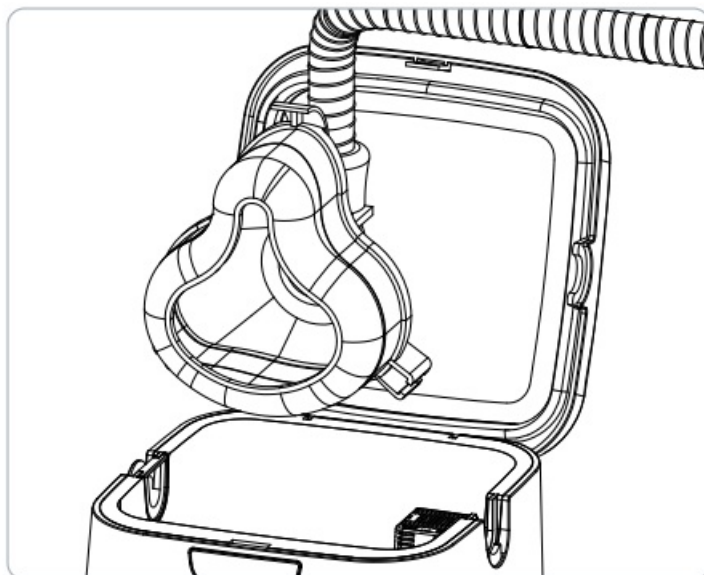

Figure 7. Put PAP mask into Disinfecting chamber

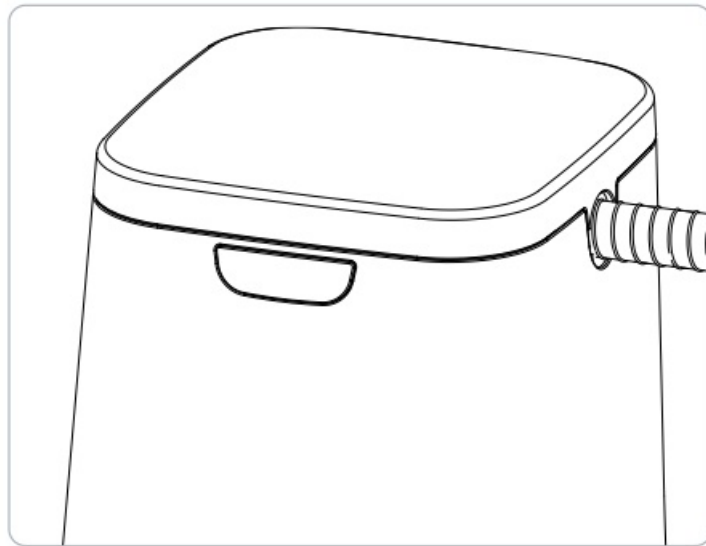

Figure 8. Closed lid with PAP mask inside

Once the cycle has completed (status light will be green), open the lid and remove the PAP mask. Remove the Removable slot plug and place inside the SoClean Disinfecting chamber.

Tip: Placing the Removable slot plug into the Disinfecting chamber helps prevent accidental loss of the Removable slot plug.

Ozone is a gaseous disinfectant that naturally break down after it is generated. The SoClean is designed to safely contain ozone within the system and has a catalyst Cartridge filter inside the Disinfecting chamber to convert ozone back to oxygen

WARNING: Do not route your PAP hose through both Hose detect slots while or after using your PAP. This may result in the SoClean device running at an unexpected time

CARE AND MAINTENANCE OF YOUR SOCLEAN 2 DEVICE

Wipe down the SoClean 2 with a damp cloth. The Neutralising pre-wash should only be used to clean your PAP equipment following the manufacturer's instructions.

WARNING: Do not submerge or fill the SoClean device with water!

The SoClean Check valve and Cartridge filter should be replaced every 6 months. A reminder message on the display will appear after approximately six months, depending on usage.

To reorder supplies (Cartridge filter, Check valve or Neutralising pre-wash), contact your authorised reseller or visit [SoClean.com](https://www.soclean.com) and search for the desired part.

If the SoClean has been dropped or visibly damaged, or if cracks in the tubing or enclosure are noticed, stop using the SoClean and contact Customer Service.

Please purchase your Cartridge filter kits from SoClean® only. Authentic Cartridge filter kits can be purchased from SoClean via multiple online marketplaces, such as Amazon® and eBay® in addition to SoClean.com. However, please confirm that the seller of your Cartridge filter kit is SoClean, and not any other seller, to ensure the authenticity of your Cartridge filter kit. SoClean has discovered counterfeit Cartridge filter kits being sold, particularly on Amazon® and eBay®, with check valves and filters that leak and can cause damage to your SoClean machine or to your property due to water leakage from the counterfeit check valves. Please contact SoClean immediately if you have had any issues with your Cartridge filter kit.

FAQS

1. Will my PAP equipment be wet from the SoClean?

No. The SoClean 2 destroys 99.9% of PAP germs, bacteria and other pathogens with ozone. No fluids or water

are used in this process.

2. Is the SoClean harmful to me or the environment?

No. The SoClean 2 ozone technology is also used on fruit and vegetable produce and drinking water. The SoClean 2 produces ozone in a closed system and includes a Cartridge filter which converts ozone back to regular oxygen. The ozone disinfects your equipment and naturally breaks down to regular oxygen completely within two hours.

3. How do I know that my SoClean 2 is operating properly?

After the disinfecting cycle has successfully completed, the status indicator light will illuminate green. Your PAP equipment will have a light, clean scent.

4. What if the scent the SoClean 2 leaves is too strong for me?

Wash your equipment with the Neutralising pre-wash. Do not use scented detergents as they can react with the ozone and produce undesirable odours. If the device still produces a strong odour, you may try any of these steps:

- Before wearing your mask at bedtime, run your PAP for 20 seconds to allow any residual scent to blow out.
- Schedule the machine to run earlier in the day, allowing any residual scent to dissipate by nighttime.
- Increase the cycle duration time up to 12 minutes for a few days. A strong odour can indicate a high amount of oxidised organics, such as scented detergent. A longer cycle can remove these organics completely. You can reduce the cycle time back down if the above has helped to reduce the odour.

5. What if my indicator light is shining red or yellow?

This means that the disinfecting cycle is not yet complete. Wait until the light turns green to remove your PAP equipment from the SoClean 2 Disinfecting chamber (see page 11).

6. It has been more than two hours since the SoClean completed a cycle, but the status light is still yellow. Why?

Some types of indoor lighting make it difficult to distinguish the yellow and green lights on the SoClean 2. Confirm that the green light is visible before opening your SoClean 2 to ensure that a disinfecting cycle is complete, and your PAP equipment is disinfected and ready for use.

7. What if the indicator light is off after a scheduled disinfecting time?

The SoClean 2 is green when a disinfecting cycle completes successfully. If there is no light, the cycle did not start.

Common reasons for this are that the lid was not securely closed, there was no mask in the Disinfecting chamber at disinfecting time or the Removable hose slot plug is missing or not properly seated (see page 22). If everything look good, then close the lid and press the button to test. Any error message will appear on the screen (see page 11 for error messages).

8. What if I missed my scheduled disinfecting time, but still wish to disinfect my equipment?

You can use the Manual function to run a cycle (see page 21).

For warranty information visit SoClean.com/warranty.

For further questions or concerns, visit our website: SoClean.com

9. Why does my display say Order filter kit?

This message appears approximately every 6 months, depending upon usage, as a reminder to regularly replace the Cartridge filter and Check valve. These parts wear out due to regular use. You can purchase the Cartridge filter and Check valve together in a Cartridge filter kit (PN1207). To reorder, contact your authorised

reseller or visit [SoClean.com](https://www.soclean.com). 10. Are there materials that I should avoid putting into the SoClean? The SoClean device is designed to disinfect only your PAP equipment. Nylon and natural rubber break down when exposed to ozone. PAP manufacturers typically do not use these materials in their reservoirs, hoses, masks or headgear. If you have questions, contact your PAP manufacturer, supplier or SoClean.

10. My mask feels oily, what should I do?

Skin chemistry is unique. Individuals with an oily skin type should hand-wash the mask as recommended by the manufacturer. You may use the provided Neutralising pre-wash or wipe your mask with SoClean's mask wipes.

11. How often should I wash my PAP equipment

PAP equipment should be washed as recommended by the manufacturer. You may use the provided Neutralising pre-wash.

12. If I lose power, do I need to reset my SoClean?

In the event of loss of power to your home or the SoClean 2, ensure the correct clock time and cycle start time are set on your SoClean 2 before using your PAP machine. Failure to do so may result in the SoClean device operating at an unexpected time. See page 19 for instructions on how to set your clock and cycle start times.

Documents / Resources

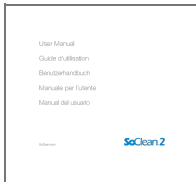
	SoClean 2 Automated PAP Disinfecting System [pdf] User Manual 2 Automated PAP Disinfecting System, 2 Automated PAP System, Disinfecting System, Automated PAP System, Automated PAP
--	--

References

- [SoClean | Bettering Lives Through the Power of A Better Clean](#)
- [US SoClean Patents](#)
- [SoClean 3 Warranty Registration | SoClean US](#)