

**socket mobile 800 Series
Battery Replacement**



socket mobile 800 Series Battery Replacement Instructions

[Home](#) » [socket mobile](#) » socket mobile 800 Series Battery Replacement Instructions 

Contents

- [1 socket mobile 800 Series Battery Replacement](#)
- [2 Replacement Instructions](#)
- [3 Specifications](#)
- [4 FAQ](#)
- [5 Documents / Resources](#)
 - [5.1 References](#)
- [6 Related Posts](#)



socket mobile 800 Series Battery Replacement



Replacement Instructions

Step 1: Remove Battery Door

Press the release latch and lift the battery cover.

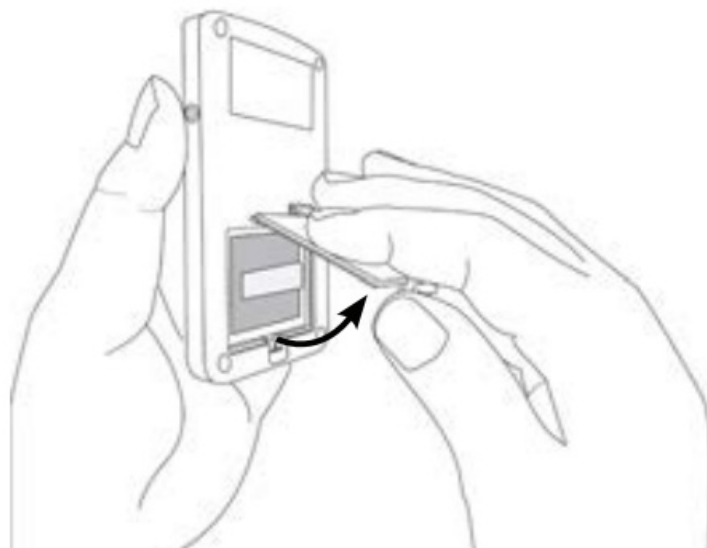

Step 2: Remove Old Battery

Pull the plastic pull tab to expose the connector on the top right. Then gently pull the connector to remove the old battery.

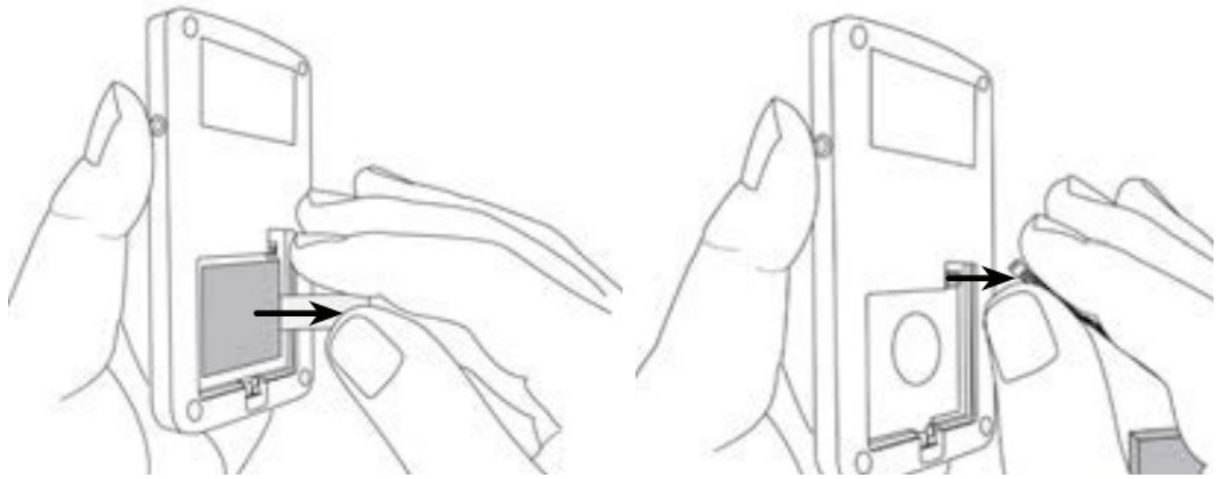

Step 3: Insert New Battery

Insert the connector back in place. With the adhesive side down, insert the battery and make sure the pull tab is facing out.

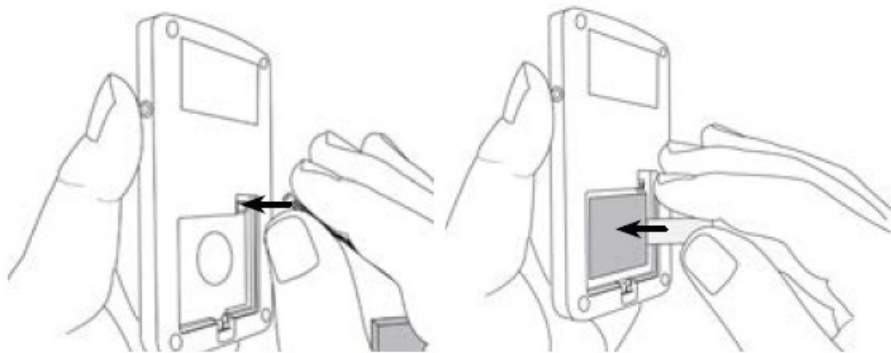

Step 4: Secure Battery Door

Replace the battery cover.

Specifications

- **Model:** 800 Series
- **Compatibility:** Compatible with specified battery model
- **Release Date:** September 2021
- **Part Number:** 6430-00416

FAQ

Q: How often should I replace the battery?

A: It is recommended to replace the battery every [specified time period] or when performance issues are noticed.

Q: Can I use third-party batteries with this product?

A: To ensure optimal performance and safety, it is recommended to use only batteries specified for use with this product.

Documents / Resources

