

SNR-S5210X-8F
Managed L2
Plus Ethernet
Switch



SNR-S5210X-8F Managed L2 Plus Ethernet Switch Installation Guide

[Home](#) » [SNR](#) » SNR-S5210X-8F Managed L2 Plus Ethernet Switch Installation Guide 

Contents

- [1 SNR-S5210X-8F Managed L2 Plus Ethernet Switch](#)
- [2 Product Specifications](#)
- [3 Product Usage Instructions](#)
 - [3.1 Switch Installation](#)
 - [3.2 Access to Initial Switch Configuration](#)
- [4 Front and back panel description](#)
- [5 Switch installation](#)
- [6 Access to initial switch configuration](#)
- [7 Technical support](#)
- [8 Frequently Asked Questions \(FAQ\)](#)
- [9 Documents / Resources](#)
 - [9.1 References](#)
- [10 Related Posts](#)



SNR-S5210X-8F Managed L2 Plus Ethernet Switch

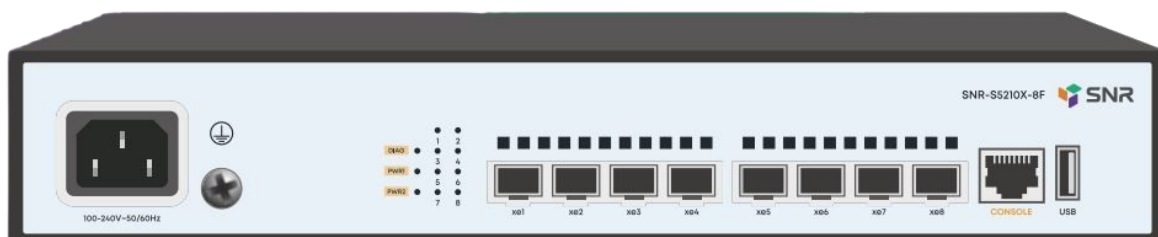

Product Specifications

- **Model:** SNR-S5210X-8F
- **Type:** Managed L2+ Ethernet Switch
- **Power Input:** 100-240V AC, 50/60Hz
- **Port Configuration:** 8 x 1/10GBase-X SFP+
- **Console Port:** Yes
- **USB Port:** Yes

Product Usage Instructions

Front and Back Panels Description:

Refer to the user manual for detailed information on the front and back panel descriptions.

Switch Installation

Install the Device:

Before installation, take ESD-preventive measures. Install the device in a 19" cabinet or on a worktable with proper spacing for heat dissipation.

Connect Cables:

Connect the PGND cable and power cable to the switch. Power on the switch after making the connections.

Access to Initial Switch Configuration

Access via Console Port:

Connect console cable to the switch via RJ-45 connector and to the PC's RS-232 port. Use default credentials (admin/admin) to access the switch.

Access via Ethernet Port:

Connect the switch to the PC NIC interface. Check IP address compatibility and open a telnet connection to the switch's default IP address (192.168.1.1).

Technical Support

- Contact NAG service and technical support center for assistance.
- **Address:** Office M-03, Al Garhoud BusinessCenterr Building, UAE,
- Dubai
- **Website:** [Snr.g global](http://snr.gglobal)
- **Technical Support Portal:** snr.support
- **Tel:** +971 0 42599967

This guide describes the steps of installing the switch, including the basic introduction to the product, the basic installation steps, etc.

Front and back panel description

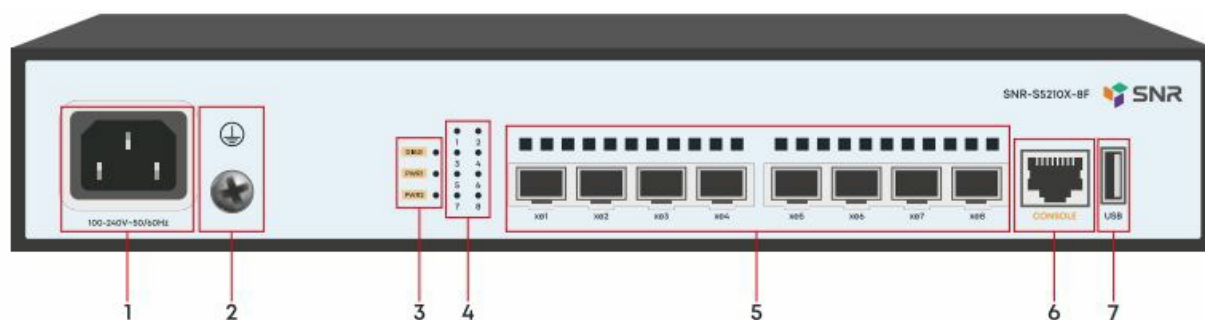

No	Item	Description
1	~100-240V; 50/60Hz	The AC power socket, AC rated voltage range: 100-240V AC 50/60 Hz
2	Grounding	The Grounding screw
3	DIAG	Switch status LED
		Green The system is starting or abnormal
		Green (Blink) System works normally
	PWR1, PWR2	PRW1 – AC power LED, PWR2 – DC power LED
		Green Power is on
4	xe1-8	Port LEDs
		Off No link on the port
		Green The port has a valid link
		Green (Blink) Blinking indicates activity on the port
5	xe1-8	1/10GBase-X SFP+ ports
6	CONSOLE	Console port
7	USB	USB port

Switch installation

Before installation, take ESD-preventive measures, such as wearing the ESD-preventive gloves or a wrist strap.

Install the device in a 19" cabinet

- Fix the rack mount brackets.

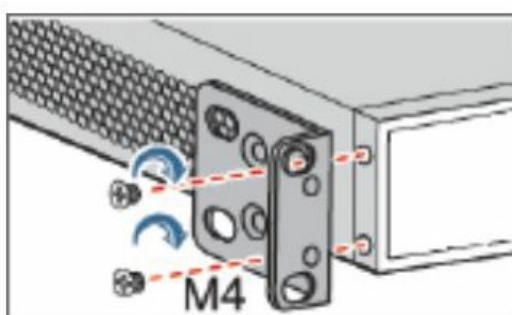

- Fix the captive nuts, and install the device in a cabinet. Attention: leave more than 1U space between the devices for proper heat dissipation.

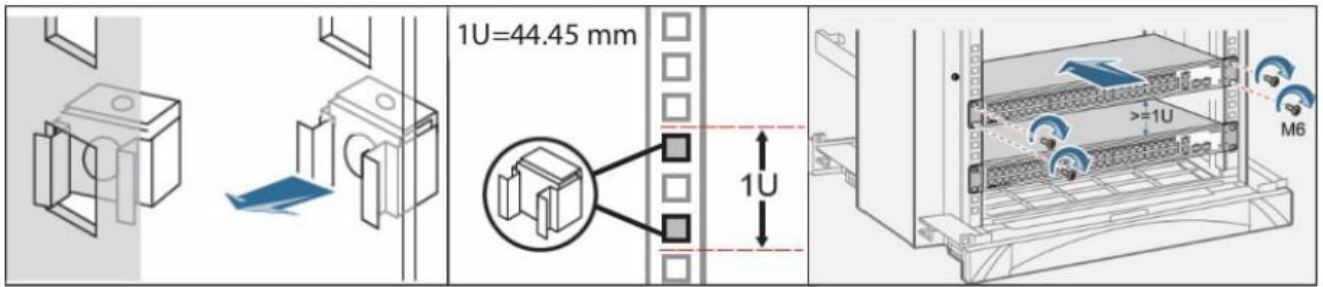

Install the device on a worktable.

Stick the rubber gasket, and Install the device on a worktable.

Connect the PGND cable and power cable

- Connect the switch with the PC NIC interface. Power on the switch.

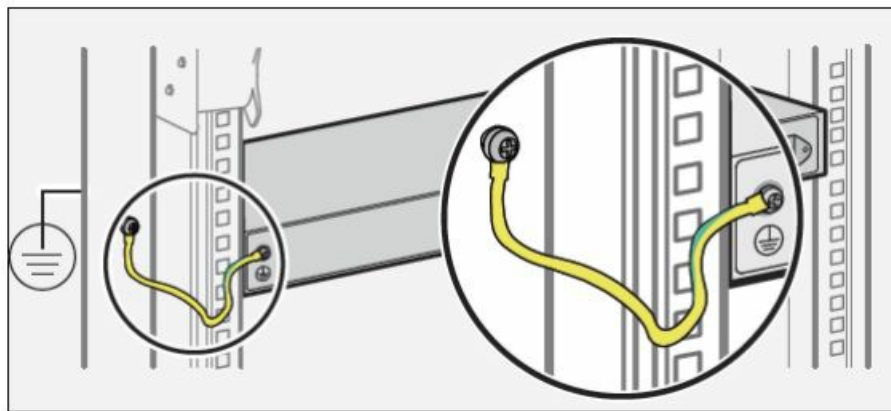

- Connect the switch with the PC NIC interface. Power on the switch.

Access to initial switch configuration

Access to the switch via the console port

Connect the console cable to the switch via the RJ-45 connector and another side to the RS-232 port of the PC. The settings of the COM-port are below:

Parameter	Value
Bitrate	115200
Databits	8
Parity	None
StopBits	1
FlowControl	None

Use default username admin and password admin to access the switch.

Access to the switch via Ethernet port

Connect the switch with the PC NIC interface. Power on the switch. Check whether the IP address of the computer is within this network segment: 192.168.1.xxx (“xxx” ranges 2~254), for example, 192.168.1.100. Open telnet connection to address 192.168.1.1.

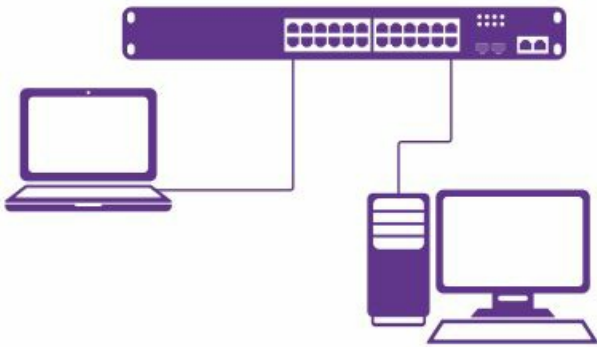

Parameter	Value
Switch default IP-address	192.168.1.1
Default username	admin
Default password	admin

Technical support

- NAG service and technical support center:
- NAG LLC
- **Address:** Office M-03, Al Garhoud Business Center Building. UAE, Dubai
- **Website:** [Snr. global](#)
- **Technical** support portal: [snr.support](#)
- **Tel:** +971 0 42599967

Frequently Asked Questions (FAQ)

- **What should I do if the power LED is off on the switch?**
Check the power connections and ensure there are no errors with the power source.
- **How can I reset the switch to factory settings?**
Refer to the user manual for instructions on resetting the switch to factory settings.

Documents / Resources

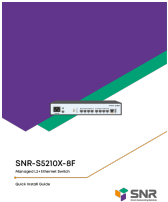

SNR-S5210X-8F
Managed L2 Plus Ethernet Switch

[SNR SNR-S5210X-8F Managed L2 Plus Ethernet Switch](#) [pdf] Installation Guide
SNR-S5210X-8F, SNR-S5210X-24FX, SNR-S5210X-8F Managed L2 Plus Ethernet Switch, Man
aged L2 Plus Ethernet Switch, L2 Plus Ethernet Switch, Ethernet Switch

References

- [User Manual](#)

[Manuals+](#), [Privacy Policy](#)

This website is an independent publication and is neither affiliated with nor endorsed by any of the trademark owners. The "Bluetooth®" word mark and logos are registered trademarks owned by Bluetooth SIG, Inc. The "Wi-Fi®" word mark and logos are registered trademarks owned by the Wi-Fi Alliance. Any use of these marks on this website does not imply any affiliation with or endorsement.