



SNR S2995G-
12FX Managed L3
Ethernet Switch



SNR S2995G-12FX Managed L3 Ethernet Switch Installation Guide

[Home](#) » [SNR](#) » SNR S2995G-12FX Managed L3 Ethernet Switch Installation Guide 

Contents

- [1 SNR S2995G-12FX Managed L3 Ethernet Switch](#)
- [2 Product Usage Instructions](#)
- [3 Front and back panels description](#)
- [4 Switch installation](#)
- [5 Access to initial switch configuration](#)
- [6 Technical support](#)
- [7 Documents / Resources](#)
 - [7.1 References](#)
- [8 Related Posts](#)



SNR S2995G-12FX Managed L3 Ethernet Switch

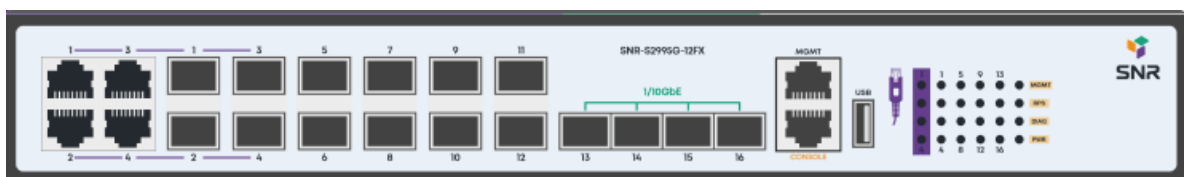

Product Usage Instructions

Front and Back Panels Description

Refer to the manual for detailed LED indicators and port descriptions.

Install the Device on a Worktable

Stick the rubber gasket and install the device on a worktable securely.

Connect the PGND Cable and Power Cable

Connect the grounding cable to the ground bus and then to the switch. Connect the AC power cable to power the switch.

Access to Initial Switch Configuration:

Access via Console:

Connect console cable to the switch via RJ-45 connector and the other end to the RS-232 port of the PC. Use the following settings for the COM-port:

- Baudrate: 115200
- Databits: 8
- Parity: None
- StopBits: 1
- Flow Control: None

Use default username 'admin' and password 'admin' to access the switch.

Access via Ethernet Port:

Default IP-address: 192.168.1.1, Default username: admin, Default password: admin.

Frequently Asked Questions (FAQ):

Q: How do I access technical support for the product?

A: You can reach NAG service and technical support center at the following details:

SNR-S2995G-12FX Quick Install Guide

This guide describes the steps of installing the switch, including the basic introduction to the product, the basic installation steps, etc.

Front and back panels description

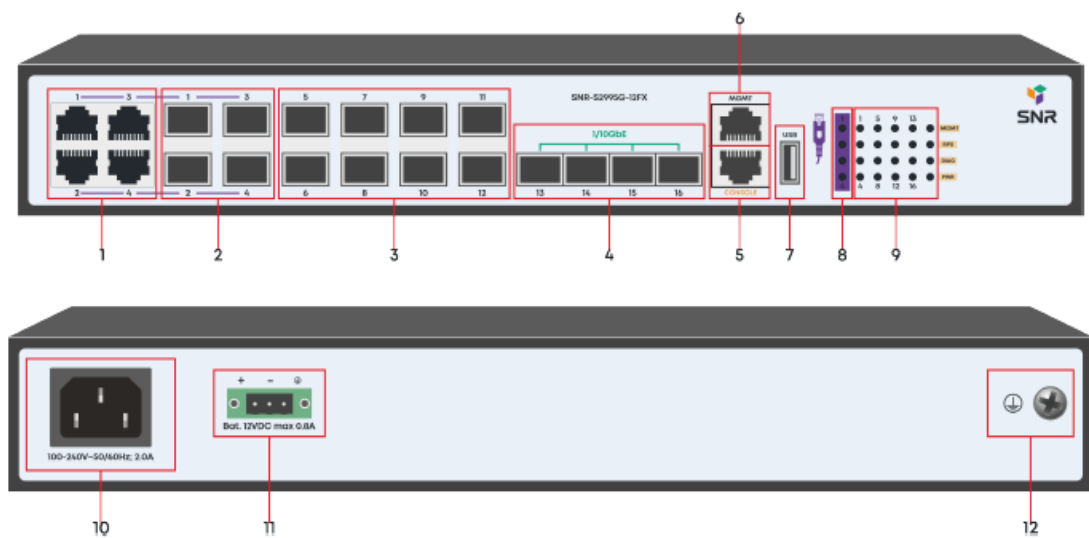

Nº	Item	Description	
1	Ports 1-4	Copper Combo ports 10/100/1000BaseT	
2	Ports 1-4	SFP Combo ports 100/1000BaseX	
3	Ports 5-12	SFP 100/1000BaseX ports	
4	Ports 13-16	SFP+ 1/10GbE ports	
5	Console	Console port	
6	MGMT	Management port	
7	USB	USB port	
8	Ports 1-4	Copper Combo port LEDs	
9	1-16	Port LEDs	
		Off	No link on port
		Green	The port has a valid link
		Green (Blink)	Blinking indicates activity on port
	RPS	RPS LED	
		Off	Switch work from AC power
		Green	AC is off. Switch work from battery
	DIAG	Switch status LED	
		Green	System is starting or abnormal
		Green (Blink)	System works normally
	PWR	Power LED	
		Green	Internal/External power is operating normally
		Off	Power off

9	MGMT	Management port LED	
		Off	No link on port
		Green	The port has a valid link
		Green (Blink)	Blinking indicates activity on port
10	100-240V~ 50/60Hz	The AC power socket, AC rated voltage range: 100-240V AC; 50/60Hz	
11	DC 11-13V 4.5A	RPS port, 11-13V DC	
12	Grounding	The Grounding bolt	

Switch installation

Before installation, take ESD-preventive measures, such as wearing the ESD-preventive gloves or a wrist strap.

Install the Device in a 19" Cabinet

Fix the Rack Mount Brackets.

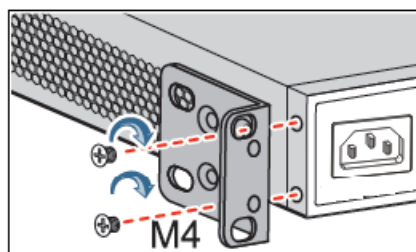

Fix the captive nuts and install the device in a cabinet. Attention: leave more than 1U space between the devices for proper heat dissipation.

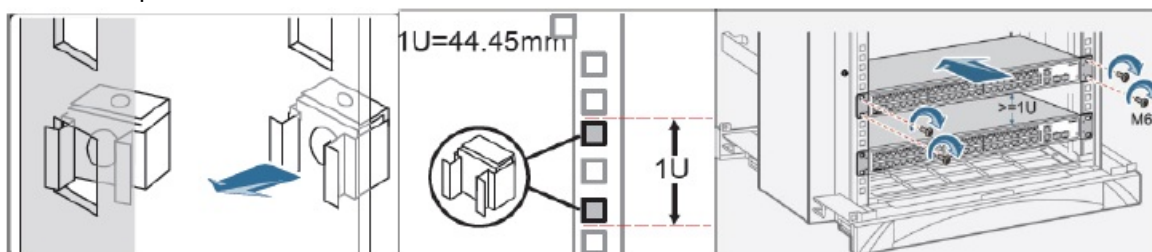

Install the Device on a Worktable

Stick the rubber gasket and install the device on a worktable.

Connect the PGND cable and power cable

Connect grounding cable to the ground bus and to the switch.

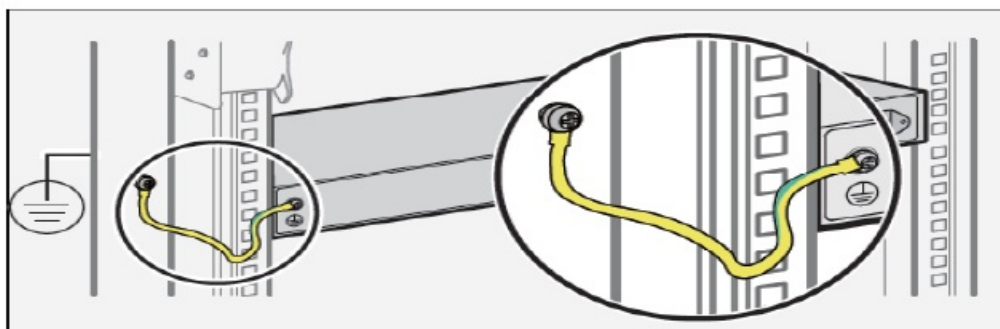

Connect the AC power cable.

Access to initial switch configuration

Access to the switch via console

Connect console cable to switch via RJ-45 connector and another side to RS-232 port of the PC. Settings of the COM-port are below.

Parameter	Value
Bitrate	115200
Databits	8
Parity	None
StopBits	1
FlowControl	None

Use default username admin and password admin to access the switch.

Access to the switch via Ethernet port

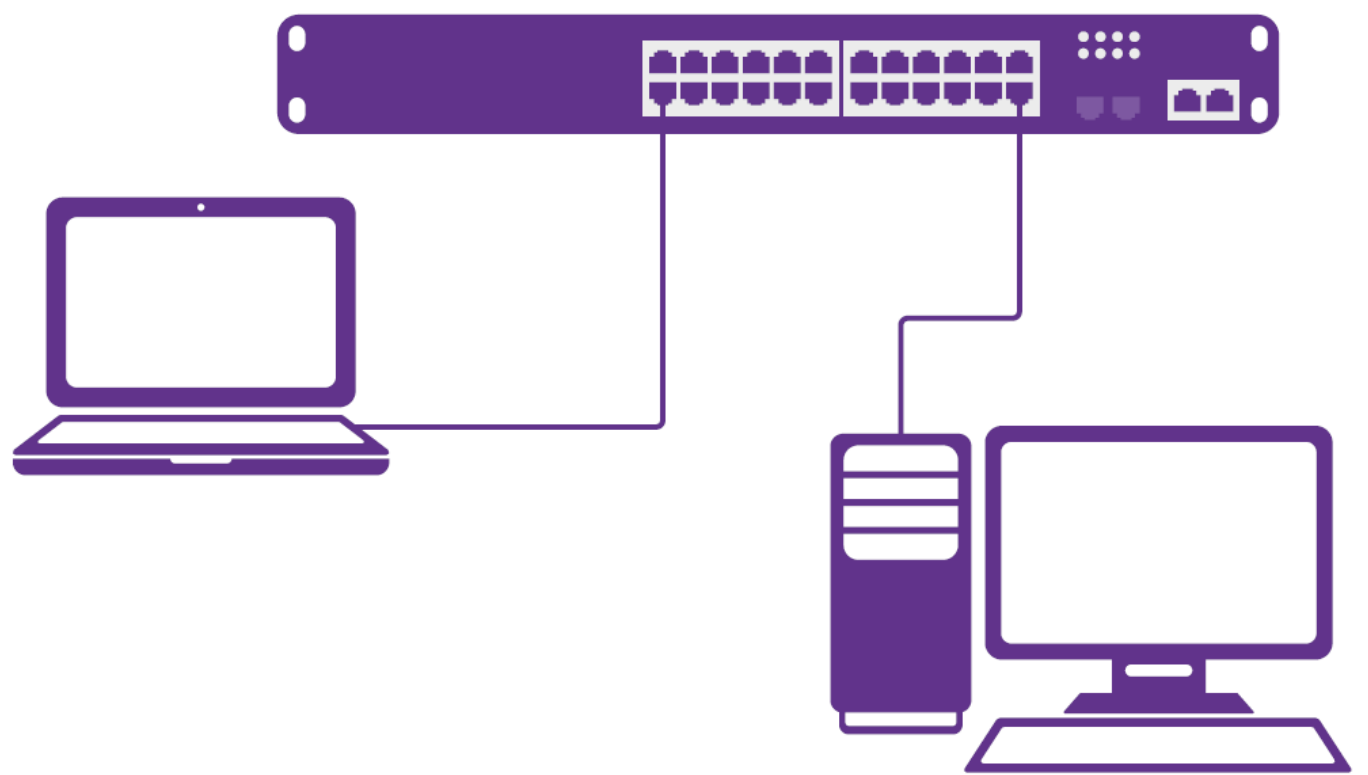

Connect the Switch with the PC NIC interface. Power on the Switch. Check whether the IP-address of the computer is within this network segment: 192.168.1.xxx (“xxx” ranges 2~254), for example, 192.168.1.100. Open the browser, and enter `http://192.168.1.1` and then press «Enter» or open telnet connection to address 192.168.1.1.

Parameter	Value
Switch default IP-address	192.168.1.1
Default username	admin
Default password	admin

Technical support

- NAG service and technical support center:
- NAG LLC
- Address: Office M-03, Al Garhoud Business center Building. UAE, Dubai
- Website: snr.global
- Technical support portal: snr.support
- Tel: +971 0 42599967

Documents / Resources

 The image shows a network switch with a purple top and a white front panel. The front panel has several ports and a small display. Below the switch, the text "SNR-S2995G-12FX" is visible, along with the SNR logo.	<p>SNR S2995G-12FX Managed L3 Ethernet Switch [pdf] Installation Guide</p> <p>S2995G-12FX Managed L3 Ethernet Switch, S2995G-12FX, Managed L3 Ethernet Switch, Ethernet Switch, Switch</p>
--	--

References

- [User Manual](#)

Manuals+, Privacy Policy

This website is an independent publication and is neither affiliated with nor endorsed by any of the trademark owners. The "Bluetooth®" word mark and logos are registered trademarks owned by Bluetooth SIG, Inc. The "Wi-Fi®" word mark and logos are registered trademarks owned by the Wi-Fi Alliance. Any use of these marks on this website does not imply any affiliation with or endorsement.