



snapmaker How to Use the Z-Axis Extension Module Installation Guide

[Home](#) » [snapmaker](#) » snapmaker How to Use the Z-Axis Extension Module Installation Guide 

Contents

- [1 snap maker How to Use the Z-Axis Extension Module](#)
- [2 Assembly](#)
- [3 Configuration of Lubann](#)
- [4 Documents / Resources](#)
- [5 Related Posts](#)

snapmaker

snap maker How to Use the Z-Axis Extension Module



Foreword

This is a guide on how to use the Z-Axis Extension Module on your Snapmaker Original. It is divided into two sections:

1. Provides information on assembly.
2. Demonstrates the configuration of Snapmaker Luban.

Used Symbols

Caution: Ignoring this type of message might result in malfunction or damage of the machine and injuries to users

Notice: Details you should be aware of through- out the process

- Make sure that the highlighted part is facing the right way.

Assembly

1. Make sure that the machine is powered off.

Unplug all the cables.

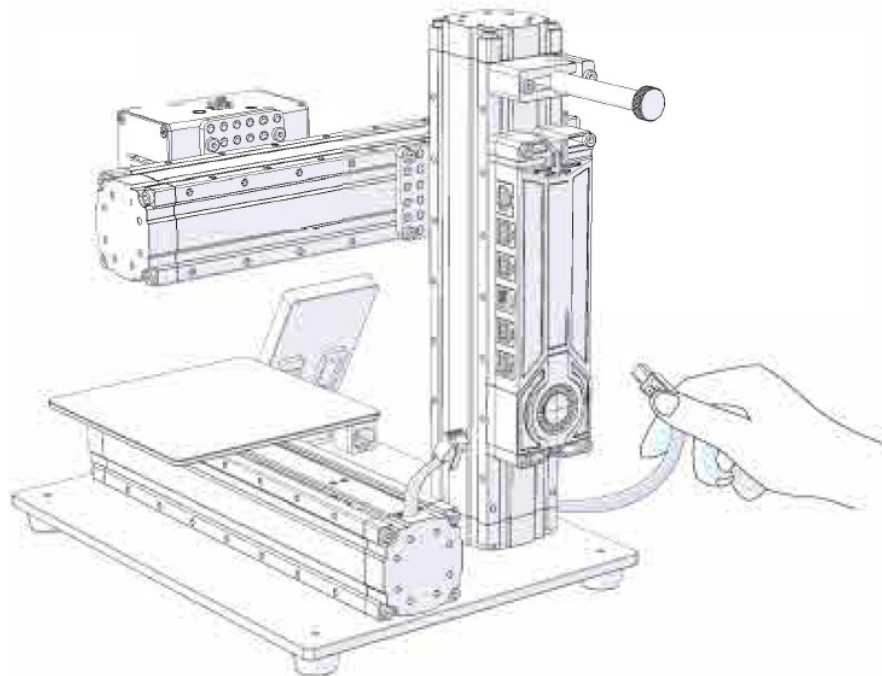

Wait about 5 minutes for the machine to cool off if it just finished printing.

2. Detach the Filament Holder.
 - Detach the X-Axis
(with 3D Printing Module attached).
 - Detach the Controller.

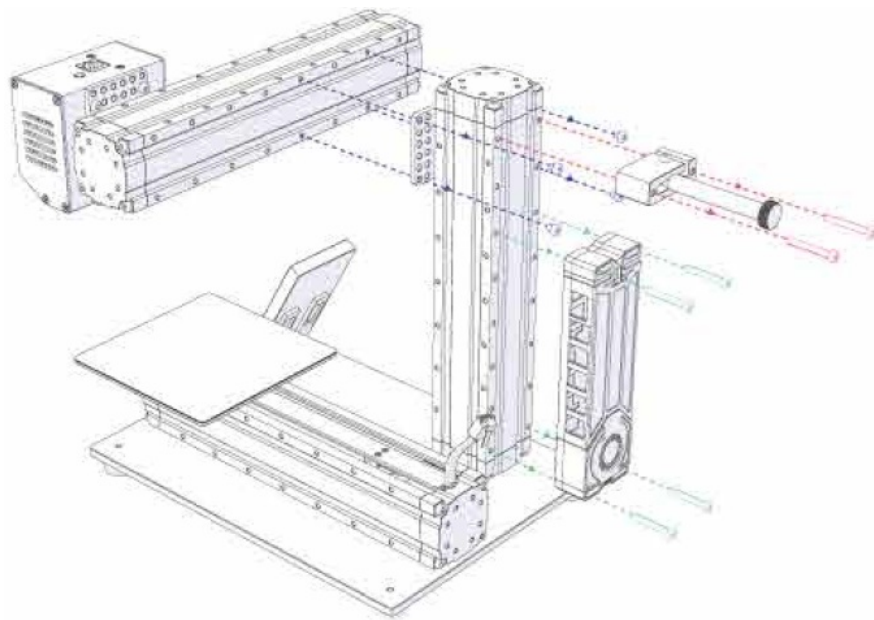

3. Detach the previous Z-Axis.

Attach the Z-Axis Extension Module (Z-Axis thereafter).

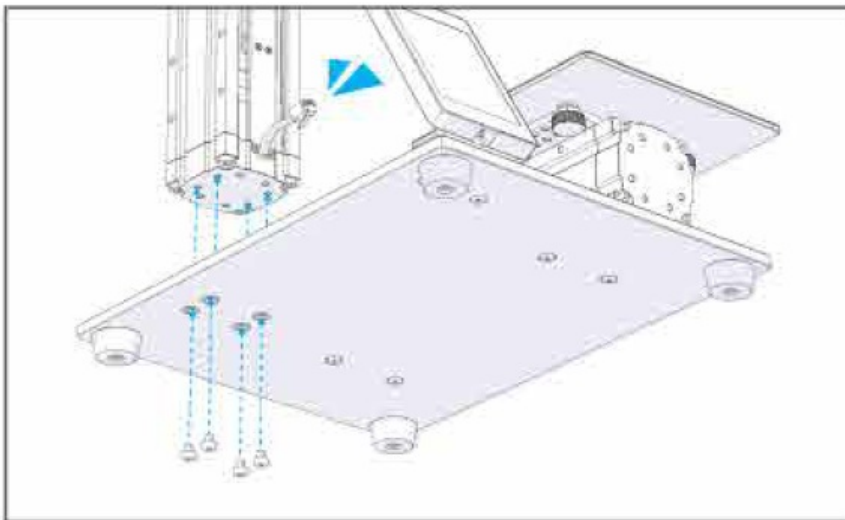

4. Attach the Filament Holder onto the Z-Axis.

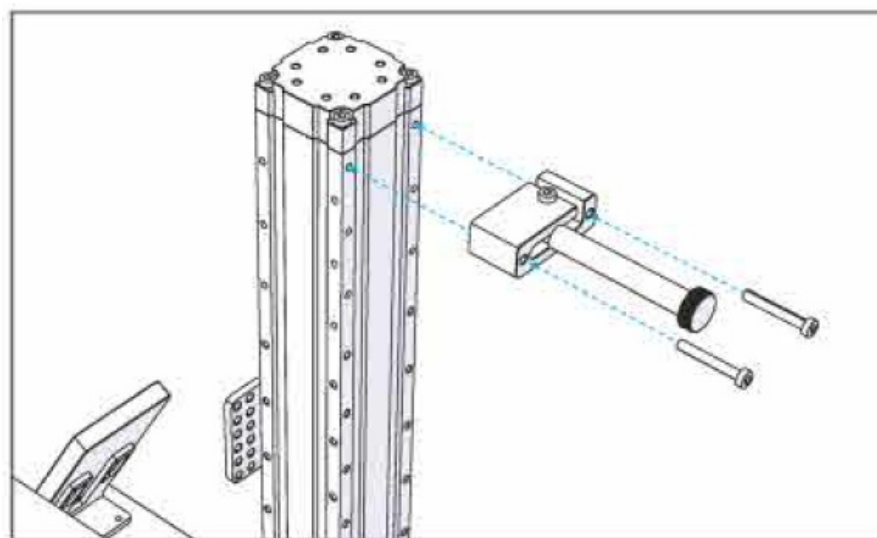

5. Attach the XAxis (with 3D Printing Module attached) to the Z-Axis.

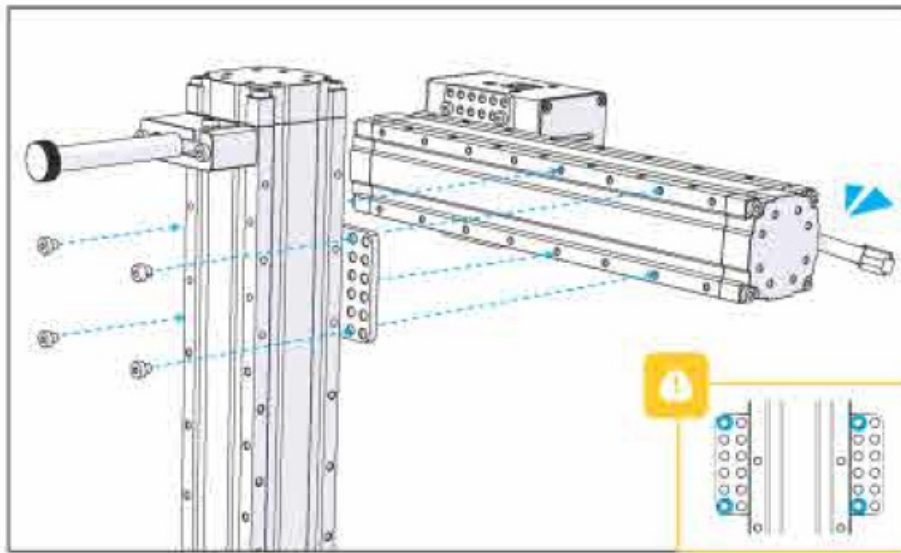

6. Attach the Controller to the Z-Axis.

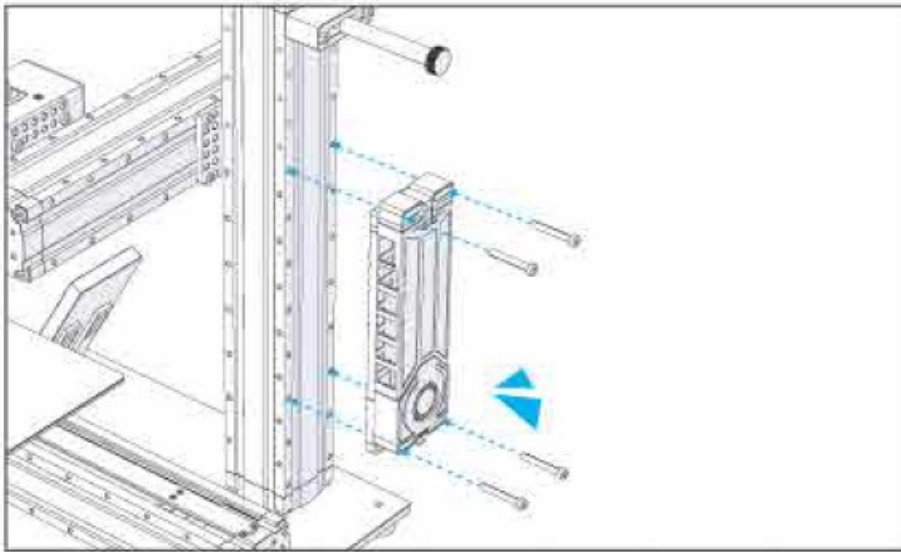

7. Connect all the cables unplugged in Step 1.

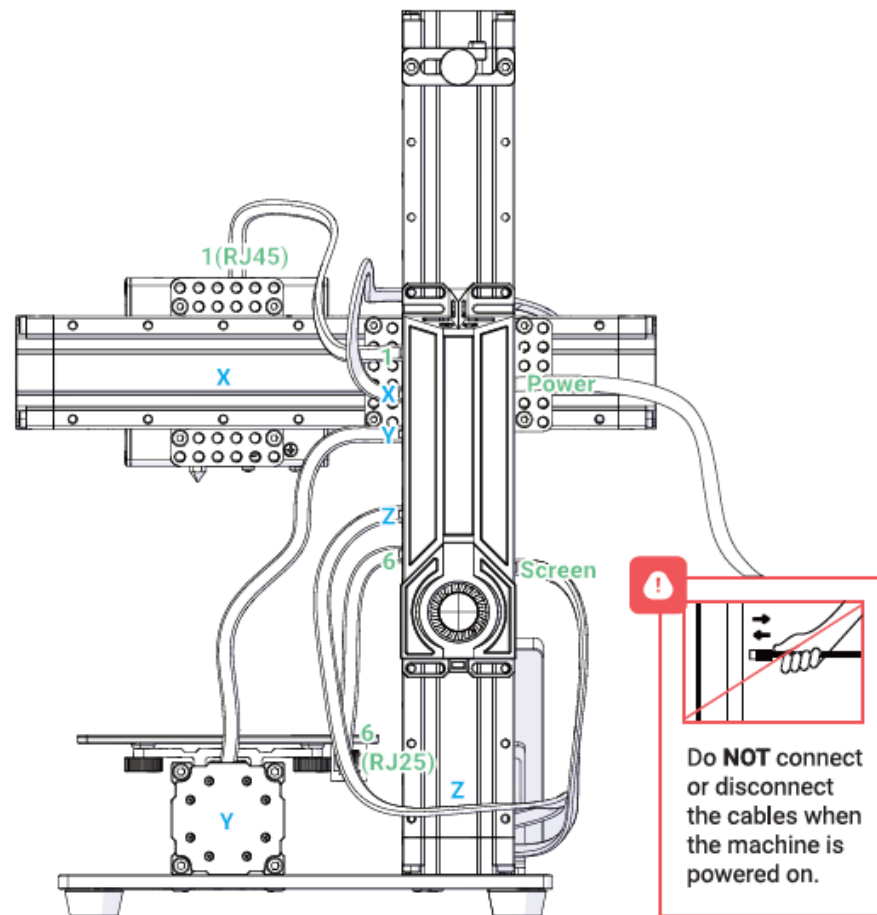

Configuration of Lubann

1. Make sure that your firmware is updated to the latest 2.11, and that Snapmaker Luban is installed:
<https://snapmaker.com/product/snapmaker-original/downloads>.
2. Connect your PC with the machine using the provided USB cable, and switch the power on.

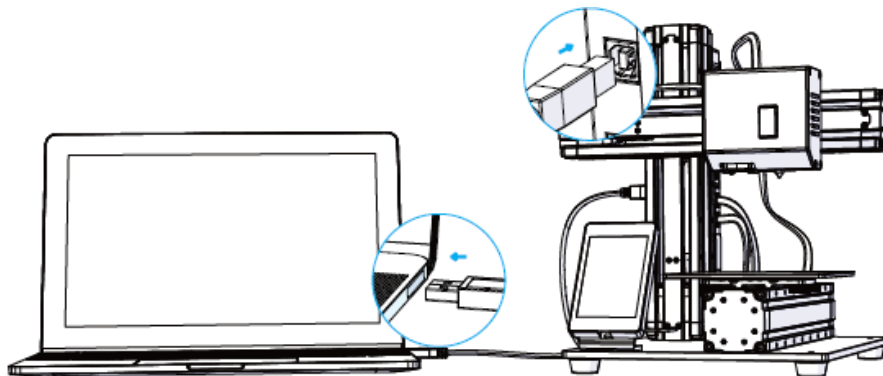

Note: If you fail to find serial port of your machine, try and install CH340 driver at:

<https://snapmaker.com/product/snapmaker-original/downloads>.

3. Launch Snapmaker Luban.
 - From the left sidebar, enter Workspace
 - On top left, find Connection and click the refresh button to reload serial ports list
 - Click the drop-down button and select the serial port of your machine, and click Connect.

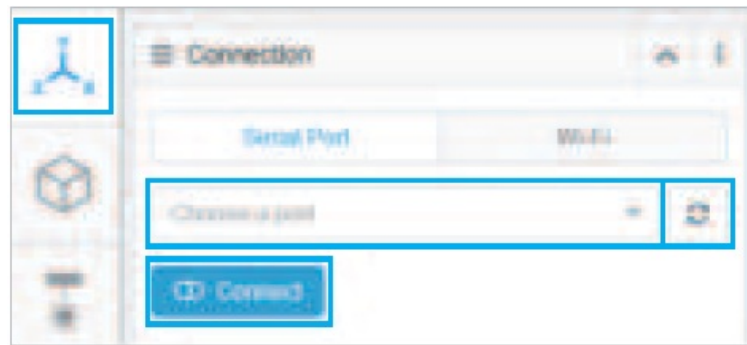

4. Select Custom and the toolhead connected to the machine when prompted.



5. Click Settings on the left sidebar, choose Machine Settings.

- Type 125, 125, 221 separately in the blank spaces under X, Y, and Z.
- Under Z axis Extension Module, click the drop-down button and select On.
- Click Save Changes.



6. Tap Controls on the Touchscreen, and tap Home AXes to run a homing session.

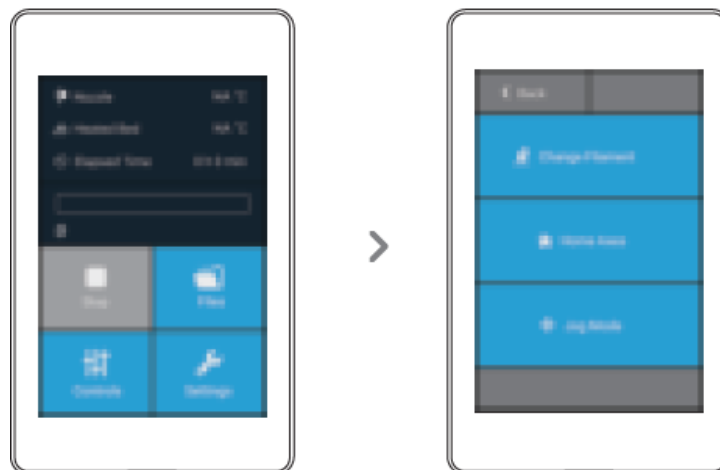

7. Level the Heated Bed. For detailed instructions, refer to Quick Start Guide. Your Z-Axis Extension Module is now ready to go.

Note: If your machine is using 3D printing Module, to see if configuration is successful, tap Settings About > Build Volume on the Touchscreen.

Documents / Resources



[snapmaker How to Use the Z-Axis Extension Module](#) [pdf] Installation Guide
How to Use the Z-Axis Extension Module, Z-Axis Extension Module, Extension Module, Module

