

**SMS**  
SECURITY  
**DMSS App**  
**For Camera**



## SMS SECURITY DMSS App For Camera User Guide

[Home](#) » [SMS SECURITY](#) » SMS SECURITY DMSS App For Camera User Guide 

### Contents

- [1 SMS SECURITY DMSS App For Camera](#)
- [2 DOWNLOADING THE APP](#)
- [3 ADDING THE CAMERAS TO THE APP](#)
- [4 SCANNING THE QR CODE \(ON THE RECORDER\)](#)
- [5 SELECTING A DEVICE](#)
- [6 COMPLETION](#)
- [7 Documents / Resources](#)
  - [7.1 References](#)
- [8 Related Posts](#)

**SMS**  
SECURITY

**SMS SECURITY DMSS App For Camera**



## DOWNLOADING THE APP

Install the DMSS App to your mobile device. This can be found on the Google Play Store for Android users, and on the Apple App Store for iPhone users. The icon looks like the image below.



## ADDING THE CAMERAS TO THE APP

Once you have the app open on your mobile device. You will see the screen below. Simply press on the + button shown in the image. No need to log in or create an account.

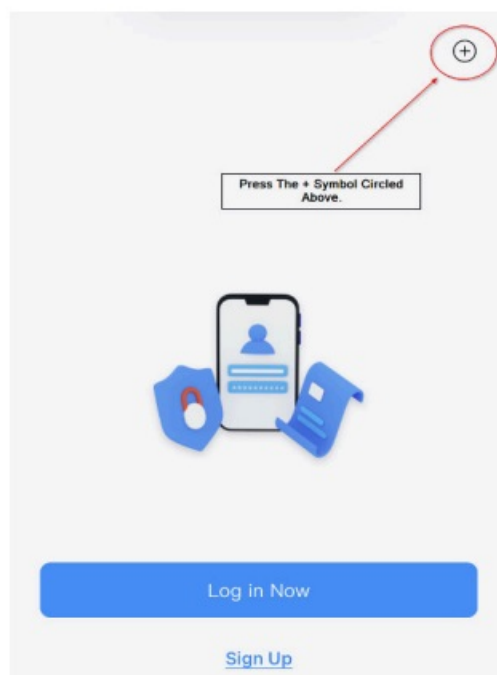

## SCANNING THE QR CODE (ON THE RECORDER)

Once you have pressed the + sign, select the Scan QR Code option. This will open a page asking for you to give access to DMSS to use your camera. Press allow or yes to allow DMSS to use the camera, then simply scan the QR code that is located on the bottom of the recorder (camera box).

## SCANNING THE QR CODE (ON THE CONNECTED SCREEN)

Alternatively, you can view the QR code on your connected screen if you have one. To do this, right click with the mouse and select main menu. From there go to Network, and then choose the P2P option at the bottom of the Network menu. You will see 2 QR codes, one will have a Register App option, the other will have a Serial Number. Scan the code with the Serial Number and this will take you to the next step.

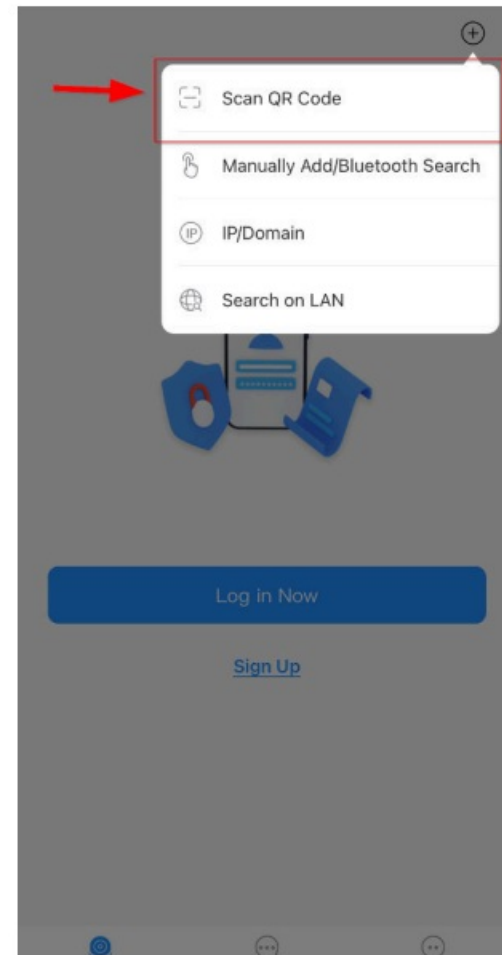

## MOVING TO THE NEXT STEP

After scanning the QR code, you will arrive at this screen. The serial number will be prefilled and there is no need for a security code for the device. Simply press NEXT to continue with the setup.

< Add Device



Device SN and Security Code

████████████████████

Please enter the security code

If the security code is not on the device label, you can leave this field empty.

Next



## SELECTING A DEVICE

The screen below will appear after pressing next. By default, the New IPC menu will be selected. Simply select NVR/XVR as shown in the below image, then select NVR which is circled below.

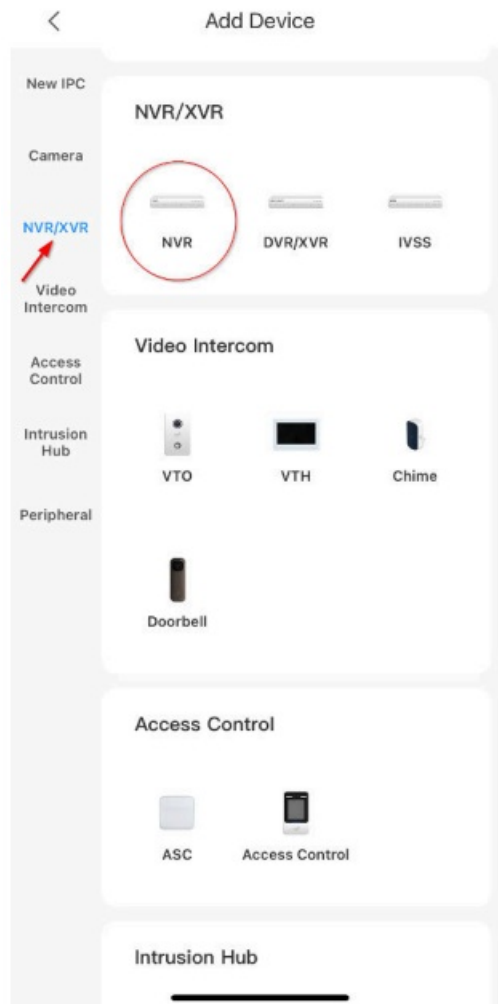

## SETTING NAME OF CAMERAS AND INPUTTING

### CREDENTIALS

After choosing the NVR in the above step, you will arrive at the screen shown below. In this section, you will need to type in a name for your cameras, the example shown is using Home as the name. Your user name will be prefilled so you should not need to enter anything in there. Finally, enter in the password for the NVR and press OK at the top right corner of the screen. (If this installation was done by us, you can contact the office for this information, otherwise contact the person who installed the device and they should be able to give you this information).

<

Add Device

OK

Add Mode

P2P

SN

9B00EFBPAZCCA9A

Name

1 → Home

Username

admin

Device Password

⊗ ↻

2 ↗

^ v

Done

### UPnP (Universal Plug and Play)

Make sure that UPnP is turned on, by default it will be. As long as the toggle is blue it is on. Then press Completed. If the message below appears, disregard as it is not necessary to create an account.

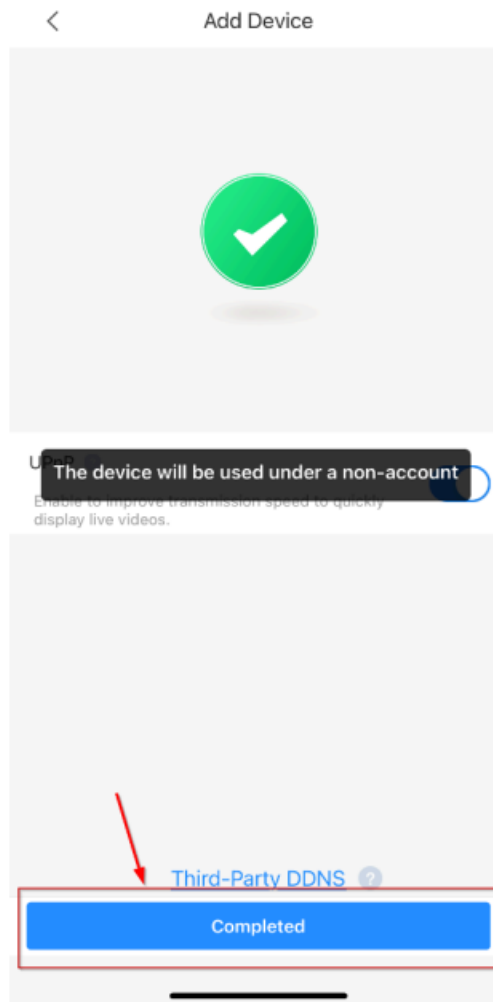

## COMPLETION

Finally, you will arrive at this screen which will show the cameras in the black boxes below. Congratulations, you have just added the cameras to your mobile device! If you face any difficulties, please contact the office for further assistance or to book a technician if required.

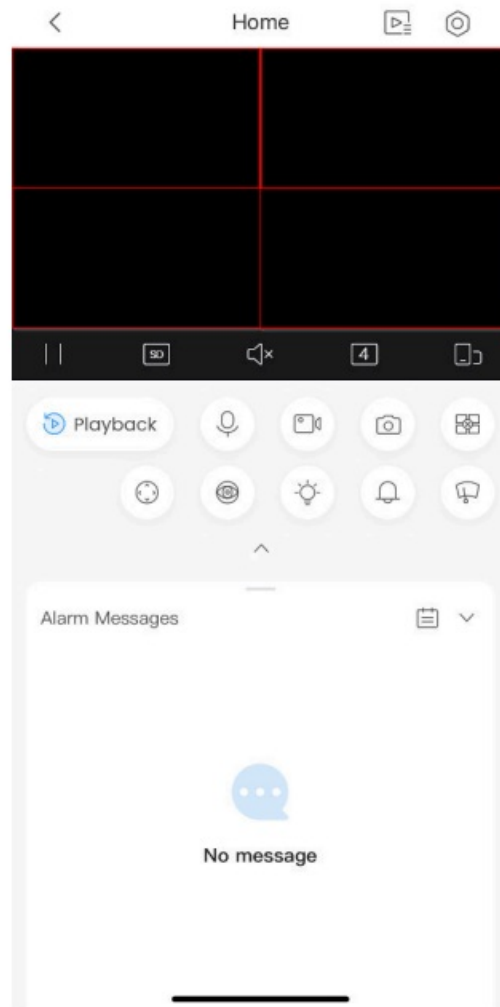

## Documents / Resources

	<a href="#">SMS SECURITY DMSS App For Camera</a> [pdf] User Guide DMSS App For Camera, App For Camera, Camera
---	--

## References

- [User Manual](#)

### Manuals+, Privacy Policy

This website is an independent publication and is neither affiliated with nor endorsed by any of the trademark owners. The "Bluetooth®" word mark and logos are registered trademarks owned by Bluetooth SIG, Inc. The "Wi-Fi®" word mark and logos are registered trademarks owned by the Wi-Fi Alliance. Any use of these marks on this website does not imply any affiliation with or endorsement.