



Smeg BCC02 Fully Automatic Coffee Machine Manual: User Instructions & Safety Info

[Home](#) » [Smeg](#) » **Smeg BCC02 Fully Automatic Coffee Machine Manual: User Instructions & Safety Info**

safe use of the appliance. The Smeg BCC02 Fully Automatic Coffee Machine is a unique and innovative product that offers both aesthetic appeal and functionality. As a product expert, it is advised to read the user manual carefully before using the appliance to ensure safe and proper usage. The manual contains all the necessary instructions for managing the appliance's features and design. It is important to follow the safety information provided in the manual to avoid potential hazards that could result in personal injury or property damage. The manual includes detailed safety instructions, important safeguards, and warnings to ensure safe usage of the appliance. It is also recommended to keep the operating instructions in a safe place and pass them on to any future user. The Smeg BCC02 Fully Automatic Coffee Machine is designed for household use only and should not be used for any other purpose. For further information on the product, please visit www.smegusa.com.

Contents [[hide](#)]

- [1 smeg BCC02 Fully Automatic Coffee Machine](#)
- [2 IMPORTANT INSTRUCTIONS](#)
 - [2.1 SAFETY INFORMATION](#)
- [3 IMPORTANT SAFEGUARDS](#)
- [4 Controls](#)
- [5 USE](#)
- [6 Use / Cleaning and maintenance](#)
- [7 SPECIFICATIONS](#)
- [8 FAQs](#)
- [9 Documents / Resources](#)
- [10 Related Posts](#)



smeg BCC02 Fully Automatic Coffee Machine



We advise you to read this manual carefully, as it contains all the instructions for managing the appliance's aesthetic and functional qualities. For further information on the product: www.smegusa.com

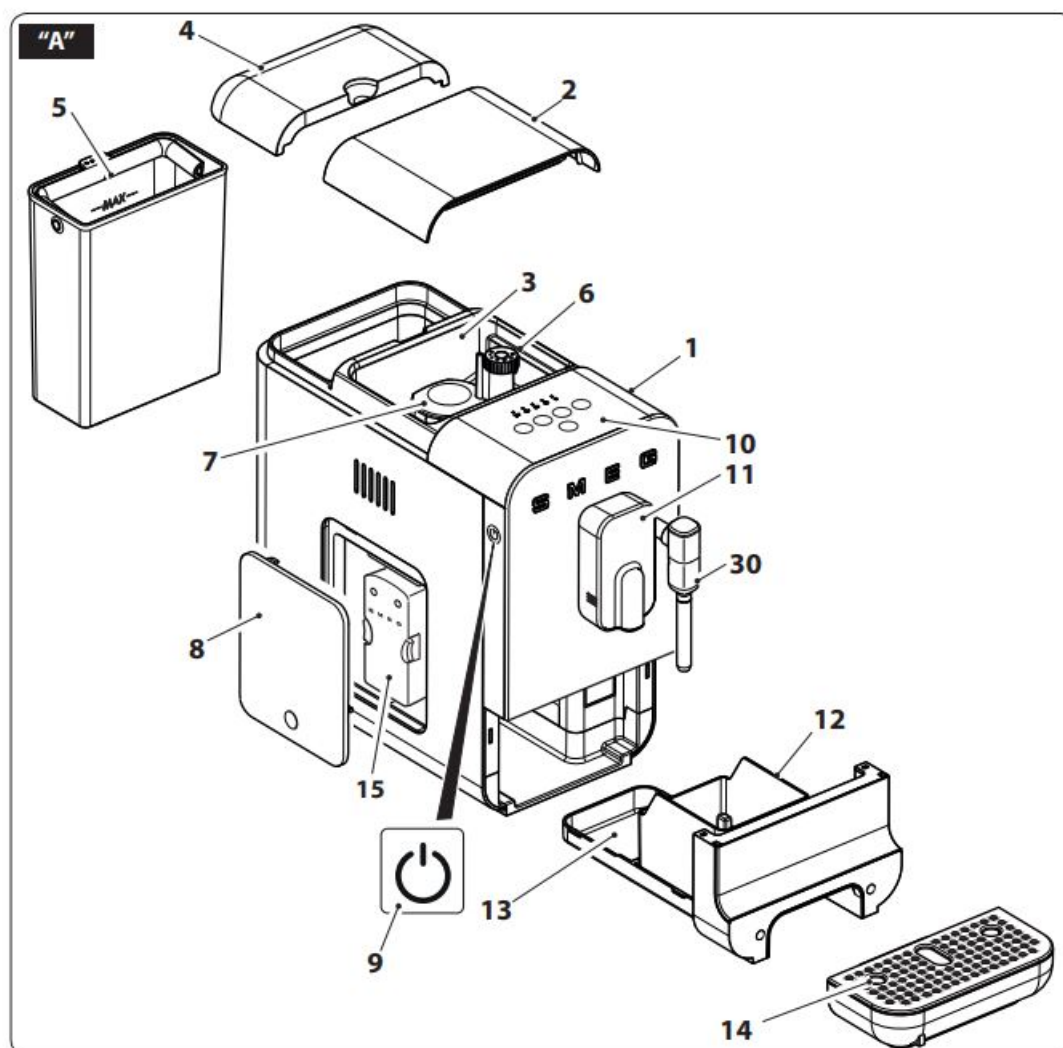

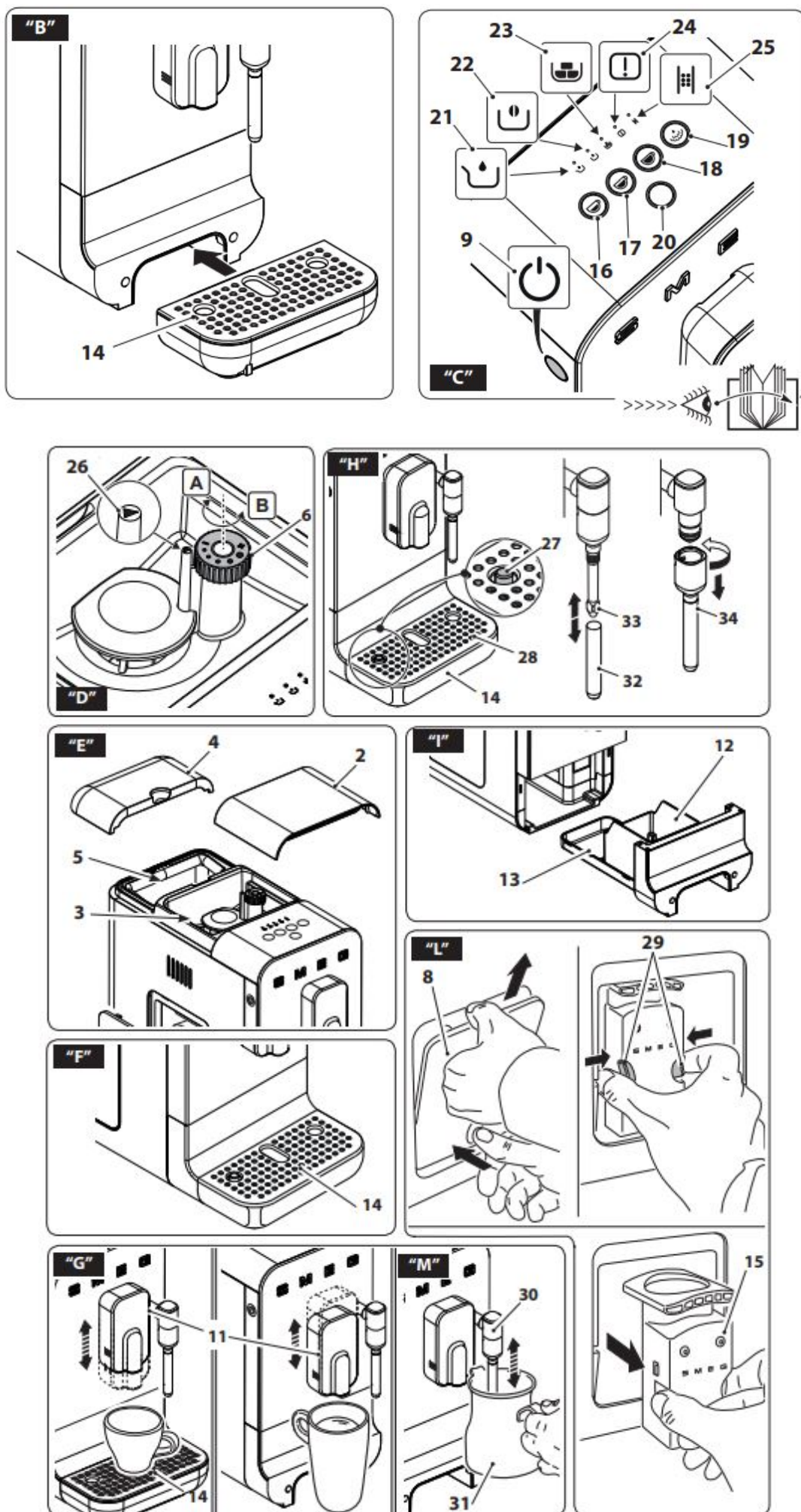

Dear Customer, Thank you for buying the Smeg Line Coffee Machine. Our products offer you a solution in which

research to create an aesthetically pleasing object and innovative engineering provide unique items that are decorative elements. A Smeg appliance is always the perfect match with other products of the line while also being a designer item for the kitchen. We hope you fully enjoy all the features of your appliance. For more information, please visit: www.smegusa.com

IMPORTANT INSTRUCTIONS

WARNING:

- If the instructions contained in this manual are not followed precisely, fire or explosion may result causing property damage, personal injury or death.
- To reduce the risk of fire or electric shock, do not remove the cover (or back).
- No user-serviceable parts inside!
- Repair should be done by authorized service personnel only.
- To reduce the risk of fire or electric shock, do not remove the cover (or back).
- No user-serviceable parts inside!
- Repair should be done by authorized service personnel only.
- means you could be killed or seriously injured if the instructions are not followed. CAUTION indicates a potentially hazardous situation, which, if not avoided, could result in minor to moderate injury.

SAFETY INFORMATION

This is a safety alert symbol. This symbol alerts you to potential hazards that can result in severe personal injury or death. **UNDERSTAND SIGNAL WORDS** A signal word – DANGER, WARNING or CAUTION – is used with the safety alert symbol. DANGER denotes the most serious hazards. It means you could be killed or seriously injured if you do not immediately follow the instructions. **ATTENTION**

- This appliance is intended for use in the home only.
- Use this appliance only for its intended purpose. The manufacturer cannot be held liable for damage caused by improper use of this appliance.
- This appliance complies with current safety regulations. Improper use of this appliance can result in personal injury and material damage.
- Read all the instructions before installing or using the appliance for the first time.
- Keep these operating instructions in a safe place and pass them on to any future user.
- For your safety, the instructions contained in this manual must be followed to minimize the risk of fire or explosion and to prevent property damage, personal injury or death.
- Do not store or use gasoline or other flammable vapors, liquids or materials near this or any other appliance.

The safety messages will inform you of potential hazards, on how to avoid the risk of injury and what can occur if the instructions are not followed. **IMPORTANT:** Observe all codes and ordinances in force. **NOTE:** This appliance is NOT designed for installation in manufactured (mobile) homes or in recreational vehicles (RVs). **GROUNDING PLUG** (for product manufactured with a grounded plug) As a safety feature, this product is equipped with grounded plug, which will only fit into a three-prong outlet. Do not attempt to bypass this safety feature. Improper connection of the grounding conductor may result in the risk of electric shock. Consult a qualified electrician if you have any doubts on whether the outlet is properly grounded.

IMPORTANT SAFEGUARDS

WARNING: When using electrical appliances, basic safety precautions should always be followed to reduce the risk of fire, electric shock, and / or injury to person including the following: Follow all safety precautions to ensure safe use of the appliance.

- Before using the appliance, read this user manual carefully.
- Do not use the appliance outdoors.
- This appliance is for household use only.
- Do not use the appliance for other than its intended use.
- Do not allow children to use the appliance.
- Children should not play with the appliance. Keep the appliance out of the reach of children.
- Keep the packaging material (plastic bags, expanded polystyrene) out of the reach of children.
- Close supervision is necessary when any appliance is used by or near children.
- Turn off the appliance immediately after use.
- Do not leave the appliance unattended while it is running.
- Disconnect the appliance from the wall outlet before assembly, disassembly, cleaning and after each use.
- Always attach plug to appliance first, then plug cord into the wall outlet. To disconnect, turn any control to “off,” then remove plug from wall outlet.
- Turn the appliance OFF, then unplug from the outlet when not in use, before assembling or disassembling parts and before cleaning. To unplug, grasp the plug and pull from the outlet. Never pull from the power cord.
- To protect against fire, electrical shock and personal injury, do not immerse the appliance, the power cord or plug in water or any other liquid.
- Do not touch the appliance or the plug with wet hands.
- Never try to extinguish a flame/fire with water: turn off the appliance, unplug it from the outlet and cover the flame with a lid or a fire blanket.
- Do not use the appliance if the power cord or plug is damaged or if the appliance has been dropped or damaged in any way.
- Do not let cord hang over edge of table or counter, or touch hot surfaces.
- Do not operate any appliance with a damaged cord or plug or after the appliance malfunctions, or has been damaged in any manner. Return appliance to an authorized service facility for examination, repair or adjustment.
- Make sure the power cord does not come in contact with sharp edges.
- Do not pull on the cord to remove the plug from the socket.
- Do not place the appliance on or near switched-on gas or electric burners, inside an oven, or near heat sources.
- Do not touch hot surfaces. Use handles and knobs.
- Do not place the appliance near faucets or sinks.
- Never attempt to repair the appliance yourself or without the help of a qualified technician. Failing to do this will void the warranty.
- In case of malfunction, have the appliance repaired by a qualified technician.
- Do not make any changes to the appliance.
- Make sure that the power outlet used is always freely accessible, because only in this way can it be unplugged when necessary.
- To remove the plug from the power outlet, operate directly on the plug. Never pull the cable, it could be damaged.

- If the appliance should break down, do not attempt to repair it.
- Do not allow the power supply cable to dangle over the edge of the table or other surface or to touch hot surfaces.
- If the plug or power supply cable are damaged, have them replaced exclusively by the Technical After-sales centre, so as to prevent all risks.
- Check hopper for presence of foreign objects before using.
- Only insert water into the appropriate tank. Use fresh, clean water.
- The appliance shall not be placed in a cabinet when in use.
- Allow the appliance to cool down before cleaning.
- The appliance generates heat and produces hot water and steam during operation. Avoid contact with boiling steam or water.
- Do not fill the water container beyond the maximum limit indicated.
- Do not use without water in the tank or without a tank.
- Only use the appliance indoors and at a maximum altitude of 2000 meters.
- Use only coffee beans to obtain the powder, do not put already ground coffee in the coffee bean hopper.
- Use the device only to prepare coffee-based drinks from grinding coffee beans or to dispense hot water. Other uses are improper.
- Use only original spare parts from the manufacturer. The use of spare parts not recommended by the manufacturer may cause fire, electric shock or injury to persons.
- Place the appliance on a flat, dry surface.
- Avoid wetting or spraying liquid on the appliance. In case of contact with liquid, immediately unplug the cord from the electrical outlet and dry thoroughly: Risk of electric shock!

To avoid the risk of injury, do not open the brew chamber during the brew process.

- Do not use abrasive cleaners or sharp objects to clean the appliance.
- The use of an accessory not evaluated for use with this appliance may cause injuries.
- Do not install the appliance in an environment that is not suitable.
- Do not place the appliance on or in proximity of electric or gas cookers, or in a heated oven.
- This appliance is not intended for use by persons (including children) with reduced physical, sensory, or mental capabilities, or lack of experience and knowledge, unless they are closely supervised and instructed concerning use of the appliance by a person responsible for their safety. Children should be supervised to ensure that they do not play with the appliance.
- Avoid contacting moving parts.
- This appliance has important markings on the plug blade. Contact a qualified technician to replace the plug with a suitable one if damaged.
- Connect the appliance only to a power outlet installed perfectly.

Electrical Cord:

- A short power-supply cord (or detachable power-supply cord) is provided to reduce risks resulting from becoming entangled in or tripping over a longer cord.
- Longer detachable power-supply cords or extension cords are available and may be used if care is exercised in their use.

- if a long detachable power-supply cord or extension cord is used:

1. The marked electrical rating of the detachable power-supply cord or extension cord should be at least as great as the electrical rating of the appliance;
2. If the appliance is of the grounded type, the extension cord should be a grounding-type 3-wire cord; and
3. The longer cord should be arranged so that it will not drape over the counter top or table top where it can be pulled on by children or tripped over.

Connect the appliance Make sure that the mains voltage corresponds with that indicated on the data plate on the bottom of the appliance. Connect the appliance only to a power outlet installed perfectly. If the plug and power outlet are incompatible, have the power outlet replaced with a suitable type by qualified staff. This user's manual is an integral part of the appliance and must be kept intact and available to the user throughout its life cycle. **Use compliant with destination**

- The appliance is intended for household and similar use, such as:
- in the kitchen area for the staff of shops, offices and other work environments;
- in bed and breakfast and agritourism accommodation;
- by guests at hotels and motels, and in residential environments.
- Other uses, in restaurants, bars and cafes for example, are improper.

Manufacturer's liability The manufacturer declines all liability for damage undergone by persons and objects due to:

- use of the appliance different from that envisioned;
- user manual has not been read;
- tampering of individual parts of the appliance;
- use of non-original spare parts;
- failure to comply with safety recommendations.

Identification plate The identification plate lists the technical data, serial number and brand name. The identification plate must never be removed. **Disposal:** Power voltage Risk of electric shock

- Unplug the appliance.
- Unplug the cord from the wall outlet.
- Old electrical equipment must not be disposed of with household waste! In accordance with the law in force, electrical appliances at the end of their life should be taken to separate collection facilities for electrical and electronic waste. This is so that valuable materials from old appliances can be recycled and the environment can be protected. For more information, please contact your local authorities or recycling center employees. Note that non-polluting and recyclable materials are used for packaging the appliance.
- Dispose of the packaging materials at appropriate differentiated waste collection centers.
- Do not leave the packaging or any part of it unattended.
- Do not allow children to play with the plastic packaging bags.

Controls

DESCRIPTION OF THE APPLIANCE

1. Machine body.
2. Coffee bean container lid.
3. Coffee bean container.
4. Water tank cover.
5. Water tank (1,4 l).
6. Grinding selection knob.
7. Grinders protection.
8. Brewing group access door.
9. ON/OFF button.
10. Control panel.
11. Height adjustable coffee dispenser.
12. Coffee grounds container.
13. Internal drip tray.
14. External drip tray with level indicator.
15. Brewing group.
16. Steam wand.





IDENTIFICATION PLATE The identification plate states the technical data, serial number, and marking. The identification plate must never be removed. **BEFORE FIRST USE**

- Unpack the appliance carefully and remove all packaging materials.
- Rinse the removable components with lukewarm water, such as: water tank (5) covers (2,4), door (8) grounds container (12) drip trays (13,14) and brewing group (15).

Before use, check that all components are integral and have no cracks. **ASSEMBLY OF COMPONENTS**

- Place the machine on a flat surface and fix the drip tray (14).
- Connect the power supply cable to the socket on the rear of the machine and the other end to a power socket.

DESCRIPTION OF CONTROLS AND ALARMS ON/OFF button (9) Pressing the button switches the machine on or off. **Change dispensing program button (20)** The product has 8 functions, accessible through two menus, Primary Menu and Secondary Menu. By pressing this button it is possible to change the dispensing menu from “Primary” and “Secondary” and vice versa.

Primary	Keys LED white
 16	Ristretto coffee
 17	Espresso coffee
 18	Coffee
 19	Hot water
Secondary	Keys LED orange
 16	Light Ristretto coffee
 17	Light Espresso coffee
 18	Long coffee
 19	Steam function

Empty water tank alarm (21) The related LED flashes when the tank (5) is absent, or when the water inside it is missing or at an insufficient level. Insert the tank or fill it with water. **No coffee alarm (22)** The relative LED lights up steadily indicating that the coffee beans in the container (3) have reached the minimum level or are absent. Fill the container with coffee beans. **Coffee grounds container alarm (23)** Steady lit LED: Coffee grounds container full (12); empty the container. **Flashing LED:** Coffee grounds container (12) or internal drip tray (13) missing or incorrectly assembled; the machine is blocked until the components are correctly reassembled. **Brewing group alarm (24)** Steady lit LED: Brewing group missing or not correctly inserted; the machine is blocked until the brewing group (15) has been reassembled correctly (15). Flashing LED: Brewing group access door (8) not correctly assembled; the machine is blocked until the door is correctly reassembled (8). **Descaling alarm (25)** Steady lit LED: Indicates that it is highly recommended to carry out a descaling cycle; **Flashing LED:** The machine is blocked in all its functions, a descaling cycle is mandatory to restore machine operation. **Grinding adjustment knob (6)** (Fig. D) The appliance is equipped with a knob (6) that allows you to adjust the grinding grain of the coffee according to its uses: Turning the knob (6) clockwise "A" increases the grinding grain; turning the knob (6) anticlockwise "B" decreases the grinding grain and the ground coffee will be finer (Fig.D). Turn the knob (6) and match the indicator (26) with the desired grinding level. **WARNING:** The grinding grain adjustment must be carried out when the grinder is in operation or on first use when the bean container is completely empty; turning the knob (6) with the grinder stopped and the beans inside could damage the grinding unit.

USE

USE (Fig. E-F-G-H)

- Lift the lid (4) and insert cold water into the tank (5) taking care not to exceed the 'Max' level indicated, then refit the lid (4).
- Lift the lid (2) and insert coffee beans into the container (3).
- Check that the drip tray (14) is correctly positioned.
- Press the button (9) , the machine starts the heating phase and the keys light up flashing in sequence. At the

end of the heating, a self-cleaning cycle of the internal circuits is carried out and, once the cycle is finished, the machine is ready to be used.

At the first use it is recommended to make at least one coffee to make a complete break-in of all the circuits. After 20 minutes of non-use, the machine switches off. If it has made at least one coffee, it performs a self-cleaning cycle. Press the button (9) to switch on the machine. **Change of dispensing program:** The machine has two dispensing menus in its memory: Primary and Secondary. To switch from one program to another, press the key (20). In the Primary menu all the keys are illuminated in white, in the Secondary menu, all the keys are illuminated in orange. For the specific functions of each menu, refer to the paragraph "DESCRIPTION OF CONTROLS AND ALARMS". Turning off the machine the setting of the Primary or Secondary dispensing menu remains in the memory at the next restart. **Dispensing a drink**

- It is possible to adjust the position of the dispenser (11) according to the cup used. For very high cups it is possible to remove the drip tray (14).
- Place a cup or large cup under the dispenser.
- Press the key for the desired function. For each selected function, preparation stops automatically. For specific functions, refer to the paragraph "DESCRIPTION OF CONTROLS AND ALARMS".
- At the end of dispensing, all the keys light up fixed.

Dispensing can be stopped at any time by pressing the dispensing key again. Remember to reassemble the tray (14) at the end of any dispensing. It is completely normal that after a prolonged inactivity of the machine (breaks longer than 20 min) the first coffees are not at the right temperature. The tips to obtain a hot coffee immediately are given in the section "What to do if..." **Steam delivery**

- Enter the "Secondary" dispensing program.
- Make sure that the tray (14) is correctly assembled.
- Press the button (19) which starts flashing. Wait for the steam to reach the correct supply temperature, identified by the fixed lighting of the button (19).
- Place a container (31) under the steam wand (30) with about 100 grams of milk for each cappuccino you want to prepare. Then press the button (19) to start dispensing the steam and at the same time rotate the container (31) with slow movements from the bottom upwards in order to correctly froth the milk (Fig.M).

The result of the steam function can be influenced by the ingredients used. For a good result, we recommend using partially skimmed milk or whole by removing it from the fridge immediately before pouring it into the container. To avoid obtaining a little frothed milk, or with big bubbles, always clean the cappuccino cleaner as described in the paragraph "Cleaning and maintenance".

- The maximum continuous steam delivery time is two minutes, if you want to stop the delivery before the automatic stop, press the button (19) again.
- After the automatic stop, steam delivery can be restarted by pressing the button (19)
- After heating the milk, clean the inside of the steam wand by dispensing steam for a few seconds, making sure that the tray (14) is fixed to the machine.
- Clean the steam wand every time you use it, to avoid milk residues or clogging. For a complete cleaning of the steam wand see paragraph "Cleaning and maintenance".
- A manual rinse cycle is recommended at the end of each use of the steam function.

Customization of the quantity It is possible to customize, for each type of dispensing, the quantity of coffee or water dispensed.

- Place a cup or large cup under the dispenser.
- Press for at least 3 seconds one of the keys relative to the drink to be dispensed. The selected key lights up flashing; the machine emits a double sound to signal the modification of the preset program.
- On reaching the desired quantity, stop dispensing by pressing the key again; an acoustic signal indicates the memorization of the quantity.



Any customization of the drinks remains saved for future dispensing. To restore the manufacturer's settings, press the keys (9) and (20) simultaneously for at least 3 seconds. The machine emits a single sound to signal the restoration of the factory settings. **Turning off the machine**

- Check that the drip tray (14) is positioned correctly.
- If there is no water, the machine remains in the rinse position until the tank is filled.
- Press the button (9) , the keys (16), (17), (18), (19) light up flashing in sequence and the machine, if it has dispensed at least one coffee, performs a self-cleaning cycle. At the end of the self-cleaning cycle, the machine switches off.

Use / Cleaning and maintenance

MACHINE SETTINGS (Fig. C-G) Through a programming menu it is possible to set the water hardness and the acoustic signals. Activation / deactivation of acoustic signals. The acoustic signals can be disabled / enabled by keeping the keys (17) (20) pressed for three seconds; the key (17) flashes three times indicating the memorization of the setting. Setting the water hardness. To access the water hardness programming, press the keys (16) simultaneously for at least 3 seconds, the LEDs (21) , (22) , (23) light up flashing.

- Choose the water hardness, referring to the following table, pressing the key (16) , the LED relating to the selected hardness lights up steadily, the others go off.

Led	Hardness
 21	Light
 22	Medium
 23	Hard

- To memorize the selected hardness, press keys (16) and (20) simultaneously for at least 3 seconds or do not press any key for 15 seconds.

To prolong the machine operation and preserve the aroma and taste of the coffee, it is recommended to use the Smeg Softener Filter (optional, not supplied). For installation and operation, follow the instructions that accompany the accessory. Once installed, set the water hardness level to 'Light' following the instructions in the previous paragraph. **CLEANING AND MAINTENANCE**

- Make sure that the Primary program is selected with keys (16), (17), (18), (19) illuminated in white.
- With the machine ready to dispense and the drip tray mounted, press the keys (20) and (19) simultaneously for at least 3 seconds: the machine will rinse the coffee circuit (coffee dispenser 11) and the water circuit (steam wand). At the end of the washing cycle, the keys light up steadily.

Cleaning of the machine body For a good preservation of the external surfaces it is necessary to clean them regularly at the end of each use, after letting them cool. Clean with a soft cloth dampened with water.

- Never immerse the machine body (1) in water or other liquids.
- Allow the machine to cool down before cleaning.

Cleaning the external drip tray (14) The drip tray (14) is equipped with a red float (27) which protrudes from the cup-holder grid as soon as the maximum liquid level is exceeded.

- Remove the tray (14) and the cup-holder grid (28) and empty it.
- Clean the tray (14) and the grid (28) in running water with neutral dish detergent.
- Dry the components and reassemble them in the machine.

Cleaning the coffee grounds container (12) and internal tray (13) Always empty the coffee grounds container with the appliance switched on. This is the only way of resetting the coffee grounds counter.

- Remove the tray (14).
- Remove the grounds container (12) with its tray (13) by pulling it outwards.
- Empty the coffee grounds from the container (12).
- Clean the container (12) and the tray (13) in running water with neutral dish detergent.
- Dry the components and reassemble them in the machine.

Daily cleaning of the coffee grounds container and internal tray is recommended. **Cleaning the water tank (5)**

- Remove the lid (4) and remove the tank (5) from the machine using the appropriate handle.
- Clean the tank (5) in running water with neutral dish detergent and reassemble it in the machine.

Cleaning the brewing group (15) Before performing this cleaning operation, ALWAYS disconnect the plug from the power outlet.

- Press the door (8) in the lower part until it releases then remove it from the upper part.
- Press the two release clips (29) located on the sides of the infuser (15) and remove it from the machine (Fig.L).
- Wash the brew group (15) with running water, dry it and reassemble it in the machine, making sure it is positioned correctly.
- Refit the service door (8) making sure it is correctly positioned.
- Do not wash the brewing group in the dishwasher in order not to damage it permanently.

Steam wand cleaning (30)

- Wait for the steam wand (30) to cool before operating.
- Remove the lower part (34) of the steam wand by turning it anticlockwise to release it then pull it downwards.
- Clean with running water and reassemble everything in the reverse order.

Descaling The coffee machine signals when it is necessary to carry out a descaling cycle based on the set water hardness (For the setting of the water hardness, see the “Machine Settings” paragraph). If the LED (25) lights up steadily, it means that a descaling cycle is necessary, so as not to alter the taste of the coffee and damage the







machine. However, coffee and further drinks may continue to be dispensed for a limited number of cycles. If the LED (25) flashes, it means that a descaling cycle is mandatory to proceed with further dispensing of drinks. To carry out a descaling cycle, proceed as follows:

- Place a container with a capacity of at least 1.4l under the dispenser (11) and the steam spout (30).
- Make sure that the Primary program with white illuminated keys is selected.
- Fill the tank (5), up to the "MAX" level, with a solution of water and descaler in the doses recommended by the manufacturer. With the machine ready for use, press the keys (20) and (18) simultaneously for at least 3 seconds. The key (18) flashes with an orange light and the LED (25) has a fixed light for the entire duration of the descaling cycle, which has duration of several minutes.
- The descaling cycle ends when the solution contained in the tank (5) is finished, the key (18) and the LEDs (21) and (25) light up fixed.
- During the descaling cycle, the machine will take a few breaks to allow the descaler to act effectively. Wait for the end of the cycle.
- Pour clean water into the tank (5) up to the "MAX" level to carry out the rinse cycle, then press the button (18) to start the rinse cycle, the button (18) flashes and the LED (25) lights up steadily for the entire duration of the rinsing cycle.
- When the tank (5) is empty, the rinse cycle is finished.
- The keys light up in white.

If, at the end of the descaling process, the LED (25) remains permanently lit, it indicates that a new descaling cycle must be carried out since the quantity of descaling solution that was used was insufficient for complete cleaning. Any other servicing should be performed by an authorized service representative. **"Empty system" procedure** The 'Empty system' procedure is recommended before long periods of non-use and before consulting a maintenance manager.

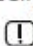
- Activate the procedure by holding down the key (16) and the key (19) simultaneously for three seconds, the key (17) and the key (19) flash simultaneously.
- The entire quantity of water in the tank is drained through the coffee circuit and the steam spout.
- The pump continues to operate, even intermittently, to also empty the internal water circuits.
- At the end of the procedure the machine switches off

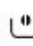
The empty system procedure takes several minutes and on-off cycles. Do not turn off the machine until the complete procedure is complete.

Problem	Possible causes	Solution
The appliance does not work.	Plug not inserted.	Insert the plug.
	ON/OFF button not pressed.	Press the button to start the machine.
	Descaling alarm activated (LED 25  flashes).	Perform descaling.
	Full grounds container alarm (LED 23 ).	Empty the grounds container.
	Infuser alarm missing or not correctly assembled (LED 24 ).	Check that the infuser and its door are correctly assembled.
	Empty or missing tank alarm (LED 21 ).	Make sure that the tank is correctly inserted or fill it with water.
The machine stops during dispensing.	No coffee alarm (led 22 ).	Pour some coffee beans into the container.
	Tank not inserted or empty.	Make sure that the tank is correctly inserted or fill it with water.
The coffee comes out of the dispenser slowly.	Ground coffee too fine.	Increase the coffee grain using the relative knob. Warning: adjust the grinder only when it is operating, in order not to damage the grinding unit.
	Clogged dispenser spout.	Clean the dispenser spout.
The coffee comes out of the dispenser too quickly.	Ground coffee too thick.	Decrease the coffee grain using the relative knob.
	Worn grinders.	Contact an authorized service centre.
The coffee is not hot.	Machine inactivity for a prolonged time.	Using the same cup in which the coffee will be prepared, dispense hot water to heat the cup.
The steam is not dispensed.	Dispensing temperature not reached.	Wait for the temperature to be reached with the button (19)  lit steadily.
Locked drawer.	Incorrect use of the machine.	Check lights or switch the machine off and on.
All the buttons are blinking simultaneously.	Internal water circuit error.	Make sure there is water in the tank and wait for the circuit to reset If the problem persists, contact the service center.

SPECIFICATIONS

Product Name	Smeg BCC02 Fully Automatic Coffee Machine
Intended Use	Household use only
Safety Features	Grounded plug, safety alert symbol, safety messages, safety instructions, important safeguards, and warnings
Maximum Altitude	2000 meters
Power Source	Electricity
Water Tank Capacity	Not specified
Coffee Bean Hopper Capacity	Not specified
Material	Not specified
Dimensions	Not specified
Weight	Not specified

FAQS

What is the Smeg BCC02 Fully Automatic Coffee Machine designed for?

The Smeg BCC02 Fully Automatic Coffee Machine is designed for household use only and should not be used for any other purpose.

What should I do before using the appliance?

It is advised to read the user manual carefully before using the appliance to ensure safe and proper usage.

Can children use the appliance?

No, children should not use the appliance. Keep the appliance out of the reach of children.

Can I repair the appliance myself?

No, never attempt to repair the appliance yourself or without the help of a qualified technician. Failing to do this will void the warranty.

Can I use already ground coffee in the coffee bean hopper?

No, use only coffee beans to obtain the powder, do not put already ground coffee in the coffee bean hopper.

Can I place the appliance near heat sources?



No, do not place the appliance on or near switched-on gas or electric burners, inside an oven, or near heat sources.

Can I use abrasive cleaners to clean the appliance?

No, do not use abrasive cleaners or sharp objects to clean the appliance.

Can I install the appliance in an unsuitable environment?

No, do not install the appliance in an environment that is not suitable.

 	<p>smeg BCC02 Fully Automatic Coffee Machine [pdf] User Manual BCC02, BCC02 Fully Automatic Coffee Machine, Fully Automatic Coffee Machine, Coffee Machi ne</p>
--	---