



## SMEDBO Outline Sensor Activated LED User Manual

[Home](#) » [SMEDBO](#) » SMEDBO Outline Sensor Activated LED User Manual 



## Contents

- [1 Information & safety](#)
- [2 Indication light info](#)
- [3 Mounting instructions, screw fitting](#)
- [4 Mounting instructions, glue fitting](#)
- [5 How to charge the battery](#)
- [6 Mounting instructions, hardwired](#)
- [7 Mounting instructions, screw fitting](#)
- [8 How to charge the battery](#)
- [9 Test and certification](#)
- [10 Documents / Resources](#)
- [11 Related Posts](#)

## Information & safety

### Congratulations on your new bathroom mirror!

We hope you will enjoy it very much. Before you begin to install the mirror, please carefully read and follow the instructions.

- The mirror should be placed according to the requirements for bathroom and in the correct zone according to IP21.
- Do not use the mirror outdoors.
- Make sure the power source complies with the product specifications.
- Do not let children play with the mirror.
- The mirror comes with an uncharged battery and it takes about 5 hours to fully charge.

### Kelvin:

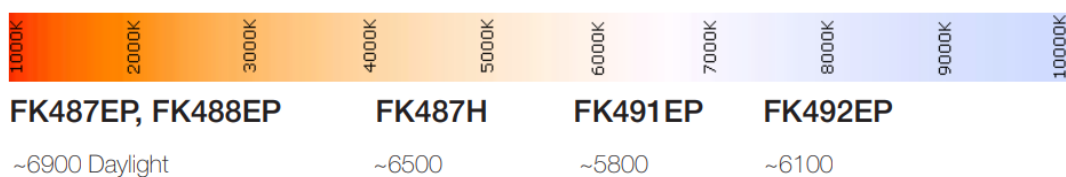

### Lumen:

FK487EP, FK488EP, FK487H	FK491EP	FK492EP
58 Light	68,25	65,36







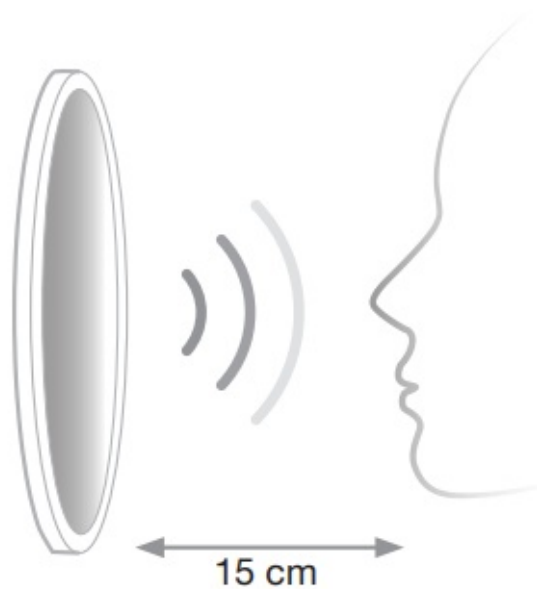

### The light in your mirror!

LED light ring and a built-in sensor that lights up automatically when moving close to the mirror. The LED light ring has an estimated life span of 50 000 h.

### Sensor activated LED







The sensor is activated at a distance of 15 cm, it will turn off automatically after 12 seconds without use.

	Premium LED/wall mount
	Premium LED/freestanding
	Sensor activated
	USB cord enclosed
	Rechargeable battery included
	Main switch ON/OFF
	7X magnification
	Screw or glue. Glue is not included.
	Hardwired installation

	Power indicator
-----------------------------------------------------------------------------------	-----------------

Indication light info

	No light ar normal use		Please charge when red light flashes
	One blue flash when turning on		Pulses red light when charging
	One red flash when turning off		Blue light when fully charged

Caution!

	Avoid sunlight
------------------------------------------------------------------------------------	----------------

Important!

Tighten screws and retighten later if needed.

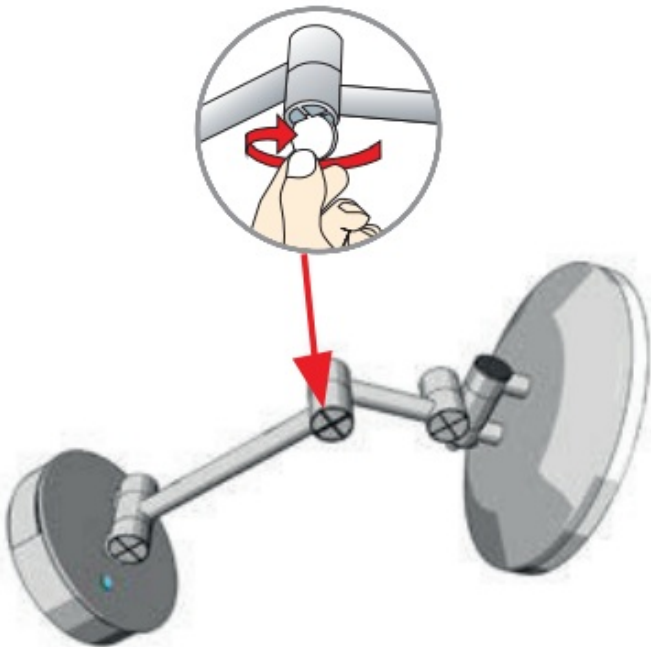

Care instructions!

Wipe with a slightly damp cloth.



Mounting instructions, screw fitting

### FK487EP

Dismantel the bracket using the allen key.

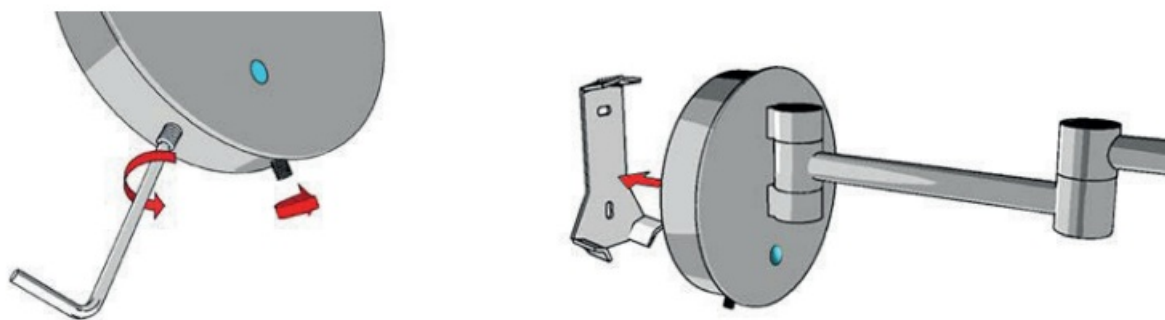

Drill two holes Ø5 mm and fix the brackets to the wall using the plugs and screws.

Check that the bracket is tightly fixed. Before drilling, make sure you have measured the distance between the wholes carefully.

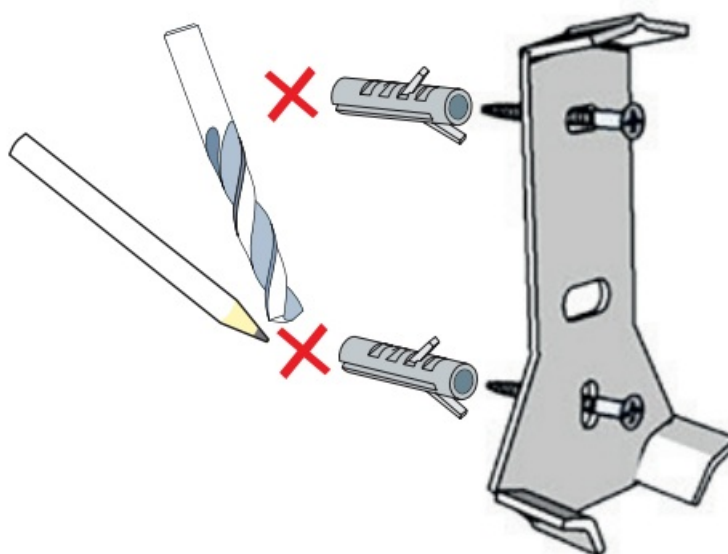

Fasten the hexagonal screw with the allen key. Switch on.



Tighten screws and retighten later if needed.

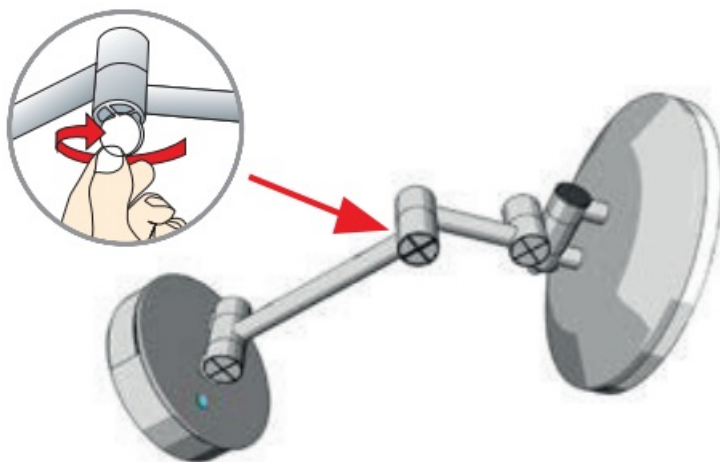

## Mounting instructions, glue fitting

### FK487EP

Dismantel the bracket using the allen key.

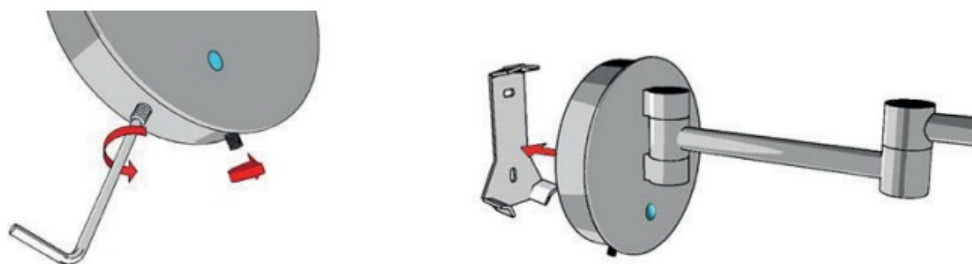

Carefully follow the instructions for assembly and safety provided by the glue manufacturer.

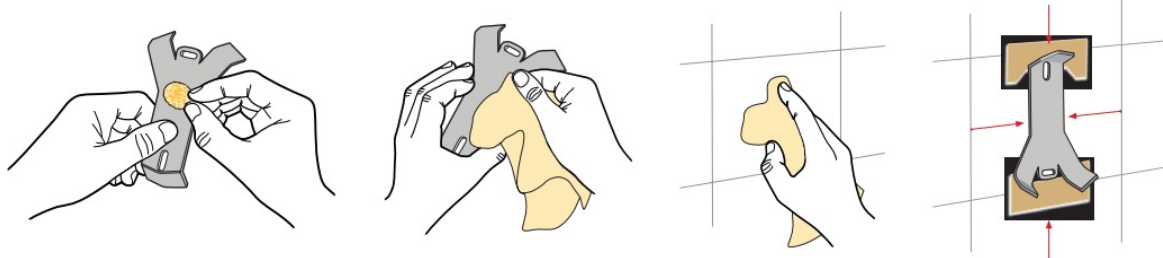

Fasten the hexagonal screw with the allen key.  
Switch on.

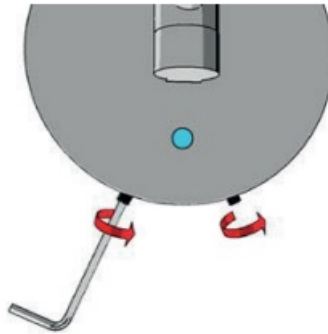
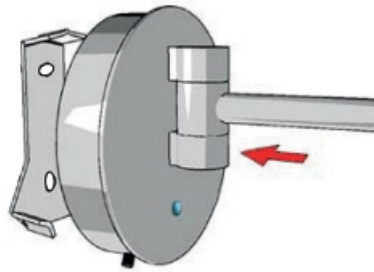

Tighten screws and retighten later if needed.

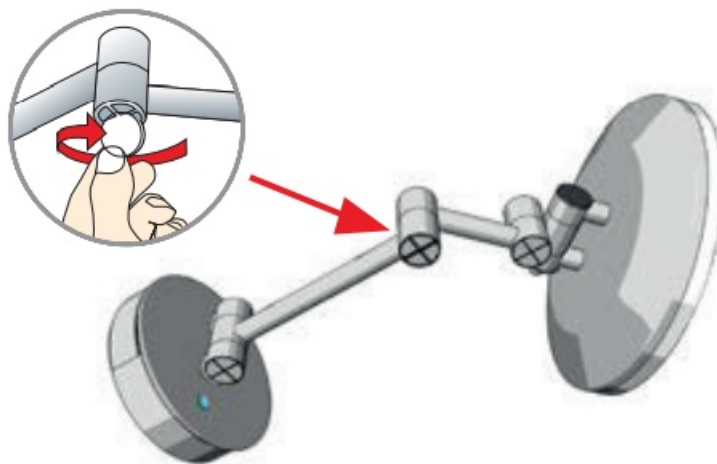

## How to charge the battery

### **FK487EP/ FK488EP**

Rechargeable battery, charge with USB.

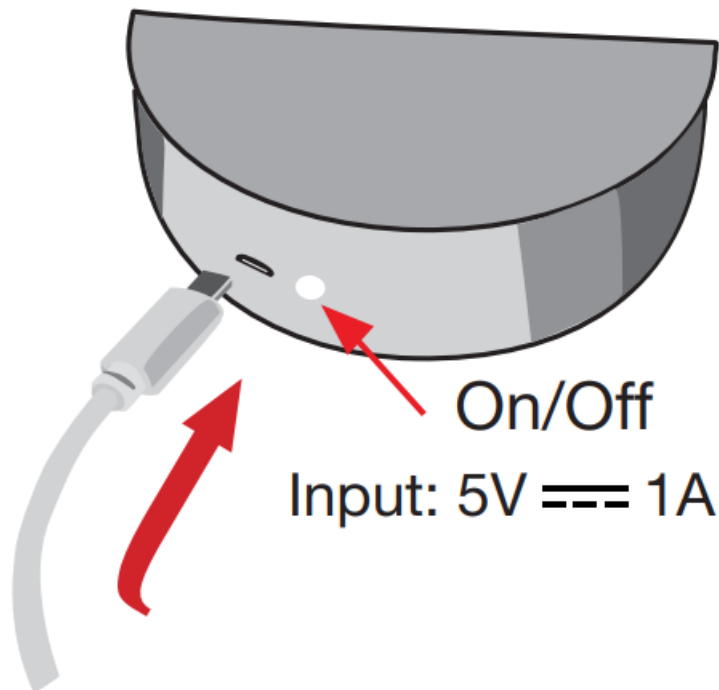

### Mounting instructions, hardwired

FK487H



#### Important!

Electrical installations must be performed by an authorized electrician.  
Dismantel the bracket using the allen key.

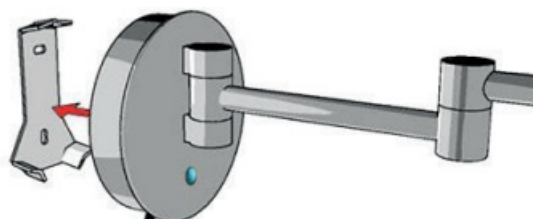



Drill a hole of Ø50 mm and 15 mm dept to the wall.

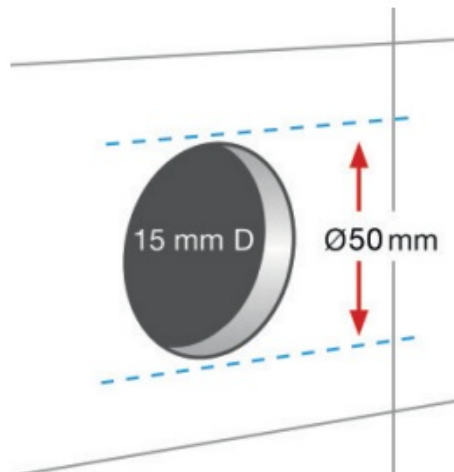

Drill two holes Ø5 mm and fix the brackets to the wall using the plugs and screws. Check that the bracket is tightly fixed. Before drilling, make sure you have measured the distance between the wholes carefully.

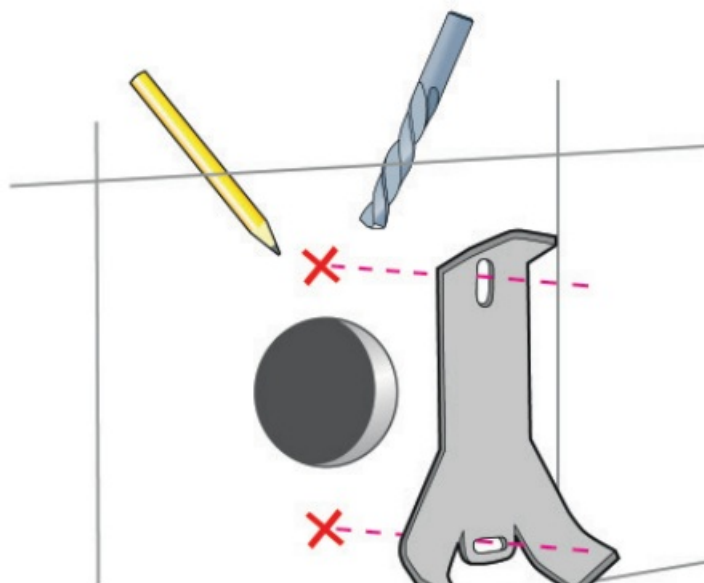

Fix the brackets to the wall using the screws and make sure the bracket is tightly fixed.

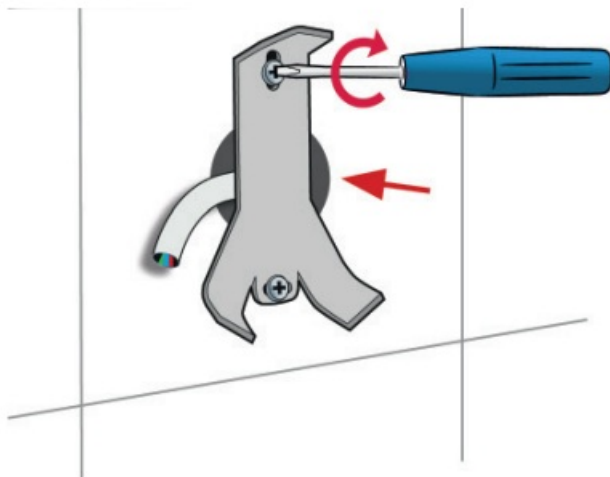

Fasten the hexagonal screw with the allen key. Plug into the main socket and switch on.

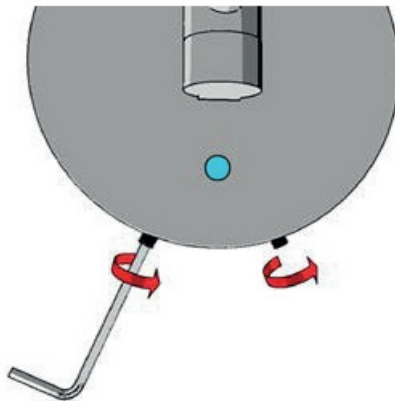
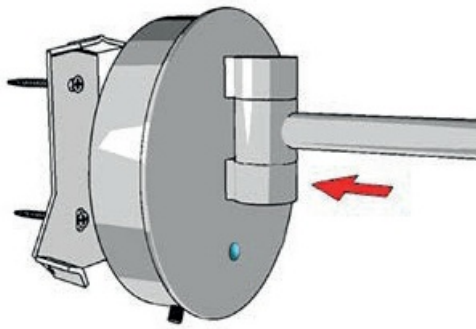

Tighten screws and retighten later if needed.

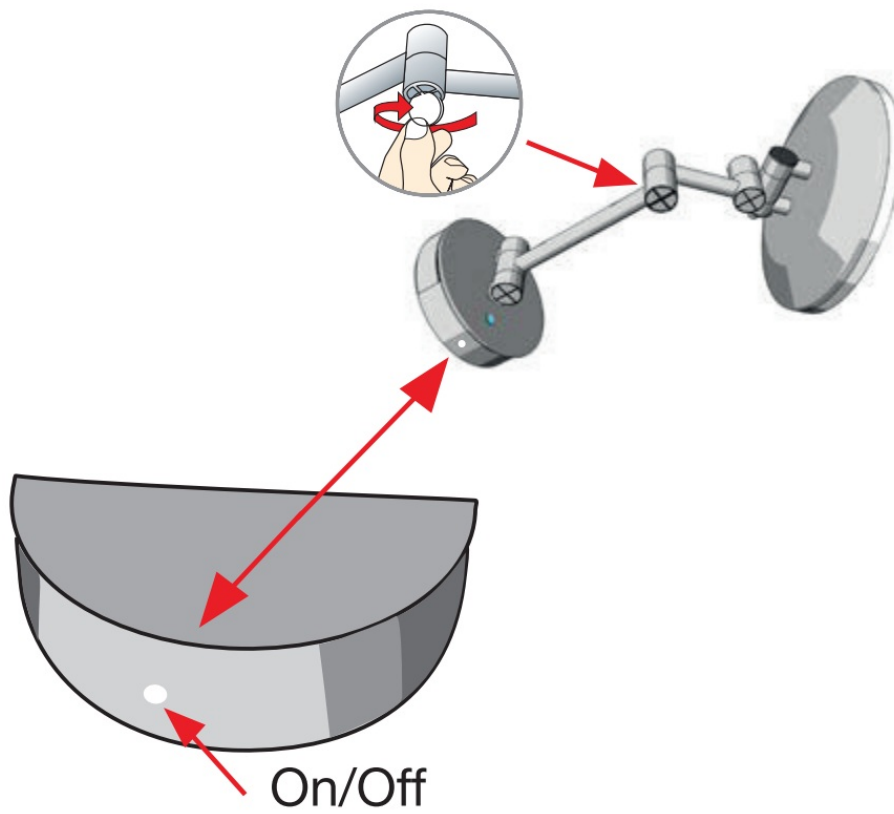

**Mounting instructions, screw fitting**

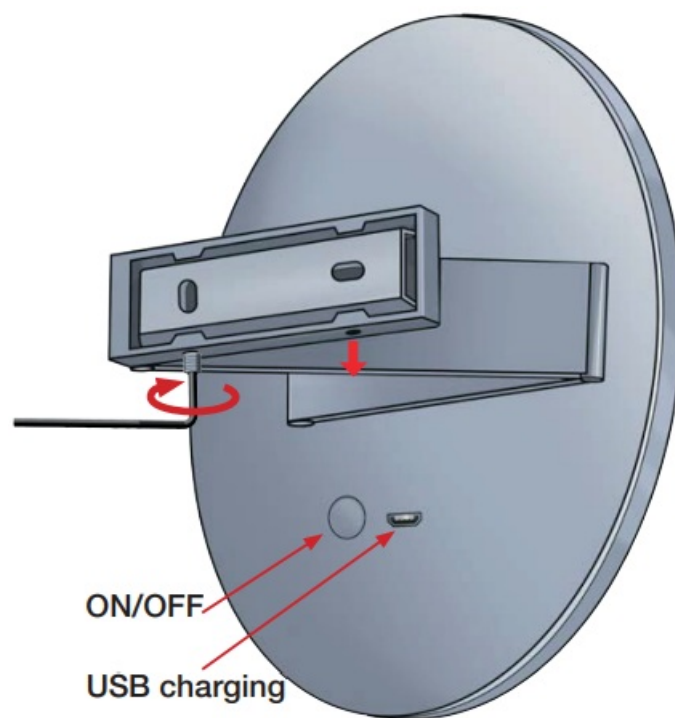

Dismantel the bracket using the allen key.

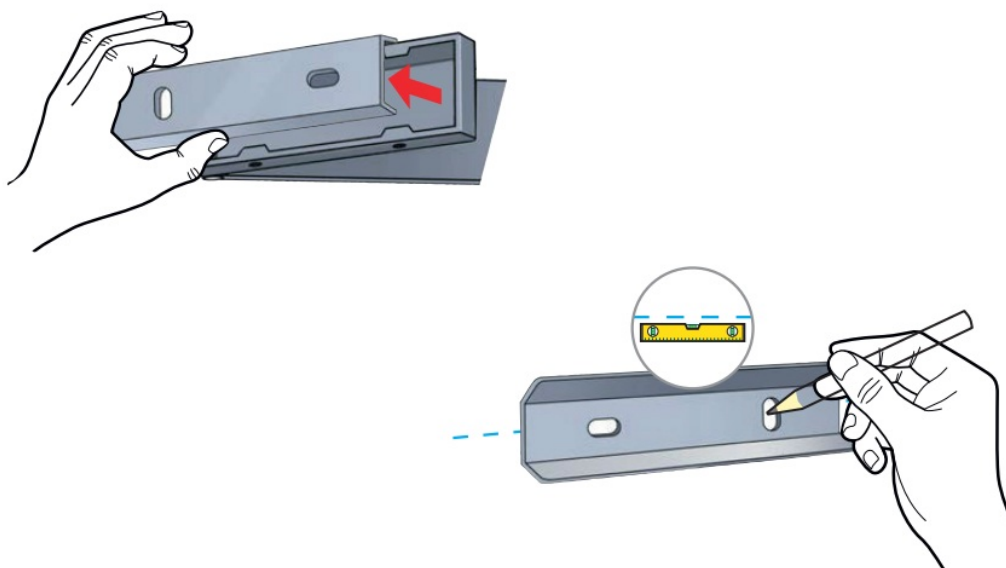

Drill two holes Ø5 mm and fix the brackets to the wall using the plugs and screws. Check that the bracket is tightly fixed. Before drilling, make sure you have measured the distance between the wholes carefully.

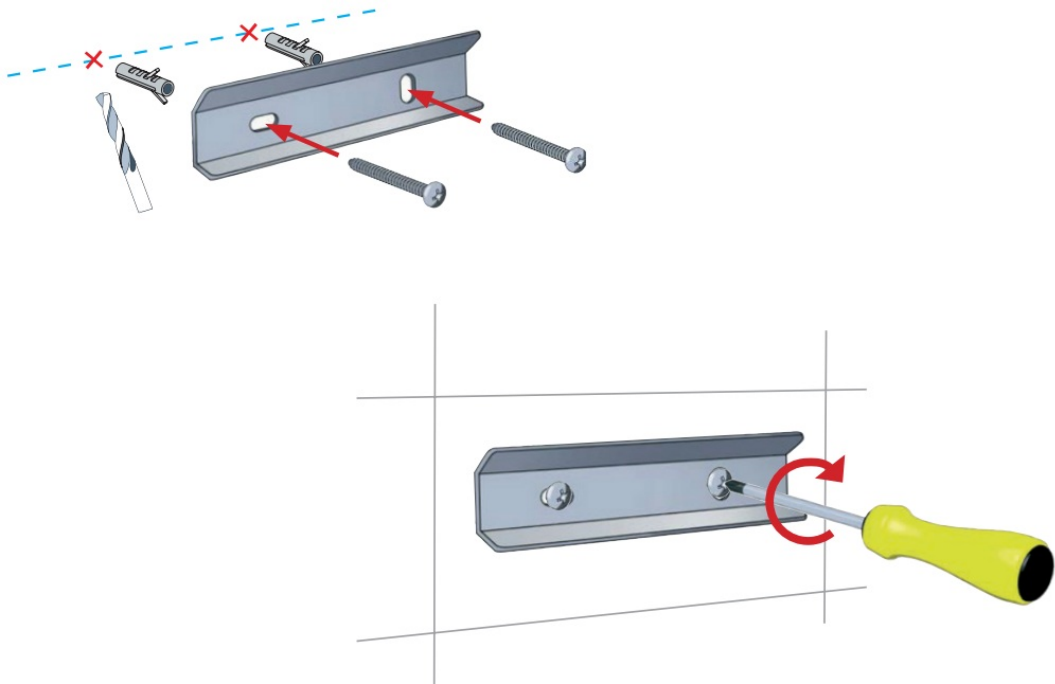

Fasten the hexagonal screw with the allen key. Plug into the main socket and switch on.

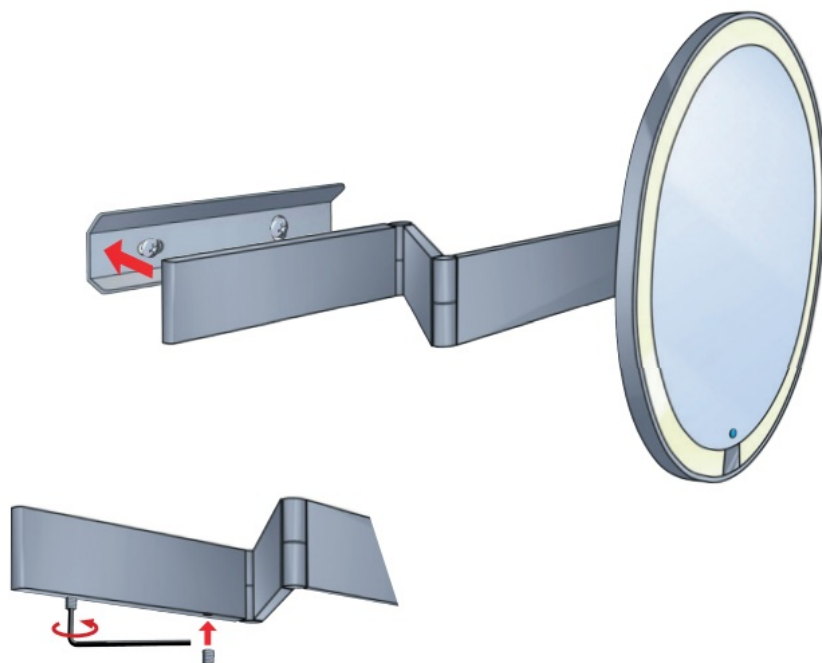

### How to charge the battery

#### FK491EP/ FK492EP

Rechargeable battery, charge with USB.

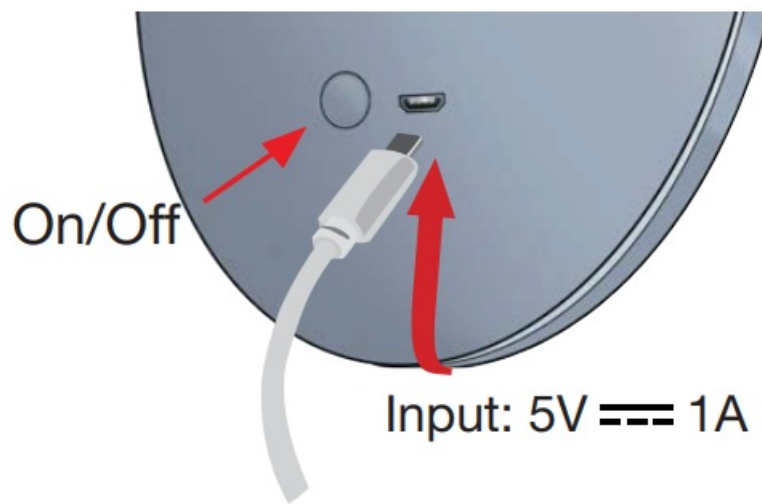

## CE Test and certification

Tested and approved by TÜV SYD (FK487EP, FK488EP), TÜV Rheinland (FK487H, FK491EP, FK492EP).

## Warranty



Made in solid brass with a genuine construction and classic design



Smedbo bathroom products comes with a 10-Year consumer warranty

## Recycling



Please recycle the outer package as card board, inner package as plastic and the mirror as electronics. Leave batteries in the proper container at your nearest recycling yard.



 **SMEDBO**

SMEDBO AB HEAD OFFICE BOX 13063 250 13 HELSINGBORG SWEDEN TEL +46 42 25 15 00 FM: +46 42 25 1  
E-MAIL: INFO@SMEDBO.SE  
[WWW.SMEDBO.NET](http://WWW.SMEDBO.NET)

UNITED KINGDOM SMEDBO PHONE: 0114 276 0707  
FAX: 0114 272 0499  
E-MAIL: [UK.SALES@SMEDBO.COM](mailto:UK.SALES@SMEDBO.COM)  
[WWW.SMEDBO.CO.UK](http://WWW.SMEDBO.CO.UK)

DEUTSCHLAND SMEDBO GMBH AN DER STRUSBEEK 68 D-22926 AHRENSBURG  
TEL: 04102-2208-0 FM: 04102-2208-22  
E-MAIL: [INFO@SMEDBO.DE](mailto:INFO@SMEDBO.DE)

**X1710**  
**E60548700REVG**

## Documents / Resources

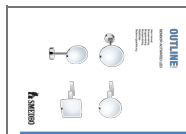

[SMEDBO Outline Sensor Activated LED](#) [pdf] User Manual  
Outline, Sensor Activated LED, Activated LED, Sensor LED, LED