

smartwares®
SHW-90302
Built in
Smart Switch



smartwares SHW-90302 Built in Smart Switch Instruction Manual

[Home](#) » [smartwares](#) » smartwares SHW-90302 Built in Smart Switch Instruction Manual 

Contents

- 1 smart wares SHW-90302 Built-in Smart Switch
- 2 Product Specifications
- 3 Product Information
- 4 Product Usage Instructions
- 5 FAQ
- 6 Preparation before use
- 7 CONNECTION INSTRUCTION
- 8 Mounting the receiver
- 9 PAIRING INSTRUCTION
- 10 RESETING INSTRUCTION
- 11 Specifications
- 12 Documents / Resources
 - 12.1 References
- 13 Related Posts

smartwares®

smart wares SHW-90302 Built-in Smart Switch



Product Specifications

Frequency: 2.4 GHz 433.92MHz

Product Information

The SHW-90302 is a wireless light switch conversion kit that allows you to convert your existing wired light switches into wireless ones. With the ability to control your lights remotely, this kit offers convenience and flexibility in managing your home lighting.

Product Usage Instructions

Preparation Before Use:

1. Locate the circuit breaker control for the wall switch you will be working on and switch the circuit off.
2. Remove the wired light you want to make wireless and disconnect the power supply wires.

Connecting a Wired Wall Switch (Optional):

1. Connect the black wire from the wall switch to the S1 connection on the built-in receiver to switch lamp 1 on.
2. If you want to connect a second wall switch, connect the black wire from the wall switch to the S2 connection on the receiver to switch lamp 2 on.
3. Note: If any wires are missing, additional cables need to be pulled.

Resetting Wi-Fi Connection:

To reset the Wi-Fi connection, press and hold the pairing button for more than 5 seconds and less than 10 seconds. The LED will start flashing quickly.

Resetting (433MHz):

Press and hold the button for more than 10 seconds to reset senders (433MHz). The LED will start blinking in 5-10 seconds and turn off after the reset is complete.

FAQ

How do I know if the reset for senders (433MHz) is successful?

The LED indicator will stop blinking once the reset process is finished, indicating a successful reset of the senders (433MHz).

Preparation before use

In your electrical circuit panel, locate the circuit breaker control for the wall switch you will be working on. Switch the circuit off. Remove the wired light you want to make wireless and disconnect the wires for the power supply.

CONNECTION INSTRUCTION

Connecting the built-in switch to the power supply

Connect the phase wire (brown) to L and connect the neutral wire (blue) to N. (Fig. 1)

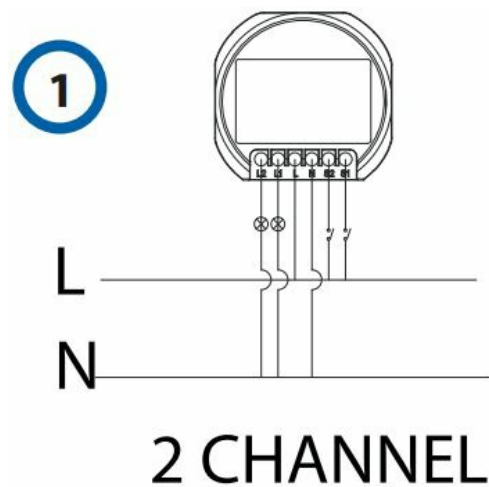

Connecting the built-in switch to the lamp

- Connect the black wire from the lamp 1 to L1
- If you want to connect a second lamp, connect the black wire from lamp 2 to L2

(Optional) Connect a wired wall switch

- Connect the black wire from the wall switch to the S1 connection on the built-in receiver, to switch lamp 1 on.
- If you want to connect a second wall switch; connect the black wire from the wall switch to the S2 connection on the built-in receiver, to switch lamp 2 on. (Fig. 1)

Note: If any of the wires are missing on the desired spot, extra cables need to be pulled.

Mounting the receiver

Mount the receiver to the desired spot (lamp fitting, mounting- or junction box) and switch on the main power in your electric circuit panel.

PAIRING INSTRUCTION

Pairing with Wi-fi

Pairing the receiver with your smartphone

Note: Please enable Bluetooth and GPS location functions on your smartphone before pairing. (Fig. 2 & 3)

- Download the Connected at Home app from the Apple App Store or Google Play Store.
- Register or log in with your existing account.
- Press [Add Device] or the + button to add the device.
- Press and hold the button for more than 5 seconds and less than 10 seconds 2, the LED starts flashing quickly 3, the device is now in Wi-Fi pairing mode. Note: during this process, the previous setting of Wi-Fi will be removed, previous paired senders (433MHz) will not be removed.
- Choose a built-in Wi-Fi receiver by pressing the + button.
- Follow the instructions in the app for connecting with Wi-Fi.
- The receiver can now be controlled using the app.

Note: The receiver can also be controlled via Alexa or Google Assistant, follow the instructions for third-party services under “Me” in the app.

2

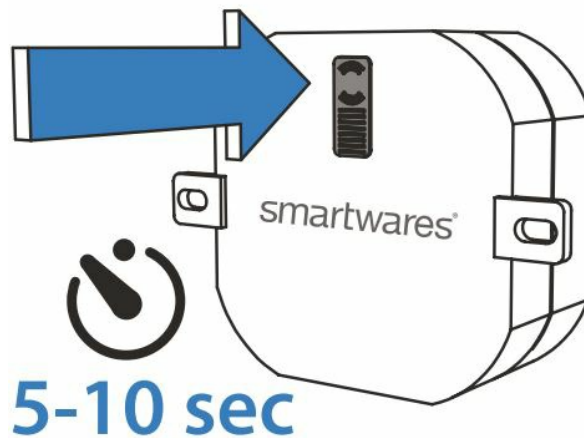

3

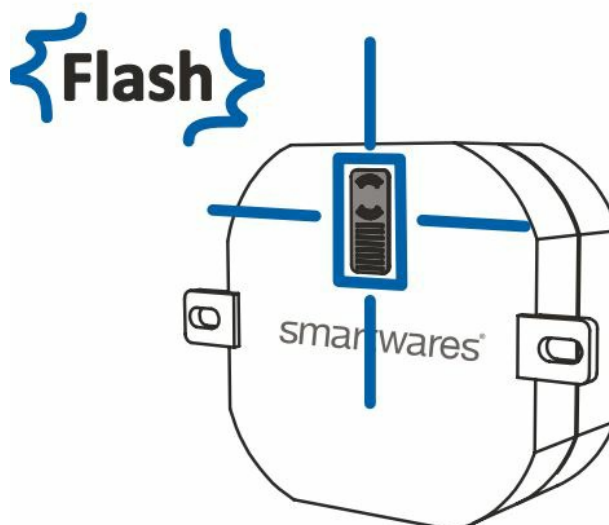

Pairing with senders (433Mhz)

- Press the button on the receiver once shortly. The LED on the receiver will light up. Your receiver is now switched to 433Mhz pairing mode for Lamp 1.
- Repeat these steps to connect a second lamp.
 - Press the on-button on the sender (see the instructions given in the manual for the sender).
 - The LED on the receiver will turn off.
 - Your receiver and sender are now paired.
- The built-in receiver has 8 memory slots per channel, you can pair up to 8 different senders.

RESETTING INSTRUCTION

Resetting Wi-fi connection

To reset the Wi-fi connection, press and hold the pairing button for more than 5 seconds and less than 10 seconds. After 5 seconds, the LED starts flashing quickly. (Fig. 2)

Resetting (433MHz)

Reset for senders (433MHz): Press and hold the button for more than 10 seconds (Fig. 4) to remove all Senders (433 MHz). LED starts blinking in 5-10 seconds and will be off after the Reset is finished.

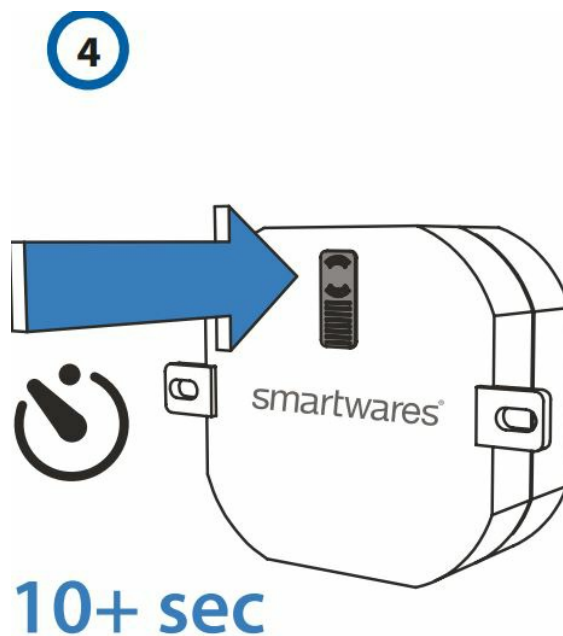

Specifications

- **AC Input Voltage:** 220 – 240 V~50Hz.
- **Maximum distance:** 30 m.
- **Maximum power:** 1000 W.
- **Maximum RF output:** 20dBm
- **Operating temperature:** 0-35 °C.

Documents / Resources

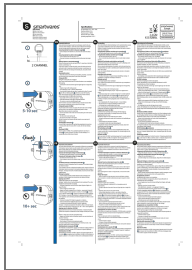

[smartwares SHW-90302 Built in Smart Switch](#) [pdf] Instruction Manual
90302, SHW-90302, SHW-90302 Built in Smart Switch, SHW-90302, Built in Smart Switch, Smart Switch, Switch

References

- [User Manual](#)

[Manuals+](#), [Privacy Policy](#)

This website is an independent publication and is neither affiliated with nor endorsed by any of the trademark owners. The "Bluetooth®" word mark and logos are registered trademarks owned by Bluetooth SIG, Inc. The "Wi-Fi®" word mark and logos are registered trademarks owned by the Wi-Fi Alliance. Any use of these marks on this website does not imply any affiliation with or endorsement.