



smartwares SH4-99578 Wireless Switch Set Instruction Manual

[Home](#) » [smartwares](#) » smartwares SH4-99578 Wireless Switch Set Instruction Manual 

Contents

- [1 smartwares SH4-99578 Wireless Switch Set](#)
- [2 Specifications](#)
- [3 PREPARATION BEFORE USE](#)
- [4 OPERATING RECEIVERS](#)
- [5 Documents / Resources](#)
- [6 Related Posts](#)



smartwares SH4-99578 Wireless Switch Set



Specifications

Remote control (SH4-90151)

- **Battery:** 3VDC, type CR 2032 (incl.)
- **Radio Frequency:** 433.92Mhz
- **Maximum output:** 0dBm
- **Maximum range:** 30m

EU plug (SH4-99578)

Maximum power: 2300 W

AC input Voltage: 230V ~ 50Hz

CE

smartwares Europe

Jules Verneweg 87 5015 BH Tilburg The Netherlands www.smartwares.eu

PREPARATION BEFORE USE

Insert battery

- Open the battery lid at the back of the remote (1) by turning it counter clockwise.
- Insert the battery with the negative polarity downward.
To check if the battery is inserted correctly, briefly press a button on the remote. If the LED flashes, then the battery is inserted successful.
- Insert the receiver into the wall outlet.
NOTE: The socket-outlet must be installed close to the equipment and must be easily accessible.

PAIRING THE REMOTE TO THE RECEIVER

- Press the button on the receiver (2) for 3 seconds. When the LED starts to blink, the receiver is in pairing mode.
- Press any of the ON buttons on the remote. If the LED stops blinking and is constantly lit, the pairing was successful.

OPERATING RECEIVERS

- Press the "ON" button on the remote control to turn on the receiver.
- Press the "OFF" button on the remote control to turn off the receiver.
- Press the "ON" button beneath ALL (on the remote control) to turn on all paired devices at the same time.
- Press the "OFF" button beneath ALL (on the remote control) to turn off all paired devices at the same time.

Disconnecting a remote

- Press and hold the button on the receiver for 3 seconds (3) and then release it. During this operation the LED starts to blink. Your receiver is now switched into the pairing mode. Attention: the LED should blink only after releasing the button. If the LED starts to blink while holding the button, there will be no pairing.
- Perform one of the following steps:
- Press an "OFF" button on the row on the remote you wish to disconnect from a receiver. During this operation the LED on the receiver blinks quickly and then turns off.
- Press the "OFF" button next to ALL (on the remote) to disconnect all links. During this operation the LED on the receiver turns off.
- To remove all pairing memories on the receiver:
 - Press and hold the button for more than 6 seconds (3).

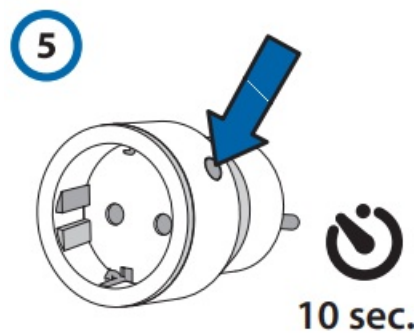
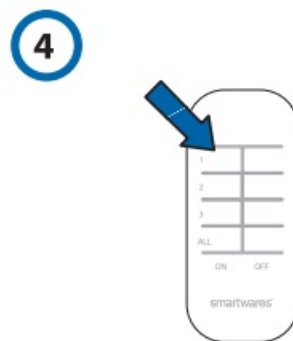
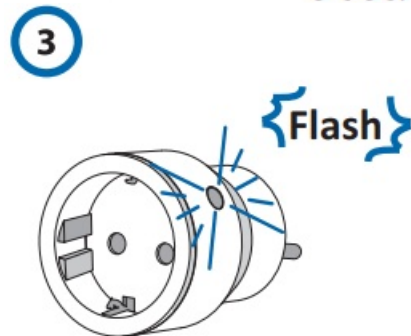
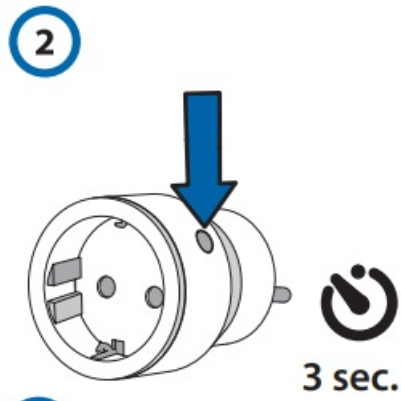
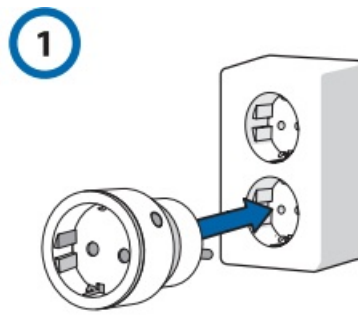

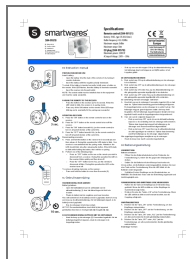

[smartwares SH4-99578 Wireless Switch Set](#) [pdf] Instruction Manual
SH4-99578 Wireless Switch Set, SH4-99578, Wireless Switch Set, Switch Set