



smartwares SH4-99572 Shutter Curtains Switch Instruction Manual

[Home](#) » [smartwares](#) » smartwares SH4-99572 Shutter Curtains Switch Instruction Manual 

Contents

- [1 smartwares SH4-99572 Shutter Curtains Switch](#)
- [2 PREPARATION BEFORE USE](#)
- [3 CONNECTING THE RECEIVER TO THE POWER SUPPLY](#)
- [4 INSTALLING THE WIRELESS WALL SWITCH](#)
- [5 MOUNTING THE RECEIVER](#)
- [6 OPERATING RECEIVERS](#)
- [7 Specifications](#)
- [8 CONTACT](#)
- [9 Documents / Resources](#)



smartwares SH4-99572 Shutter Curtains Switch



PREPARATION BEFORE USE

- Please read the operating instructions!
- Observe the warning and safety notes!
- In your electrical circuit panel, locate the circuit breaker control for the wall switch you will be working on.
Switch the circuit off.

CONNECTING THE RECEIVER TO THE POWER SUPPLY

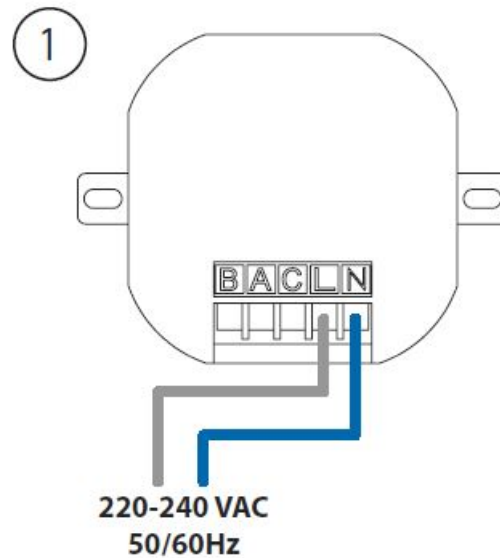

- Connect the phase wire (brown) to L and connect the neutral wire (blue) to N.

Connecting the receiver to the roll-down shutter motor (standard connection)

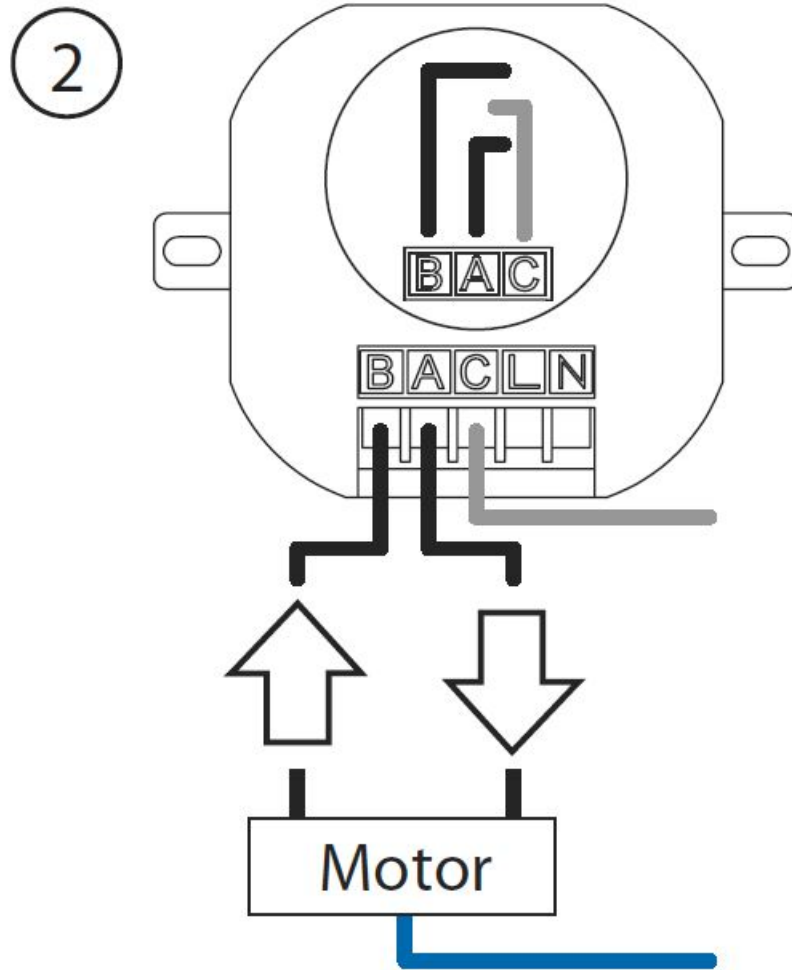

First consult the instruction manual of the motor before connecting it.

- **A.** Connect the “UP/OPEN” pin of the motor to B and connect the “DOWN/CLOSE” pin of the motor to A.
- **NOTE:** For the correct connections of a potential free contact, please consult the instruction manual of the gate or garage door motor.
- **B.** Connect the phase wire of the motor (black) with C.

INSTALLING THE WIRELESS WALL SWITCH

- **A.** First remove the push button(s) and the frame from the mounting plate.
- **B.** Attach the mounting plate to the desired spot on the wall, using the supplied screws. Make sure the “UP” arrow is in the right position (3).
- **C.** Activate the battery by pulling out the tab (3).

3

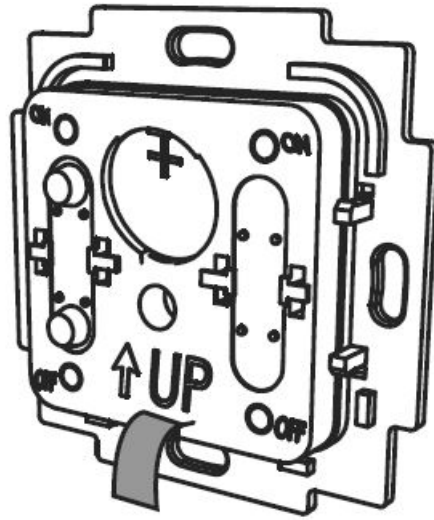

- **D.** Place the frame back on the mounting plate by using the mounting knobs.
- **E.** Place the push button(s) back on the mounting plate. Make sure “UP” is in the right position (4).

4

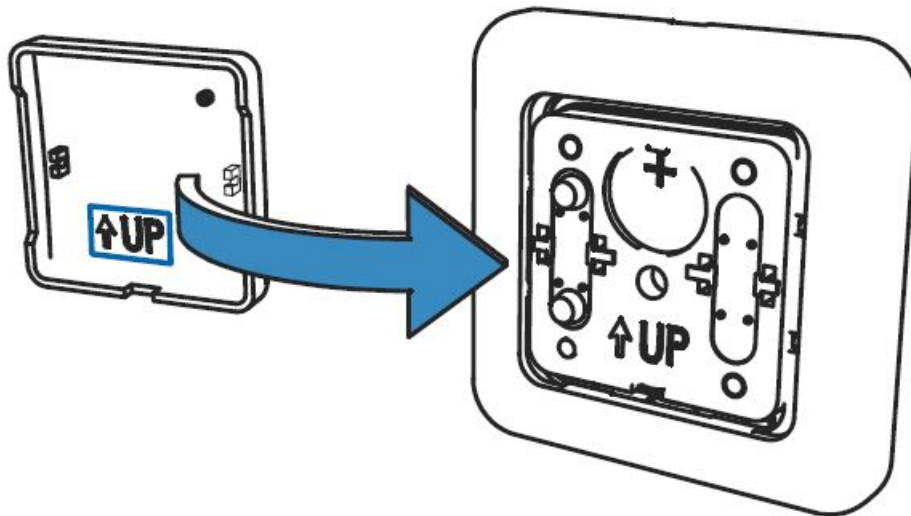

MOUNTING THE RECEIVER

- Mount the receiver in place of the existing up/down switch and switch on the power with the power switch in your electric circuit panel.

PAIRING

Pairing the receiver with a sender

- **A.** Press and hold the button on the receiver for 3 seconds, then release it (5). The LED starts to blink. Your receiver is now switched to pairing mode.
- **Attention:** the LED should only blink after releasing the button. If the LED starts to blink while holding the

button, there will be no pairing.

- **B.** Press the “PAIR” button on the sender for 2 seconds to pair it with a receiver. The LED on the receiver will light up and the LED on the sender will start blinking rapidly.
- Your receiver and sender are now paired.
- **Attention:** it is possible to pair a receiver with multiple senders, eight memory positions are available.

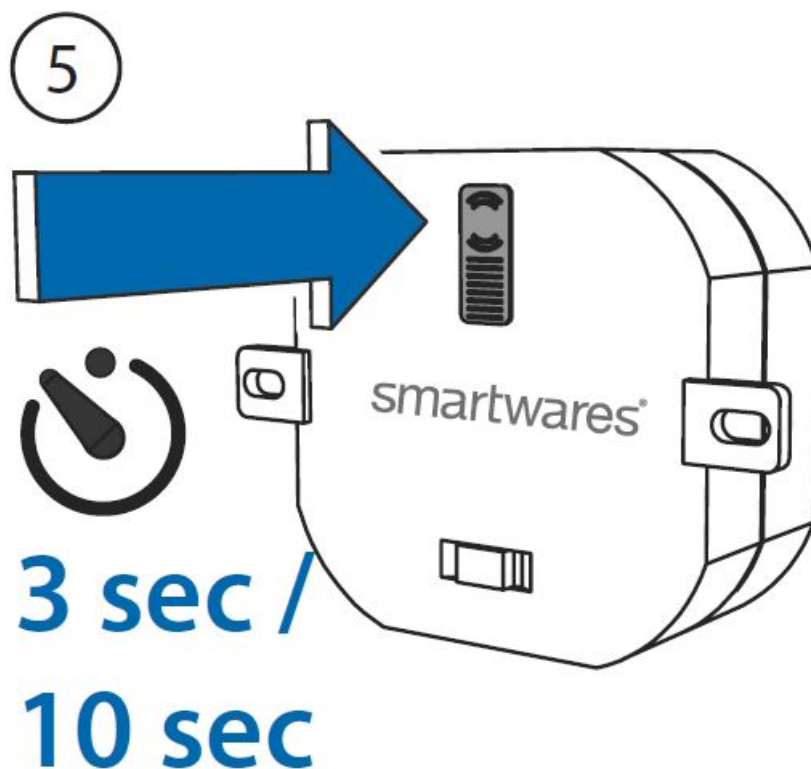

OPERATING RECEIVERS

- Press the “I/ON” button on the sender to activate the receiver.
- Press the “O/OFF” button on the sender to turn off the receiver.

Disconnecting all links

- **A.** When the switch is connected to the power supply, press and hold the button on the built-in switch for 6 seconds, then release it.
- **B.** The LED starts to blink quickly for 12 seconds.
- **C.** During this period, press the button again, the LED will start to blink slowly, then stops blinking and is constantly lit.
- **D.** All links will be disconnected.

Specifications

Remote control

- **Battery:** 3VDC, type CR 2032 (incl.)
- **Frequency:** 433.92MHz
- **Wireless range:** 30m

Built-in switch

- **Wattage:** 300
- **Frequency:** 433.92MHz
- **Wireless range:** 30m
- **Input:** 230V~ – 50Hz



CONTACT

- Jules Verneweg 87
- 5015 BH Tilburg
- The Netherlands
- www.smartwares.eu

Documents / Resources

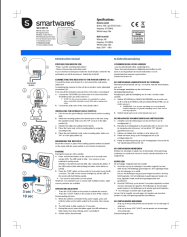
	<p>smartwares SH4-99572 Shutter Curtains Switch [pdf] Instruction Manual SH4-99572_IM, SH4-99572, SH4-99572 Shutter Curtains Switch, Shutter Curtains Switch, Curt ains Switch, Switch</p>
--	--