



# SBID-GX065-V3 SMART Board GX Zero Interactive Displays Installation Guide

[Home](#) » [Smart](#) » SBID-GX065-V3 SMART Board GX Zero Interactive Displays Installation Guide 

## Contents

- [1 SBID-GX065-V3 SMART Board GX Zero Interactive Displays](#)
- [2 Product Usage Instructions](#)
- [3 PARTS](#)
- [4 Installation](#)
- [5 EU and UK Declaration of Conformity](#)
- [6 Documents / Resources](#)
  - [6.1 References](#)
- [7 Related Posts](#)



**SBID-GX065-V3 SMART Board GX Zero Interactive Displays**



## Specifications

- Models: SBID-GX065-V3, SBID-GX075-V3, SBID-GX086-V3
- Weight:
  - SBID-GX065-V3: 82 lb. (37 kg)
  - SBID-GX075-V3: 114 lb. (52 kg)
  - SBID-GX086-V3: 143 lb. (65 kg)
- Dimensions:
  - SBID-GX065-V3: A – 23 5/8" (60 cm), B – 9" (23 cm), C – 15 3/4" (40 cm), D – 10 5/8" (27 cm)
  - SBID-GX075-V3: A – 31 1/2" (80 cm), B – 11 3/4" (30 cm), C – 15 3/4" (40 cm), D – 13 1/4" (34 cm)
  - SBID-GX086-V3: A – 31 1/2" (80 cm), B – 10 1/2" (27 cm), C – 23 5/8" (60 cm), D – 12" (30 cm)

## Product Usage Instructions

### Installation

1. Ensure the SMART Board GX Zero series interactive display is securely mounted using the SMART wall mount (WM-SBID-200).
2. Do not use ropes or wires to move or secure the interactive flat panel as it may cause injury. Only use VESA-approved equipment for mounting.

### Connections

#### Connect the necessary cables to the appropriate ports

- HDMI 1 & HDMI 2 for high-definition multimedia interface connections
- USB-C for touch functionality
- USB 3.0 for data transfer
- S/PDIF Out, RS232, and Service HDMI 2 for additional functionalities

## FAQ:

### Q: Can I use ropes or wires to move the interactive flat panel?

A: No, it is not recommended to use ropes or wires to move or secure the interactive flat panel as it may cause injury. Use only VESA-approved equipment for mounting.

## SMART Board GX Zero series interactive displays

### Models

SBID-GX065-V3

SBID-GX075-V3

SBID-GX086-V3

Do not move or mount the interactive flat panel by connecting rope or wire to its handles. Because the interactive flat panel is heavy, rope, wire or handle failure could lead to personal injury.

Use only VESA®-approved mounting hardware.

## PARTS

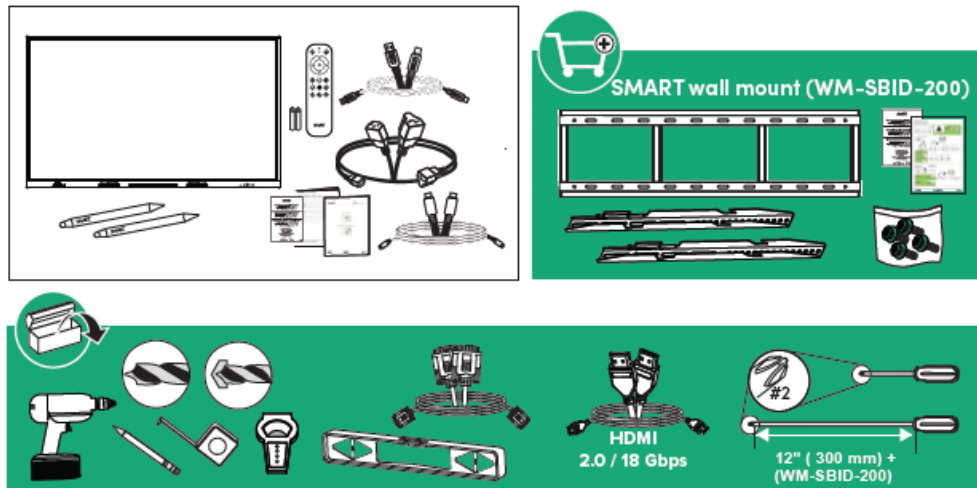

## Installation

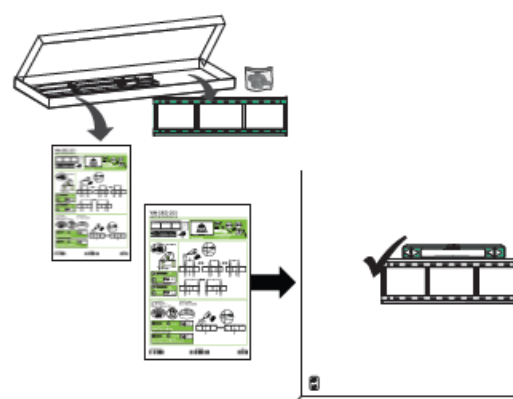
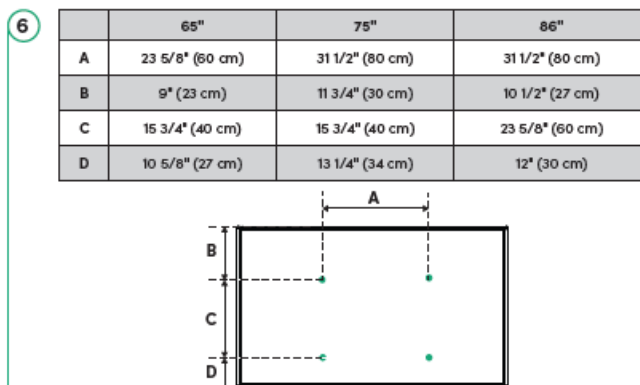
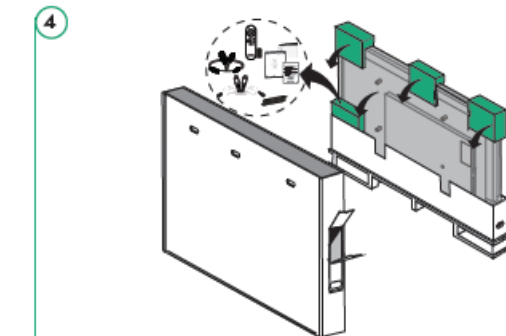
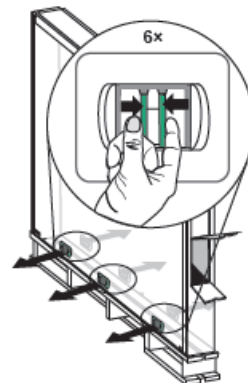

8

WM-SBID-200

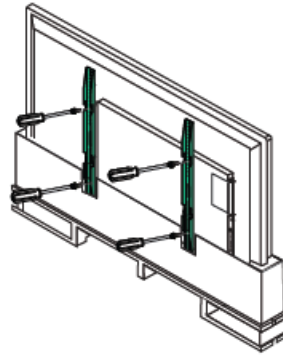
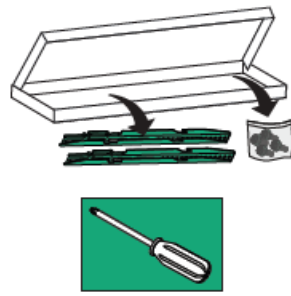

9

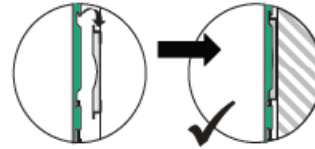

SBID-GX065-V3 | SBID-GX075-V3



A

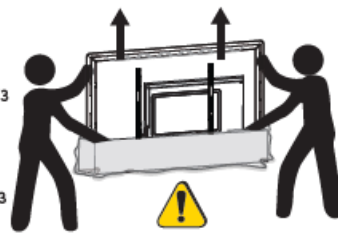

B

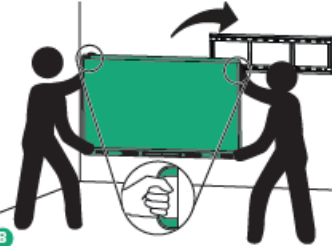

SBID-GX086-V3

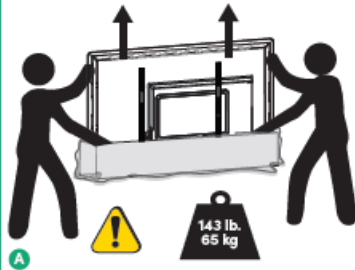

A

B

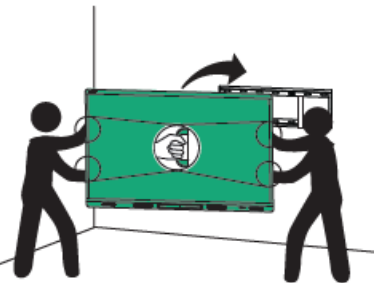

10

WM-SBID-200

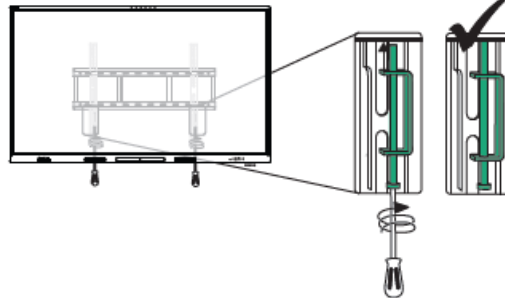

11

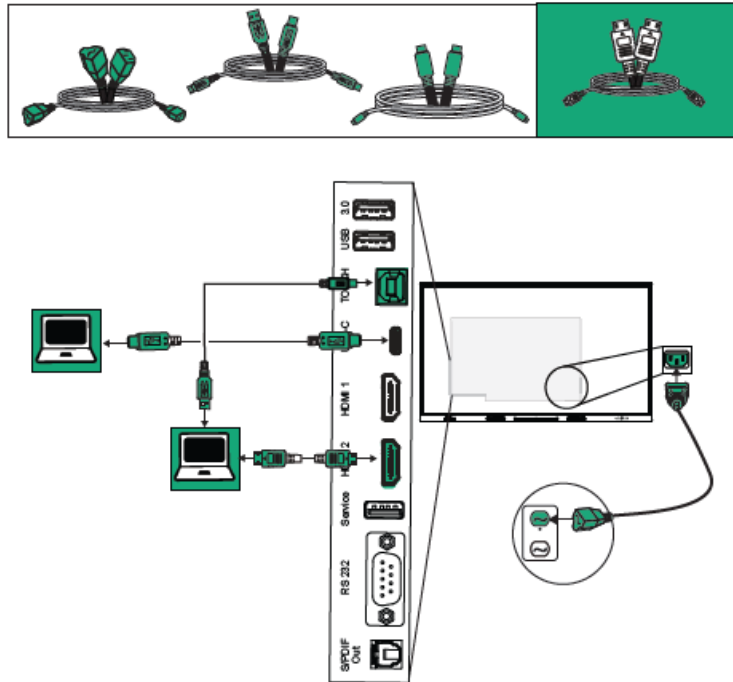

12

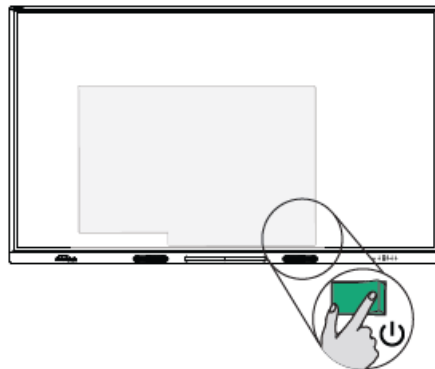

13

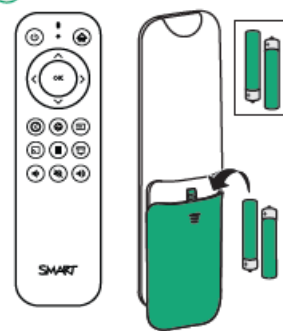

14



[smarttech.com/qrsbidgxzero](http://smarttech.com/qrsbidgxzero)

Was this document helpful? [smarttech.com/docfeedback/171949](http://smarttech.com/docfeedback/171949)

The terms HDMI, HDMI High-Definition Multimedia Interface, HDMI trade dress and the HDMI Logos are trademarks or registered trademarks of HDMI Licensing Administrator, Inc.

For purposes of certification the SBID-GX065-V3, SBID-GX075-V3 and SBID-GX086-V3 are identified as IDGX65-2, IDGX75-2 and IDGX86-2 respectively.

## EUROPE

### EU and UK Declaration of Conformity

Hereby, SMART Technologies ULC declares that the radio equipment type Interactive Display, regulatory models: IDGX65-2, IDGX75-2, and IDGX85-2 comply with Directive 2014/53/EU and UK Radio Equipment Regulations 2017. The full text of the EU and UK declaration of conformity is available at the following internet address:

[www.smarttech.com/compliance](http://www.smarttech.com/compliance)

**The frequency band and the maximum transmitted power are:**

- 2400 MHz – 2483.5 MHz: 19.5 dBm (EIRP)
- 5150 MHz – 5350 MHz: 21 dBm (EIRP)
- 5470 MHz – 5725 MHz: 20 dBm (EIRP)
- 5725 MHz – 5825 MHz: 14 dBm (EIRP)

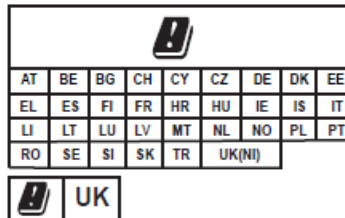

**Restrictions: 5150 MHz – 5350 MHz is for indoor use only**

- Class A products for EU: This product is intended for use in a non-residential environment. The product does not have AM/FM broadcast receiver function.
- Caution: Exposure to Radio Frequency Radiation This equipment complies with EU radiation exposure limits set forth for an uncontrolled environment.
- This equipment should be installed and operated with minimum distance 20 cm between the radiator and your body.

### EU

SMART Technologies (Germany), Gustav-Heinemann-Ufer, 72 c 50968 Köln, Germany

### UK

SMART Technologies (GB) Limited, Scott House, Suite 1  
The Concourse, Waterloo Station, London, United Kingdom SE1 7LY

### Hardware environmental compliance

SMART Technologies supports global efforts to ensure that electronic equipment is manufactured, sold and disposed of in a safe and environmentally friendly manner.

Waste Electrical and Electronic Equipment and Battery regulations (WEEE and Battery Directives)



Electrical and electronic equipment contain substances that can be harmful to the environment and to

human health. The crossed-out wheeled bin symbol indicates that products should be disposed of in the appropriate recycling stream and not as regular waste.

See [smarttech.com/compliance](https://www.smarttech.com/compliance) for more information.



### Batteries

The product contains a CR2032 coin cell battery (not user accessible). The remote contains two AAA batteries. Recycle or dispose of batteries properly.

### Perchlorate material

The coin cell battery contains perchlorate material. Special handling may apply. See

[dtsc.ca.gov/hazardouswaste/perchlorate](https://dtsc.ca.gov/hazardouswaste/perchlorate)

The following information is required for certain products placed on the market in the United States to comply with Reese's Law:

### WARNING

- INGESTION HAZARD: This product contains a button cell or coin battery.
- DEATH or serious injury can occur if ingested.
- A swallowed button cell or coin battery can cause Internal Chemical Burns in as little as 2 hours.
- KEEP new and used batteries OUT OF REACH of CHILDREN.
- Seek immediate medical attention if a battery is suspected to be swallowed or inserted inside any part of the body.
- The 3V, CR2032 battery in this product is not user replaceable.

**WARNING:** The coin cell battery installed in this product is not intended for user replacement. The following statements apply if the battery is replaced:

- Remove and immediately recycle or dispose of used batteries according to local regulations and keep away from children. Do NOT dispose of batteries in household trash or incinerate.
- Even used batteries may cause severe injury or death.
- Call a local poison control center for treatment information.
- Replace only with a type CR2032 battery, this is nominally a 3V battery.
- Non-rechargeable batteries are not to be recharged. The CR2032 battery is non-rechargeable.
- Do not force discharge, recharge, disassemble, heat above 100°C or incinerate. Doing so may result in injury due to venting, leakage or explosion resulting in chemical burns.

[support.smarttech.com](https://support.smarttech.com)

[support.smarttech.com/contact-support](https://support.smarttech.com/contact-support)

[docs.smarttech.com/kb/171949](https://docs.smarttech.com/kb/171949)







SMART Technologies ULC. All rights reserved. SMART Board, smarttech, the SMART logo and all SMART taglines are trademarks or registered trademarks of SMART Technologies ULC in the U.S. and/or other countries. All third-party products and company names may be trademarks of their respective owners. Contents are subject to change without notice. This product and/or use thereof covered by one or more of the following U.S. patents: [smarttech.com/patents](https://www.smarttech.com/patents). Other patents pending. May 2024.



## Documents / Resources

	<p><b><a href="#">SMART SBID-GX065-V3 SMART Board GX Zero Interactive Displays</a></b> [pdf] Installation Guide SBID-GX065-V3, SBID-GX075-V3, SBID-GX086-V3, SBID-GX065-V3 SMART Board GX Zero Interactive Displays, SBID-GX065-V3, SMART Board GX Zero Interactive Displays, Zero Interactive Displays, Interactive Displays, Displays</p>
---	---

## References

-  [dtsc.ca.gov/hazardouswaste/perchlorate](https://dtsc.ca.gov/hazardouswaste/perchlorate)
-  [SurveyMonkey Powered Online Survey](#)
-  [Downloads and drivers - SMART Technologies](#)
-  [Support](#)
-  [SMART Support - SMART Technologies](#)
-  [SMART Support - SMART Technologies](#)
- [User Manual](#)

### Manuals+, Privacy Policy

This website is an independent publication and is neither affiliated with nor endorsed by any of the trademark owners. The "Bluetooth®" word mark and logos are registered trademarks owned by Bluetooth SIG, Inc. The "Wi-Fi®" word mark and logos are registered trademarks owned by the Wi-Fi Alliance. Any use of these marks on this website does not imply any affiliation with or endorsement.