



[Home](#) » [Smart Watt](#) » **Smart Watt WHMC01 Smart WiFi Door Sensor Window Sensor Door User Manual** 

## Contents [ [hide](#) ]

- [1 Smart Watt WHMC01 Smart WiFi Door Sensor Window Sensor Door](#)
- [2 Manual to prevent any damage](#)
- [3 Specifications:](#)
- [4 How to use](#)
- [5 FCC Warning](#)
- [6 Frequently Asked Questions](#)
- [7 Documents / Resources](#)
  - [7.1 References](#)



## Smart Watt WHMC01 Smart WiFi Door Sensor Window Sensor Door



\*Please read this manual carefully before use and keep it for future reference.

## Manual to prevent any damage

- Tamper protection
- Low battery alert
- Alexa compatible
- OTA firmware upgrade supported

## Specifications:

- Input voltage: DC3V LR03
- Quiescent Current:  $\leq 10\mu\text{A}$
- Alarm Current:  $\leq 160\text{mA}$
- Low power under voltage:  $\leq 2.7\text{V}$
- WiFi: 802.11 b/g/n
- Magnetic control distance:  $\leq 15\text{mm}$
- Working temperature:  $-10-50\text{-C}$
- Working humidity: max 95%RH

## How to use

1. Push the mounting bracket upward and take out the bracket, then insert the battery.

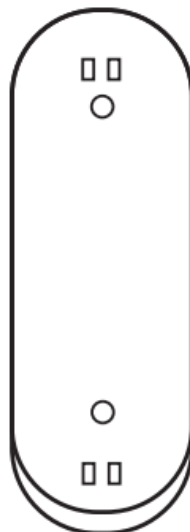

2. Put the battery into the battery bin and place it according to the graphics in the battery bin After two batteries are loaded the indicator lights are always on and then off.

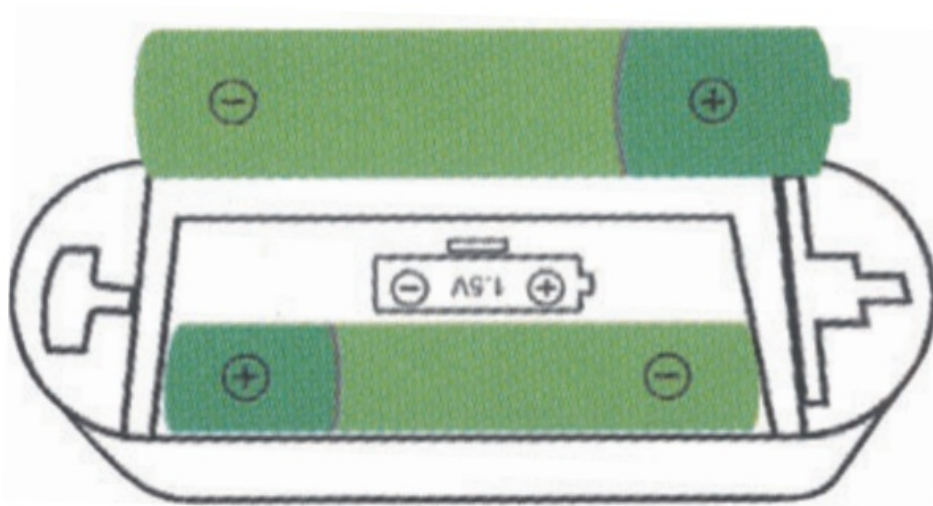

3. Download TUYA Smart APP in app store or google play store,or scan the following QR code.



**iOS/Android**

4. Register with mobile phone number,clickRMy Home” interface”+R or click R Add Devices” in the middle blank.  
Select the security sensor and click on the door magnetic sensor.



5. With the card pick-up pin in the accessory package,hold the reset key for more than 5 seconds, and the indicator flashes into the automatic network connection mode. Enter the WiFi password according to the prompt ,and click to confirm.

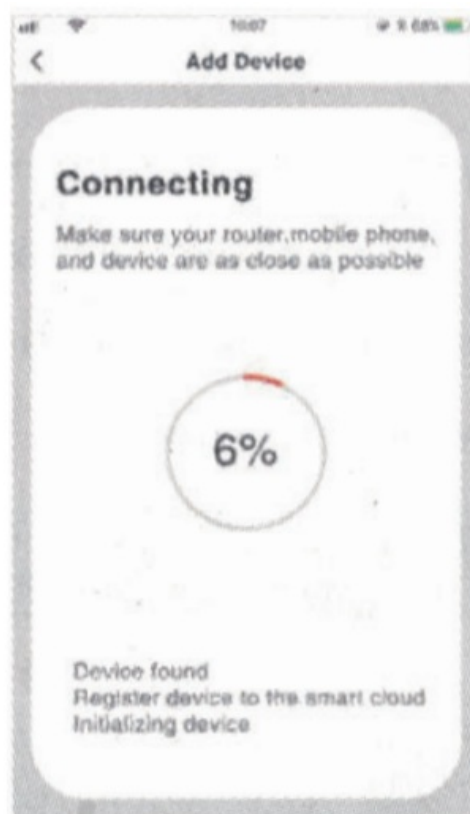

6. In the automatic network connection Mode,the indicator flashes quickly, holds the reset key for 5 seconds with the card pickup pin ,the indicator flashes slowly, and enters the manual network connection mode.APP chooses compatible mode. According to the prompt, enter'WiFi password "and click confirmation ,then switch to the WIFI settings interface. Connect Smartlife-XXXX network and return to APP to continue adding devices.

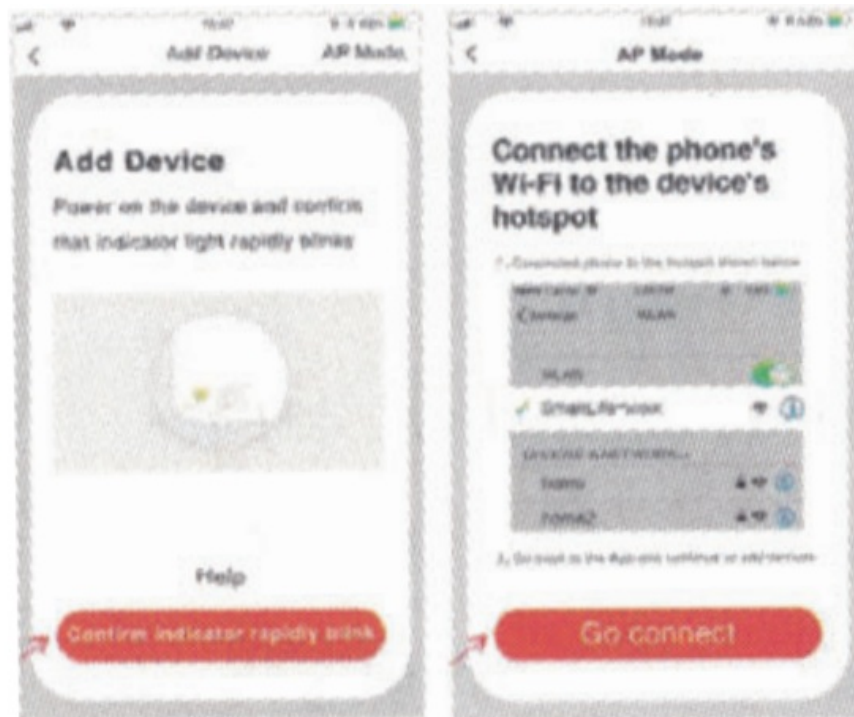

7. Network connection successfully, click on the door magnetic icon to enter the interface open the door magnetic, APP will remind you the door is open close the magnet door magnetic APP will remind you the door is closed.

## FCC Warning

This equipment has been tested and found to comply with the limits for a Class B digital device, pursuant to part 15 of the FCC Rules. These limits are designed to provide reasonable protection against harmful interference in a residential installation. This equipment generates, uses and can radiate radio frequency energy and, if not installed and used in accordance with the instructions, may cause harmful interference to radio communications. However, there is no guarantee that interference will not occur in a particular installation. If this equipment does cause harmful interference to radio or television reception, which can be determined by turning the equipment off and on, the user is encouraged to try to correct the interference by one or more of the following measures:

- Reorient or relocate the receiving antenna.
- Increase the separation between the equipment and receiver.
- Connect the equipment into an outlet on a circuit different from that to which the receiver is connected.
- Consult the dealer or an experienced radio/TV technician for help.

**Caution:** Any changes or modifications to this device not explicitly approved by manufacturer could void your authority to operate this equipment.

This device complies with part 15 of the FCC Rules. Operation is subject to the following two conditions:

- 1. This device may not cause harmful interference, and
- 2. This device must accept any interference received, including interference that may cause undesired operation.

This equipment complies with FCC radiation exposure limits set forth for an uncontrolled environment. This equipment should be installed and operated with minimum distance 20cm between the radiator and your body.

### Frequently Asked Questions

- **Q: Can I modify the device for better performance?**  
A: No, any modifications not approved by the manufacturer may void the device’s warranty and compliance.
- **Q: What should I do if I experience interference during operation?**  
A: Try adjusting the positioning of the device to minimize interference sources, and ensure proper distance from other electronic devices.

### Documents / Resources

	<a href="#">Smart Watt WHMC01 Smart WiFi Door Sensor Window Sensor Door [pdf]</a> User Manual WHMC01 Smart WiFi Door Sensor Window Sensor Door, WHMC01, Smart WiFi Door Sensor Window Sensor Door, Door Sensor Window Sensor Door, Sensor Window Sensor Door, Window Sensor Door, Sensor Door
---	---

### References

- [User Manual](#)

Door Sensor Window Sensor Door, Sensor Door, Sensor Window Sensor Door, Smart Watt, Smart WiFi Door Sensor Window Sensor Door, WHMC01, WHMC01 Smart WiFi Door Sensor Window Sensor Door, Window Sensor Door

---

## Leave a comment

Your email address will not be published. Required fields are marked \*

Comment \*

Name

Email

Website

☐ Save my name, email, and website in this browser for the next time I comment.

**Post Comment**

**Search:**

e.g. whirlpool wrf535swhz

**Search**

[Manuals+](#) | [Upload](#) | [Deep Search](#) | [Privacy Policy](#) | [@manuals.plus](#) | [YouTube](#)

This website is an independent publication and is neither affiliated with nor endorsed by any of the trademark owners. The "Bluetooth®" word mark and logos are registered trademarks owned by Bluetooth SIG, Inc. The "Wi-Fi®" word mark and logos are registered trademarks owned by the Wi-Fi Alliance. Any use of these marks on this website does not imply any affiliation with or endorsement.