

**SmallRig
4458 Side Handle
Extension Adapter**



SmallRig 4458 Side Handle Extension Adapter Instruction Manual

[Home](#) » [SmallRig](#) » SmallRig 4458 Side Handle Extension Adapter Instruction Manual 

Contents

- [1 SmallRig 4458 Side Handle Extension Adapter](#)
- [2 In the Box](#)
- [3 Specifications](#)
- [4 Product Details](#)
- [5 Installation Instructions](#)
- [6 FAQ](#)
- [7 CONTACT](#)
- [8 Documents / Resources](#)
 - [8.1 References](#)
- [9 Related Posts](#)

SmallRig

SmallRig 4458 Side Handle Extension Adapter



Thank you for purchasing SmallRig's product.· Please read this Operation Guide carefully.Please follow the safety warnings

In the Box

- Extension Adapter with NATO Clamp× 1
- Operating Instruction× 1
- Guarantee Card× 1

Specifications

Product Dimensions	2.2 × 1.2 × 1.7in 56 × 31 × 44.3mm
Product Weight	1.8 ± 0.2oz 52.0 ± 5.0g
Material(s)	Aluminium Alloy, Stainless Steel
Compatibility	Compatible with NATO handle, 1/4"-20 threaded handle, 1/4"-20 locating handle.

Product Details

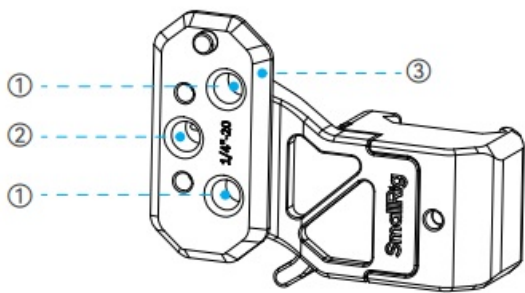

1. 1/4"-20 Threaded Hole
2. 1/4"-20 Threaded Hole
3. NATO Rail

Installations

1

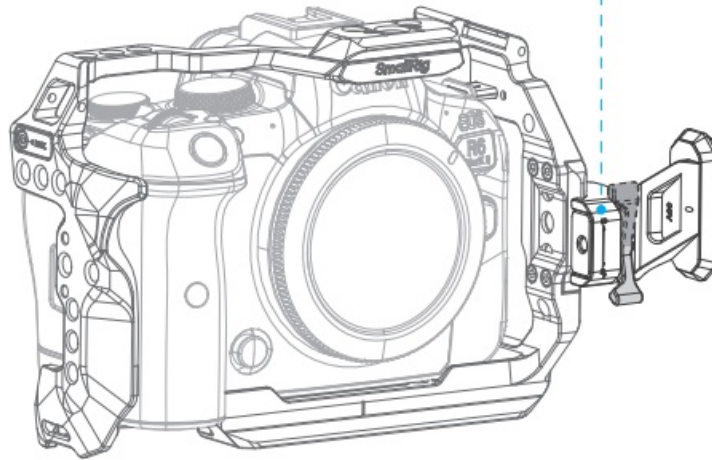
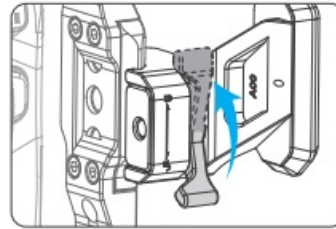

2

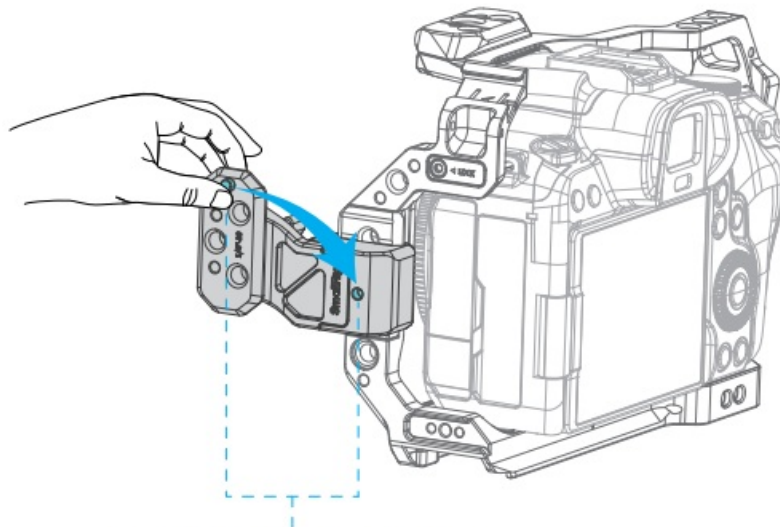

Store the Magnetic Anti-drop Pin.

FAQ

- **Q:** What is the weight of the product?
- **A:** The weight of the product is not specified in the specifications.
- **Q:** What materials are used in the construction of the product?
- **A:** The product is constructed using Aluminium Alloy and Stainless Steel.
- **Q:** What handles are compatible with this adapter?
- **A:** This adapter is compatible with a NATO handle, 1/4-20 threaded handle, and 1/4-20 locating handle.
- **Q:** How many threaded holes does the adapter have?
- **A:** The adapter has two 1/4-20 threaded holes.

CONTACT

- Manufacturer Email: support@smallrig.com
- Manufacturer: Shenzhen Leqi Innovation Co., Ltd.
- Add: Rooms 101, 701, 901, Building 4, Gonglianfuji Innovation Park, No. 58, Ping'an Road,
- Dafu Community, Guanlan Street, Longhua District, Shenzhen, Guangdong, China.
- Consignor: Shenzhen LC Co., Ltd.
- Add: Room 201, Building 4, Gonglianfuji Innovation Park, No. 58, Ping'an Road,
- Dafu Community, Guanlan Street, Longhua District, Shenzhen, Guangdong, China.

Documents / Resources

	<p>SmallRig 4458 Side Handle Extension Adapter [pdf] Instruction Manual</p> <p>4458 Side Handle Extension Adapter, 4458, Side Handle Extension Adapter, Extension Adapter, Adapter</p>
---	--

References

- [User Manual](#)

[Manuals+](#), [Privacy Policy](#)

This website is an independent publication and is neither affiliated with nor endorsed by any of the trademark owners. The "Bluetooth®" word mark and logos are registered trademarks owned by Bluetooth SIG, Inc. The "Wi-Fi®" word mark and logos are registered trademarks owned by the Wi-Fi Alliance. Any use of these marks on this website does not imply any affiliation with or endorsement.