

## SM Tek Group LDC1 Car Atmosphere Lights User Manual

[Home](#) » [SM Tek Group](#) » SM Tek Group LDC1 Car Atmosphere Lights User Manual 

### SM Tek Group LDC1 Car Atmosphere Lights User Manual

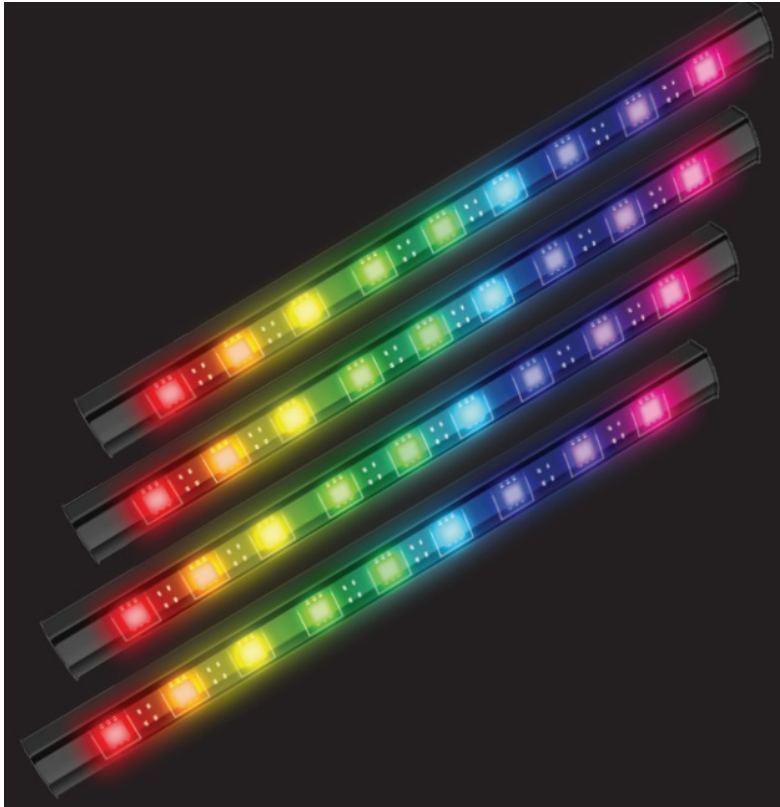

## Contents

### [1 INTRODUCTION](#)

### [2 PACKAGE CONTENTS](#)

### [3 SPECIFICATIONS & FEATURES](#)

### [4 HOWTO USE](#)

### [5 PRODUCT OVERVIEW](#)

### [6 CARE AND SAFETY](#)

### [7 Documents / Resources](#)

### [8 Related Posts](#)

## INTRODUCTION

Do you want your car to have the vibes you've always dreamed of? Want to drive in style? These lights are sure to make you the coolest driver on the block. Adhere them to wherever you want in your car and use the remote to put it on the exact Getting ymu want. Never drive in the boring dark again.

## PACKAGE CONTENTS

- 4x LED Car Strips
- 1 x Power block
- 1 x Aux to USB
- 1 x Remote

## SPECIFICATIONS & FEATURES

Each strip is about 7 inches long and .5 inches thick

8 Different static colors

4 Colorful sets

6 Brightness modes

4 Music Modes

Strips are USB powered

Remote uses 1 CR2025 Battery

## HOWTO USE

1. First unbox and make sure you have all the pieces
2. Next you're going to plug into the Aux cable into the hole at the top of the power box
3. Now you're going to plug the USB into the proper power outlet
4. Now you are going to carefully remove the red adhesive tape from the back of the strips
5. Carefully place the LED strips where you would like and be sure to be careful when placing as to not make the adhesive weak by placing and removing often
6. Once everything is all hooked up, try to hide the power source as well as possible but making sure the remote receiver is still visible so you could control it easily
7. Remote the small piece of plastic in the remote to activate the battery
8. Start to enjoy as soon as you hit that power button!

## PRODUCT OVERVIEW



## CARE AND SAFETY

- Do not use this unit for anything other than its intended use.
- Keep the unit away from heat source, direct sunlight, humidity, water or any other liquid.
- Do not expose the device to extremely high or low temperatures, as it may damage the battery.
- Do not operate the unit if it has been wet or moist to prevent against electric shock and/or injury to yourself and damage to the unit.
- Do not use the unit if it has been dropped or damaged in any way.
- Repairs to electrical equipment should only be performed by a qualified electrician. Improper repairs may place the user at serious risk.
- Keep the unit out of reach of children.
- This unit is not a toy.

### BATTERY DISPOSAL:

This product contains a lithium polymer battery. Lithium polymer batteries are environmentally safe when fully discharged. Please refer to your local and state laws for battery disposal procedures.

©SM TEK GROUP INC, All rights reserved.  
BlueStone is a trademark of SM TEK GROUP INC.  
New York, NY 10001  
[www.smtekgroup.com](http://www.smtekgroup.com)

## Documents / Resources

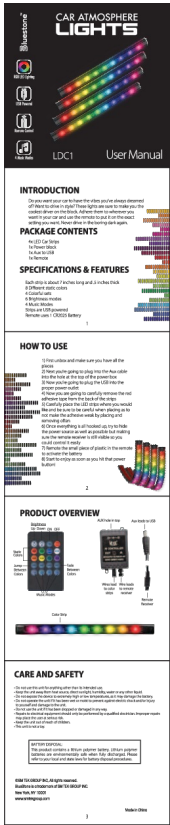

[SM Tek Group LDC1 Car Atmosphere Lights \[pdf\] User Manual](#)  
LDC1 Car Atmosphere Lights, LDC1, Car Atmosphere Lights