



SLEIPNER SE100 IP Tunnel Thruster User Manual

[Home](#) » [SLEIPNER](#) » SLEIPNER SE100 IP Tunnel Thruster User Manual 

Contents

- [1 SLEIPNER SE100 IP Tunnel Thruster](#)
- [2 Products](#)
- [3 General Operation Considerations and Precautions Guidelines](#)
- [4 User Operation](#)
- [5 Compatible Control Device Products](#)
- [6 Control Panel](#)
- [7 Maintenance](#)
- [8 SE & SE-IP user manual](#)
- [9 Basic Troubleshooting](#)
- [10 Service and Support](#)
- [11 Warranty statement](#)
- [12 Patents](#)
- [13 Documents / Resources](#)
 - [13.1 References](#)
- [14 Related Posts](#)

SLEIPNER

SLEIPNER SE100 IP Tunnel Thruster



Products

- SE300/300TC – SE300 Tunnel thruster, 48V
- SE250/300TC – SE250 Tunnel thruster, 24V
- SE210/250TC – SE210 Tunnel thruster, 24V
- SE170/250TC-AM – Sidepower SE170-TC-Amel 24V SE170/250TC-AMS – Sidepower S-link SE170-TC-Amel
SE170/250TC-AMR – Sidepower SE170-TC-Amel Retractable SE170/250TC – SE170 Tunnel thruster, 24V
- SE150/215T-24V – SE150 Tunnel thruster, 24V
- SE150/215T-12V – SE150 Tunnel thruster, 12V
- SE130/250T-12V – SE130 Tunnel thruster, 12V
- SE130/250T-24V – SE130 Tunnel thruster, 24V
- SE120/215T-24V – SE120 Tunnel thruster, 24V
- SE120/215T-12V – SE120 Tunnel thruster, 12V
- SE100/185T-24V – SE100 Tunnel thruster, 24V
- SE100/185T-12V – SE100 Tunnel thruster, 12V
- SE80/185T-12V – SE80 Tunnel thruster, 12V
- SE80/185T-24V – SE80 Tunnel thruster, 24V
- SE60/185S-24V – SE60 Tunnel thruster, 24V
- SE60/185S-12V – SE60 Tunnel thruster, 12V
- SE60/185S2-12V – SE60 Tunnel thruster, 12V
- SE60/185-12V OST – SE60 Tunnel thruster, 12V
- SE60/185S2-24V – SE60 Tunnel thruster, 24V
- SE50/140S-12V – SE50 Tunnel thruster, 12V
- SE50/140S-24V – SE50 Tunnel thruster, 24V
- SE40/140S-ALU – SE40 Tunnel thruster, 12V
- SE40/140 SPESIAL – SE40 Tunnel thruster, 12V
- SE40/125S2 – SE40 Tunnel thruster, 12V

- SE40/140S – SE40 Tunnel thruster, 12V
- SE40/125S – SE40 Tunnel thruster, 12V
- SE30/140S – SE30 Tunnel thruster, 12V
- SE30/125S – SE30 Tunnel thruster, 12V
- SE30/125S2 – SE30 Tunnel thruster, 12V
- SE25/110S – SE25 Tunnel thruster, 12V
- SE20/110S – SE20 Tunnel thruster, 12V
- SE170/250TC-IP – SE170 Tunnel thruster, 24V-IP SE130/250T-12IP – SE130 Tunnel thruster, 12V-IP
SE130/250T-24V – SE130 Tunnel thruster, 24V
- SE130/250T-24IP – SE130 Tunnel thruster, 24V-IP SE120/215T-24IP – SE120 Tunnel thruster, 24V-IP
SE100/185T-12IP – SE100 Tunnel thruster, 12V-IP SE100/185T-24IP – SE100 Tunnel thruster, 24V-IP
SE80/185T-12IP – SE80 Tunnel thruster, 12V-IP
- SE80/185T-24IP – SE80 Tunnel thruster, 24V-IP
- SE60/185S-24V – SE60 Tunnel thruster, 24V
- SE60/185S2-12IP – SE60 Tunnel thruster, 12v-IP SE60/185S-24IP – SE60 Tunnel thruster, 24V-IP
- SE60/185S-12IP – SE60 Tunnel thruster, 12V-IP
- SE50/140S-24IP – SE50 Tunnel thruster, 24V-IP
- SE50/140S-12IP – SE50 Tunnel thruster, 12V-IP
- SE40/125S2-12IP – SE40 Tunnel thruster, 12v-IP SE40/125S-12IP – SE40 Tunnel thruster, 12V-IP
- SE30/125S2-12IP – SE30 Tunnel thruster, 12v-IP SE30/125S-12IP – SE30 Tunnel thruster, 12V-IP
- SE60/185S2-24IP – SE60 Tunnel thruster, 24v-IP SE60/185S2-24V – SE60 Tunnel thruster, 24v

Failure to follow the considerations and precautions can cause serious injury, damage and will render all warranties given by Sleipner Motor as VOID.

General Operation Considerations and Precautions Guidelines

For the operation of thrusters

Never use thrusters when close to objects, persons or animals in the water. The thruster will draw objects into the tunnel and the rotating propellers. This will cause serious injuries and damage the thruster.

Always turn the main power switch off before touching any part of the thruster. An incidental start while touching moving parts can cause serious injuries.

It is the owner, captains or other responsible parties full responsibility to assess the risk of any unexpected incidents on the vessel.

If the thruster stops giving thrust for some reason while manoeuvring you must have considered a plan on how to avoid damage to persons or other objects.

- Always turn the control device off when the thruster is not in use or when leaving the boat.
- When leaving the boat always turn off the main power switch for the thruster.
- Never use thrusters out of water.
- If the thruster stops giving thrust while running, there is possibly a problem in the drive system. You must immediately stop running the thruster and turn it off. Running the thruster for more than a few seconds without resistance from the propeller can cause serious damage to the thruster.
- If two panels are operated with conflicting directions at the same time the thruster will not run. If both are operated in the same direction, the thruster will run in this direction.

- If you notice any faults with the thruster switch it off to avoid further damage.
- The primary purpose of the thruster is to manoeuvre or dock the vessel. Forward or reverse speed must not exceed 4 knots when operated.

For the operation of electric thrusters

Never store items (e.g. equipment, sails, ropes etc.) in the same compartment as the thruster. When the thruster runs for an extended period, it can reach 150°C and will cause damage to nearby items or cause a fire. Any loose items near the thruster motor can cause problems with electrical wiring coming loose and short-circuiting.

- Ensure you know the location of the main battery switch that disconnects the thruster from all power sources (batteries) so the thruster can be turned off in case of serious malfunction.
- We advise keeping the main engine(s) running while using the thruster. This will keep the batteries in a good charge condition. It will also give better performance to the thruster.
- If the performance of the thruster is reduced check the battery system or check the tunnel for marine growth.
- The electric motor, its components, contacts/ plugs or other joints in the control cables must be mounted so they will remain dry at all times.

For the operation of DC electric motors

- The DC electric motor will generate some carbon dust during operation. Ensure any storage compartments are separated from the thruster area to prevent nearby items from becoming dusty.
- The maximum continuous run time of the electrical thruster is approximately 3 minutes. The electrical motor includes a built-in thermal cut off switch that will shut down the motor when it detects overheating. Consider this when planning your maneuvering.

NEVER Disassemble any part of the Ignition Protected assembly. Tampering with the Ignition Protected assembly will cause it to lose this safety feature. If there is a problem with your Ignition Protected motor, please contact your dealer.

User Operation

The following is an operation guide to ALL Sleipner control products. Ensure to familiarise yourself with the functionality and operation of your specific control device.

General operation

1. Turn on the main power switch for the bow thruster. (NB: Always turn off the main power switch when not on-board.)
2. Turn on the control panel by pushing the/ both "ON" button(s) on the original Sleipner panel simultaneously.
 - Turn off the control panel by pushing the "OFF" button
3. To Turn the bow/ stern in the desired direction:

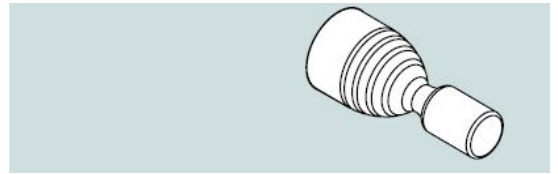
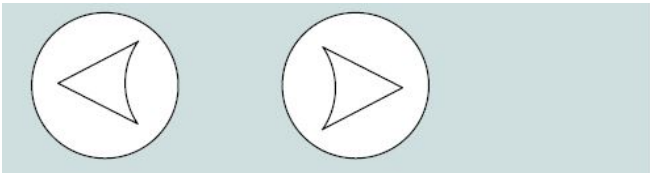

Button control panels

For button control, push the button in the corresponding direction you wish the bow/ stern to move.

Joystick control panels

For joystick control, move the joystick in the direction you wish the bow/ stern to move.

(NB: If equipped for proportional control move the joystick equivalent to the amount of thrust you intend to receive.) For other controls like foot switches or toggle-switches please refer to that products user manual for detailed operational use.

Hold functionality

If equipped with 'hold' functionality push the button in the corresponding direction you wish the thrusters to engage a holding pattern:

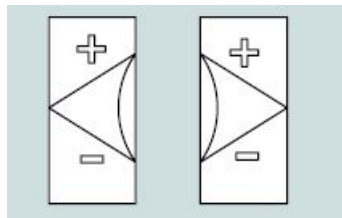

Hold Button

+ or – Will increase or decrease the holding force output of the thrusters

Operating a combined bow and stern thruster

The combination of a bow and stern thruster offers total manoeuvrability to move the bow and the stern separately from each other or in unison. This enables the boat to move sideways in both directions or turn the boat around a 360° axis while staying stationary.

Remote controls

Ensure the remote control is held in the same direction as the boat during operation.

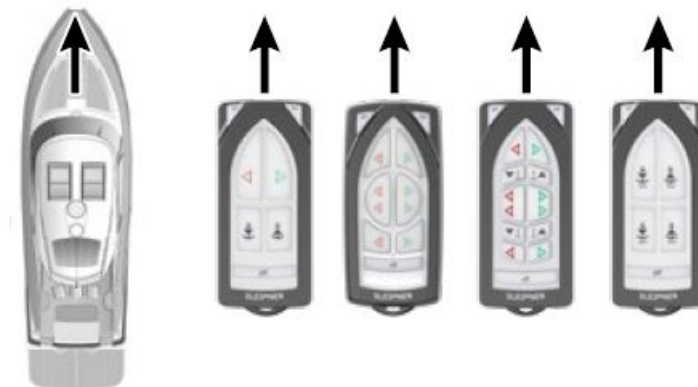

Drift

Depending on the sideways speed of the bow/ stern, you must disengage the control device shortly before the vessel is in the desired position. (NB: Be aware the boat will continue to move after disengaging the thruster control.) At any significant cruising speed (+1-2 kn) the side thruster will have little effect to steer the vessel.

Compatible Control Device Products

Please refer to the graphic for special considerations relating to your model !

- ON/ OFF CONTROL PANEL
- REMOTE CONTROL



Control Panel

- Activating the bow thruster

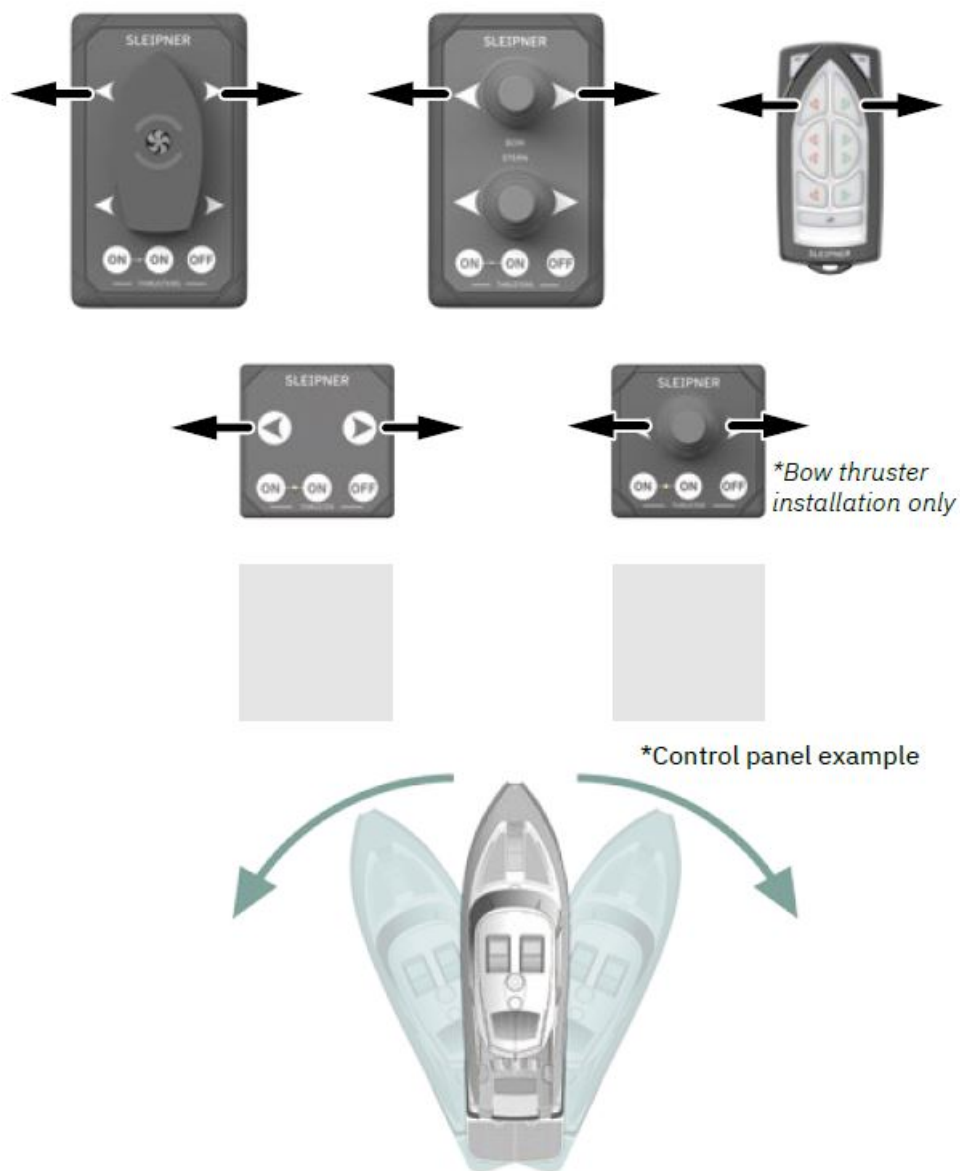

- Activating the stern thruster

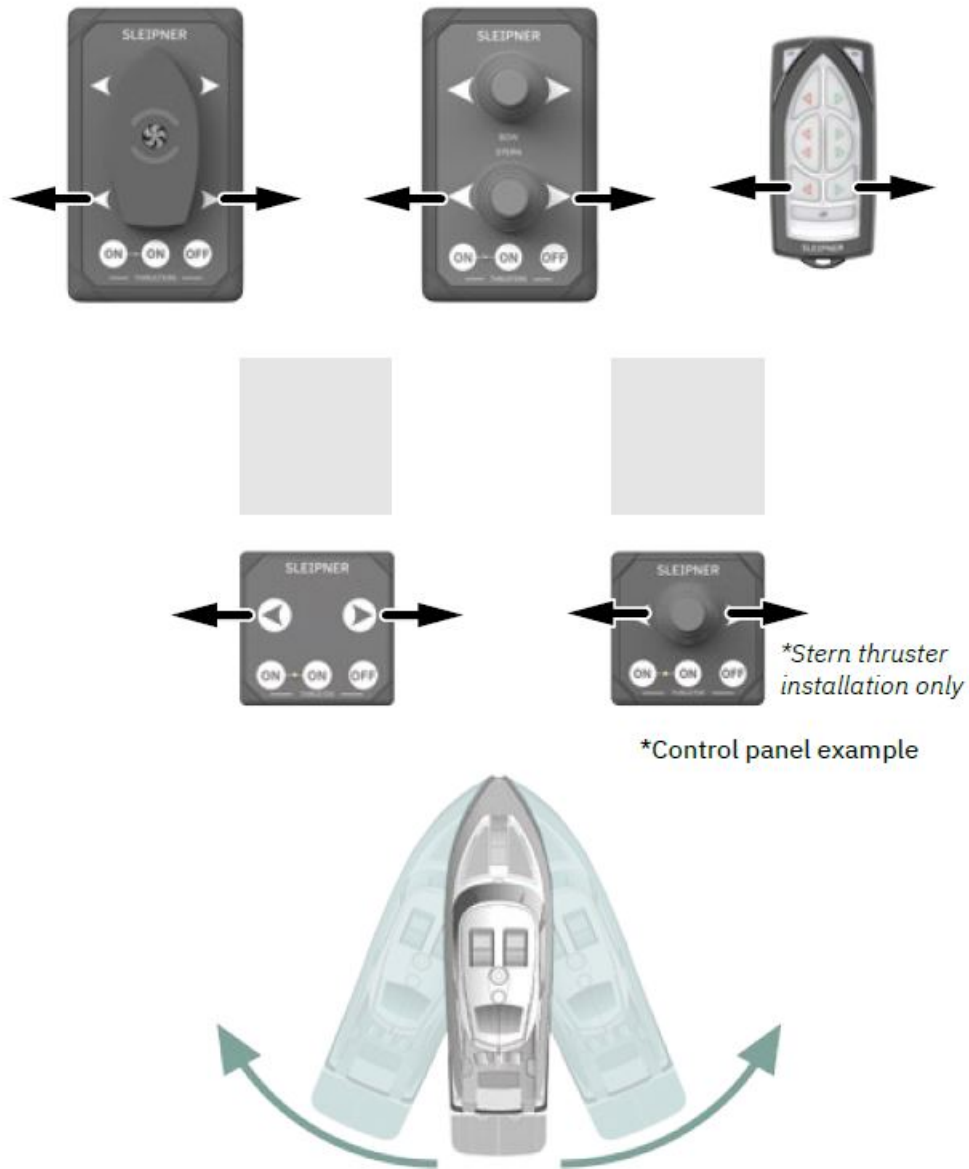

- Activating both bow and stern thruster to push the boat sideways

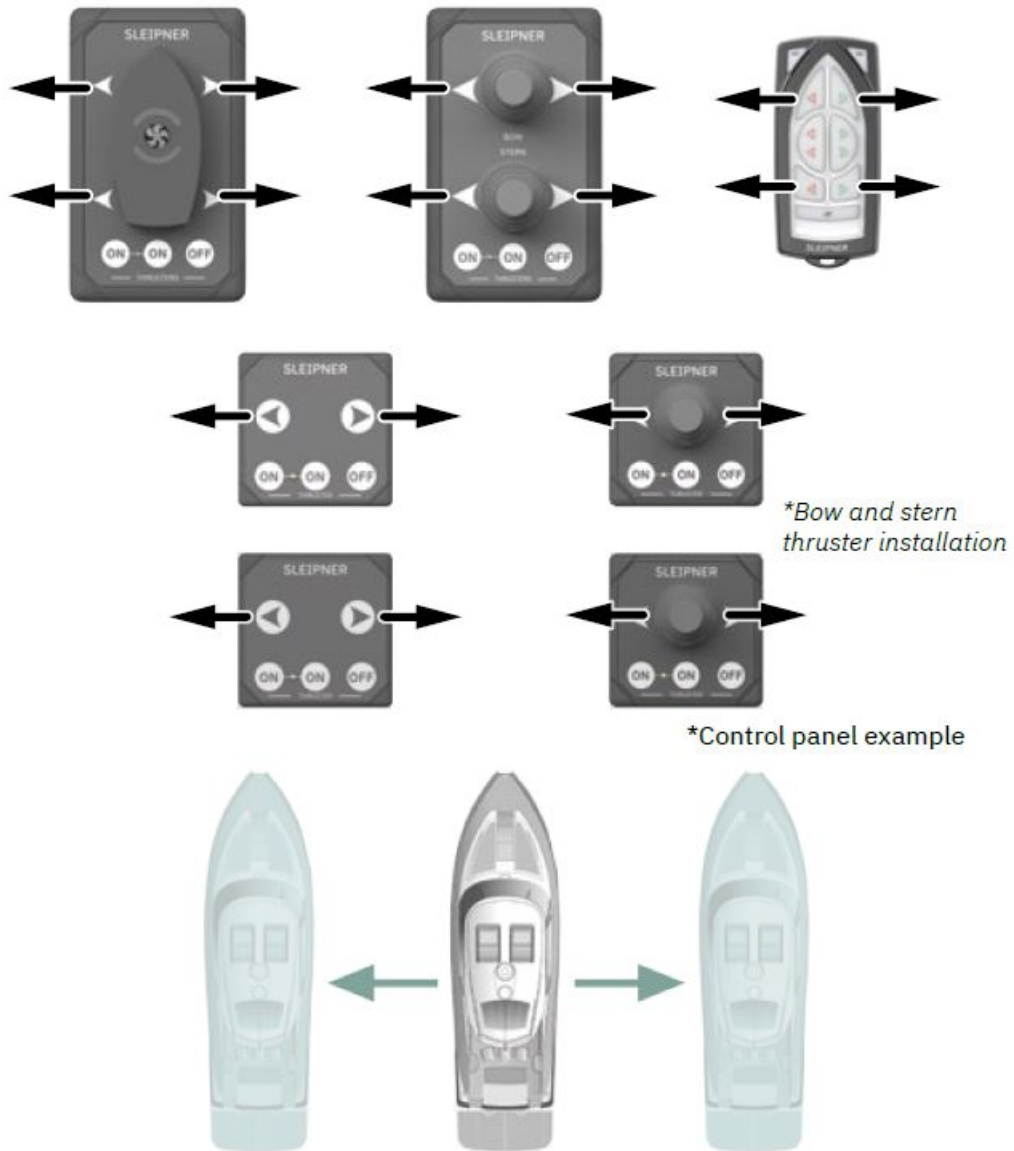

- Activating both bow and stern thruster to rotate the boat on axis

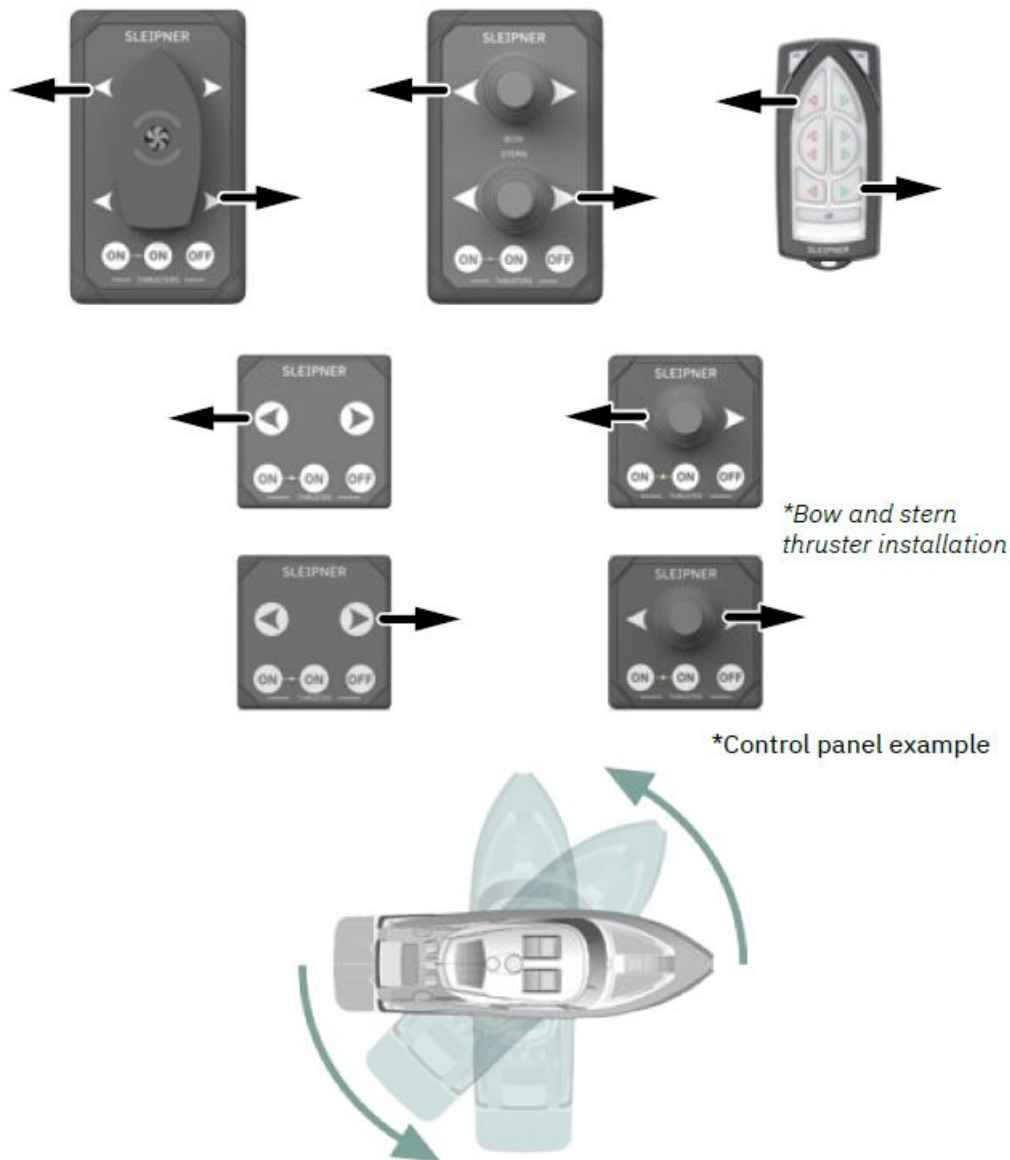

Maintenance

As a part of the seasonal service of your Thruster before every season, always check that:

In Water

- The area around the thruster inside the boat is clean and dry. Ensure there are no signs of water leaks.
- All electrical connections are clean and fastened firmly.
- Ensure that your batteries are in good condition.

Out of Water

- Check the propeller(s) or tunnel for any damage for example impact damage.
- The propeller(s) is fastened securely to the gear leg.
- Check all components of thruster are fastened securely.
- Clean the tunnel and gear leg from marine growth.
- Paint the propeller and gear leg with anti-fouling before every season to keep it clean from sea growth. (NB: Never paint the anode, sealing or propeller shaft. Ensure paint does not enter the space between the propeller

and the gear leg.)

- Change the anode before every season, or when half the anode has eroded. Always use a sealant or thread glue on the holding screw to ensure that it does not fall off.
- Check the gear leg is not leaking oil NEVER Disassemble any part of the Ignition Protected assembly. Tampering with the Ignition Protected assembly will cause it to lose this

SE / SEP

- 20
- 25
- 30
- 40

SE / SEP

- 50

SE / SEP

- 60

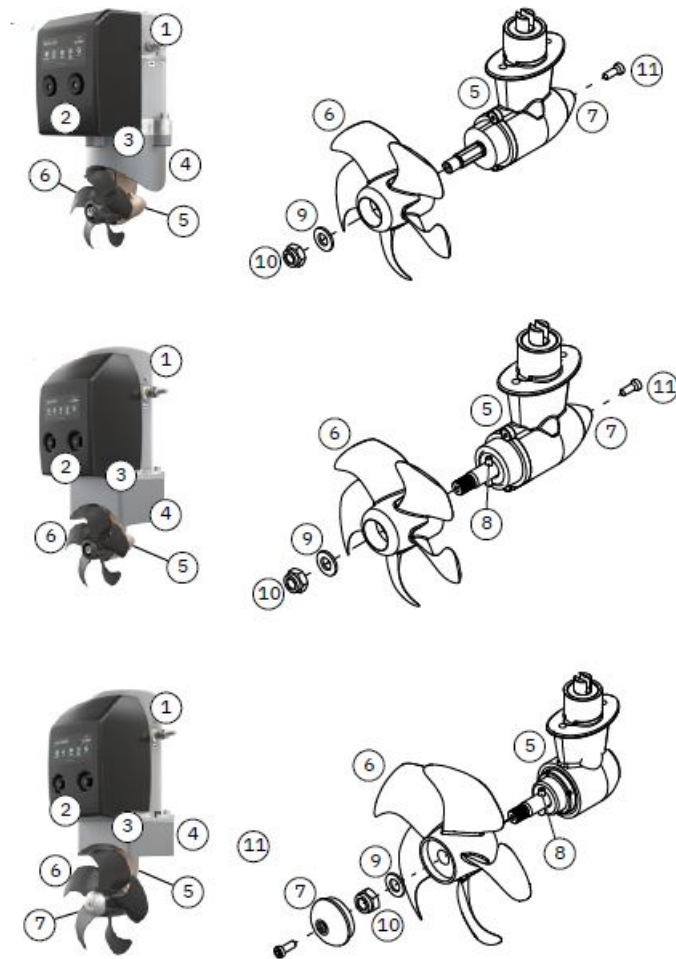

SE / SEP

- 80
- 100
- 120
- 130
- 150
- 170
- 210

SE / SEP

- 250
- 300

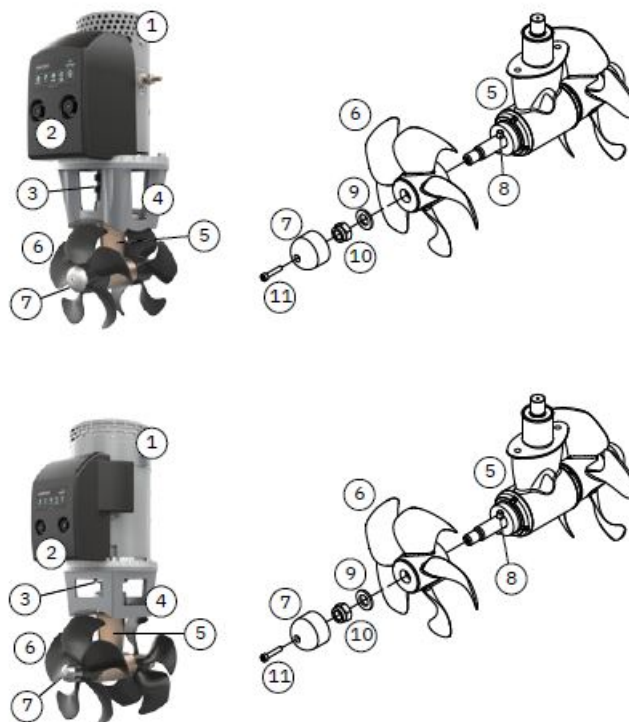

KEY:

1. Electro motor
2. Directional Solenoids/ power & control cables
3. Coupling (inside motor bracket
4. Motor Bracket
5. ear Leg
6. Propeller
7. Anode
8. Propeller Drive pin
9. Washer
10. Lock Nut
11. Fastening Screw for anode

SE / SEP (IP)

- 30
- 40

SE / SEP (IP)

- 50

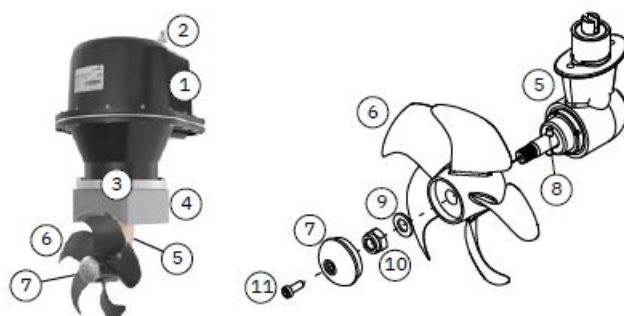
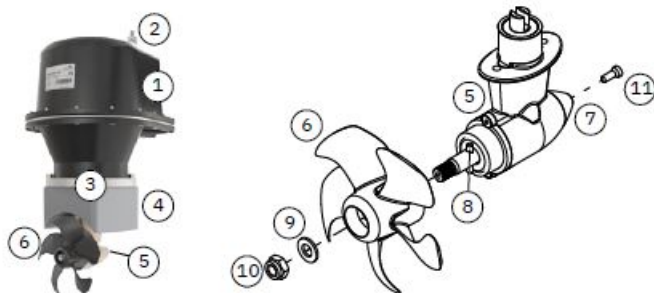
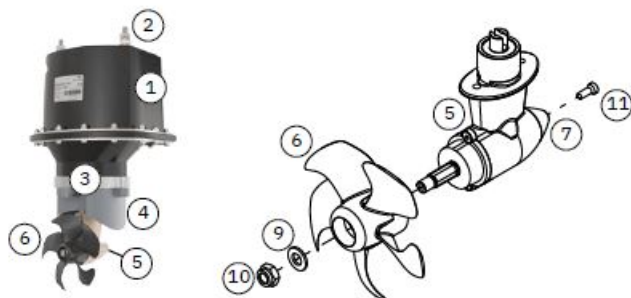

SE / SEP (IP)

- 60

SE / SEP (IP)

- 80
- 100

- 120
- 130
- 170

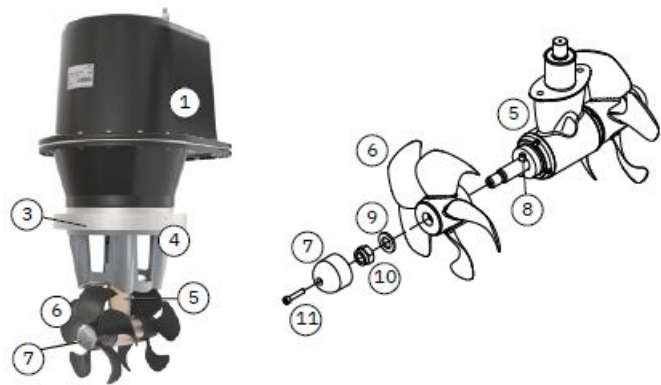

KEY

- 1. Electro motor
- 2. Directional Solenoids/ power & control cables
- 3. Coupling (inside motor bracket
- 4. Motor Bracket
- 5. Gear Leg
- 6. Propeller
- 7. Anode
- 8. Propeller Drive pin
- 9. washer
- 10. Lock Nut
- 11. Fastening Screw for anode

Basic Troubleshooting

Before seeking assistance from the website help desk from your Sleipner dealer/ distributor, please perform these tests. (NB: If you are unable to understand or perform these checks, you must consult a Sleipner distributor.)

CHECK	SOLUTION
The motor runs, but there is no thrust	
Check propellers are fitted, fastened correctly and there is no damage to the prop shaft.	Re-fasten or replace if necessary
*Check the flexible coupling between the motor and drive shaft is fitted correctly and not damaged.	Replace if necessary

* Check the gear leg is not damaged.	Replace if necessary		
The thrusters performance is reduced			
Check the propeller, gear house and tunnel are free from growth/ barnacles or debris and damage.	Remove growth and clean. <i>(NB: If there is obstruction in the tunnel it will disturb/ block the water flow and significantly reduce performance.)</i>		
Check the battery is in a good working condition.	<i>(NB: Keep the main engine(s) running in use to have a continuous charge to the batteries)</i> <ul style="list-style-type: none">• Check batteries are not worn out or in a bad charged condition• Check electrical connections/ wiring for damage or wear (corrosion)• Check cables are the correct size per the product manual• Tighten/ re-adjust connections		
The thruster does not start/ works in only one direction or does not turn off			
Check the main switch is active/ on.	Open the main switch if it is closed.		
Check all battery fuses are in good condition.	<ul style="list-style-type: none">• Check batteries• Check electrical connections/ wiring for damage or wear (corrosion)• Tighten/ re-adjust and clean connections		Replace if necessary
The thruster is not shutting off after the Joystick/ panel is disengaged.	Hit the main switch to disengage the thruster. Contact and consult a Sleipner distributor as the control system has been damaged.		
The thruster works in only one direction			
Damaged relay.	Hit the main switch to disengage the thruster. Contact and consult a Sleipner distributor as the control system has been damaged.		
The thruster runs in a pulsing action			
This is a build-in error response. -Solenoids failure	Hit the main switch to disengage the thruster. Contact and consult a Sleipner distributor.		
The solenoid might be in a lock-in/ auto stop position.	Hit the main switch to disengage the thruster. Contact and consult a Sleipner distributor.		

Service and Support

Find your local professional dealer from our certified worldwide network for expert service and support. visit our website www.sleipnergrouper.com/support Product Spare Parts and Additional Resources For additional supporting documentation, we advise you to visit our website www.sleipnergrouper.com and find your Sleipner product.

Warranty statement

1. Sleipner Motor AS (The "Warrantor") warrants that the equipment (parts, materials and embedded software of products) manufactured by the Warrantor is free from defects in workmanship and materials for the purpose for which the equipment is intended and under normal use and service (the "Warranty").
2. This Warranty is in effect for two years (Leisure Use) or one year (Commercial and other Non-leisure Use) from the date of purchase by the end user (for demonstration vessels, the dealer is deemed as end user).
3. This Warranty is transferable and covers the equipment for the specified warranty period.
4. The warranty does not apply to defects or damages caused by faulty installation or hook-up, abuse or misuse of the equipment including exposure to excessive heat, salt or fresh water spray, or water immersion except for equipment specifically designed as waterproof.
5. In case the equipment seems to be defective, the warranty holder (the "Claimant") must do the following to make a claim:
 - Contact the dealer or service centre where the equipment was purchased and make the claim.
Alternatively, the Claimant can make the claim to a dealer or service centre found at www.sleipnergroupp.com. The Claimant must present a detailed written statement of the nature and circumstances of the defect, to the best of the Claimant's knowledge, including product identification and serial nbr., the date and place of purchase and the name and address of the installer. Proof of purchase date should be included with the claim, to verify that the warranty period has not expired;
 - Make the equipment available for troubleshooting and repair, with direct and workable access, including dismantling of furnishings or similar, if any, either at the premises of the Warrantor or an authorised service representative approved by the Warrantor. Equipment can only be returned to the Warrantor or an authorised service representative for repair following a pre-approval by the Warrantor's Help Desk and if so, with the Return Authorisation Number visible postage/shipping prepaid and at the expense of the Claimant.
6. Examination and handling of the warranty claim:
 - If upon the Warrantor's or authorised service Representative's examination, the defect is determined to result from defective material or workmanship in the warranty period, the equipment will be repaired or replaced at the Warrantor's option without charge, and returned to the Purchaser at the Warrantor's expense. If, on the other hand, the claim is determined to result from circumstances such as described in section 4 above or a result of wear and tear exceeding that for which the equipment is intended (e.g. commercial use of equipment intended for leisure use), the costs for the troubleshooting and repair shall be borne by the Claimant;
 - No refund of the purchase price will be granted to the Claimant, unless the Warrantor is unable to remedy the defect after having a reasonable number of opportunities to do so. In the event that attempts to remedy the defect have failed, the Claimant may claim a refund of the purchase price, provided that the Claimant submits a statement in writing from a professional boating equipment supplier that the installation instructions of the Installation and Operation Manual have been complied with and that the defect remains.
7. Warranty service shall be performed only by the Warrantor, or an authorised service representative, and any attempt to remedy the defect by anyone else shall render this warranty void.
8. No other warranty is given beyond those described above, implied or otherwise, including any implied warranty of merchantability, fitness for a particular purpose other than the purpose for which the equipment is intended, and any other obligations on the part of the Warrantor or its employees and representatives.

9. There shall be no responsibility or liability whatsoever on the part of the Warrantor or its employees and representatives based on this Warranty for injury to any person or persons, or damage to property, loss of income or profit, or any other incidental, consequential or resulting damage or cost claimed to have been incurred through the use or sale of the equipment, including any possible failure or malfunction of the equipment or damages arising from collision with other vessels or objects.
10. This warranty gives you specific legal rights, and you may also have other rights which vary from country to country.

Patents

At Sleipner we continually reinvest to develop and offer the latest technology in marine advancements. To see the many unique designs we have patented visit our website www.sleipnergroupp.com/patents Sleipner Group, All rights reserved The information given in the document was right at the time it was published. However, Sleipner Group cannot accept liability for any inaccuracies or omissions it may contain. Continuous product improvement may change the product specifications without notice. Therefore, Sleipner Group cannot accept liability for any possible differences between product and document. Register your product and learn more at www.sleipnergroupp.com

SLEIPNER AS

- P.O. Box 519
- N-1612 Fredrikstad Norway
- www.sleipnergroupp.com

Documents / Resources

	<p>SLEIPNER SE100 IP Tunnel Thruster [pdf] User Manual DC SE, SE-IP Electric, SE100, IP Tunnel Thruster, SE100 IP, Tunnel Thruster, Thruster</p>
---	---

References

- [↔ Sleipner - Ocean born. Tech bred.](#)
- [↔ Patents - Sleipner Group](#)
- [↔ Support - Sleipner Group](#)