



Skywave BTR318-Dark Gray Bluetooth Transmitter and Receiver for Airplane User Manual

[Home](#) » [Skywave](#) » Skywave BTR318-Dark Gray Bluetooth Transmitter and Receiver for Airplane User Manual 

SkyWave

User Manual



Contents

- [1 Box Contents](#)
- [2 Transmitter mode](#)
- [3 Receiver mode](#)
- [4 FAQ](#)
- [5 Contact Us](#)
- [6 Documents / Resources](#)
 - [6.1 References](#)
- [7 Related Posts](#)

Box Contents

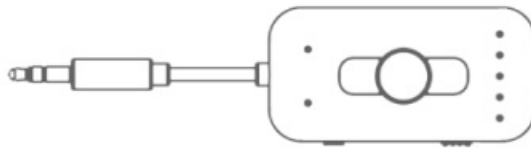

Skywave Transmitter & Receiver

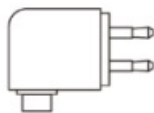

Dual 3.5mm Male to
3.5mm Female Adapter



3.5 audio port for 2 RCA

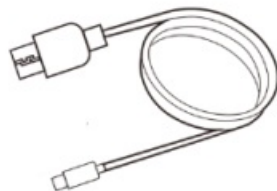

USB C Charging Cable
(1.5ft / 0.5m)



Traveling Pouch

Front

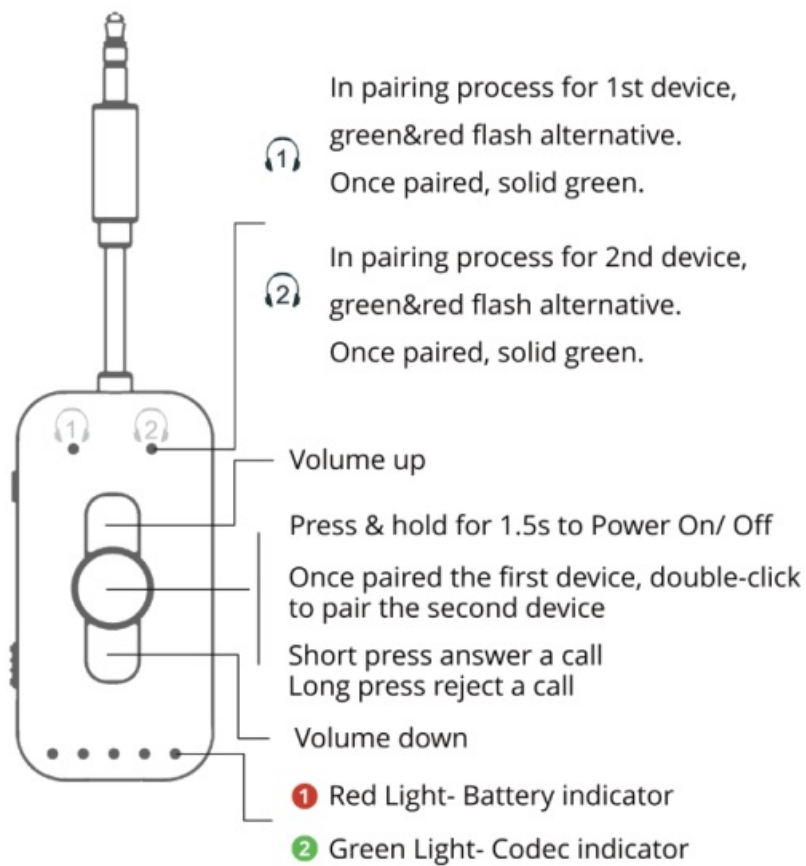

Side

① Troubleshooting : **Any pairing issues? Try it.**

Factory Reset - Press & hold 3s, both LED1&LED2 become brown, then all history data cleared, it automatically enter pairing for 1st device.

② Voice assistant:

After power on, double click to activate Voice assistant

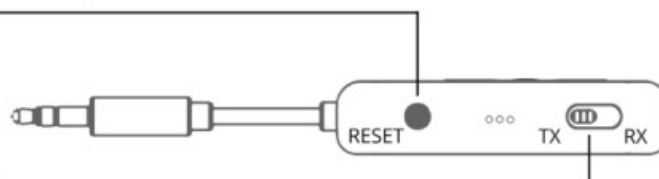

TX  RX

Transmitter mode: Connect to audio source

Slide to TX side. (The factory default setting is TX model).

TX  RX

Receiver mode: Connect to Non-bluetooth device/ car audio system/ Yacht audio system

Slide to RX side.

Transmitter mode

Plug into an Audio Source (Airplane/TV/PC/ Gym), paired with Earbuds, Airpods, Headphone, Speaker, and

stream audio signal into them.

1. Make sure the Switch on the TX side TX  RX.
2. Power on: Long press 1.5s on Multifunctional button

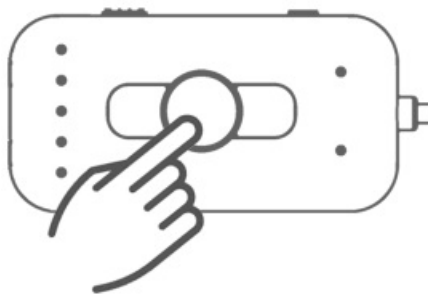

3. Plug the Skywave into an in-flight entertainment system (use the adapter if necessary) or any other audio source with an AUX 3.5mm audio connector.

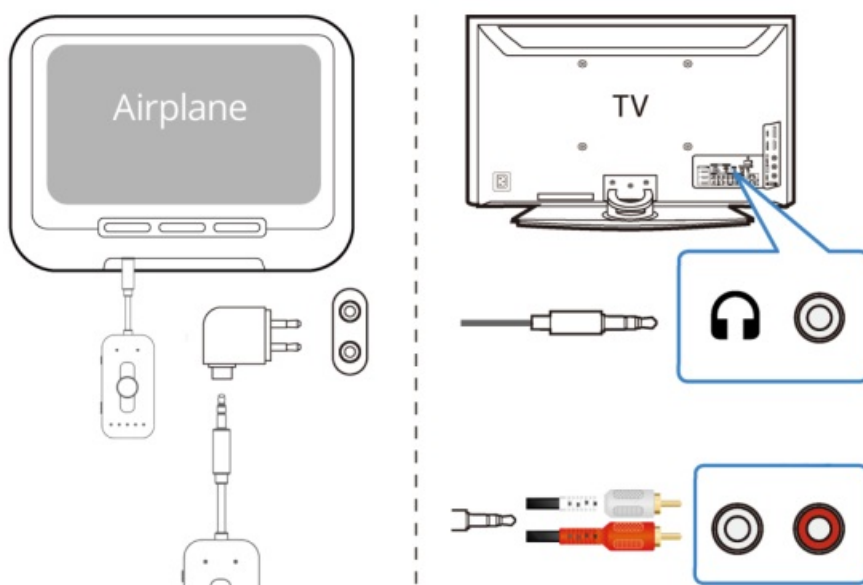

Receiver mode

Plug into Non-bluetooth device/ car audio system/ Yacht audio system, paired with Phone to stream audio signal.

1. Make sure the Switch on the RX side. TX  RX
2. Power on: Long press 1.5s on Multifunctional button
3. Plug the Skywave into a Car audio system/ Non-bluetooth speaker with an AUX 3.5mm port.

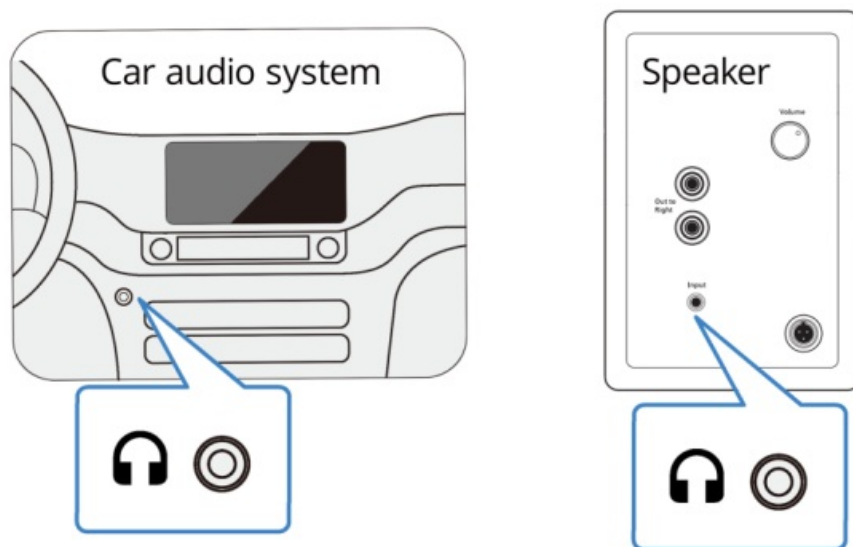

4. On your Phone- Turn on Bluetooth, search and select “Hornihear BTR318” to connect.

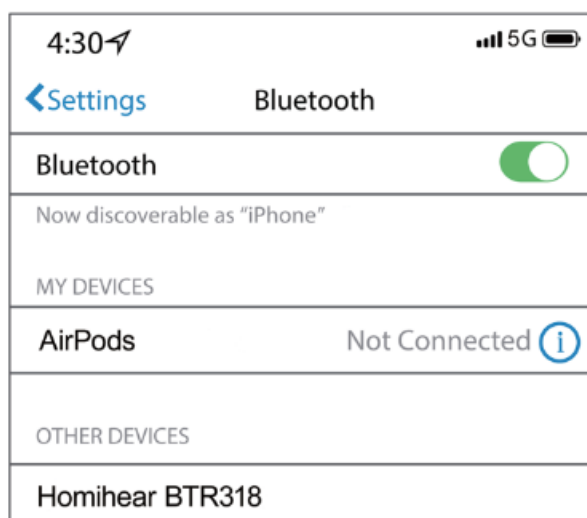

Tap “Hornihear BTR318” to connect



Voice assistant Double click RESET button to activate Voice assistant (Only in receiver mode , has Voice assistant)

FAQ

1. Pairing time too long or it refuse to pair with device, how to fix it?

CD Press and hold the Reset button for 3s until both LED1 & 2 become brown, it automatically enter pairing for 1st device. Make sure the mode switch is set to the correct position, either TX or RX.

2. How can I disconnect the current device and pair with a new one?

Press and hold the Reset button for 3s until both LED1&2 become brown, clear pairing history, then it automatically enter pairing for 1st device.

3. Can not find the device 81R318 in phone list?

Make sure the Mode Switch set to the RX side.

4. Can it work while charging?

Yes. It works while charging. Just make you power on it again After USB C cable plug-In.

5. How can I know the Battery level?

Pressing on one of the buttons, the charging LEDs will light up Red, every one of LED red up means 20% charged

6. How to pair the 2nd device?

After 1st device paired, DoubleClick the Multifunctional button to pairing 2nd device, LED 2 green red flash alternative. After paired, solid green.

7. How to answer a call?

(RX mode only) A call coming, short press to answer it, long press to reject it.

8. How to make a call?

(RX mode only) Activate the voice assistant(Siri), then a call by voice assistant

Contact Us

Support Email: support@homichron.com

Warning! This device complies with Part 15 of the FCC Rules. Operation is subject to the following two conditions: (1) This device may not cause harmful interference. (2) This device must accept any interference received, including interference that may cause undesired operation.

CAUTION: Changes or modifications not expressly approved by the party responsible for? compliance could void the user's authority to operate the equipment.

NOTE: This equipment has been tested and found to comply with the limits for a class B digital device, pursuant to part 15 of the FCC Rules. These limits are designed to provide reasonable protection against armful interference in a residential installation. This equipment generates, uses and can radiate radio frequency energy and, if not installed and used in accordance with the instructions, may cause harmful interference to radio comununications. However, there is no guarantee that interference will not occur in a particular installation. If this equipment does cause harmful interference to radio or television reception, which can be determined by turning the equipment off and on, the user is encouraged to try to correct the interference by one or more of the following measures:

- Reorient or relocate the receiving antenna.
- Increase the separation between the equipment and receiver.
- Connect the equipment into an outlet on a circuit different from that to which the receiver is connected.
- Consult the dealer or an experienced radio/ TV technician for help.

Manufacturer: Homichron Limited

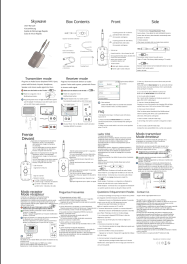

Documents / Resources

	<p>Skywave BTR318-Dark Gray Bluetooth Transmitter and Receiver for Airplane [pdf] User Manual</p> <p>2BDXA-BTR318, 2BDXABTR318, btr318, BTR318-Dark Gray Bluetooth Transmitter and Receiver for Airplane, BTR318-Dark Gray, Bluetooth Transmitter and Receiver for Airplane, Transmitter and Receiver for Airplane, and Receiver for Airplane, Receiver for Airplane, for Airplane, Airplane</p>
---	--

References

- [User Manual](#)

[Manuals+](#), [Privacy Policy](#)

This website is an independent publication and is neither affiliated with nor endorsed by any of the trademark owners. The "Bluetooth®" word mark and logos are registered trademarks owned by Bluetooth SIG, Inc. The "Wi-Fi®" word mark and logos are registered trademarks owned by the Wi-Fi Alliance. Any use of these marks on this website does not imply any affiliation with or endorsement.