



Skylight AQCT-3 Wifi Controller Instruction Manual

[Home](#) » [Skylight](#) » Skylight AQCT-3 Wifi Controller Instruction Manual 

Contents

- [1 Skylight AQCT-3 Wifi Controller](#)
- [2 Product Information](#)
- [3 Product Usage Instructions](#)
- [4 Installation and safety](#)
- [5 SAFETY INSTRUCTIONS](#)
- [6 INSTALLATION INSTRUCTIONS](#)
- [7 REPAIRS AND UTILIZATION](#)
- [8 WARRANTY](#)
- [9 Documents / Resources](#)

SKYLIGHT

Skylight AQCT-3 Wifi Controller



Product Information

- **Model:** AQCT-3
- **Dimension:** 131x81x16 mm
- **Power Rating:** 96 W/channel
- **Voltage:** 12V DC
- **Channels:** 2
- **Wi-Fi Frequency:** 2.4 GHz
- **Wi-Fi Security Standard:** WPA2
- **Minimum Operation System Version:** Android 10 or iOS 15
- **Lamp Name:** Maximum of 8 characters|
- **Lamp Type:** Maximum of 8 characters
- **Schedule Resolution:** Up to 1 minute
- **Maximum Number of Schedule Points:** 10|
- **Minimum Number of Schedule Points:** 2

Product Usage Instructions

1. Make sure the product is installed indoors and at room temperature.
2. Ensure the controller is installed securely to prevent it from falling into the aquarium.
3. Follow the installation instructions provided.
4. Keep children and pets away from the lamp.
5. Do not use a mechanically damaged device or modify its construction.
6. Do not switch on the device if any cable, including the power supply, is damaged.
7. Do not exceed electrical ratings.
8. To connect the controller to your Wi-Fi network, follow these steps:
 1. Install the SL CONTROL application on your Android or iOS device.
 2. Launch the app and select the CONNECTIONS tab.
 3. Press Register Controller.
 4. Connect to the controller access point network by scanning the QR code on the device.
9. For repairs or non-functional devices, contact your supplier.
10. Dispose of the product at designated collection points according to directive 2012/19/UE.

Warranty

SKYLIGHT provides a 2-year warranty for this product from the date of purchase. The warranty covers defects in material and workmanship under normal use. SKYLIGHT will repair or replace defected elements. The warranty does not cover damage caused by accidents, improper usage, improper storage, accidental dropping, etc.

Installation and safety

The AQCT-3 controller has been designed for adjusting colour and brightness of Skylight aquarium lamps: AQI, AQIR and HYPERSPOT series. It is additionally compatible with Skylight terrarium lamps: TINY-, PR-, PRI- and MID series in which It can be used for adjusting brightness. Daytime cycle including sunrise and sunset simulation can be programmed individually for each of the 2 channels. To allow for easier configuration with PR-, PRI-, AQI, AQIR and HYPERSPOT lamps channels has been named as W-warm and C-cold which fits their actual function.

SAFETY INSTRUCTIONS

- The product is only intended to be used as a controller for Skylight aquarium and terrarium lighting, indoors and at room temperature. Make sure, that the controller is installed in a way, that prevents it's falling into the aquarium.
- Follow the installation instructions.
- Keep children and pets other than your aquarium animals away from the lamp.
- Do not use a mechanically damaged device, do not modify the construction. Do not switch on the device if any cable (including the power supply) is damaged.
- Do not exceed electrical ratings!

INSTALLATION INSTRUCTIONS

Installation scheme (Fig. 1).

1

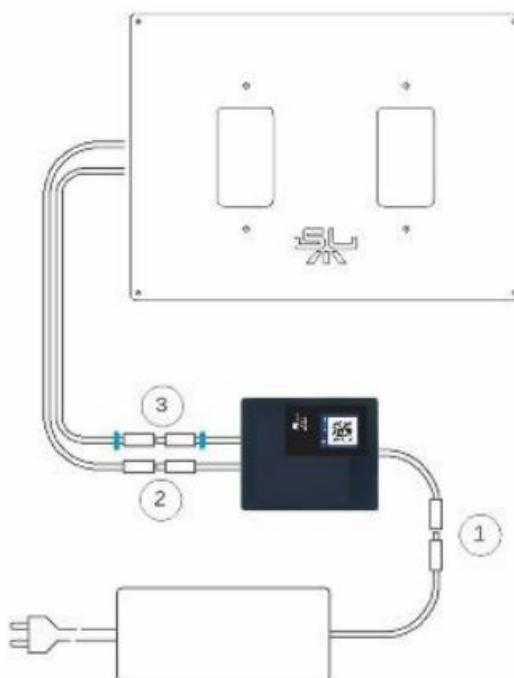

- a) Connect the controller output plugs to the lamps sockets. Make sure, that the blue markers indicating the cold channel (C) on plugs and sockets are fitting. (position 2 and 3).
- b) Connect the power adapter plug to the controller socket (position 1).

Wi-Fi frequency needs to be 2.4 GHz!

2



3



4



- Install the SL CONTROL application on your Android or iOS device (fig. 4).
- Launch the app on your smartphone and select the CONNECTIONS tab. Press “Register Controller”. You will be redirected to the list of available Wi-Fi networks (android) or you will need to start the camera app (iOS). Connect to the controller access point network by scanning the QR code on the device (Fig. 2)
- We have prepared videos showing how to connect to your AQCT-3 controller and how to register it in your home Wi-Fi network. To watch the videos scan the QR codes please Fig. 3).

CAUTION:

Using an inappropriate power adapter, which does not fit the power supply range will result in the device damage!

Model	AQCT-3
Dimension	131x81x16 mm
Power rating	96 W/channel
Voltage	12V DC
Channels	2
Wi-Fi frequency	2,4 GHz
Wi-Fi security standard	WPA2
Minimum operation system version	Android 10 or iOS 15

- lamp name max 8 characters,
- lamp type max 8 characters,
- resolution of schedule up to 1 minute,
- maximum number of schedule points 10,
- minimum number of schedule points 2.

REPAIRS AND UTILIZATION

- Do not try to repair a damaged product. For information about the service of a non-functional device contact your supplier.
- Product cannot be disposed of as unsorted municipal waste. According to the directive 2012/19/UE, the device should be disposed of at designated collection points.



WARRANTY

SKYLIGHT warrants this product to be free of defects in material and workmanship under normal use for 2 years from the date of purchase. The obligation of this warranty is limited to the repair or replacement of defected elements. No claim shall be allowed under this warranty if, in the opinion of SKYLIGHT, this product has been subject to accident or improper usage, including, but not limited to: damage, improper storage, accidental dropping etc. Please send the damaged device to your supplier including power supply and cables, the completed warranty card and receipt. The serial number on the device has to be the same as in the warranty card. The obligation of this warranty is limited to the device bought, and no claim shall be allowed under this warranty due to damage or loss of any other objects.

WARRANTY CARD

Model:

AQCT-3

Serial number(s):

Date of purchase:

Name:

Address:

e-mail:

My signature below acknowledges, that I have fully read, understand and accept this limited warranty agreement.

DateSignature

Documents / Resources

	Skylight AQCT-3 Wifi Controller [pdf] Instruction Manual AQCT-3, AQCT-3 Wifi Controller, Wifi Controller, Controller
---	---